

Age Range: 3 and up
 Weight Limit: 65 LBS
 Surfaces: Grass/Asphalt & Other
 Hard Surfaces
 Speed: 2.5 MPH For/Rev
 5.0 MPH For
 Colors: Black Body/Silver Seat
 Black Wheels

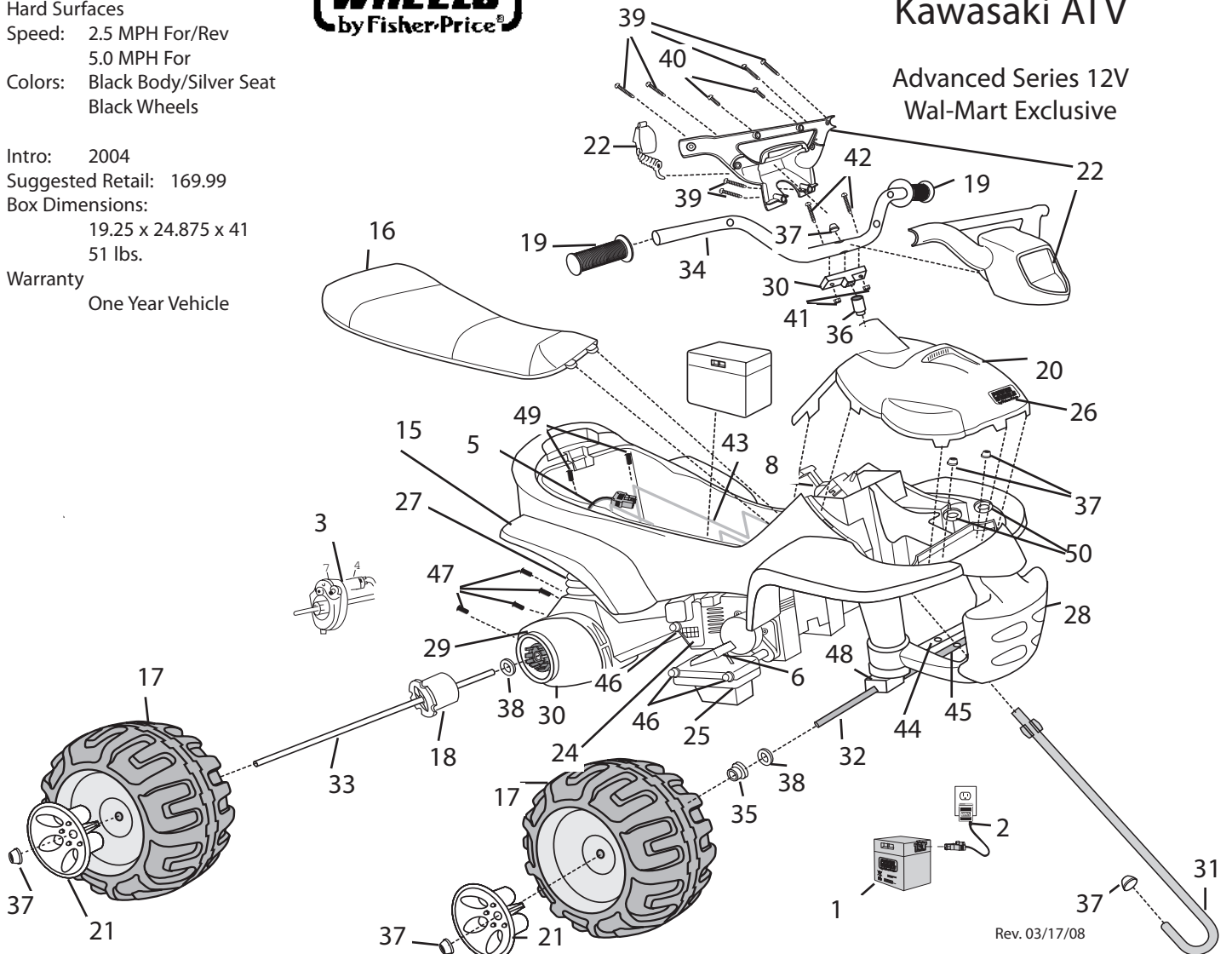

C7478
 Kawasaki ATV
 Advanced Series 12V
 Wal-Mart Exclusive

Intro: 2004
 Suggested Retail: 169.99
 Box Dimensions:
 19.25 x 24.875 x 41
 51 lbs.
 Warranty
 One Year Vehicle



Rev. 03/17/08

Item No.	Description	Part No.	Qty.	Item No.	Description	Part No.	Qty.	Item No.	Description	Part No.	Qty.
Working / Electrical Parts				Hardware / Metal Parts				Parts Not Shown			
1.	12V Battery	00801-0638	1	30.	Handlebar Neck	73690-4289	1	50.	Top Bushing	74110-2129	2
2.	12V Charger w/Probe	00801-0972	1	31.	*Steering Column	73690-4249	1	51.	Trusshead Screw	0801-0278	1
3.	Motor Gearbox Assembly	00968-2912	2	32.	Front Axle	73690-4509	2	Large Parts Bag C7478-9249 1			
4.	Motor Pinion Assembly	0968-2702	2	33.	Rear Axle	73690-4549	1	Small Parts Bag N/A C7478-9259 1			
5.	Main Harness Assembly	C7478-9799	1	34.	Handlebar	74282-4219	1	Hardware Bag C7478-9279 1			
6.	Footboard Assembly	73690-9169	1	35.	Round Bushing	74550-2689	2	Owner's Manual C7478-0920 1			
7.	Gearbox W/out Motor	00968-2802	2	36.	Steering Bushing	78476-2259	1	Decal Sheet C7478-0310 1			
8.	Shifter Assembly	73690-9439	1	37.	*.437 Cap Nut	0801-0226	6	Cap Nut Tool 78640-2629 1			
Plastic / Other Parts				38.	7/16" Washer	0801-0196	4	Adhesive Clip (Harness) 0801-0313 2			
15.	Body	N/A	1	39.	# 6 x 1" Screw (Order Hardware Bag)	00912-6006	6	False Motor Cover Left 73690-2069 1			
16.	Seat	C7478-2309	1	40.	# 6 x 1/2" Screw	00912-6002	2	Footrest 73690-2189 1			
17.	Wheel	73690-2469	4	41.	# 10-32 Lock Nut N/A (Order Hardware Bag)	0801-0318	3	Footboard Support (Metal) N/A 76262-4439 1			
18.	Rear Wheel Driver	74460-2249	2	42.	# 10 x 1 5/8" Screw (Order Hardware Bag)	N/A	2	Motor Rod Lower (no sub) 74110-4569 1			
19.	Handgrip	74527-2229	2	43.	Battery Retainer	74110-4429	1	Shifter w/Harness 73690-9679D 1			
20.	Cowling	3800-7368	1	44.	Crossbar	73690-4649	1	Footswitch (plunger-type) 00801-1566 1			
21.	Hubcap	73690-2579	4	45.	Steering Linkage Assembly	B2008-9239	1				
22.	Handlebar Assy. W/Microphone	3800-7474	1	46.	.354 Retainer	0801-0604	4				
24.	False Motor Cover Right	73690-2059	1	47.	#8-18 x 3/4 Screw	0801-0223	10				
25.	Footboard -Lower	73690-2179	1	48.	Bottom Bushing	74110-2639	2				
26.	PW Emblem	74460-9069	1	49.	#10 x 1.25" N/A	00801-0260	2				
27.	Rear Shock Boot	74527-2089	2								
28.	Brushguard	73690-2079	1								
29.	Motor Housing Top	C7478-2159	1								
30.	Motor Housing Bottom	C7478-2169	1								

*Service Bulletin 174

N/A = Not Available

Bold and Underlined parts are to be purchased and installed by Service Centers only. These items may not be sold directly to consumers by Service Centers or Fisher-Price.