

QUICK START GUIDE



www.Stingerdetectors.us



GOLD STINGER X5

Please read this **quick user guide** before you start using the device.

Gold Stinger X5 . Installation

To install **Gold Stinger X5**:

First, connect the search coil shaft and main unit shaft to each other, as shown in the video

Then install the appropriate coil in the coil shaft

Secondly, connect the shafts carrying the coil that you connected earlier, to the handle of the main unit

Thirdly and finally, install the coil cable connector in its socket in the main unit, and pay attention to the correct installation.

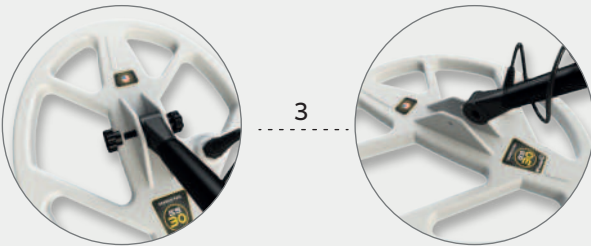
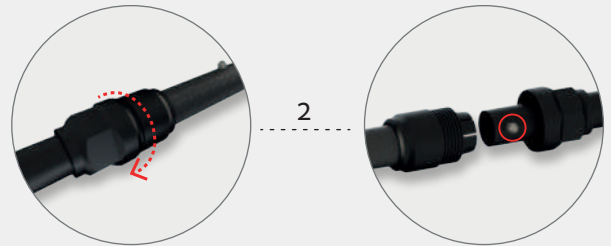
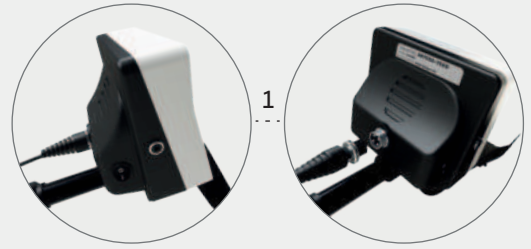

Turning on the Gold Stinger X5

Turn on the device with the button on the right side of the device main unit.

One of the search coils must be connected to the device correctly so that the device can perform the ground balancing correctly. After the start and welcome screen loading is complete, Ground Balance screen will appear immediately.

You can also perform ground balancing by pressing the G-Balance button on the control panel.



Correct adjustment of the ground balance

Adjusting the ground balance correctly is the first and most important step in finding your target by uncovering your hidden treasure.

In order to get the best results while searching with the Gold Stinger X5, you must pay attention to the correct ground balancing, follow the following steps in order:

1- Factory Reset: It is the first step in properly setting the ground balance correctly; to reset to factory settings; we first enter the settings by pressing the Settings button, then the general settings screen will appear in grey, as shown in the image above.

to enter the device settings;

we press the Enter / Start button located in the center of the main control panel, then we go to the last option in the list that appears to us, by moving down through the Down / - . button located to the right of the main control panel, we stop on the option, Factory Settings, and press the Enter / Start button , we will then see that the device has restarted automatically.

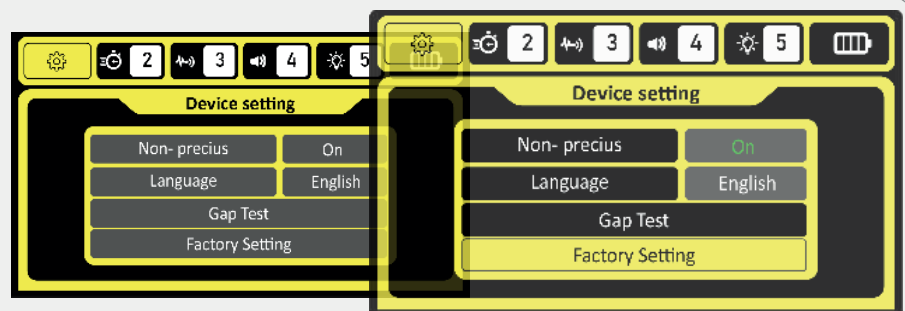

Note: When you turn on the device for the first time, the automatic Ground Balance screen will appear; In order to bypass this screen and go to settings to factory reset; we just press the Enter/Start button on the control panel, then the "All Metals" mode screen will appear, to go to the settings from here, press the Settings button from the keyboard, and complete the setup as described previously.



2- Installing Search Coils: When the Loading screen appears, after factory reset, we make sure that the coil properly connected to the device, quickly; we raise the device horizontally in the air, so that it is parallel to the user's arm, then immediately and continuously press the Down/ - . button from the main control panel, the device will start recognizing the attached coil, wait a while for the coil to complete loading, then the device will make a distinctive sound indicating that the attached search coil has been recognized. Then lower the device at a level of **5 to 10 cm** from the surface of the ground vertically, to start balancing the ground.

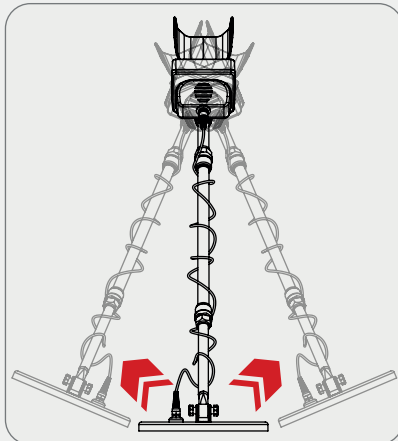

Incorrect use

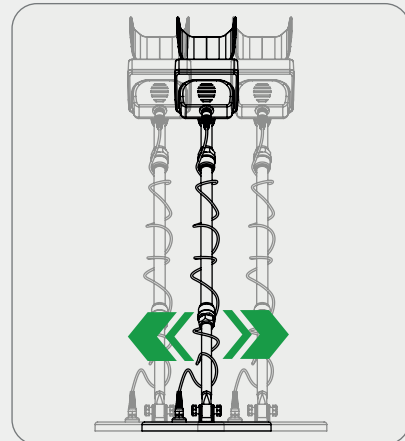

correct use

Note: During the ground balancing of the device, it is always preferred that the distance between the surface of the ground and connected search coil of the device being used should be 5 to 10 centimeters maximum. Our experts also advise to reset the ground balance again if the device is giving wrong or inaccurate data.

3- Ground Balance Adjustment: After the first factory reset, then connecting the search coil correctly, and loading it into the device. We lower the device from the air perpendicular to the ground, so that the coil connected to the device is horizontal with the surface of the ground, as described previously.

To make a correct ground balance: move the device steadily from right to left or from front to back and vice versa; until a fixed number appears on the Ground Balance screen, the device will make a distinctive beep sound indicating that the Gold Stinger X5 has the correct ground balancing.



QUICK GOLD STINGER X5

START GUIDE



STINGER  DETECTORS

U S A TECHNOLOGY

www.Stingerdetectors.us

Please read this **quick user guide** before you start using the device.