

QUICK START GUIDE

Packing List

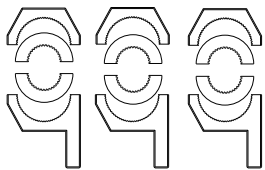

Round Clamp Bracket Kit*3

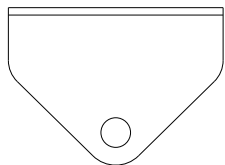

Lawn mower trailer hook*1

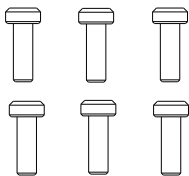

Round head bolt M5*6

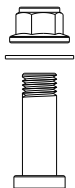

Shoulder bolt with washer and nut M8*1

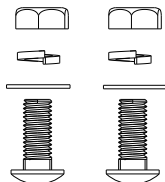

Square neck bolts with washer and nut M8*2



L-Shaped wrench*1

Towing Hitch Compatibility Diagram

*Install trailer ball

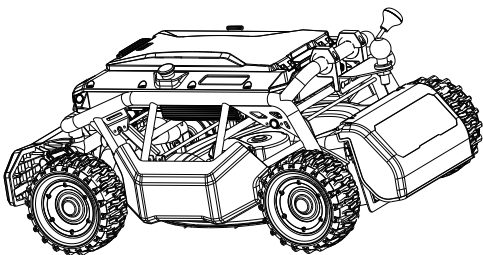

*Install latch

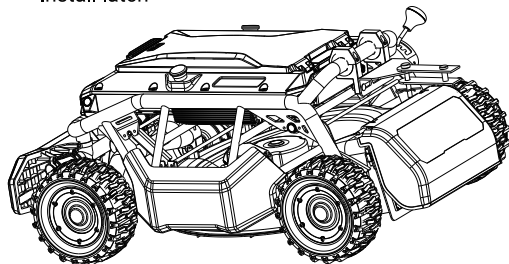

*Install the bracelet

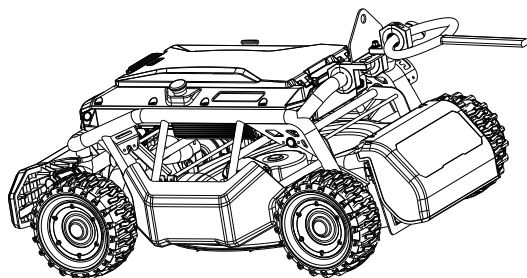

Assembly Instructions

Step 1: Install the clamp base and trailer hook

(Tighten all the bolts and nuts)

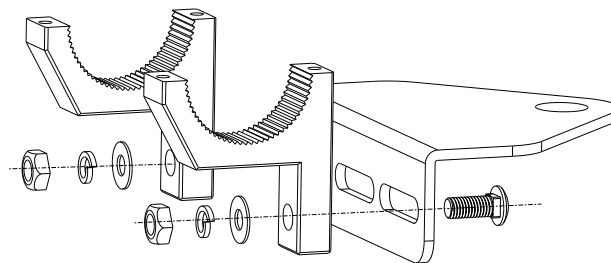

Step 2: Install in the middle of the handle

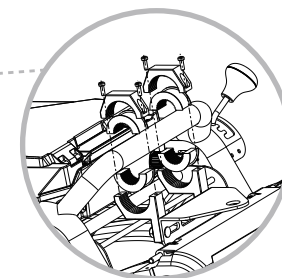
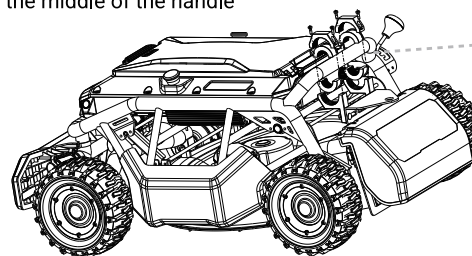

(Select the suitable soft gel based on requirements.)

Step 3: Adjust trailer hook

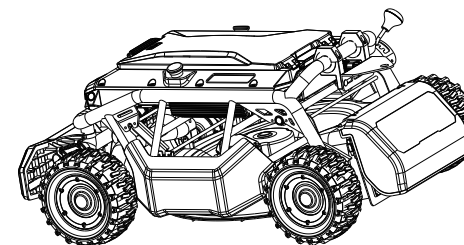

Step 4: Install the third clamp(optional)

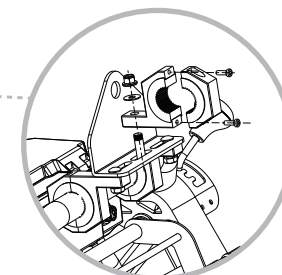
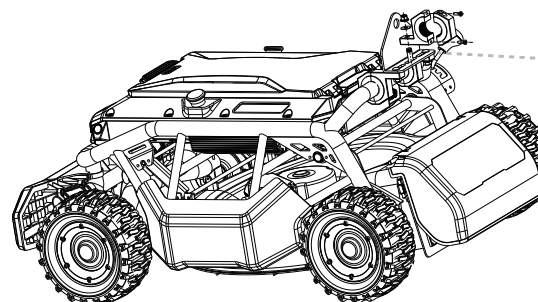

(Towing hitch compatibility diagram)