



Ergo-Series E7W Barrel Sauna  
Half Glass Window 71D" x 81H"



Note: Please read manual before construction

Rev 4/2023

# Front & Back Walls

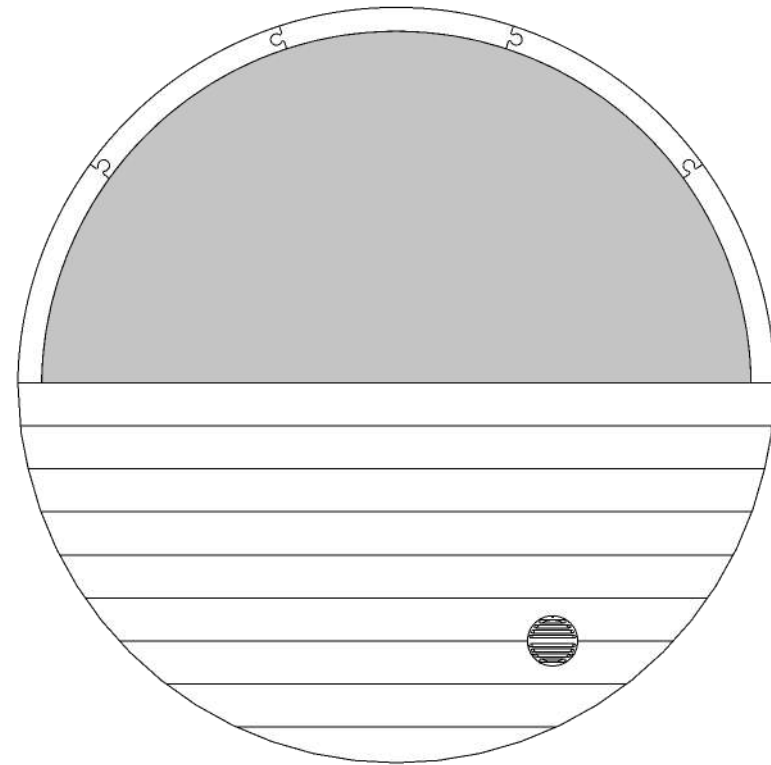
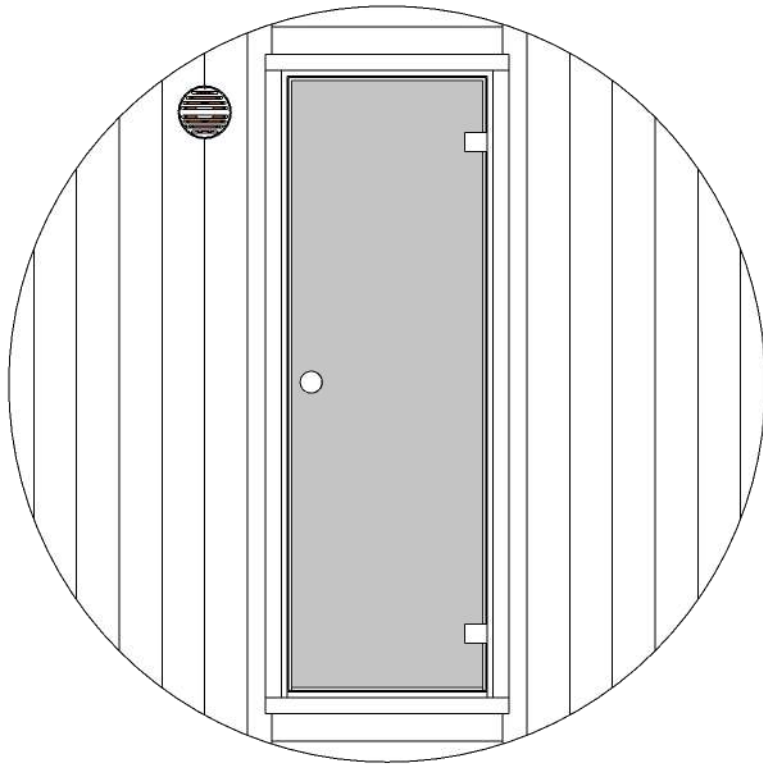

E7W Barrel Sauna 71D" x 81H"

Details list.

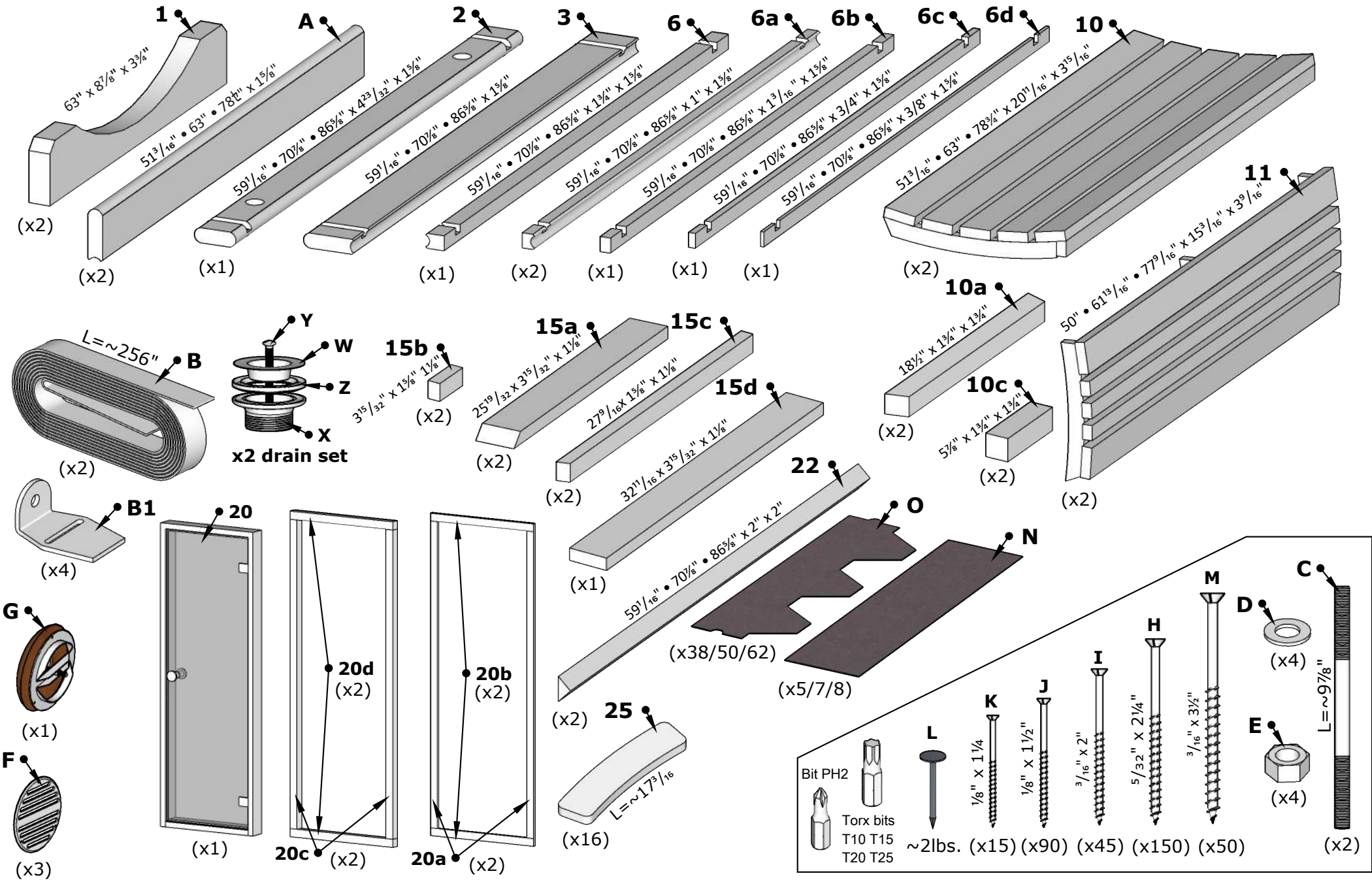

## Tools needed

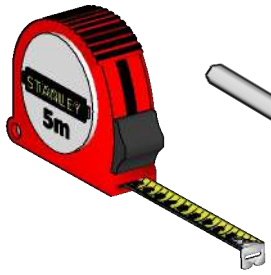

Measuring tape

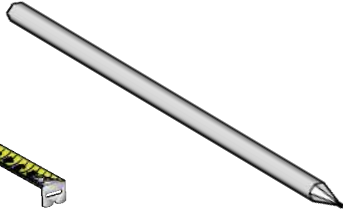

Marker pen

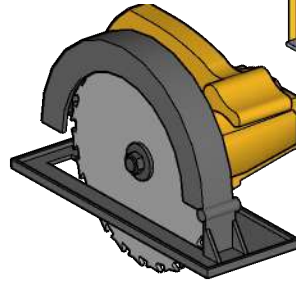

Circular saw

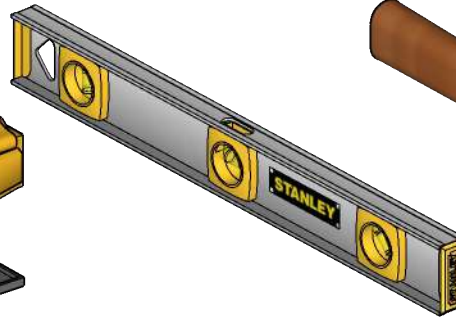

Water level

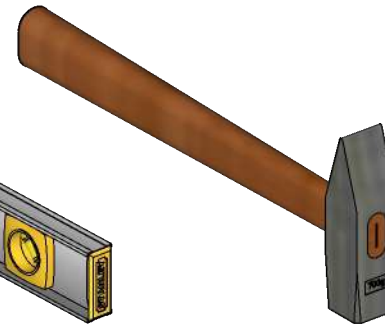

Hammer



Extra hands



Ratchet strap

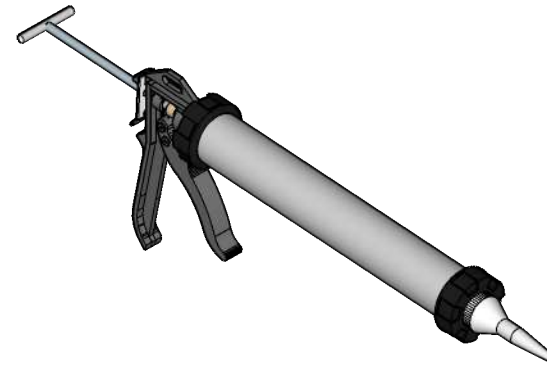

Silicone gun  
(Only glass-wall models)

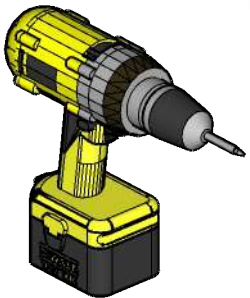

Drill

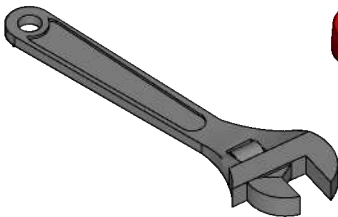

Crescent wrench



Utility knife

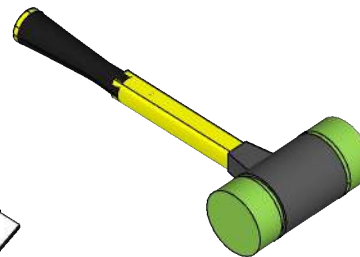

Rubber mallet



# Wooden front wall installation

## Details

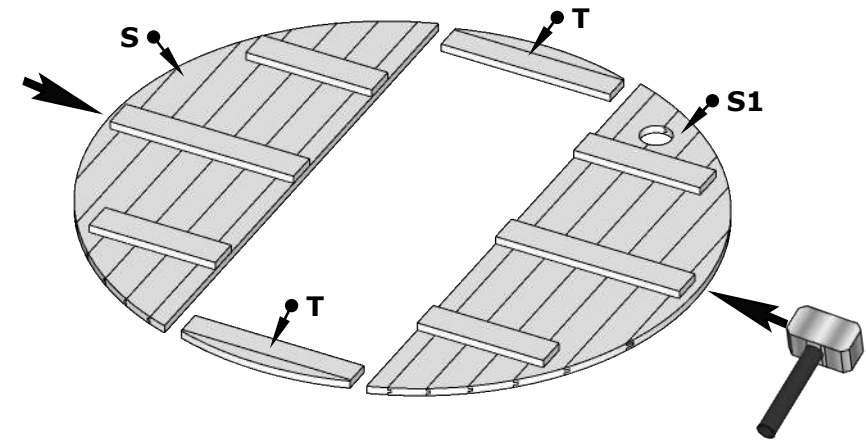
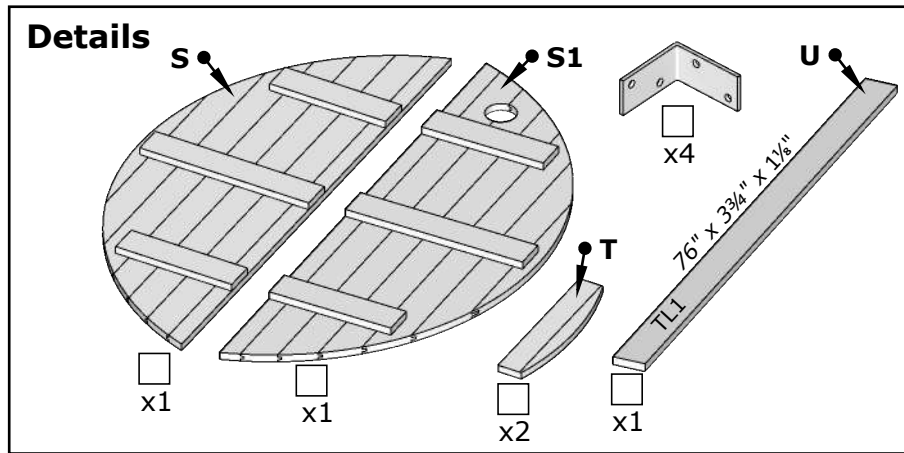

I

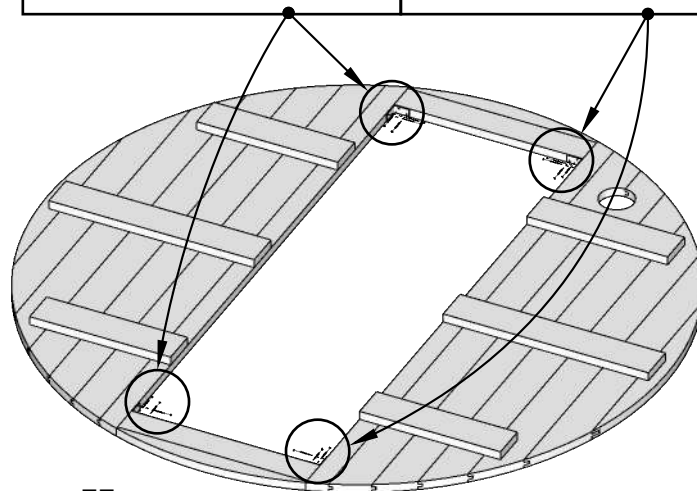
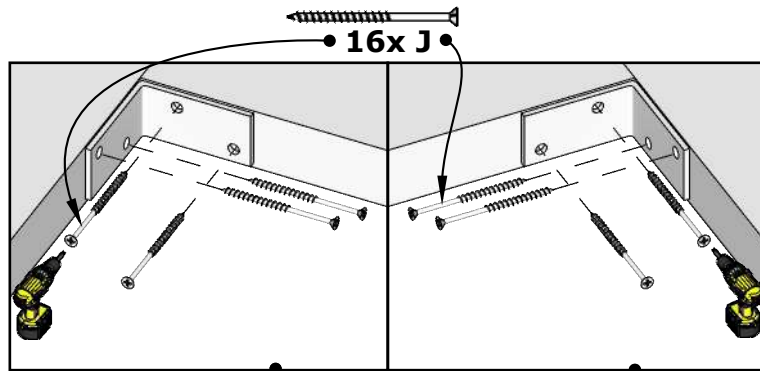

II

**DET U** Fix it diagonally to make wall more rigid during the installation.

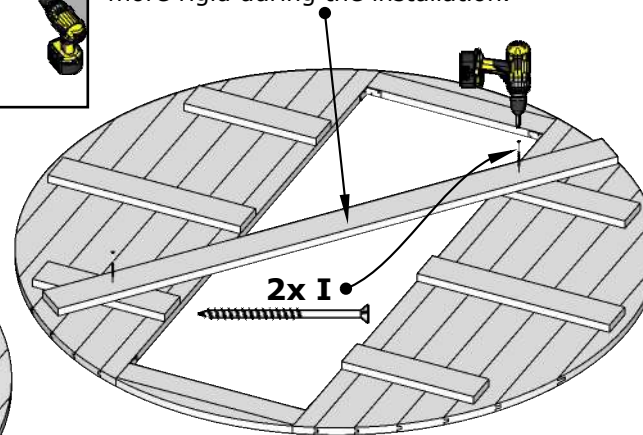

III

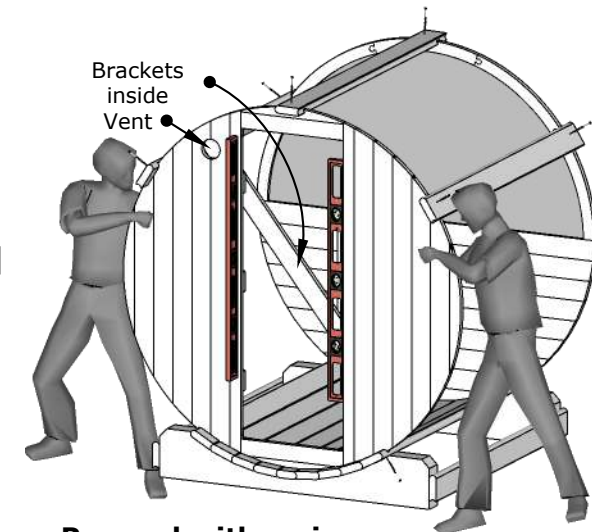

**Proceed with main installation manual!**

# Half-moon wall installation

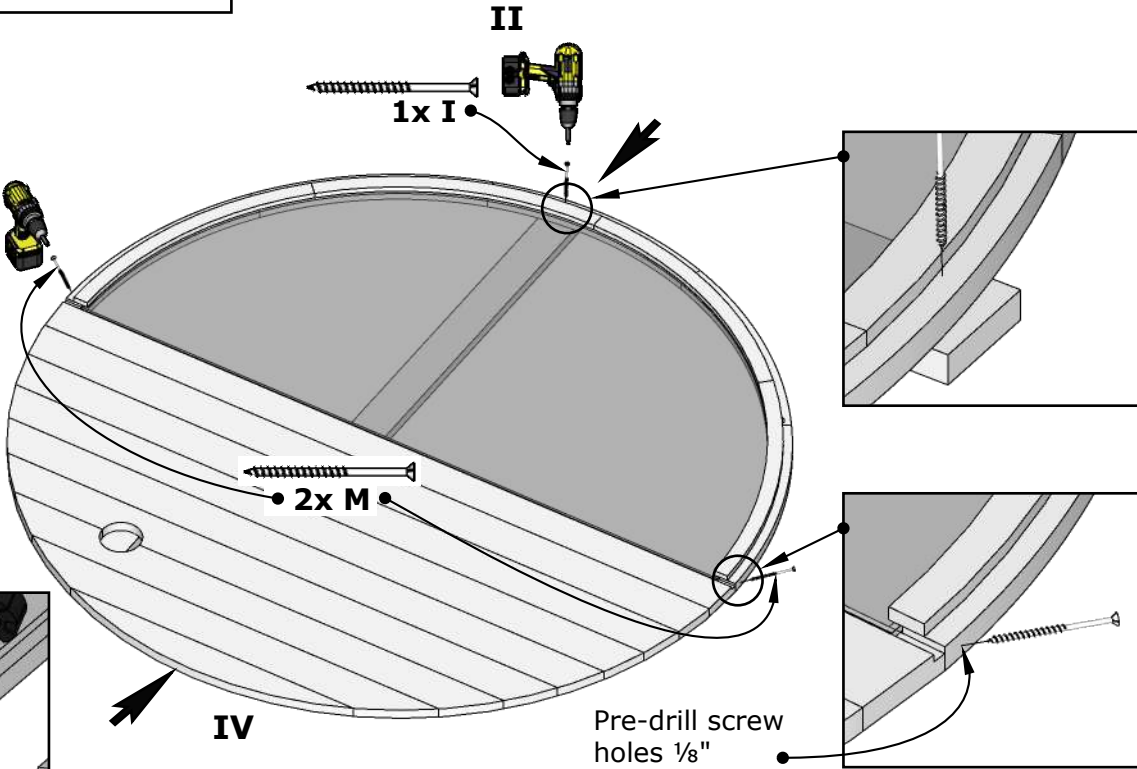
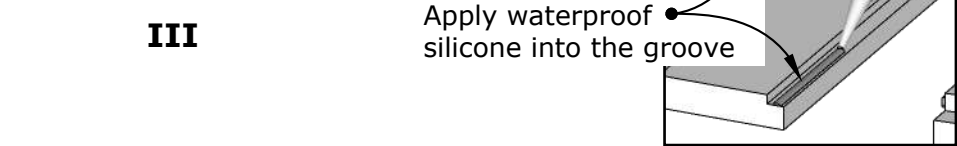
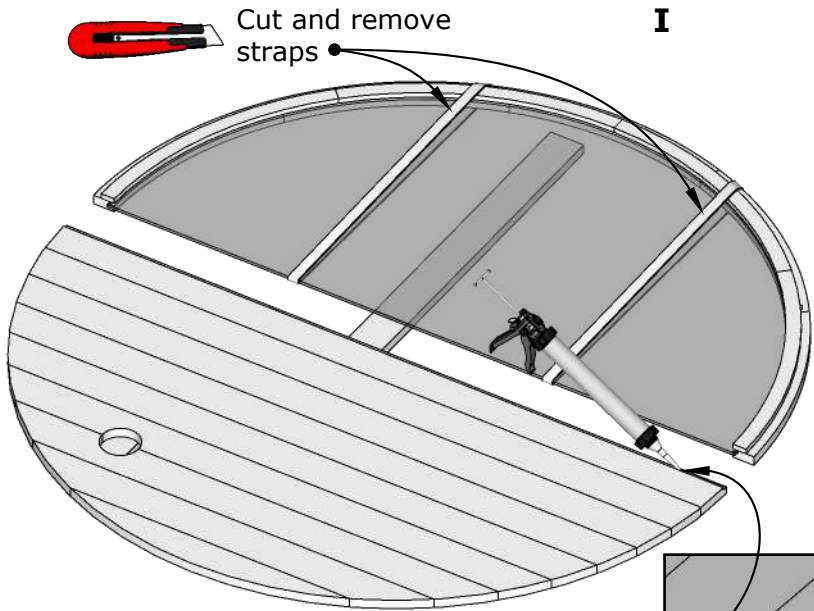
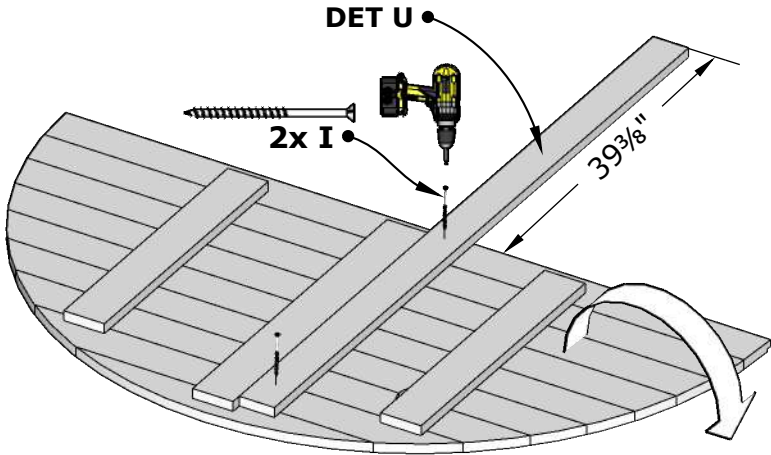
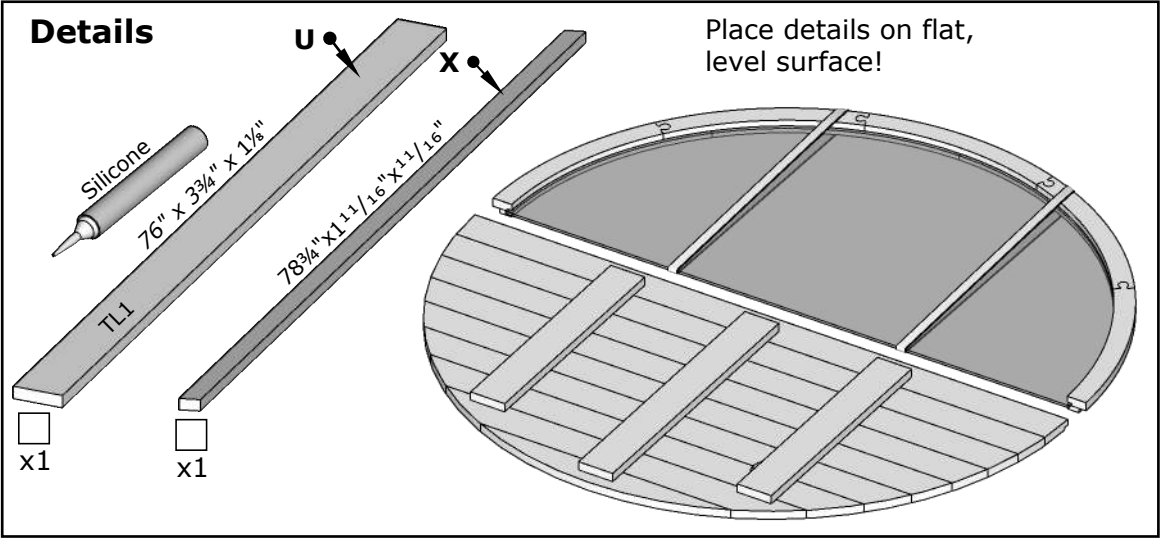

**WARNING:** Do not let screws touch glass!



# Half-moon wall installation

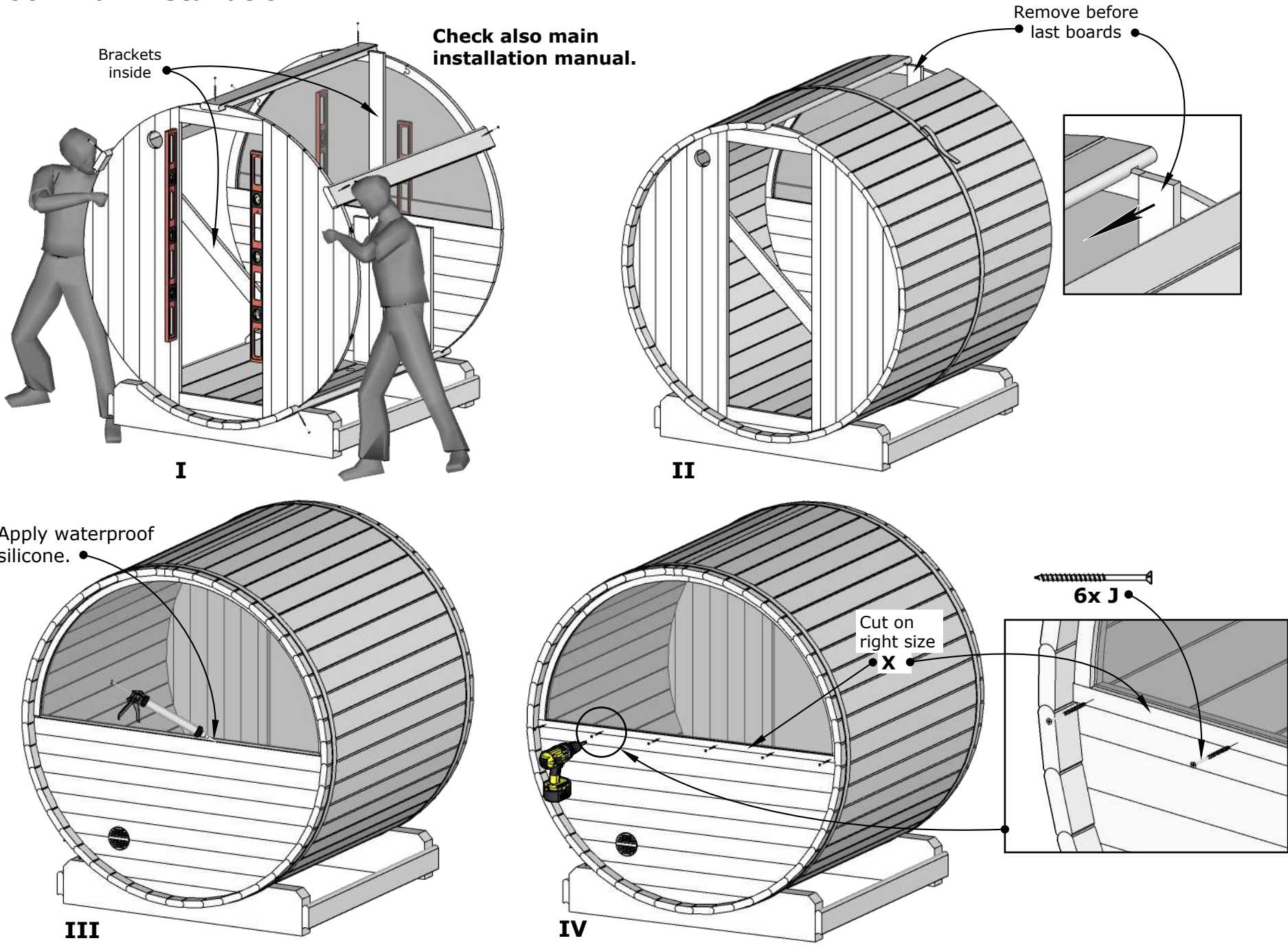

E7W Barrel Sauna 71D" x 81H"

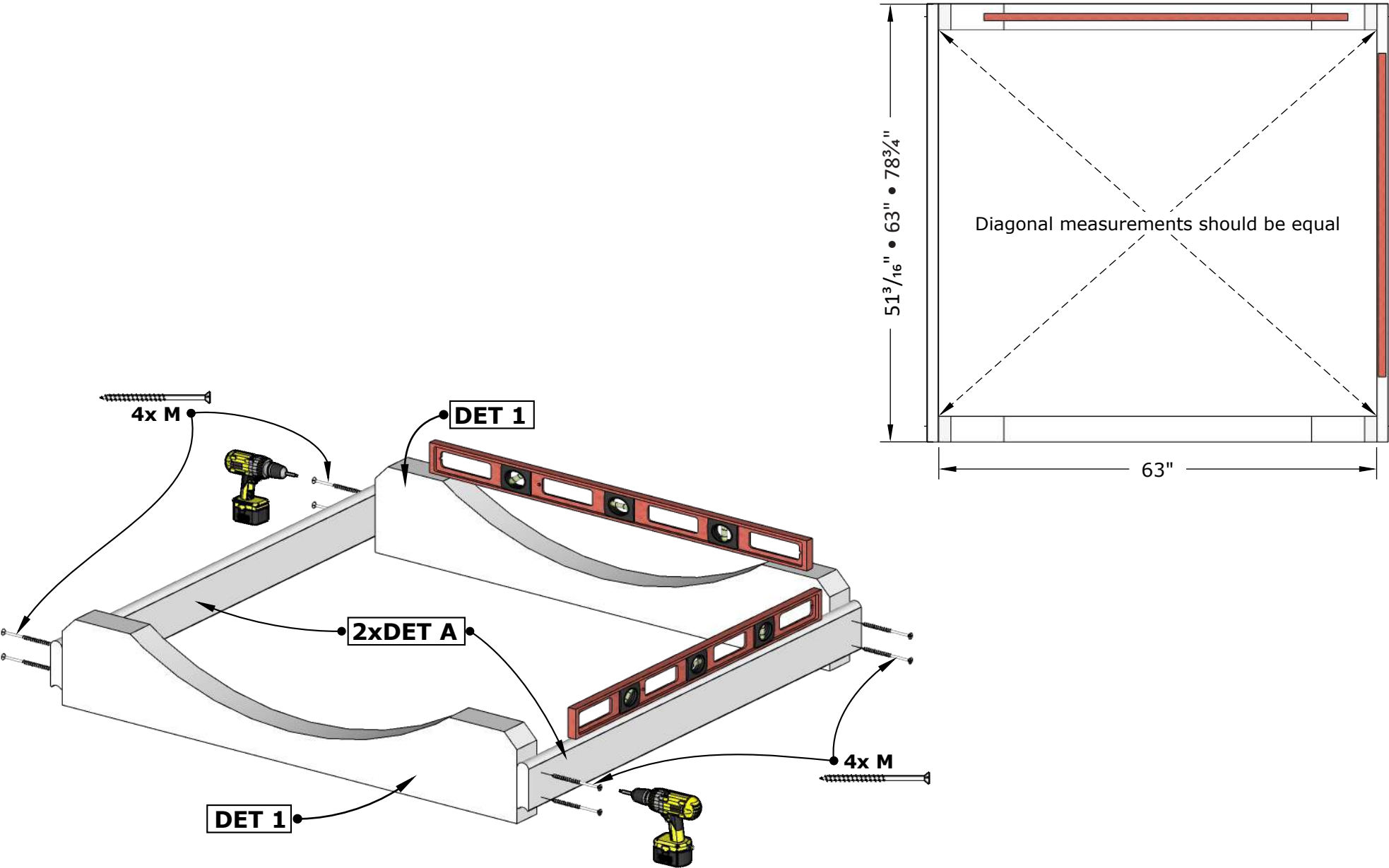



E7W Barrel Sauna 71D" x 81H"

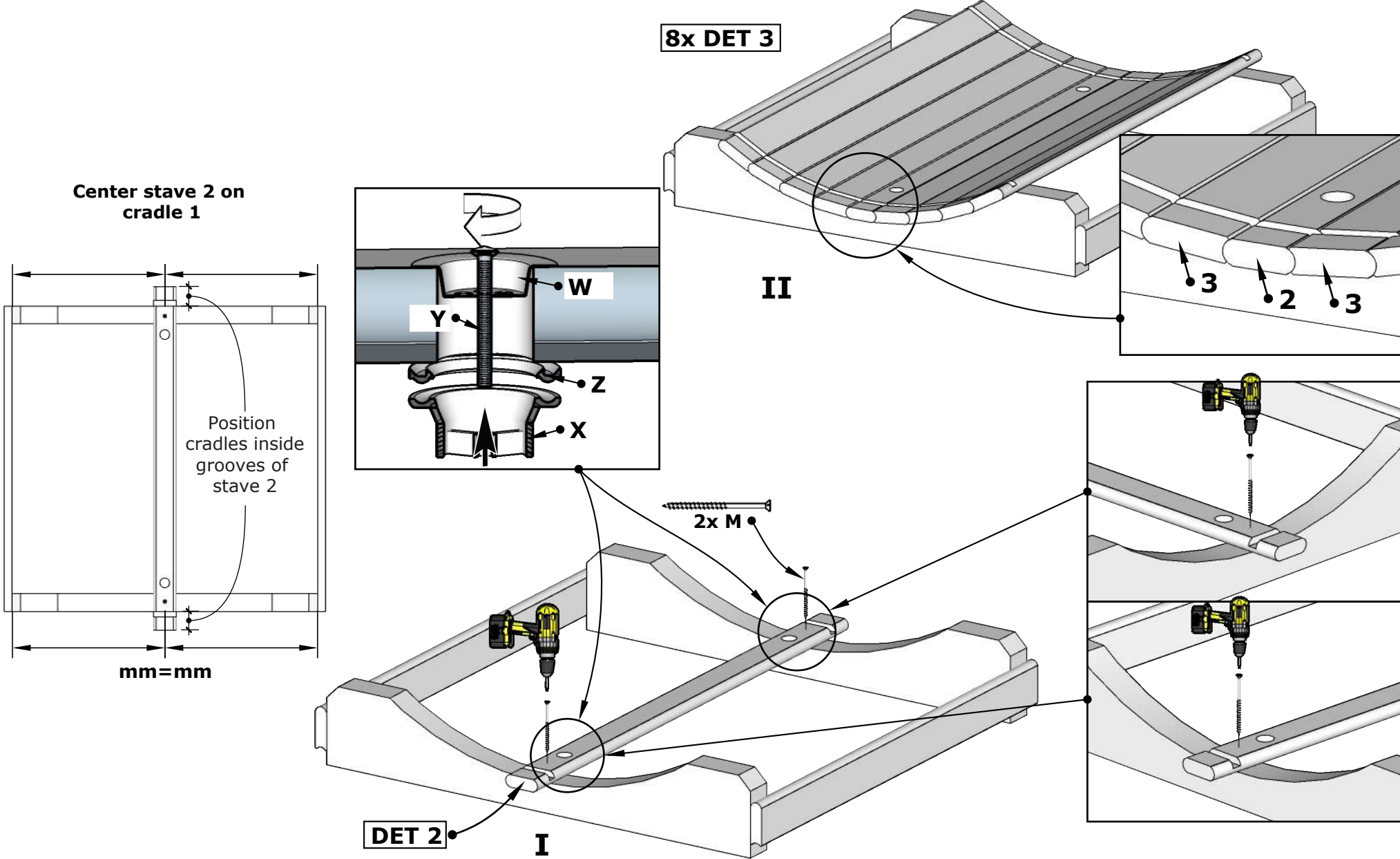

E7W Barrel Sauna 71D" x 81H"

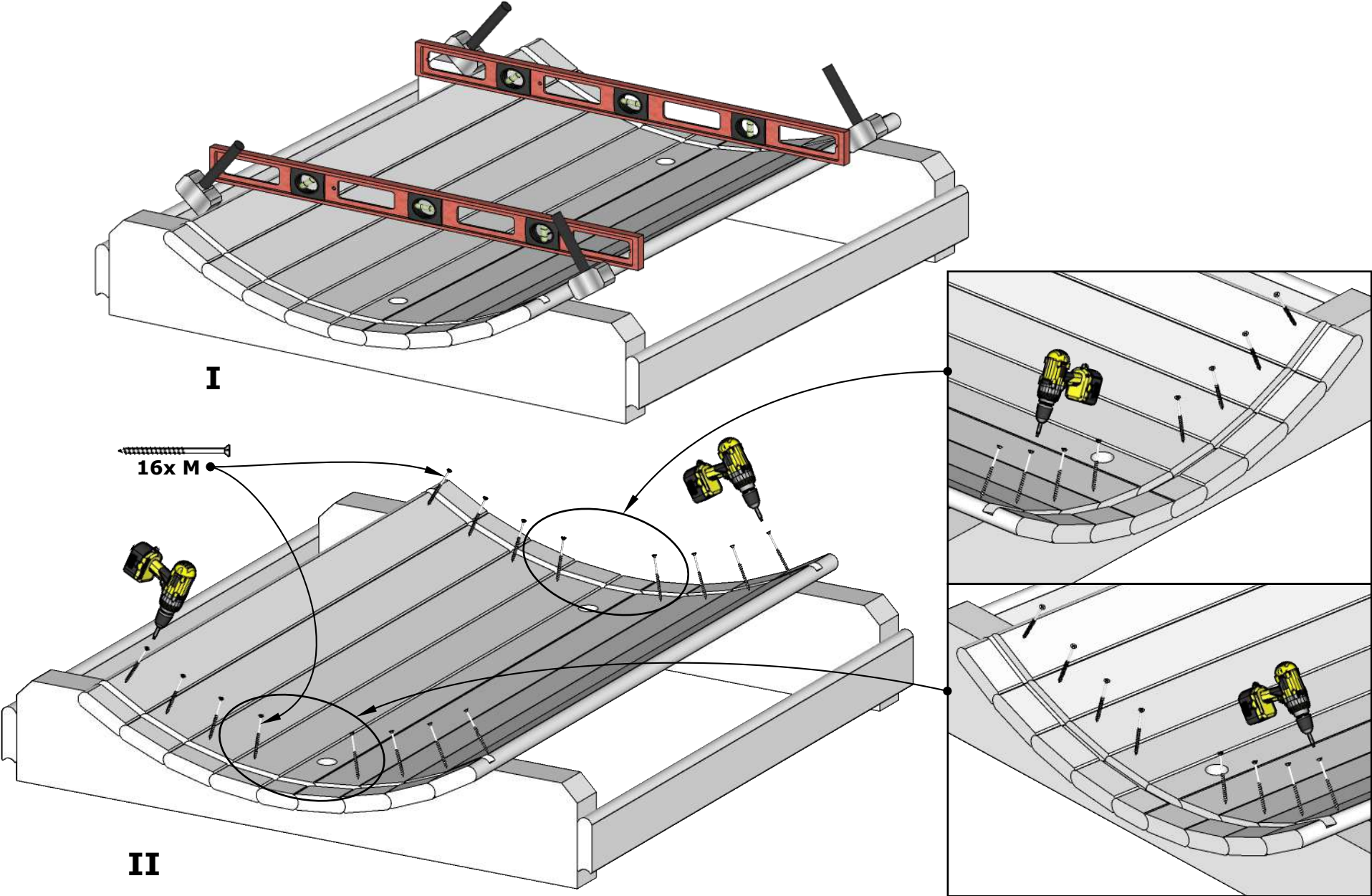

E7W Barrel Sauna 71D" x 81H"

Drill 4 holes Ø1/2"  
through DET 2  
outside

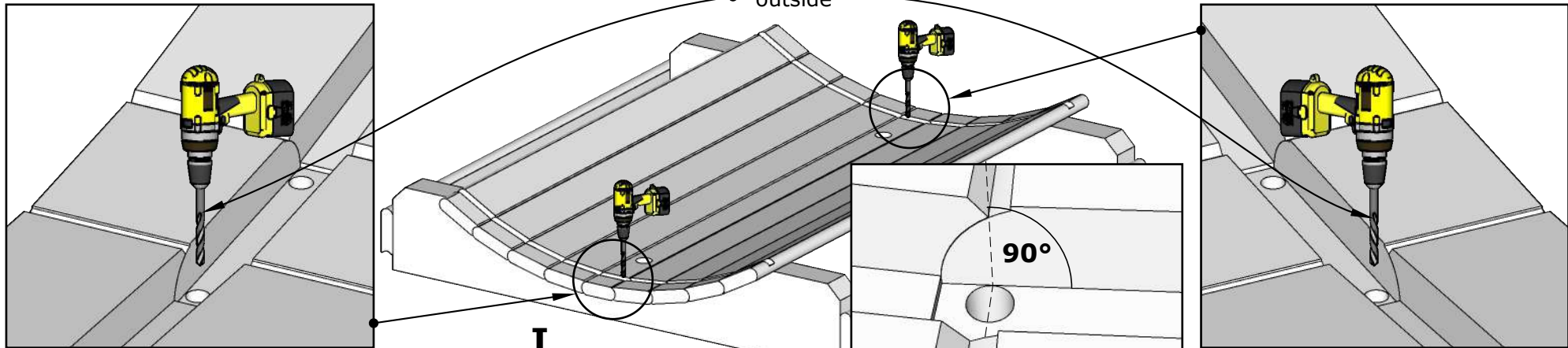

I

Check walls installation  
manual on extra pages!

Sauna wall configuration  
depends on Your model!

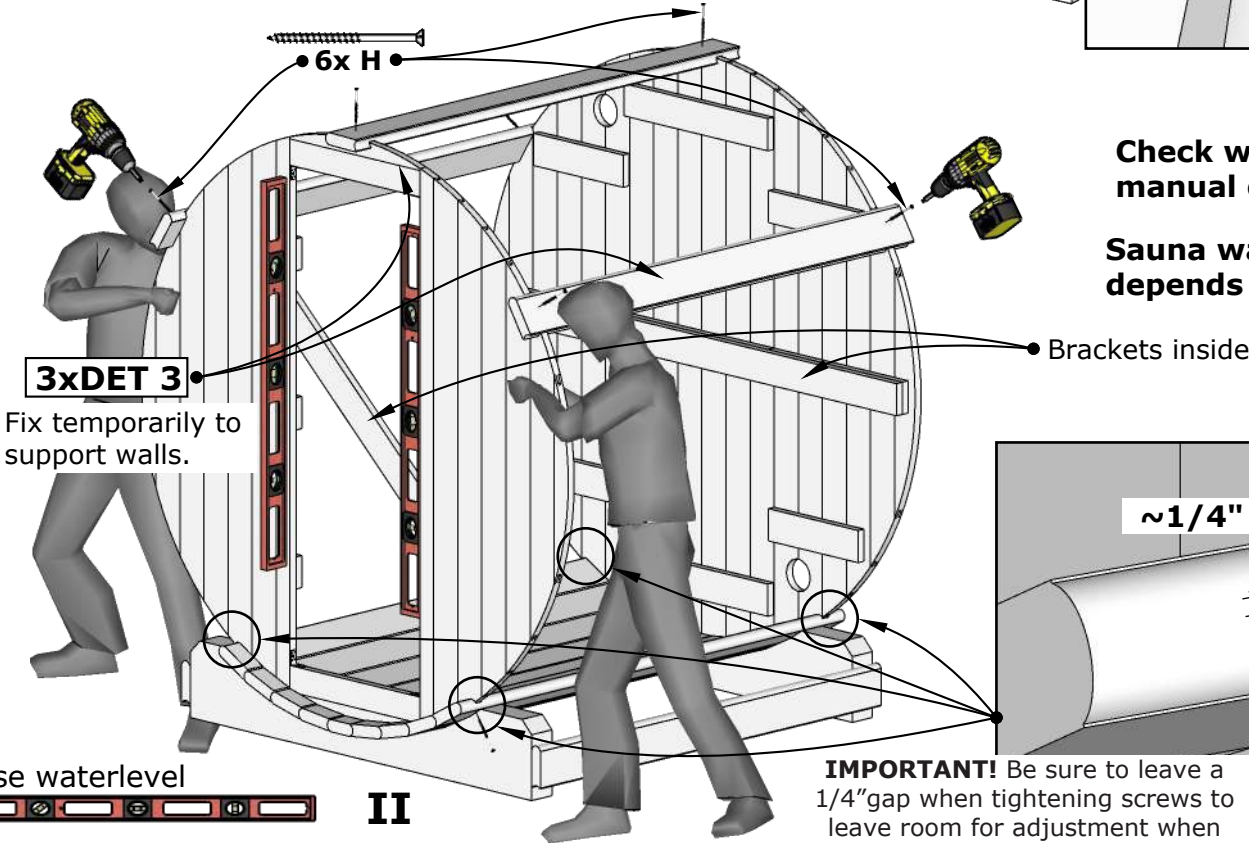

3xDET 3

Fix temporarily to  
support walls.

6x H

Brackets inside

Use waterlevel

II

**IMPORTANT!** Be sure to leave a  
1/4" gap when tightening screws to  
leave room for adjustment when  
the outer bands (B) are installed.

~1/4"

4x H



E7W Barrel Sauna 71D" x 81H"

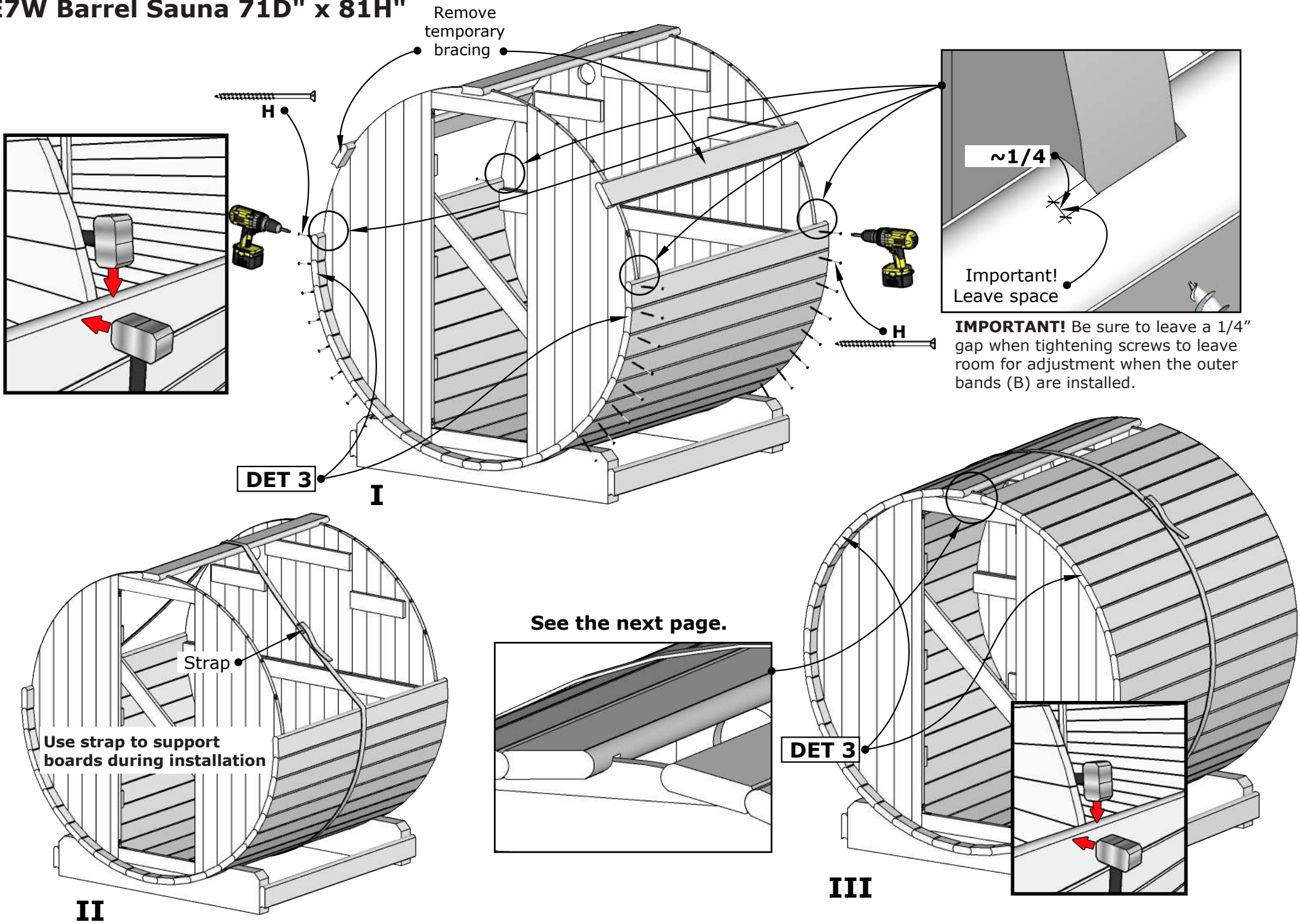

E7W Barrel Sauna 71D" x 81H"

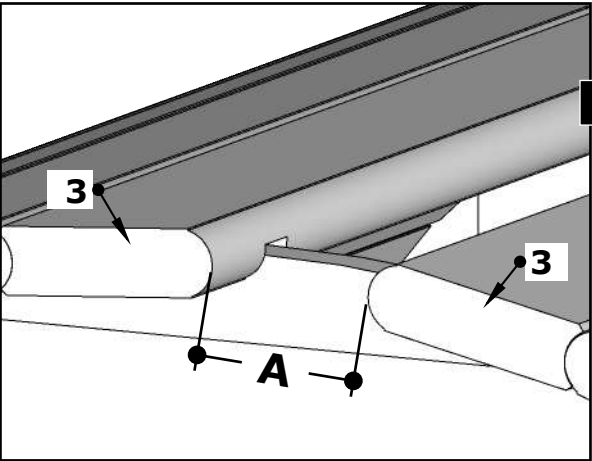

I

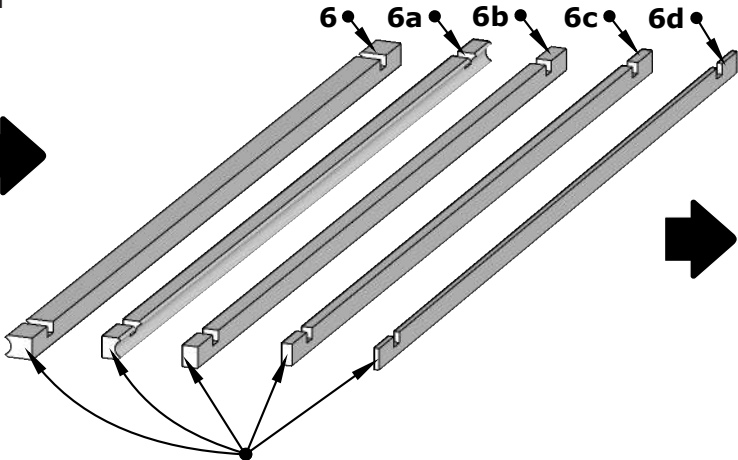

Join two boards together (as shown in diagram II) that will bridge the width of the "A" gap. It is recommended that the combined boards are approximately 1/4" wider than the gap.

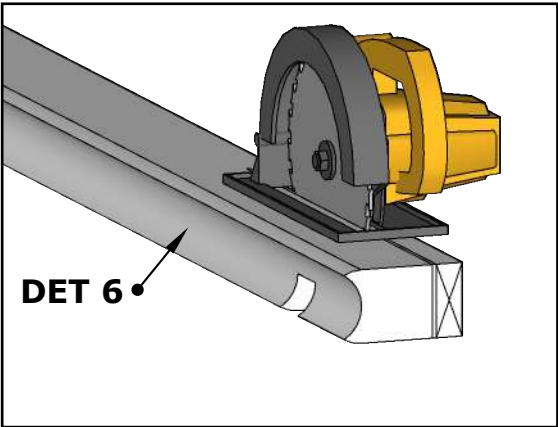

If needed, trim the flat edge of the board to create the desired width.

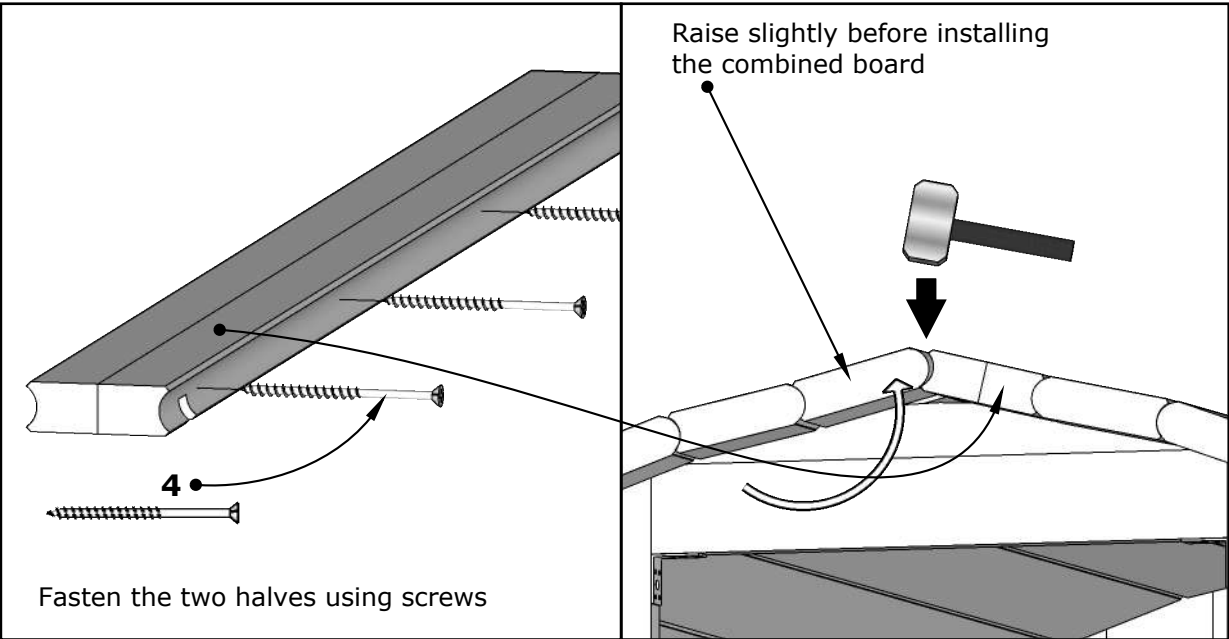

II

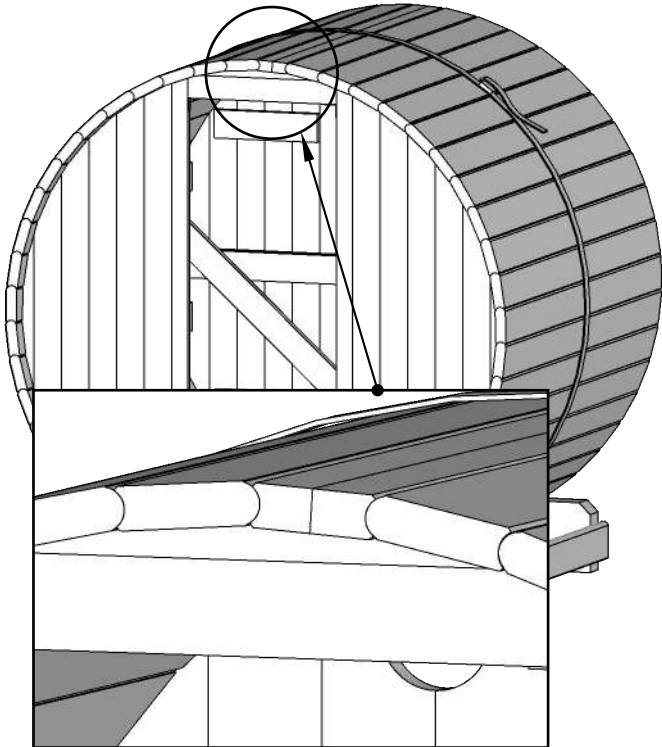

III

E7W Barrel Sauna 71D" x 81H"

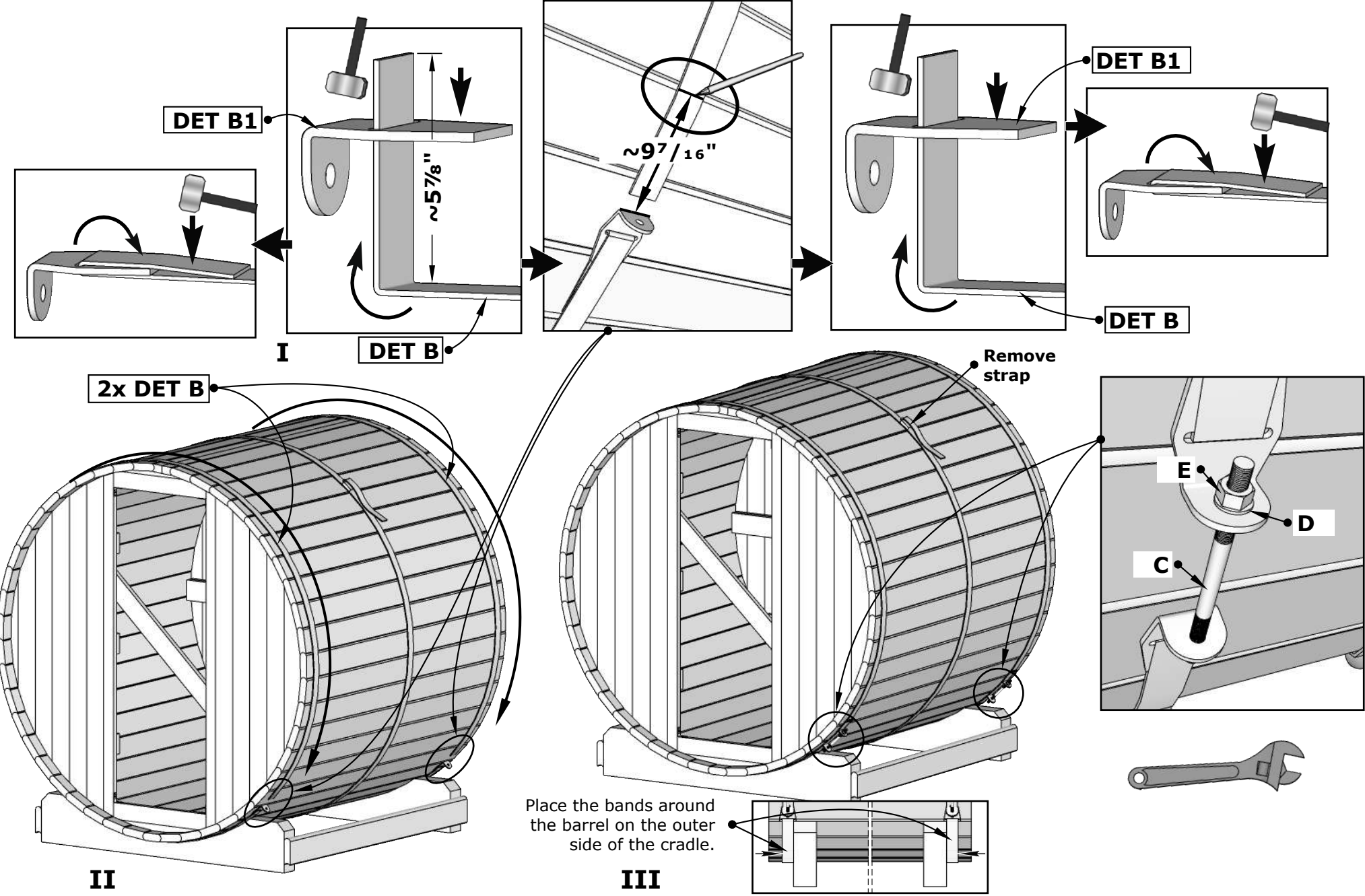



E7W Barrel Sauna 71D" x 81H"

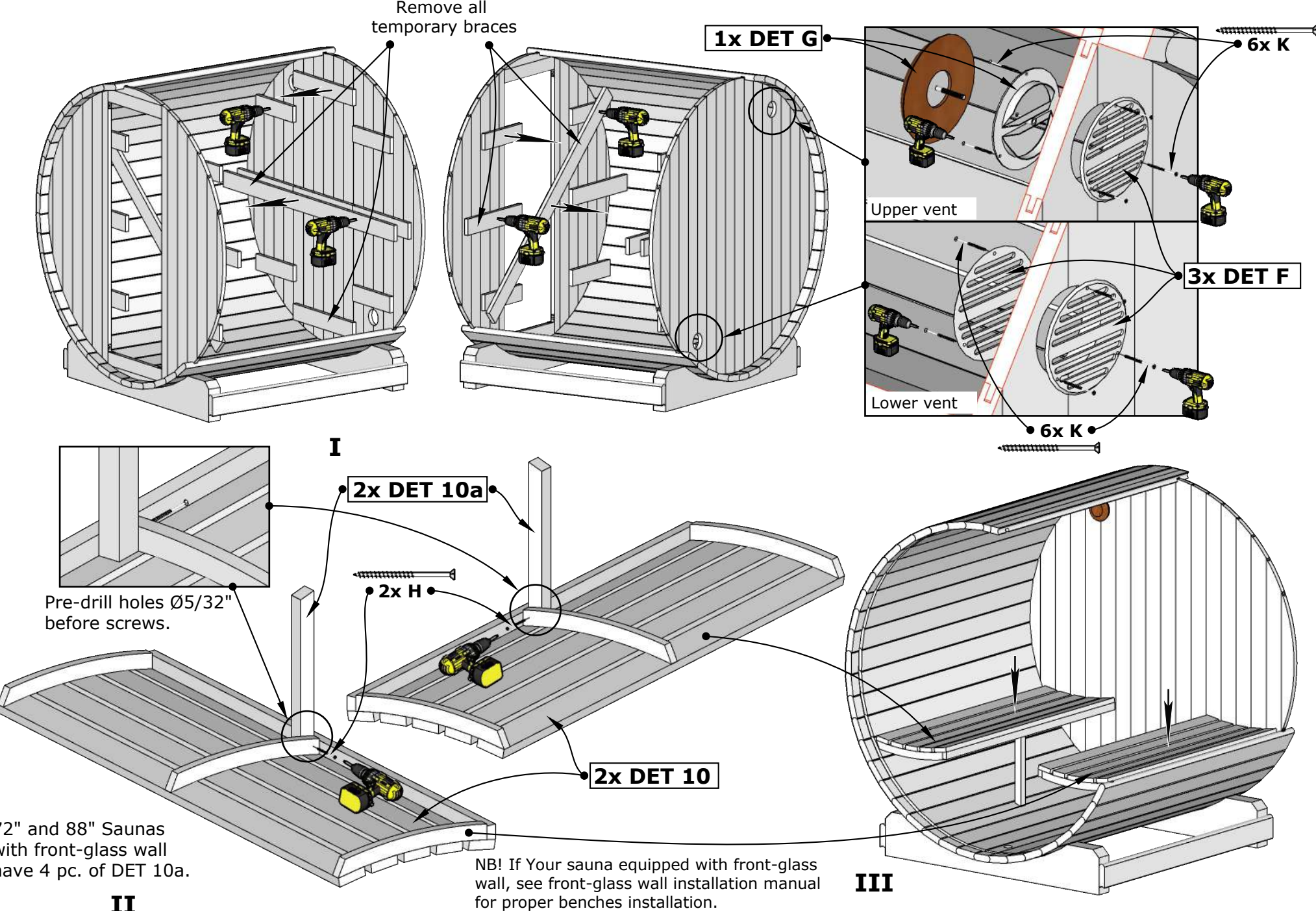

E7W Barrel Sauna 71D" x 81H"

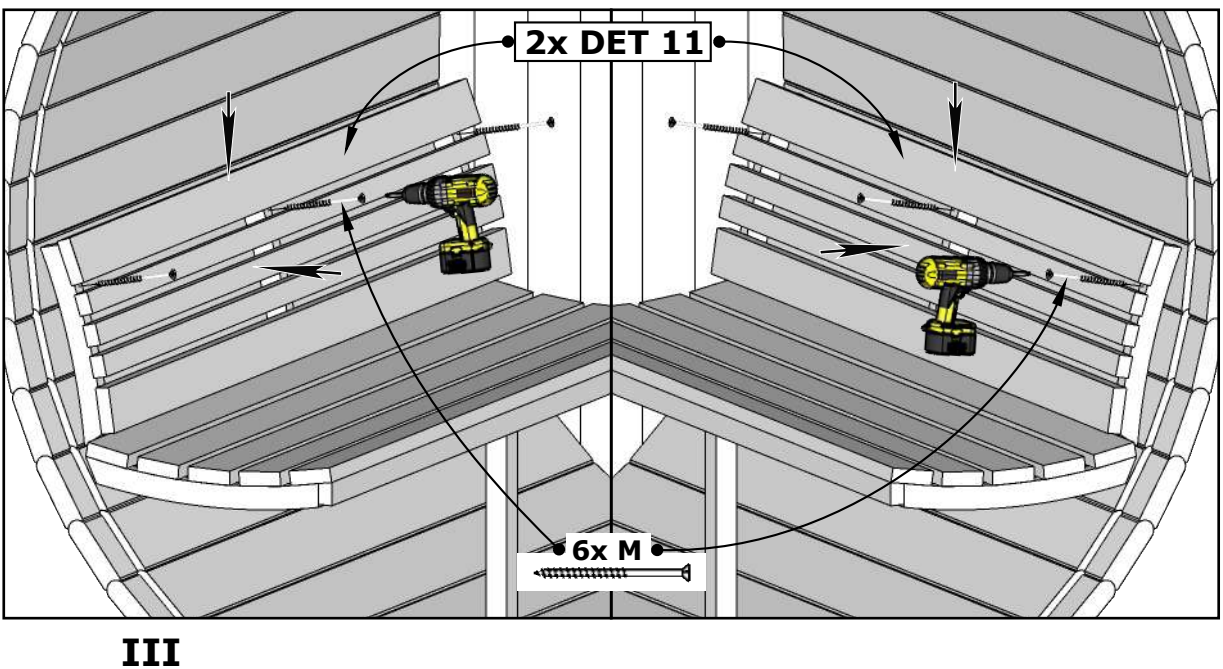
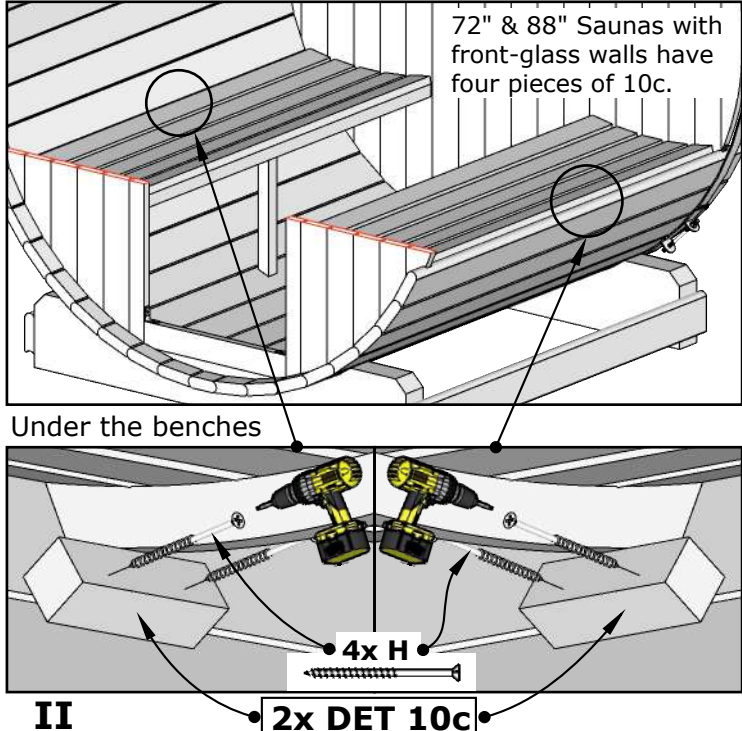
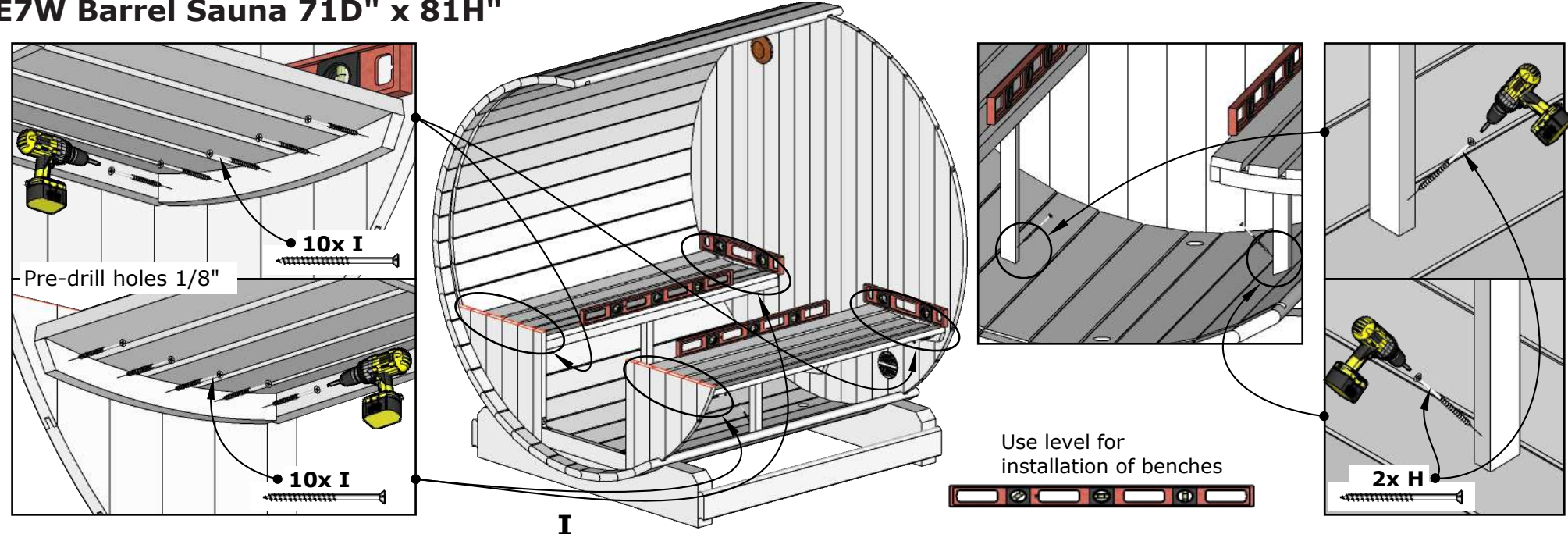



E7W Barrel Sauna 71D" x 81H"

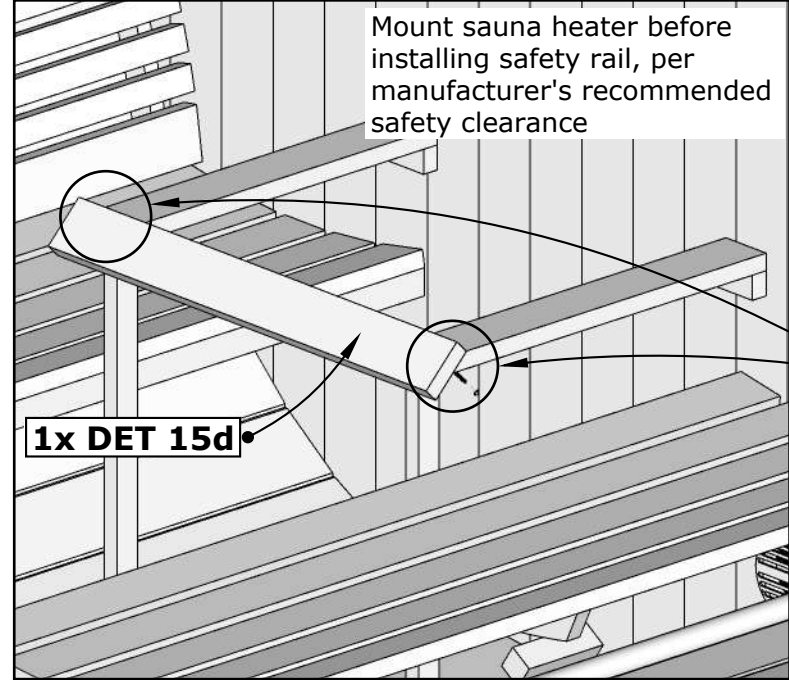
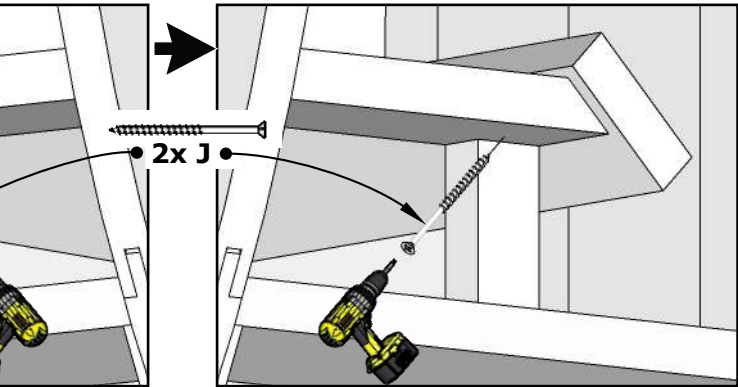
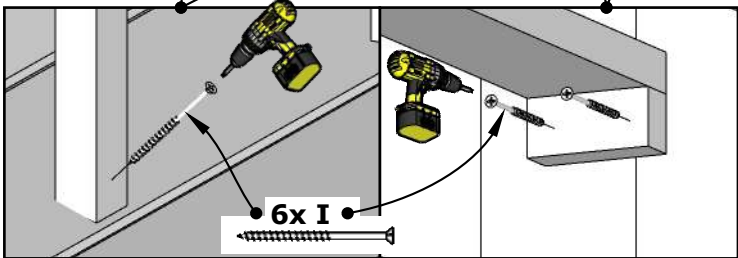
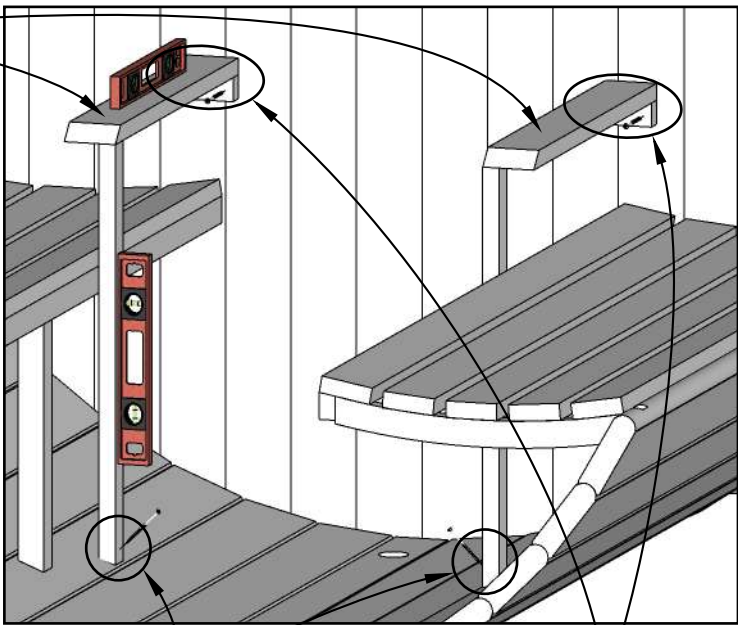
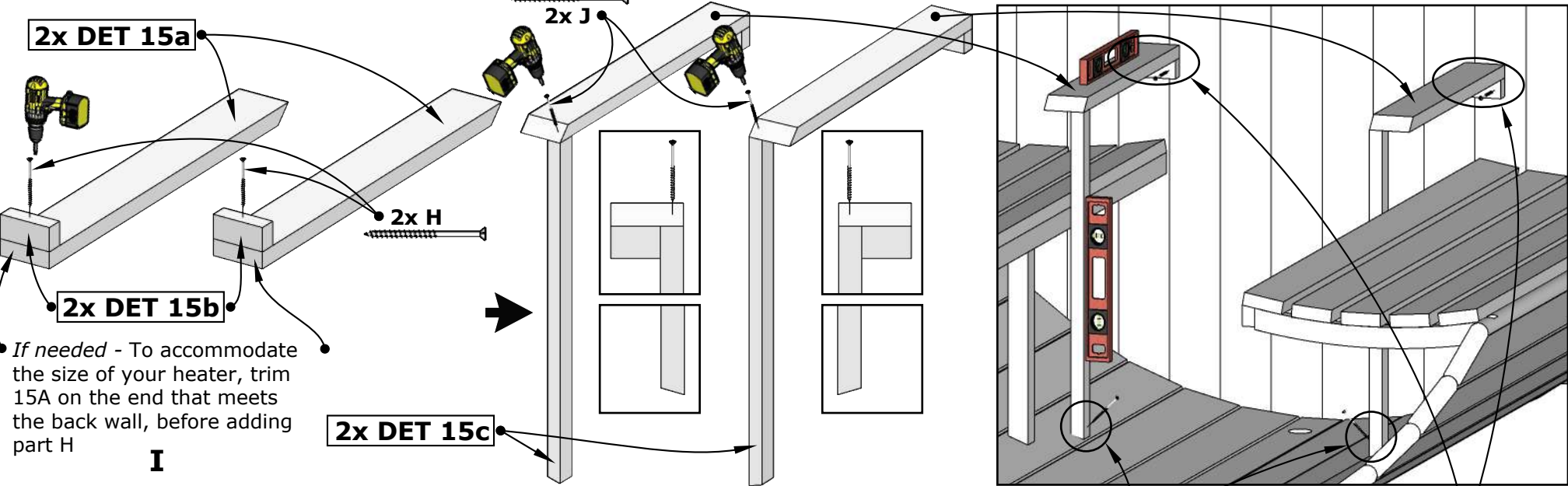



E7W Barrel Sauna 71D" x 81H"

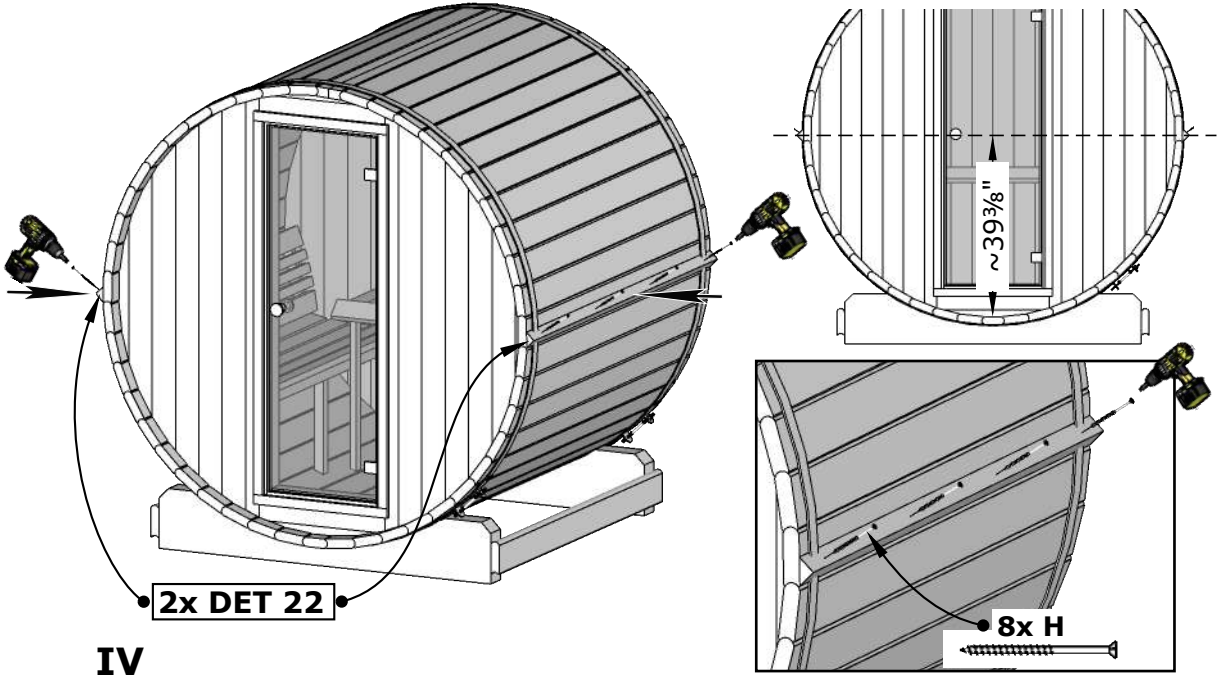
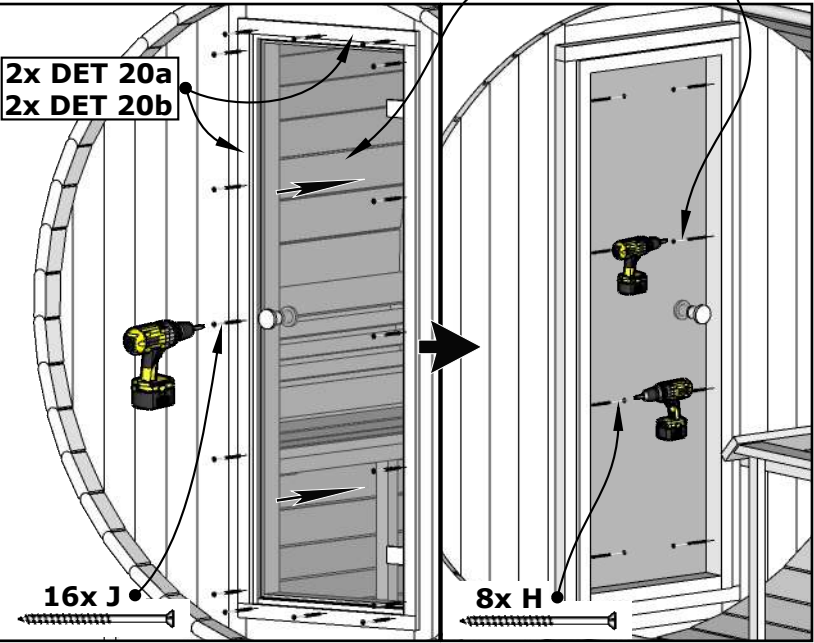
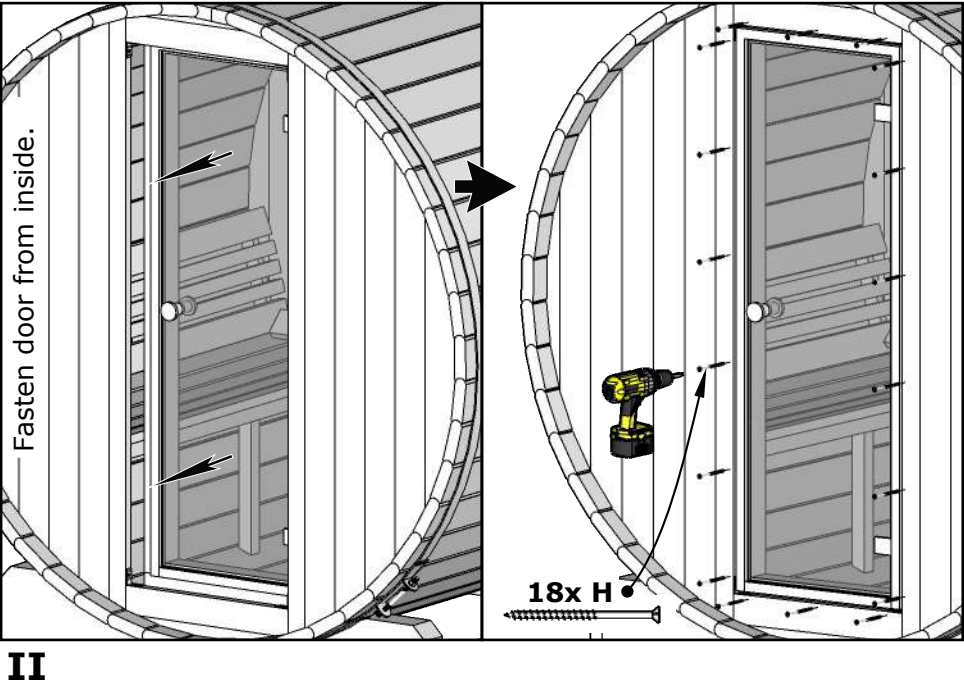
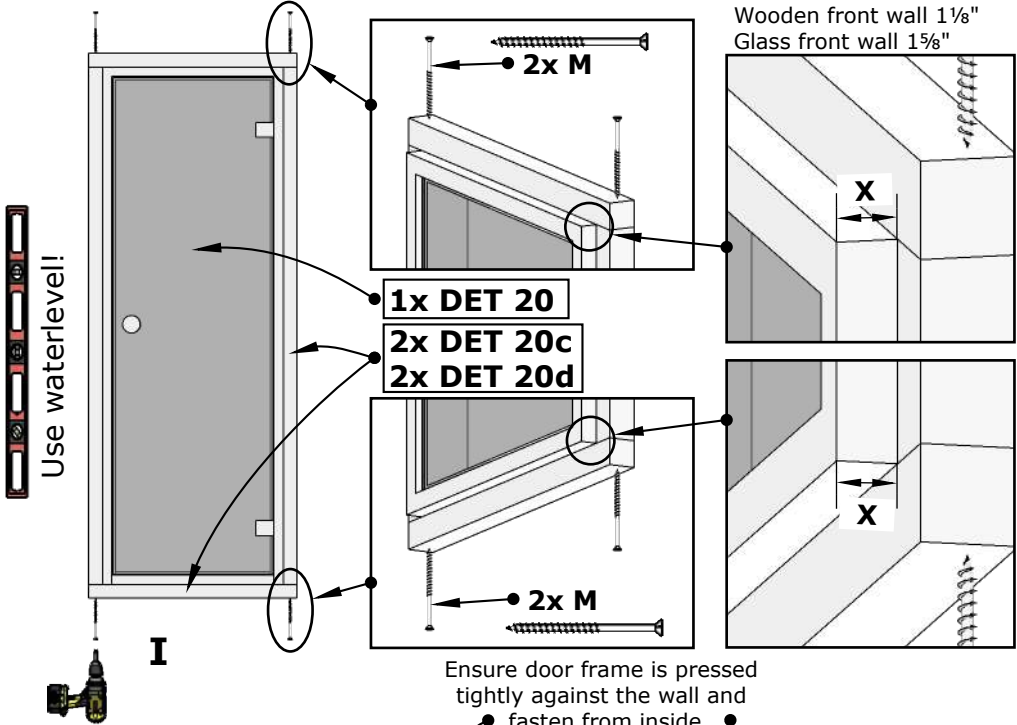

E7W Barrel Sauna 71D" x 81H"

See the installation manual inside the shingles package

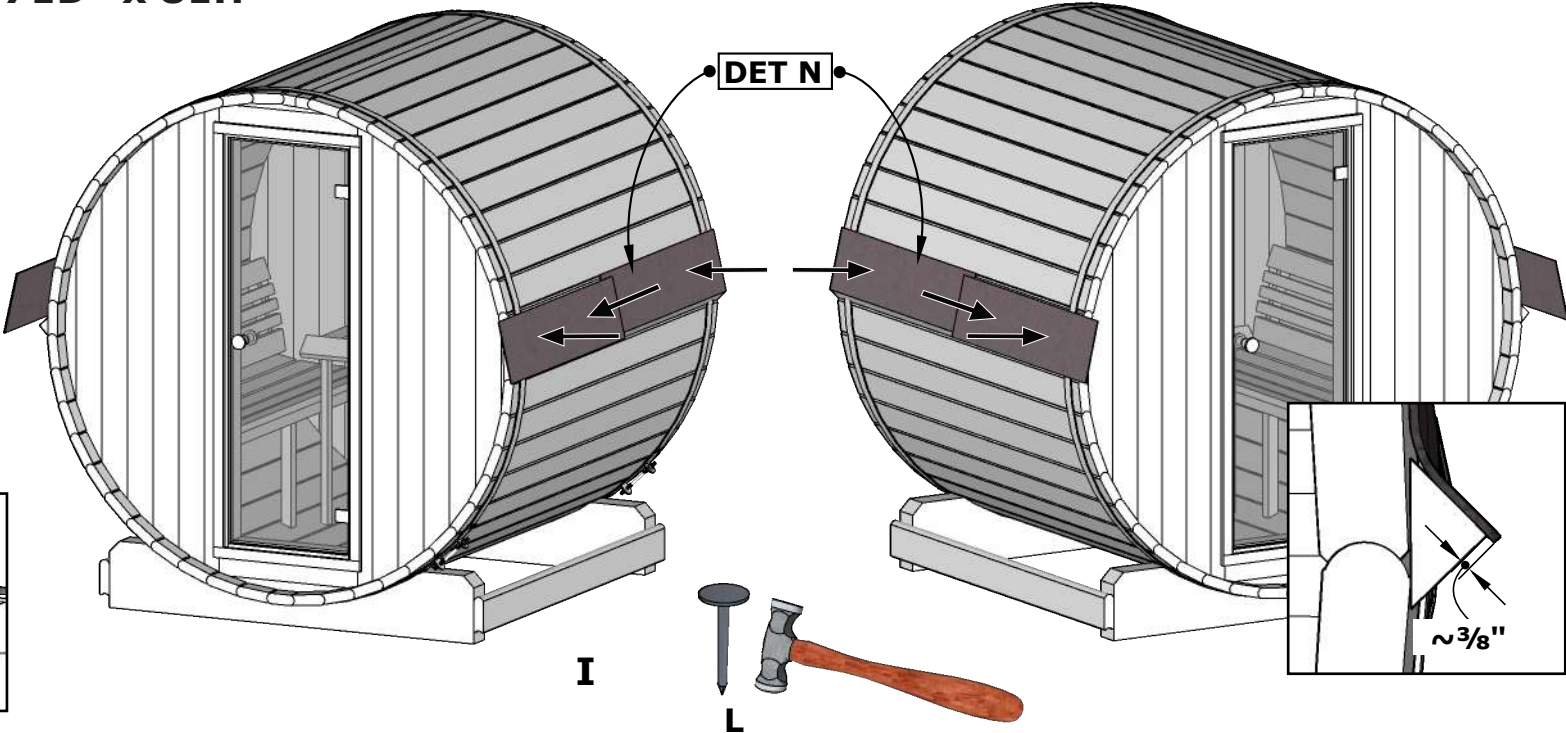

Check also roof shingles installation manual inside package.

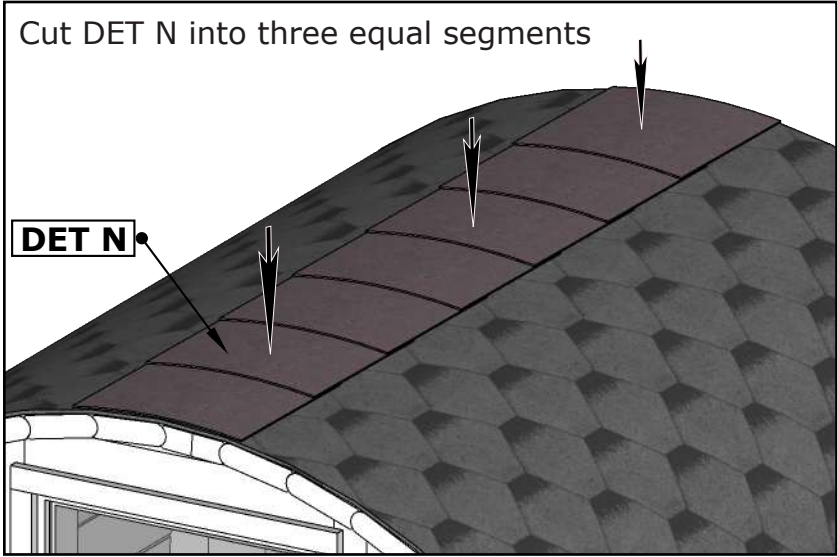
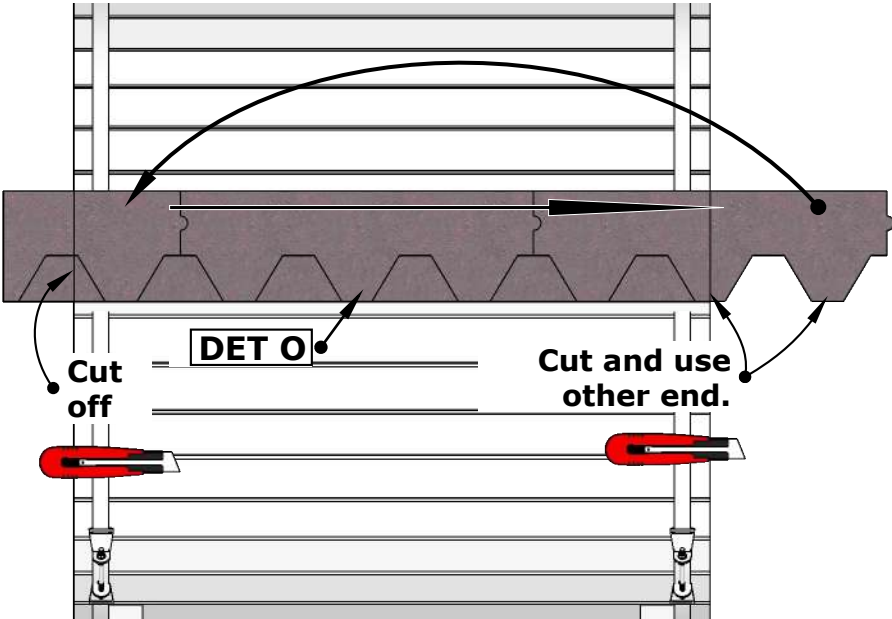

E7W Barrel Sauna 71D" x 81H"

