

# **ECOMAX<sup>®</sup>**

## **INSTRUCTION MANUAL**

### **18V CORDLESS STRING TRIMMER**

*Model: ELG03*

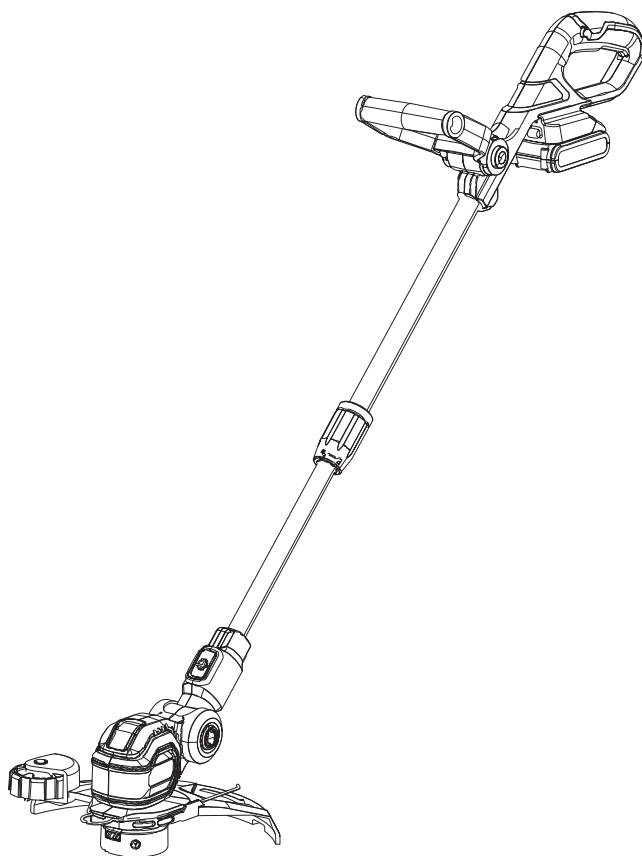

**WARNING:** Read carefully and understand all INSTRUCTIONS before operating. Failure to follow the safety rules and other basic safety precautions may result in serious personal injury. Save this instructions in a safe place and on hand so that they can be read when required.

# CONTENTS

PURPOSE ----- 01

DESCRIPTION OF SYMBOLS ----- 01

SYMBOLS ----- 03

ACCESSORY INFORMATION ----- 03

TECHNICAL DATA ----- 04

COMPONENTS ----- 05

OPERATION ----- 06

CHARGER & BATTERY ----- 14

# PURPOSE

This machine is used to cut grass, light weeds, and other similar vegetation at or around ground level. The cutting plane must be approximately parallel to the ground surface. You cannot use the machine to cut or chop hedges, shrubs, bushes, flowers and compost. flowers and compostflowers and compost

# DESCRIPTION OF SYMBOLS

The rating plate on your tool may show symbols. These represent important information about the product or instructions on its use.



Read and understand all instructions before operating the product, and follow all warnings and safety instructions.



Precautions that involve your safety.



Always wear eye protection with side shields marked to comply with ANSI Z87.1 when operating this equipment



Thrown objects can ricochet and result in personal injury or property damage. Wear protective clothing and boots.



Wear non-slip, heavy duty gloves.



Wear safety footwear.



Beware of blade thrust.



Thrown objects can ricochet and result in personal injury or property damage. Wear protective clothing and boots.



Do not use saw blades.



Do not expose the product to rain or moist conditions.



Keep all bystanders at least 50 feet away.



Batteries may enter water cycle if disposed improperly, which can be hazardous for ecosystem. Do not dispose of waste batteries as unsorted municipal waste.



Do not burn.



Li-ion battery. This product has been marked with a symbol relating to 'separate collection' for all battery packs and battery pack. It will then be recycled or dismantled in order to reduce the impact on the environment. Battery packs can be hazardous for the environment and for human health since they contain hazardous substances.



Positive terminal.



Negative terminal.



Thrown objects can ricochet and result in personal injury or property damage. Wear protective clothing and boots.

# SYMBOLS

The label on your tool may include the following symbols. The symbols and their definitions are as follows.

V	Voltage
A	Ampere( Current)
W	Watt(Power)
min	Time
/min	Revolutions/minimum
≡	Direct current
HZ	Hertz
~	Alternating current
Kg	Kilograms
n.	No load speed
mm	Millimetres
dB	Decibel
°C	Degrees centigrade
Li-ion	Lithium ions
Wh	Watt-hours

# ACCESSORY INFORMATION

Battery pack	1pcs 2.0Ah Li-ion battery
Charger	1pcs quick charger
Accessories	2pcs replacement spool

We recommend that you purchase your accessories from the same store that sold you the tool. Refer to the accessory packaging for further details. Store personnel can assist you and offer advice.

# TECHNICAL DATA

Voltage	18V DC
No load speed	7500±10%min <sup>-1</sup>
Cutting line diameter	0.06inch( Φ1.6mm )
Cutting path diameter	12inch( Φ300mm )
Weight (without battery pack)	3.68lbs( 1.67Kg )



**WARNING!** Read all safety warnings and all instructions.

Failure to follow the warnings and instructions may result in electric shock, fire and/or serious injury. Save all warnings and instructions for future reference.

The term "power tool" in the warnings refers to your mainsoperated(corded) power tool or battery-operated (cordless) power tool.

# COMPONENTS

- ❶ Switch button
- ❷ Safety lock button Guard
- ❸ Rear handle shell
- ❹ The auxiliary handle rotates the button
- ❺ Auxiliary handle
- ❻ Battery pack
- ❼ Aluminum tube(top)
- ❽ Aluminum tube lock turn knob
- ❾ Aluminum tube( bottom)
- ❿ Work head rotation button
- ⓫ Work head shell
- ⓬ A wire frame for protecting flowers
- ⓭ Guard cover
- ⓮ Cutting head assembly

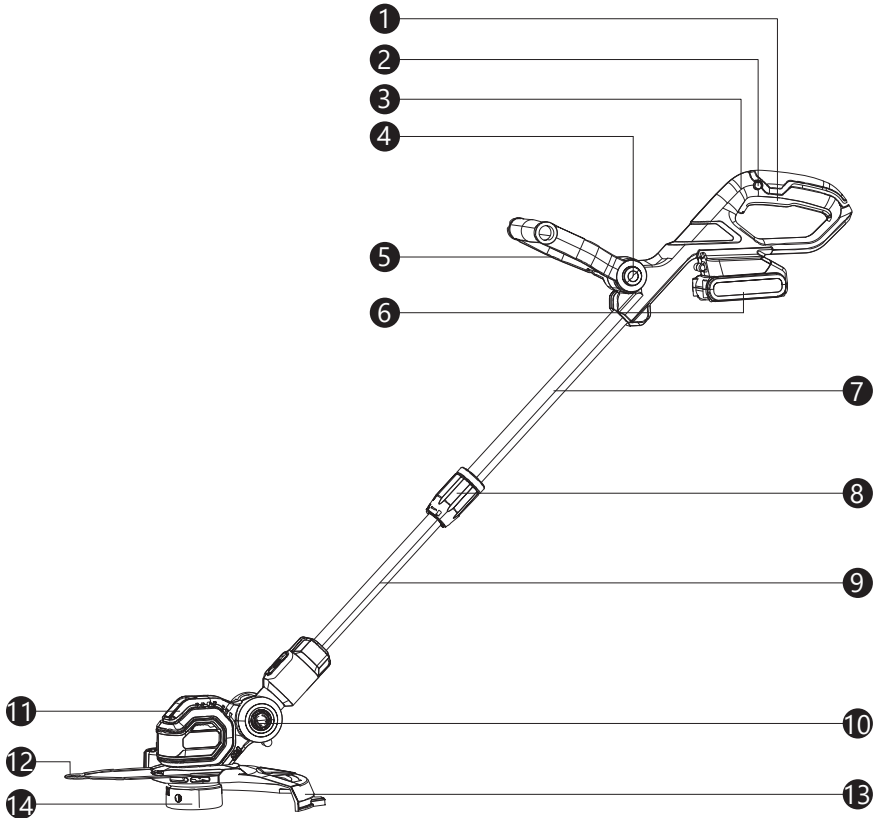

# OPERATION

**⚠ WARNING!** Before any replacements, switch the tool off, wait for it to come to a standstill, and take the battery out of the tool.

**⚠ WARNING!** It is not necessary to assemble the machine.

## 1. ATTACH THE GUARD

**⚠ WARNING!** Do not touch the cut-off blade.

1). As shown in Figure 1, first install the steel wire frame for protecting flowers and guard cover on the working head shell.

2). Tighten the screws as shown in Figure 2.

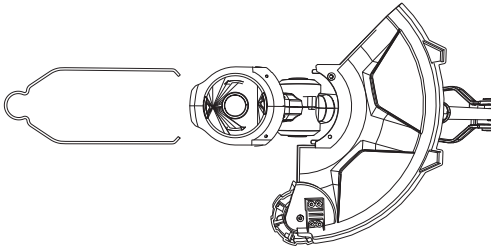

( Figure 1 )

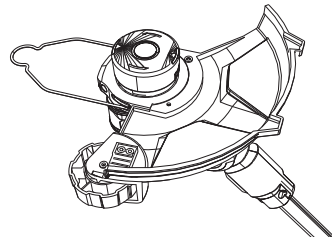

( Figure 2 )

## 2. ATTACH THE AUXILIARY HANDLE

1). Install the auxiliary handle onto the machine as shown in Figure 3.

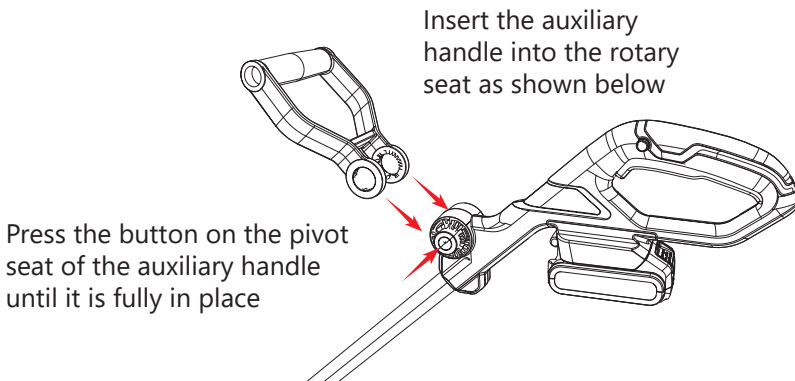

( Figure 3 )



### 3. INSTALL THE BATTERY PACK

- 1). Align the lift ribs on the battery pack with the grooves in the battery compartment.
- 2). Push the battery pack into the battery compartment until the battery pack locks into place.
- 3). When you hear a click, the battery pack is installed.

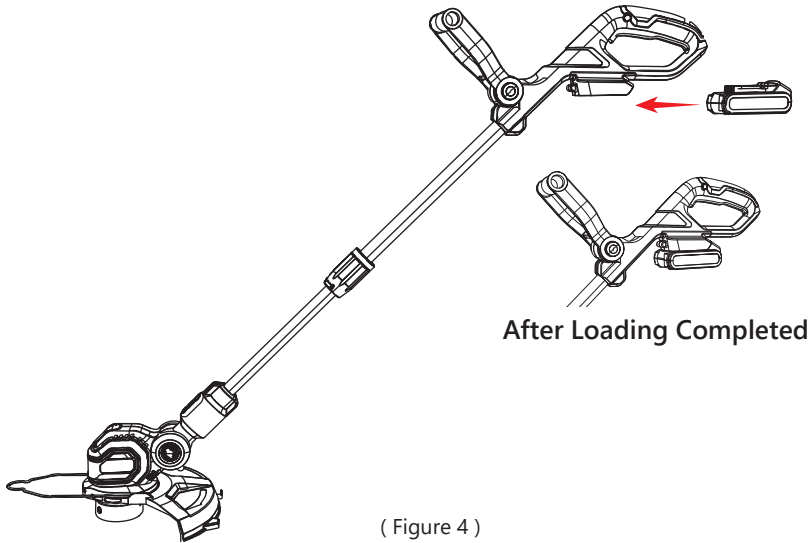

- ⚠ **WARNING!** If the battery pack or charger is damaged, replace the battery pack or the charger.
- ⚠ **WARNING!** Stop the machine and wait until the motor stops before you install or remove the battery pack
- ⚠ **WARNING!** Read and understand the instructions in the battery and charger manual.

### 4. REMOVE THE BATTERY PACK

- 1). Push and hold the battery release button.
- 2). Remove the battery pack from the machine.

## 5. CONTROLS

1). As shown in Figure the left hand operates the auxiliary handle "4" and the right hand controls the rear handle "3".

**⚠ WARNING!** Do not keep your finger on the button when you move the machine to prevent accidental start.

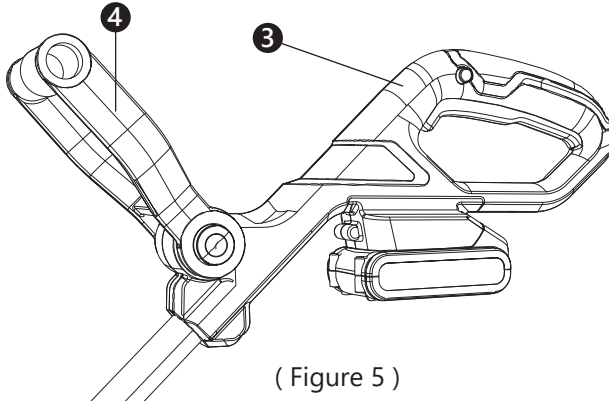

( Figure 5 )

## 6. START THE MACHINE

1). Pull the safety button "1" in Figure 6.

2). Pull the switch button "2" in Figure 6.

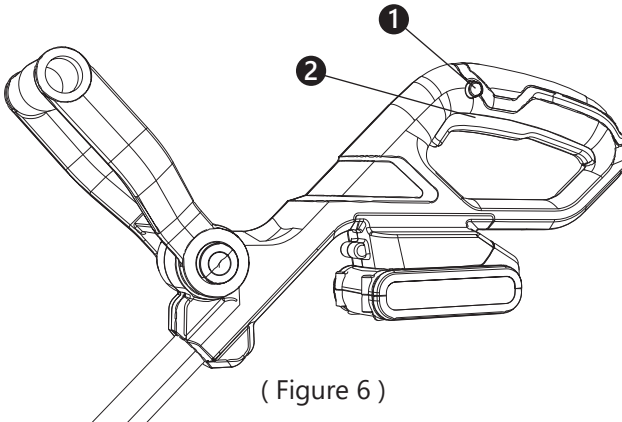

( Figure 6 )

**⚠ WARNING!** Hold the machine with hands during operation.

## 7. STOP THE MACHINE

Release the switch button 2 in Figure 6.

## 8. OPERATION TIPS

**⚠ WARNING!** Keep clearance between the body and the machine.

**⚠ WARNING!** Keep clearance between the body and the machine.

Do these tips when you use the machine:

- Keep the machine connected to the correctly worn harness
- Keep a firm hold with the two hands on the machine while you operate the machine
- Cut tall grass from the top down

If grass winds around the trimmer head:

- Remove the battery pack
- Remove the grass

## 9. LINE CUT-OFF BLADE

This trimmer is equipped with a line cut-off blade (Figure 7) on the guard. The line cut off blade continuously trims the line to ensure a consistent and efficient cut diameter. Advance line whenever you hear the engine running faster than normal, or when trimming efficiency diminishes. This will maintain best performance and keep line long enough to advance properly.

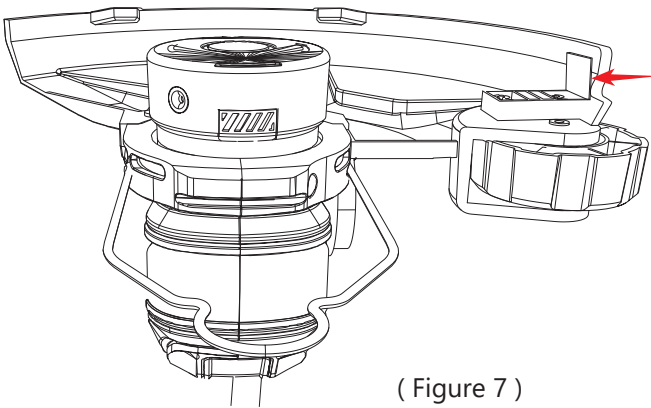

( Figure 7 )

## 10. CUTTING TIPS

- Tilt the machine toward the area to be cut. Use the tip of the cutting line to cut grass, as shown in figure 9
- Move the machine from right to left to prevent thrown debris toward the operator
- Do not cut in the dangerous area
- Do not force the trimmer head into uncut grass
- Wire and picket fences cause cutting line wear and breakage. Stone and brick walls, curbs, and wood can wear the cutting line quickly
- The cutting Angle of the cutting head can be adjusted according to the actual cutting requirements. The cutting Angle can be adjusted from 0-22.5-45-67.5-90, as shown in figure 9

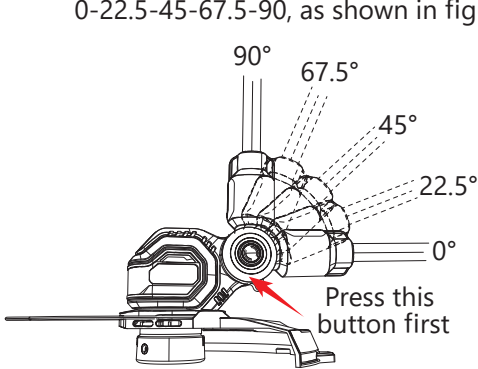

( Figure 8 )

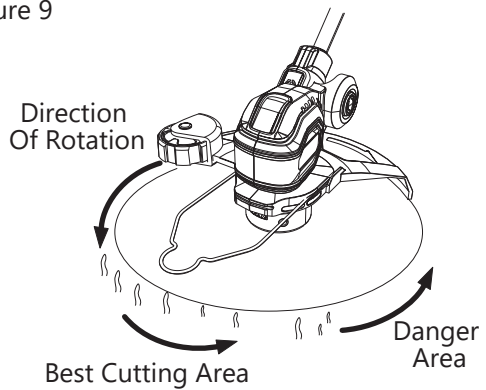

( Figure 9 )

## 11. TRIMMER EDGES

**⚠ WARNING! Risk of injury!** When using e cutting head upright, particular care should be taken. Always maintain sufficient distance to the cutting head.

NOTE: Risk of damage to the unit! Avoid contact with solid surfaces to prevent rapid wear of the thread.

NOTE: The heel assembly only serves for easier guidance when trimming edges. It should not be used for brush cutting and no influence on the cutting height.

- Remove the battery pack from the lawn trimmer.
- Press the work head rotation button in the figure 10. Rotate to 0°.
- Press the work head rotation button in the Figure 10, Rotate the Aluminum tube 90°.
- Once the adjustment is complete, as shown in Figure 11 you can edge trimming.

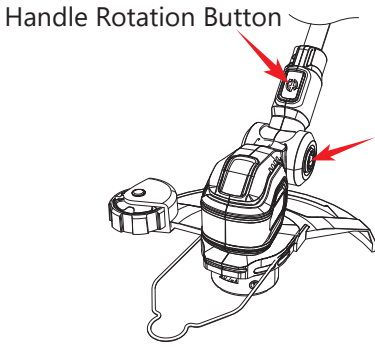

( Figure 10 )

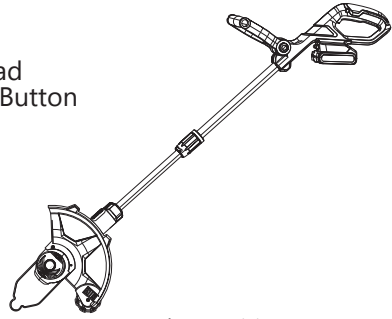

( Figure 11 )

## 12. REPLACING THE SPOOL

**⚠ WARNING!** Risk of injury! When using the cutting head upright, particular care should be taken. Always maintain sufficient distance to the cutting head.

- a. Press the locking clips(A)in.
- b. Remove the cover(B).
- c. Pull out the cord spool.
- d. Feed the thread in the opening(C)of the spool housing.
- e. Press the thread spool into the spool housing. Pull the thread out through the opening(C).
- f. Mount the cover (B)and allow to engage.

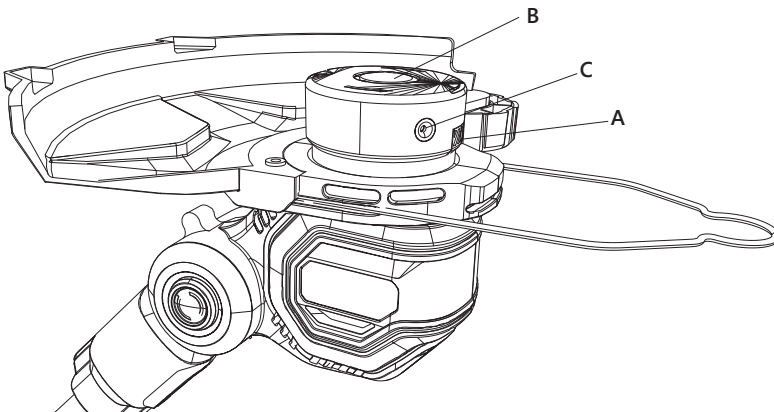

( Figure 12 )

### 13. AUXILIARY HANDLE ANGLE ADJUSTMENT

Press the auxiliary handle rotation button in Figure 13 below. Turn the auxiliary handle to the Angle you want.

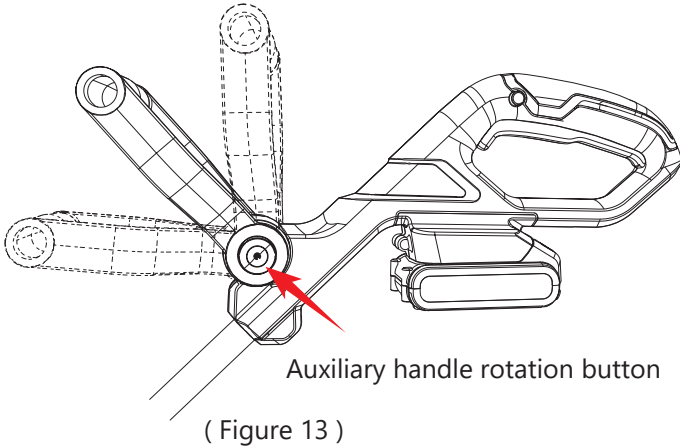

### 14. TELESCOPIC ALUMINIUM TUBE

- a). Turn the aluminum tube lock knob shown in Figure 14 counterclockwise, then lengthen or shorten the aluminum tube to the desired length.
- b). After the length is adjusted, turn the aluminum tube lock knob clockwise until the aluminum tube is completely locked.

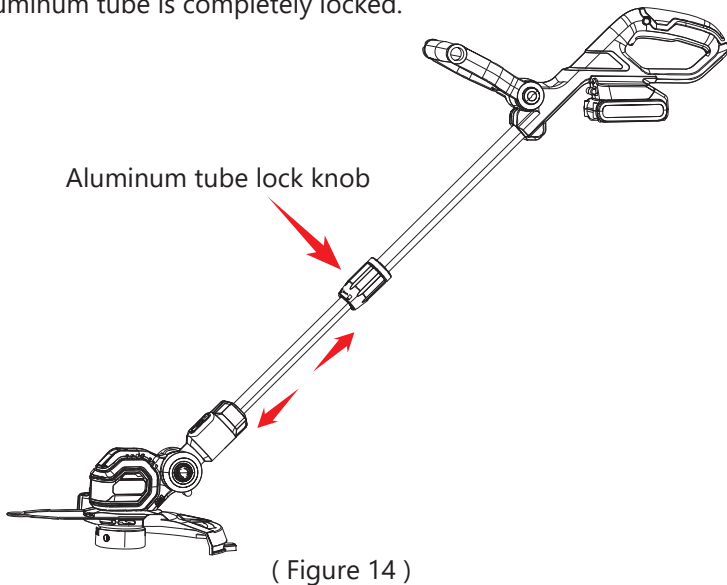

## 15. MAINTENANCE

- ⚠ **CAUTION!** Do not let brake fluids, gasoline, petroleum-based materials touch the plastic parts. Chemicals can cause damage to the plastic, and make the plastic unserviceable.
- ⚠ **CAUTION!** Do not use strong solvents or detergents on the plastic housing or components.
- ⚠ **WARNING!** Remove the battery pack from the machine before maintenance.

## 16. CLEAN THE MACHINE

- ⚠ **WARNING!** Keep the machine and the motor free of leaves, branches or excessive oil to prevent fire risks.
- Clean the machine after use with a moist cloth dipped in neutral detergent.
- Do not use aggressive detergents or solvents to clean the plastic parts or handles.
- Keep the trimmer head free of grass, leaves, or excessive grease.
- Keep the air vents clean and free of debris to avoid overheating and damage to the motor or the battery.
- Do not spray water onto the motor and electrical components.

## 17. OVERLOAD PROTECTION

When overloaded, the motor comes to a stop. Relieve the load on the machine immediately and allow cooling for approx. 30 seconds.

## 18. TEMPERATURE DEPENDENT OVERLOAD PROTECTION

When using as intended the power tool cannot be subject to overload. When the load is too high or the allowable battery temperature of 75 C is exceeded, the electronic control switches off the power tool until the temperature is in the optimum temperature range again.

## 19. PROTECTION CONTRE LES DECHARGES PROFONDES

The Li-ion battery is protected against deep discharging by the "Discharging Protection System". When the battery is empty, the machine is switched off by means of a protective circuit:

The inserted tool no longer start.

# CHARGER & BATTERY

## CHARGING THE BATTERY

### 1. REMOVING THE BATTERY

If the Battery does not slide into the charger easily, do not force it. Instead, slide the Battery out of the charger again, check the top of Battery and the tool battery slot are clean and undamaged and that the contacts are not bent.

Setting up the battery charger.

- 1). If fitted, remove any Battery(B)from the Battery Charger(A).
- 2).Insert the Battery Charger mains plug into a suitable mains socket.

**WARNING!** Use this charger only to charge the supplied battery or additional purchased batteries that are specifically distance to the cutting head designed for this tool.

**WARNING!** The charger is designed for indoor use only, and must not be used in damp or wet conditions.

### 2. PUT IN THE BATTERY TO CHARGER

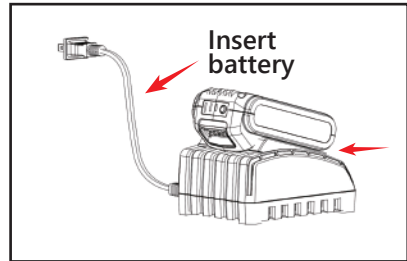
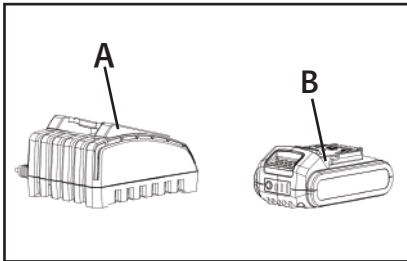

**WARNING!** Failure to follow the correct procedure when charging batteries will result in permanent damage.

**Note:** Normal charging time is approximately 70 minutes for a recently discharged 2.0Ah capacity battery. However, if the Battery has been left in a discharged state for some time, it may take additional time to charge.

LED indicate			
Nummer	Charger status	LED status	
		Red light	Green light
	Charging	ON	OFF
	Finished charging	OFF	ON
	Battery failure	OFF	OFF

Remark battery operating temperature  $0\pm 3^{\circ}\text{C} < T < 50\pm 3^{\circ}\text{C}$



## **NOTE: ABOUT BATTERY CHARGING:**

- 01) The battery should be charged at ambient temperatures between 10 and 40°C. (ideally around 20°C).
- 02) After discharging the battery, please wait 10 minutes for the battery to cool down before charging.
- 03) After charging, allow 15 minutes for the battery to cool before use.
- 04) Ensure that the charger is disconnected from the mains supply after use, and is stored correctly.
- 05) Do not leave batteries on charge for extended periods and never store batteries on charging.
- 06) The Battery Charger monitors battery temperature and voltage while charging. Remove the battery once charging is complete to maximise charge cycles of the battery and not waste power.
- 07) Batteries can become faulty over time, individual cells in the battery can fail and the battery could short. The charger will not charge faulty batteries. Use another battery if possible, to check correct functionality of the charger and purchase a replacement battery if a faulty battery is indicated.
- 08) Do not store lithium-ion battery packs in a discharged state over a long period as this can damage the lithium-ion cells.
- 09) For long-term storage, store batteries in a high charge state disconnected.
- 10) The capacity of batteries will reduce over time. After 100 charge cycles, the battery's operation time and the maximum torque performance of the driver will slightly reduce. This decline will continue until the battery has minimal capacity after 250 charge cycles. This is normal and not a fault with the battery pack.
- 11) When battery pack is not in use, keep it away from other metal objects, like paper clips, coins, keys, nails, screws or other small metal objects, that can make a connection from one terminal to another. Shorting the battery terminals together may cause burns or a fire.
- 12) Under abusive conditions liquid may be ejected from the battery; avoid contact. If contact accidentally occurs, flush with water. If liquid contacts eyes, additionally seek medical help. Liquid ejected from the battery may cause irritation or burns.
- 13) If the tool will not be used for long periods of time, charge the battery every 3-6 months.

## ADDITIONAL SAFETY INSTRUCTIONS FOR YOUR BATTERY CHARGER

01. Before charging, read the instructions.
02. For charging Li-ion battery packs only.
03. If the supply cord is damaged, it must be replaced by the manufacturer, its service agent or similarly qualified persons in order to avoid a hazard.
04. After charging, disconnect the battery charger from the supply mains. Then remove the chassis connection and then the battery connection.
05. Do not charge a leaking battery.
06. Do not use chargers for work other than those for which they are designed.
07. Before charging ensure your charger matches the local AC supply.
08. The charging device must be protected from moisture.
09. Do not use the charging device in the open.
10. Do not short out the contacts of battery or charger.
11. Respect the polarity "+/-" when charging.
12. Do not open the unit and keep out of the reach of children.
13. Do not charge the batteries of other manufactures or ill-suited models.
14. Ensure that the connection between the battery charger and battery is correctly positioned and is not obstructed by foreign bodies.
15. Keep battery chargers slots free of foreign objects and protect against dirt and humidity. Store in a dry and frost-free place.
16. When charging batteries, ensure that the battery charger is in a well-ventilated area and away from inflammable materials. Batteries can get hot during charging. Do not overcharge any batteries. Ensure that batteries and chargers are not left unsupervised during charging.
17. Do not recharge non-rechargeable batteries, as they can overheat and break.
18. Charge only battery pack of the same model provided by ECOMAX and of models recommended by ECOMAX.

## TRANSPORTATION AND STORAGE

 **WARNING!** Remove the battery pack from the machine before transportation and storage.

## STORE THE MACHINE

- Clean the machine before storage.
- Make sure that the motor is not hot when you store the machine.
- Make sure that the machine does not have loose or damaged parts. If it is necessary, do these steps.

## INSTRUCTIONS

- Replace the damaged parts.
- Tighten the bolts.
- Speak to a person of an approved service center.
- Store the machine in a dry area.
- Make sure that children cannot come near the machine.

## THE RECOMMENDED AMBIENT TEMPERATURE RANGE:

Item	Temperature
String trimmer storage temperature range	-4°F(-20°C) - 158°F(70°C)
String trimmer operation temperature range	-4°F(-20°C) - 104°F(40°C)
Battery charging temperature range	39°F(4°C) - 104°F(40°C)
Charger operation temperature range	39°F(4°C) - 113°F(45°C)
Battery storage temperature range	1 year:32°F(0°C) - 73°F(23°C)
	3 months:32°F(0°C)113°F(45°C)
	1 months:32°F(0°C)140°F(60°C)
Battery discharging temperature range	6.8°F(-14°C) - 113°F(45°C)

## IMPORTANT SAFETY INSTRUCTIONS

READ ALL INSTRUCTIONS BEFORE USING  
(THIS POWER TOOL)

 **WARNING!** Read and understand all instructions before using this product. Failure to follow all instructions listed below may result in electric shock, fire, and/or serious personal injury. When using an electrical appliance, basic precaution should always be followed, including the following:

- Do not use on wet surfaces.
- Do not charge the unit outdoors.
- For household use.
- Do not allow to be used as a toy. Close attention is necessary when used by or near children.

- Use only as described in this manual. Use only manufacturer's recommended attachments.
- If appliance is not working as it should, has been dropped, damaged, left outdoors, or dropped into water, return it to a service center.
- Do not handle appliance with wet hands.
- Do not put any object into openings. Do not use with any opening blocked; keep free of dust, lint, hair, and anything that may reduce air flow.
- Keep hair, loose clothing, fingers and all body parts away from openings and moving parts.
- Use extra care when cleaning on stairs.
- Do not operate power tools in an explosive atmosphere, such as in the presence of flammable liquids, gases, or dust. Power tools create sparks that may ignite the dust or fumes.  
Store indoors. Do not expose to rain or water. Avoid direct sunshine.
- Never allow children to operate the equipment. Never allow adults to operate the equipment without proper instruction.
- Wear heavy long pants, boots, and gloves. Avoid loose garments or jewellery that could get caught in moving parts of the machine or its motor.
- Do not force tool. Use the correct tool for your application. The correct tool will do the job better and safer at the rate for which it is designed.
- Keep firm footing and balance. Do not overreach. Overreaching can result in loss of balance.
- Do not use a tool if the switch does not turn it on or off. Any tool that cannot be controlled with the switch is dangerous and must be repaired.
- Do not operate this unit when you are tired, ill, or under the influence of alcohol, drugs, or medication.
- Do not operate in poor lighting.
- Do not use to pick up flammable or combustible liquids, such as gasoline, or use in areas where they may be present.
- Do not pick up anything that is burning or smoking, such as cigarettes, matches, or hot ashes.
- Do not use without collection bag, gate or tubes in place (if applicable).
- Check the work area before each use. Remove all objects such as rocks, broken glass, nails, wire, or string which can be thrown or become entangled in the machine.
- Use only identical manufacturer's replacement parts and accessories. Use of any other parts may create a hazard or cause product damage.

# BATTERY OPERATED POWER TOOLS

- Do not use battery-operated appliance in rain.
- Turn off all controls before removing the battery.
- Recharge only with the charger specified by the manufacturer. A charger that is suitable for one type of battery pack may create a risk of fire when used with another battery pack.
- Use only the charger supplied by the manufacturer to recharge.
- Use appliances only with specifically designated battery packs. Use of any other battery packs may create a risk of injury and fire
- Prevent unintentional starting. Ensure the switch is in the off-position before connecting to battery pack, picking up or carrying the appliance. Carry the power tool with your finger on the switch or energize power tool that have the switch on invites accidents.
- Disconnect the battery pack from the power tool before making any adjustments, changing accessories, or storing the power tool. Such preventive safety measures reduce the risk of starting the power tool accidentally.
- When battery pack is not in use, keep it away from other metal objects like paper clips, coins, keys, nails, screws or other small metal objects that can make a connection from one terminal to another. Shorting the battery terminals together may cause burns or a fire.
- Under abusive conditions, liquid may be ejected from the battery: avoid contact. If contact accidentally occurs, flush with water. If liquid contacts eyes, additionally seek medical help. Liquid ejected from the battery may cause irritation or burns.
- Do not incinerate the appliance even if it is severely damaged. The batteries can explode in a fire.
- Do not use a battery pack or appliance that is damaged or modified. Damaged or modified batteries may exhibit unpredictable behavior resulting in fire, explosion or risk of injury.
- Do not expose a battery pack or appliance to fire or excessive temperature Exposure to fire or temperature above 265°F(130°C) may cause an explosion.
- Have servicing performed by a qualified repair person using only identical replacement parts. This will ensure that the safety of the product is maintained
- Don't modify or attempt to repair the appliance or the battery pack(as applicable)except as indicated in the instructions for use and care.
- Follow all charging instructions and do not charge the battery pack or appliance outside of the temperature range specified in the instructions. Charging improperly or at temperatures outside of the specified range may damage the battery and increase the risk of fire.

## CHILD SAFETY

Tragic accidents can occur if the operator is not aware of the presence of children.

- Keep children out of the working area and under the watchful care of a responsible adult.
- Do not allow children under the age of 14 to operate this machine. Children who are 14 years of age and older must read and understand the operating instructions and safety rules in this manual and must be trained and supervised by a parent.
- Stay alert, and turn the machine off if a child or any other person enters the working area.
- Use extreme care when approaching blind corners, doorways, shrubs, trees, or other objects that may obscure your view of a child who may run into the path of the machine.

## RECYCLE

The toxic and corrosive materials below are in the batteries used in this machine: Lithium-Ion, a toxic material.

 **WARNING!** Discard all toxic materials in a specified manner to prevent contamination of the environment. Before discarding, damaged or worn out Li-ion batter contact your local waste disposal agency, or the local Environmental Protection Agency for information and specific instructions. Take the batteries to a local recycling an/or disposal center, certified for lithiumion disposal.

 **WARNING!** If the battery pack cracks or breaks, with or without leaks, do not recharge it and do not use. Discard it and replace with a new battery pack. **DO NOT TRY TO REPAIR IT!** To prevent injury and risk of fire, explosion, or electric shock, and to avoid damage to the environment.

- Cover the terminals of the battery with heavy-duty adhesive tape.



Separate collection. You must not scar with usual household waste. If it is necessary to replace the machine, or it is no more use to you, do not discard it with household waste. Make this machine available for separate collection.



Separate collection of used machine and packaging let you recycle materials and use them again. Use of the recycled materials helps prevent environmental pollution and decreases the requirements for raw materials.



At the end of their useful life discard batteries with a precaution for our environment. The battery contains materials that is dangerous to you and the environment. You must remove and discard these materials separately at a equipment that accepts lithium-ion batteries.

## TROUBLE SHOOTING

PROBLEM	POSSIBLE CAUSE	SOLUTION
The machine does not start when you push the trigger.	No electrical contact between the machine and the battery pack.	1. Remove battery pack. 2. Check contact and install the battery pack again.
	The battery pack is depleted.	The battery pack is depleted.
	The lock-out button and trigger are not pushed at the same time.	The lock-out button and trigger are not pushed at the same time.
The machine smokes during operation.	The guard is not attached to the machine.	Remove the battery pack and attach the guard to the machine
	Heavy cutting line is used.	Use only with the nylon cutting line of 2.0 mm diameter.
	The grass winds around the motor shaft or the trimmer head.	1. Stop the machine. 2. Remove the battery pack. 3. Remove the grass from the motor shaft and trimmer head.

The machine smokes during operation.	The motor is overloaded.	<ol style="list-style-type: none"> <li>1. Remove the trimmer head from the grass</li> <li>2. The motor will recover to work as soon as the load is removed</li> <li>3. When you cut, move the trimmer head in and out of the grass to be cut and remove no more than 8" in pass.</li> </ol>
	The battery pack or machine is too hot.	<ol style="list-style-type: none"> <li>1. Cool the battery pack until its function returns to normal</li> <li>2. Cool the machine for approximately 10 minutes</li> </ol>
	The battery pack is disconnected from the tool.	Install the battery pack again.
	The battery pack is depleted.	Charge the battery pack.
The line does not advance.	Lines are welded to themselves.	Lubricate with silicone spray.
	Not enough line on spool.	Install more line.
	Lines are worn too short.	Advance the cutting line.
	Lines are tangled on spool	<ol style="list-style-type: none"> <li>1. Remove the lines from the spool.</li> <li>2. Wind the lines.</li> </ol>



<p>The line keeps breaking.</p>	<p>The machine is used incorrectly.</p>	<ol style="list-style-type: none"> <li>1. Cut with the tip of the line, avoid stones walls and other hard objects.</li> <li>2. Advance the cutting line regularly to keep full cutting width.</li> </ol>
<p>The grass winds around the trimmer head and motor housing.</p>	<p>Cut tall grass at ground level.</p>	<ol style="list-style-type: none"> <li>1. Cut tall grass from the top down.</li> <li>2. Remove no more than 8 in each pass to prevent wrapping.</li> </ol>

# WARRANTY

## ALTON INDUSTRY LTD. GROUP 2-YEAR LIMITED WARRANTY

This warranty covers any defects in materials or workmanship of the enclosed product. Alton Industry Ltd. Group will repair or replace any defective materials due to craftsmanship of the product. This warranty does not cover any problem caused by misuse, abuse, accidents or acts of God, such as floods or hurricanes. Consequential and incidental damages are not covered under this warranty. Coverage terminates if you sell or otherwise transfer the ownership. If you feel you have a defective product, please submit a copy of your receipt to the address below and call 1-888-899-0146 for instructions prior returning this item to the store or sending back to:

Alton Industry Ltd. Group  
643 Innovation Drive  
West Chicago, IL 60185

We will inspect the product and contact you within 72 hours to give you the results of our inspection. We reserve the right to repair or replace the product at our discretion. However, we may replace the product with one of similar but not exact features. **Parts and Service Information available call Alton Industry at 1-888-899-0146.** This warranty gives you specific legal rights. You may have other rights which vary from state to state.

# ALTON INDUSTRY LTD. GROUP

📍 643 Innovation Drive West Chicago, IL 60185

🌐 <https://www.altonindustries.com>

✉️ [info@altonindustries.com](mailto:info@altonindustries.com)

MADE IN CHINA

---

