

PrismXR Vega T1
P1201
User Manual
Rev1.0
10/07/2023

Support

For more information, please visit www.prismxr.com/pages/support

Contents

1. What's In the Box	1
2. Product Introduction	2
2.1 Earbuds	2
2.2 Dongle	4
2.3 Charging Case	5
3. Wearing	6
4. Power On/Off	7
4.1 Power On (for your first-time use)	7
4.2 Power On (for your normal use)	8
4.2 Power Off	9
5. Paring	10
5.1 Paring with both Bluetooth Device and Dongle	10

5.2 Paring with Dongle	13
5.3 Paring with a New Dongle	14
5.4 Paring with a New Bluetooth Device	15
6. Using Earbuds	17
6.1 Controls	17
6.2 Playing While Charging	19
6.3 VR Linking With PC	20
6.4 Chatmix	21
7. Using PrismXR App	22
7.1 Download PrismXR App	22
7.2 Connect to PrismXR App	23
7.3 Details Page	24
7.4 Settings	25
8. Maintenance	26

8.1 Firmware Update	26
8.2 Charging	32
8.3 Factory Reset	34
9. Specifications	37
10. Safety Instructions	40
11. Warranty	43
12. FCC Statement	44

1. What's In the Box

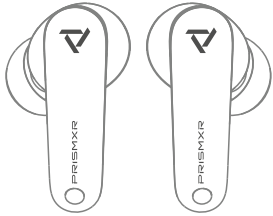

Vega T1 Earbuds



Vega T1 Dongle

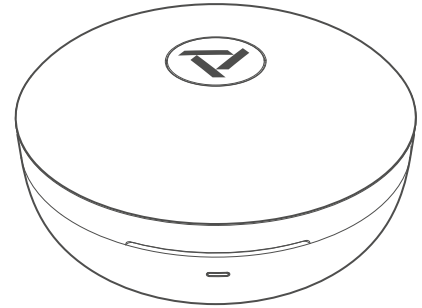

Charging Case

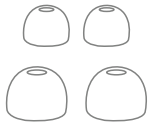

S/L Ear Tips

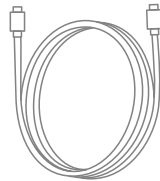

USB-C to USB-C Cable



USB-A to USB-C Adapter

2. Product Introduction

Vega T1 includes earbuds, a dongle, and a charging case.

2.1 Earbuds

Vega T1 earbuds is a true wireless earbuds that support either individual Bluetooth connection or connection with a dongle, and also support *dual connection.

*Dual connection:

The earbuds can simultaneously connect to two devices via Bluetooth and a dongle. You can answer phone calls over Bluetooth while playing games with the dongle, but you can only play music from one device at a time. If you receive an incoming call on the Bluetooth device, the volume on the dongle-connected device will automatically be lowered compared to the Bluetooth device.

Touch Area

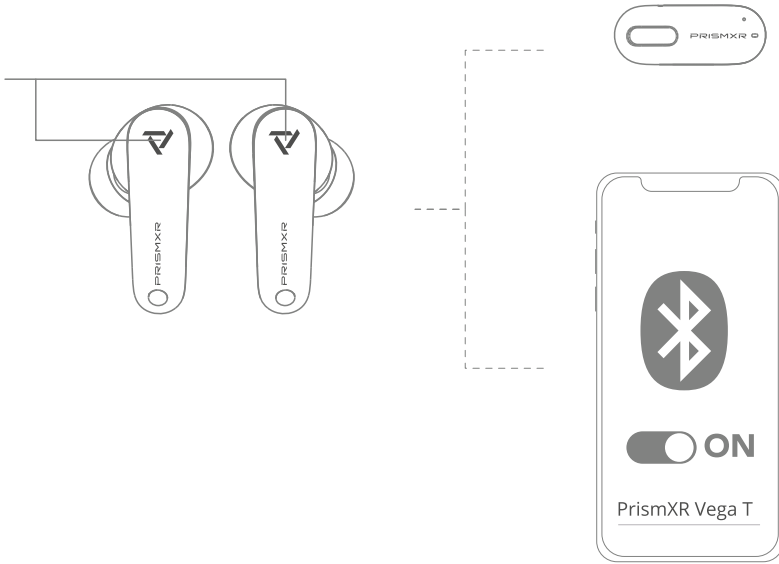

2.2 Dongle

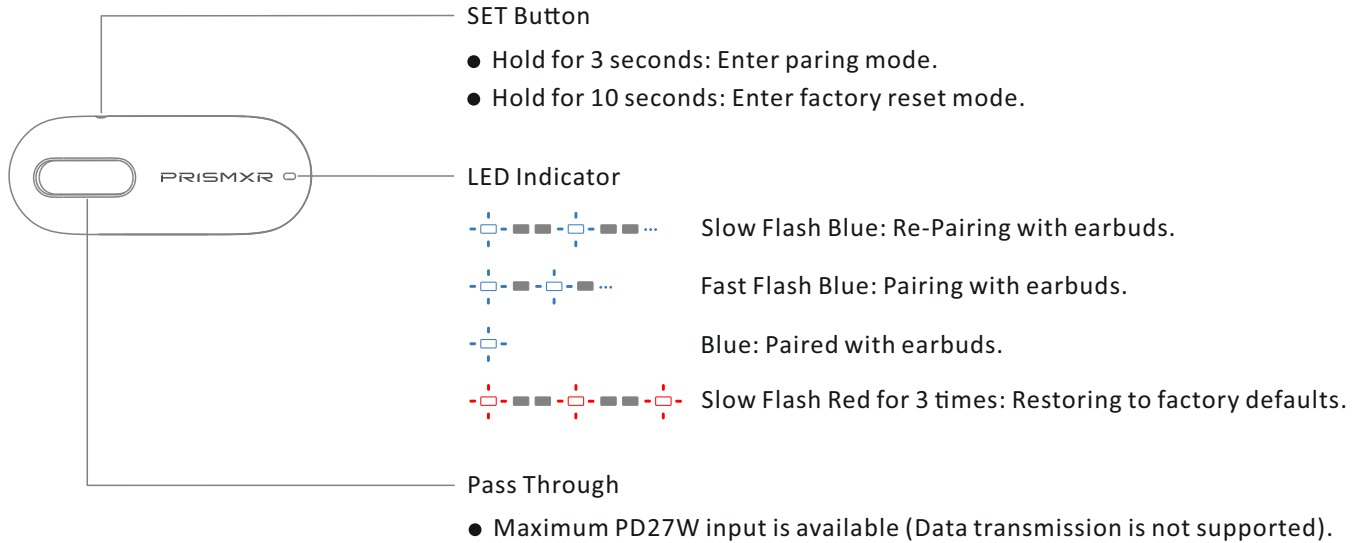

2.3 Charging Case

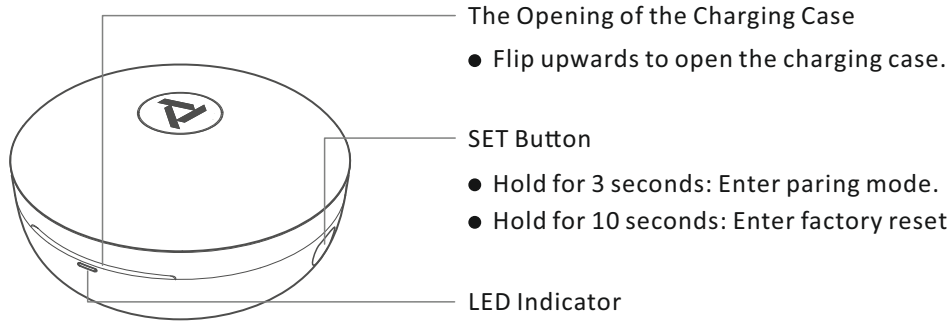

- Flip upwards to open the charging case.
- Hold for 3 seconds: Enter pairing mode.
- Hold for 10 seconds: Enter factory reset mode.

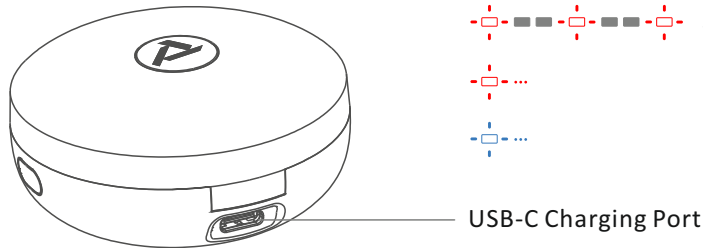

- Blue for 3 seconds: Charging case battery is high.
- Red for 3 seconds: Charging case battery is low.
- Slow Flash Blue: Re-Pairing with Bluetooth device or dongle.
- Fast Flash Blue: Pairing with Bluetooth device or dongle.
- Slow Flash Red for 3 times: Restoring to factory defaults.
- Red: Charging case is charging.
- Blue: Charging case is fully charged.

3. Wearing

- 3 sizes of ear tips: S/M/L, M is default to be installed on the earbuds.
- Select the ear tips that fit your ear best.

1

S

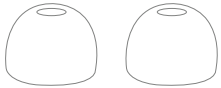

M



L

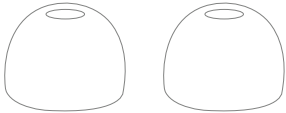

2

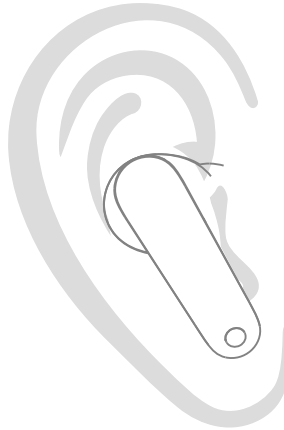

4. Power On/Off

4.1 Power On (for your first-time use)

- ① Open the charging case.
- ② Place the earbuds into the charging case, and the LED indicator will be blue for 3 seconds.
- ③ The earbuds will automatically power on.

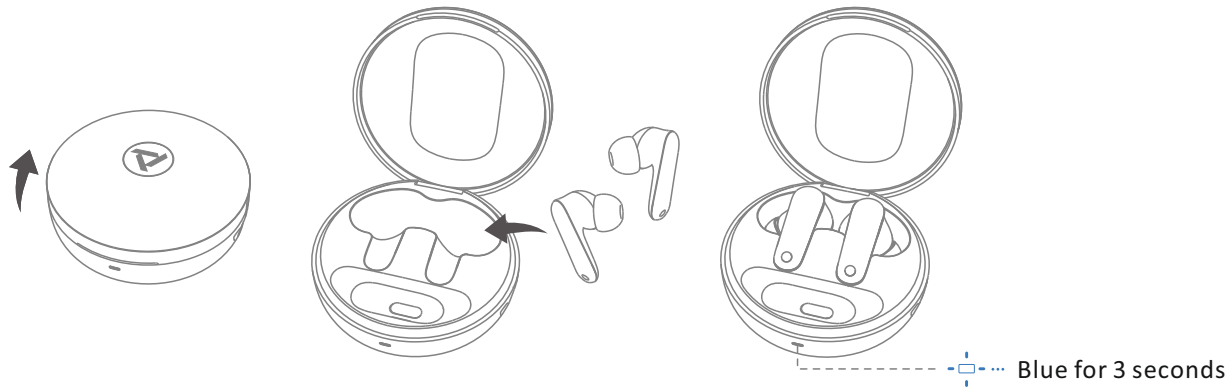

4.2 Power On (for your normal use)

- 1 Keep the earbuds in the charging case, and open the charging case, the LED indicator will be blue for 3 seconds.
- 2 The earbuds will automatically power on.

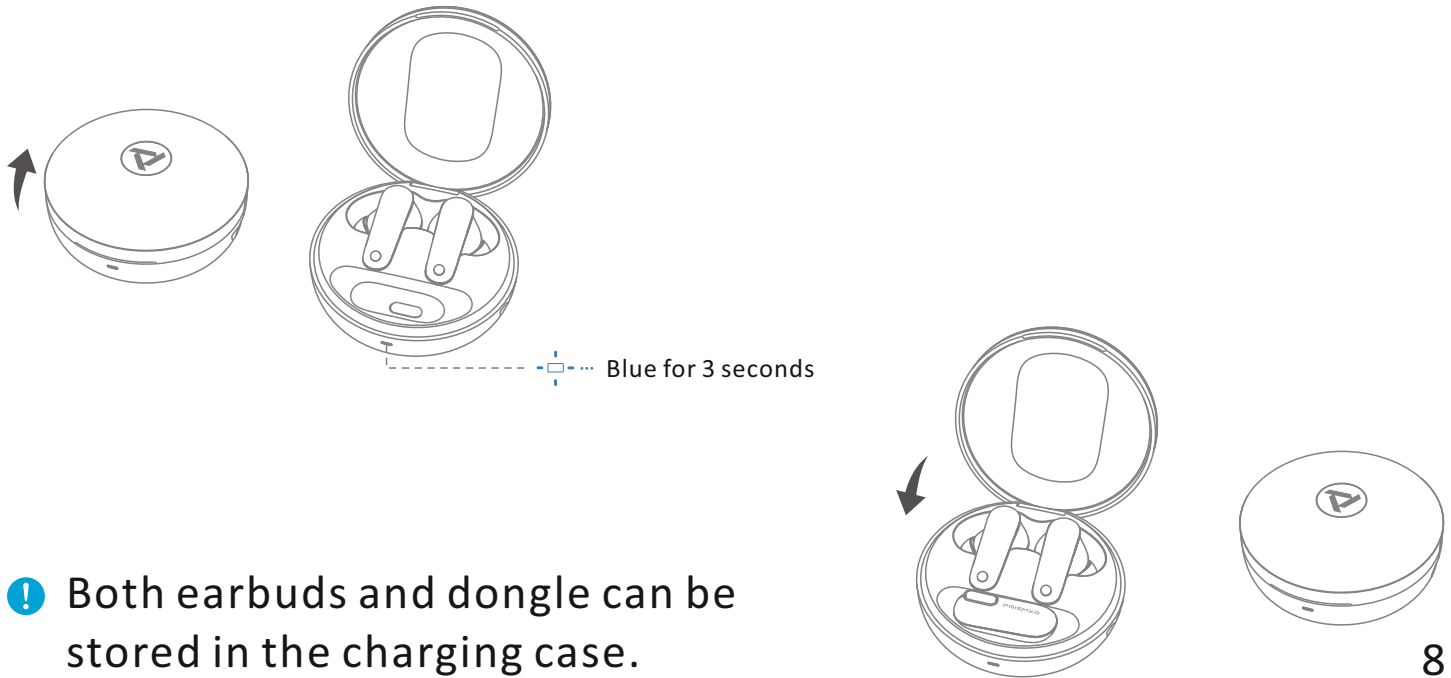

4.3 Power Off

- ❗ The earbuds will automatically power off after 5 minutes if both Bluetooth and the dongle are not connected.
- ① Place the earbuds in the charging case and close it.
- ② The earbuds will automatically power off.

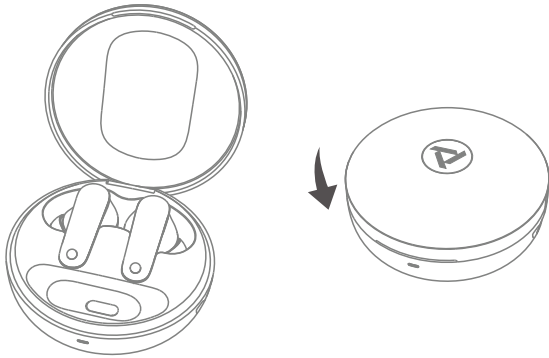

5. Pairing

5.1 Pairing with both Bluetooth Device and Dongle

If you want to connect both the dongle and a Bluetooth device at the same time, please follow the following steps.

- ① Pairing with Dongle
 - a Open the charging case.
 - b The earbuds will automatically enter pairing mode, and the LED indicator will flash blue rapidly.
 - c Turn on the dongle by plugging into the VR headset, its LED indicator will also flash blue rapidly.
 - d The earbuds will automatically connect with the dongle.

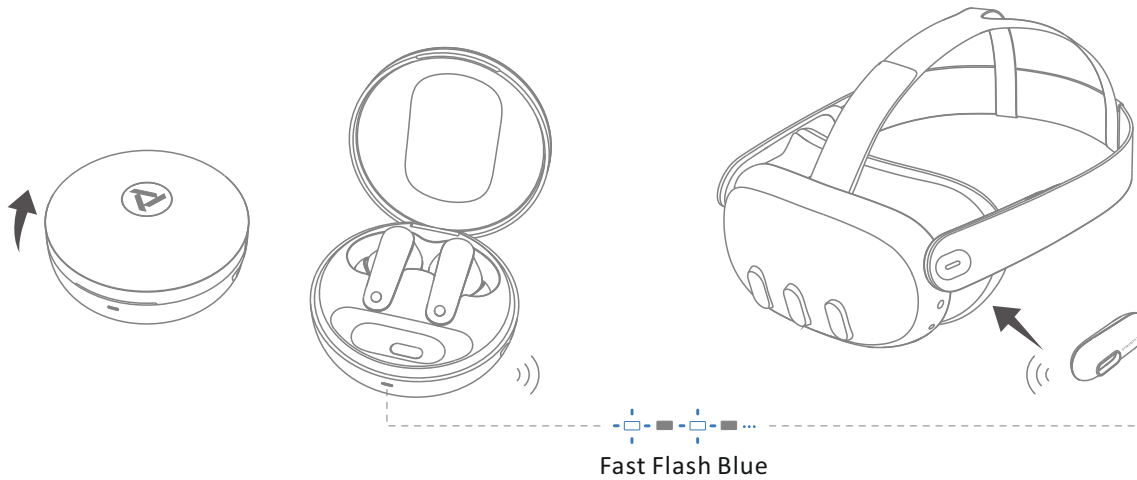

2 Pairing with Bluetooth Device

- a Open the charging case.
- b Keep the earbuds in the charging case and leave the case open.
- c Press and hold the SET button on the case for 3 seconds until LED indicator on the case fast flashes blue.
- d Turn on the Bluetooth in your phone's Settings.

- e Select "PrismXR Vega T1" from your device's Bluetooth list to connect.
- f The earbuds will connect to the Bluetooth device.

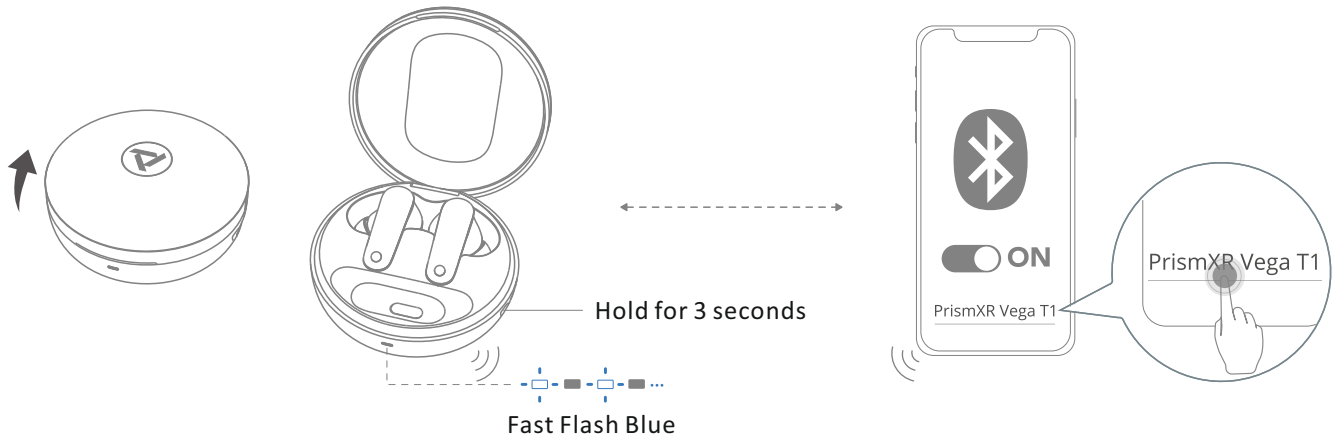

5.2 Pairing with Dongle

- ① Open the charging case.
- ② The earbuds will automatically enter pairing mode, and the LED indicator will flash blue rapidly.
- ③ Turn on the dongle by plugging into the VR headset, its LED indicator will also flash blue rapidly.
- ④ The earbuds will automatically connect with the dongle.

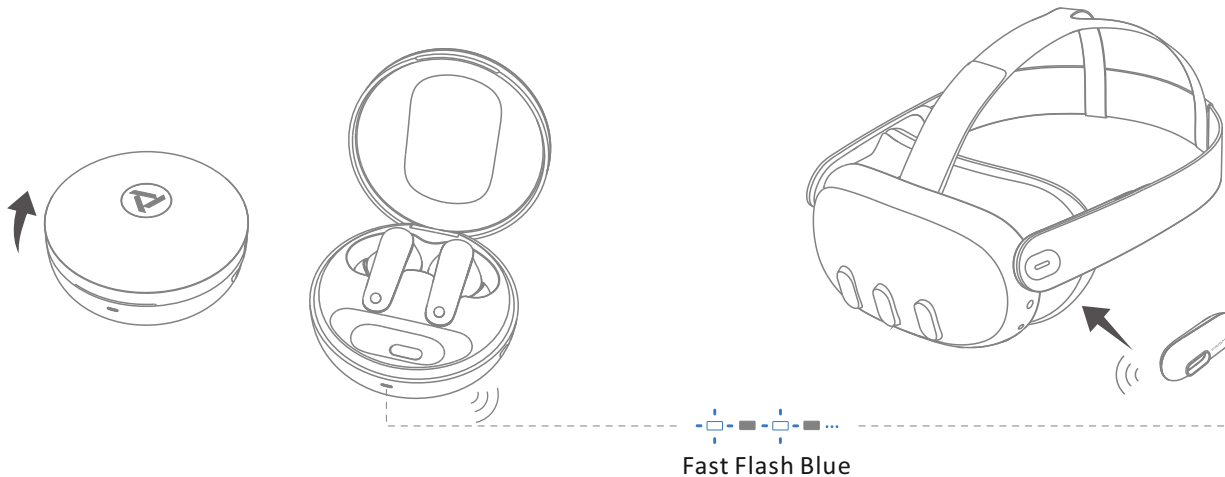

5.3 Pairing with a New Dongle

- ❗ If your earbuds are paired with multiple dongles, you can switch the connection of the earbuds to different dongles through the PrismXR App. You can follow the instructions in **Section 7.3** for more information.
- ① Open the charging case.
- ② Keep the earbuds in the charging case and leave the case open.
- ③ Press the SET button on the case for 3 seconds until LED indicator on the case fast flashes blue.
- ④ Turn on the dongle by plugging into the VR headset, Use a paperclip with a diameter of about 0.04 inches to insert into the small hole of the dongle, press and hold it for 3 seconds until the LED indicator will also flash blue rapidly.
- ⑤ The earbuds will automatically connect with the dongle.

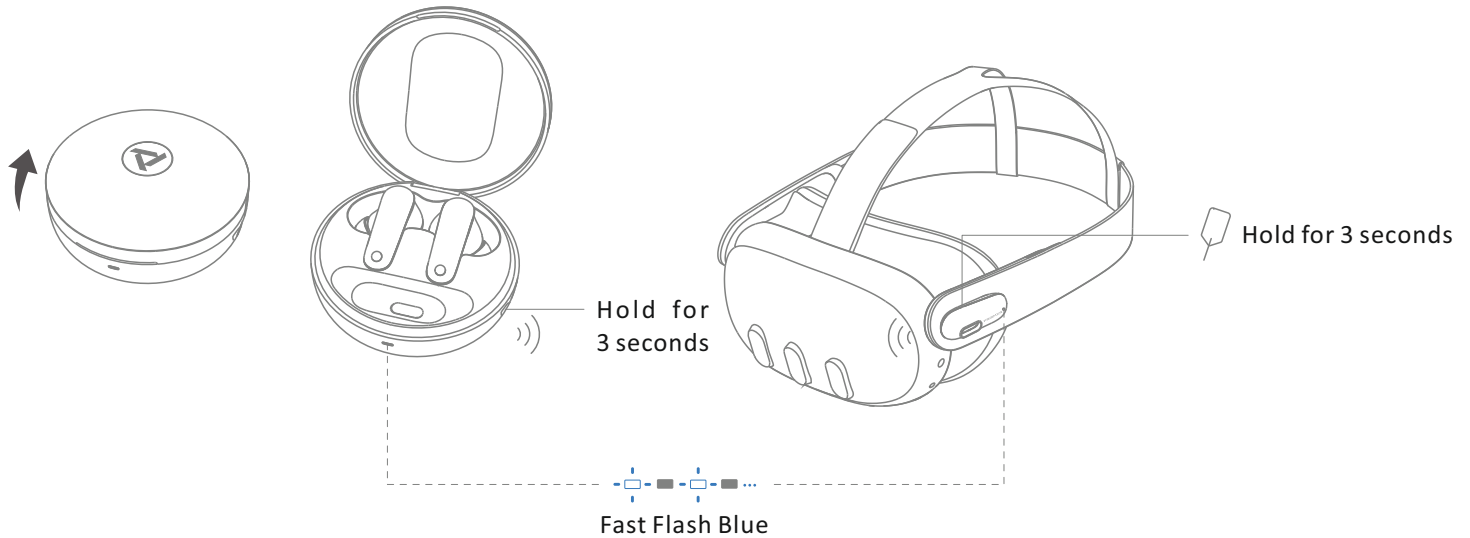

5.4 Pairing with a New Bluetooth Device

- 1 Open the charging case.
- 2 Keep the earbuds in the charging case and leave the case open.
- 3 Press the SET button on the case for 3 seconds until LED indicator on the case fast flashes blue.

- 4 Turn on the Bluetooth in your phone's Settings.
- 5 Select "PrismXR Vega T1" from your device's Bluetooth list to connect.
- 6 The earbuds will connect to the Bluetooth device.

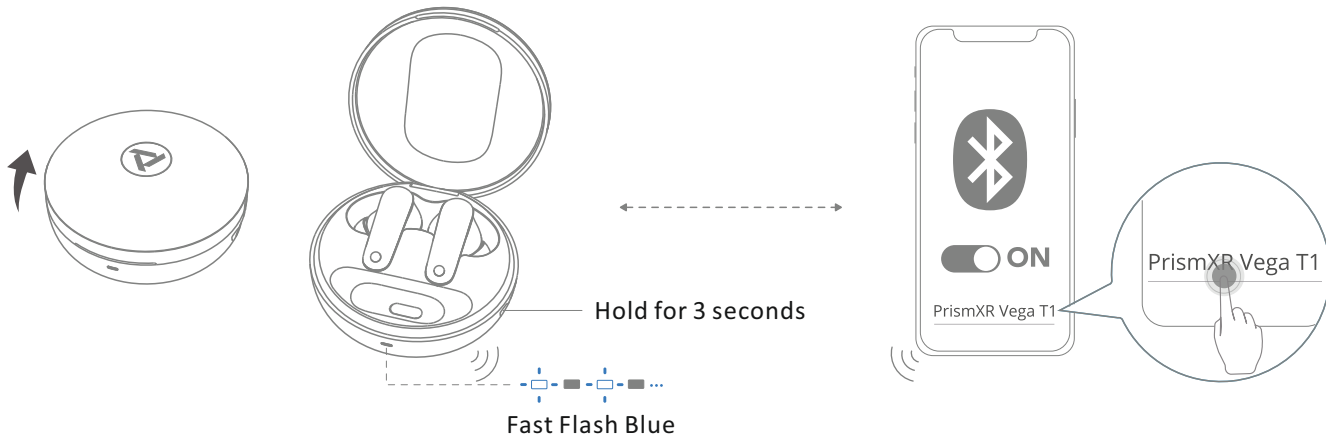

6. Using Earbuds

6.1 Controls

- ! You can customize the controls via PrismXR App.
- ! Controls may vary when connected via the dongle if the console's system is incompatible.
- ! Under dual connection, controlling the Bluetooth device takes priority.

Left	Music	Double tap	Next Song
	Call	Double tap	Answer/Hang up the call
		Press and hold for 2 seconds	Reject the call
Voice Assistant	Press and hold for 2 seconds	Wake up Voice Assistant	

Right	Music	Double tap	Play/Pause
	Call	Double tap	Answer/Hang up the call
		Press and hold for 2 seconds	Reject the call
Voice Assistant	Press and hold for 2 seconds	Wake up Voice Assistant	

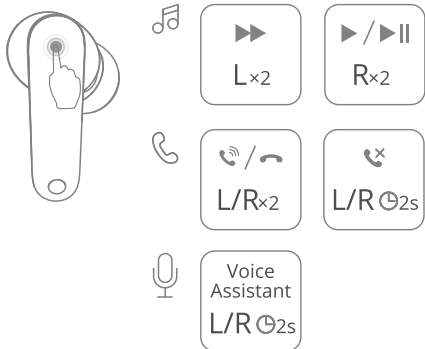

6.2 Playing While Charging

- ❗ This device does not support data transmission. Please avoid attempting to connect a PC to your VR headset to stream using a USB-C cable.
- ❗ The USB-C charging port of the dongle supports a maximum input of 27W.
- ① Insert the USB-C connector into the USB-C charging port of the dongle.
- ② Connect the charger to the power supply.

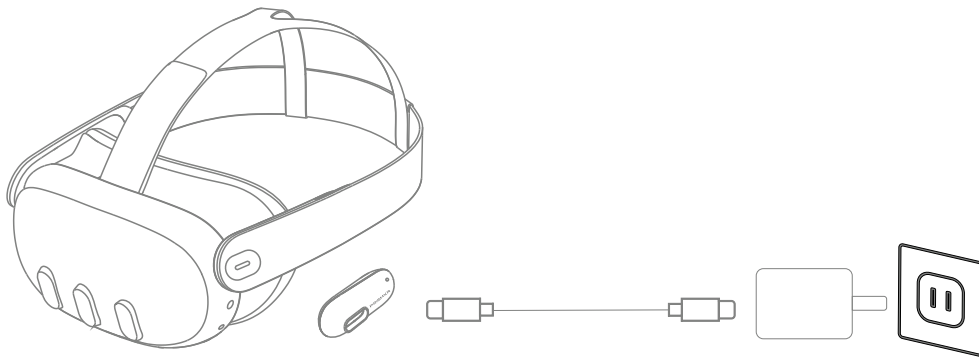

6.3 VR Linking With PC

- 1 Connect the link cable from a USB C port on your PC to your VR headset.
- 2 Plug the dongle into another USB port on your PC to use your PrismXR earbuds.

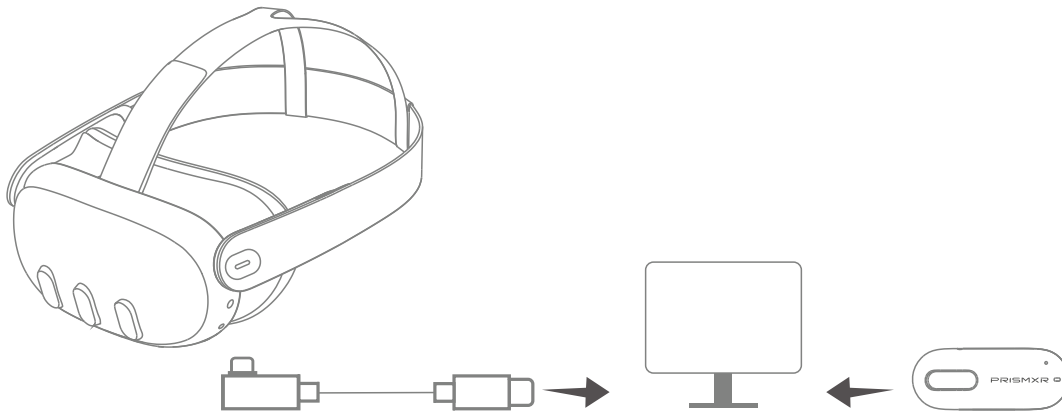

6.4 Chatmix

- ❗ It is not supported to play music over Bluetooth and dongle simultaneously.
- ❗ When the earbuds are in chatmix mode, the sound quality of the earbuds will decrease slightly, and the volume cannot be adjusted.
- You can answer phone calls over Bluetooth while playing games with the dongle.

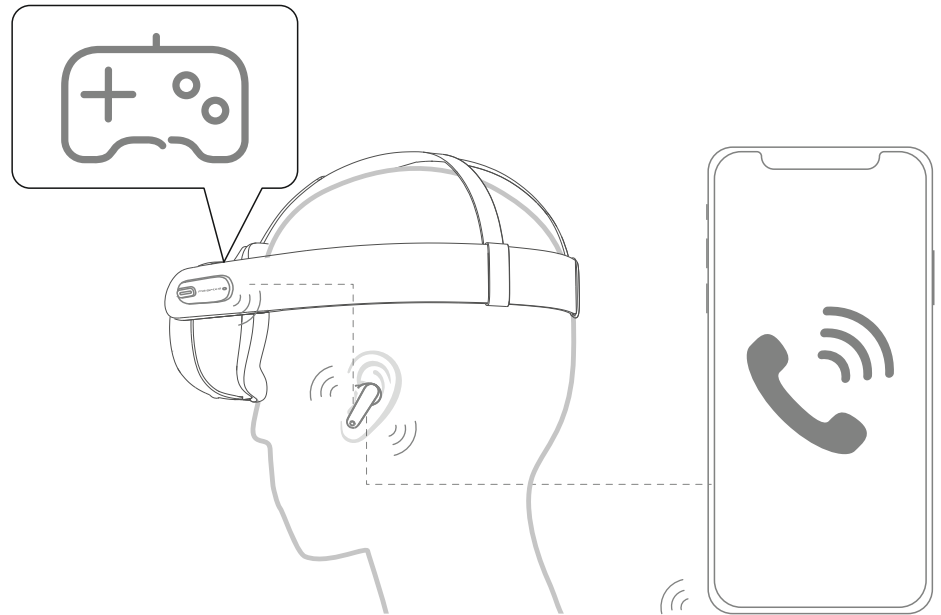

7. Using PrismXR App

7.1 Download PrismXR App

- Get and download the PrismXR App on the Apple App Store or Google Play.



App Store and App Store logo are trademarks of Apple Inc.



Google Play and the Google Play logo are trademarks of Google LLC.

7.2 Connect to PrismXR App

- ❗ Make sure the earbuds are paired with your phone.
- ➊ Open PrismXR App. Click on the "+" icon at the top right corner, select "Vega T1" to search for your earbuds.
- ➋ When your earbuds are found, there will be a pop-up notification saying "Vega T1 is Found".
- ➌ Select "Add" to add the Vega T1 to the App.

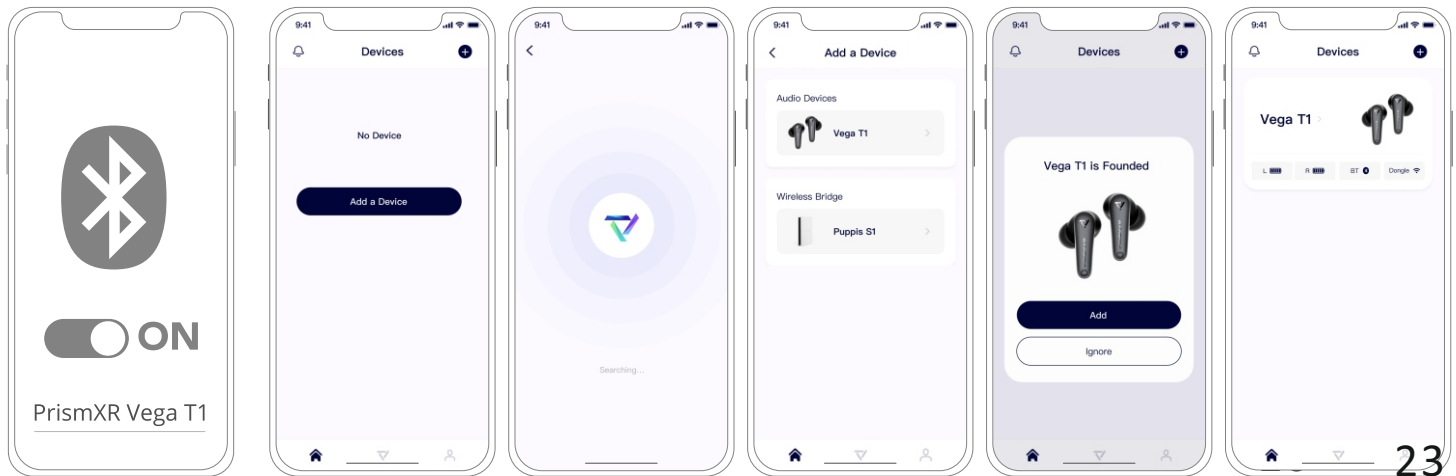

7.3 Details Page

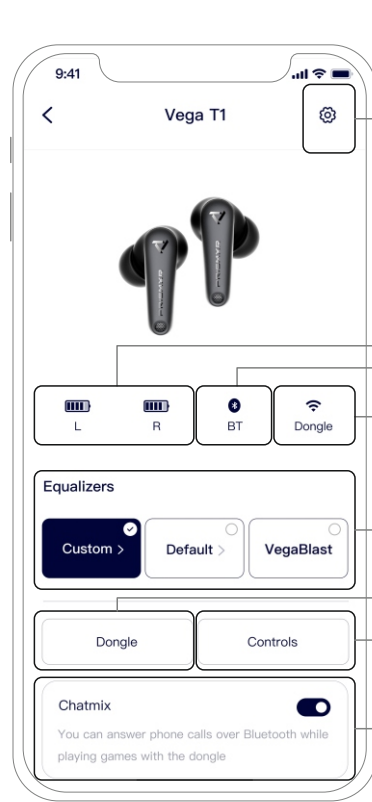

The screenshot shows the Vega T1 settings page on a mobile device. At the top, there's a status bar with the time 9:41, signal strength, Wi-Fi, and battery icons. Below that, the page title is 'Vega T1' with a back arrow on the left and a settings gear icon on the right. The main content area features a pair of earbuds. Below the earbuds are four status indicators: 'L' (Left ear), 'R' (Right ear), 'BT' (Bluetooth), and 'Dongle'. The 'Equalizers' section has three options: 'Custom' (selected with a checkmark), 'Default', and 'VegaBlast'. Below the equalizers are two buttons: 'Dongle' and 'Controls'. At the bottom, there's a 'Chatmix' section with a toggle switch and a description: 'You can answer phone calls over Bluetooth while playing games with the dongle'. Lines connect these elements to explanatory text on the right.

Click to enter the Settings page.

Battery Status

- Blue indicates battery is high.
- Red indicates battery is low.

Bluetooth Pairing Status: Blue indicates paired.

Dongle Pairing Status

- Blue indicates dongle is paired.
- Gray indicates dongle is unpaired.

Equalizers: You can choose one of the three equalizers.

- Custom: Tap to switch to Custom Equalizers or open the Custom Equalizers interface, you can edit, add or select an EQ.
- Default: Tap to switch to default Equalizers or open the default Equalizers interface and select one of them.
- Vegablast: Enable Vegablast may reduce the sound quality, please confirm whether to enable.

Dongle: You can switch dongle or edit dongle information.

Controls: You can customize the controls.

Chatmix: You can answer phone calls over Bluetooth while playing games with the dongle.

7.4 Settings

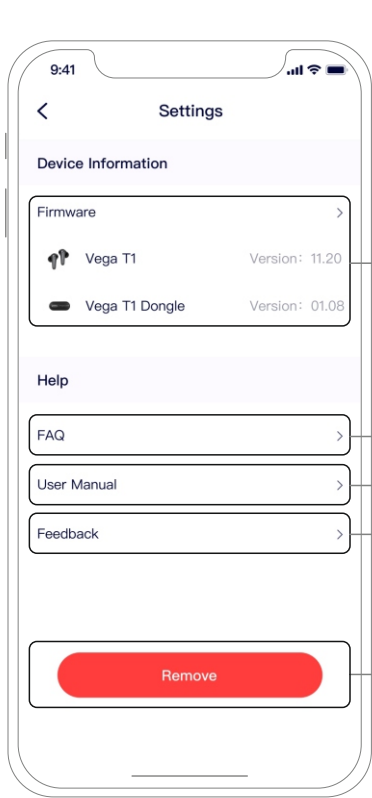

The screenshot shows the 'Settings' page of the Vega T1 app. At the top, the time is 9:41 and the status bar shows signal, Wi-Fi, and battery icons. Below the title 'Settings' is a 'Device Information' section containing two entries: 'Firmware' with a right-pointing chevron, and two items: 'Vega T1' (Version: 11.20) and 'Vega T1 Dongle' (Version: 01.08). Below this is a 'Help' section with three buttons: 'FAQ', 'User Manual', and 'Feedback', each with a right-pointing chevron. At the bottom is a red 'Remove' button.

The firmware version of the earbuds and dongle (There will be a red dot if a new firmware version is available).

Click to go to Vega T1's FAQ.

Click to go to Vega T1's User Manual.

Click to go to Feedback page.

Click to remove Vega T1 from your App.

8. Maintenance

8.1 Firmware Update

To ensure our customers have the best user experience, we highly recommend you update to the newest version firmware.

- ❗ The App will detect if there is any firmware available for the earbuds to update when they are connected to the App. It will also check for any firmware available for the dongle to update when the dongle is powered on and connected to your earbuds.
- ❗ If a new firmware version is available for both the earbuds and dongle, you should update the earbuds first, then update the dongle.
- ❗ If a new firmware version is available for either the earbuds or dongle, simply update the earbuds or the dongle directly.
- ❗ Do not disconnect or play music while installing.

- ❗ Before updating the earbuds, please ensure that both sides of your earbuds have sufficient battery power. It is recommend to update the earbuds when the battery level displayed on the App exceeds one bar.
- ❗ Ensure the earbuds are placed in the charging case and the case remains open until the firmware update is completed.
- ❗ Keep earbuds within 20 inches of your phone during earbuds updating.
- ❗ Keep the dongle powered (plug into HMD or PC) and within 20 inches of your earbuds during dongle updating.
- ① Update the Firmware for both Earbuds and Dongle
 - ⓐ If the App shows "Update Available", click "Update Firmware" to view the updated information.
 - ⓑ Click "Download" to download the new firmware of earbuds, and click "Install" to install the new firmware.

- c The earbuds will restart after updating is completed.
- d Click "Download" to download the new firmware of dongle, and click "Install" to install the new firmware.
- e The dongle will restart after updating is completed.

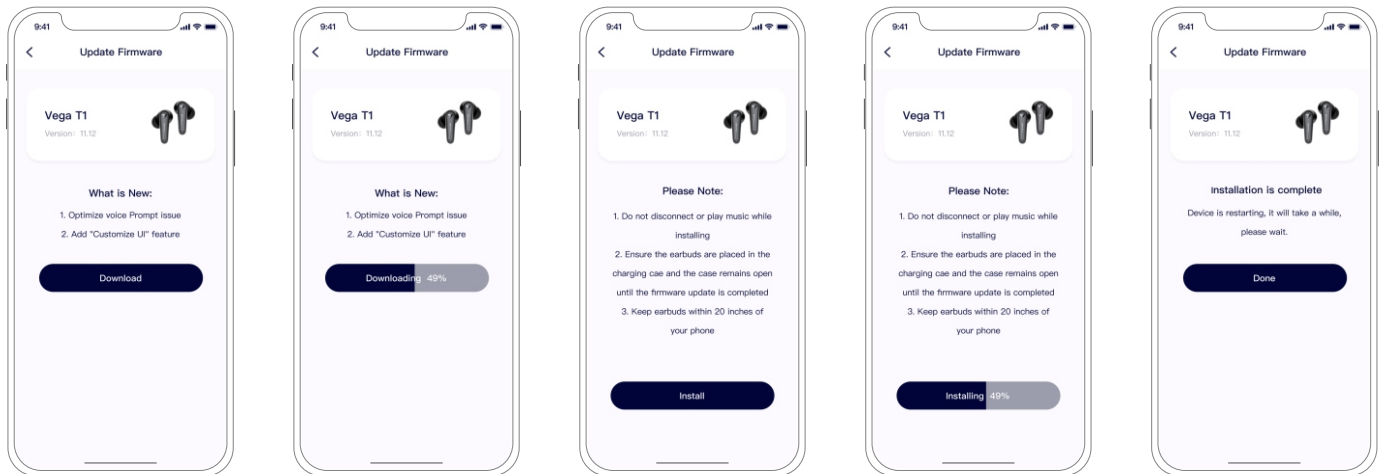

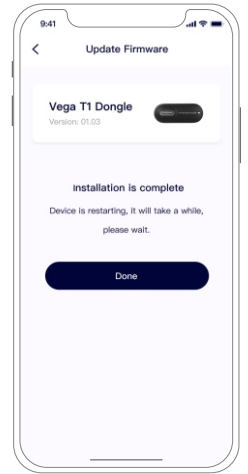
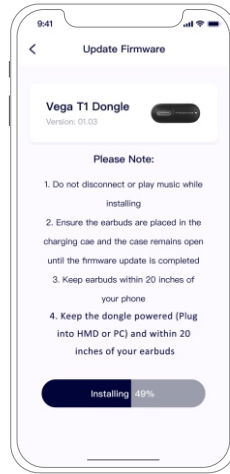
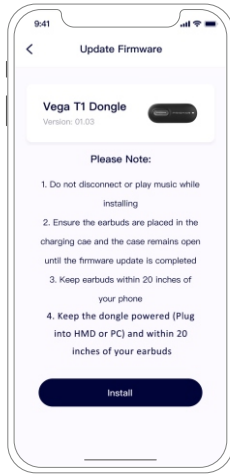
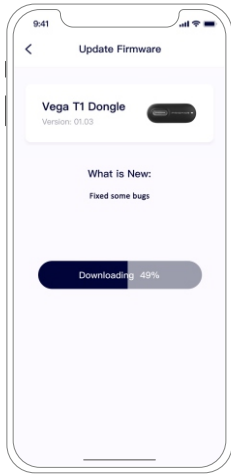
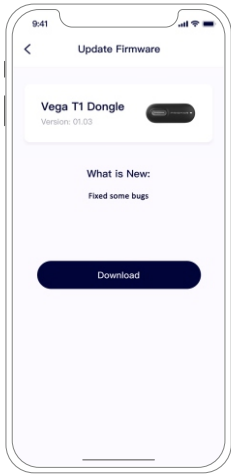

2 Update the Firmware for Earbuds

- a If the App shows "Update Available", click "Update Firmware" to view the updated information.
- b Click "Download" to download the new firmware of earbuds, and click "Install" to install the new firmware.
- c The earbuds will restart after updating is completed.

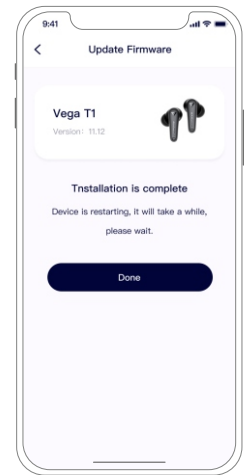
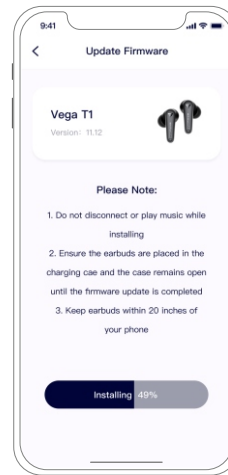
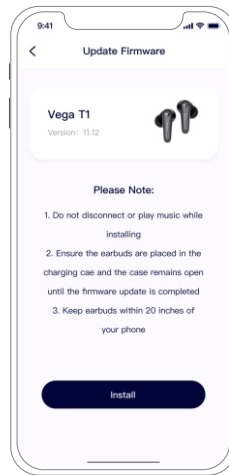
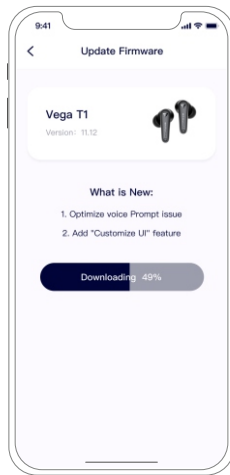
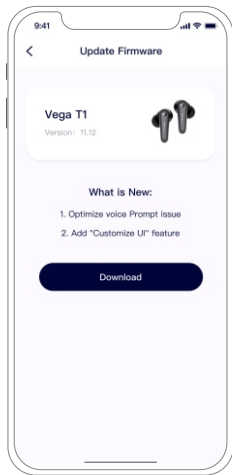

3 Update the Firmware for Dongle

- a If the App shows "Update Available", click "Update Firmware" to view the updated information.
- b Click "Download" to download the new firmware of dongle, and click "Install" to install the new firmware.
- c The dongle will restart after updating is completed.

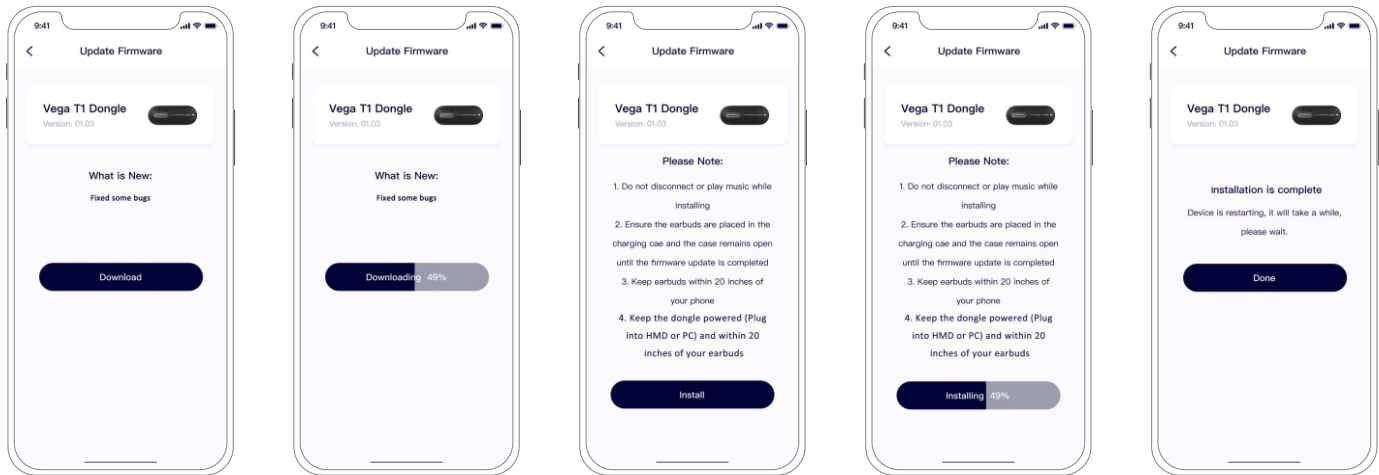

8.2 Charging

① Charge your Charging Case

- a Connect the charging case to the power supply.
- b A red LED indicator signifies that the charging case is currently charging. A blue LED indicator signifies that the charging case is fully charged.

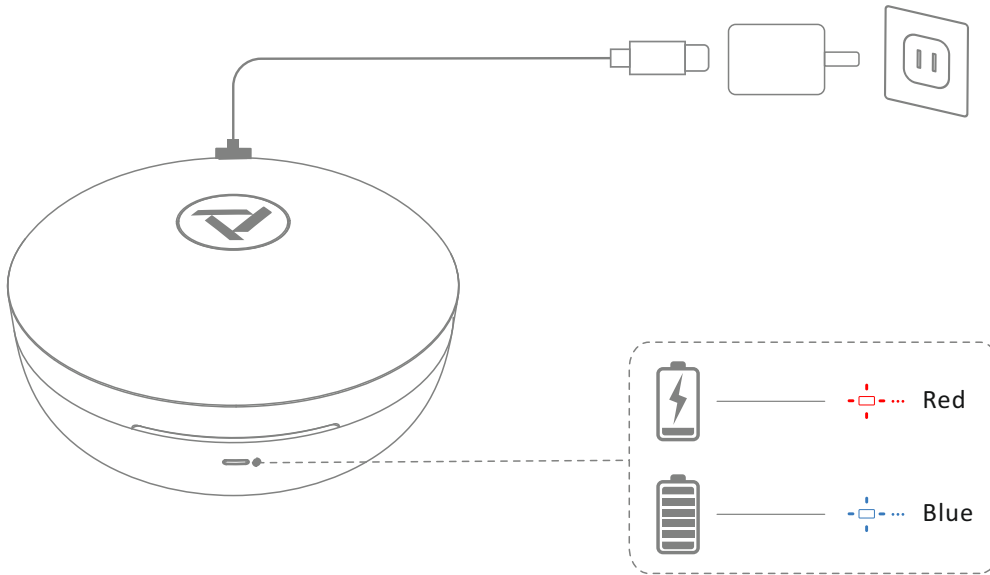

2 Charge your Earbuds

- ! Please make sure that your charging case has sufficient battery power.
- a Place the earbuds into the charging case.
- b Close the case.

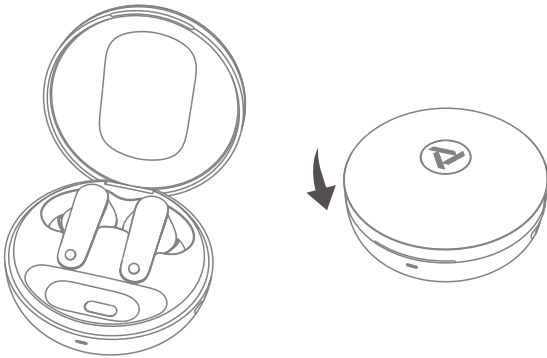

8.3 Factory Reset

- ❗ You might need to reset the earbuds or dongle if you experience any connectivity problems or function issues.
- ❗ Factory reset will erase all of your settings and restore earbuds or dongle to factory defaults. After factory reset, your device will remain in your PrismXR App.

1 Factory Reset the Earbuds

- a Place the earbuds in the charging case and leave the case open.
- b Press and hold the button on the right of the case for 10 seconds until the LED indicator flashes red for 3 times and then flash blue in sequence continuously. This confirms that the reset was successful and your earbuds can be connected normally.

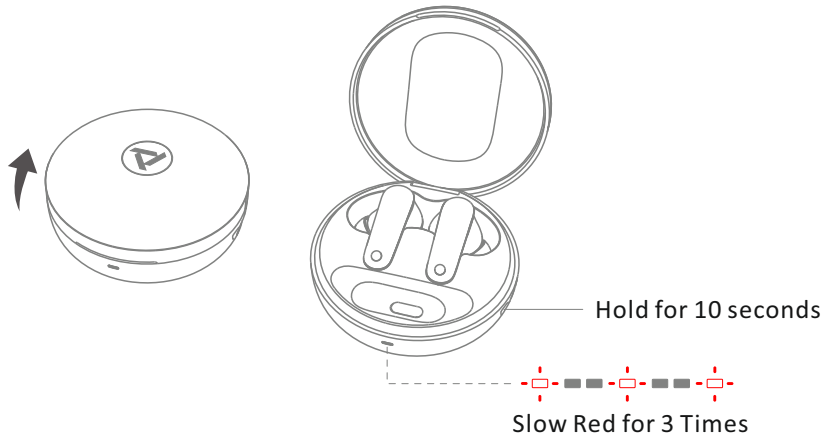

2 Factory Reset the Dongle

- a Plug the dongle into an HMD or PC.
- b Use a paperclip with a diameter of about 0.04 inches to insert into the small hole of the dongle, press and hold it for 10 seconds until the LED indicator flashes red for 3 times and then flash blue in sequence continuously. This confirms that the reset was successful and your dongle can be connected normally.

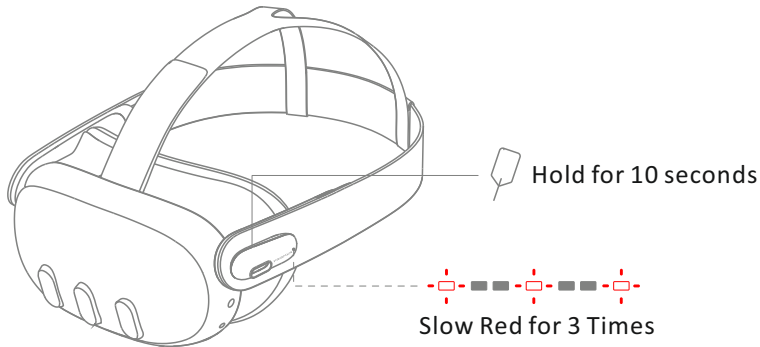

9. Specifications

! Specifications are subject to change without notice.

EARBUDS

Input	5V = 0.1A * 2pcs
Battery Capacity	63 mAh x 1 (left), 63 mAh x 1 (right)
Charging Time	70 minutes
Playtime	Up to 6 hours (Total 24 hours with the charging case)
Speaker Size	Φ11 mm x 1 (left), Φ11 mm x 1 (right)
Frequency Response	20 Hz - 20 kHz
Impedance	16 Ω
Waterproof Level	IPX4
Bluetooth Version	V5.2

Bluetooth Range	10m/32ft
Environment	Operating Temperature: 0 - 40°C (32 - 104°F) Storage Temperature: -20 - 45°C (-4 - 113°F) Humidity: ≤ 90% non-condensing

DONGLE

Input	5V = 2A, 5V = 3A, 9V = 2A, 9V = 3A
Output	5V = 2A, 5V = 3A, 9V = 2A, 9V = 3A
Input Protocol	BC 1.2, Q.C., P.D
RF Protocol	2.4G Proprietary
RF Range	5m/16ft
Environment	Operating Temperature: 0 - 40°C (32 - 104°F) Storage Temperature: -20 - 45°C (-4 - 113°F) Humidity: ≤ 90% non-condensing

CHARGING CASE

Input	5V = 1A
Battery Capacity	570mAh
Charging Time	1.5 hours
Environment	Operating Temperature: 0 - 40°C (32 - 104°F) Storage Temperature: -20 - 45°C (-4 - 113°F) Humidity: ≤ 90% non-condensing
Dimensions (W×D×H)	Φ2.49 x 1.2 inch (Φ63.2 x 30.6mm)

12. Safety Instructions

The following basic guidelines are recommended when unpacking, use, and maintenance of your electronic device.

- Avoid dropping.
- Do not disassemble.
- Avoid extreme temperature.
- Use original or certified cables.
- Do not wear the product while charging.
- Do not use any corrosive cleaner or oil to clean.
- Do not use the product outdoors during thunderstorms.
- Keep out of the reach of children. The product contains small parts which may be a choking hazard.
- The battery shall not be exposed to excessive heat such as sunshine, fire or the like.

- Do not use the product in environments with too high or too low temperatures, and never expose the products to strong sunshine or very wet environments.
- Ensure there is no liquid, sweat or water on the charging port when charging.
- Earbuds' waterproof level is IPX4, do not expose earbuds to dripping or splashing water.
- To avoid hearing damage, do not listen for extended periods at high volume.
- Do not turn the volume so high that you are unable to hear your surroundings.
- Do not use earbuds while driving.
- You should use caution or temporarily discontinue use in potentially hazardous situations.

- The product generates stronger permanent magnetic fields that could cause interference with cardiac pacemakers, implanted defibrillators (ICDs) and other implants. Always maintain a distance of at least 3.94"/10 cm between the product component containing the magnet (earbuds and charging case) and the cardiac pacemaker, implanted defibrillator, or other implant.

13. Warranty

If you have any difficulties using your PrismXR Vega T1, please contact us

Email: customerservice@prismxr.io

PRISMXR PTE LTD 60 PAYA LEBAR ROAD #12-03 PAYA LEBAR
SQUARE 409051

Warranty 18 months Limited Electrical Warranty

PrismXR warrants to the original residential user of this product that it will be free from defects in materials and workmanship, under normal use, for 18 months from the date of purchase. User must provide a copy of original purchase receipt. This warranty does not cover abuse or misused products or products used in commercial applications. This warranty does not apply to PrismXR Vega T1 that have been improperly installed, modified, put to a use other than designed, or subjected to acts of God (such as floods, lightning, earthquakes, etc.). This warranty is limited to repair or replacement of the PrismXR Vega T1 only at PrismXR's sole discretion. PrismXR will NOT be liable for the cost of installing, removing, nor reinstalling this product, nor direct, indirect, or consequential damages to persons or property resulting from the use of this product. This warranty only covers the cost of replacement parts or replacement units, it does not cover shipping & handling fees.

To implement this warranty, please visit www.prismxr.com/pages/support

14. FCC Statement

This device complies with Part 15 of the FCC Rules. Operation is subject to the following two conditions: (1) This device may not cause harmful interference, and (2) this device must accept any interference received, including interference that may cause undesired operation.

Warning: Changes or modifications not expressly approved by the party responsible for compliance could void the user's authority to operate the equipment.

Note: This equipment has been tested and found to comply with the limits for a Class B digital device, pursuant to Part 15 of the FCC Rules. These limits are designed to provide reasonable protection against harmful interference in a residential installation. This equipment generates, uses, and can radiate radio frequency energy and, if not installed and used in accordance with the instructions, may cause harmful interference to radio communications. However, there is no guarantee that interference will not occur in a particular installation. If this equipment does cause harmful interference to radio or television reception, which can be determined by turning the equipment off and on, the user is encouraged to try to correct the interference by one or more of the following measures:

- (1) Reorient or relocate the receiving antenna.
- (2) Increase the separation between the equipment and receiver.
- (3) Connect the equipment into an outlet on a circuit different from that to which the receiver is connected.
- (4) Consult the dealer or an experienced radio/TV technician for help.

To maintain compliance with FCC's RF exposure guidelines, this equipment should be installed and operated with a minimum distance of 20cm between the radiator and your body.

The following importer is the responsible party.

Company Name: PRISM XR PTE, LTD

Address: 60 PAYA LEBAR ROAD #12-03 PAYA LEBAR SQUARE SINGAPORE, 409051