



# TERYX KRX1000

## RADIO/INTERCOM INSTALLATION INSTRUCTIONS



### PROVIDED HARDWARE:

- (6) 10-24 x 5/8" Button Head Socket Screws
- (6) #10 Washer
- (6) #10-24 Nylock Nut

### TOOLS YOU WILL NEED:

- Phillips Screwdriver
- Plastic Clip Remover
- Dremel with cutting wheel
- 3/16" Drill bit and drill

1. To remove the center dash with compartment, remove the six push rivets and 2 Phillips screws. Disconnect any switches.

2. To make enough room for the back of the radio and intercom, the lower portion of the compartment needs to be cut.

- On the back side of the compartment, draw a line just below the two screw holes as shown in step 2A photo.
- Continue the line three inches forward on both sides and then down as shown in 2B photo.
- Cut along the lines to remove the lower rear section of the compartment.

3. Place the PCI KRX1000 bracket on the front of the dash console and mark the six outside mounting holes. Drill with a 3/16" drill bit.

4. Install the radio and intercom into the bracket using the supplied hardware from the radio and intercom box.

5. Mount the bracket with radio and intercom into the dash using the supplied six 10mm screws and nuts.

6. Before re-installing the center console onto the car, remove the seats and run the intercom power, radio power, intercom cables, push to talk buttons and coax cable down the center console. Keep headset/helmet cables, antenna cable and power cables as far apart as possible, do not run in the same loom. Reference routing instructions included with intercom.

7. Connect all cables to the rear of the radio and intercom.

8. Reinstall the completed center dash piece using hardware from step 1. The two push rivets from the compartment will not be reinstalled.

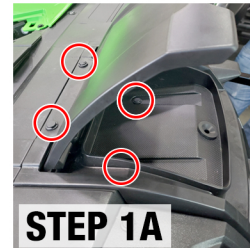

STEP 1A



STEP 1B



STEP 2A

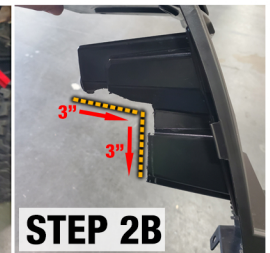

STEP 2B



STEP 3



STEP 4-5



STEP 6



800.869.5636 • WWW.PCIRACERADIOS.COM