



EcoSmart

Panel Heater



Model: ACPH710, ACPH720, ACPH730

General Care and Safety Guide

YOUR SAFETY IS IMPORTANT TO US. PLEASE ENSURE YOU TAKE NOTE OF THE INSTRUCTIONS AND WARNINGS OUTLINED IN THIS MANUAL.

CAUTION: In order to avoid a hazard due to inadvertent resetting of the thermal cut-out, this appliance must not be supplied through an external switching device, such as a timer, or connected to a circuit that is regularly switched on and off by the utility.

- This appliance is not intended for use by persons (including children) with reduced physical, sensory or mental capabilities or lack of experience and knowledge, unless they are supervised or have been given instruction concerning the use of the appliance by a person responsible for their safety.
- Children should be supervised to ensure that they do not play with the appliance.
- If the supply cord is damaged, it must be replaced by the manufacturer, its service agent or similarly qualified persons in order to avoid a hazard.

WARNING: You must not cover this appliance. Covering this appliance presents fire risk and will activate the safety fuse; permanently disabling the unit.

WARNING: Do not use this appliance in small rooms when they are occupied by persons not capable of leaving the room on their own, unless constant supervision is provided.

WARNING: To reduce the risk of fire, keep textiles, curtains, or any flammable material a minimum distance of 1 metre from the air outlet.

- Use only the voltage specified on the rating label of the appliance.
- Keep all objects at least 1 metre from the front and 150mm from the sides of the appliance.
- This appliance is intended for household use only and not for commercial or industrial use.
- Indoor use only.
- Use this appliance only as described in this manual. Any other use is not recommended by the manufacturer and may cause fire, electric shock or injury.
- Do not use the appliance if it has been dropped or damaged.
- The common cause of overheating is deposits of dust or fluff in the appliance. Ensure these deposits are removed regularly by unplugging the appliance and vacuum cleaning the air vents and grills.

General Care and Safety Guide

- Never use the appliance to dry clothes.
- Always unplug appliance when not in use.
- When the appliance has been unpacked, check it for transport damage and ensure all parts have been delivered. If parts are missing or the appliance has been damaged, contact the Customer Services Team.
- Do not use if there are visible signs of damage to the appliance.
- Do not connect the appliance to mains supply until completely assembled and adjusted.
- Ensure hands are dry before handling the plug or main unit.
- Ensure appliance is on a flat, stable, heat-resistant surface.
- Do not operate with cord set coiled up as a heat build up is likely, which could be sufficient to become a hazard.
- Carry out regular checks of the supply cord to ensure no damage is evident
- Do not operate this appliance with a damaged cord, plug or after the appliance malfunctions or has been dropped or damaged in any manner. Take to a qualified electrical person for examination, electrical service or repair.
- Do not twist, kink or wrap the cord around the appliance, as this may cause the insulation to weaken and split. Always ensure that all cord has been removed from any cord storage area and is unrolled before use.
- It is recommended that this appliance is plugged directly into the wall socket. Power boards are not rated to supply power to high wattage appliances.
- A correctly specified, undamaged extension cord may be used with this appliance provided it is used in a safe manner.
- Do not remove plug from power socket until the appliance has been switched off.
- Do not remove plug from power socket by pulling cord; always grip plug.
- Do not place cord under carpet or cover with rugs or furniture. Arrange the cord so it cannot be tripped over.
- Don't place appliance on bedding or on thick & long carpet where the openings may get blocked.
- Switch off and use handle provided when moving
- Do not place appliance close to radiant heat source.
- Do not insert or allow foreign objects to enter any ventilation or exhaust opening, as this may cause an electric shock, fire or damage to the appliance.
- Do not sit on the appliance.
- Do not use abrasive cleaning products on this appliance. Clean with a damp cloth (not wet) rinsed in hot soapy water only. Always remove plug from the mains supply before cleaning.
- Do not operate in areas where petrol, paint or other flammable liquids are used or stored.
- Do not use this appliance in the immediate surrounds of a bath, a shower, or a swimming pool or other liquids.

General Care and Safety Guide

- The appliance must not be immersed in any liquids.
- There are no user serviceable parts installed in the unit.
- Do not place the unit in wardrobes or other enclosed spaces as this may cause fire hazards.
- This unit is not supposed to be used in or around locations where foodstuffs, works of art or delicate articles of science, etc. are stored.
- If your appliance does not work, or is not working properly, contact the place of purchase or the Customer Services Team.

Components

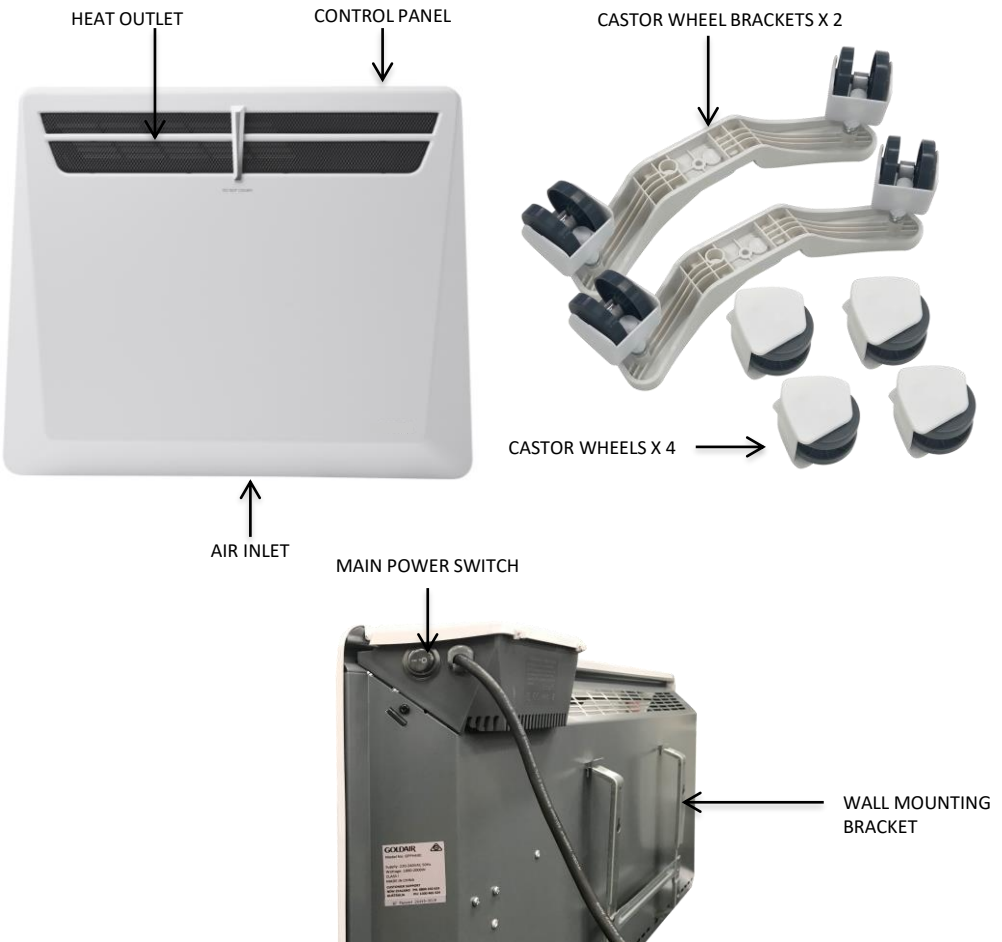

Assembly Instructions

Before using this appliance, it must either be wall mounted or have the castor plates and castors fitted.

This appliance has been supplied with '1 way screws' for permanent installation of the feet. This is a safety requirement for the New Zealand and Australian market.

FREE STANDING

1. Ensure the appliance is unplugged and power switches are off.
2. Carefully turn the main body upside-down on a scratch-free and stable surface. Be careful to prevent damage to the cosmetic finish or your floor surfacing.
3. Align the screw hole on the Castor Wheel Bracket with the screw hole on the base of the appliance.
4. Firmly press Castor Wheels into the slots provided on the Castor Wheel Bracket until they click into place. Some force may be required.
5. Attach Castor Wheel Bracket with the '1 way screws' provided and ensure the bracket sits firmly in place. Ensure the screws are tight and the feet are attached firmly.
6. Set appliance upright.

NOTE: The wall bracket edges may be sharp. It is recommended that if using as a free standing appliance please remove the wall bracket from the back of the heater.



Installation Instructions

The appliance must not be located immediately below a socket outlet.

NOTE: Your Panel Heater should be installed with at least 150mm clearance from the floor and any other surrounding parts including other appliances and side walls.

At least 300mm clearance from ceilings, shelves and soft furnishings.

Note: Do not run the power cord behind the heater.

WALL MOUNTED HEATERS ARE ONLY TO BE MOUNTED ON HEAT RESISTANT WALLS THAT COMPLY WITH CURRENT AS/NZS SPECIFICATIONS & BUILDING REGULATIONS

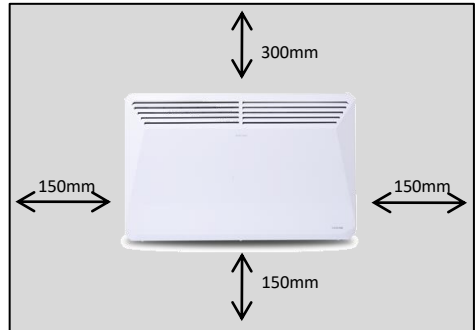

WALL MOUNTED

1. Make sure the appliance is unplugged and power switches are off.
2. Position the panel appliance within one metre of a wall socket. Do not mount in front of or below the wall socket. Ensure there is at least 150mm clearance on all sides of the appliance.
3. Detach the mounting bracket from the back of the panel appliance by unscrewing the two locking screws (located on the top of the mounting bracket).
4. Position the mounting bracket on the wall and mark the hole positions with a pen or pencil and check they are horizontal with a spirit level. Ensure the two bottom mount holes are at least 150mm from the floor and drill holes as required.
5. Secure the mounting bracket to the wall with the mounting screws. (For masonry walls use the plastic sheaths).
6. Slot the back of the appliance onto the mounting bracket locating the bottom plugs first and secure with two locking screws.
7. Plug appliance into a standard 240 volt AC electrical outlet.

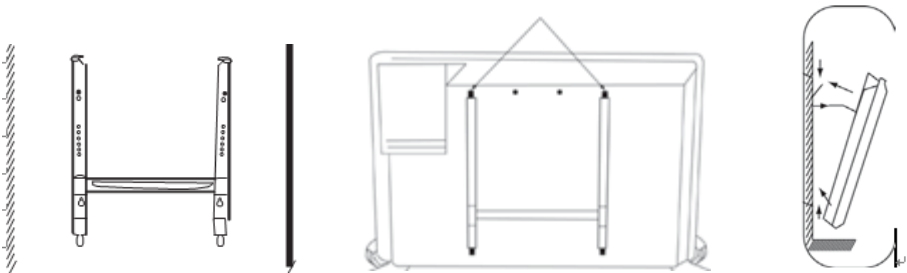

Operating Your Heater

Always choose a safe location for the heater, keeping in mind the safety precautions outlined. Ensure all packaging has been removed from the unit before use. Please follow the below instructions.

WARNING: In order to avoid overheating or fire, do not cover the heater.

WARNING: Keep all objects at least 1 metre from the front and 150mm from the sides of the appliance.

WARNING: Do not use this heater with a programmer, separate timer, remote-control system or any other device that switches the heater on automatically, since a fire risk exists if the heater is covered or positioned incorrectly.

WARNING: Never leave this heater unattended when in use.

If mounted on castors, ensure heater is on a flat, stable, heat-resistant surface.

Once the heater is in a safe operating position and all switches are in the off position, insert the power plug into the mains outlet and switch on.

CAUTION: Ensure the power cord is not tight because if pulled it may partially pull the plug from the socket. A partially inserted plug will overheat the plug and socket and could result in fire.

Note: When the appliance is turned on for the first time, it may release a slight odour or smoke. This odour or smoke is a normal occurrence caused by the initial heating of the heating elements and should not occur again.

Operating Your Heater

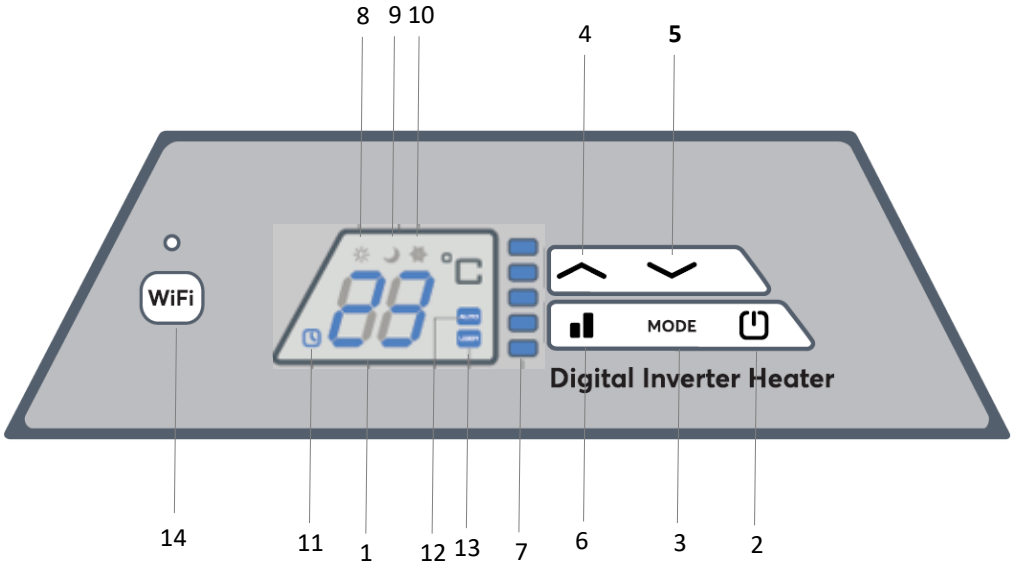

- | | | | |
|----|------------------------|-----|----------------------------|
| 1. | LED display | 8. | Comfort indicator light |
| 2. | On/Off button | 9. | Economy indicator light |
| 3. | Mode setting button | 10. | Anti-frost indicator light |
| 4. | Up button | 11. | Timer indicator light |
| 5. | Down button | 12. | Auto indicator light |
| 6. | Power setting button | 13. | User indicator light |
| 7. | Power indicator lights | 14. | WiFi button |

Operating Your Heater

Check that the heater main power switch is in the OFF position before plugging into the mains supply.

Turn the main power switch which is on the right hand side of the appliance just below the control panel to the "I" position to turn the heater on. The heater will beep once and will be stand by mode.



Press the  button. A beep will sound indicating the heater is now on and the setting will be "AUTO" mode. The current temperature will be displayed on the screen.

To turn the heater off, press the  button for at least 2 seconds until the heater switches off.

AUTO Mode

In "AUTO" mode you can set either Comfort or Economy settings as shown below. The default temperature setting is 25°C. Set your desired temperature by pressing the UP or DOWN buttons. The screen will return to the current temperature after a few seconds but the set temperature will be retained unless changed by you.



Comfort mode can be set from 5 – 35°C



Economy mode can be set from 5 - 31°C (this is pre-set so there is always a 4°C difference between Comfort and Economy settings)

You may want to set the economy temperature to a much lower level than the comfort temperature and set the heater to economy when going to bed so that the room it is in stays warm but not as hot as you would have it if you were in the room.

The heater will automatically set the best heat setting to reach the temperature you have set and will adjust the heat setting to maintain the temperature you have set. The blue lights will show which heat setting is currently in use.

USER mode

Press the  button to change from AUTO to USER mode. The power setting will go to high (all blue lights illuminated). You can select the power setting you want. There are 5 levels. The blue lights will decrease with each push. When it reaches the bottom light (lowest heat setting) the heater will then go back into AUTO mode.

In "USER" mode you can set either Comfort or Economy settings as shown below. The default temperature setting is 25°C. Set your desired temperature by pressing the UP or DOWN buttons. The screen will return to the current temperature after a few seconds but the set temperature will be retained unless changed by you.



Comfort mode can be set from 5 – 35°C



Economy mode can be set from 5 - 31°C (this is pre-set so there is always a 4°C difference between Comfort and Economy settings)

You may want to set the economy temperature to a much lower level than the comfort temperature and set the heater to economy when going to bed so that the room it is in stays warm but not as hot as you would have it if you were in the room.

Operating Your Heater

You can set the heat setting to any of the 5 levels to heat the room. It is best to set it at the highest setting to initially heat up the room and then set to a lower level to maintain the setting. When the room reaches the set temperature, the element will turn off and not turn on again until the room temperature drops lower than the set temperature.

ANTI-FROST mode.

The heater is fitted with an “anti-frost” mode which can be activated by pressing the MODE button until the ❄️ symbol is illuminated. The heater will automatically come on if the temperature drops below 5 degrees. Note the appliance has to be turned on for this function to work. To deactivate this mode press the MODE button again to go back to comfort or economy mode.

AUTO OFF TIMER

Set the timing function by pressing the ⏸️ button twice in quick succession.

The TIMER symbol ⏸️ will light and the screen starts flashing, use the UP or DOWN buttons to set the desired turn off time (from 1 to 24 hours). Once the set time has elapsed the heater will turn off.

CHILD LOCK

To activate the child lock, press both the UP and DOWN buttons together for 3 seconds and the heater will then display [] to show the lock is active. After 5 seconds the screen will return to showing the heater settings but none of the keys will work until the child lock is deactivated by pressing both the UP and DOWN buttons again for 3 seconds.

SAFETY DEVICES

This appliance has three protection devices:

- Tilt Switch - this will automatically turn the appliance off if the appliance is not in the correct operating position.
- Resettable Thermal Link - this will automatically disconnect the power to the appliance at a pre-set overheat temperature. After cooling down it will reset and power on again. If this occurs, investigate what is causing the appliance to overheat.
- Thermal Fuse - this disconnects the appliance permanently in case of overheating. (It is non resettable).

WiFi – Downloading and Setting up APP

This APP is supported only on 2.4GHz Wi-Fi channels. Please ensure your phone is 2.4GHz capable

Note this device will only work within your home WIFI system.

This does not operate on 3G or 4G internet connections.

You will need a connection to your home Wi-Fi.



Download Ausclimate mobile APP

- Open the APP Store or Google Play on your mobile phone.
- Open 'Search' and enter '**Ausclimate**'
- Click 'GET' and begin to download and install.

Once downloaded to your phone open the APP

- Tap REGISTER near the bottom of the screen.
- Read and agree to the Privacy Policy.
- Add your email address.
- Tap 'Obtain verification code'

You will then receive an email with a verification code.

- Enter the verification code from your email.
- Create a password.
- Then tap confirm.

If you haven't received a verification code via email, tap the resend button and when the verification code is received follow above steps.

Your APP is now registered and ready for pairing to your device.

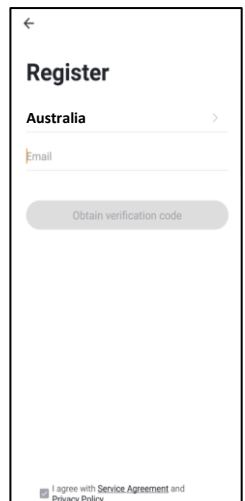
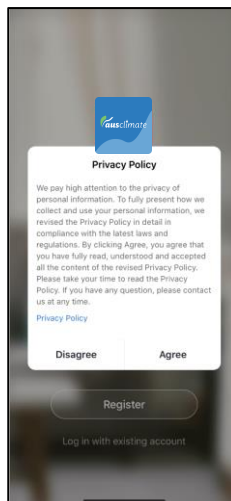
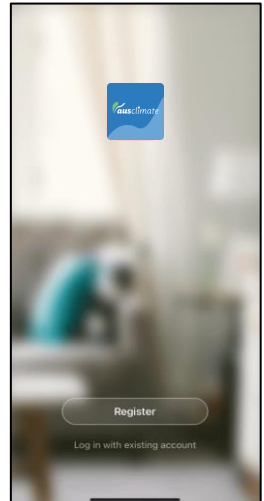

Pairing APP to Device

Details for pairing this heater to the Ausclimate App can be found at the below website link.

Either scan the QR code below or visit the help section on our website.

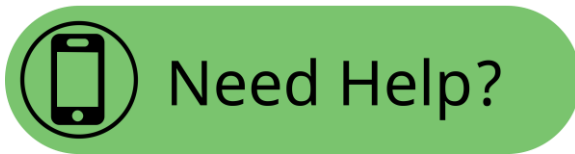

Pairing Mode

To connect to the Ausclimate app you must ensure that your device is in pairing mode which is where the Wifi Icon is flashing.

Most products will be in pairing mode after switching the device on but if it is not:



- Turn heater ON
- Navigate to the 'Connection' function under Settings → Service



Operating Your Heater



CARE AND CLEANING

The heater requires regular cleaning to ensure trouble free operation:

- Unplug the heater from the mains supply before cleaning.
- Ensure that the heater has been allowed to cool down completely before cleaning.
- The common cause of overheating is deposits of dust or fluff in the appliance. Ensure these deposits are removed regularly by unplugging the appliance and vacuum cleaning the air vents and grills.
- Use a damp cloth (not wet) to wipe the exterior of the heater to remove dust and dirt.
- Never use solutions such as petrol, thinners or polishing agents.
- Ensure the heater is dry before plugging back into the mains supply.
- Do not attempt to dismantle the heater.
- There are no user serviceable parts. For service or repair, contact an authorised electrical service technician.

	
Model No: ACPH710	
Supply: 220-240VAC 50Hz	Bluetooth
Wattage: 900-1000W	
CLASS I	
Approval: TUV021697EA	
QC Passed: PO#-WWYY	
MADE IN CHINA	
CUSTOMER SUPPORT	
NEW ZEALAND PH: 0800 232 633	
AUSTRALIA PH: 1800 122 100	

	
Model No: ACPH720	
Supply: 220-240VAC 50Hz	Bluetooth
Wattage: 1350-1500W	
CLASS I	
Approval: TUV021697EA	
QC Passed: PO#-WWYY	
MADE IN CHINA	
CUSTOMER SUPPORT	
NEW ZEALAND PH: 0800 232 633	
AUSTRALIA PH: 1800 122 100	

	
Model No: ACPH730	
Supply: 220-240VAC 50Hz	Bluetooth
Wattage: 1800-2000W	
CLASS I	
Approval: TUV021697EA	
QC Passed: PO#-WWYY	
MADE IN CHINA	
CUSTOMER SUPPORT	
NEW ZEALAND PH: 0800 232 633	
AUSTRALIA PH: 1800 122 100	

PROOF OF PURCHASE

To receive warranty retain receipt as proof of purchase. (Refer to back of booklet).

SUPPORT AND TECHNICAL ADVICE



Ausclimate – New Zealand
Monday – Friday 8am-5pm
Phone +64 (0)9 917 4000
Phone 0800 232 633

Ausclimate – Australia
Monday – Friday 8am-5pm
Phone 1800 122 100



Five Year Warranty

Thank you for purchasing this Ausclimate product. Your product is warranted against faults and manufacture when used in normal domestic use for a period of **five years**. In non-domestic use Ausclimate limits the voluntary warranty to **three months**.

Ausclimate present consumers with the option of extending their warranty by a **further 2 years** to a total warranty period of **7 years**, if the unit is registered on the Ausclimate website.

Ausclimate undertake to repair or replace this product at no charge if found to be defective due to a manufacturing fault during the warranty period.

This warranty excludes damage caused by misuse, neglect, shipping accident, incorrect installation, or work carried out by anyone other than a qualified electrical service technician.

PLEASE KEEP YOUR RECEIPT AS THIS WILL HELP VERIFY YOUR WARRANTY.

The benefits given to you by this warranty are in addition to other rights and remedies available to you under law in relation to the goods or services to which this warranty relates.

In Australia, our goods come with guarantees that cannot be excluded under the Australian Consumer Law. You are entitled to a replacement or refund for a major failure and compensation for any other reasonably foreseeable loss or damage. You are also entitled to have the goods repaired or replaced if the goods fail to be of acceptable quality and the failure does not amount to a major failure.

In New Zealand this warranty is additional to the conditions and guarantees of the Consumers Guarantee Act (1993).

Ausclimate – New Zealand

CDB Media Ltd.
PO Box 100-707
N.S.M.C
Auckland

Phone 0800 232 633
www.ausclimate.co.nz

Ausclimate – Australia

CDB Goldair Australia Pty
PO Box 574
South Morang
Victoria, 3752

Phone 1800 122 100
www.ausclimate.com.au

Ausclimate Seven Year Warranty (IMPORTANT: Please complete and retain this warranty card)

Name

Address

Place Of Purchase

Date Of Purchase

Name Of Product

Model Number

Attach a copy of the purchase receipt to this warranty card



healthy indoor climate solutions

CDB  GROUP

Australia
PO Box 574,
South Morang,
Victoria, 3752
www.ausclimate.com.au

New Zealand
PO Box 100707,
North Shore Mail Centre,
Auckland, 0745
www.ausclimate.co.nz