



A. EQUIPMENT AND MATERIALS:

- Level or laser – to measure flatness of wall(s).
- Protective Gloves – wear when handling panels.
- Safety Goggles/Glasses – wear during installation.
- Workbench – large enough to accommodate panel size.
- Table Saw, Circular Saw or Track Saw – with cutting guide, the guide should be long enough to cut the length of the panel board. The blade must be suitable for cutting wood.
- C-clamp(s) – to pin the panel to the work surface during cutting.
- Construction adhesive – fast acting, to adhere panel to wall.
- Silicone – to fill in gaps between wall and panel edges and between panels (if necessary).
- Caulking gun – for applying silicone.
- Masking tape – to protect panel during cutting & to protect panel and wall edges from extra silicone and putty knife.
- Plastic Putty Knife – to remove extra silicone.
- 1/16th inch spacers – to apply between mounted panels and the floor/ceiling.
- Electric Drill – only needed if you need to drill holes or make quick cuts for sockets, light switches etc. Steel drill bit is recommended.
- 120 Grit Sandpaper – to sand out edges on the cuts you have performed.

B. BEFORE INSTALLATION:

1. Due to large panel size, consider the following:
 - Confirm route to panel installation location & ensure panel can be transported to location without being damaged.
 - At least 2 people are needed for proper installation.
 - Confirm if product meets relevant requirements of where you want to install.
 - Ensure a large and safe working area.
2. Use a level or laser to measure flatness of wall(s) used for installation. The allowable tolerance is 1/8th of an inch (3 mm). **(Figure 1)**
3. Ensure the installation wall(s) are dry and free of dust, grease & any other substances that could compromise the bonding of the adhesive to the wall(s).
4. Be aware of the order and orientation of the panels you are installing so that your wall design is executed correctly.
5. Ensure that panels are in good condition.

C. TRANSPORT AND HANDLING (Figure 2):

1. At least 2 people are needed to transport and handle the panels.
2. To prevent damage, support panel on the ground with a soft object and always place it on a flat edge. Avoid putting panel on the ground at the corner.
3. Move the panel perpendicular to the floor to prevent bending.
4. Work in an open and safe area as close as possible to installation location.



Installation Tips / Conseils D'installation

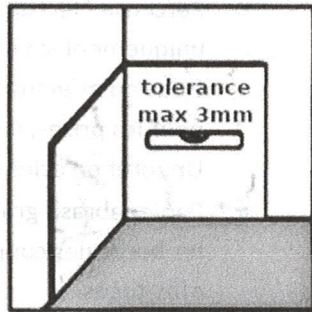

Figure 1

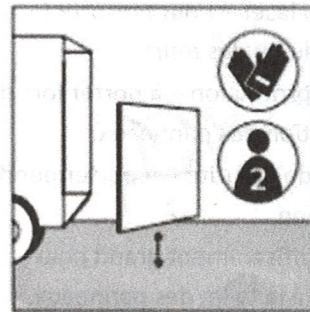

Figure 2

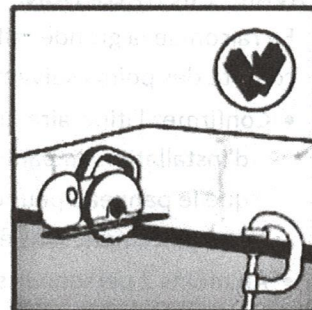

Figure 3

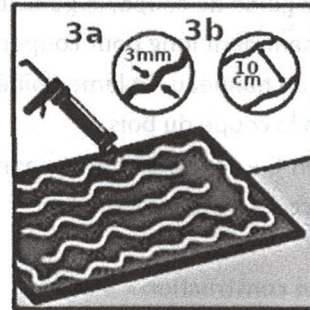

Figure 4

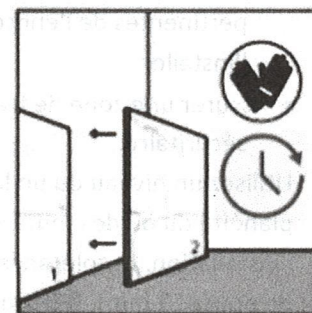

Figure 5

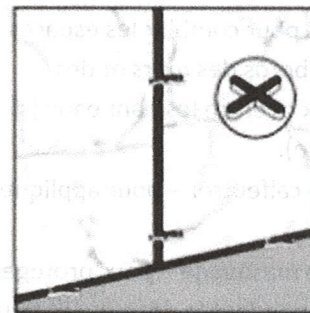

Figure 6

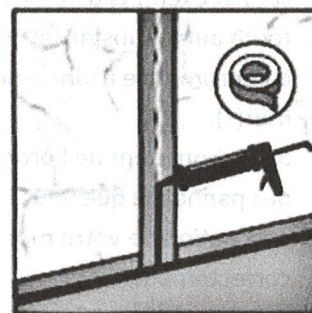

Figure 7

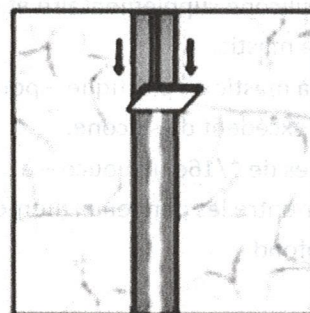

Figure 8