

Use & Care Manual

WARM TIPS

Please keep this manual for future reference and read it before assembly. If any question still exists, please feel free to contact us via [service@xmcossy.com] for customer services.

INTRODUCTION

Landscaping is a great way to add some curb appeal and beauty to your home, a good solar spotlights is essential in the evening.

XMCOSY+ Solar Spotlights is a perfect choice to showcase your beautiful gardens with the amount of details and design which you put in.

The solar panel adopted the photographic technology to auto detects light, therefore, it turn-off automatically when there is bright, and light-up when the environment is not bright enough.

Once it starts charging during daytime, the conversion of solar lights or energy to electricity take place. The energy get stored to the built-in battery.

Operating hours depends on the quality of sunlights, charging hours and lighting mode. During night time or when the surrounding is dark, and there is no shade above the solar panel, the unit will turn itself on.

The solar spotlights have 3 modes and you can switch to the dim light mode or bright light mode by pressing the back button.

The spotlights comes with wall mounting interface as well as a ground spike, which is perfect to be stuck into the ground or mounted on the wall without wire required and without electricity consumption.

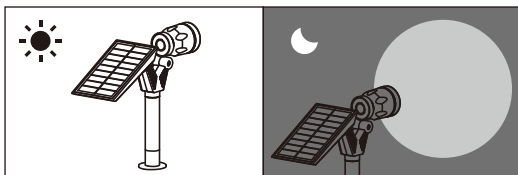

⚠ Please carefully read all the instructions before assembly. Failure to do so may result in faulty assembly and potential injury.

FUNCTION:

The built-in solar panels convert sunlight into electricity. The rechargeable battery stores the energy and converts power into light for use during the night.

The lighting hours of the solar spotlight depends on the geographical location and weather condition. Stronger or longer exposure to sunlight enables the battery to store more energy and provide longer lighting hours.

LOCATION:

It is important to charge the light in direct sunlight for more than 8 hours each day.

Make sure not to place the solar spotlights in the shadow of trees, eaves, buildings, or other external light sources, such as street lights or porch lights which may cause the solar lights to turn off automatically.

CLEANING AND MAINTENANCE:

Please clean the solar panel with a damp cloth. Do not use any chemical or abrasive cleaners. Prevent moisture from entering the solar panel unit.

Replacement parts may be ordered by using the fixture model number and part's name.

RECHARGEABLE BATTERY:

This product contains Long Lasting and Quick Charging Battery. When the battery expires, it must be recycled or disposed of properly. Please contact your local waste disposal authority for the correct procedure. Do not put the battery into fire.

WHAT IN BOX

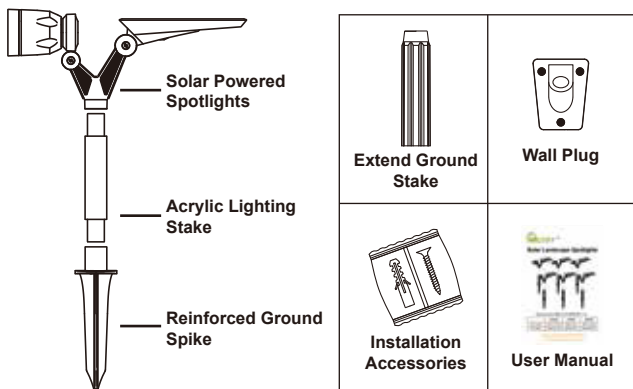

SPOTLIGHTS OVERVIEW



SPECIFICATION

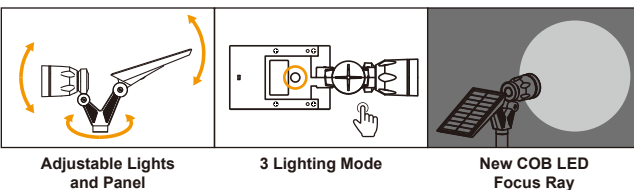

Brand	XMCOSY+
Model	XMGYS-W-02 ; XMGYS-W-04 ; XMGYS-W-06 XMGYS-C-02 ; XMGYS-C-04 ; XMGYS-C-06
Solar Panel Type	4.5V 2W Polycrystalline Silicon Solar Panel
Switch	<ul style="list-style-type: none"> ☞ ×1 Smart IC Auto Mode; ☞ ×2 Low Brightness Mode; ☞ ×3 High Brightness Mode; ☞ ×4 TURN OFF
Adjustable Panel	Horizontal 360°; Solar Panel 210°; Spotlight 180°
LED	Smart Auto Control IC of COB LED
Color Temperture	Warm White: 3000K / Cool White: 6500K
Charging Time	6-8 Hours under Direct Sunlight
Working Time	<ul style="list-style-type: none"> 6-10H IC Auto Mode 8-10H Low Brightness Mode 6-8H Hight Brightness Mode
Lighting Feature	Warm White Color + Brightness Mode Control Cool White Color + Brightness Mode Control
Assembled Height	47.5cm / 18.7inch
Waterproof Class	IP65

HOW TO OPERATE

The solar powered spotlights default mode is OFF, press the back button to switch your preferred mode when using the spotlight and it will remember your setting.

Step 1: place the solar spotlights in direct sunshine for at least 8 hours to charge completely.

Step 2: Press the button for mode setting. [Press once for Smart IC Auto Mode; Press twice for Low Brightness Mode; Press 3 times for High Brightness Mode; Press 4 times to turn off.]

Note: As a solar powered product, the working time is ENTIRELY weather sensitive. Other factors include: illumination intensity geographical location and sunshine duration, etc.

Choose your lighting mode with the back button. Then install the solar spotlights in an area where it gets direct sunlight, please make sure there is NO shadow or obstruction above the solar panel.

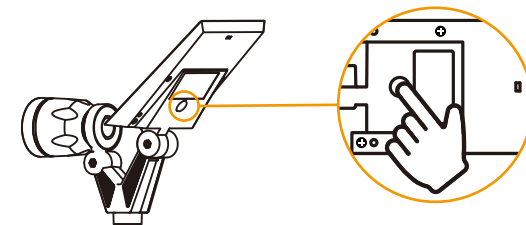

☞ ×1 Smart IC Auto Mode; ☞ ×2 Low Brightness Mode;
☞ ×3 High Brightness Mode; ☞ ×4 TURN OFF

INSTALLATION METHODS

METHOD 1 : Ground Inserted

- 1 Insert the ground stake to the spotlight and adjust the solar panel and LED spotlights angle by loosening and tightening to get enough sunshine during the day and to meet different lighting angle.
- 2 Insert the entire spotlights into the ground vertically.

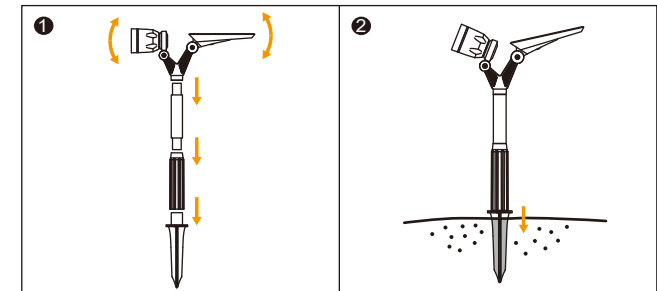

NOTE: You can choose whether you need to install the extend ground stake or not.

METHOD 2 : Wall Mounted

- 1 Punch three holes with drill bit on the wall that is exposed to sunlight.
- 2 Insert the attached wall pillar hinge into three holes.
- 3 Twist the screw through the screw holes of holder into the wall plugs for a tight seal.
- 4 Adjust the installation to get the perfect position and the angle of the light and the solar panel.

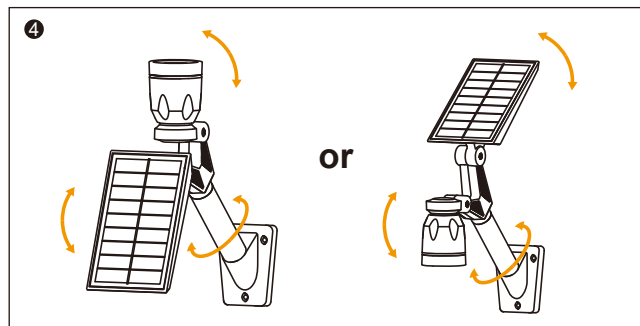
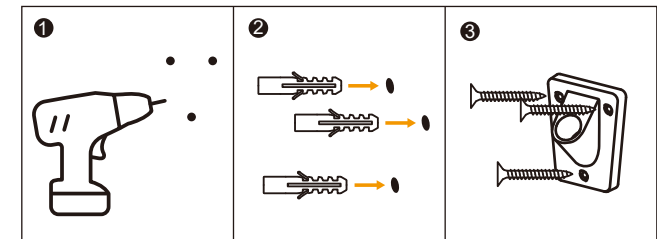

TROUBLESHOOTING

The light does not come on at night:

- ✓ It is recommended to charge the spotlights under direct sunlight for 1-2 days before the first use to make sure the spotlights have enough power.
- ✓ To assess if the product functions or operates well, please turn it on by pressing the back button, then cover the solar panel with your hand or any dark close during the day. You may also bring it in a dark to test the light or change the settings. (Auto / Low Light / High Light / OFF)
- ✓ Please make sure install the solar spotlights in an area where there is enough direct sunlight. Avoid shadow or obstruction above the solar panel.
- ✓ When the switch is at the "Auto" state, the spotlight will automatically detect the capacity of the battery and automatically adjust the brightness to ensure that the spotlight can provide sufficient lighting.
- ✓ When the switch is at the "LOW" state, light intensity is weaker. When the switch is at the "HIGH" state, the light intensity is stronger.
- ✓ Charge the solar spotlights by placing it under direct sunshine for at least 8 hours.
- ✓ Illumination time after fully charged: about 6-8 hours at "HIGH" level, 10-12 hours at "LOW" level.

At XMcosy+, we provide a complete line of lighting products
 Suitable for porches, terraces, and landscaped areas to make your home safe and attractive.
 XMcosy+ always believes that good design could make life easier and delighter. Just like what we did, our XMcosy+ Outdoor Lighting was born for cozy, smart, and stylish life!



After-sales service



Shop in Amazon



Lighting Expert, Brighten up Your Life

If there is any problem with our product or you unluckily receive a defective product



YOU DON'T NEED TO RETURN IT TO AMAZON
 WE WILL PROVIDE YOU A 100% SATISFIED SOLUTION

[service@xmcosy.com]
 or scan the QR code



Solar Landscape Spotlights



Choose your Lights from XMcosy+ at:

	2 PACK	4 PACK	6 PACK
Warm White	XMGYS-W-02	XMGYS-W-04	XMGYS-W-06
Cool White	XMGYS-C-02	XMGYS-C-04	XMGYS-C-06

Need any help from XMcosy+?
 Email: service@xmcosy.com