



Quick Glance User Guide



The Athena low air loss mattress system is a high quality air support surface suitable for individuals with up to and including grade 4 pressure ulcers, needing frequent monitoring and positioning. A controlled rate of air escaping through the air cells is intended to reduce excess moisture between the patient and mattress to minimise the risk of skin breakdown and to provide a cooling effect to the body. Via the pressure distribution in the air cells the mattress forms around the pressure points of the body providing comfort and pressure reduction to vulnerable tissue.

Contraindications: Appropriate advice should be taken for patients with unstable spinal injuries. Do not use the mattress if the patient and accessories exceed patient weight limit (MUW).

- Place mattress directly onto the mattress platform ensuring umbilical cord is at foot end and 'feet' symbol is facing up.
- Attach straps to moving parts of bed frame making sure they are not twisted. (Fig. 1)
- Position control unit on foot board of bed using the integral brackets or on a firm surface. (Fig. 2)
- Attach umbilical cord to control unit by aligning with the port on control box and pushing into place.
- Attach pump power lead to mains power outlet (Fig. 3)
- Switch on.
- The low pressure indicator will illuminate whilst it is inflating, which will take approximately 2-3 minutes.

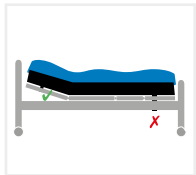

Fig. 1

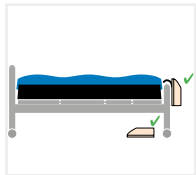

Fig. 2

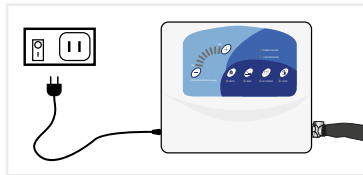

Fig. 3

Leaflet Code: LL280

Need Assistance?

Call 01422 233 136 (8:30am - 5pm)

or 0800 037 0234 (out of office hours)

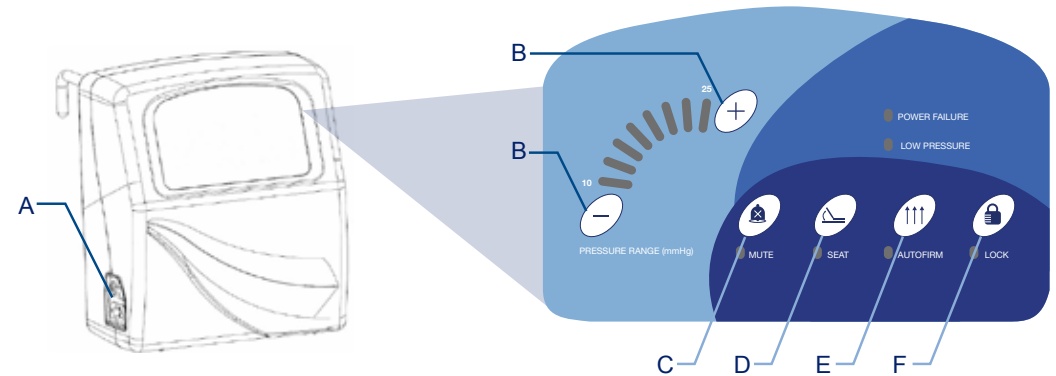

Operation

A. Power

The switch on the side of the pump turns it on/off. When switched on an audible signal will sound for a brief period and the switch illuminates green.

B. Pressure Range

Press + or - to increase or decrease the pressure setting depicted on the pressure scale. There are 8 available pressure settings from soft to firm (10mmHg to 25mmHg, ±2mmHg per step). The green lights illuminate on the pressure scale to indicate what pressure setting has been chosen..

C. Mute

Mutes the audible signal for a 30 minute period. The mute setting will self-cancel after 30 minutes and the audible signal will re-sound. Note: If the 'power failure' indicator activates the mute button will not silence the audible signal. To silence, the on/off switch on the control unit must be set to 'off'. Please ensure it is turned on again to inflate the mattress.

D. Seat

Increases the pressure in each cell by 5mmHg. The 'seat' mode prevents the patient from bottoming out when the patient is in a sitting position. When in 'seat' mode an amber indicator illuminates. Re-pressing the button cancels 'seat' mode.

E. Autofirm

Automatically inflates the mattress to a maximum level of 45mmHg to aid patient transfers. When in 'autofirm' mode an amber indicator illuminates.

'Autofirm' self-cancels after 30 minutes and returns to the previous pressure setting. Re-pressing the 'autofirm' or pressure adjustment buttons cancels 'autofirm' mode.

F. Lock/unlock

The control unit will automatically lockout all functionality 2 minutes after a function change. To unlock the control unit the 'lock' button is pressed for 2 seconds. To reengage the lock the button can either be again pressed for 2 seconds or the user can wait for the automatic lock to re-engage. When the system is locked an amber indicator illuminates.



Quick Glance User Guide



CPR

Rapid deflation of the mattress may be required for emergency treatment or system deflation.

Press the button on the connector and while holding down pull the air pipe off the receptacle on the side of the control unit.

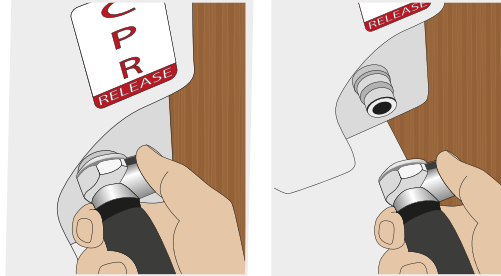

Trouble Shooting - Fault Indicators

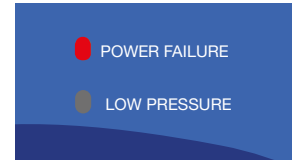

Power failure:

A red indicator illuminates and an audible signal sounds if a power failure occurs. Check mains cable is plugged in and switched on. Check mains cable is attached to the pump.

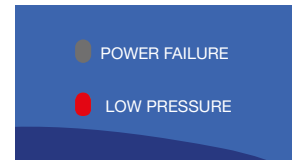

Low pressure:

A red indicator illuminates and an audible signal sounds if the pressure becomes unacceptably low. Ensure the mattress air connector is correctly connected to the control unit.

Leaflet Code: LL280

Need Assistance?

Call 01422 233 136 (8:30am - 5pm)

or 0800 037 0234 (out of office hours)