

Surface-mounted Installation Instructions of LED Linear

(一) Installation kits



Ceiling mounting bracket A
2PCS



Self-tapping KA3.5*25 screw
4PCS



Self-tapping PM3*8 screw
4PCS



Plastic expansion tube
4PCS



Ceiling mounting bracket B
2PCS

(二) Single LED Linear Mounting Space and Steps

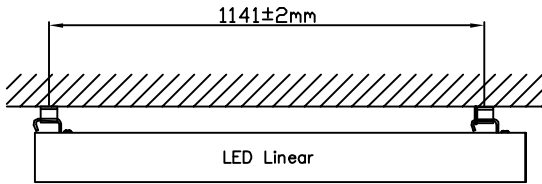

Distance between two drilling holes

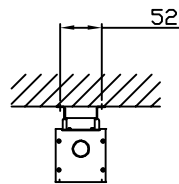

<p>①</p> <p>1. Drill two desirable holes on the ceiling as shown above and the holes should match with M6-M8 self-tapping screw.</p>	<p>②</p> <p>2. Tap the plastic expansion tube into the hole.</p>
<p>③</p> <p>Ceiling mounting bracket A</p> <p>3. Let KA3.5*25 screw go through ceiling mounting bracket A and inserted into plastic expansion tube</p>	<p>④</p> <p>Ceiling mounting bracket B</p> <p>4. Fixate ceiling mounting bracket B to linear by supplied PM3*8 screw. Pay attention to the bracket's direction.</p>
<p>⑤</p> <p>LED Linear</p> <p>Break through the hole</p> <p>5. Break through the hole of the side cover by cutting nipper.</p>	<p>⑥</p> <p>Front cover</p> <p>6. Remove the front cover by tools</p>

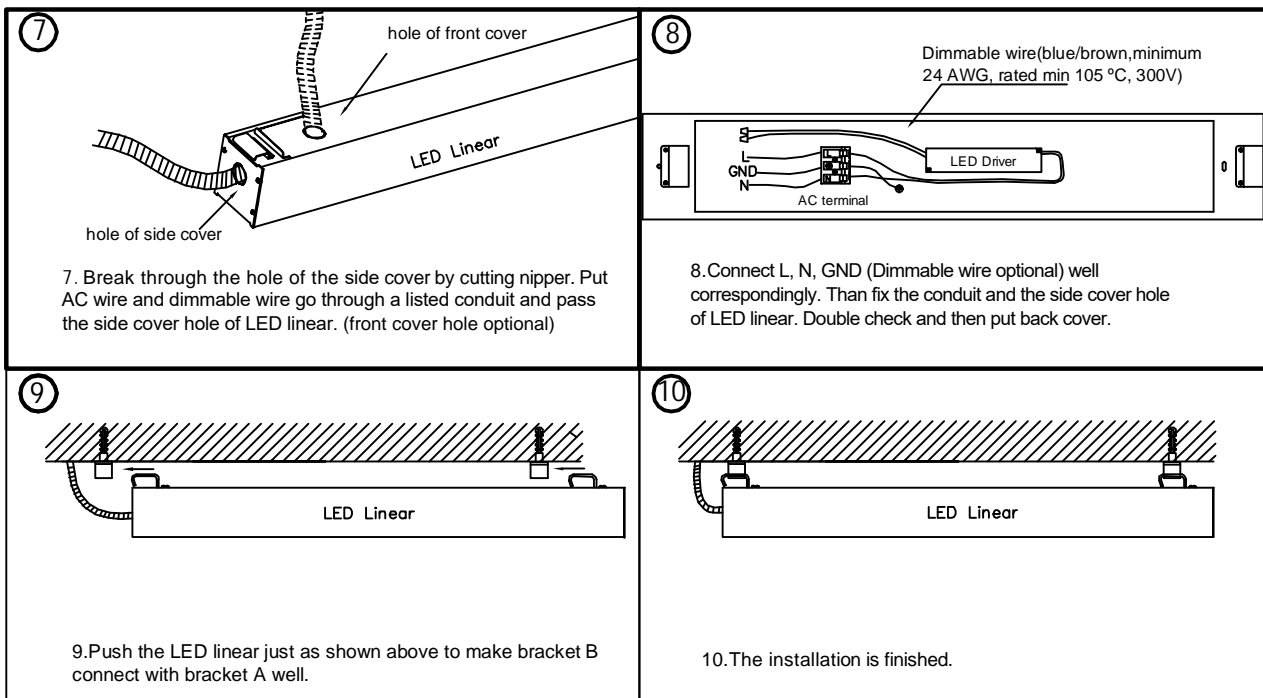

(三) Row LED Linear Mounting Space and Steps

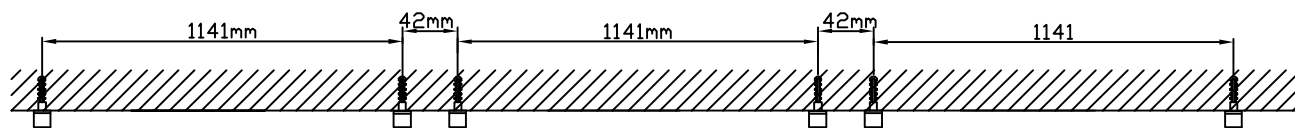

Distance between two drilling holes in row linear

1 1. Drill desirable holes on the ceiling as shown above and the holes should match with M6-M8 self-tapping screw. Tap the plastic expansion tube into the hole.

2 3. Let KA3.5*25 screw go through ceiling mounting bracket A and inserted into plastic expansion tube

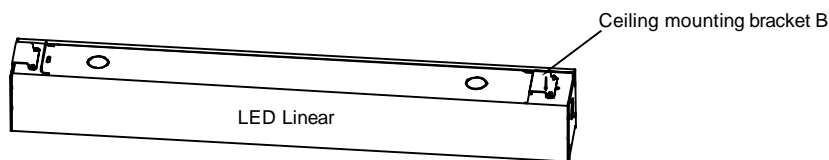

3 4. Fixate ceiling mounting bracket B to linear by supplied PM3*8 screw. Pay attention to the bracket's direction.

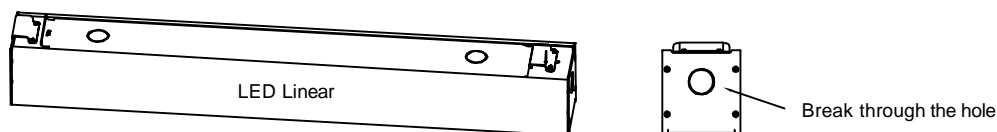

4 5. Break through the hole of the side cover by cutting nipper. Take out the dimmable wire through the hole to make wire connection easy.

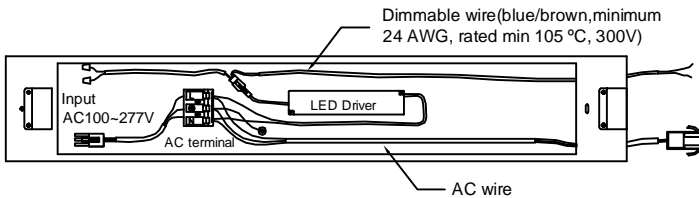

5 Remove the front covers firstly. Take out the AC wire and dimmable wire through side hole to make wire connection easy.

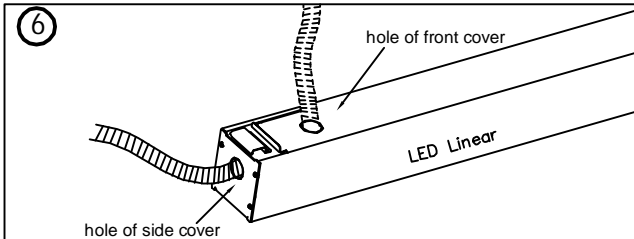

6. Break through the hole of the side cover by cutting nipper. Put AC wire and dimmable wire go through a listed conduit and pass the side cover hole of LED linear 1. (front cover hole optional)

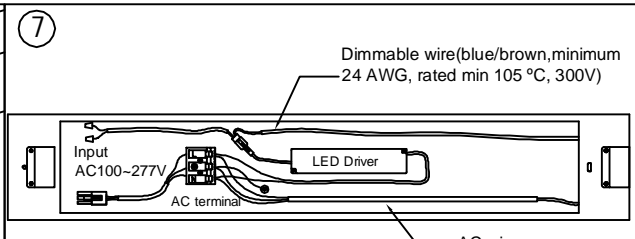

7 Connect L, N, GND (Dimmable wire optional) well correspondingly. Than fix the conduit and the side cover hole of LED linear 1. Double check and then put back cover.

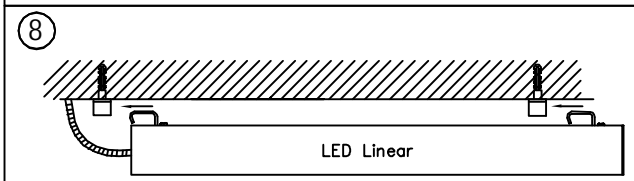

8. Push the LED linear just as shown above to make bracket B connect with bracket A and sure fix well.

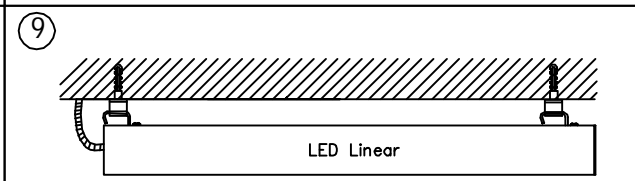

9. The LED linear1 installation is finished.

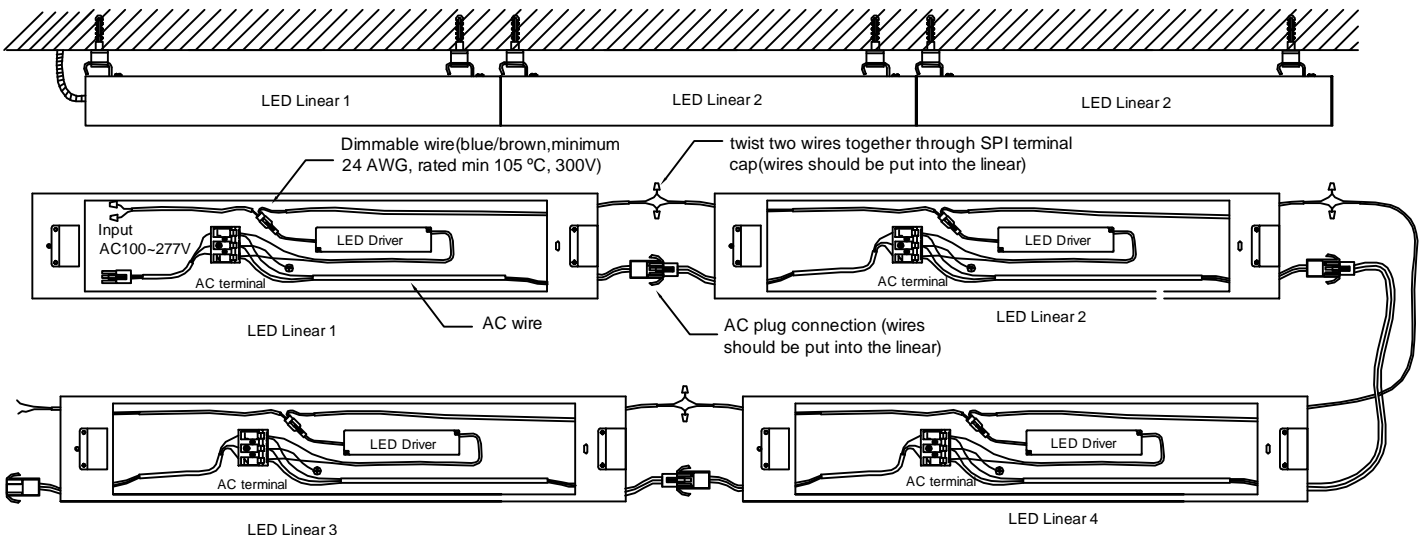

Connection Diagram

The two LED linears should be chained closely.

10 Install needed linears just as shown above. Put back wire into either side linear after connection

- ▲ Make sure power off before installation or disassembly.
- ▲ Chain-hanging: LED Linear can be jointed together as needed, but the total number of fixtures should be no more than 7 pcs (including 7 pcs).
- ▲ Two workers are needed to install the linear.
- ▲ The hole of front cover and hole of side cover are open only if needed.