

# I-ME (Illumination-Made Easy) BLUETOOTH ENABLED LED PANEL LIGHT



Customer safety and satisfaction is paramount at LED Waves.

To ensure optimum performance and safe usage of our products:

- Please read through the instructions first and save for reference throughout the installation process.
- Make sure the electrical switch is OFF before connecting to the power supply to prevent electric shock.
- We recommend installations be performed by a licensed electrician.
- Please note, warranty will be voided if instructions are not followed.

## LED Panel Light

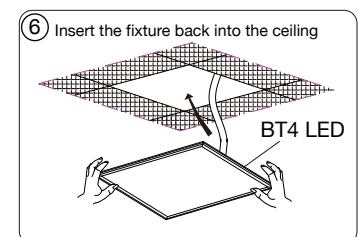
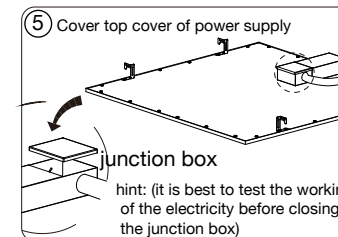
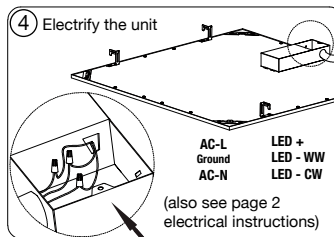
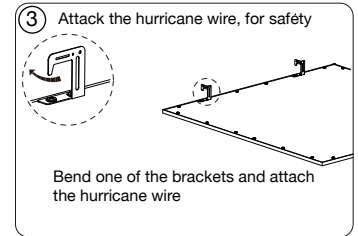
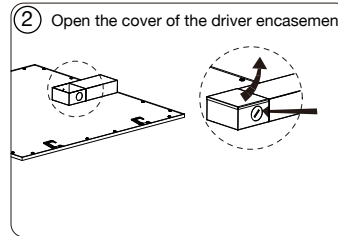
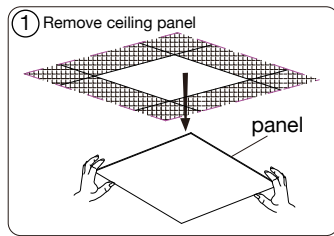

Note (if required by your local code you can use the L frame bracket hooks with the safety wire (provided by LEDWaves).



### Electrification diagram

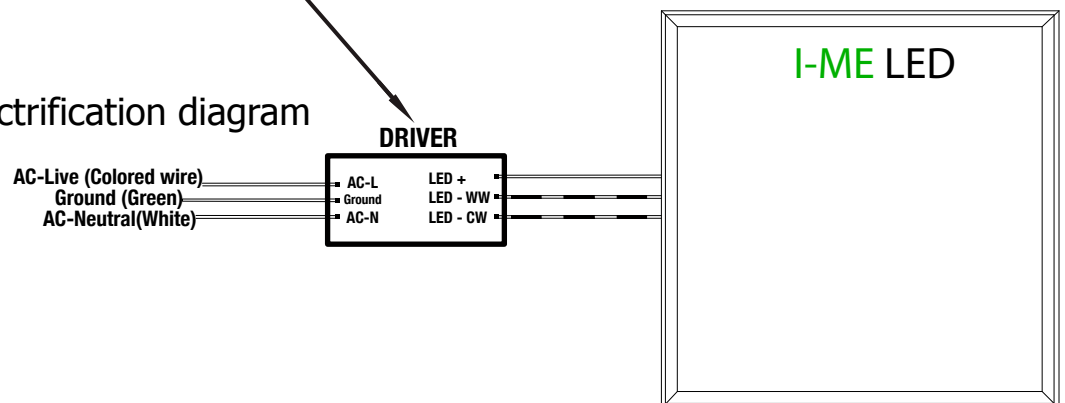

# I-ME (Illumination-Made Easy) BLUETOOTH ENABLED LED PANEL LIGHT

The panel light is controlled via a bluetooth signal powered by a Smart wireless LED driver.

- Support iOS and Android applications.
- Permits remote, one touch control through devices such as smartphones and tablets, digitally control dimming and color temperature.
- Handheld Remote Controller sets lights to your specifications anywhere in your home.
- Easy to use Wall Remote Controller offers instant illumination and ambience control.
- Color Temperature Control (CCT).
- Dimming capabilities for optimum energy usage.

## LED Panel Light



### Electrical Connection

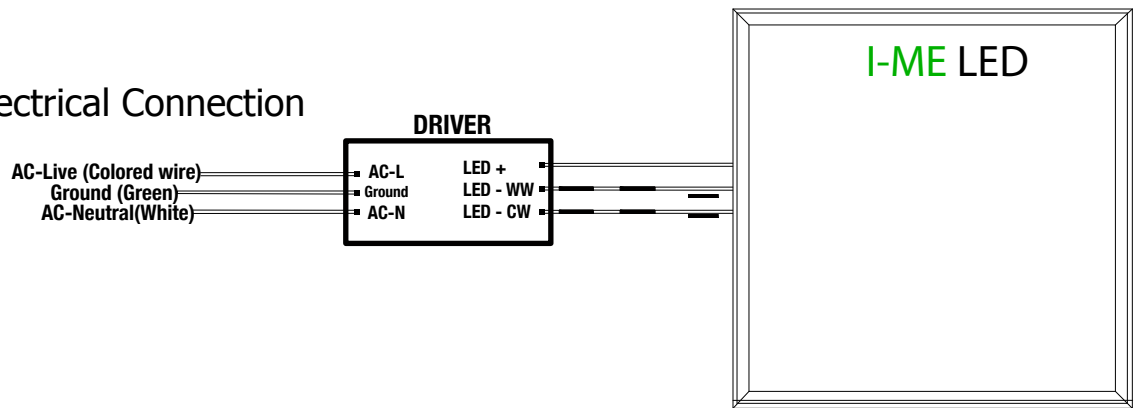

### Specifications

Model Number	Size (feet)	Watts	System	
SL6-2x2-40W-BT	2x2	40W	Bluetooth	
SL6-1x4-40W-BT	1x4	40W	Bluetooth	
SL6-2x4-50W-BT	2x4	50W	Bluetooth	
SL6-HW-RCWPS			Wall remote	
SL6-HW-RCHH			Hand remote	

- \* Voltage = AC100-277V
- \* Power factor = 0.95
- \* Hertz = 50/60 Hz
- \* CRI = 80
- \* Beam Angle = 110°

### Specifications (Nominal CCT)

Model Number	Size (feet)	Color temp	Kelvin	Watts	Lumens ±10%	System
SL6-BT-2x2	2x2	Warm White	3000	40W	4000	Bluetooth
		Day Light White	4000	40W	4140	
		Cool White	5000	40W	4120	
SL6-BT-1x4	1x4	Warm White	3000	40W	4040	Bluetooth
		Day Light White	4000	40W	4120	
		Cool White	5000	40W	4140	
SL6-BT-2x4	2x4	Warm White	3000	50W	5050	Bluetooth
		Day Light White	4000	50W	5150	
		Cool White	5000	50W	5200	

- \* Voltage = AC100-277V
- \* Power factor = 0.95
- \* Hertz = 50/60 Hz
- \* CRI = 80
- \* Beam Angle = 110°

# I-ME (Illumination-Made Easy) BLUETOOTH ENABLED LED PANEL LIGHT



## Bluetooth wireless applications

1. Control the panel light with the Smartphone/tablet application

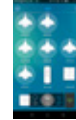

2. With the remote controller, (see specs)



3. With the wall controller, (see specs)



## LED Panel Light



SL6-BT4-2x2-40W  
SL6-BT4-1x4-40W  
SL6-BT4-2x4-50W

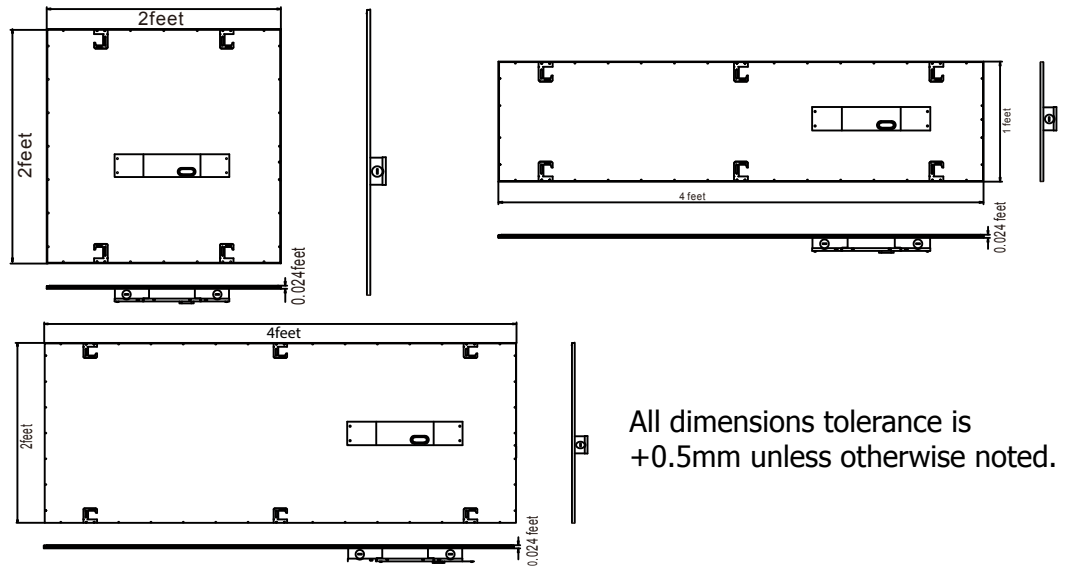

The information contained on our product packaging, spec sheets, instructional guides, any marketing materials and on our website, [www.ledwaves.com](http://www.ledwaves.com) has been thoroughly vetted to the best of our ability and are obtained from sources believed to be reliable.

Damages arising from errors and/or omissions as a result of the use or misuse of the data or information contained at [www.ledwaves.com](http://www.ledwaves.com) or on our packaging are not the responsibility of LED Waves. Where noted, LED Waves offers a five-year limited warranty to the original purchaser and it is the option of LED Waves to repair or replace a defective LED product that has not been misused or improperly installed.

All specifications are subject to changes without notice.

All information contained at [www.ledwaves.com](http://www.ledwaves.com) is published for professionals seeking information about the subjects contained therein. It is not the intent of LED Waves to provide professional services such as design, engineering or consulting.

If these services are sought, they should be rendered by properly trained, registered, regulated and insured professionals.



*LedWaves* **Waves Of The Future**

Customer safety and satisfaction is paramount at LED Waves.

Please do not hesitate to contact us

TOLL-FREE at  
**1-800- 986-0169**

**Professional grade technical support  
and Consultations**

**LED Waves** is a Service Disabled Veteran Owned Small Business.

