

# EasyStand<sup>®</sup> Evolv<sup>®</sup>

PNG50162-1 Medium, PNG50084-1 Large & PNG50209-1 XT  
Assembly Manual



Please ensure the Assembly Manual stays with the unit at all times.

# SYMBOL/LABEL LEGEND



**CAUTION/WARNING/ATTENTION**



**TYPE BF APPLIED PART**



**PINCHPOINT**



**HUMIDITY**

**SN**

**SERIAL NUMBER**

**CE**

**CONFORMITÉ EUROPÉENNE**

**MD**

**MEDICAL DEVICE**



Waste of electrical and electronic equipment must not be disposed as unsorted municipal waste. It must be collected separately, and must be disposed as per local regulations. Contact your authorized representative for information concerning the decommissioning of your equipment.



**TEMPERATURE**



**DATE OF MANUFACTURE**



**SEE INSTRUCTIONS FOR USE**

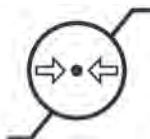

**ATMOSPHERIC PRESSURE**



**MANUFACTURER**

**Rx only**

**PRESCRIPTION ONLY**



**POTENTIALLY HOT SURFACE**

Accessible surfaces which may exceed 105°F/41°C and could be a hazard to persons with skin damage or not having sensation.

## CERTIFICATION LABEL/UNIQUE DEVICE IDENTIFICATION LABEL

Manufacturer: Altimate Medical, Inc 262 West First Street Morton, MN 56270 507-697-6393	2021
<b>SN 0000000000</b>	
<b>00000000000000000000</b>	
Model: Height Range: Max. Weight Limit:	Approx. Max. Mass of Unit & Weight Limit: 0000

Serial Number

Item Number  
Item Description

Unique Identifier

# Table of Contents

<b>Assembly .....</b>	<b>1</b>
<b>Options &amp; Parts Detail .....</b>	<b>21</b>

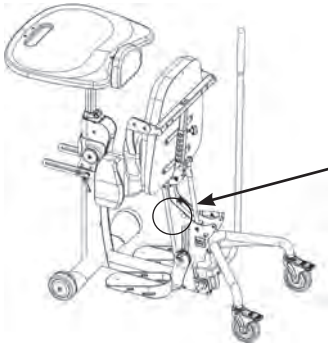

*Note:* The serial number is located under the seat on the seat column.

Date Purchased \_\_\_\_\_ Serial # \_\_\_\_\_

Contact Altimate Medical for any information required prior to purchase. This owner's manual along with other information is freely available by request or by downloading from [easystand.com](http://easystand.com).

# EasyStand® Evolv® Assembly

Videos of EasyStand Evolv assembly & fitting can be viewed at [www.easystand.com/videos](http://www.easystand.com/videos)

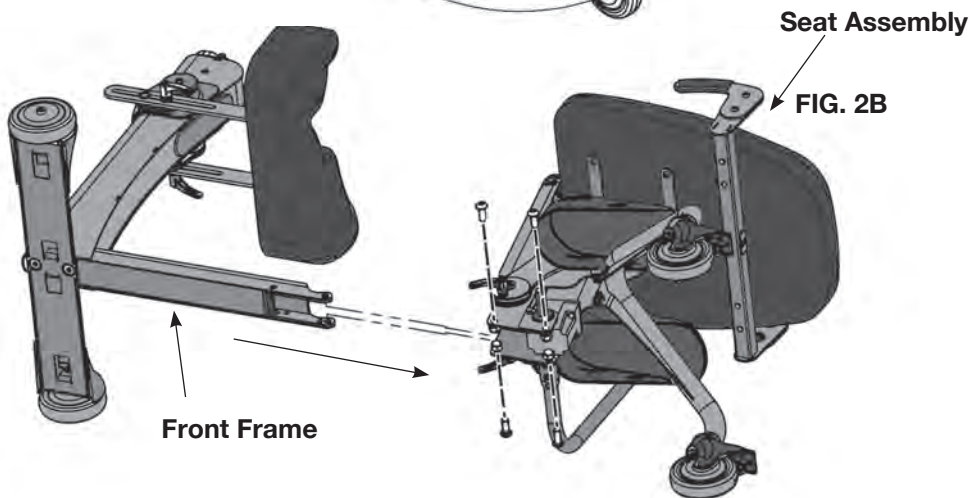
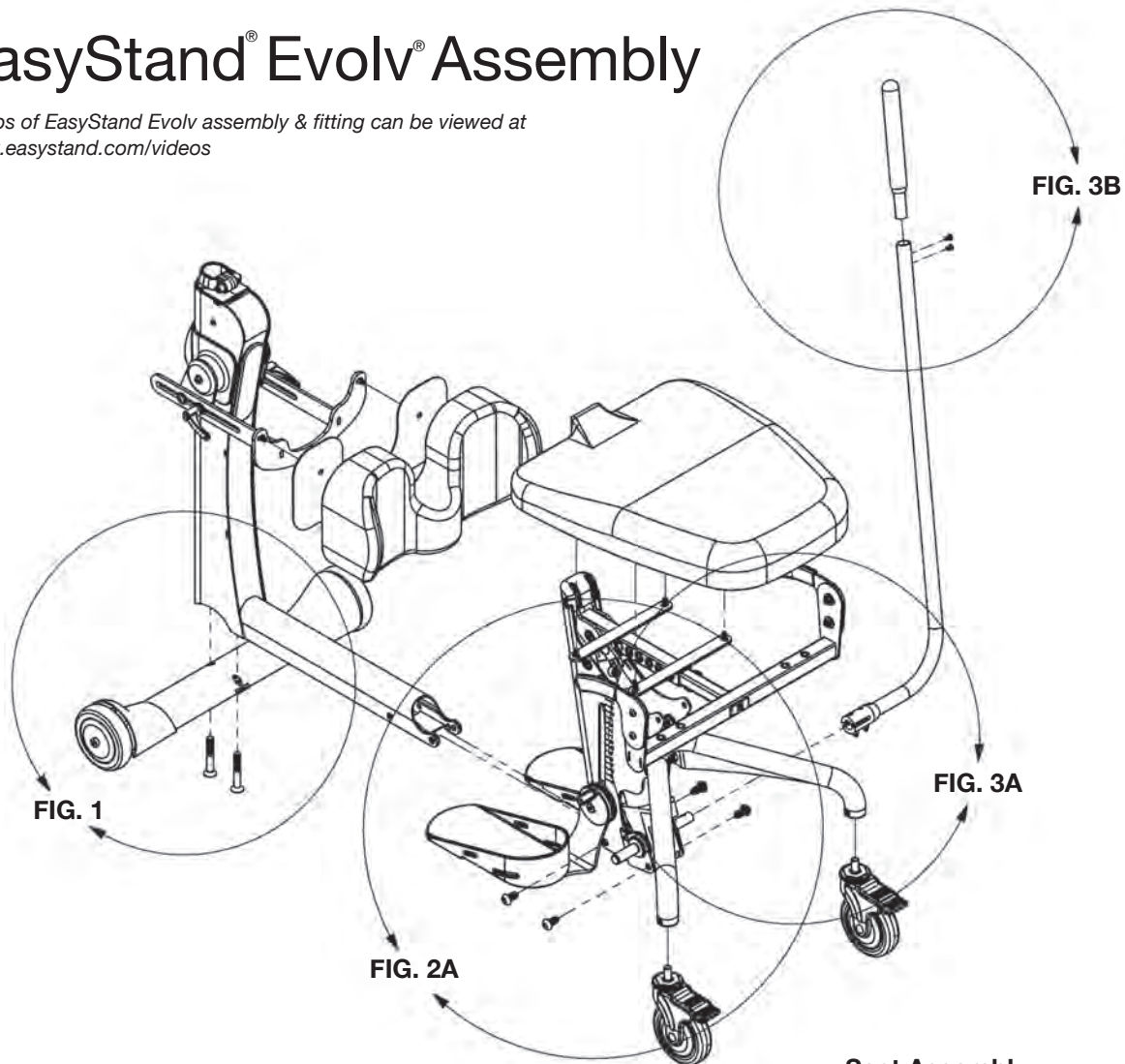

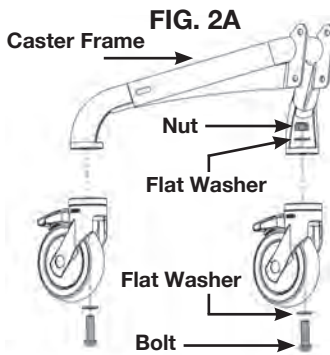

For Mobile assembly refer to p. 9.

**If the Evolv XT was ordered, the unit will be fully assembled except for the tray and back option. Refer to p. 11 for the back option assembly, p. 16 for the tray assembly and p. 7 for the Shadow Tray. For any other option assembly, please refer to pp. 11-19.**

**FIG. 1-** Attach the standard front wheel frame to the front frame with bolts and tighten securely.

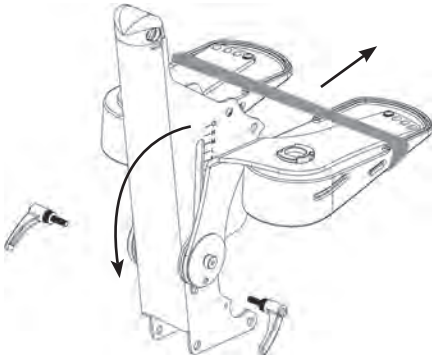

**FIG. 2A-** Remove nut and flat washer from the bolt on the caster. A flat washer will remain on the bolt on the caster. Place caster, bolt, and flat washer into rear caster frame as shown. Place second flat washer that was removed onto the bolt. Place nut onto bolt and tighten securely with wrench and hex wrench provided in the tool kit. Repeat steps for other caster. Ensure the casters are flush with the rear base frame.

**FIG. 2C**

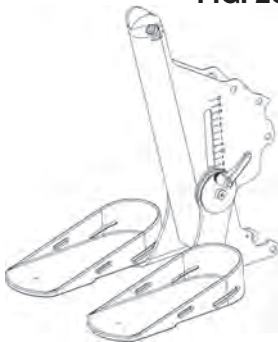
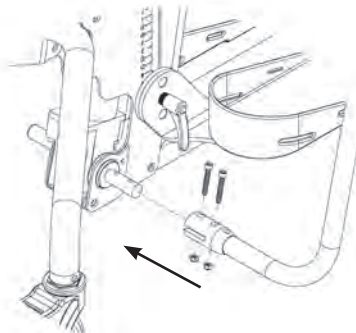

**FIG. 2B-** Place the front frame and the seat assembly on its side, slide the front frame into the opening of the seat assembly as shown. Line up holes and insert all four bolts first, then place nuts onto bolts and tighten securely with hex wrench and 19mm open-ended wrench. Place unit upright on its wheels.

If the Swing-Away Front option was ordered, slide the front frame into the opening of the seat assembly as shown on p. 5, FIG. 7. To help with installation, place folded cardboard or a block of wood underneath the frame for support. Start the four bolts by going in a criss-cross pattern (ex: Start back left bolt then front right bolt followed by back right and front left bolts). Start all four bolts first, then tighten securely.

For more Swing-Away Front assembly, refer to p. 5.

**FIG. 2C-** To flip foot plates down, lift the seat up. Then insert ratchet handles, (located in bag with assembly manual) tighten securely.



**FIG. 3A**

**FIG. 3A-** Attach the pump handle to the pump on the seat assembly with bolts and nuts, tighten securely.

**FIG. 3B-** Insert top of handle into pump handle and tighten bolts securely.

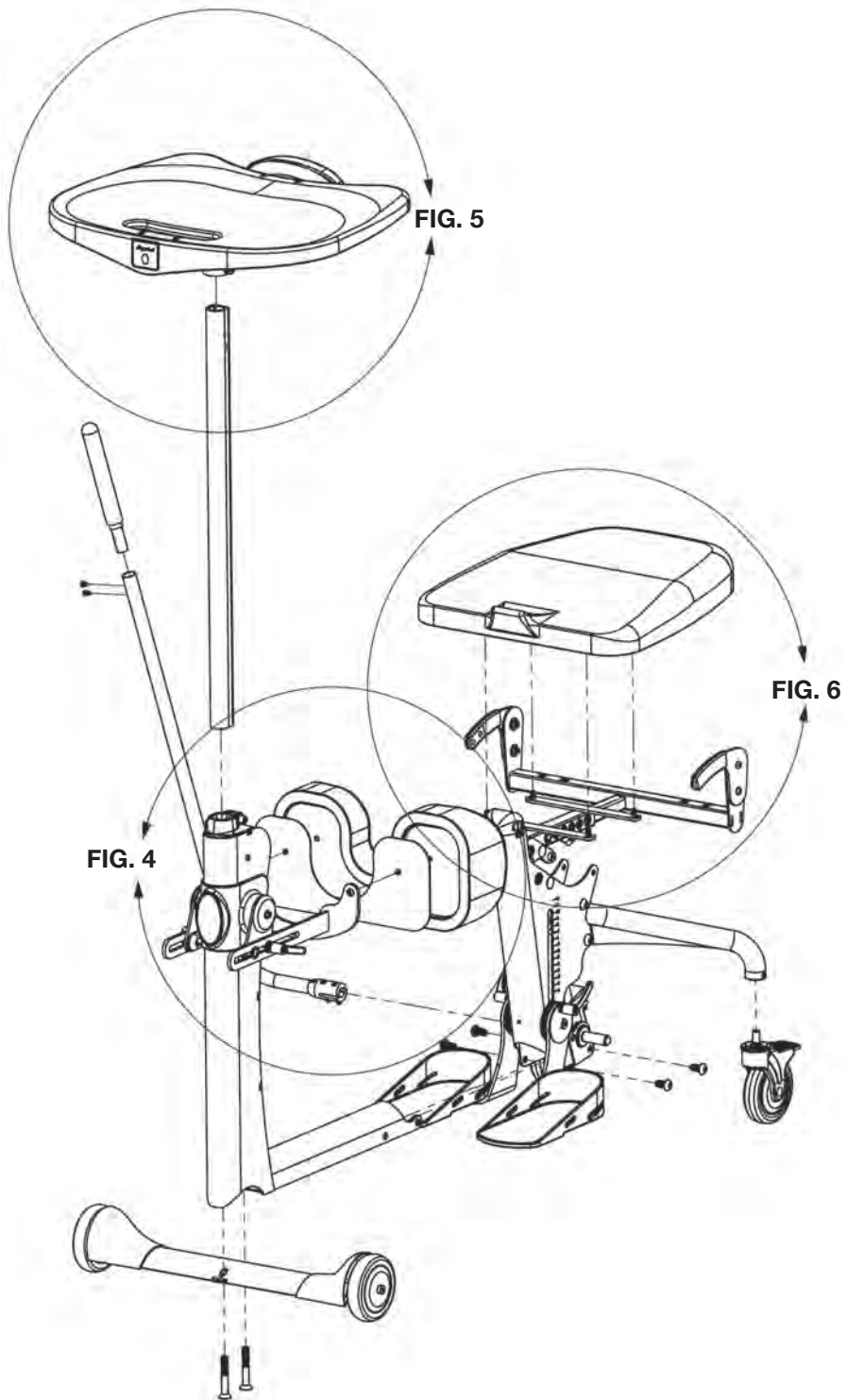



**FIG. 4**

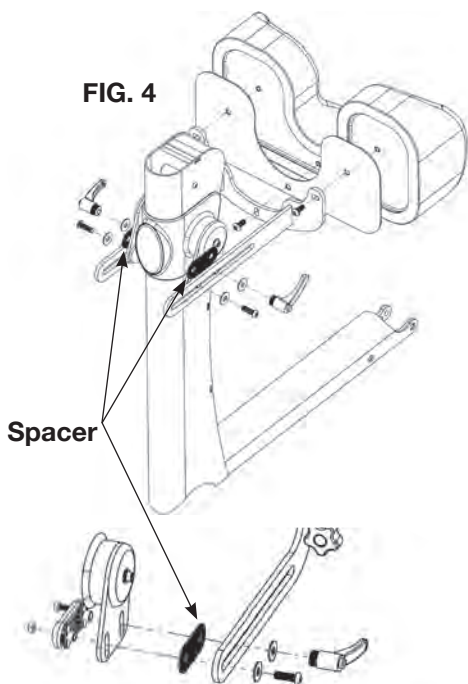

*If the Swing-Away Frame was ordered, please refer to pp. 5-6.  
If the Independent Kneepads were ordered refer to p. 18.*

**FIG. 4-** Remove ratchet handle and hardware from the knee bracket. Place the bracket and hardware onto the column in the order shown. Ensure the spacer is placed between the two steel brackets. Place the washer and bracket bolt into the bracket assembly. Tighten the bolt leaving it just loose enough for the knee bracket to slide freely. Do NOT overtighten bolt. Insert hex bolt into clamp. Place the washer and ratchet handle into the bracket assembly, screw ratchet handle onto hex bolt. Tighten ratchet handle once desired position is reached.

Remove the three bolts from the kneepad making sure the plastic insert stays in place. Place the kneepad onto the bracket and insert top two bolts before inserting the middle bolt. Tighten securely. If the independent kneepads were ordered, place pads into knee bracket, the narrow end of the slotted washer for the knee pads will be inserted into the bracket, make sure the larger end of the pad is on the outside of the unit (see drawing on p. 18).

**FIG. 5**

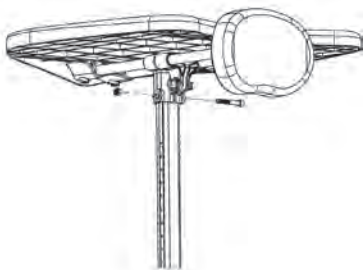

*If the Shadow Tray Frame was ordered, please refer to pp. 7-8.*

**FIG. 4/5-** Insert the tray post into the front column with the holes in the post facing upward. The tray clamp on the front frame may need to be adjusted to fit the tray post into the frame. Place tray onto the tray post, insert nut into slot and bolt into hole, tighten securely.

*If any additional options were ordered, please refer to the drawings on pp. 11-19.*

**FIG. 6-** Install the seat onto the seat assembly after all other options are added. For easier installation, pump the seat halfway up. Start all four bolts first, then tighten securely.

**For Evolv adjustments, see the Instructions for Use Manual.**

# Swing-Away Frame Assembly

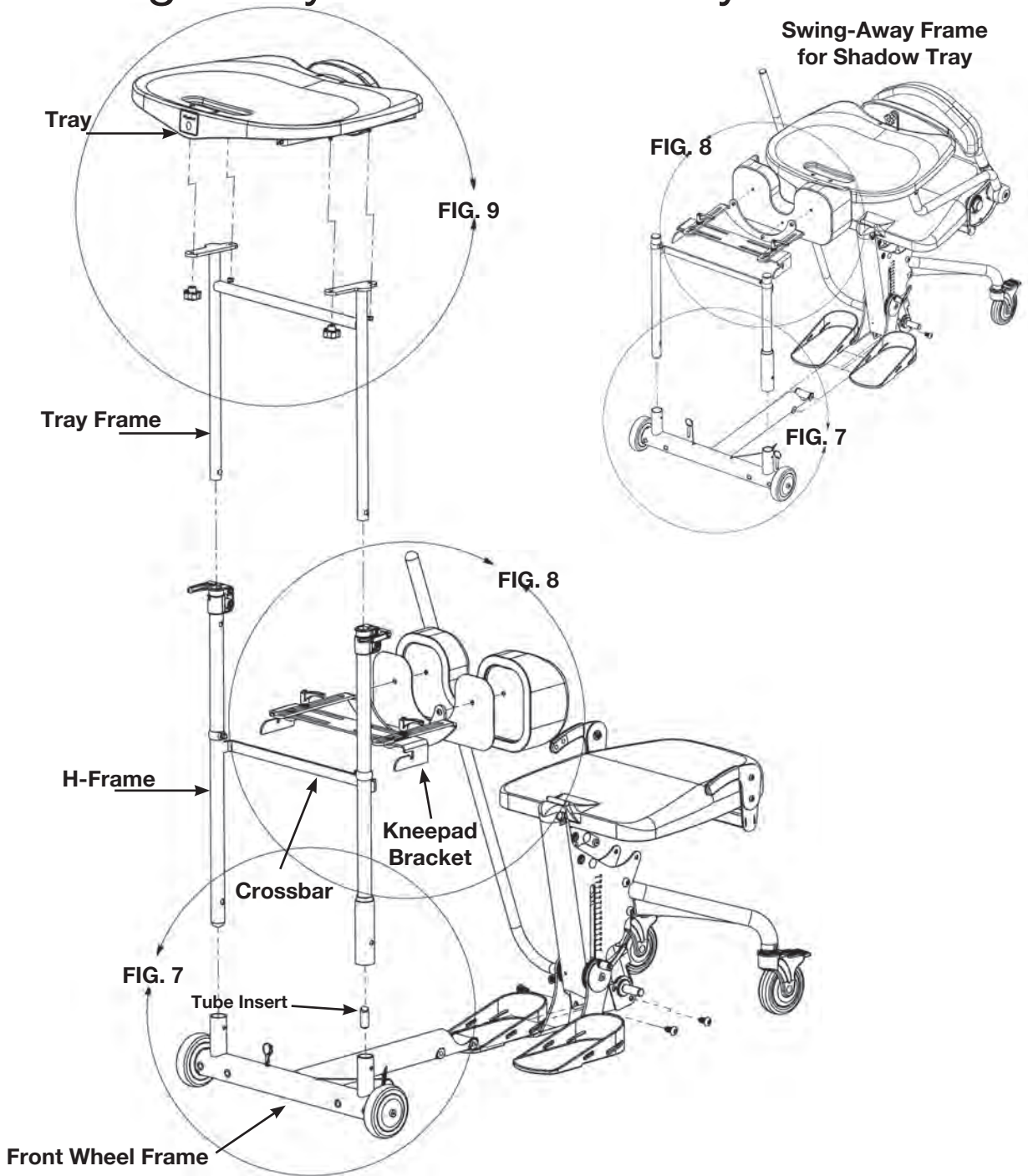



**FIG. 7-** Insert the H-frame into the front wheel frame. Insert pins into the holes provided (crossbar should face seat). Make sure the tube insert is in place as shown.

*If the Front Swivel Casters were ordered refer to p. 17.  
If the Independent Kneepads were ordered refer to p. 18.*

**FIG. 8-** Place the knee pad bracket onto the H-frame. Remove the three bolts from the knee pad making sure the plastic insert stays in place. Place the knee pad onto the bracket and insert the top two bolts before inserting the middle bolt. Tighten securely.

**To use the Swing-Away Front:**

To swing away the front for transferring, remove pull pins from the bottom of the H-frame. Lift collar and swing away. After positioning client in stander, swing front back into front caster frame and replace pins, making sure the collar is secure.

**Caution:** Collar and pins must be securely in place before the user transitions into the standing position.

**For Evolv adjustments, see the Instruction for Use Manual.**

*If the Shadow Tray was ordered, skip to p. 7.*

**FIG. 9-** Insert the tray frame into the H-frame, tighten knobs securely. Place the tray onto the tray frame, install knobs. Tighten nuts securely.

Note: Tray will not move if nuts are overtightened.

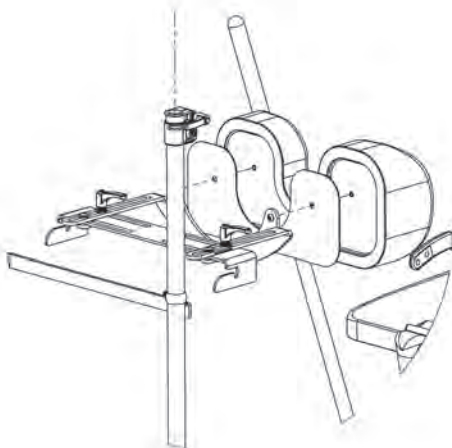

**FIG. 8**

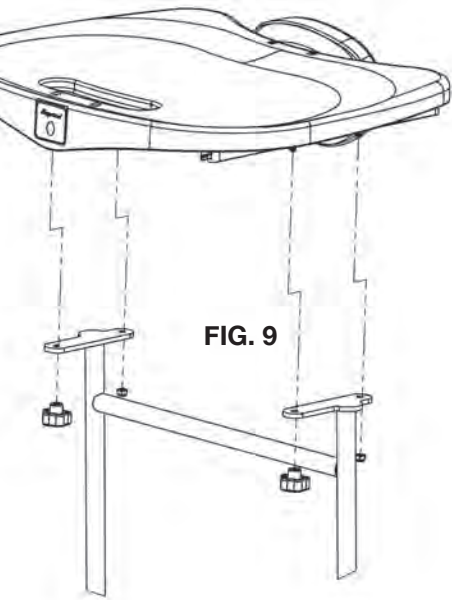

**FIG. 9**

# Shadow<sup>®</sup> Tray Assembly

These assembly instructions are shown for the right side mounted Shadow Tray, for the left side mounted Shadow Tray, installation will be on the opposite side.

## Required Tools:

-13mm open end wrench

-Hex Wrench

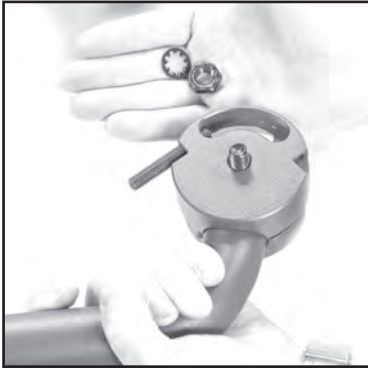

1. Remove nut and lock washer from the bolt on the support arm



2. Insert bolt and support arm onto unit as shown, making sure notch is in the groove on the support arm.



3. Start the bolt by hand.



4. Place lock washer and nut onto bolt. Using a hex tool and wrench tighten securely.



5. Place the tray bracket on the unit as shown. Insert one bolt and hand tighten.



6. Insert second bolt and tighten both bolts securely.



7. Place the cloth protection sleeve on the tray bracket as shown.



8. Insert tray tube into the tray bracket.

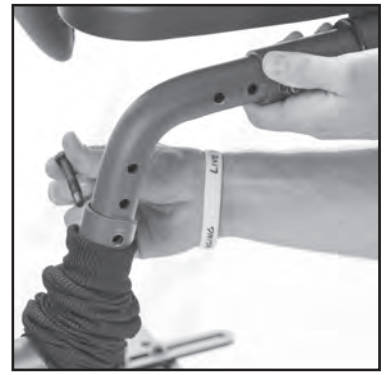

9. Insert bolt into desired hole. Note: You may need assistance lining up the hole from a partner.



10. Place washer onto bolt.



11. Place nut onto bolt.



12. Using hex wrench and 13mm wrench tighten securely.



10. Place black protective cap onto nut. Pull the cloth protection sleeve on the tray tube.



Your Shadow Tray is now completed. Please refer to the Instructions For Use manual for adjustments and usage.

# Mobile Assembly

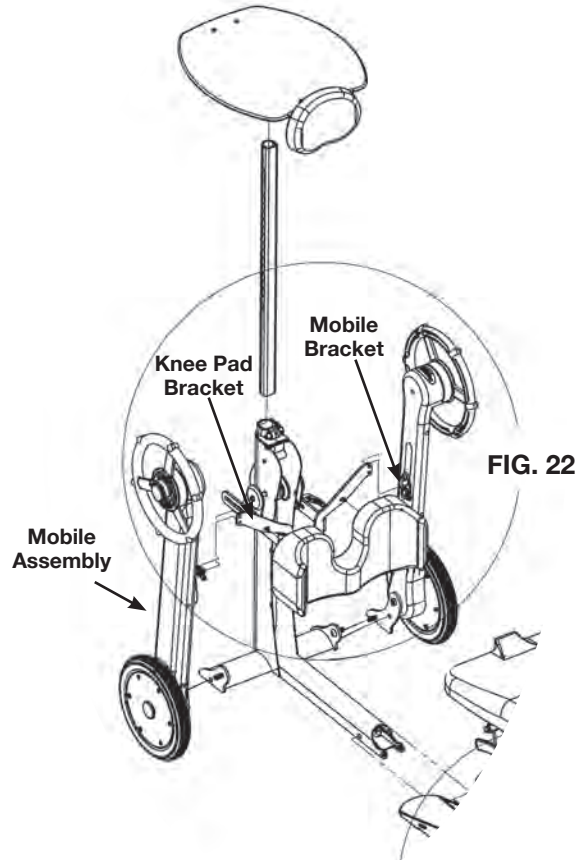
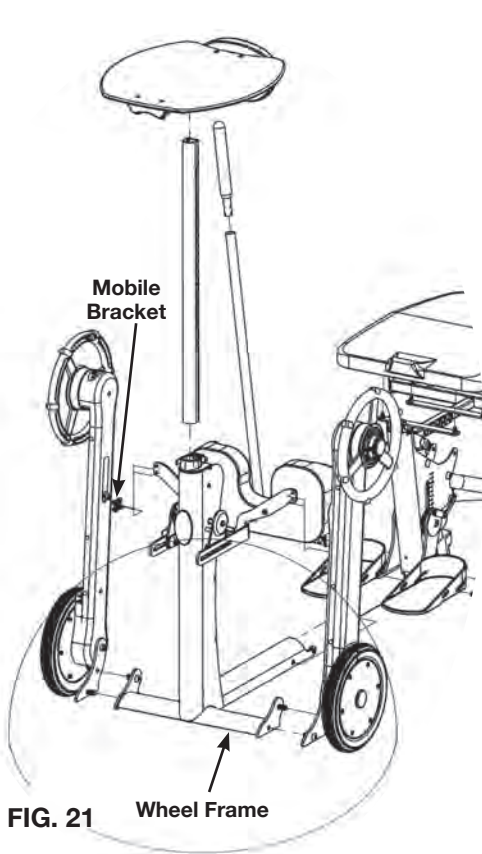
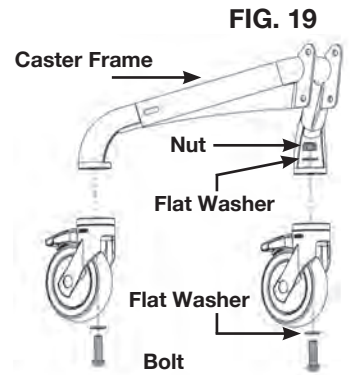
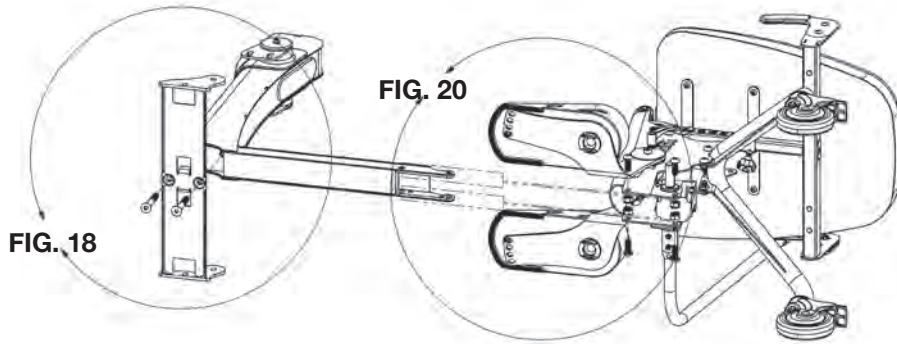

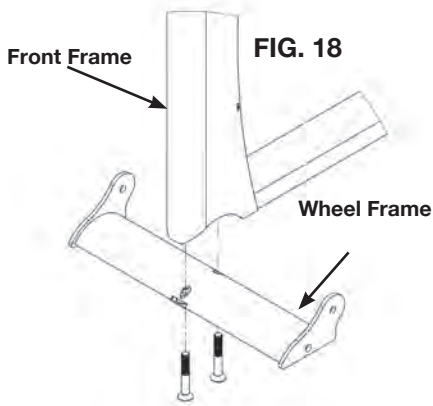

**FIG. 18-** Place the front frame onto the wheel frame. Line up the two bolts with the holes on the wheel frame, start both bolts before tightening securely.

**FIG. 19-** Remove nut and flat washer from the bolt on the caster. A flat washer will remain on the bolt on the caster. Place caster, bolt, and flat washer into rear caster frame as shown. Place second flat washer that was removed onto the bolt. Place nut onto bolt and tighten securely with wrench and hex wrench provided in the tool kit. Repeat steps for other caster. Ensure the casters are flush with the rear base frame.

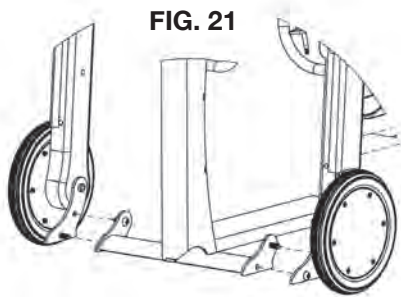

**FIG. 20-** Place the front frame and the seat assembly on its side, slide the front frame into the opening of the seat assembly as shown. Line up holes and insert all four bolts first, then place nuts onto bolts and tighten securely with hex wrench and 19mm open-ended wrench. Place unit upright.

**FIG. 21-** Place the left-side mobile assembly onto the wheel frame. Line up holes and insert top bolt through the inside as shown. Place the nut onto the bolt and hand tighten. Line up holes and insert bottom bolt through the outside, as shown. Hand tighten the nut onto the bolt, then tighten both bolts securely with a 19mm wrench and hex wrench. Repeat on the opposite side before continuing to the next step.

**FIG. 22-** Place mobile bracket onto the kneepad bracket. Place kneepad onto the mobile bracket. Insert three bolts into the back of the kneepad. Tighten bolts securely. Remove bolts from mobile bracket. Flip down kneepad and align bracket on mobile assembly. Tighten bolts and nuts securely with 13mm wrench and hex wrench. Repeat steps on the opposite side before continuing to the next step.

Lift seat up and flip foot plates down. Then insert ratchet handles into foot plates. Tighten securely.

**FIG. 23-** The Mobile is equipped with wheel locks for safety while transferring and stability while performing stationary activities. Note the directional arrows imprinted in the center hub of each handrim.

To assemble the tray and seat, go to p. 4, FIG. 5.

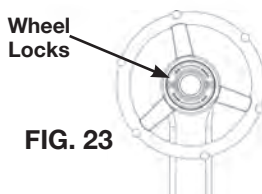
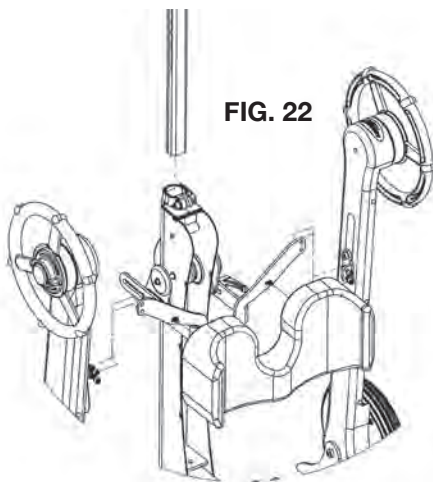



# Option Assembly

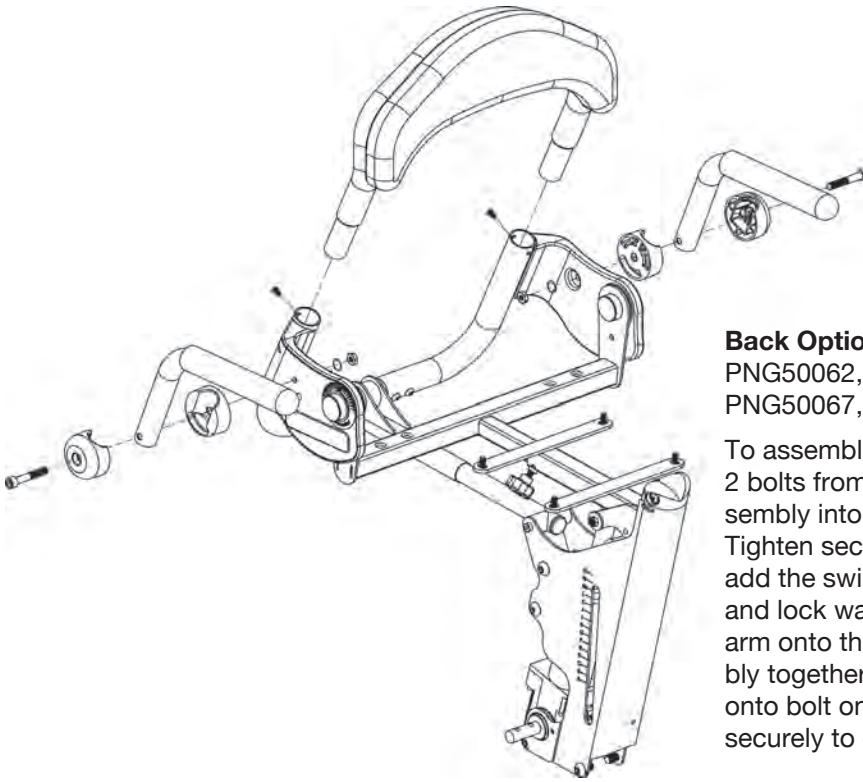

## Back Option

PNG50062, PNG50066,  
PNG50067, PNG50068

To assemble the back option, remove the 2 bolts from the back, slide the back assembly into the seat assembly as shown. Tighten securely with bolts provided, then add the swing-away arms. Remove the nut and lock washer from the arm. Place the arm onto the unit keeping the arm assembly together. Place the nut and lock washer onto bolt on the inside of the unit. Tighten securely to desired level of tension.

## Removable Back Option

PNG50171, PNG50172,  
PNG50173, PNG50174

To attach the Removable Back to the unit, slide the back assembly into the seat assembly as shown. Insert hardware into back tubes with tabs facing upward and toward the back. Tighten securely with knobs provided.

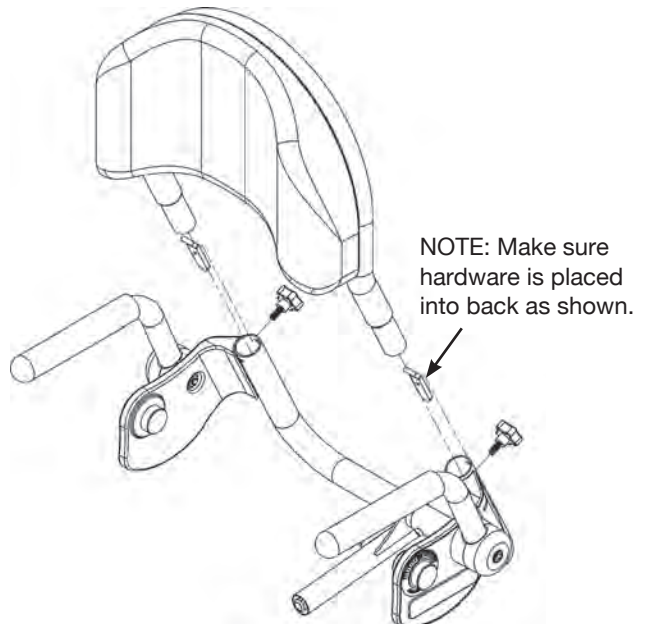



**Head Support-Short**

21"-30"H

PNG50240

**Head Support-Tall**

25"-34"H

PNG50037

If you ordered the high mount chest vest bracket see p. 14.

**FIG A-** Place head support bracket onto accessories mounting bracket as shown. Insert 4 bolts and nuts and tighten securely.

**FIG B-** Insert the head support onto the unit and tighten securely.

**FIG A**

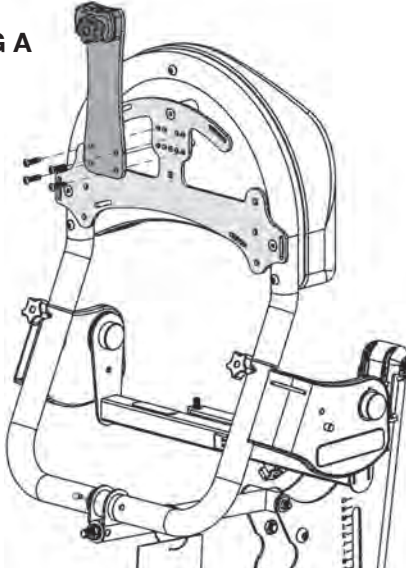

**FIG B**

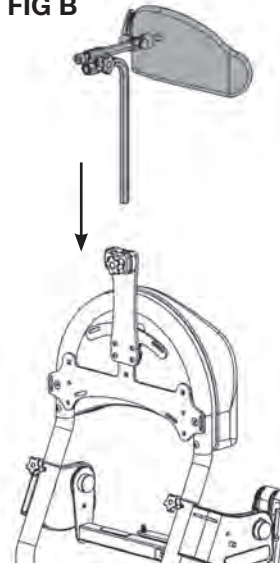

**Standard Foot Straps**

PNG30030-15"L

PNG50505-21"L



**Secure Foot Straps**

PNG30031-15"L

PNG50506-21"L

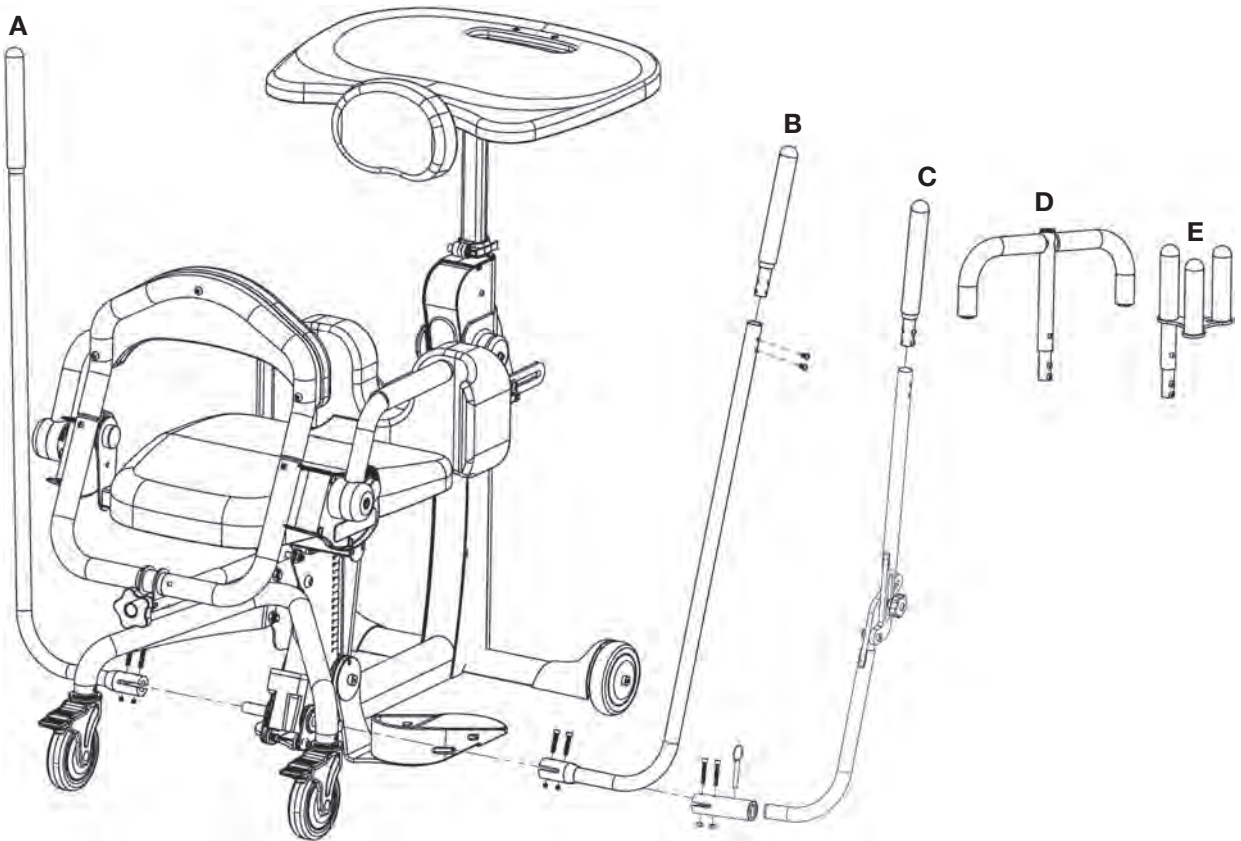

Remove the nuts and bolts from the pump handle. Insert the handle onto the pump. Line up holes and insert bolts, place nuts onto bolts. Tighten securely.

**A**  
**Standard**  
**Actuator**  
**Left Handle**  
 PNG50126

**B**  
**Standard**  
**Actuator**  
**Right Handle**  
 PNG50059

**C**  
**Adjustable/**  
**Removable Handle**  
**Universal Left/Right**  
 PNG50328

**D**  
**T-Style**  
**Handle**  
**Extension**  
 PNG50070

**E**  
**Quad Grip**  
**Handle**  
**Extension**  
 PNG50044

**High Mount Chest  
Vest Bracket**  
PNG11212

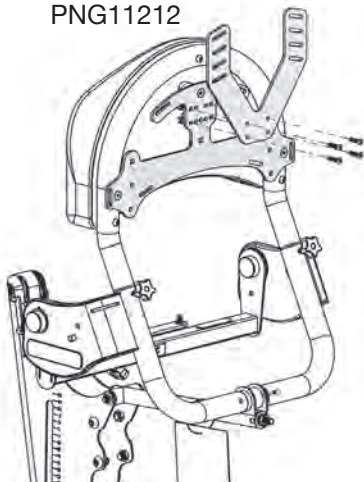

**High Mount Chest Vest Bracket  
with Head Support**  
PNG11212

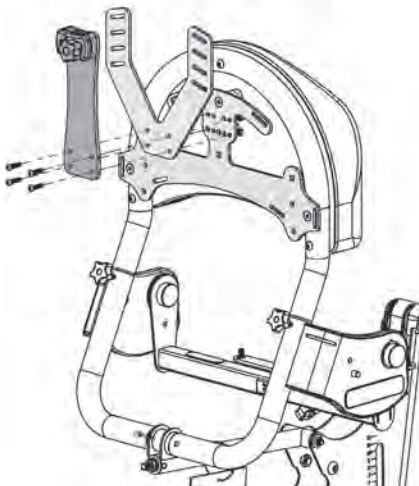

If you ordered the high mount chest vest bracket and head support, place the head support bracket and the high mount chest vest bracket on the unit as shown. Insert 4 bolts and nuts and tighten securely. See p.12 for head support assembly.

**Airline Buckle Hip  
Belt**  
PNG30028 26"-55"

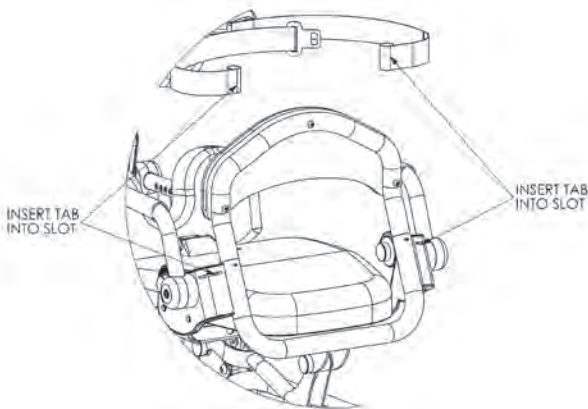

**Velcro Hip Belt**  
PNG30029 26"-55"  
PNG30306 38"-67"

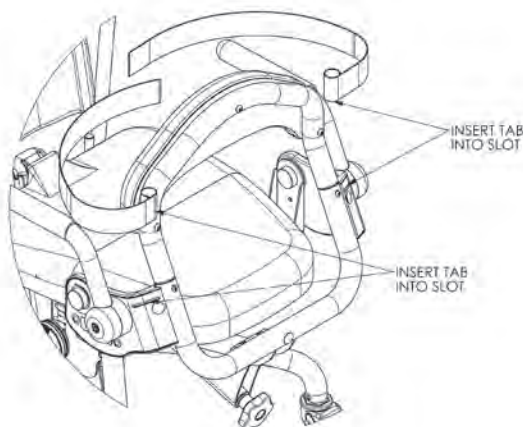

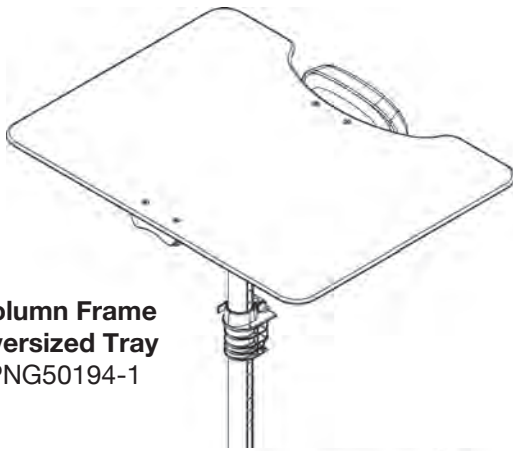

**Column Frame  
Oversized Tray**  
PNG50194-1

**Large Contoured  
Chest Pad**  
PNG30000

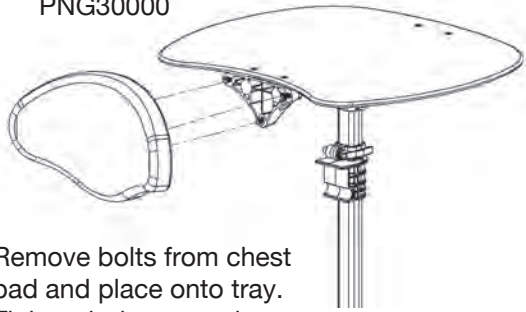

Remove bolts from chest pad and place onto tray. Tighten bolts securely.

**Chest Strap**  
PNG50192 30"-46"  
PNG50193 34"-54"  
PNG50504 46"-66"

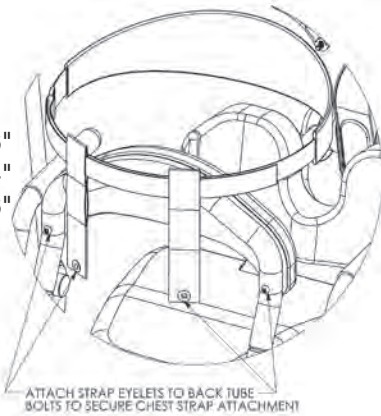

ATTACH STRAP EYELETS TO BACK TUBE BOLTS TO SECURE CHEST STRAP ATTACHMENT

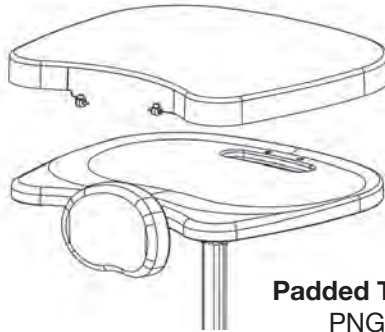

**Padded Tray Cover**  
PNG30295

**X-Style Chest Vest**  
PNG30170 11"L-9.5"W  
PNG30056 14.5"L-10.5"W

**Non-Stretch X-Style Chest Vest**  
PNG30318 11"Lx9.5"W  
PNG30322 14.5"Lx10.5"W

**Y-Style Chest Vest**

PNG30171 17.5"L-11.5"W  
PNG30021 20.5"L-12.5"W

**Non-Stretch Y-Style Chest Vest**

PNG30320 17.5"Lx11.5"W  
PNG30324 20.5"Lx12.5"W

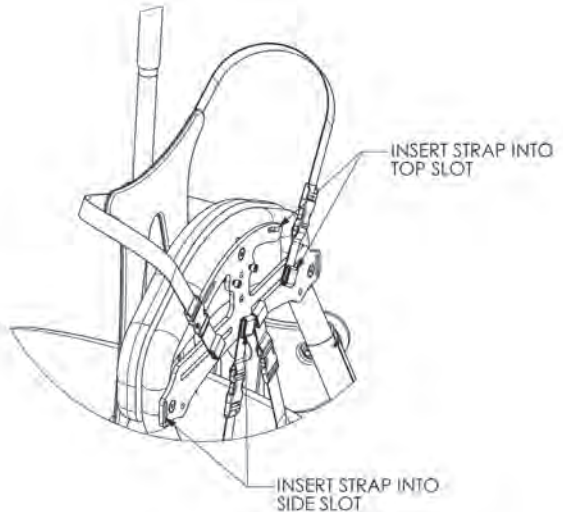
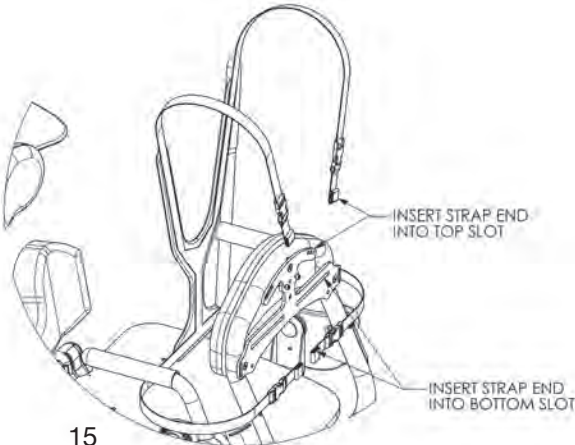



**Swing-Away Frame  
Black Molded Angle  
Adjustable Tray**  
PNG50490-1

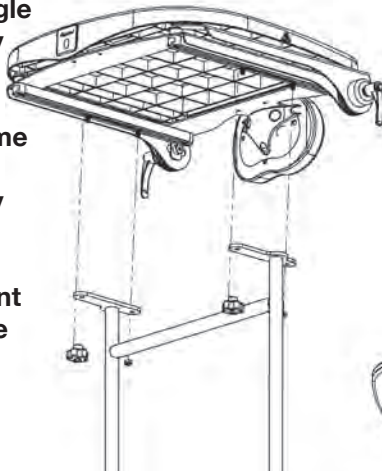

Place tray onto the tray post, insert nut into slot and bolt into hole, tighten securely.

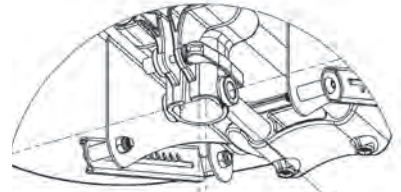

**Swing-Away Frame  
Clear Angle  
Adjustable Tray**  
PNG50489-1

**Swing-Away Front  
Oversized Angle  
Adjustable  
Clear Tray**  
PNG50491-1

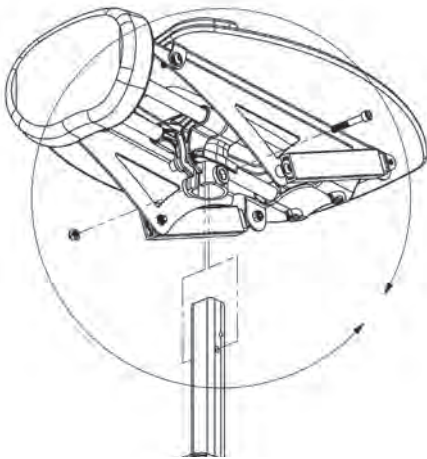

**Mobile Frame  
Narrow Clear Angle  
Adjustable Tray for Mobile**  
PNG50327-1

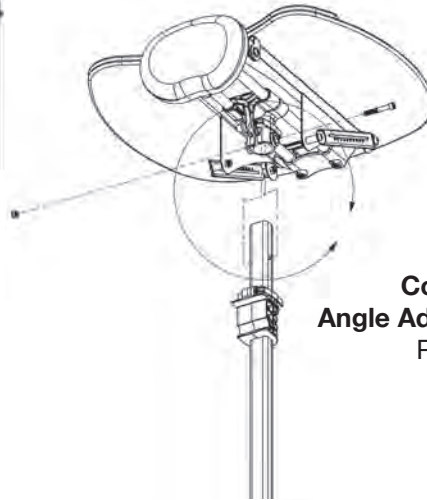

**Column Frame  
Angle Adjustable Clear Tray**  
PNG50366-1

**Column Frame  
Black Molded Angle  
Adjustable Tray**  
PNG50368-1

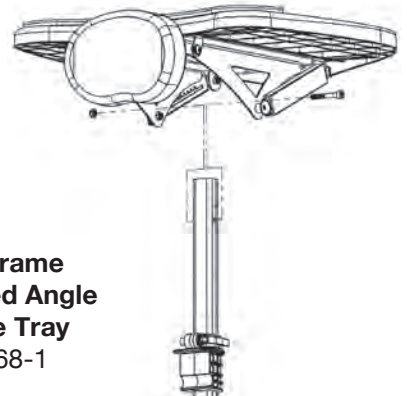

**NOTE:** Raise the Angle Tray by pulling up on the front of the tray and it will lock into position, to lower the tray, angle the tray all the way up and the mechanism will become free to lower the tray.

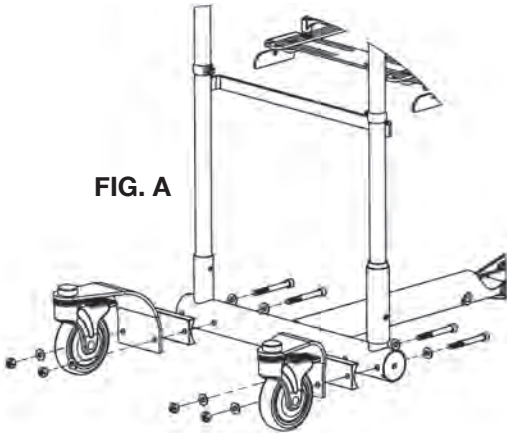

**FIG. A**

**Front Swivel Casters for  
Swing-Away Fronts**

Evolv Medium/Large-PNG51044R/PNG51044L  
Evolv Medium/Large-PNG51048R/PNG51048L

**FIG. A-** Place a block of wood under the unit to raise the caster frame to line up caster brackets to frame. Place hardware onto the unit as shown-bolt, washer, frame, spacer, caster assembly, washer, then nut.

**FIG. B-** It is important to ensure the brackets are assembled as shown, with the angular portion of the bracket pointing outward and away from each other. Tighten securely.

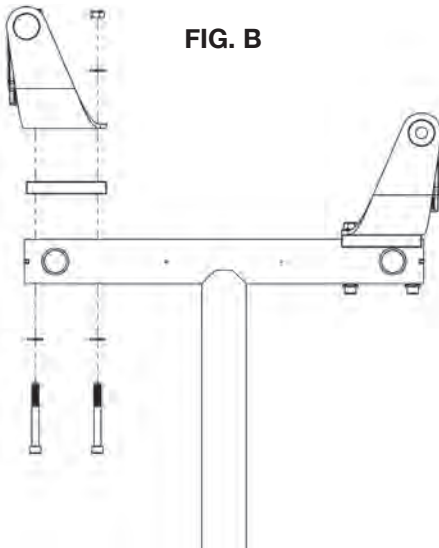

**FIG. B**

**Front Swivel Casters for  
Column Fronts**

Evolv Medium/Large-PNG51052/ PNG51053  
Evolv XT-PNG51056/ PNG51057

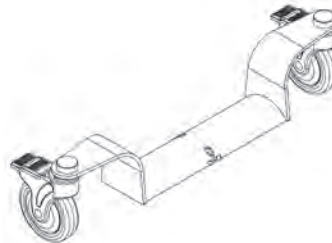



**Independent  
Knee Pads PNG50384**

**Independent Roho®  
Knee Pads PNG50385**

**Swing-Away Front  
Independent Knees PNG50425**

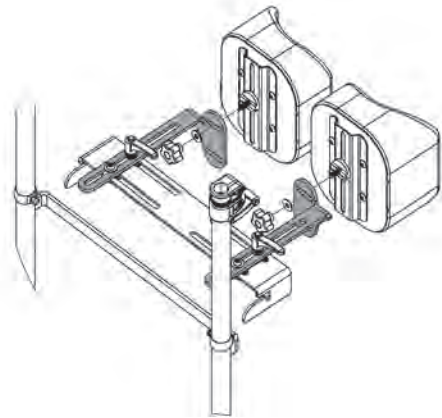
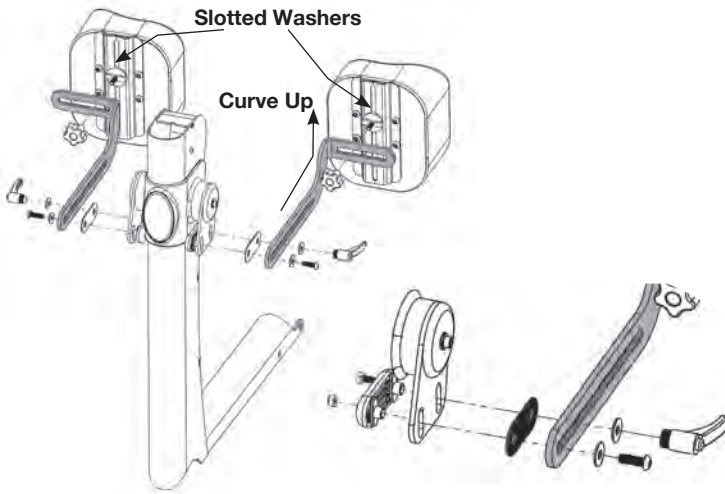

Remove ratchet handle and hardware from the knee bracket. Place onto the column in the order as shown. Make sure spacer is placed between the two steel brackets. Leave the bolt just loose enough to allow bracket to slide freely. Note the position of the grey brackets, the curve must go up. The narrow end of the slotted washer for the knee pads will be inserted into the bracket.

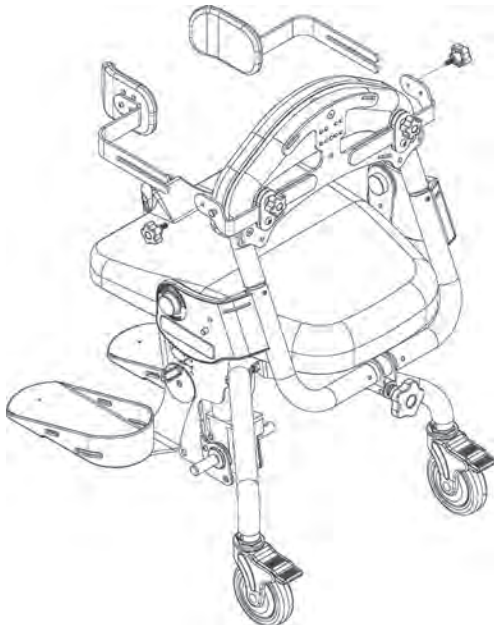

**Lateral Supports  
with Curved Pads**  
8"-16.5"W  
PNG50224

**Lateral Supports  
with Curved Pads**  
11"-19.5"W  
PNG50176

**Lateral Supports  
with Flat Pads**  
8"-16.5"W  
PNG50535

**Lateral Supports  
with Flat Pads**  
11"-19.5"W  
PNG50536

Slide each lateral support onto notch and knob on the accessories mounting bracket. Tighten knobs securely.

### Roho® Seat

Evolv Medium-PNG30183  
Evolv Large/XT-PNG30023

Install the seat onto the seat assembly after all the other options are added. Tighten the bolts securely.

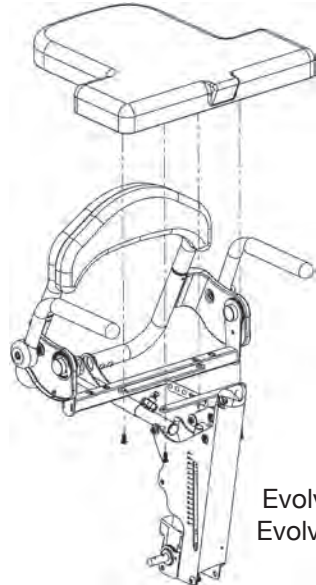
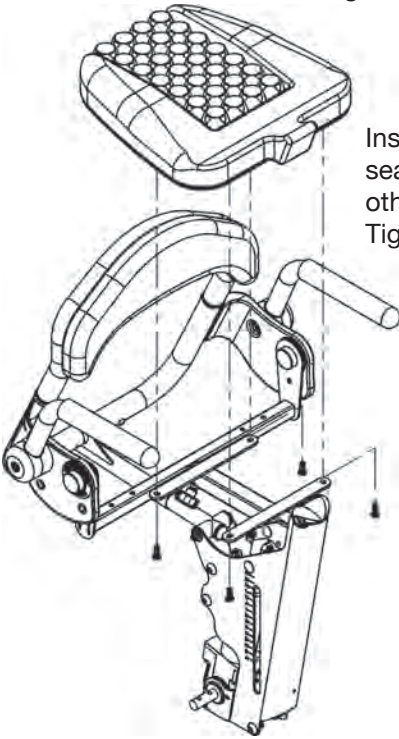

### Transfer Seat

Evolv Medium-PNG30269  
Evolv Large/XT-PNG30270

### Rotating Seat

Evolv Medium-PNG50324  
Evolv Large/XT-PNG50318

Push the lever under the seat to rotate. Ensure seat is locked into position prior to transferring.

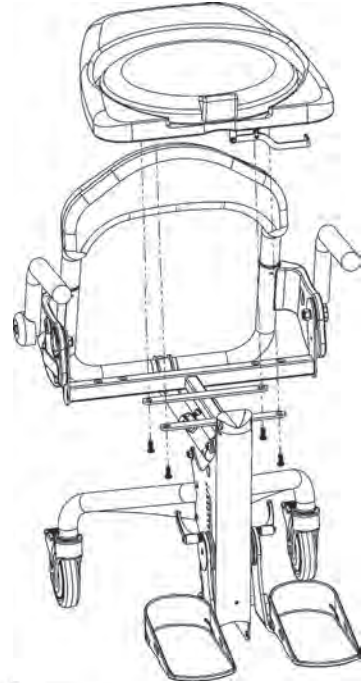

### Hip Supports

Evolv Medium  
PNG50161 9"-15"  
PNG50198 11"-17"

Evolv Large/XT  
PNG50161 10"-15"  
PNG50198 12"-17"

Slide hip supports onto notch and knob under seat. Tighten knob securely.

*If adding hip supports off-unit, remove hole covers from top and bottom of the seat frame.*

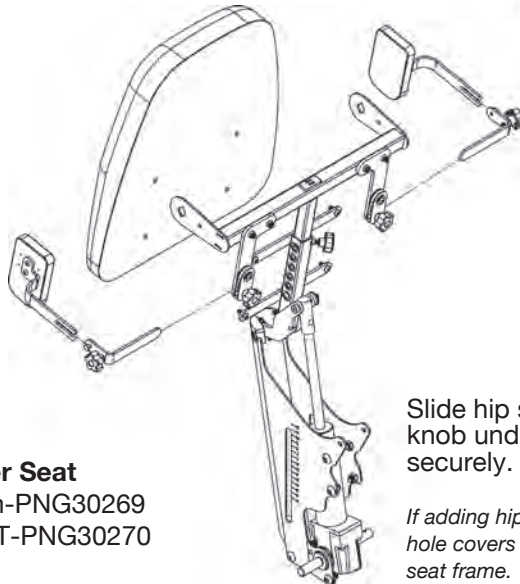

# Pow'r Up Lift Hand Pendent Assembly

Evolv Medium/Large-PNG50010  
Evolv XT-PNG50321

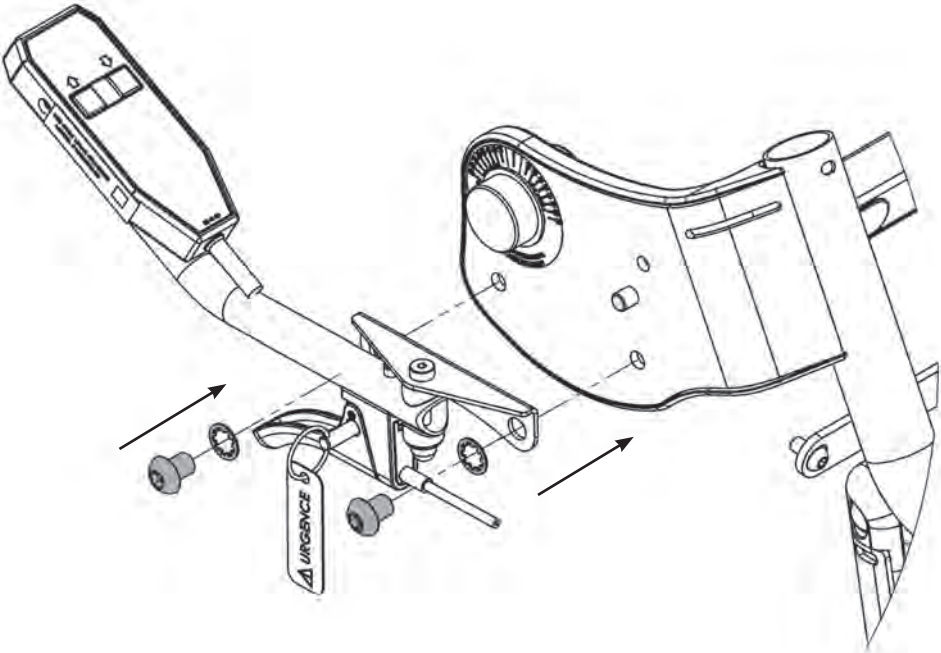

Place hand pendent assembly onto unit and line up bracket with holes on unit. Place lock washers onto bolts. Insert bolts into holes on the unit and tighten securely.

# Evolv® Options & Parts Detail (front)

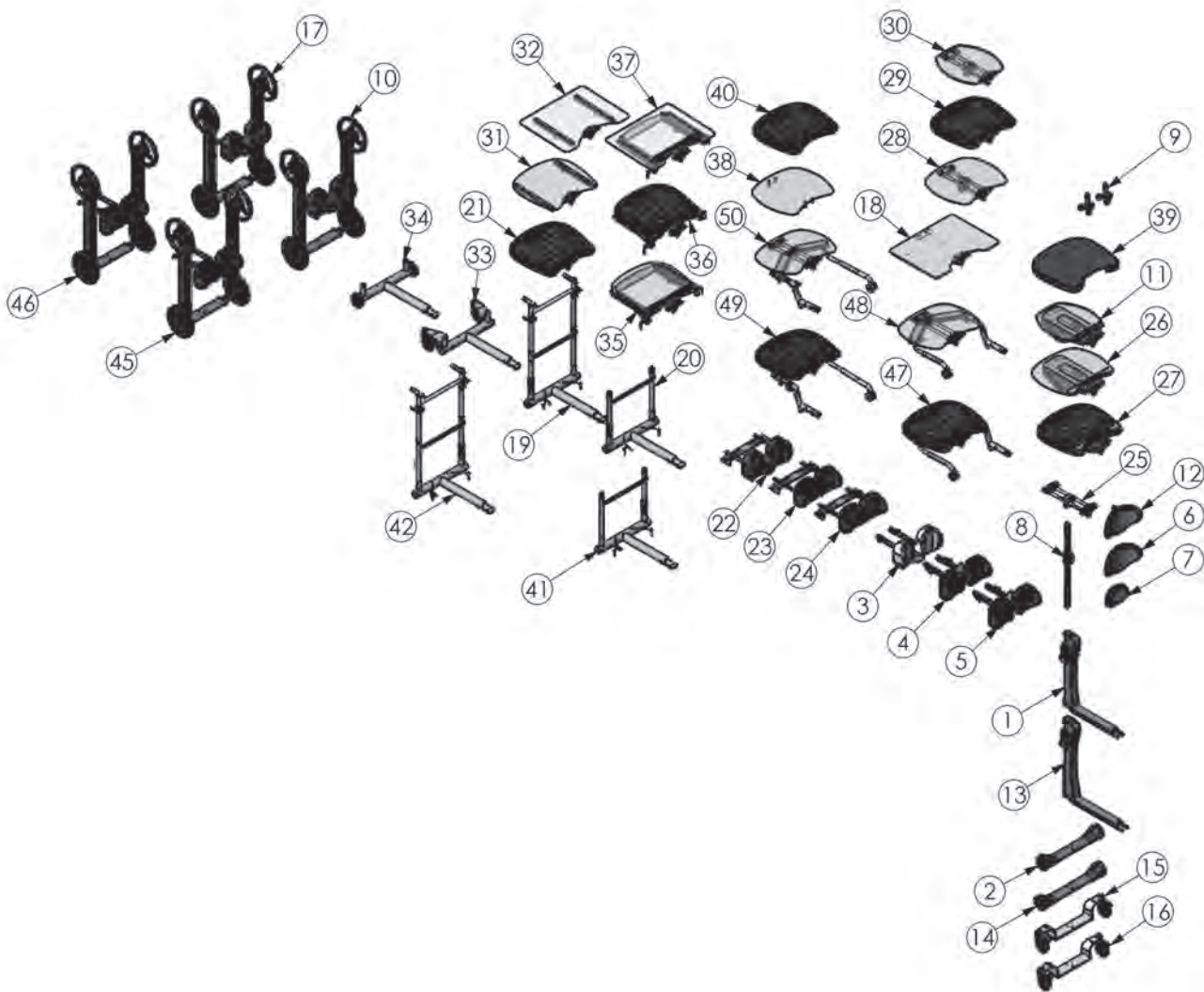



ITEM NO.	PART NO.	NAME
1	NG50376	FRONT FRAME STANDARD IND KNEE
2	NG50055	FRONT CASTER FRAME STANDARD
3	NG50460	PAD STANDARD KNEE ASSEMBLY
4	NG50384	INDEPENDENT KNEES EVOLV
5	NG50385	INDEPENDENT KNEES EVOLV ROHO
6	NG30000	PAD FRONT EXTRA SUPPORT
7	NG30001	PAD CHEST STANDARD
8	NG50309	TABLE POST ASSEMBLY
9	NG50042	SUPPORT GRIP OPTION
10	NG50025	MOBILE OPTION EVOLV
11	NG50327	ANGLE ADJUSTABLE TRAY MOBILE
12	NG50331	ASSEMBLY ADJUSTABLE PAD BRACKET
13	NG50377	FRONT FRAME XT
14	NG50207	FRONT CASTER FRAME STANDARD XL
15	NG50346	ASMBLY CASTER FRONT EVOLV XT
16	NG50314	ASMBLY CASTER FRONT EVOLV
17	NG50322	MOBILE OPTION EVOLV XT
18	NG50194	OVERSIZED TABLE ASSEMBLY
19	NG50417	EVOLV H-FRAME RH
20	NG50428	EVOLV H-FRAME RH SHADOW
21	NG50418	TRAY ASSEMBLY BLK-MOLDED H-FRAME
22	NG50424	PAD KNEE STANDARD H-FRAME
23	NG50425	PAD KNEE IND H-FRAME
24	NG50426	PAD KNEE IND ROHO H-FRAME
25	NG50341	TABLE SLIDE ASSEMBLY
26	NG50366	ASMBLY TABLE TILT CLEAR
27	NG50368	ASMBLY TABLE STANDARD TILT
28	NG50248	TABLE EVOLV ACRYLIC
29	NG50247	TABLE EVOLV STANDARD
30	NG50372	TABLE EVOLV MOBILE
31	NG50456	TRAY ASSEMBLY CLEAR H-FRAME
32	NG50458	TRAY ASSEMBLY OVERSIZED H-FRAME
33	NG50483	ASMBLY H-FRAME SW FRONT EVOLV
34	NG50488	H-FRAME STANDARD FRONT EVOLV
35	NG50489	TRAY ASMBLY CLEAR TILT SWING AWAY
36	NG50490	TRAY ASMBLY BLK TILT SWING AWAY
37	NG50491	TRAY ASMBLY O-SIZE TILT SWING AWAY
38	NG50347	TABLE EVOLV ACRYLIC
39	NG30295	PADDED TRAY COVER
40	NG50348	TABLE EVOLV STANDARD
41	NG50427	EVOLV H-FRAME LH SHADOW
42	NG50416	EVOLV H-FRAME LH
45	NG50510	MOBILE OPTION IND ROHO KNEES
46	NG50512	MOBILE OPTION IND KNEES
47	NG50515	ADJ SHADOW TRAY RH BLK MOLDED
48	NG50517	ADJ SHADOW TRAY RH CLEAR TRAY
49	NG50537	ADJ SHADOW TRAY LH BLK MOLDED
50	NG50538	ADJ SHADOW TRAY LH CLEAR

# Evolv® Options & Parts Detail (rear)

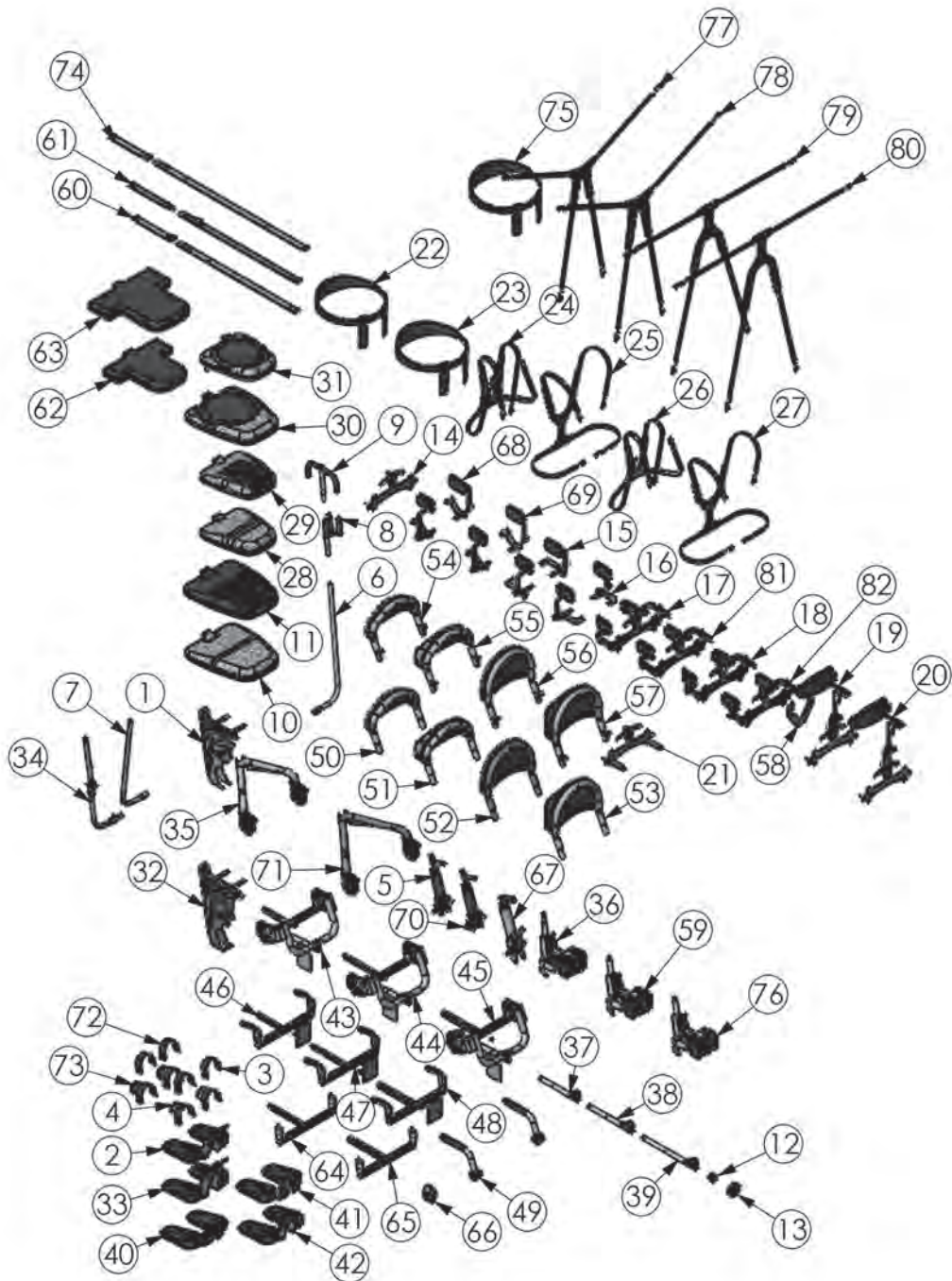



ITEM NO.	PART NO.	NAME	ITEM NO.	PART NO.	NAME
1	NG50007	SEAT LIFT W/ ARMS MED	51	NG50062	BACK LOW W/CONTOUR (V908)
2	NG50015	FOOT ASMBLY LG	52	NG50067	BACK HIGH FLAT(V909)
3	ng30030	FOOT STRAPS 15"L	53	NG50068	BACK HIGH W/CONTOUR (V910)
4	NG30031	SECURE FOOT STRAPS 15"L	54	NG50171	BACK REMOVABLE LOW FLAT
5	NG50009	PUMP HYDRAULIC ASSEMBLY LARGE	55	NG50172	BACK REMOVABLE LOW CONTOURED
6	NG50059	HANDLE PUMP STANDARD RT	56	NG50173	BACK REMOVABLE HIGH FLAT
7	NG50126	HANDLE PUMP STANDARD LH	57	NG50174	BACK REMOVABLE HIGH CONTOURED
8	NG50044	QUAD GRIP OPTION	58	NG11212	HIGH MOUNT CHEST VEST BRACKET
9	NG50070	ACTUATOR HANDLE EXTENSION EVOLV LG	59	NG50010	POW'R UP LIFT EVOLV
10	NG30006	PAD SEAT CONTOURED LARGE	60	NG30029	POSITIONING BELT 26"-55"
11	NG30023	PAD SEAT LG ROHO OPTION	61	NG30028	STRAP SEAT BELT W/BUCKLE NG ADULT
12	NG20122	KNOB FEMALE M12 X 1.75	62	NG30269	SEAT LATERAL TRANSFER YOUTH
13	600002	WHEEL 100mm W/FOLD AWAY HANDLE	63	NG30270	SEAT LATERAL TRANSFER ADULT
14	NG50034	BRACKET ACCESSORY LG	64	NG50499	ASSEMBLY BEARING SEAT DEPTH
15	NG50161	HIP GUIDE ASSEMBLY MEDIUM	65	NG50500	ASSEMBLY BEARING SEAT DEPTH XT
16	NG50198	HIP GUIDE ASSEMBLY LARGE	66	80246	SEAT ANGLE LOCATOR
17	NG50224	LATERAL SUPPORTS 8"-16.5"W	67	NG50320	PUMP HYDRAULIC ASSEMBLY XL
18	NG50176	LATERAL SUPPORTS 11"-19.5"W	68	NG50345	HIP GUIDE ASMBLY GLIDER YOUTH
19	NG50240	HEAD REST ASSEMBLY MED	69	NG50374	HIP GUIDE ASMBLY GLIDER ADULT
20	NG50037	HEAD REST ASSEMBLY LG (V915)	70	NG50113	PUMP HYDRAULIC ASSEMBLY MEDIUM
21	NG50040	HANDLE PUSH ASSEMBLY	71	NG50277	XL REAR CASTER TUBE
22	NG50192	CHEST STRAP 30"-46"	72	NG50505	FOOT STRAPS 21"L
23	NG50193	CHEST STRAP 34"-54"	73	NG50506	SECURE FOOT STRAPS 21"L
24	NG30056	X-STYLE CHEST VEST 11"L X 9.5"W	74	NG30306	POSITIONING BELT 38"-67"
25	NG30021	Y-STYLE CHEST VEST 20.5"L X 12.5"W	75	NG50504	CHEST STRAP 46"-46"
26	NG30170	X-STYLE CHEST VEST 9.5"W X 9"W	76	NG50262	ELECTRIC ACTUATOR ASM
27	NG30171	Y-STYLE CHEST VEST 17.5"L X 11.5"W	77	NG30318	NON STRETCH "X" VEST 11"L X 9.5"W
28	NG30012	PAD SEAT CONTOURED YOUTH	78	NG30322	NON STRETCH "X" VEST 14.5"L X 10.5"W
29	NG30183	PAD SEAT ROHO YOUTH	79	NG30320	NON STRETCH "Y" VEST 17.5"L X 11.5"W
30	NG50318	SEAT SWIVEL LARGE	80	NG30324	NON STRETCH "Y" VEST 20.5"L X 12.5"W
31	NG50324	SEAT SWIVEL YOUTH	81	NG50535	LATERAL SUPPORTS 8"-16.5"W FLAT
32	NG50209	SEAT & LIFT ASM XT	82	NG50536	LATERAL SUPPORTS 11"-19.5"W FLAT
33	NG50278	FOOT ASMBLY XT			
34	NG50328	HANDLE PUMP REMOVEABLE/ADJ			
35	NG50058	SEAT REAR CASTER TUBE			
36	NG50321	POW'R UP LIFT EVOLV XT			
37	NG50436	ASMBLY FOLLOWING ARM YOUTH			
38	NG50437	ASMBLY FOLLOWING ARM ADULT			
39	NG50438	ASMBLY FOLLOWING ARM XT			
40	NG50414	FOOT ASMBLY YOUTH			
41	NG50355	FOOT ASMBLY LG			
42	NG50391	FOOT ASMBLY LG			
43	NG50441	ASMBLY BACK REST YOUTH			
44	NG50442	ASMBLY BACK REST ADULT			
45	NG50443	ASMBLY BACK REST XT			
46	NG50444	ASMBLY EVOLV NO BACK YOUTH			
47	NG50445	ASMBLY EVOLV NO BACK ADULT			
48	NG50446	ASMBLY EVOLV NO BACK XT			
49	NG50450	ARM REST ASSEMBLY EVOLV			
50	NG50066	BACK LOW FLAT			

# AltimateMedical

262 West 1st St.  
Morton, MN 56270 USA  
Toll Free: 800.342.8968 or 507.697.6393  
Fax Free: 877.342.8968 or 507.697.6900  
email: info@easystand.com  
easystand.com

## Assembly Manual

**EC** **REP**

Medical Product Service GmbH  
Borngasse 20  
35619 Braunfels  
Deutschland

**UK** **REP**

MPS Medical Product Service UK Ltd  
Northgate House  
Northgate Street  
Devizes  
Wiltshire England SN10 1JX

**CH** **REP**

MPS Medical Product Service Switzerland, CO/Accumed Sagl  
Morbio Inferiore  
Viale Serfontana 10  
CH-6834 Switzerland

**EasyStand**  
standing made easy 



Standing technology should only be used under the guidance of a physician with recommendations for standing program protocol and any medical precautions. Standing programs should be monitored by the attending therapist. AMI maintains a policy of continual product improvement and reserves the right to change features, specifications, and prices without prior notification. Check with AMI for latest info.  
FORM EVOLVASSEMMAN 012623 REV A Copyright © 2023 Altimate Medical, Inc. All rights reserved. Printed in the U.S.A.