



Innovative Healthcare Solutions

© 2022 MedaCure Inc. All rights reserved.  
MedaCure is a registered trademark of  
Medacure Inc. Kenilworth, NJ 07033.

Made in Taiwan

## Assist & Turn Sit-Stand Transfer Aid

Model #AT440



Innovative Healthcare Solutions

MedaCure Inc.  
221 South 31st Street  
Kenilworth, NJ 07033 USA  
[www.medacureinc.com](http://www.medacureinc.com)

## Intended Use

The Assist & Turn is a lightweight and compact sit to stand transfer aid that can easily be placed close to the user. There's an anti-slip base plate for safe and secure positioning of the feet onto the base. The lower knee pad is fully adjustable in height and should be positioned just below the knees of the user. Position the handle just above the shoulder of the user.

Please note: This device is designed to be used as an aid from a sitting to a standing position and is not designed to be used as a transfer device from one location to another. Transporting patients could cause serious injury to the user and damage the device.

## Operating Suggestions

**Maximum Weight Capacity: 429 lbs. / 190 KG**

### SAFETY NOTICE:

- The wheels are for transporting the device only.
- The Assist & Turn must not be used as a transport device.
- Do not tip the device while someone is standing on the rotating plate.
- Do not remove your foot away from the pedal when someone is in mid transfer.

### STEP 1

The caregiver should grasp the upper handlebar grips with both hands and place one foot firmly onto the pedal at the back of the device and lean slightly backwards to act as a counterweight.

The person being assisted should grasp the lower handlebar grips and place their feet onto the base of the turner while positioning the

knees into the knee pad allowing them to stand up.

Ensure the adjustable pads are in the correct position and fastened tightly.

### STEP 2

Rotate the turner to place the assisted person correctly in front of the new seating arrangement.

When using the Assist & Turn from a standing to a sitting position, repeat the same technique as for standing up, ensuring the foot is firmly on the pedal so the device does not tilt over.

## Safe Transfer

People in need of assistance often feel unsafe in the transfer process and caregivers are subject to strain when assisting with the transfer. The risk of accidents from both parties may result in fewer transfers. Being left in the same position for long periods of time can lead to severe secondary injuries. Good eye contact and communication of the caregiver and user throughout the transfer is recommended and important.

## Maintenance

To ensure the Assist & Turn device works well and is safe, the following actions and maintenance should be carried out regularly:

1. Clean the rotating plate using an ordinary solvent-free detergent and then wipe it dry.
2. Keep the wheels and the space between the rotating plates free of dust, hair and the like. Check that the bolts, nuts and controls are tightened properly.

## Specifications

#	Description	Dimension
1	Overall height	49.5" / 1255 mm
2	Height adjustment from handle grip	31" - 49.4" / 790-1255 mm
3	Width of handle	17" / 430 mm
4	Diameter of stepping turn wheel	16" / 410 mm
5	Knee pad height adjustment	10" - 18" / 250 - 450 mm
6	Diameter of castor	3" / 75 mm
7	Net Weight	31 lbs. / 14 kgs.

## Key Components

Part #	Description
1	Upright mast
2	Thumb bolt for Knee pad
3	Foot pedal
4	Right footrest anti slip base
5	Rubber spacer
6	Left footrest anti slip base
7	Hex head nut
8	Spring washer

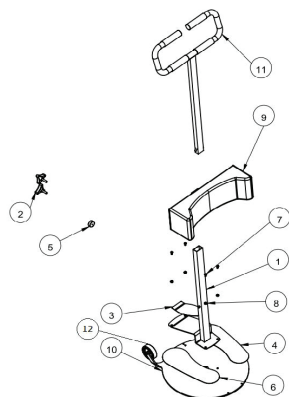

## Assembly Instructions

1. Set base plate on a flat floor.
2. Attach the upright mast to the base plate with 4 bolts, spring washer and flat washer.
3. Please note: Insert spring washer into the bolt first and then the flat washer.
4. Attach the knee pad into the upright mast. Remove the rubber spacer first before inserting into the upright mast.
5. Reinsert the rubber spacer after the knee pad is set into the upright mast and fasten knee pad by the thumb bolt.
6. Insert the handle into the upright mast and turn thumb bolt tightly at appropriate location.
7. The turner is assembled.

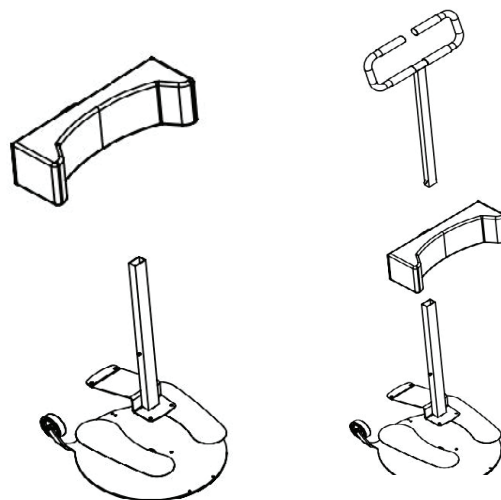

## Medacure Limited Warranty

Your Medacure product is warrantied to be free of defects in materials and workmanship for the lifetime of the product for the original purchaser. This item was built to exacting standards and carefully inspected prior to shipment. This Limited Lifetime Warranty is an expression of our confidence in the materials and workmanship of our products and our assurance to the consumer of years of dependable service.

The Warranty shall not apply under the following conditions: problems arising from normal wear; problems arising from failure to adhere to the product instructions; problems arising from misuse, negligence, accident or improper operation, maintenance or storage; problems arising from modifications or unauthorized repairs, parts or attachments; products where the serial number has been removed or defaced; problems with non-durable components, such as rubber accessories, casters, and grips, which are subject to normal wear and need periodic replacement. Medacure shall not be liable for any consequential or incidental damages whatsoever. Medacure shall repair or replace defective products at its option. The foregoing warranty is exclusive and in lieu of other express warranties, if any, including the implied warranties of merchantability and fitness of a particular purpose. The remedy for any violation of the implied warranty shall be limited to repair or replacement of the defective products pursuant to the terms contained herein.