

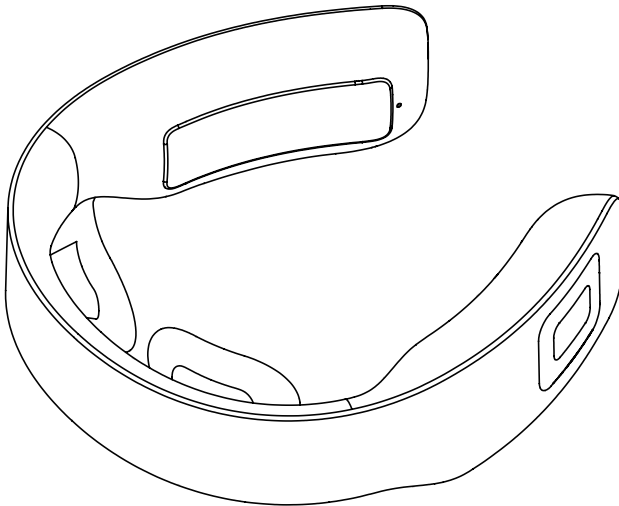

# Neck Massager

## N3900



## **OPERATING INSTRUCTIONS**

Please read the instructions carefully before use and keep it well for further reference.

# I Contents

Instruction & Product Presentation -----	1
Operating Guide & Product charging -----	2-3
Specifications -----	4
Warnings & Cautions -----	4-5
Daily Maintenance & Troubleshooting -----	5-6
Product and Parts Recycling Instructions -----	7

## Instruction

Thanks for purchasing our product. Please read the instructions carefully before use and keep it well for further reference.

### Product Presentation

This Neck Massager is designed according to ergonomics, stylish and beautiful, fits the curve of the neck, and is easy to carrying. The product uses hot compress technology to improve circulation, relieve neck fatigue and protect neck health through the effects of hot compress on acupuncture points around the neck and low-frequency pulses; 5 massage techniques, 16 massage strengths, applicable For all kinds of people.

### Product Diagram

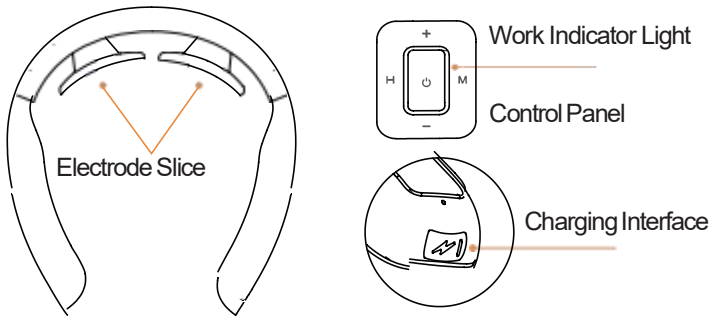

### Neck Massager

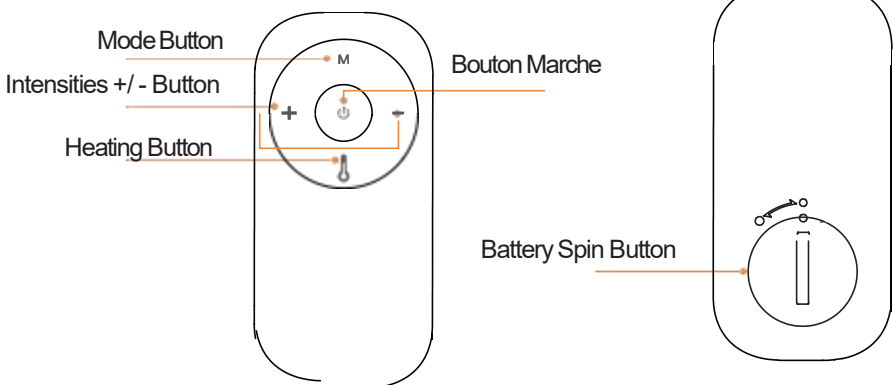

### Remote Controller

## Operating Guide

1. Put the product on your neck.
2. Long press "⏻" button, turn on the machine (Voice prompt: Power On). First is Auto Mode, the colorful atmosphere indicators at both ends are on.
3. The default is mode 1, Auto Mode, the temperature is low heating, the pulse massage intensity is 1.
4. Press "M" to select massage mode:
  - Mode 1 : Auto Mode;
  - Mode 2 : Tapping Mode;
  - Mode 3 : Scrape Mode;
  - Mode 4 : Acupuncture Mode;
  - Mode 5 : Massage Mode;
5. Press "H" to select Heating function: Low / High Heating or Heating off. 6. Short press "+" button, you can adjust to increase intensities, adjustable from 1-16. Short press the "-" button, you can adjust to decrease or close the intensities, from 16-1, pulse can be off or adjustable. 7. When the battery voltage is lower than 3.25v after booting, the machine will flash red quickly to indicate a lack of power. If the battery voltage is lower than 3.2v, the machine will automatically turn off. Please plug in power supply and charge the battery to reboot, about 1.5 hours the power can be full.
8. Long press "⏻" button to turn off the device (Voice prompt: Thanks for using).

Notes: The Device will be automatically off after 15 minutes use to protect you from injury. The device is not worn within 2 minutes after starting up, and the electrode slice is not attached to the human skin, the product will start the automatic turn off function.

## Remote Controller Operating Guide

1. Long press "⏻" button, turn on the machine: The remote control is now connected.
2. On-power state, Press "⏻" button to adjust the heating function: Low / High Heating or Heating off;

3. On-power state, Press "M" button to select massage mode from mode 1 -
5. When switching modes, the massage intensities will return to the 1st level.;
4. On-power state, Long press "M" button Can turn on or off the voice assistant function, Voice announcement content is Voice On or Voice Off. Note: When the voice is off, there is no sound when you press any button.
5. Short press "+" button, you can adjust to increase intensities, adjustable from 1-16. Short press the "-" button, you can adjust to decrease or close the intensities, from 16-1, pulse can be off or adjustable.
6. Long press "⏻" button to turn off the device or using the remote controller turn off the device.

Note:

1. The device will remain in a remote control state for 2 minutes. within 2minutes, you can use the remote control to long press the "⏻" button to restart the device for massage.
2. After 2 minutes, the device enters a complete shutdown state. If you need to use it, long press the device "⏻" button to turn on the device.

## *Product charging:*

1. Please use the DC5V adapter, plug the charging cable that the device is wearing, the USB end into the adapter, and the other end into the machine jack, the machine display panel correspondingly displays the charging status;
  - LED status shows red light, which means charging;
  - LED status shows green light, which means the charging is completed;
2. To charge the product, please use an adapter of DC5V —1A, Do not use chargers adapter more than 6V. You can also use the computer USB port to charge this product.
3. The product cannot be used during charging.
4. When the remote control replaces the battery, you can insert a coin into the battery rotation slot, and turn it counterclockwise to open the battery. Take care to ensure that the battery positive side is facing upward.

## Specifications

Product Name	Neck Massager
Product Mode	N3900
Rated Voltage	3.7V
Rated Power	4W
Low Heating	95°F - 106°F(35C - 41C)
High Heating	102°F - 113°F39C - 45C
Battery Capacity	1200mAh

## Warnings & Cautions

1. If you feel unwell due to abnormality of this product, please stop using it immediately.
2. During the massage, if you want to move the product or to other people, be sure to cut off the power before moving, otherwise you may be strongly clicked.
3. Electrode pads during massage should avoid wounds and scars.
4. During massage, the electrode pads should not be placed near the chest and heart, otherwise it will increase the risk of heart fibrillation.
5. When used by cross users, please clean the electrode pads on the product before use. When using the product, the electrode pads should be closely attached to the skin and evenly contacted.
6. The electrode pads of this product have a heat generating function. When the hot compress function is used for the same part for a long time (more than 15 minutes), it may cause low temperature burn.
7. Do not plug or unplug the USB charging cable with wet hands, otherwise it may result in electric shock or accident.
8. This product contains a lithium battery. Please do not disassemble, modify, immerse the product in water or throw it into fire, otherwise it may cause damage to the product and explosion.

In the following cases, please consult your doctor before use, otherwise an accident or physical discomfort may occur:

1. Patients who are receiving medical treatment and feel abnormal.
2. Patients with abnormal heart and brain nerves.
3. Patients whose body temperature exceeds 38 degrees (fever period).
4. Patients with infectious diseases.
5. Patients with impaired skin perception or abnormal skin.
6. Patients taking medication.
7. Patients with abnormal blood pressure.
8. Patients who cannot express their wishes freely.
9. Patients with sensory disturbances due to high peripheral circulatory disturbances such as diabetes.
10. Patients with skin allergy to stainless steel electrodes.

The following situations are prohibited:

1. Patients with malignant tumors
2. Patients with bleeding tendency
3. Pregnant women
4. Patients with acute suppurative inflammation
5. Pacemaker users
6. Patients with metal built-in
7. Human heart attachment

## *Daily*

1. Please turn off the machine when cleaning and maintaining the product. Use wet paper towels to clean the electrode pads. When it is particularly dirty, use a little medical alcohol (concentration lower than 75%) to wipe and disinfect.
2. For daily maintenance, please use neutral detergent and soft cloth to wipe, do not use corrosive detergent, do not soak or rinse in water.
3. During the cleaning process, water or other liquids should be prevented from entering the machine to avoid the risk of short circuit and electric shock during use.
4. Do not pull hard on the rubber plug at the USB charging place, otherwise it may easily break and fall off.

## Troubleshooting

Problems	Possible causes and solutions
Unable to start	The internal rechargeable battery has insufficient power and please charge in time
	Please confirm whether the power button has been pressed
No charge or no charge display	Please check if the USB is connected to the product and the adapter
Normal display but no feeling	Does the electrode pad directly contact the skin? Adjust the position so that it is close to the skin
	Are there items such as hair, clothing, accessories, etc. between the electrode pads and the skin? Remove items
	Is the intensity level 1st? Adjust to increase massage intensity
Feel tingling	Is the electrode pad tight to the neck skin? Need to adjust the position to make it close to the skin
	Is the massage time too long? It is recommended to take 15 minutes once, twice a day
	Is the massage intensity too strong? Reduce the intensity
	Is the skin allergic to electrode pads? Those with severe allergies need desensitization treatment first
	Cold climate and dry skin? Use after moistening the skin with a wet towel
	Are there any wounds on the skin surface? Do not put the electrode pad on the wound for massage
Stimulation is weak	Is the electrode pad of the massager close to the neck skin? Need to adjust the position so that it is close to the skin and adjust the appropriate strength
	Is the electrode dirty or oily? Clean electrode surface
	Is the battery low? If the battery is low, please charge
	The intensity of the massage is too small? Adjust to increase massage intensity



## Product and Parts Recycling Instructions

In order to protect the environment, after the product or its parts are scrapped, you as a consumer are responsible for separating it from domestic garbage and sending it to a qualified recycling site, which is sorted and disassembled in accordance with relevant national regulations, recycled and reused.

Name and content of toxic and hazardous substances or elements in products						
Part Name	Toxic and harmful substances or elements					
	Lead (Pb)	Mercury (Hg)	Cadmium (Cd)	Hexavalent Chromium(Cr(VI))	Polybrominated Diphenyl Ether(PBDE)	Polybrominated Biphenyls(PBB)
Charging Components	X	○	○	○	○	○
Heating Components	X	○	○	○	○	○
Circuit Board	X	○	○	○	○	○
Hardware components	○	○	○	○	○	○
Battery Pack	X	○	○	○	○	○
Plastic Components	○	○	○	○	○	○

This form is prepared in accordance with the provisions of SJ / T 11364

○: Indicates that the content of the hazardous substance in all homogeneous materials of the part is below the limit requirements specified in GB / T 26572-2011

×: Indicates that the content of the hazardous substance in at least one of the homogeneous materials of the part exceeds the limit requirements of GB / T 26572-2011

## *Package Included*

- 1 x Neck Massager
- 1 x Remote Controller
- 1 x USB Charging Line
- 1 x User Manual