

vive®

# HANDHELD BIDET

Owner's Manual  
LVA2O24STL



[vivehealth.com](http://vivehealth.com)

## WARNING

When installing this unit, ensure that your toilet's water supply is fully turned off and that there's no flow or leak of water prior to the removal of toilet plumbing components. Failure to do so could result in flooding and water damage.

## OVERVIEW

We are constantly answering questions and recording helpful videos to make using your Vive Handheld Bidet as easy as possible. Check out the included links and QR codes to help you through the process.



To see all of the FAQs in one place visit [vhealth.link/zlj](https://vhealth.link/zlj)

## WHAT'S INCLUDED

- (A) 1x Handheld Bidet
- (B) 1x T-Valve
- (C) 1x Shut-off Valve: ensure that the Flat Washer is inside the end of the T-Valve
- (D) 1x Stainless Steel Sprayer Hose
- (E) 1x Bidet Holder
- (F) 2x Wall Screw : use to secure the bidet holder to the wall
- (G) 2x Expander : use to help secure the wall screws to the wall
- (H) 2x Bracket Screw : use to secure the bidet holder to the hook
- (I) 1x Bidet Holder Hook
- (J) 1x Thread seal tape
- (K) 3x Spare Rubber Seals : 2 small, 1 large

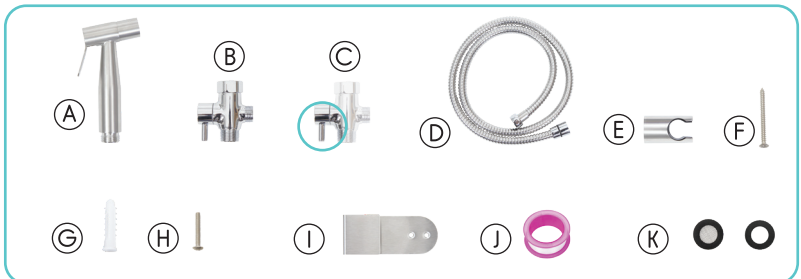

## REQUIRED INSTALLATION TOOLS

- Adjustable wrench or pliers (not included)
- Phillips head screwdriver (not included)

## BEFORE INSTALLATION

- Check the line (water supply hose) connecting the toilet tank to the water supply valve.
- If the line is a rigid pipe, you'll need to purchase a flexible water supply hose from your local hardware store.
- Replace the rigid water pipe with a flexible water supply hose (not included) before installing the Sprayer Bidet kit.
- Keep the included roll of thread seal tape nearby, in case of water leaks.
- If a fitting leaks, drain the toilet and bidet, and wrap the threads of the leaking connection in an additional layer of seal tape. Reconnect and retest.

## INSTALLATION INSTRUCTIONS



For the installation process  
check out [vhealth.link/zlj](https://vhealth.link/zlj)

1. Turn off the water supply valve at the wall behind the toilet
2. Hold down the flush handle to flush the toilet and completely drain the tank.



3. With the tank drained, disconnect the toilet water supply hose from under the toilet tank. Use pliers to loosen the connection if needed.



4. Put the large Flat Rubber Gasket inside the top of the T-Valve.

**Note:** the gasket may already be in place.

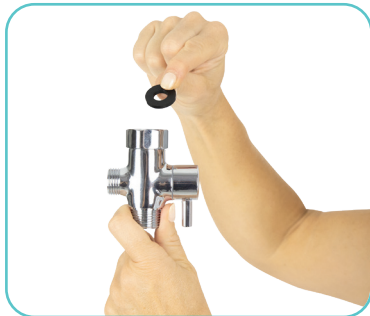

5. Remove the hose caps from the end of the Bidet Hose.



6. Wrap the threads of the T-Valve, Sprayer Handle, and toilet tank in a thin layer of thread seal tape.



7. Attach the short rounded connector on the Bidet hose to the smallest end of the T-valve and the long angled connector to the Sprayer Head.

**Note:** Be sure not to over-tighten connections.

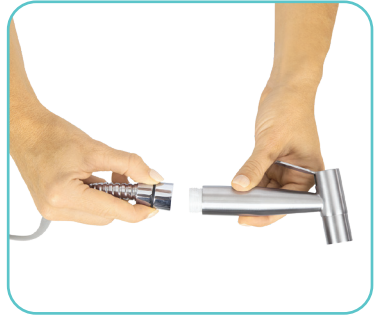
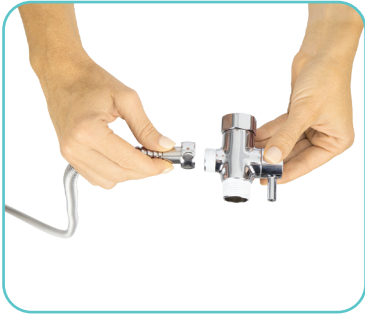

8. Connect the top of the T-Valve to the toilet tank.

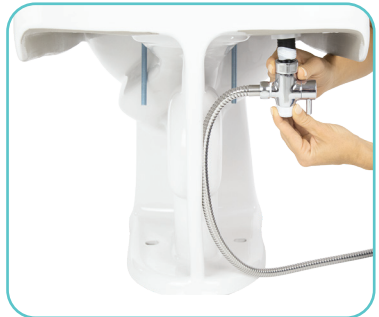

9. Connect the toilet water supply hose to the bottom of the T-valve.



10. Mount the Sprayer Holder. You have two options for completing this step:

a. Toilet Mount

Attach the Sprayer Holder to the Holder Hook using screws with a flat end (included). Hang the mount on the side of the toilet in the desired location:



b. Wall Mount

Using only the Sprayer Holder, locate the appropriate spot on the wall near the toilet. Use screws with a pointy end and anchors (included) to attach the Holder to the wall.



11. Fit the Sprayer Handle into the holder.



12. Turn the water supply valve back on at the wall.
13. Wait five minutes before use to allow water pressure to build and check for leaks. If there are no leaks, the kit is fully installed.
  - a. If any connection point leaks, turn off the water (step 1), drain the toilet with the flush handle (step 2), disconnect the parts, retape (step 6), reconnect and retest (steps 12 & 13)

## OPERATION INSTRUCTIONS

1. Turn the T-valve lever up to allow water to flow to the Bidet Sprayer Head.
2. Direct the Handheld Bidet Sprayer head in the appropriate direction.
3. Press the sprayer lever to release water from a gentle wash to a jet spray.
4. Close the T-valve by pushing the lever down to turn off the water when finished.

### WARNING

Always turn the T-valve off after each use. Failing to turn the T-valve off after use will cause water pressure to build up and weaken the internal components of the sprayer. This may lead to flooding and water damage.

## GOT MORE QUESTIONS?

Check out our list of Frequently Asked Questions at [vhealth.link/zlj](https://vhealth.link/zlj) for helpful answers.



And if that doesn't answer your question, our customer service team would love to help! Feel free to connect with them by phone, e-mail, or chat on our website.

 [service@vivehealth.com](mailto:service@vivehealth.com)

 1-800-487-3808

 [vivehealth.com](https://vivehealth.com)

Distributed by

**vive**  
health

8995 Fontana Del Sol Way  
Naples, FL 34109