

vive®



COMPACT OVERBED TABLE

Owner's Manual
LVA2048

vivehealth.com

OVERVIEW

We are constantly answering questions and recording helpful videos to make using your Vive Compact Overbed Table as easy as possible. Check out the included links and QR codes to help you through the process.



To see all of the FAQs in one place, visit vhealth.link/28j

WHAT'S INCLUDED

- (A) 1x Table Top
- (B) 1x Tension Rod
- (C) 1x Silver L-Shape Pipe
- (D) 1x Tension Knob
- (E) 1x Tension Washer
- (F) 1x Height Adjusting Knob
- (G) 1x Black Frame Pipe
- (H) 1x Leg with Locking Wheels
- (I) 2x Bolts
- (J) 1x Leg with Non-Locking Wheels

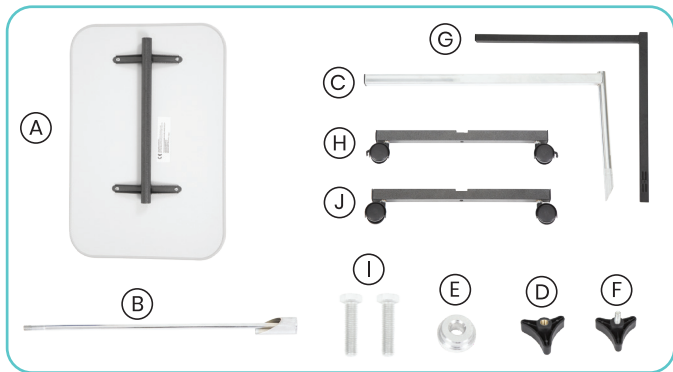

ASSEMBLY INSTRUCTIONS



For video demonstration,
check out vhealth.link/p4i

1. Insert Tension Rod (B) into
The Silver L-Shape Pipe (C).



2. Insert Tension Washer (E)
onto the end of the
Tension Rod (D) so it will
fit flush with the hole of
the Silver L-Shape Pipe (C).



3. Connect Tension Knob
(D) to the Tension Rod (B),
but do NOT tighten all the
way yet, as you will not
be able to complete the
next step.



4. Slide Table Top (A) into L-Shape Pipe (C), then tighten Tension Knob (D).



5. Insert the Black Frame Pipe (G) onto the Silver L-Shape Pipe (C).



6. Add the Height Adjusting Knob (F) to the Black Frame Pipe (G).



7. Join Leg with Locking Wheels (H) and Leg with Non-Locking Wheels (J) to the Frame (G) using the 2x Bolts (I).



NOTE: The Locking Wheels should be placed with the lock facing out flush to the pipe side of the table. This way they can easily be locked and unlocked when underneath a bed.

Note: The Table Top height can be lowered or raised with the Height Adjusting Knob (F). The Table Top (A) tilting position can be adjusted with the Tension Knob (D), but (D) must be securely tightened after adjustment to prevent Table Top (A) from falling down.

SPECIFICATIONS

Table Length: 24"

Table Width: 16"

Table Height Range: 28"-46"

WARNING

- Max Weight Capacity - 22 LBS
- Do NOT leave this product outdoors.
- Avoid direct sunlight.
- Be cautious of the table height, the higher the height the greater the risk of tipping.

GOT MORE QUESTIONS?

Check out our list of Frequently Asked Questions at [vivehealth.link/28j](https://vivehealth.com/28j) for helpful answers.



And if that doesn't answer your question, our customer service team would love to help! Feel free to connect with them by phone, e-mail, or chat on our website.



service@vivehealth.com



1-800-487-3808



vivehealth.com

Distributed by

vive
health

8955 Fontana Del Sol Way
Naples, FL 34109