

Viking Tri-Pouch Bag For Batwing Fairing:



Parts:

- | | | |
|-----|----------------|-----|
| i | Windshield bag | x 1 |
| ii | Mounting Screw | x 3 |
| iii | Spacer | x 3 |

Parts Diagram:

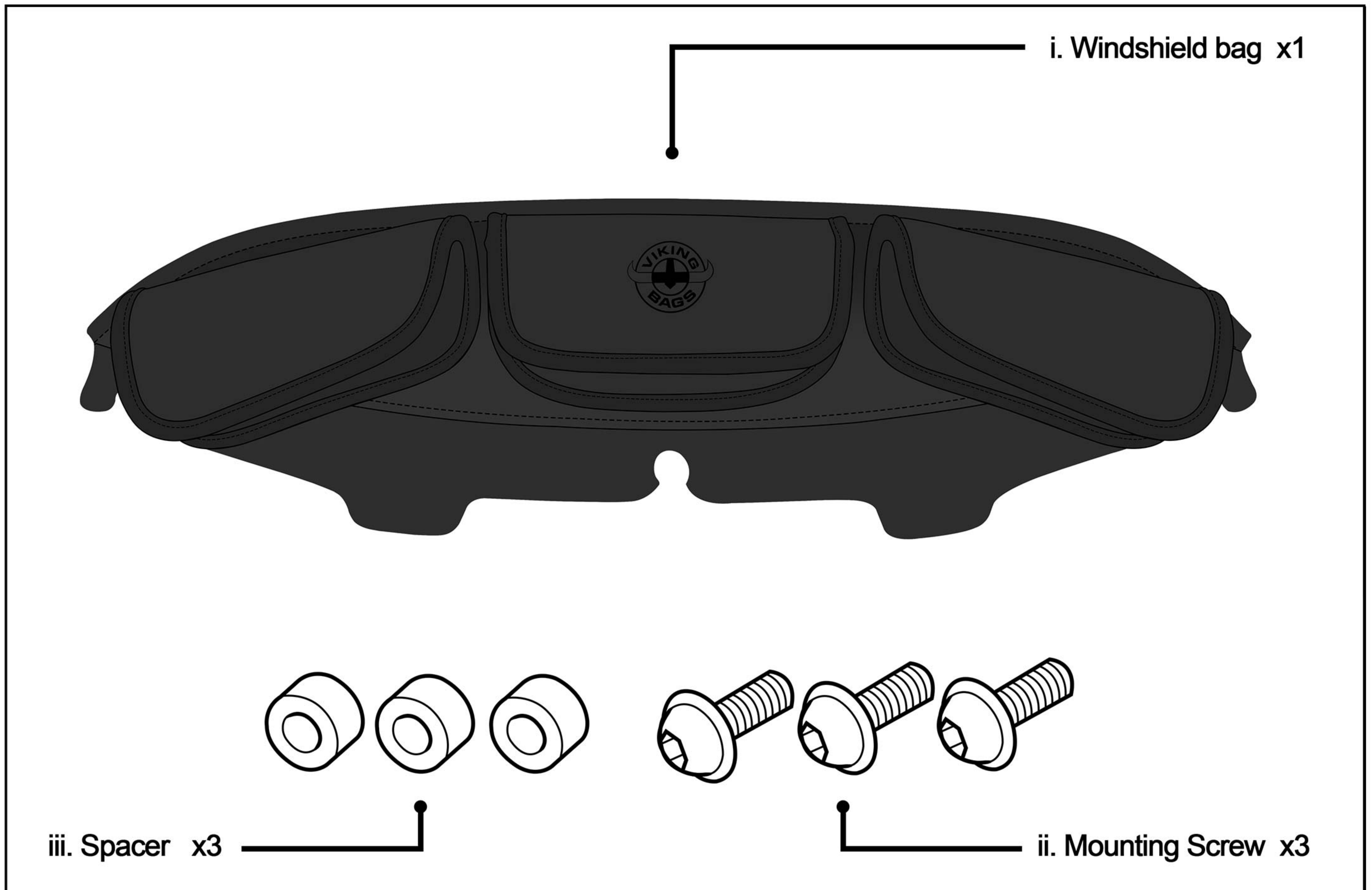

Step 1

As shown in Figure 1, remove the three front fairing screws located at the top of the fairing.

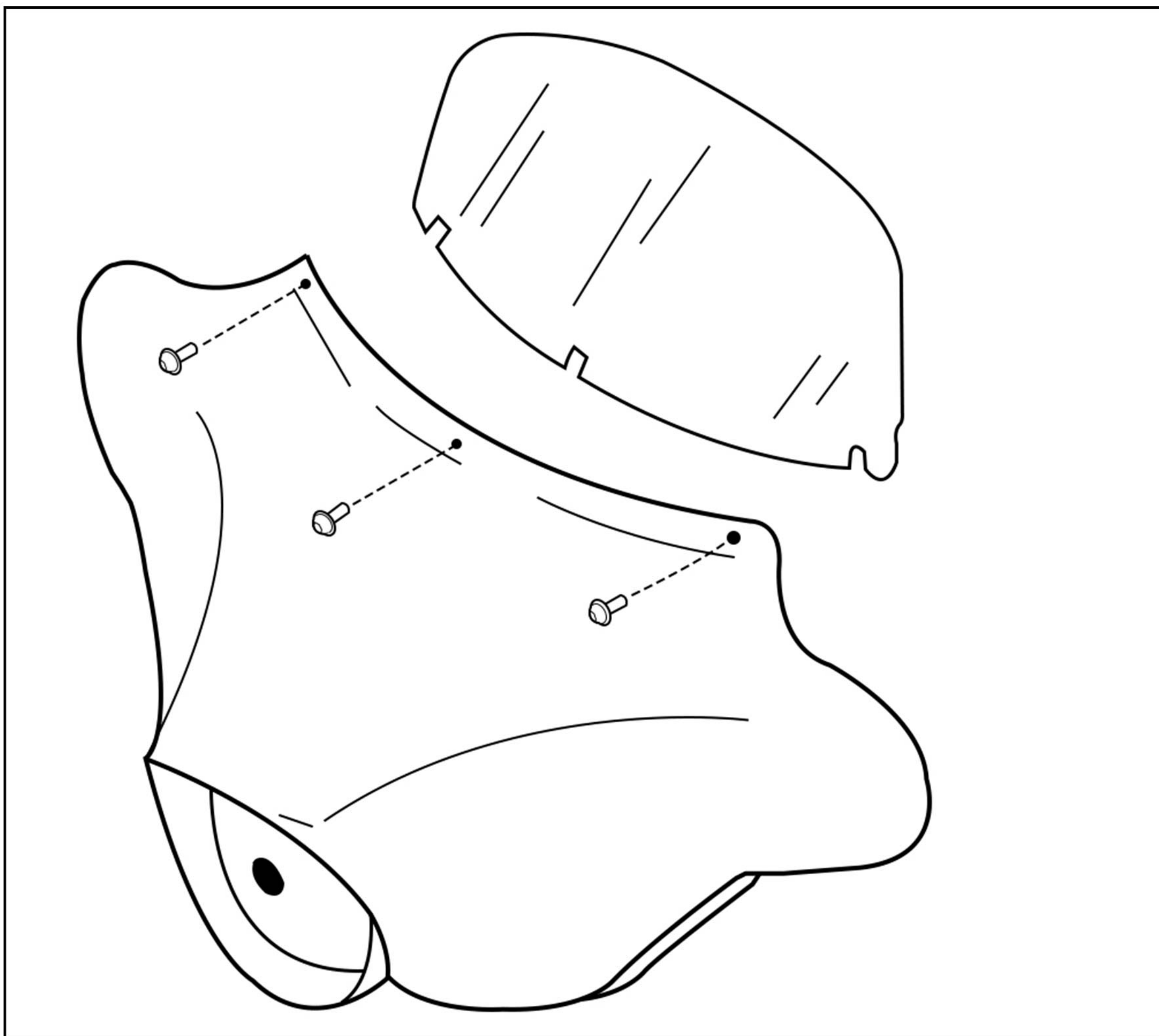

Fig 1. Removing the screws

Step 2

Loosen but do not remove the last few screws holding the outer fairing to the inner fairing. Then Pull the outer fairing back gently. Remove and set aside the windshield.

Step 3

See Figure 2. Take the three new fairing screws and spacers included in the kit. Use needle nose pliers to hold a spacer firmly between the inner and outer fairings. Screw the spacer and the outer fairing together. Tighten the screw only slightly. Repeat the procedure for the other two fairing screws and spacers.

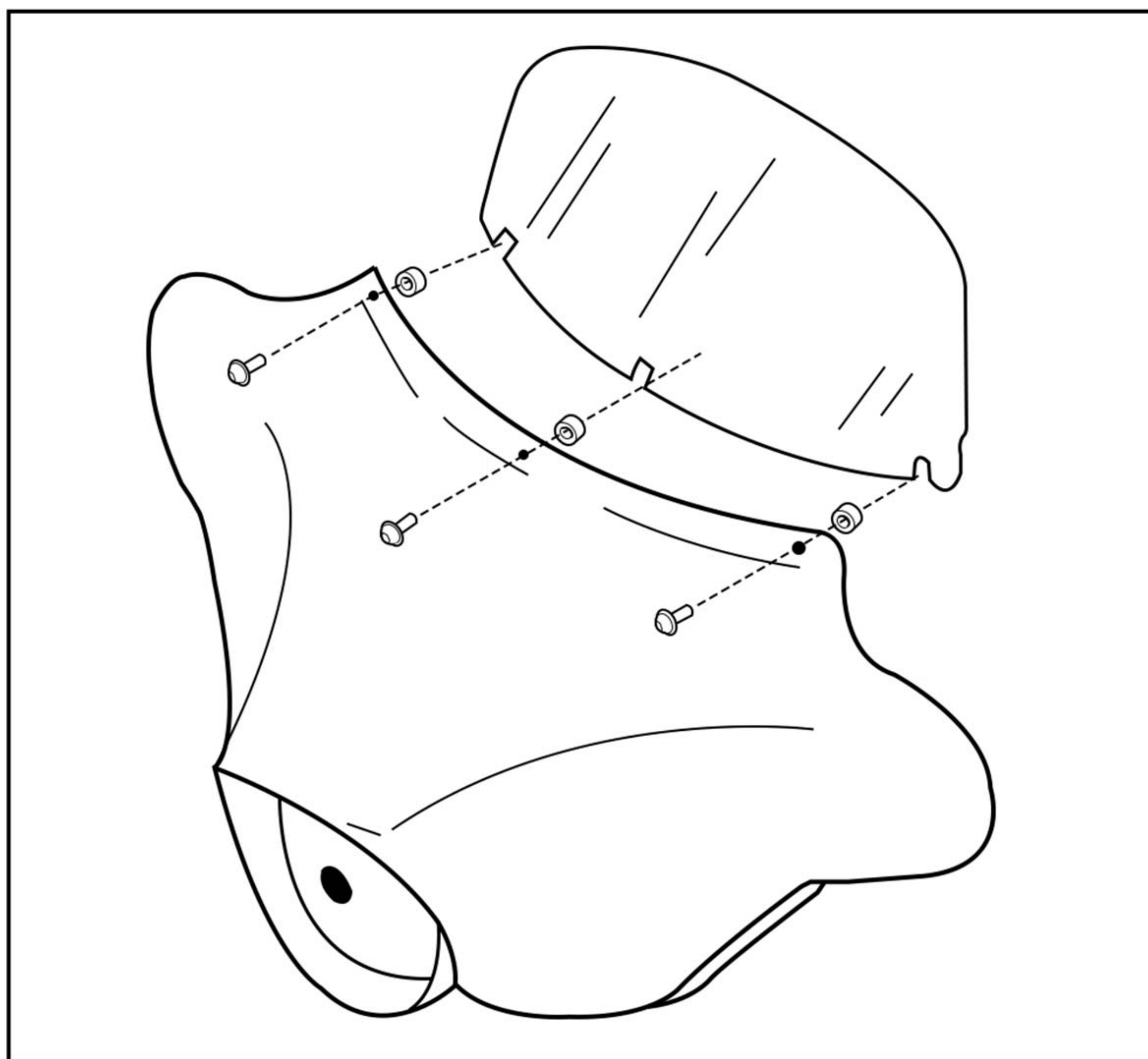

Figure 2. Install the three mounting screws and spacers.

Step 4

Place the windshield in between the inner and outer fairings.

Step 5

Install the bag between the windshield and the interior fairings. See Figure 3.

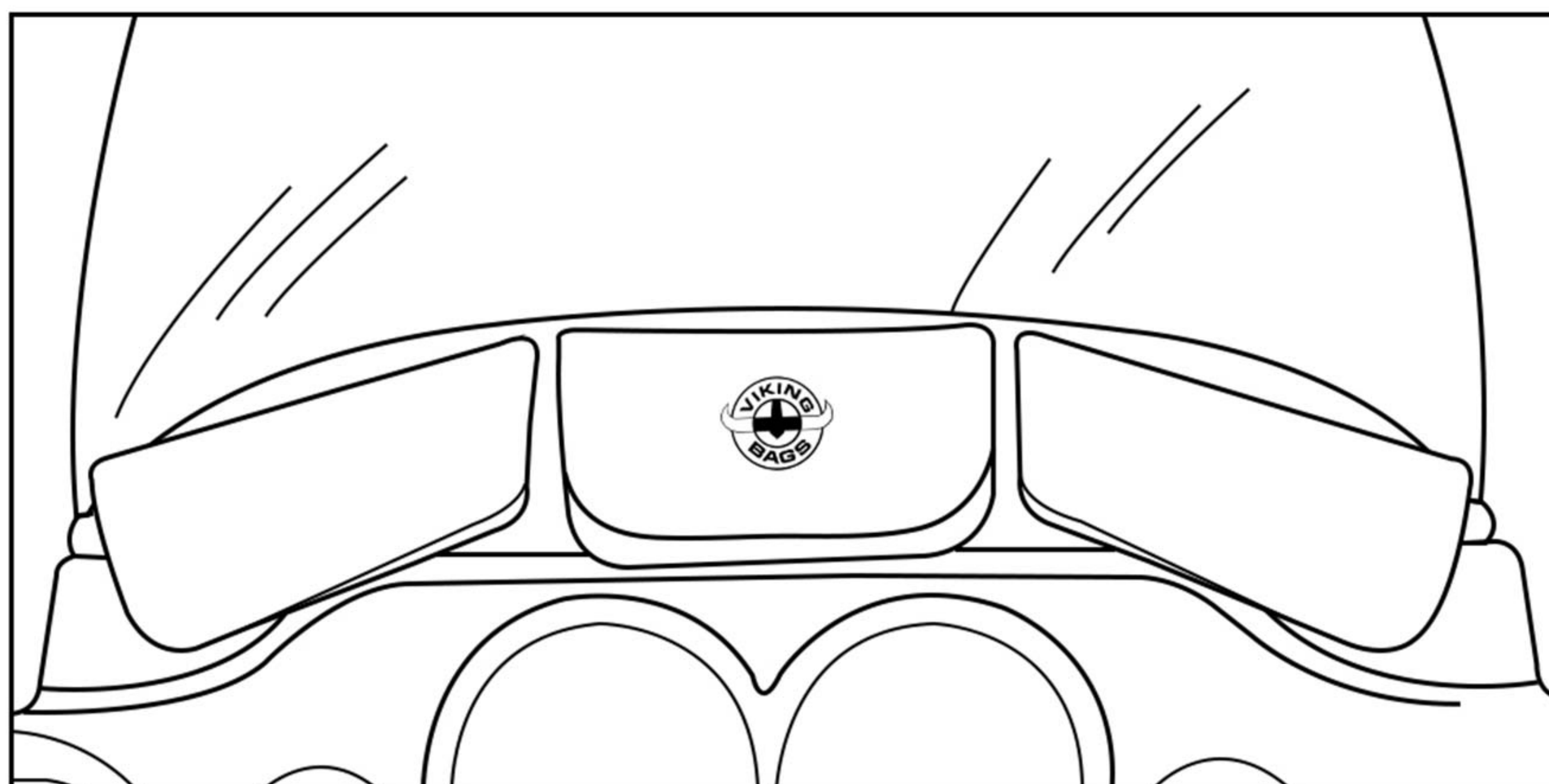

Figure 3. Sliding the bag between the windshield and the inner fairing

Step 6

Lastly, check that the windshield bag and the windshield are securely fastened. Tightening the three fairing screws to a torque of 2.3-3.4 Nm is recommended.

**Congratulations! Your bag is installed and now
you are ready to ride!**

Warnings !

- Do not install if any of the mounting hardware is damaged or impaired.
- If you have any questions or concerns about the installation, call Viking Bags or consult your local mechanic
- Ensure no part of the bag constructs any of the moving parts of the bike
- Viking Bags is not liable for any damage or malfunctions caused to your bike during the installation process
- Improper loading can cause vehicle handling problems leading to death or severe injury.