

Viking Universal Motorcycle Fairing:



Parts:

Fairing Assembly			Top Mount Headlight Relocation Hardware:		
i	Fairing	x1	xi	Headlight Bracket	x1
ii	Fairing Bracket	x2	xii	HexBolt1/2-20x1 1/2	x1
iii	Adjustment Bracket	x2			
iv	Fork Bracket	x4			
v	Hose Clamps	x4			
vi	Philips Pan Head Screw	x4			
vii	Flat Washer	x8			
viii	Split Lock Washer	x4			
ix	Flange Hex Bolt	x8			
x	Button Head Cap	x6			

Note:

- i. This item is a universal fairing. There is no specific setup on how to mount it. The fairing should fit bikes with 5 3/4" headlight and 35-49 mm front fork distance.
- ii. The included hardware is intended for several different models, some applications may not use all the included hardware.
- iii. With some adjustments on the four brackets (fairing, adjustment, fork , and headlight brackets), the fairing may fit additional models.

Parts Diagram:

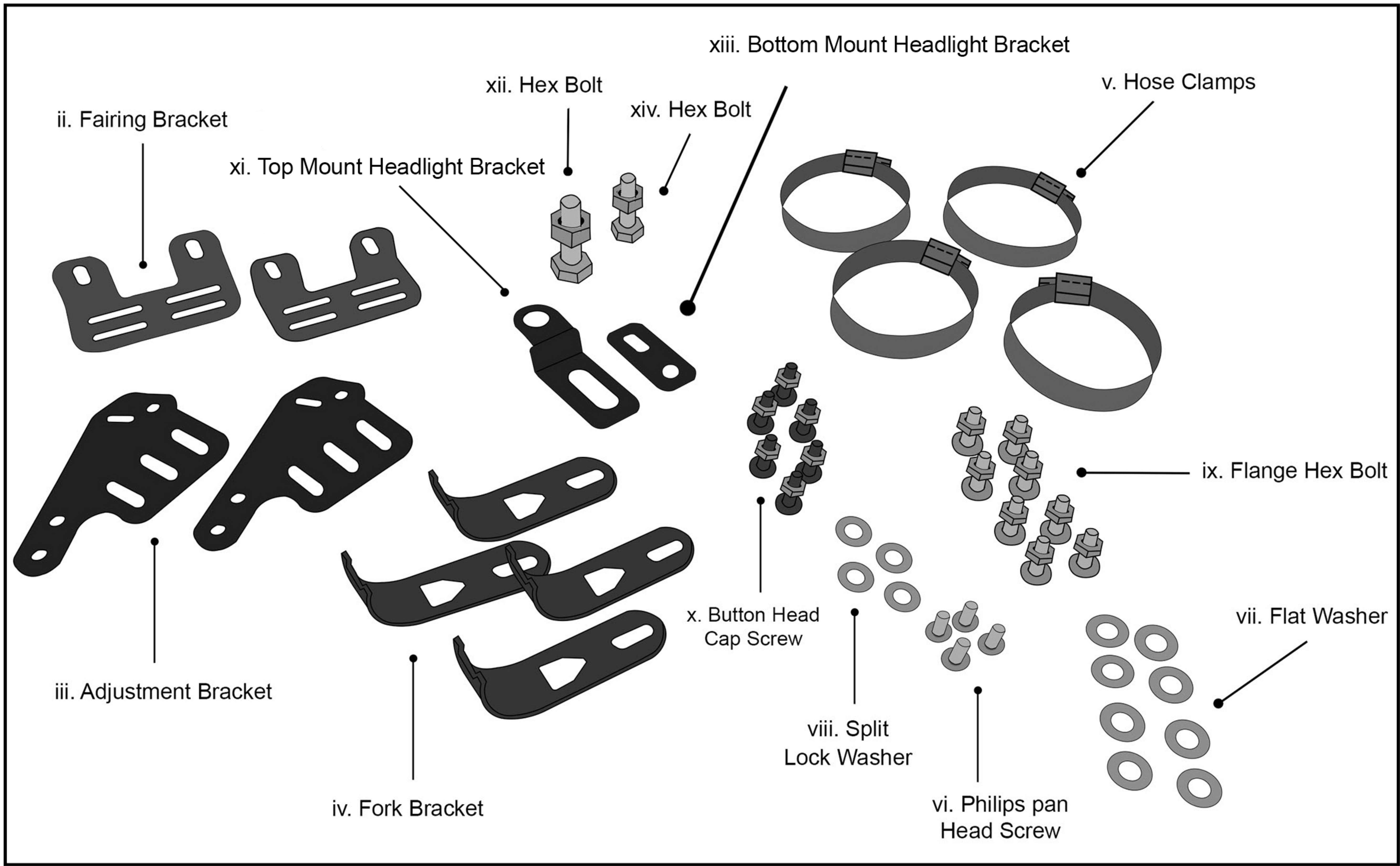

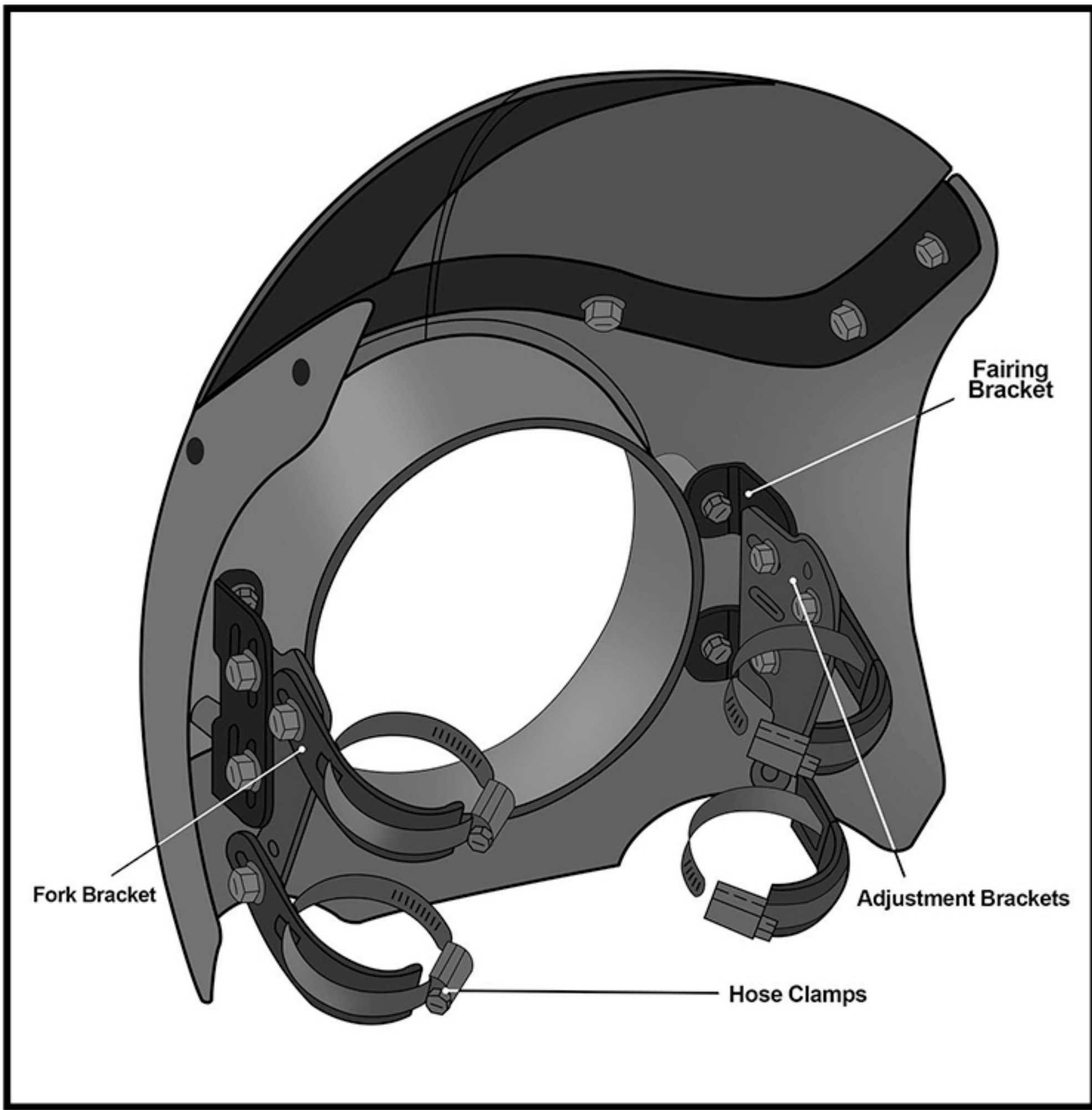

Fig 1. XL Setup

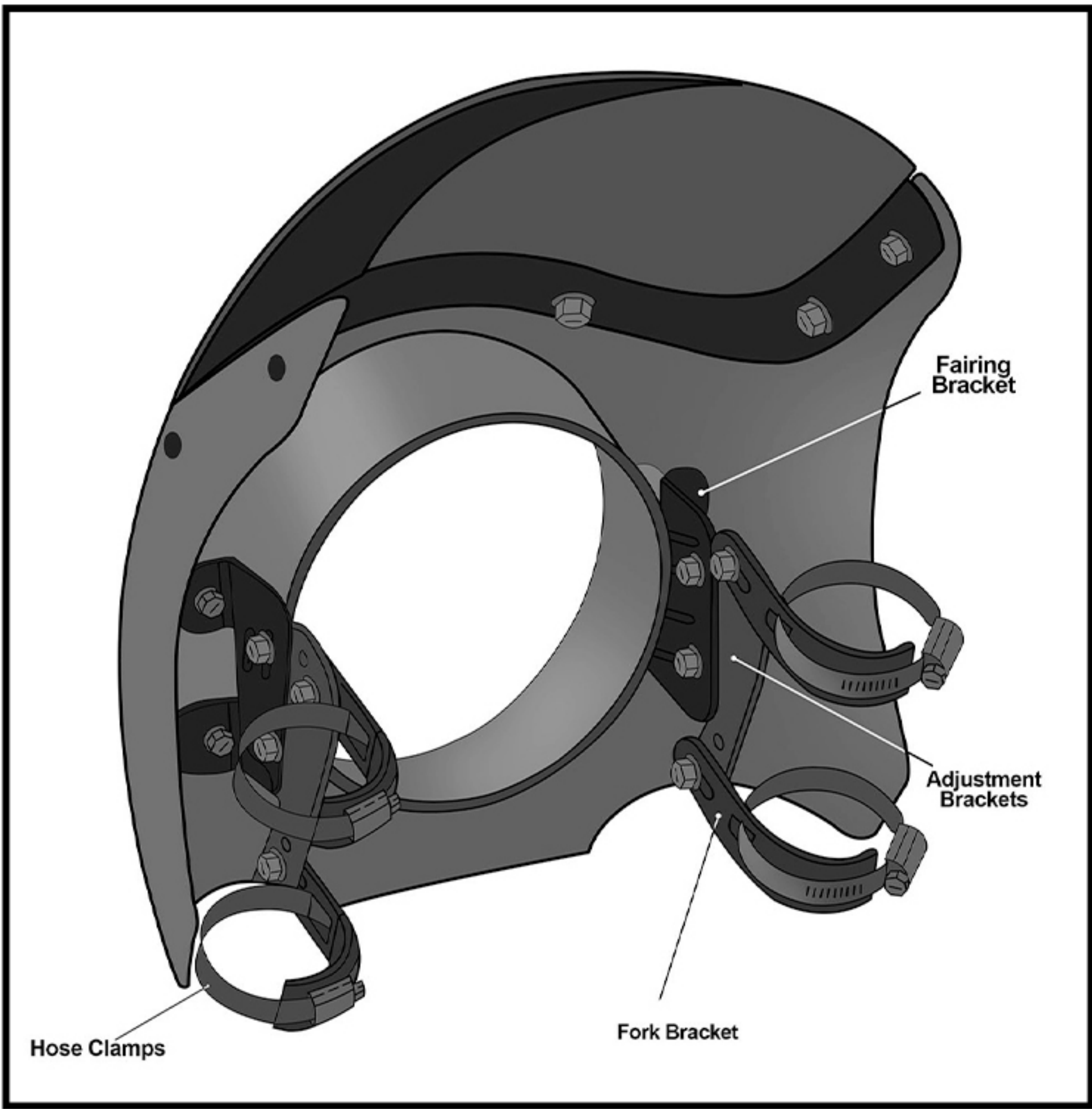

Fig 2. Dyna Setup

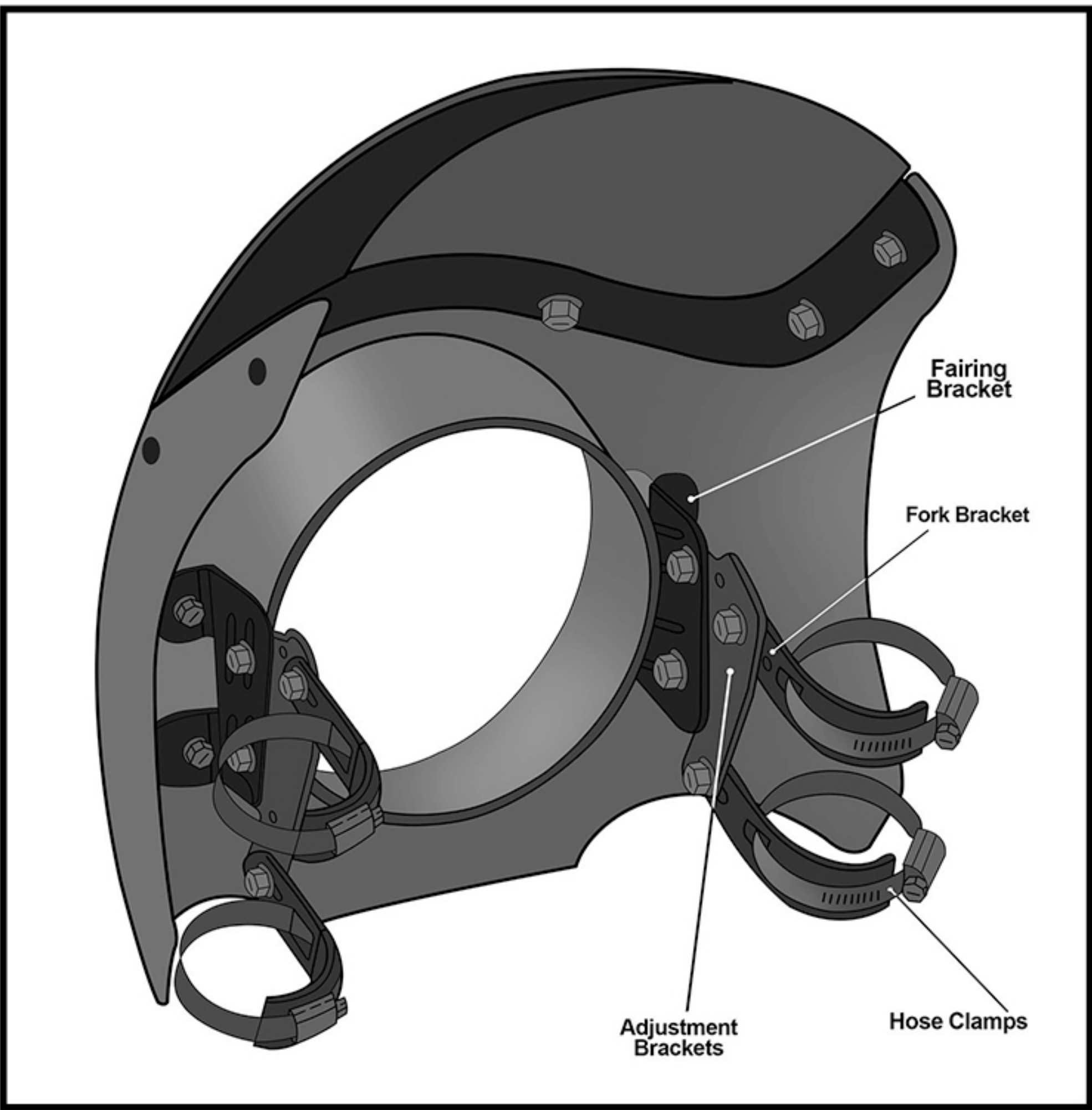

Fig 3. Forty Eight Setup

Installation Instructions:

Step 1:

Install the fairing brackets (ii.) onto the fairing using Phillips head screws (vi.) and Split Lock Washers (viii.). Next, install the adjustment brackets (iii.) onto the fairing brackets (ii.) using flange hex bolts (ix.). Then, install the fork brackets (iv.) onto the adjustment brackets (iii.) using flange hex bolts (ix.). Lastly, install the fork brackets (iv.) onto the bike’s fork using the hose clamps (v.). Use Fig 1, 2, and 3 as a reference as to how to setup the fairing brackets. If your bike is not listed in the reference, you can adjust the placements of the fork bracket (iv.), adjustment brackets (iii.), and fairing bracket (ii.) to fit the fairing to your specific bike.

Step 2:

After installing all the brackets, keep all the bolts loose enough so the brackets can easily be positioned. Adjust the fairing height and tilt alignment using the adjustment brackets (iii.), the fairing brackets (ii.) and fork brackets (iv.) so the Fairing will align properly with your headlight and fork.

Note:

It is recommended to take the Hose Clamps off the Fork Bracket before putting the Fairing on and then add them back after.

Step 3:

Place fairing around the headlight allowing the headlight to sit inside the headlight opening. Adjust the headlight with the headlight relocation bracket if necessary. Refer to Fig 4 - Top Mount Headlight Relocation, Fig 5 - Bottom Mount Headlight Relocation, Fig 6 - Headlight Bucket Position. Make sure the fork bracket is straight and aligned with the bike’s fork.

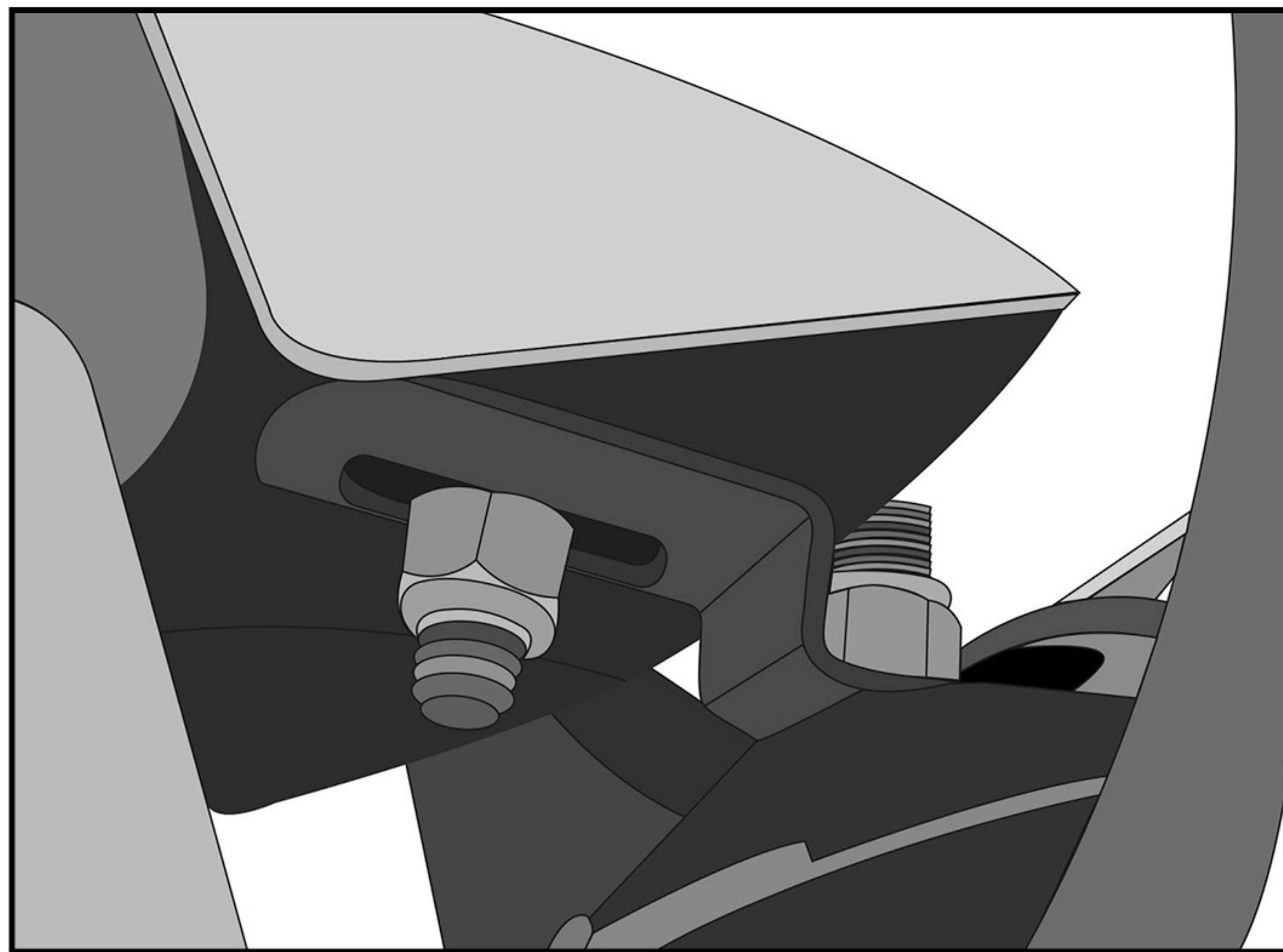

Fig 4. Top Mount Headlight relocation

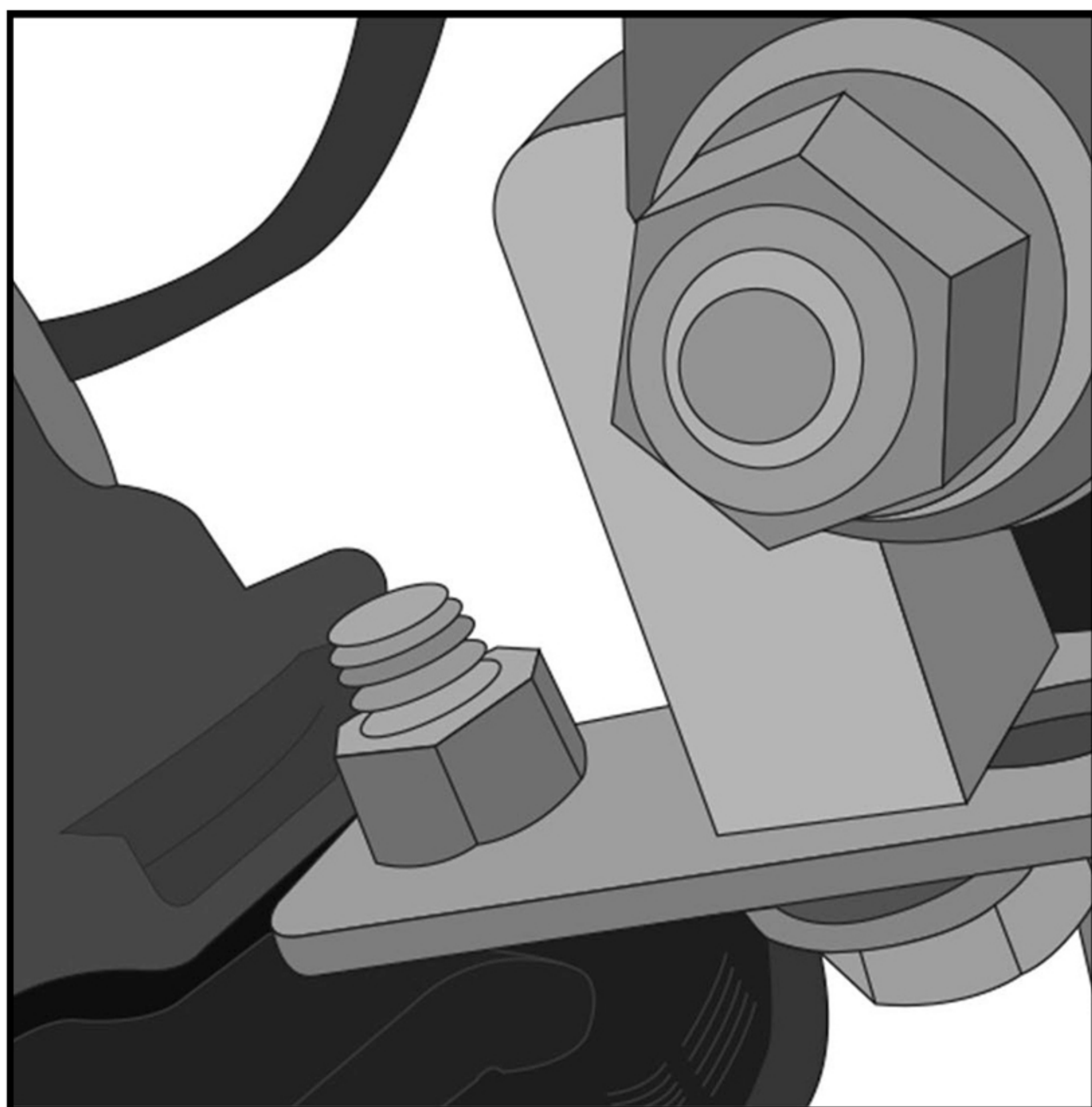

Fig 5. For Bottom headlight relocation



Fig 6. Headlight Bucket Position

Step 4:

Your may need to make several adjustments to make sure the fairing and the headlight are properly aligned per your desired setup.

Step 5:

Once you have the proper setup, torque all bracket bolts to 5 ft. lbs and torque hose clamps to 20-24 in. lbs.

**Congratulations, you have installed the Viking Motorcycle Fairing
and now you are ready to ride!**

Warnings!

- This installation requires modification to headlight location and some rerouting of some cables. In case you are unsure about your ability to install the fairing securely, please seek assistance from a qualified mechanic.
- Viking Bags is not liable for any damage or malfunctions caused to your bike during the installation process.
- It is important to note that if you do not mount the fairing properly damage may be caused to the motorcycle.
- Sporadically check for shifting of the bolts and verify that no part of the mounting system is interfering with any part of the bike while riding.
- Avoid usage of any mounting part that is impaired or is not working properly.