

HOW TO USE A DT-RT1 REMOVAL PICK

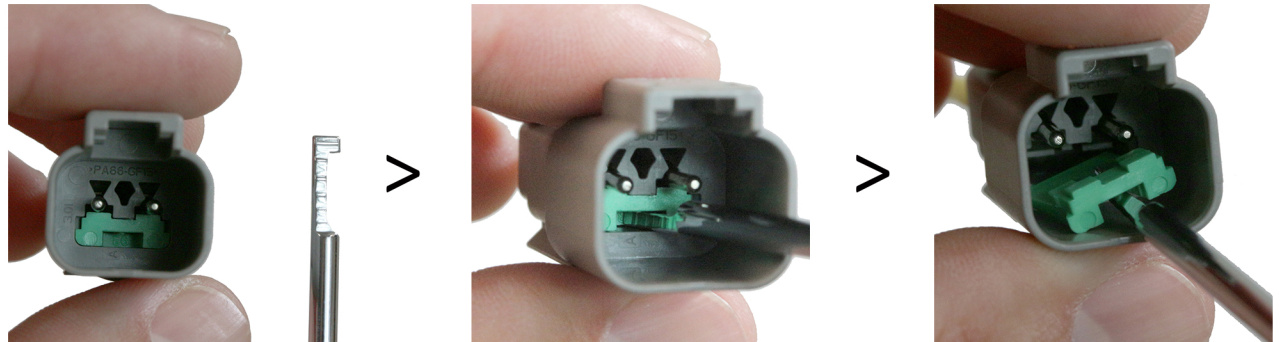

To remove wedgelocks from receptacle connectors, insert the hooked end of the tool into the slot on the wedgelock. Then pull the wedgelock out of its groove.



To remove wedgelocks from plug connectors, press the flat end of the tool underneath the wedgelock and pry it upward.



To remove contacts from a connector, first remove the wedgelock (see instructions above). Then use the flat end of the tool to depress the terminal's locking tab while pulling the wire out through the back of the connector.

