



**Video assembly instructions available online**

**EASY ASSEMBLY AND OPERATION INSTRUCTIONS**

23SV23792\_Predator of the Night



**READ AND SAVE THESE INSTRUCTIONS FOR FUTURE REFERENCE**

**ASSEMBLY REQUIRES AT LEAST 2 ADULTS, 3 ADULTS ARE RECOMMENDED. PLEASE FOLLOW THE STEP BY STEP GUIDE AND ENJOY YOUR PREDATOR OF THE NIGHT!**

**IF ANY PART IS MISSING OR BROKEN, DO NOT ATTEMPT TO ASSEMBLE THE PRODUCT AND CONTACT SVI CUSTOMER SERVICE FROM 8:30AM TO 5:30PM PST AT 1-855-428-3921, EMAIL CUSTOMERSERVICE@SVIUS.COM, OR CALL THE HOME DEPOT CUSTOMER SERVICE AT 1-855-434-6543 (1-855-HDHOLIDAY).**

**IMPORTANT TIPS:**

- Ensure that the item's adapter is plugged in at the Function Control Box and in the wall.
- Ensure that the switch on the function control box is on the desired setting.
- If not functioning properly (ex: Mouth doesn't move, head doesn't move, LEDs don't light up), ensure that cables are connected to their corresponding cable as shown in the instruction sheet.
- Be sure nothing is blocking movement or caught in moving parts.
- Ensure that the floor or surface that the item sits on is flat and level.
- Ensure that the volume is not all the way down.
- Be sure nothing is blocking the sensor.
- If the item still does not work, contact SVI Customer Service from 8:30am to 5:30pm PST at 1-855-428-3921, email customerservice@svious.com, or call Home Accents Holiday Customer Service from Mon-Fri 8:00am to 7:00pm and Sat 9:00 am To 6:00 pm EST at 1-855-HDHOLIDAY (1-855-434-6543).

**PARTS LIST**

- A. Base x 1
  - B. Left Foot x 1
  - C. Right Foot x 1
  - D. Left Pole x 1
  - E. Right Pole x 1
  - F. Left Calf x 1
  - G. Right Calf x 1
  - H. Left Upper Pole x 1
  - I. Right Upper Pole x 1
  - J. Left Thigh x 1
  - K. Right Thigh x 1
  - L. Body x 1
  - M. Left Arm x 1
  - N. Right Arm x 1
  - O. Left Wing x 1
  - P. Right Wing x 1
  - Q. Head x 1
  - R. Base Extensions x 4
  - S. Stakes x 4
  - T. Left Wing Cap x 1
  - U. Right Wing Cap x 1
  - V. Right Rear Cap x 1
  - W. Left Rear Cap x 1
  - X. Loop Screw x 1
  - Y. Tether Cable x 1
  - Z. Small Parts Bag x 1
  - Z1. Adapter \* x 1
- \* Power Adapter Spec  
Input: 120VAC 50/60Hz  
Output: 5.9V 2A

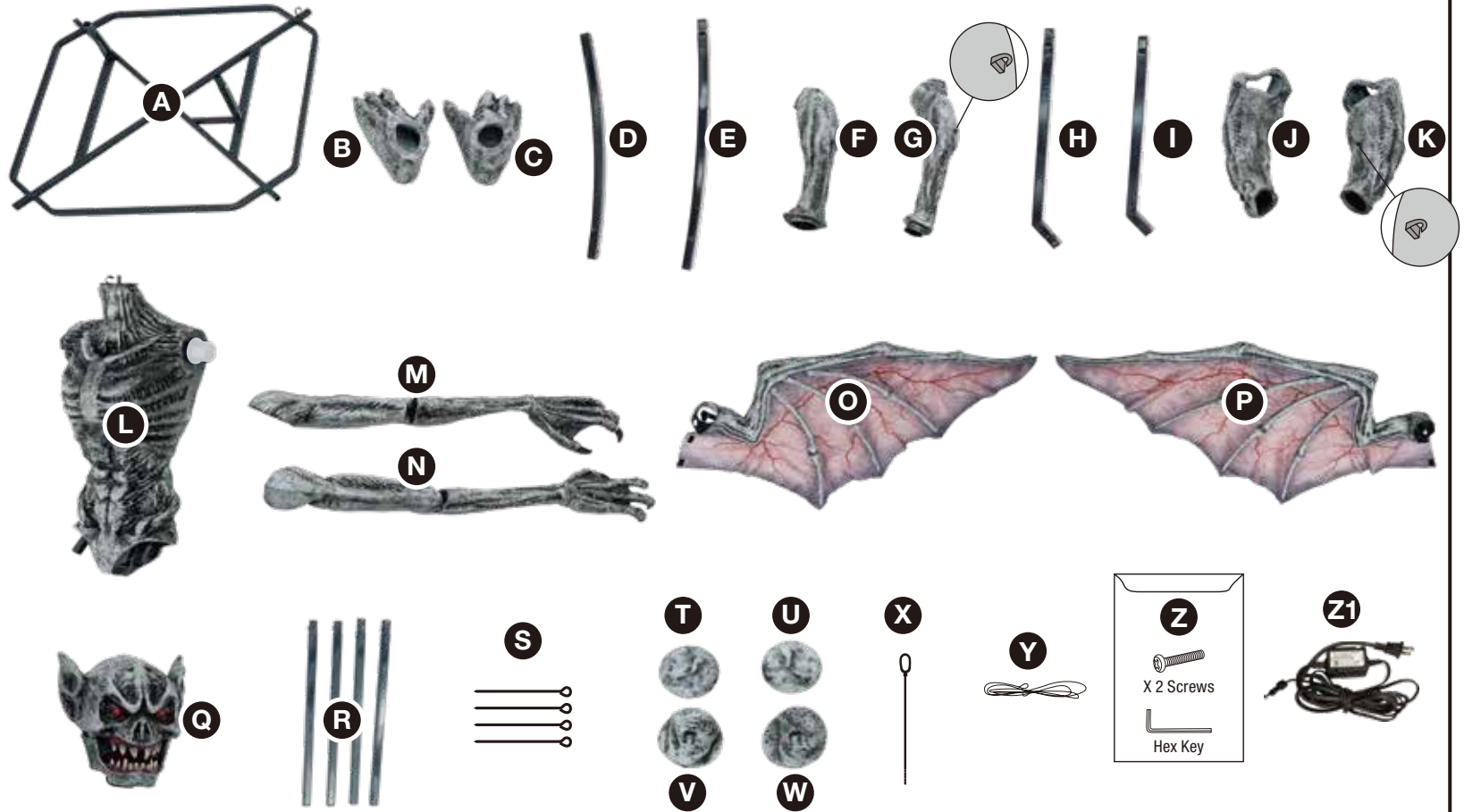

NOTE: Throughout the instructions, Right and Left are relative to the character. Allen wrench included for assembly. A stepladder is recommended for assembly. The hooks on the (A) Base are towards the back of the item.

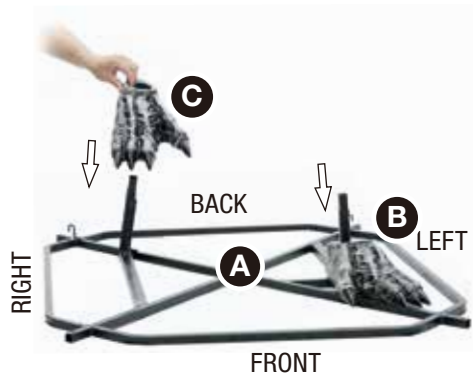
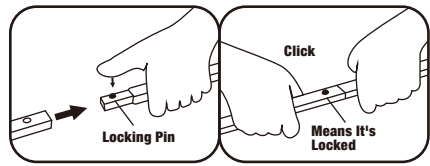

1.1

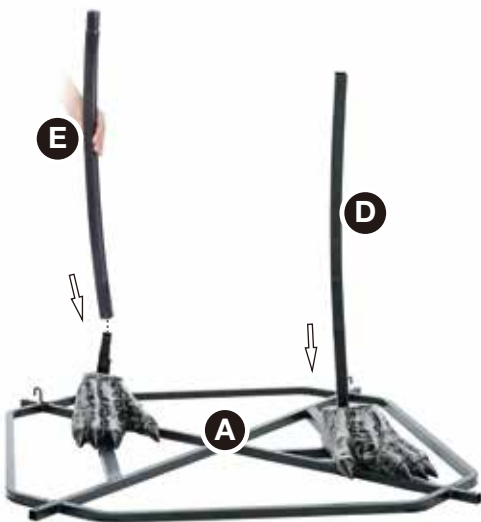

1.2

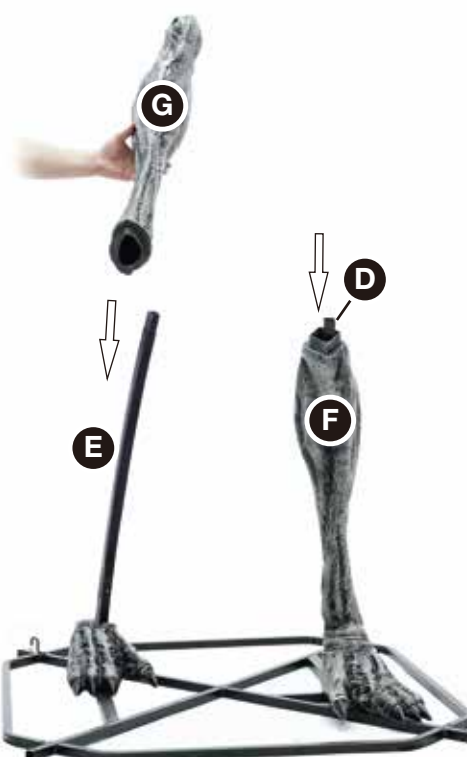

2.1

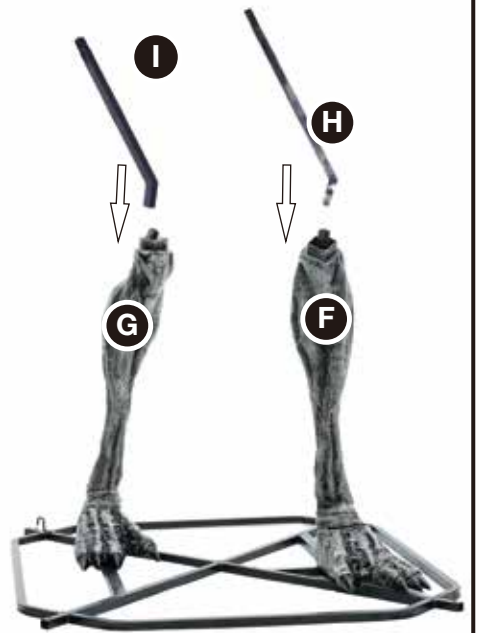

2.2



NOTE: Slide the two (J, K) Thighs onto the (H, I) Upper Support Poles and then fit them onto the (F, G) Calves as shown.

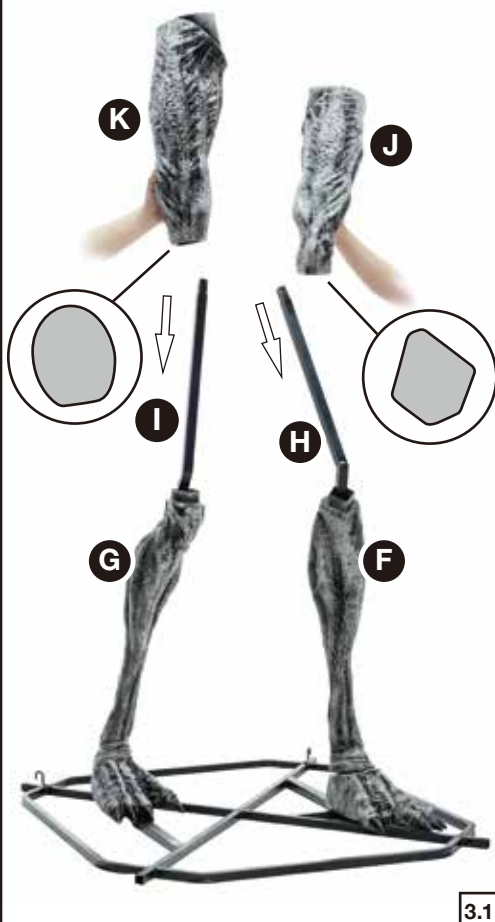

3.1

NOTE: More than 2 people are advised when assembling the (L) Body to the (H, I) Upper Support Poles and the (J, K) Thighs.

If there is difficulty in assembling the (L) Body, try adjusting the (J, K) Thighs until they are properly aligned.

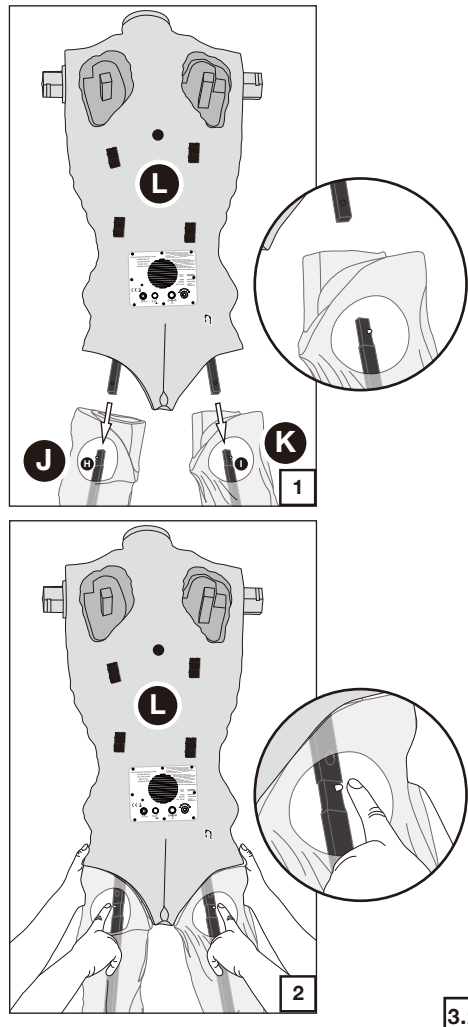

3.2

NOTE: Lean the Predator of the Night against the box it came with for easier assembly. 2 adults are strongly recommended for this step.

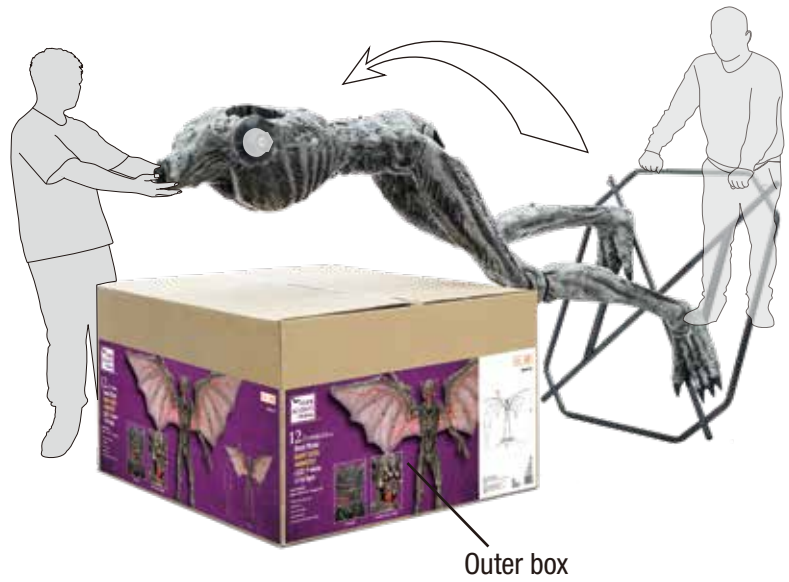

Outer box

4.1

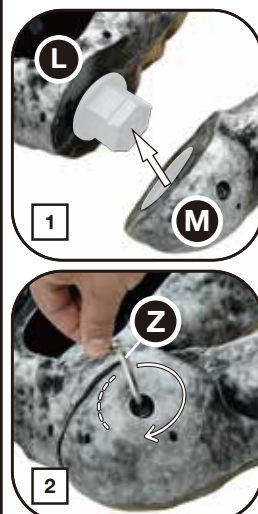

Note: Do NOT overtighten this bolt. Overtightening may result in damage to the product. Adjust the arm position to your preference. If a bolt is missing, check inside the box as it may have fallen out of the arm.



4.2



5.1

CAUTION: Cable may have sharp ends, use caution when assembling. If cable cannot reach, the upper body of the Predator of the Night needs to be lifted while in its laying position. This should enable the cable to reach.

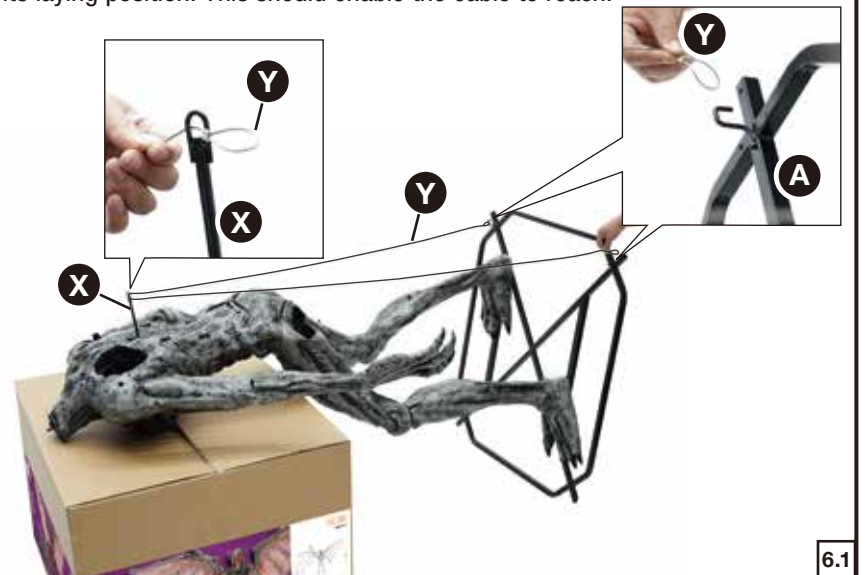

6.1

NOTE: Rotate the (X) Screw Loop into the threading available inside the back of the (L) Body.

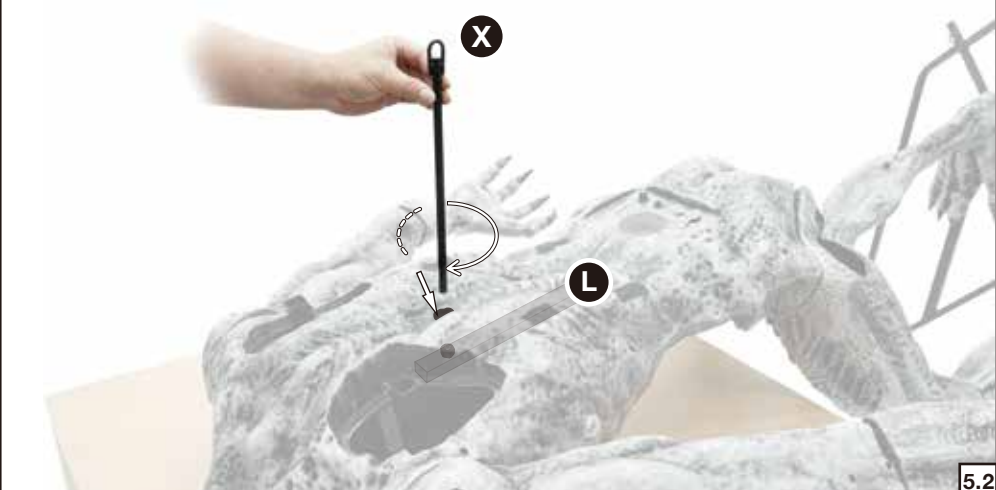

5.2

NOTE: Screw in the screws from the (Z) Small Parts Bag into the nuts available at the openings behind the upper area of the (L) Body. You will need a Phillips head screwdriver (Not Included).

Note: The screw should not emerge into the frame. The screw should only be rotated so it is fully in the nut only.

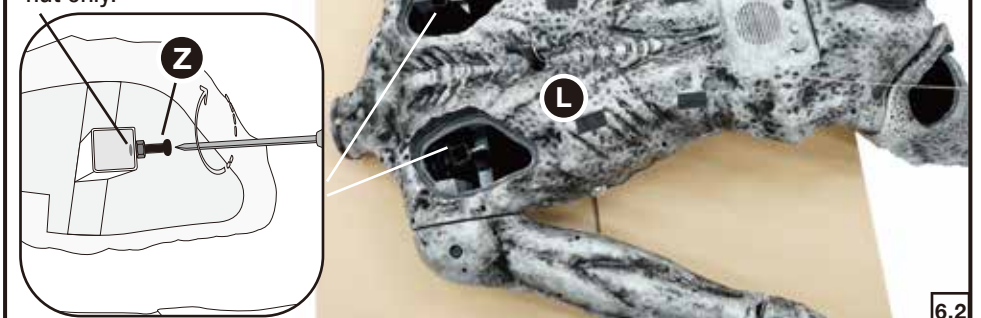

6.2



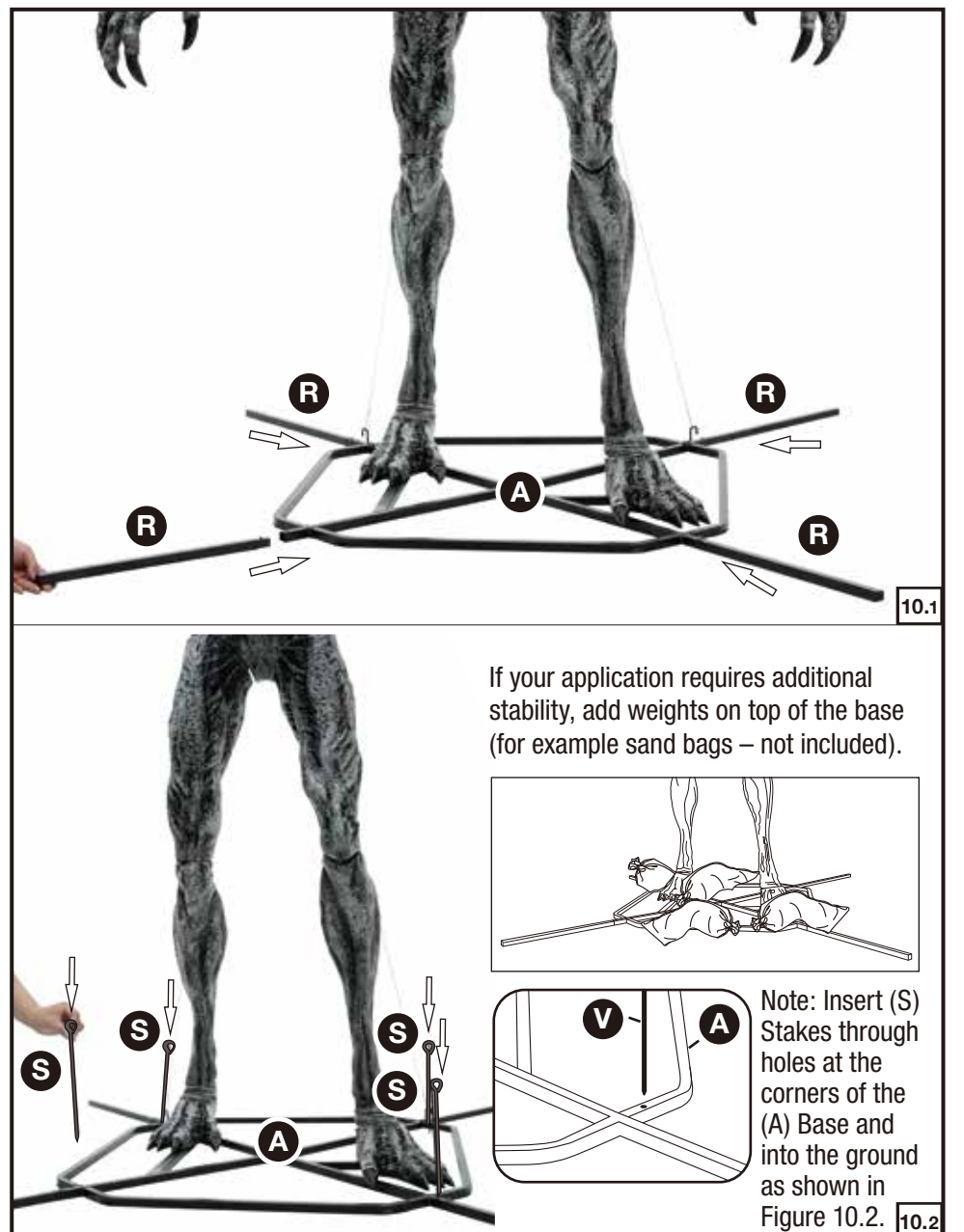
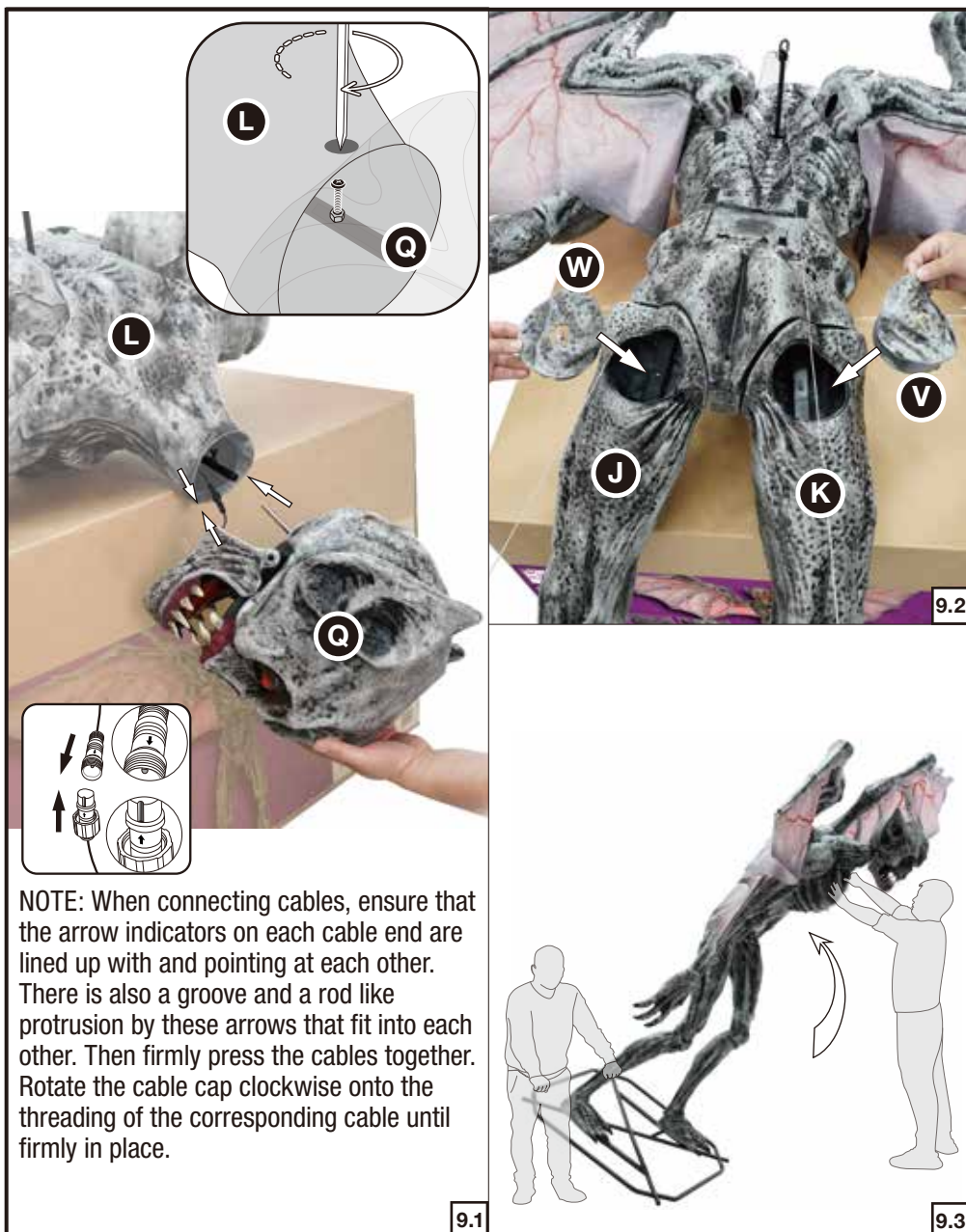
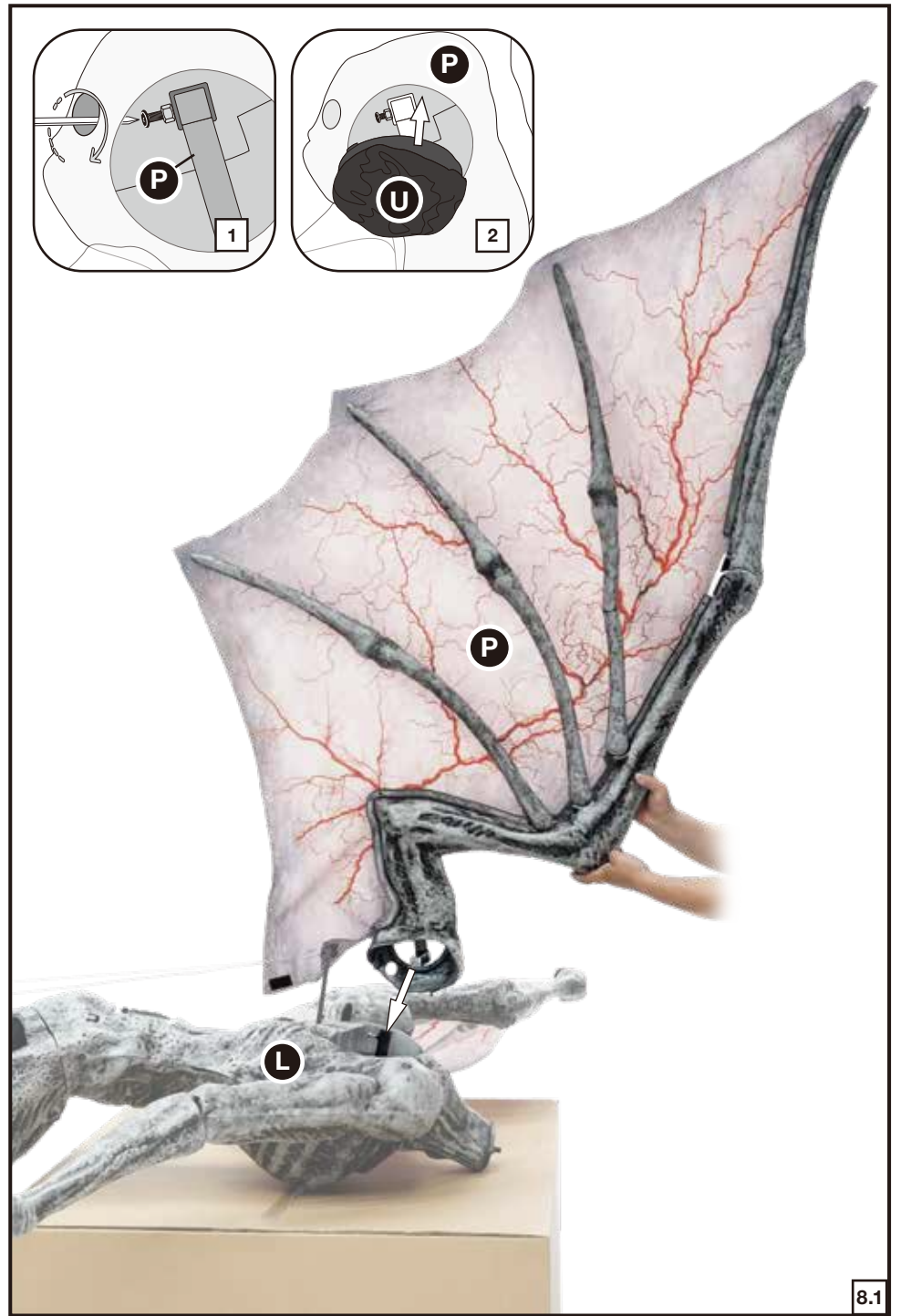
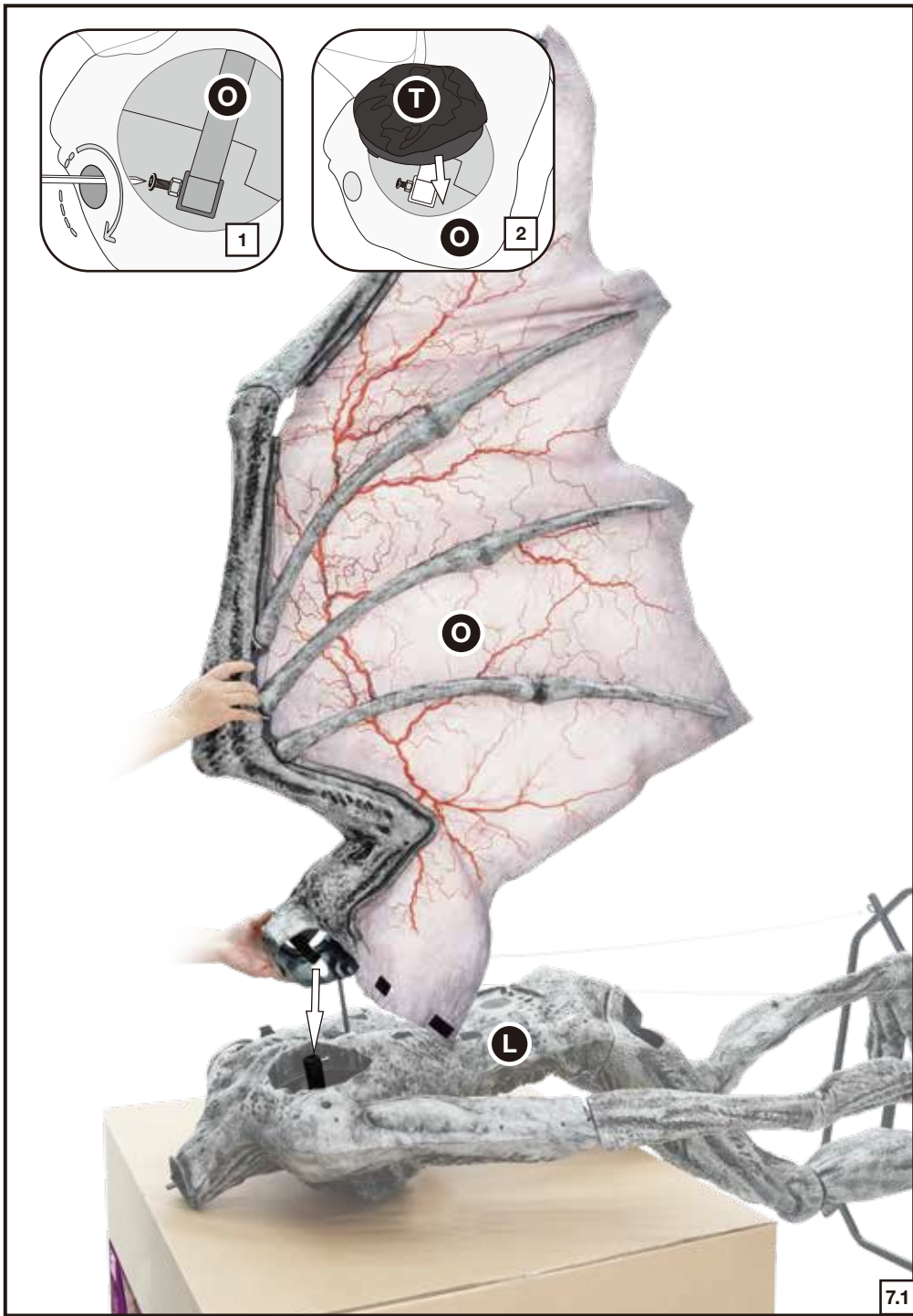



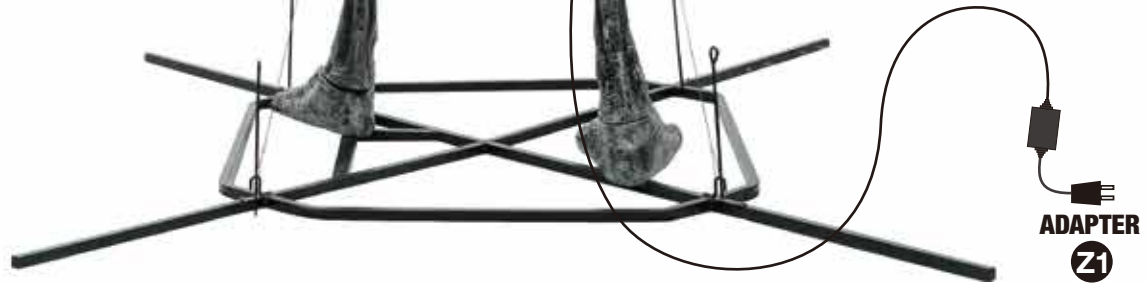
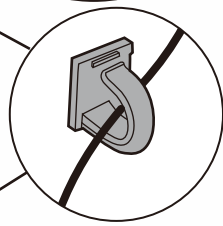
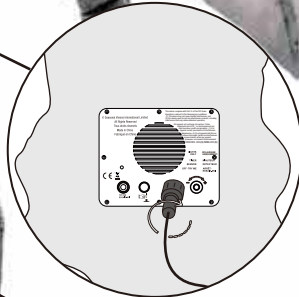
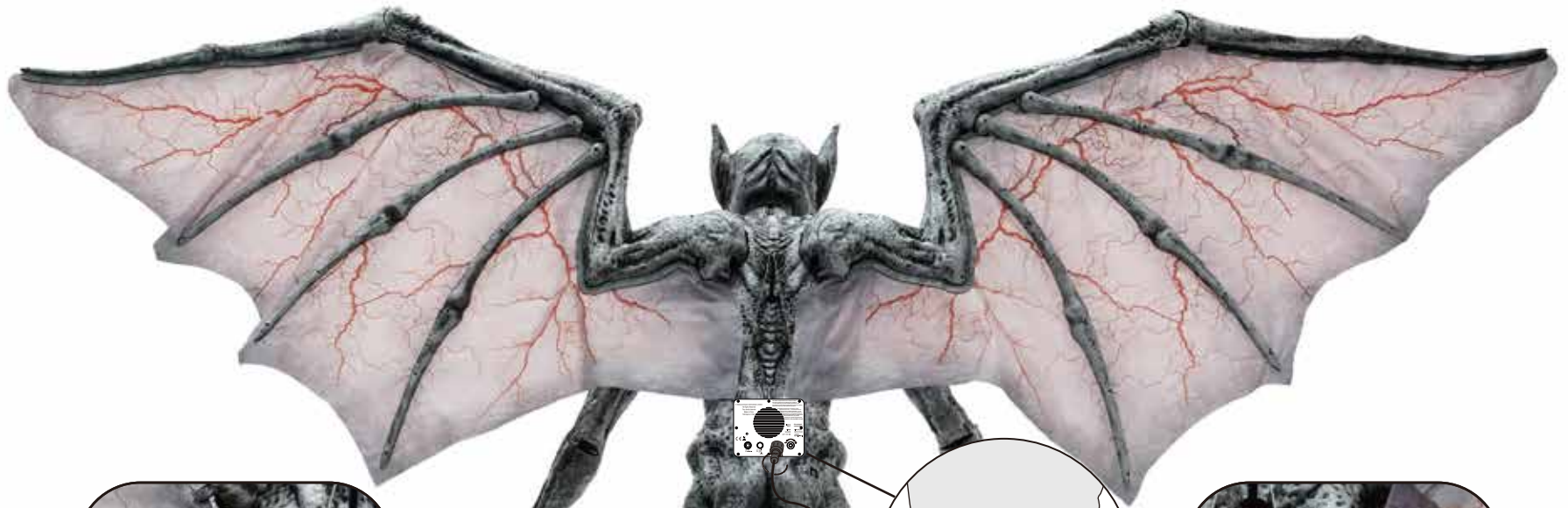

**IR SENSOR**  
Be sure nothing is blocking the sensor.

**PREDATOR OF THE NIGHT IS NOW FULLY ASSEMBLED. PLUG IN AND TURN ON TO LET THE FUN BEGIN!**



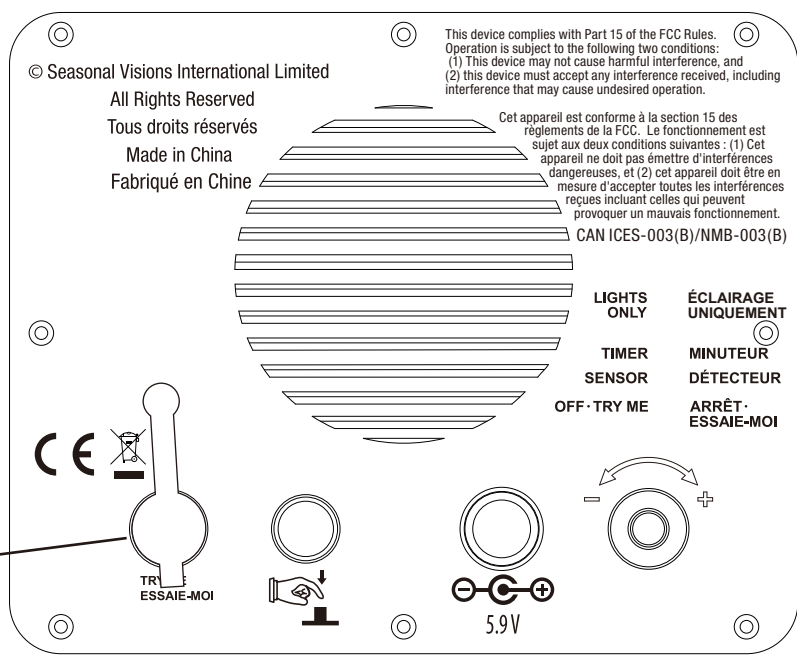

**NOTE:** Make sure the waterproof cap is covering the Try Me receiver at all times when not in use.

**OPERATION INSTRUCTIONS:**

The Predator of the Night is powered by an adapter. Plug in the power adapter into a standard power outlet. To turn on the Predator of the Night, press the button on the Function Control Box. Press the button again to switch to the Timer setting. Press the button a third time to switch to the Sensor setting. Press the button a fourth time to turn the item Off.

The item is activated by pressing the button on the Function Control Box and has the following settings:

LIGHTS ONLY / ÉCLAIRAGE UNIQUEMENT	This switch mode will activate the lights of the item. This switch mode does not have any animation and sound.
TIMER / MINUTEUR	Timer begins daily cycles of LIGHTS ONLY for 6hrs, then ALL functions off for 18hrs. Predator of the Night does not speak or move on Timer setting.
SENSOR / DÉTECTEUR	This switch mode will activate lights, sound, and animation when the Infra-red (IR) sensor is activated and will operate for 1 audio-cycle with each activation. The Infra-red (IR) sensor has a range of up to 2 m/6.5 ft. and will activate when someone comes within an 80-degree angle from left-to-right, as well as from above and below. The Predator of the Night roars and moves only when the control box is set to "SENSOR" and the sensor is activated. Between activations, the Predator of the Night LEDs will light up.
OFF • TRY ME / ARRÊT • ESSAIE-MOI	This setting will deactivate the lights, sound, and animation of the item. This mode also allows the item to be activated if triggered by using a Step Here Try Me Activation Pad (Not Included). The item will operate for one audio cycle with each Try Me activation.
	Raise or lower the volume using the volume control turn dial, turn all the way down to turn the volume off.

**THE PREDATOR OF THE NIGHT IS COMPATIBLE WITH EXTERNAL TIMERS AND PRESERVES ITS SETTING WHEN THE POWER IS TURNED OFF/ON.**

**WARNING:**

- Lay product down before a storm or strong winds.
- Don't climb or pull on product.
- Don't add to or modify product.
- Assemble and place the product on level surfaces only.
- Don't push or tilt product.

**WARNING**

This item is not a toy and should be used for decoration only. This item contains small parts that can be a choking hazard. Keep all plastic and wire parts away from children.

1. Please use the adapter supplied by manufacturer.
2. Please assemble item according to instructions. Connect all wires according to matching color.
3. Children should be supervised by adults. Item should not be grabbed, as it becomes a tipping hazard. Keep flammables away from the adapter, as it heats up during operation.

Please view all instructions carefully before assembling. Save this instruction sheet for future reference.

**CARE AND STORAGE INSTRUCTIONS**

When not in use, store this product in its original packing. Keep away from heat and moisture.

This device complies with Part 15 of the FCC Rules. Operation is subject to the following two conditions: (1) This device may not cause harmful interference, and (2) this device must accept any interference received, including interference that may cause undesired operation.

**CAUTION:** Changes or modifications not expressly approved by the party responsible for compliance could void the user's authority to operate the equipment.

**NOTE:** This equipment has been tested and found to comply with the limits for a Class B digital device, pursuant to Part 15 of the FCC Rules. These limits are designed to provide reasonable protection against harmful interference in a residential installation. This equipment generates, uses, and can radiate radio frequency energy and, if not installed and used in accordance with the instructions, may cause harmful interference to radio communications. However, there is no guarantee that interference will not occur in a particular installation. If this equipment does cause harmful interference to radio or television reception, which can be determined by turning the equipment off and on, the user is encouraged to try to correct the interference by one or more of the following measures: Reorient or relocate the receiving antenna, increase the separation between the equipment and receiver. Connect the equipment into an outlet on a circuit different from that to which the receiver is connected. Consult the dealer or experienced radio/TV technician for help.

CAN ICES-003(B)/NMB-003(B)

1

**WE SUGGEST AT LEAST TWO ADULTS FOR ASSEMBLY**

2

**NO MOVING AFTER FULLY ASSEMBLED**

3

**LEVEL AREA ONLY**

7

**USE WEIGHTS ON THE BASE**

8

**DO NOT DISPLAY DURING STRONG WINDS**

4

**DO NOT PUSH OR TILT**

5

**DO NOT CLIMB OR PULL ON**

6

**DO NOT ADD TO OR MODIFY (ADD COSTUME KITS FROM THE HOME DEPOT ONLY)**

9

**CONTACT US IF EYES, MOUTH, LIGHTS DON'T WORK**

10

**CONTACT US**  
**1-855-434-6543**  
**(1-855-HDHoliday)**