Quick start installation manual

Congratulations on the purchase of your new WORKDONE Hard Drive Caddy.

Our quick guide provides basic installation instructions, and for further information and guidance, visit our support portal.



ENGLISH



ESPAÑOL



DEUTSCH



ITALIANO



FRANÇAIS





Final checklist before installation:



My DELL PowerEdge server has a **2.5-inch Drive Bay**

Drive Bay



I have checked the DELL PowerEdge **model compatibility sheet**

DELL PowerEdge Generation	1st	2nd	3rd	4th
Module Models	PC04	PC05	MD01	MD11
	MD02	PC06	MD02	MD12
	MD03	PC07	MD03	MD13
	MD04	PC08	MD04	MD14
	MD05	PC09	MD05	MD15
	MD06	PC10	MD06	MD16
	MD07	PC11	MD07	MD17
	MD08	PC12	MD08	MD18
	MD09	PC13	MD09	MD19
	MD10	PC14	MD10	MD20
	MD11	PC15	MD11	MD21
	MD12	PC16	MD12	MD22
	MD13	PC17	MD13	MD23
	MD14	PC18	MD14	MD24
	MD15	PC19	MD15	MD25
	MD16	PC20	MD16	MD26
	MD17	PC21	MD17	MD27
	MD18	PC22	MD18	MD28
	MD19	PC23	MD19	MD29
	MD20	PC24	MD20	MD30
	MD21	PC25	MD21	MD31
	MD22	PC26	MD22	MD32
	MD23	PC27	MD23	MD33
	MD24	PC28	MD24	MD34
	MD25	PC29	MD25	MD35
	MD26	PC30	MD26	MD36
	MD27	PC31	MD27	MD37
	MD28	PC32	MD28	MD38
	MD29	PC33	MD29	MD39
	MD30	PC34	MD30	MD40



My DELL PowerEdge server has a **Hot-Plug backplane**



I want to add a **small 2.5-inch Hard Drive** to my DELL PowerEdge server





Drive Bay

The same server model is delivered with **two different drive bay sizes**. Verify whether your server model has a smaller **3-inch / 7.7 cm** drive bay size for **2.5-inch** hard drives.

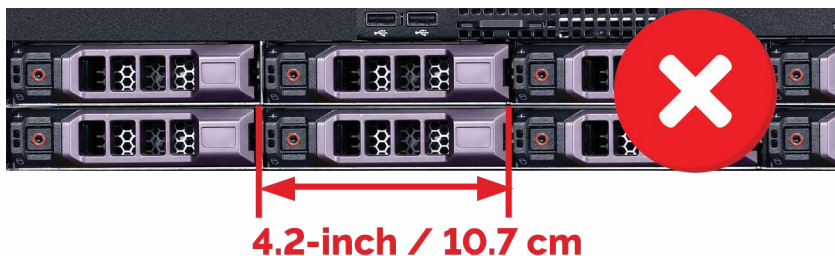

3-inch /
7.7 cm





Dell PowerEdge Front Drive Bay sizes



	Server Generation	Measurement of Hard Drive, wide	Measurement of DriveBay, wide
2.5"	16th–14th	2.8-inch / 7 cm	2.9-inch / 7.4 cm
	13th–11th	2.8-inch / 7 cm	3-inch / 7.7 cm
3.5"	16th–14th	4-inch / 10.2 cm	4.2-inch / 10.6 cm
	13th–11th	4-inch / 10.2 cm	4.2-inch / 10.7 cm



Installing a 2.5" Hard-Drive Into a 2.5" Hard-Drive Carrier

1. Insert the hard drive into the carrier with the SATA/SAS connector end facing the back.
2. Align the screw holes on the hard drive with the back set of holes on the carrier. Ensure the back of the hard drive is flush with the carrier.
3. Secure the hard drive to the carrier using the provided screws (4pcs).



1. Hard-drive carrier
2. Hard-drive
3. Screws (4pcs)

Installing a Hot-Swap Hard Drive:

1. Remove any installed hard-drive blank from the slot.
2. Press the release button (1) and open the carrier handle (2).
3. Slide the carrier into the slot until it connects with the backplane. Close the handle (2) to lock the hard drive in place.

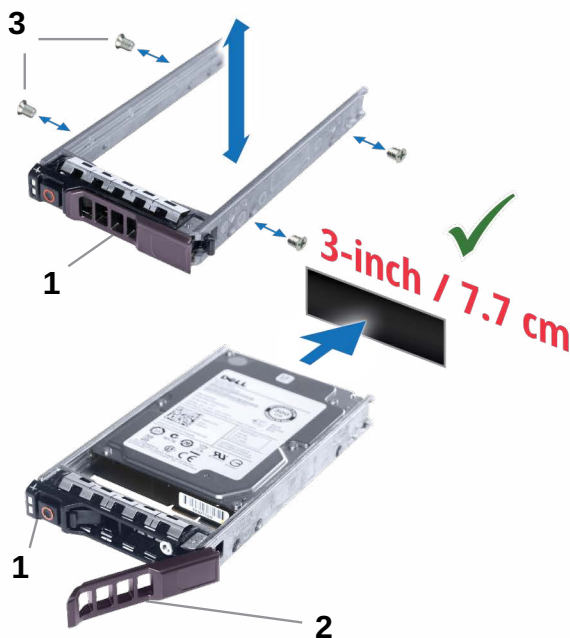



Hard-Drive Indicator Codes

Each hard drive carrier has an activity LED indicator and a status LED indicator. The indicators provide information about the current status of the hard drive.

Drive-status indicator pattern (RAID only)	Condition
Flashes green twice per second	Identifying drive or preparing for removal
Off	Drive ready for insertion or removal
Flashes green , amber , and turns off	Predicted drive failure
Flashes amber four times per second	Drive failed
Flashes green slowly	Drive rebuilding
Flashes green for three seconds, amber for three seconds, and turns off after six seconds	Rebuild stopped

Manual de instalación rápida

ESPAÑOL



Enhorabuena por la compra de su nuevo soporte para disco duro WORKDONE.

Nuestra guía de inicio rápido proporciona instrucciones básicas de instalación; para más información y orientación visite nuestro portal de servicio.



Lista de comprobación **final** antes de la instalación:

Alojamiento de la unidad de disco



PASO
01

Mi servidor DELL PowerEdge tiene una **bahía de unidad de 2,5 in**



PASO
02

He comprobado la **hoja de compatibilidad de los modelos DELL PowerEdge**

Dell PowerEdge Generation	T4E	T5E	T6E	T7E
Modelos compatibles	R540 R5405 M5405 M540	R5405 R540 M5405 M540	M5405 M540 M5405 M540	M5405 M540 M5405 M540
Modelos no compatibles	R5405 M5405 M540 M5405 M540	R5405 M5405 M540 M5405 M540	M5405 M5405 M540 M5405 M540	M5405 M5405 M540 M5405 M540



PASO
03

Mi servidor DELL PowerEdge está equipado con una **placa base Hot-Plug**



PASO
04

Quiero añadir un **pequeño disco duro de 2,5 in** a mi servidor DELL PowerEdge





Alojamiento de la **unidad**

El mismo modelo de servidor viene con **dos diferentes tamaños de bahía de unidad**. Compruebe si su modelo de servidor tiene **una bahía de unidad más pequeña de 7,7 cm para discos duros de 2,5 in.**

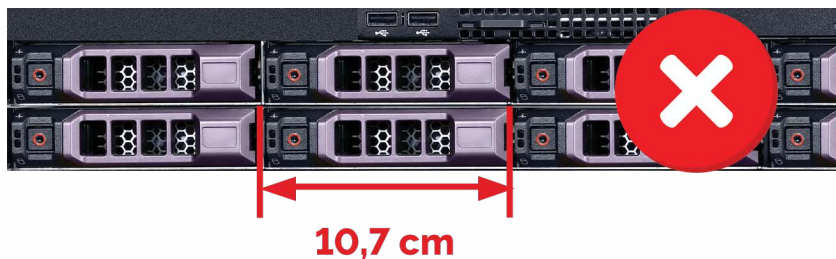

Dimensiones del alojamiento frontal de la unidad Dell PowerEdge

	Generación Servidor	Dimensión del disco duro, ancho	Dimensión alojamiento de unidad, ancho
2.5"	16 [^] -14 [^]	7 cm	7,4 cm
	13 [^] -11 [^]	7 cm	7,7 cm
3.5"	16 [^] -14 [^]	10,2 cm	10,6 cm
	13 [^] -11 [^]	10,2 cm	10,7 cm

Installing a 2.5" Hard-Drive Into a 2.5" Hard-Drive Carrier

1. Insert the hard drive into the carrier with the SATA/SAS connector end facing the back.
2. Align the screw holes on the hard drive with the back set of holes on the carrier. Ensure the back of the hard drive is flush with the carrier.
3. Secure the hard drive to the carrier using the provided screws (4pcs).

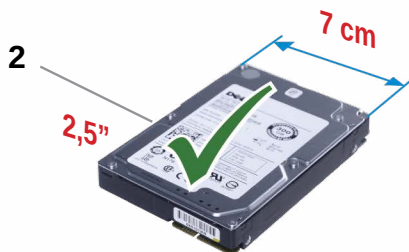

1. Hard-drive carrier
2. Hard-drive
3. Screws (4pcs)

Installing a Hot-Swap Hard Drive:

1. Remove any installed hard-drive blank from the slot.
2. Press the release button (1) and open the carrier handle (2).
3. Slide the carrier into the slot until it connects with the backplane. Close the handle (2) to lock the hard drive in place.

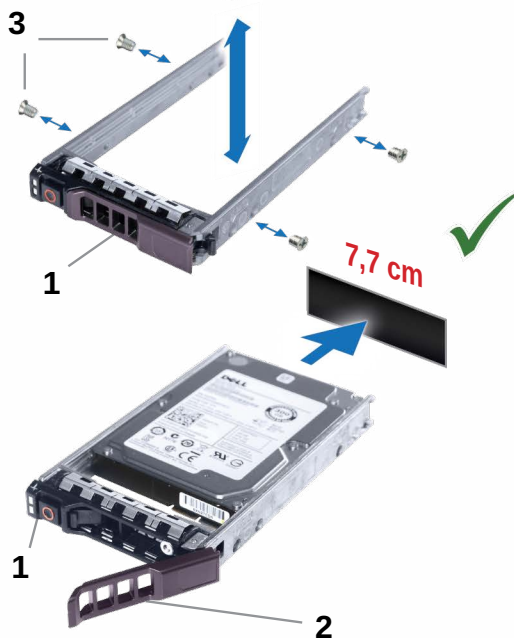



Códigos Indicadores de la Unidad de Disco Duro

Cada portauidades dispone de un indicador LED de actividad y otro indicador LED de estado. Los indicadores proporcionan información sobre el estado presente de la unidad de disco duro.

Patrón del indicador de estado del disco (solo RAID) Condición

Luz **verde** intermitente dos veces por segundo

Identifi cando a la unidad o preparando la unidad para ser expulsada.

Apagado

Unidad lista para ser insertada o removida.

Luz intermitente **verde**, **amarilla**, después de lo cual se apaga

Fallo previsto en la unidad

Luz intermitente **amarilla** cuatro veces por segundo

Unidad fallada.

Luz intermitente **verde** lenta

Reconstrucción de unidad.

Luz constante **verde**

Unidad en línea.

Luz intermitente **verde** por tres segundos, **amarilla** por tres segundos, después de lo cual se apaga al cabo de los seis segundos

Reconstrucción parada.

Schnellstart- anleitung

DEUTSCH



Herzlichen Glückwunsch zum Kauf Ihres neuen WORKDONE Hard Drive Caddy.

Unsere Kurzanleitung enthält grundlegende Installationsanweisungen. Weitere Informationen und Anleitungen finden Sie in unserem Support-Portal.





Laufwerksschacht

Das gleiche Servermodell wird mit **zwei verschiedenen Laufwerksschachtgrößen geliefert**. Prüfen Sie, ob Ihr Servermodell über einen **kleineren 7,7 cm großen Laufwerksschacht für 2,5 Zoll-Festplatten** verfügt.

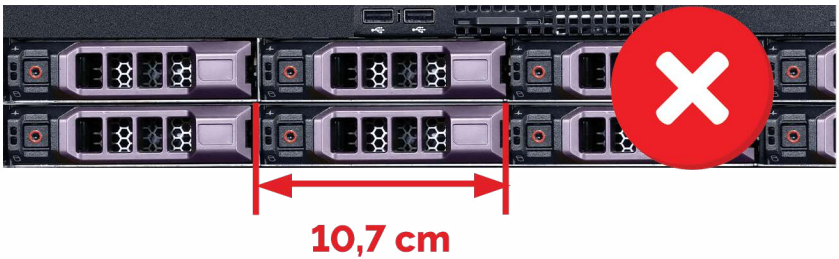



Dell PowerEdge Vordere Laufwerksschachtgrößen



	Server- Generation	Abmessung des Festplat- tenlaufwerks, Breite	Abmessung des Laufwerks- schachts, Breite
2.5"	16. - 14.	7 cm	7,4 cm
	13. - 11.	7 cm	7,7 cm
3.5"	16. - 14.	10,2 cm	10,6 cm
	13. - 11.	10,2 cm	10,6 cm

Einbau einer 2,5"-Festplatte in einen 2,5"-Festplattenträger

1. Setzen Sie die Festplatte mit dem SATA/SAS-Anschlussende nach hinten in den Träger ein.
2. Richten Sie die Schraubenlöcher der Festplatte an den hinteren Löchern des Trägers aus. Vergewissern Sie sich, dass die Rückseite der Festplatte bündig mit dem Träger ist.
3. Befestigen Sie die Festplatte mit den mitgelieferten Schrauben am Träger (4 Stück).

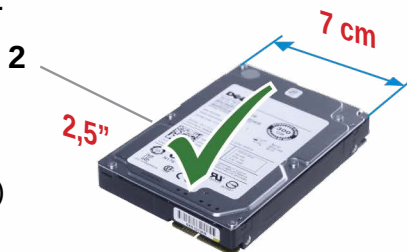

1. Festplattenträger
2. Festplatte
3. Schrauben (4 Stück)

Einbau einer Hot-Swap-Festplatte:

1. Entfernen Sie alle installierten Festplattenrohlinge aus dem Steckplatz.
2. Drücken Sie den Entriegelungsknopf (1) und öffnen Sie den Trägergriff (2).
3. Schieben Sie den Träger in den Steckplatz, bis er mit der Backplane verbunden ist. Schließen Sie den Griff (2), um das Laufwerk zu verriegeln.

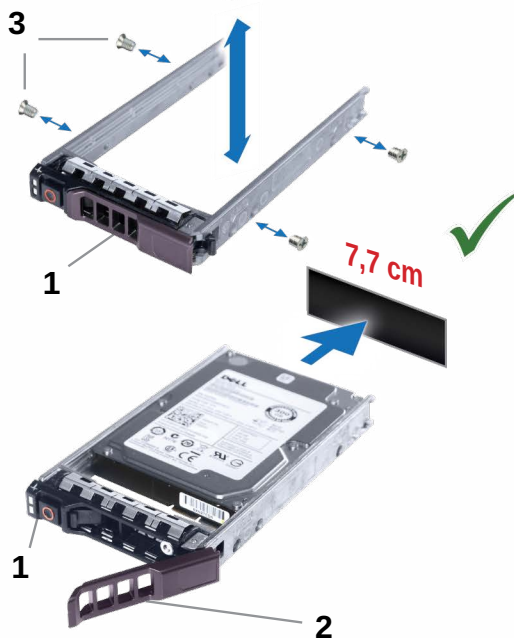



Festplatten-Anzeigecodes

Jeder Festplattenträger verfügt über eine Aktivitäts-LED und eine Status-LED. Diese Anzeigen geben Auskunft über den aktuellen Status der Festplatte.

Muster der Laufwerks-Statusanzeige (nur RAID)

Zustand

Blinkt zweimal pro Sekunde grün	Laufwerk wird identifiziert oder das Entfernen wird vorbereitet.
Aus	Laufwerk zum Einsetzen oder zum Entfernen bereit.
Blinkt grün und gelb , dann schaltet sich aus	Vorhersehbarer Laufwerkfehler.
Blinkt viermal pro Sekunde gelb	Laufwerk ist ausgefallen.
Blinkt langsam grün	Laufwerk Rebuild ist aktiv.
Grünes Dauerlicht	Laufwerk online.
Blinkt drei Sekunden lang grün , dann drei Sekunden lang gelb und schaltet sich nachher aus	der Rebuild wurde gestoppt.

Manuale di installazione rapida

ITALIANO



Congratulazioni per l'acquisto del tuo nuovo Hard Drive Caddy WORKDONE.

La nostra guida rapida fornisce istruzioni di base per l'installazione; per ulteriori informazioni e indicazioni, visitate il nostro portale di assistenza.





Lista di controllo **finale prima dell'installazione:**

Alloggiamento unità disco



PASSO
01

Il Server My
DELL PowerEdge
ha un
**alloggiamento per
unità da 2,5 pollici**



PASSO
02

Ho controllato
la **scheda di
compatibilità dei
modelli DELL
PowerEdge**

DELL PowerEdge Generation	1st	2nd	3rd	4th
Module Models				
R540	P540	M540	M540L	M540S
R640	P640	M640	M640L	M640S
M640	P640	M640	M640L	M640S
M730	P730	M730	M730L	M730S
R730	P730	M730	M730L	M730S
R740	P740	M740	M740L	M740S
R750	P750	M750	M750L	M750S
R760	P760	M760	M760L	M760S
R770	P770	M770	M770L	M770S
R780	P780	M780	M780L	M780S
R790	P790	M790	M790L	M790S
R800	P800	M800	M800L	M800S
R810	P810	M810	M810L	M810S
R820	P820	M820	M820L	M820S
R830	P830	M830	M830L	M830S
R840	P840	M840	M840L	M840S
R850	P850	M850	M850L	M850S
R860	P860	M860	M860L	M860S
R870	P870	M870	M870L	M870S
R880	P880	M880	M880L	M880S
R890	P890	M890	M890L	M890S
R900	P900	M900	M900L	M900S
R910	P910	M910	M910L	M910S
R920	P920	M920	M920L	M920S
R930	P930	M930	M930L	M930S
R940	P940	M940	M940L	M940S
R950	P950	M950	M950L	M950S
R960	P960	M960	M960L	M960S
R970	P970	M970	M970L	M970S
R980	P980	M980	M980L	M980S
R990	P990	M990	M990L	M990S
R1000	P1000	M1000	M1000L	M1000S
R1100	P1100	M1100	M1100L	M1100S
R1200	P1200	M1200	M1200L	M1200S
R1300	P1300	M1300	M1300L	M1300S
R1400	P1400	M1400	M1400L	M1400S
R1500	P1500	M1500	M1500L	M1500S
R1600	P1600	M1600	M1600L	M1600S
R1700	P1700	M1700	M1700L	M1700S
R1800	P1800	M1800	M1800L	M1800S
R1900	P1900	M1900	M1900L	M1900S
R2000	P2000	M2000	M2000L	M2000S
R2100	P2100	M2100	M2100L	M2100S
R2200	P2200	M2200	M2200L	M2200S
R2300	P2300	M2300	M2300L	M2300S
R2400	P2400	M2400	M2400L	M2400S
R2500	P2500	M2500	M2500L	M2500S
R2600	P2600	M2600	M2600L	M2600S
R2700	P2700	M2700	M2700L	M2700S
R2800	P2800	M2800	M2800L	M2800S
R2900	P2900	M2900	M2900L	M2900S
R3000	P3000	M3000	M3000L	M3000S
R3100	P3100	M3100	M3100L	M3100S
R3200	P3200	M3200	M3200L	M3200S
R3300	P3300	M3300	M3300L	M3300S
R3400	P3400	M3400	M3400L	M3400S
R3500	P3500	M3500	M3500L	M3500S
R3600	P3600	M3600	M3600L	M3600S
R3700	P3700	M3700	M3700L	M3700S
R3800	P3800	M3800	M3800L	M3800S
R3900	P3900	M3900	M3900L	M3900S
R4000	P4000	M4000	M4000L	M4000S
R4100	P4100	M4100	M4100L	M4100S
R4200	P4200	M4200	M4200L	M4200S
R4300	P4300	M4300	M4300L	M4300S
R4400	P4400	M4400	M4400L	M4400S
R4500	P4500	M4500	M4500L	M4500S
R4600	P4600	M4600	M4600L	M4600S
R4700	P4700	M4700	M4700L	M4700S
R4800	P4800	M4800	M4800L	M4800S
R4900	P4900	M4900	M4900L	M4900S
R5000	P5000	M5000	M5000L	M5000S
R5100	P5100	M5100	M5100L	M5100S
R5200	P5200	M5200	M5200L	M5200S
R5300	P5300	M5300	M5300L	M5300S
R5400	P5400	M5400	M5400L	M5400S
R5500	P5500	M5500	M5500L	M5500S
R5600	P5600	M5600	M5600L	M5600S
R5700	P5700	M5700	M5700L	M5700S
R5800	P5800	M5800	M5800L	M5800S
R5900	P5900	M5900	M5900L	M5900S
R6000	P6000	M6000	M6000L	M6000S
R6100	P6100	M6100	M6100L	M6100S
R6200	P6200	M6200	M6200L	M6200S
R6300	P6300	M6300	M6300L	M6300S
R6400	P6400	M6400	M6400L	M6400S
R6500	P6500	M6500	M6500L	M6500S
R6600	P6600	M6600	M6600L	M6600S
R6700	P6700	M6700	M6700L	M6700S
R6800	P6800	M6800	M6800L	M6800S
R6900	P6900	M6900	M6900L	M6900S
R7000	P7000	M7000	M7000L	M7000S
R7100	P7100	M7100	M7100L	M7100S
R7200	P7200	M7200	M7200L	M7200S
R7300	P7300	M7300	M7300L	M7300S
R7400	P7400	M7400	M7400L	M7400S
R7500	P7500	M7500	M7500L	M7500S
R7600	P7600	M7600	M7600L	M7600S
R7700	P7700	M7700	M7700L	M7700S
R7800	P7800	M7800	M7800L	M7800S
R7900	P7900	M7900	M7900L	M7900S
R8000	P8000	M8000	M8000L	M8000S
R8100	P8100	M8100	M8100L	M8100S
R8200	P8200	M8200	M8200L	M8200S
R8300	P8300	M8300	M8300L	M8300S
R8400	P8400	M8400	M8400L	M8400S
R8500	P8500	M8500	M8500L	M8500S
R8600	P8600	M8600	M8600L	M8600S
R8700	P8700	M8700	M8700L	M8700S
R8800	P8800	M8800	M8800L	M8800S
R8900	P8900	M8900	M8900L	M8900S
R9000	P9000	M9000	M9000L	M9000S
R9100	P9100	M9100	M9100L	M9100S
R9200	P9200	M9200	M9200L	M9200S
R9300	P9300	M9300	M9300L	M9300S
R9400	P9400	M9400	M9400L	M9400S
R9500	P9500	M9500	M9500L	M9500S
R9600	P9600	M9600	M9600L	M9600S
R9700	P9700	M9700	M9700L	M9700S
R9800	P9800	M9800	M9800L	M9800S
R9900	P9900	M9900	M9900L	M9900S
R10000	P10000	M10000	M10000L	M10000S
R10100	P10100	M10100	M10100L	M10100S
R10200	P10200	M10200	M10200L	M10200S
R10300	P10300	M10300	M10300L	M10300S
R10400	P10400	M10400	M10400L	M10400S
R10500	P10500	M10500	M10500L	M10500S
R10600	P10600	M10600	M10600L	M10600S
R10700	P10700	M10700	M10700L	M10700S
R10800	P10800	M10800	M10800L	M10800S
R10900	P10900	M10900	M10900L	M10900S
R11000	P11000	M11000	M11000L	M11000S
R11100	P11100	M11100	M11100L	M11100S
R11200	P11200	M11200	M11200L	M11200S
R11300	P11300	M11300	M11300L	M11300S
R11400	P11400	M11400	M11400L	M11400S
R11500	P11500	M11500	M11500L	M11500S
R11600	P11600	M11600	M11600L	M11600S
R11700	P11700	M11700	M11700L	M11700S
R11800	P11800	M11800	M11800L	M11800S
R11900	P11900	M11900	M11900L	M11900S
R12000	P12000	M12000	M12000L	M12000S
R12100	P12100	M12100	M12100L	M12100S
R12200	P12200	M12200	M12200L	M12200S
R12300	P12300	M12300	M12300L	M12300S
R12400	P12400	M12400	M12400L	M12400S
R12500	P12500	M12500	M12500L	M12500S
R12600	P12600	M12600	M12600L	M12600S
R12700	P12700	M12700	M12700L	M12700S
R12800	P12800	M12800	M12800L	M12800S
R12900	P12900	M12900	M12900L	M12900S
R13000	P13000	M13000	M13000L	M13000S
R13100	P13100	M13100	M13100L	M13100S
R13200	P13200	M13200	M13200L	M13200S
R13300	P13300	M13300	M13300L	M13300S
R13400	P13400	M13400	M13400L	M13400S
R13500	P13500	M13500	M13500L	M13500S
R13600	P13600	M13600	M13600L	M13600S
R13700	P13700	M13700	M13700L	M13700S
R13800	P13800	M13800	M13800L	M13800S
R13900	P13900	M13900	M13900L	M13900S
R14000	P14000	M14000	M14000L	M14000S
R14100	P14100	M14100	M14100L	M14100S
R14200	P14200	M14200	M14200L	M14200S
R14300	P14300	M14300	M14300L	M14300S
R14400	P14400	M14400	M14400L	M14400S
R14500	P14500	M14500	M14500L	M14500S
R14600	P14600	M14600	M14600L	M14600S
R14700	P14700	M14700	M14700L	M14700S
R14800	P14800	M14800	M14800L	M14800S
R14900	P14900	M14900	M14900L	M14900S
R15000	P15000	M15000	M15000L	M15000S
R15100	P15100	M15100	M15100L	M15100S
R15200	P15200	M15200	M15200L	M15200S
R15300	P15300	M15300	M15300L	M15300S
R15400	P15400	M15400	M15400L	M15400S
R15500	P15500	M15500	M15500L	M15500S
R15600	P15600	M15600	M15600L	M15600S
R15700	P15700	M15700	M15700L	M15700S
R15800	P15800	M15800	M15800L	M15800S
R15900	P15900	M15900	M15900L	M15900S
R16000	P16000	M16000	M16000L	M16000S
R16100	P16100	M16100	M16100L	M16100S
R16200	P16200	M16200	M16200L	M16200S
R16300	P16300	M16300	M16300L	M16300S
R16400	P16400	M16400	M16400L	M16400S
R16500	P16500	M16500	M16500L	M16500S
R16600	P16600	M16600	M16600L	M16600S
R16700	P16700	M16700	M16700L	M16700S
R16800	P16800	M16800	M16800L	M16800S
R16900	P16900	M16900	M16900L	M16900S
R17000	P17000	M17000	M17000L	M17000S
R17100	P17100	M17100	M17100L	M17100S
R17200	P17200	M17200	M17200L	M17200S
R17300	P17300	M17300	M17300L	M17300S
R17400	P17400	M17400	M17400L	M17



Alloggiamento unità disco

Lo stesso modello di server viene fornito con **due dimensioni diverse di alloggiamento** dell'unità. Controlla se il tuo modello di server abbia un **alloggiamento più piccolo** da 7,7 cm per hard drive da 2,5 pollici.

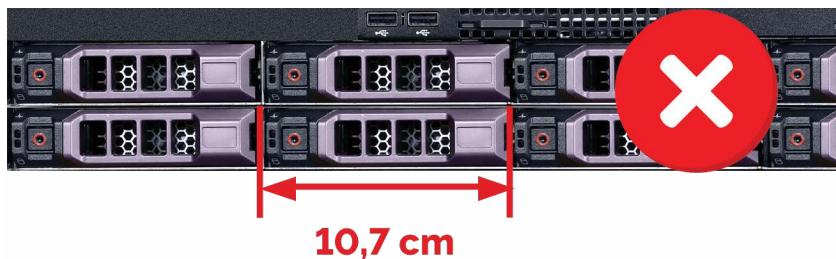



Dimensioni alloggiamento anteriore unità Dell PowerEdge



	Generazione Server	Misura Hard Drive, ampia	Misura Alloggiamento Unità, ampia
2.5"	16 [^] -14 [^]	7 cm	7,4 cm
	13 [^] -11 [^]	7 cm	7,7 cm
3.5"	16 [^] -14 [^]	10,2 cm	10,6 cm
	13 [^] -11 [^]	10,2 cm	10,7 cm



Installazione Hard Drive da 2,5” in un Supporto per Hard Drive da 2,5”.

1. Inserire il disco rigido nel supporto con l'estremità del connettore SATA/SAS rivolta verso il retro.
2. Allineare i fori per le viti del disco rigido con la serie di fori posteriori del supporto. Assicurarsi che la parte posteriore del disco rigido sia in linea con il supporto.
3. Fissare il disco rigido al supporto utilizzando le viti in dotazione. (4pz)

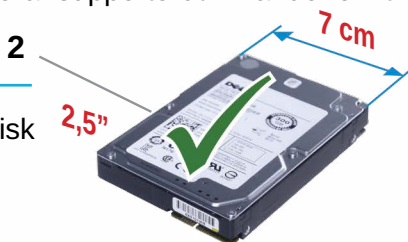

1. Supporto dell'hard disk
2. Hard disk
3. Viti (4 pezzi)

Installare un Hard Drive HotSwap:

1. Rimuovere il disco rigido vuoto installato dallo slot.
2. Premere il pulsante di rilascio (1) e aprire la maniglia del supporto (2).
3. Far scorrere il supporto nello slot finché non si collega al backplane. Chiudere la maniglia (2) per bloccare il disco rigido in posizione.





Codici dell'indicatore del disco rigido

Ogni supporto del disco rigido ha un indicatore LED di attività e un indicatore LED di stato. Gli indicatori forniscono informazioni sullo stato attuale del disco rigido.

Pattern di indicatore status del Disco (solo RAID)	Condizione
Luce lampeggiante verde due volte al secondo	Identificazione dell'unità o preparazione per la rimozione.
Off	Disco pronto per l'inserimento o la rimozione.
Luce lampeggiante verde , ambra e poi si spegne	Previsto guasto del disco.
Luce lampeggiante ambra quattro volte al secondo	Disco guasto.
Luce lampeggiante lenta verde	Ricostruzione del disco.
Verde fisso	Disco online.
Luce lampeggiante verde per tre secondi, ambra per tre secondi, poi si spegne dopo sei secondi	Ricostruzione interrotta.

Manuel d'installation rapide

FRANÇAIS



Nous vous félicitons pour l'achat de votre nouveau boîtier pour disque dur WORKDONE.

Notre guide rapide fournit des instructions d'installation de base, et pour plus d'informations et de conseils, Rendez-vous sur notre portail d'assistance.



Liste de contrôle finale avant l'installation :

Baie de disque



Mon serveur DELL PowerEdge est équipé est équipé d'une **baie de disque 2,5 pouce(s)**.



J'ai vérifié la **fiche de compatibilité pour le modèle** DELL PowerEdge.

DELL PowerEdge	Modèle	Modèle	Modèle	Modèle
Module Matras	R540	R540	R640	R740
	R640	R640	R640	R740
	R740	R740	R740	R740
	R740	R740	R740	R740
	R740	R740	R740	R740
	R740	R740	R740	R740
	R740	R740	R740	R740
	R740	R740	R740	R740
	R740	R740	R740	R740
	R740	R740	R740	R740
Module Modulo	R540	R540	R640	R740
	R640	R640	R640	R740
	R740	R740	R740	R740
	R740	R740	R740	R740
	R740	R740	R740	R740
	R740	R740	R740	R740
	R740	R740	R740	R740
	R740	R740	R740	R740
	R740	R740	R740	R740
	R740	R740	R740	R740



Mon serveur DELL PowerEdge est équipé d'une **carte-mère enfichable à chaud**.



Je souhaite ajouter un **petit disque dur de 2,5 pouces** sur mon serveur DELL PowerEdge.





Baie de disque

Le même modèle de serveur est livré avec **deux tailles de baie différentes**. Vérifiez si votre modèle de serveur a **une taille de baie plus petite de 7,7 cm** pour les disques durs de 2,5 pouces.

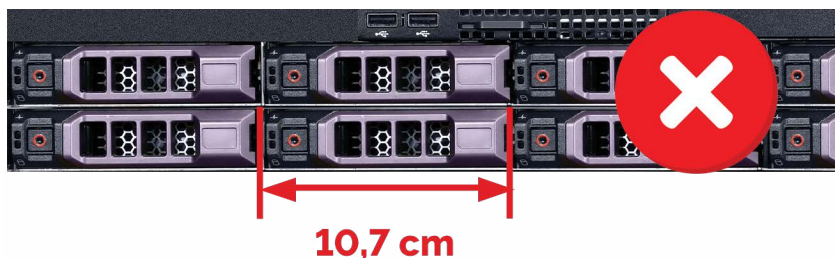

Tailles des baies de disques avant de Dell PowerEdge



Génération du serveur

Dimension du disque dur, en largeur

Dimension de la baie de disque, en largeur

2.5"	16 ème - 14 ème	7 cm	7,4 cm
	13 ème - 11 ème	7 cm	7,7 cm
3.5"	16 ème - 14 ème	10,2 cm	10,6 cm
	13 ème - 11 ème	10,2 cm	10,7 cm

Installation d'un disque dur de 2,5 pouces dans un support de disque dur de 2,5 pouces

1. Insérez le disque dur dans le support en orientant l'extrémité du connecteur SATA/SAS vers l'arrière.
2. Alignez les trous de vis du disque dur avec les trous arrière du support. Veillez à ce que l'arrière du disque dur soit au même niveau que le support.
3. Fixez le disque dur au support à l'aide des vis fournies (4 unités).

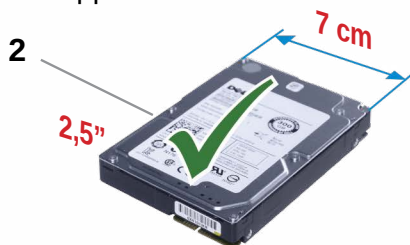

1. Boîtier de disque dur
2. Unité de disque dur
3. Vis (4 u.)

Installation d'un disque dur enfichable à chaud :

1. Retirez de l'emplacement tout disque dur vierge qui y est installé.
2. Appuyez sur le bouton de déverrouillage (1) et ouvrez la poignée du support (2).
3. Faites glisser le support dans le logement jusqu'à ce qu'il soit connecté à la carte-mère. Fermez la poignée (2) pour verrouiller le disque dur en place.

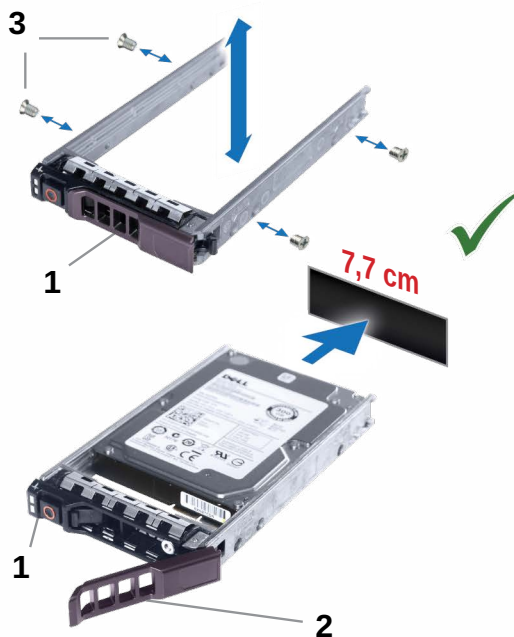



Codes de l'Indicateur du Disque Dur

Chaque boîtier d'unité de disque dur est équipé d'un indicateur LED d'activité et d'un indicateur LED d'état. Les indicateurs fournissent de l'informations sur l'état présent de l'unité.

Témoin de statut du disque dur (RAID uniquement)	État
Clignote en vert deux fois par seconde	En train de reconnaître l'unité ou de préparer l'unité pour son relèvement.
Éteint	Unité prête à être introduite ou relevée.
Clignote en vert , en jaune et puis s'éteint	Défaillance prévue du lecteur.
Clignote en jaune quatre fois par seconde	Lecteur échoué.
Clignote en vert lentement	Reconstruction du lecteur.
Vert fixe	Lecteur en linge.
Clignote en vert trois secondes, en jaune pour trois secondes et finalement s'éteint après six secondes	Reconstruction arrêtée.

A woman with long, wavy blonde hair is looking back over her shoulder towards the camera. She is wearing a light-colored, possibly white, collared shirt. The background is a server room with rows of server racks on both sides, illuminated with blue and purple lights, creating a perspective effect as the racks recede into the distance.

WE CARE – WE SUPPORT
WORKDONE

your global support portal:

www.workdone.support

Drive Caddy Configurator · Plenty of Downloads · Product PDF Manuals
Compatibility Sheets · Drive Bay Size Tables · Dell Server Naming
Dell Caddy Part Numbers · Free eBook Download
Support Articles · Installation Diagrams

