

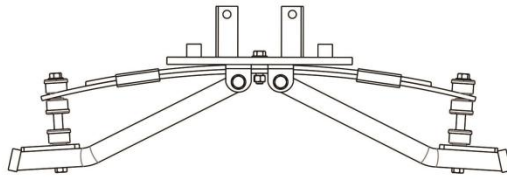

After installation, the front wheels must be properly aligned. Failure to properly align the front wheels may result in decreased ability to control the Golf Cart which may result in a rollover or crash.

HD A-ARM SUSPENSION W/T SHOCKS

YAMAHA DRIVE/G29



MAIN SUSPENSION FRAME



SGC PLATE

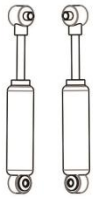

FRONT SHOCK

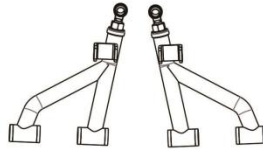

A-ARM

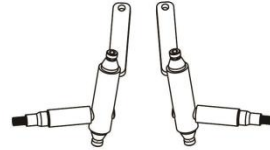

SPINDLE

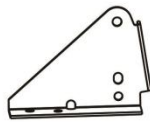

SWAY BAR BRACKET



REAR SHOCK RISER



FRONT BRACKET

| Bag# | Application | Spec. | | Qty. |
|------|-----------------------|-------------|-----------|------|
| 1 | Upper A-arm | Hex bolt | M10x80 | 4 |
| | | Lock nut | M10 | 4 |
| | | Flat washer | 10 | 8 |
| 2 | Main frame | Hex bolt | M10x65 | 2 |
| | | Lock nut | M10 | 2 |
| | | Flat washer | 10 | 4 |
| | | U bolt | M12*110 | 2 |
| | | Lock nut | M12 | 4 |
| | | Flat washer | 12 | 4 |
| 3 | Front shock lower end | Hex bolt | M10x55 | 2 |
| | | Lock nut | M10 | 2 |
| | | Flat washer | 10 | 4 |
| 4 | Front shock upper end | Hex bolt | M10x80 | 2 |
| | | Lock nut | M10 | 2 |
| | | Flat washer | 10 | 4 |
| 5 | Front bracket | Hex bolt | M10x85 | 2 |
| | | Lock nut | M10 | 2 |
| | | Flat washer | 10 | 4 |
| 6 | Heim joint | Heim joint | 1/2-20 55 | 2 |
| | | Flat washer | 1/2 | 4 |
| | | Hex nut | 1/2-20 | 4 |
| 7 | Rear shock riser | Hex bolt | M10x60 | 4 |
| | | Lock nut | M10 | 4 |
| | | Flat washer | 10 | 8 |
| 8 | Spindle nut | Lock nut | M14 | 2 |
| 9 | Sway bar bracket | Hex bolt | M12x25 | 1 |
| | | Lock nut | M12 | 1 |
| | | Flat washer | 12 | 2 |
| | | Hex bolt | M10x80 | 1 |
| | | Lock nut | M10 | 1 |
| | | Flat washer | 10 | 2 |
| | | Drill bit | φ11 | 1 |

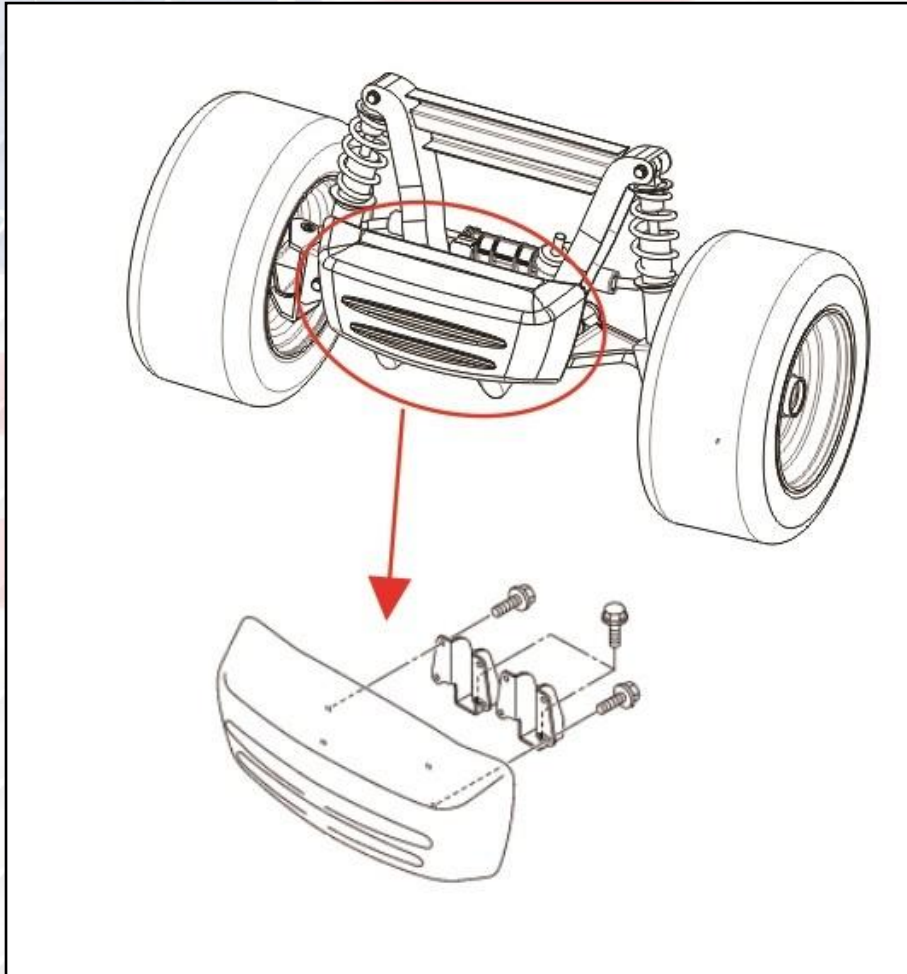

1. Remove factory front bumper.

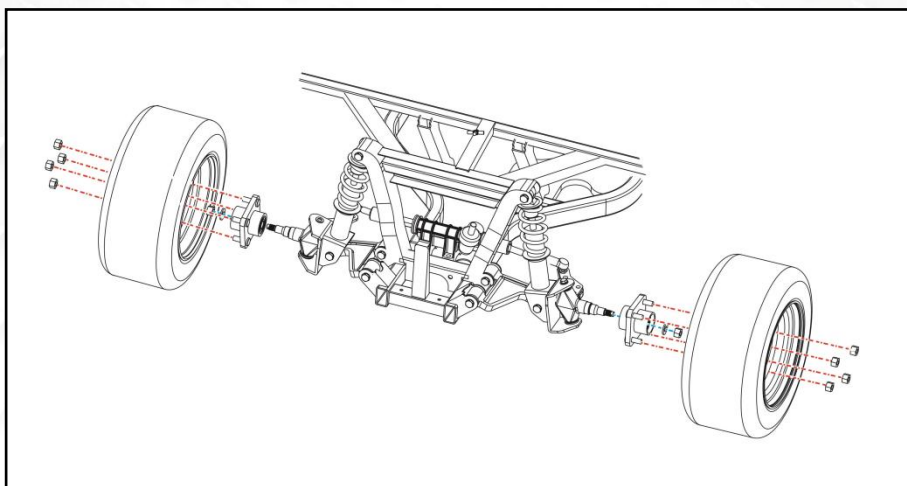

2. Remove front hubs and wheels.

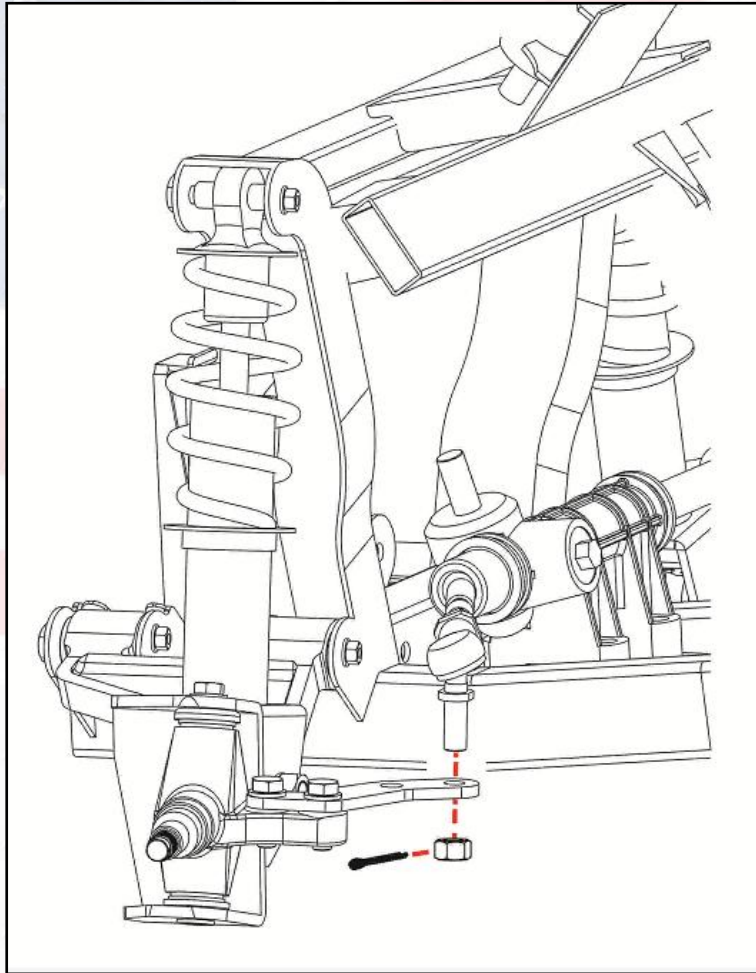

3. Deattach rack and pinion tie rod from spindles.

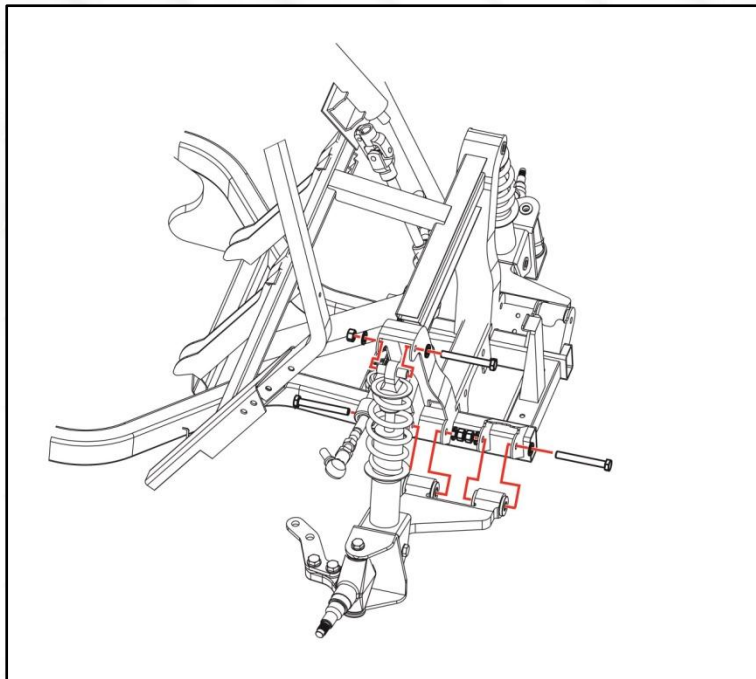

4. Remove factory lower a-arm and front shock assembly.

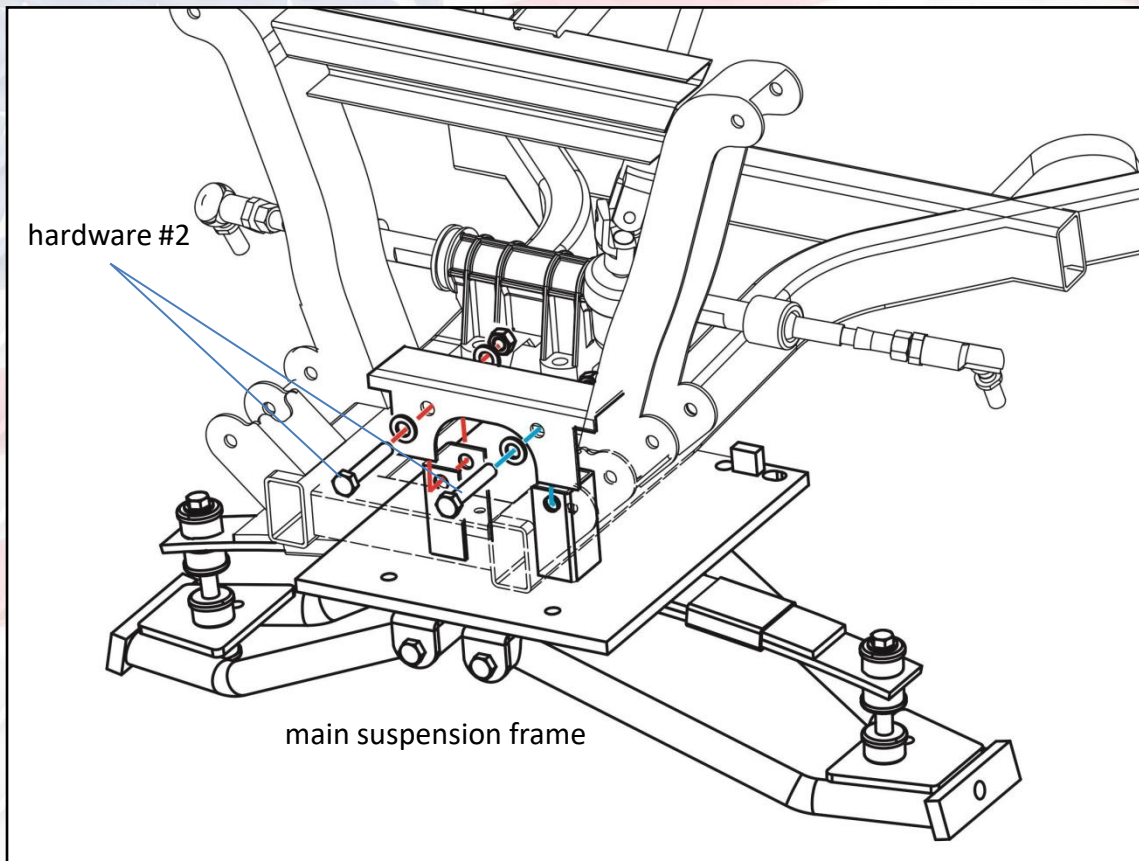

5. Attach main suspension frame to cart using hex bolts from hardware #2. You may need a hand up or a bench to support the main suspension frame for this step.

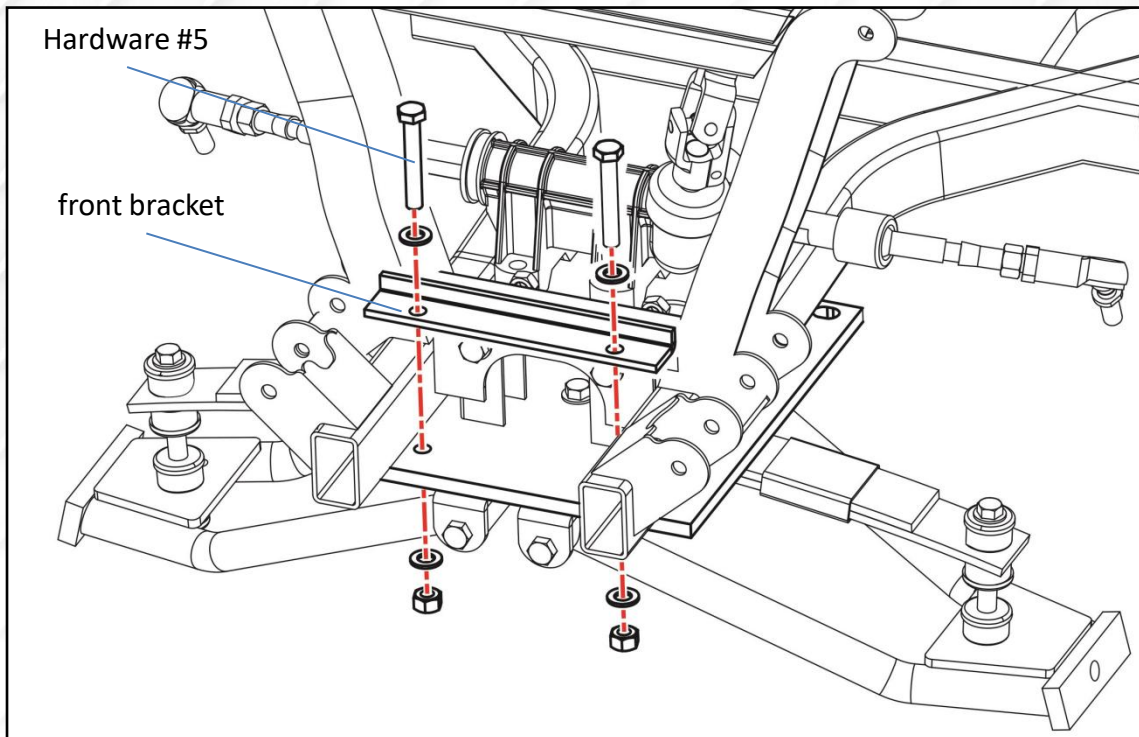

6. Attach front bracket to cart to hang front portion of main suspension frame from upside using hardware #5.

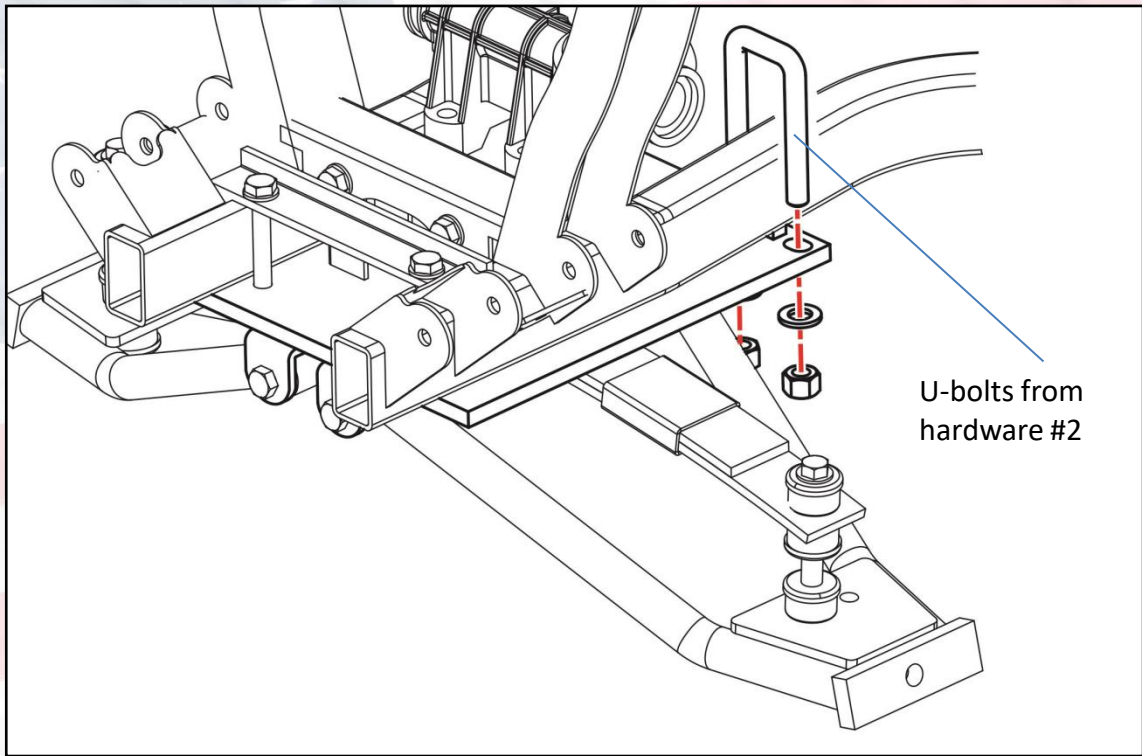

7. Attach rear portion of main suspension frame to cart frame using U-bolts from hardware #2.

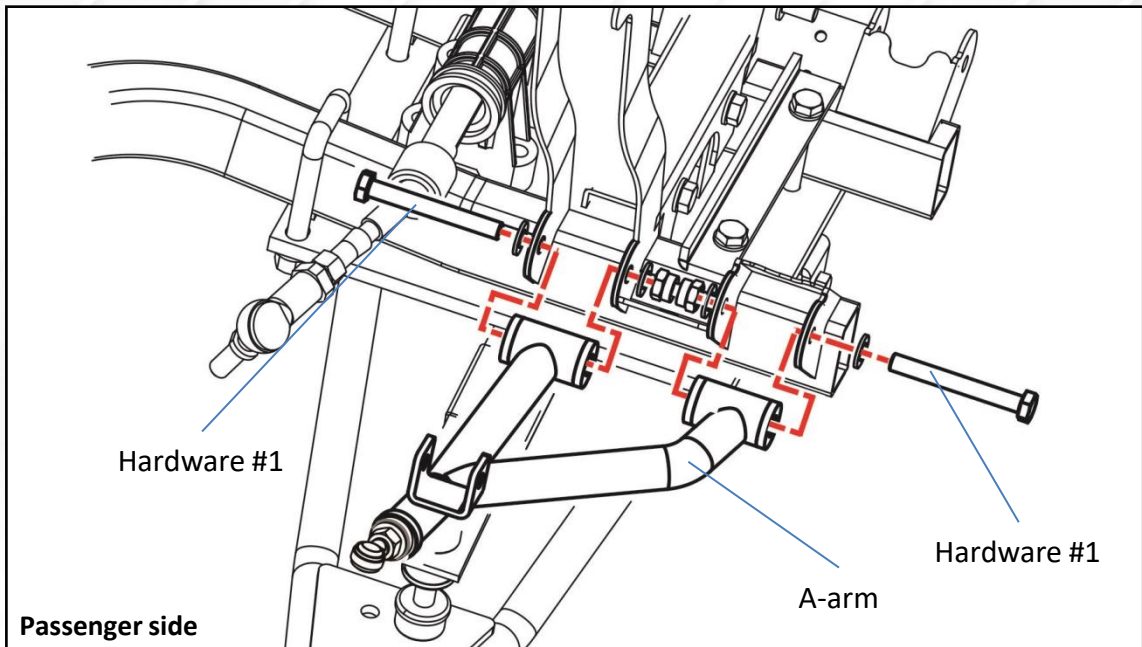

8. Attach supplied a-arm to main suspension frame using hardware #1. Compare the a-arm with the one in picture to mount in correct side. Repeat on driver side.

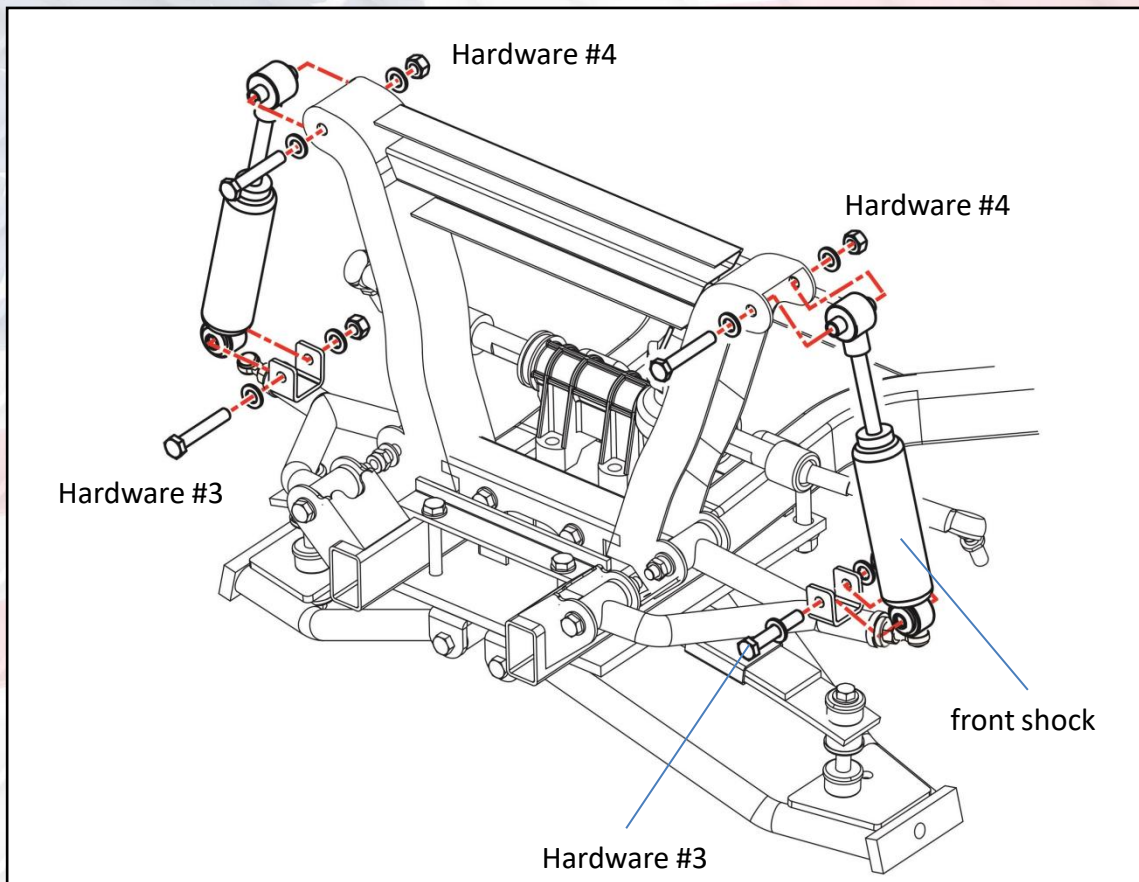

9. Attach supplied front shocks to a-arm and to cart frame using hardware #3 (lower part) and hardware #4 (upper part).

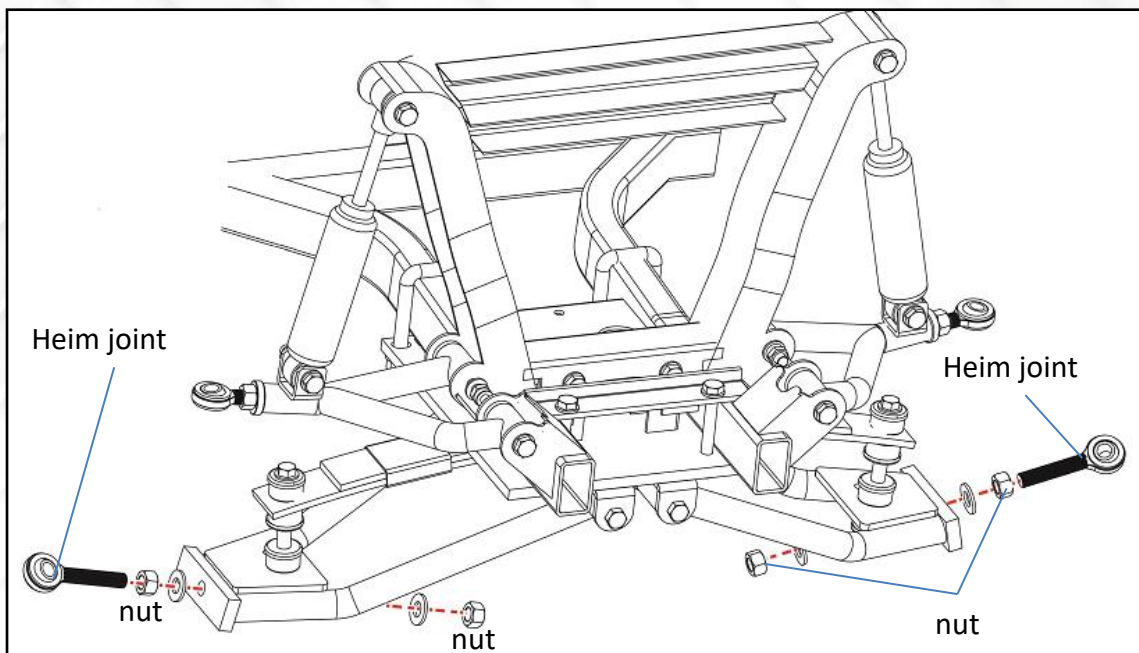

10. Attach heim joints to lower a-arms from main suspension frame using hardware #6. There is one nut on each side of the a-arm for adjustment.

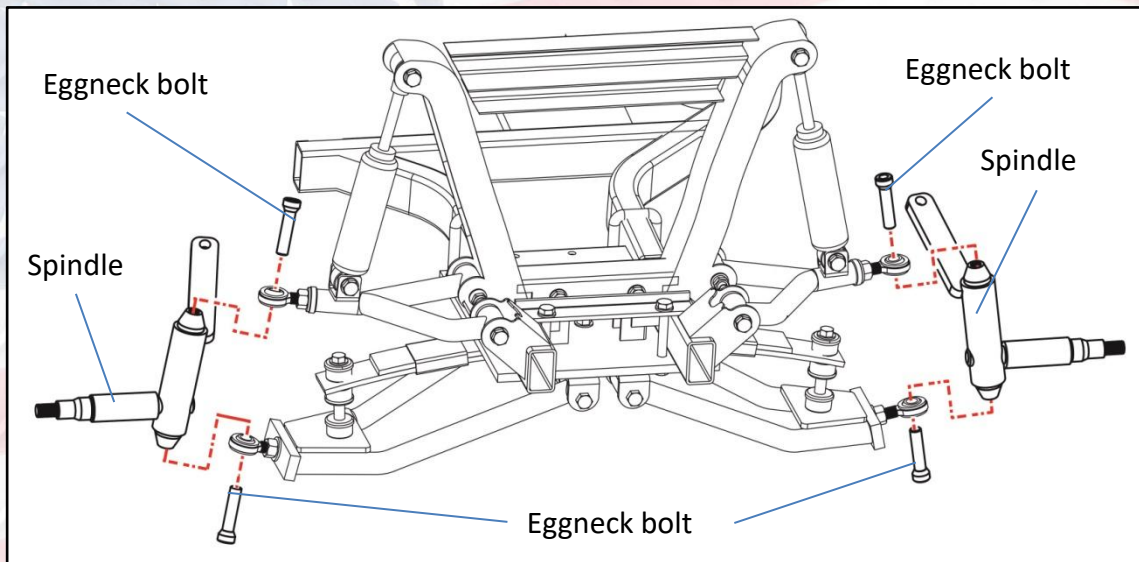

11. Attach spindles to heim joints using eggneck bolts pre-mounted on spindles.

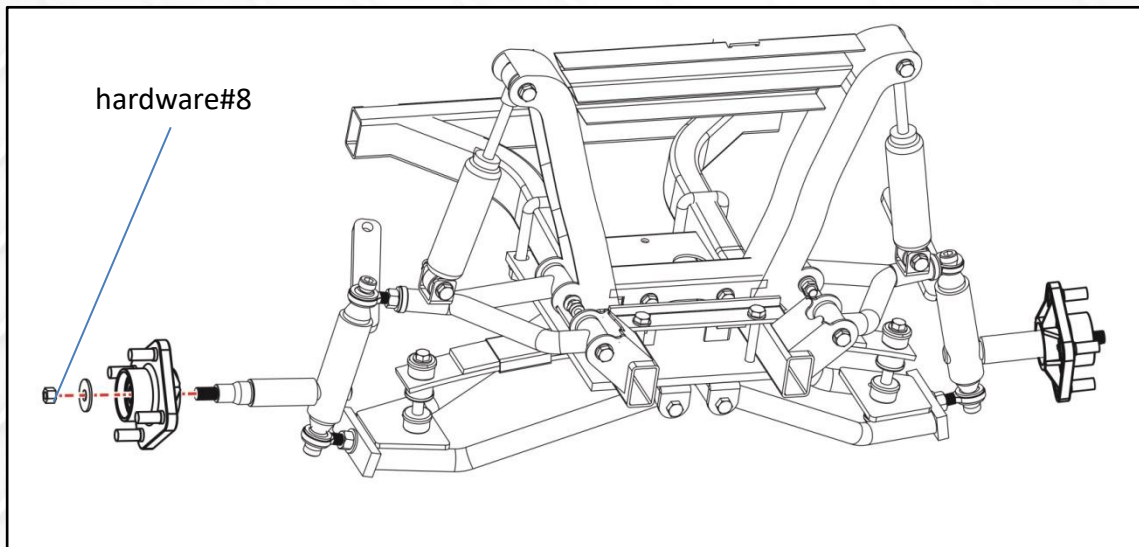

12. Attach front hubs to spindles using nuts from hardware#8.

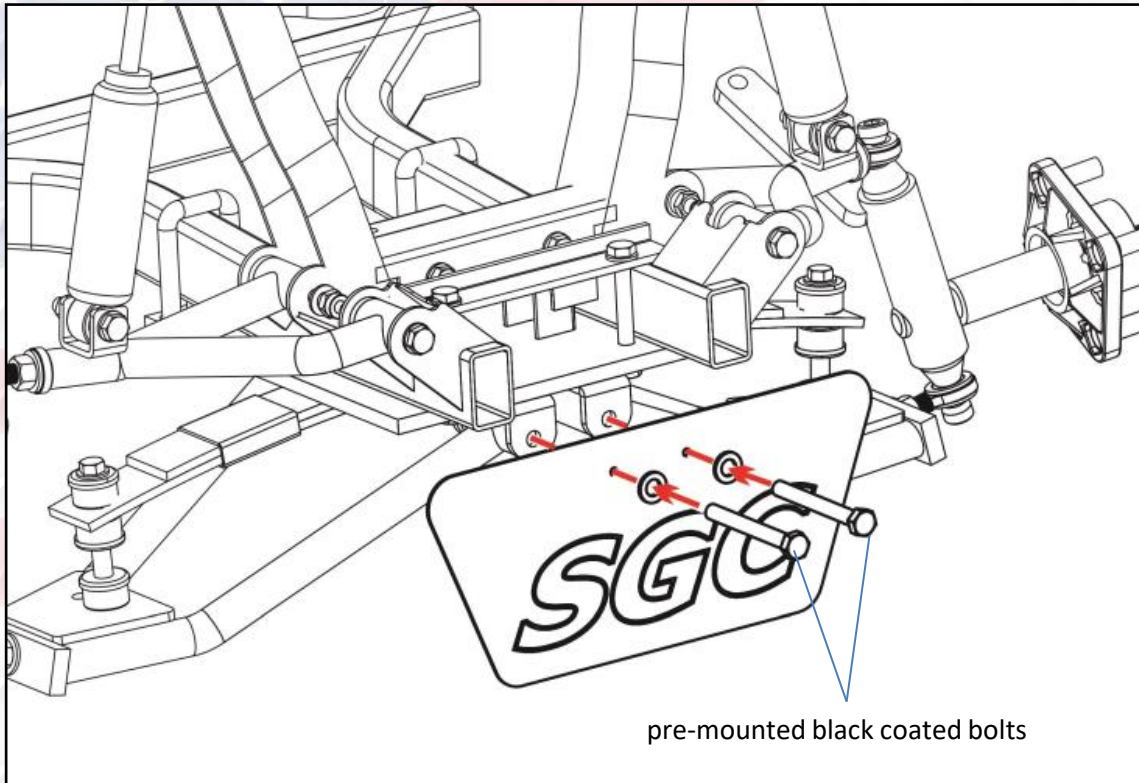

13. Take out pre-mounted black coated bolts to attach SGC plate to main suspension frame.

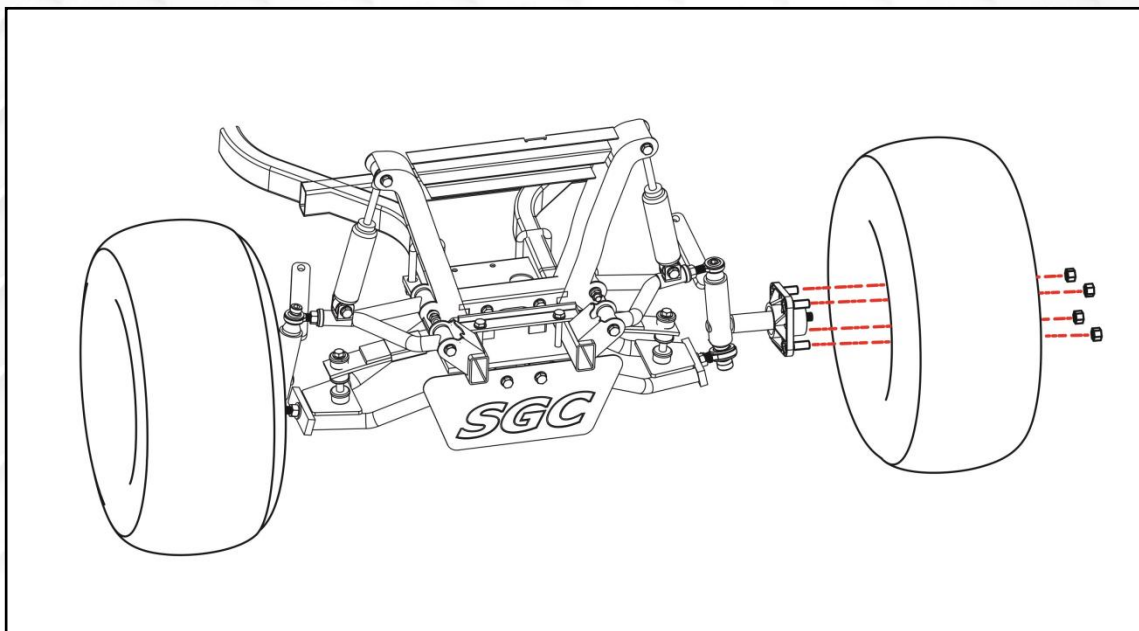

14. Reattach front wheels.

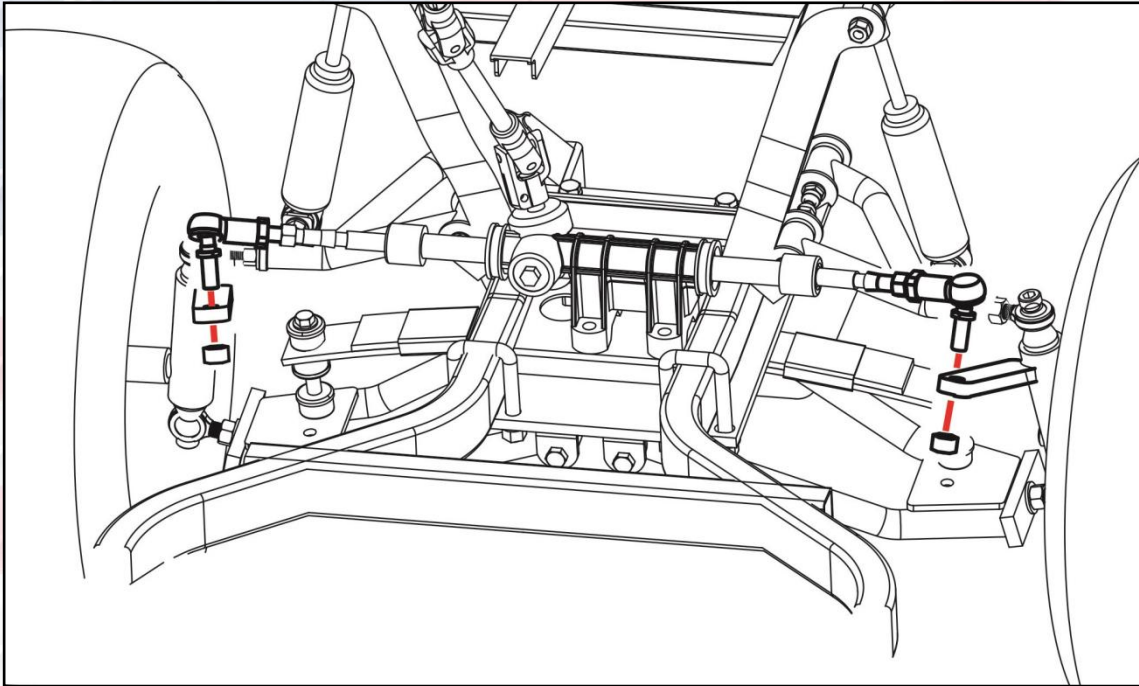

15. Align the wheels so they are standing straight and facing forwards. Turn the tie rod end to reach the hole to reattach to spindles.

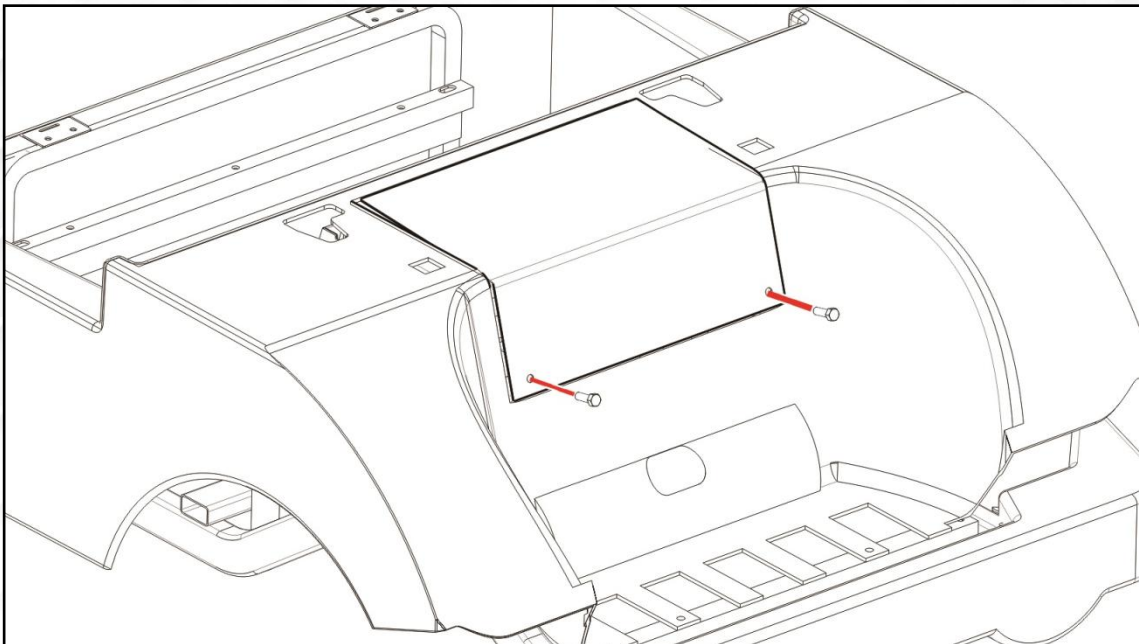

16. Remove access engine cover for rear lift installation.

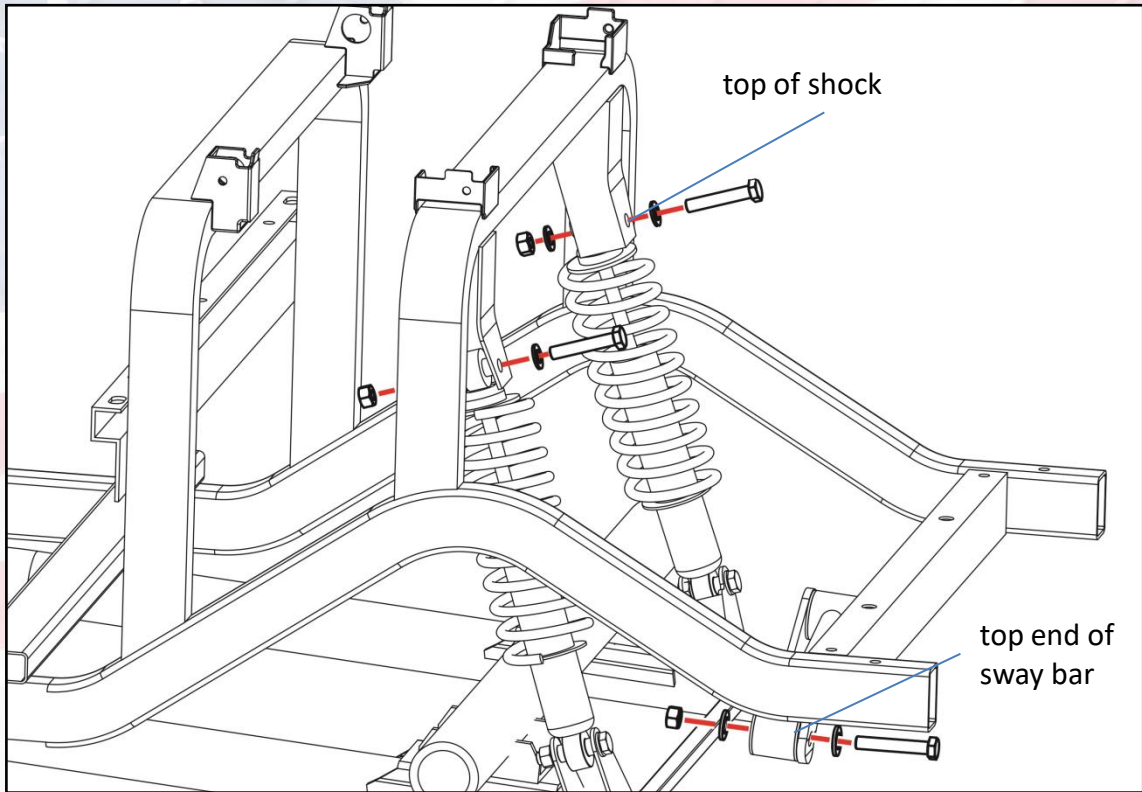

17. Loose the bolts that attach top of shocks to cart. Remove top end of sway bar from cart and keep hardware.

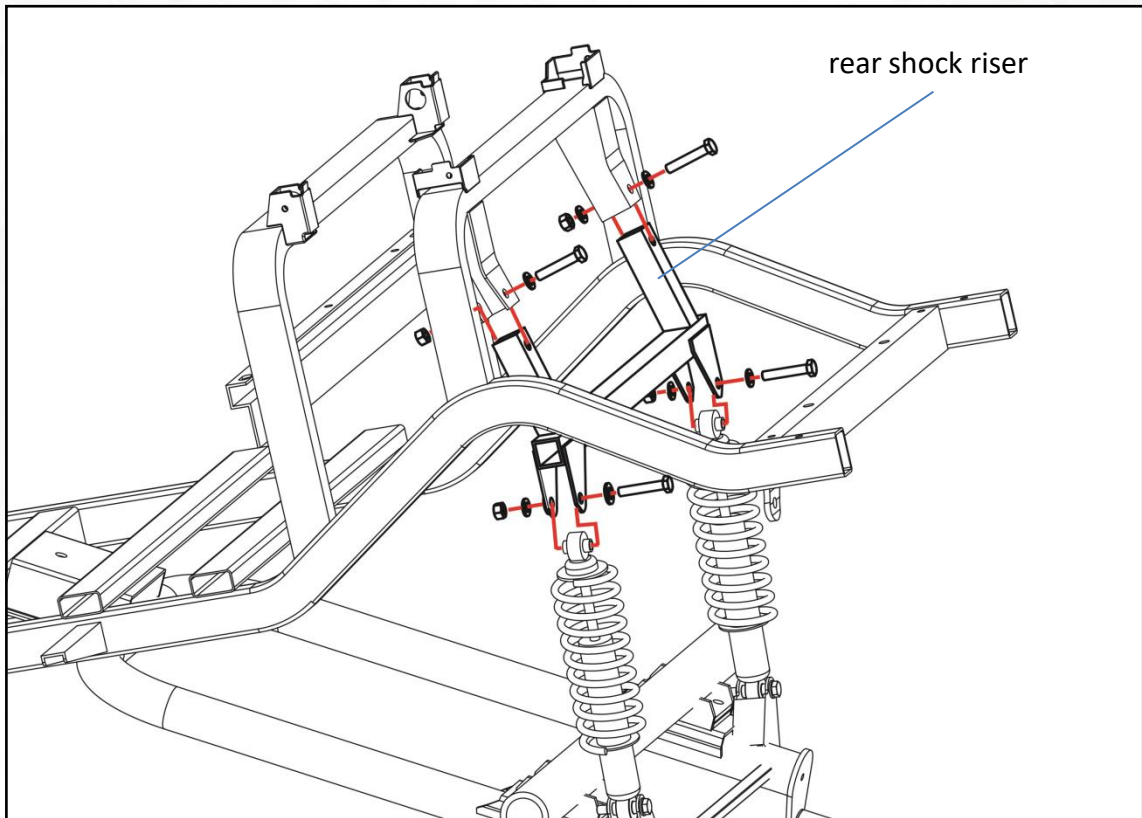

18. Attach rear shock riser between factory shocks and cart frame using hardware #7.

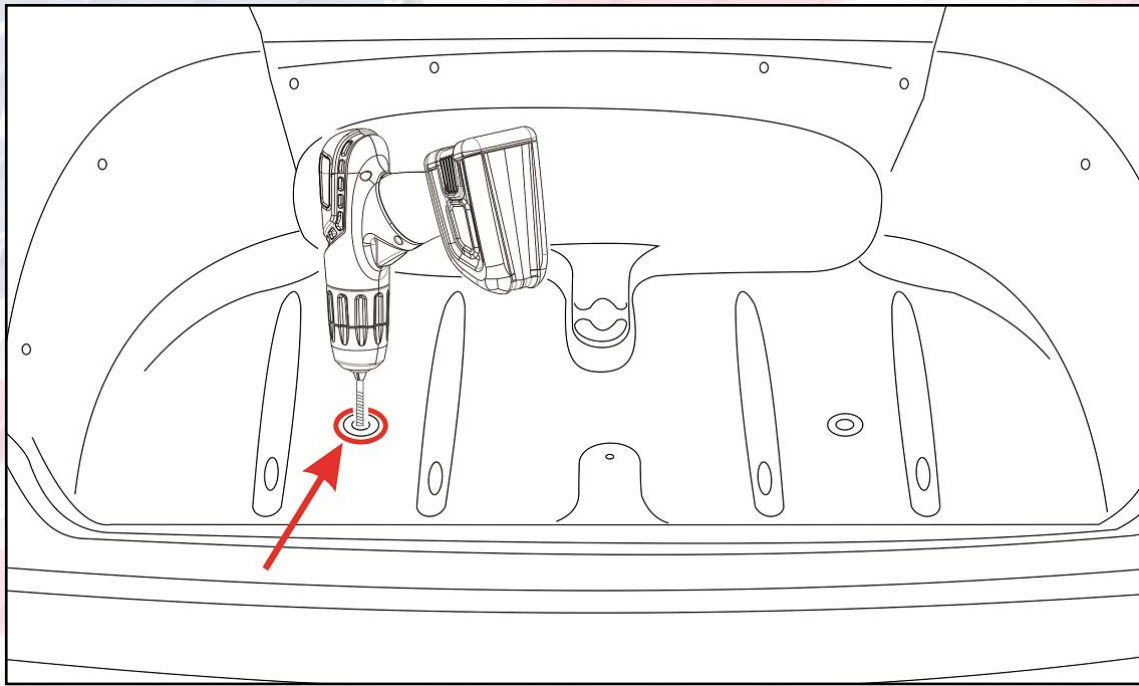

19. Depending on manufacturing year, a rivet or bolt should be removed first. Be sure to drill straight down through entire frame. Drill bit can be found in the hardware box.

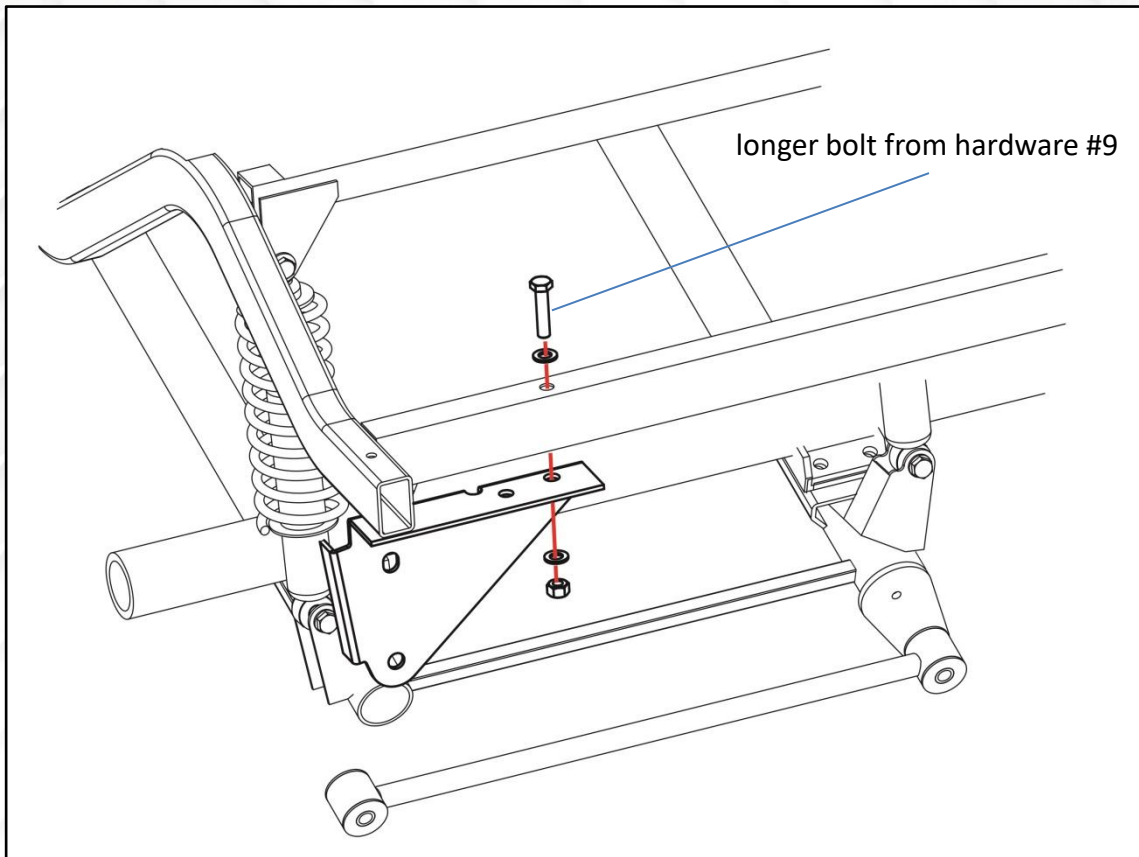

20. Attach sway bar bracket to cart frame using longer bolt from hardware #9.

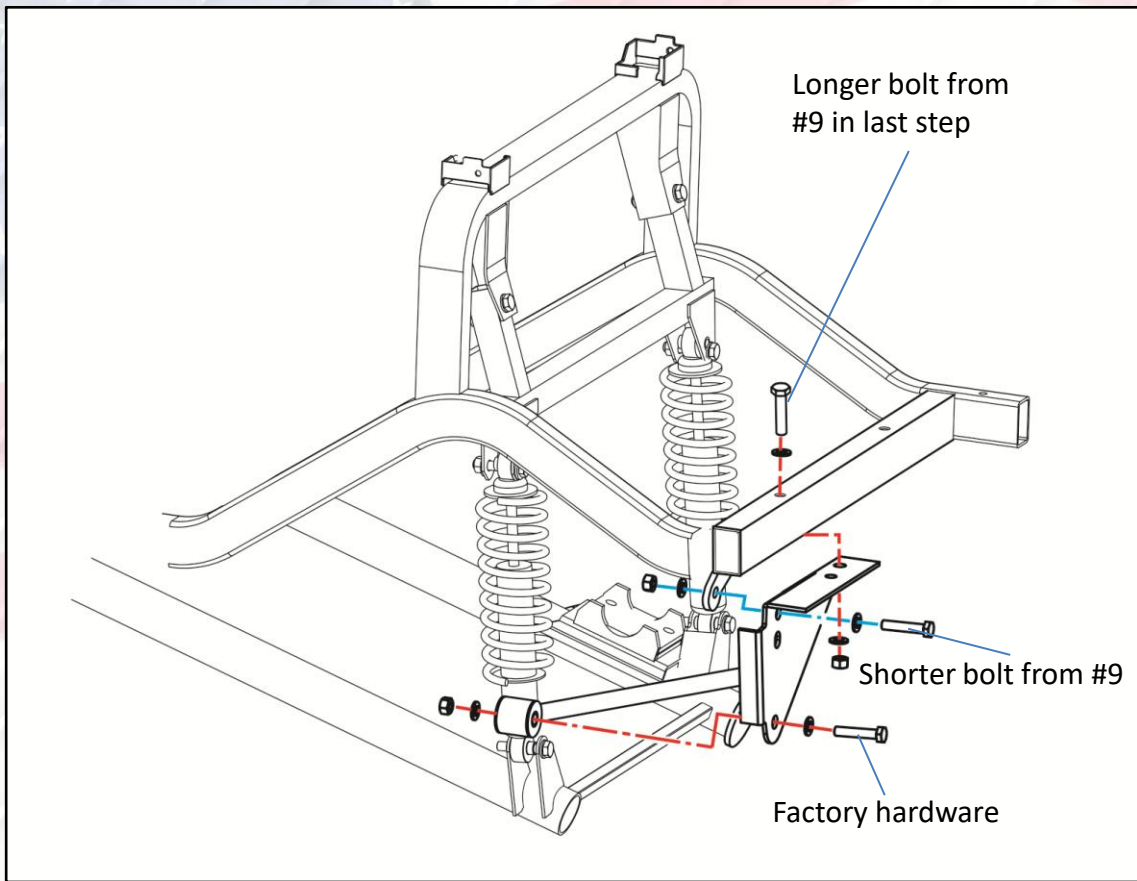

21. Attach sway bar bracket as indicated using shorter bolt from hardware #9. Reinstall hubs and wheels.

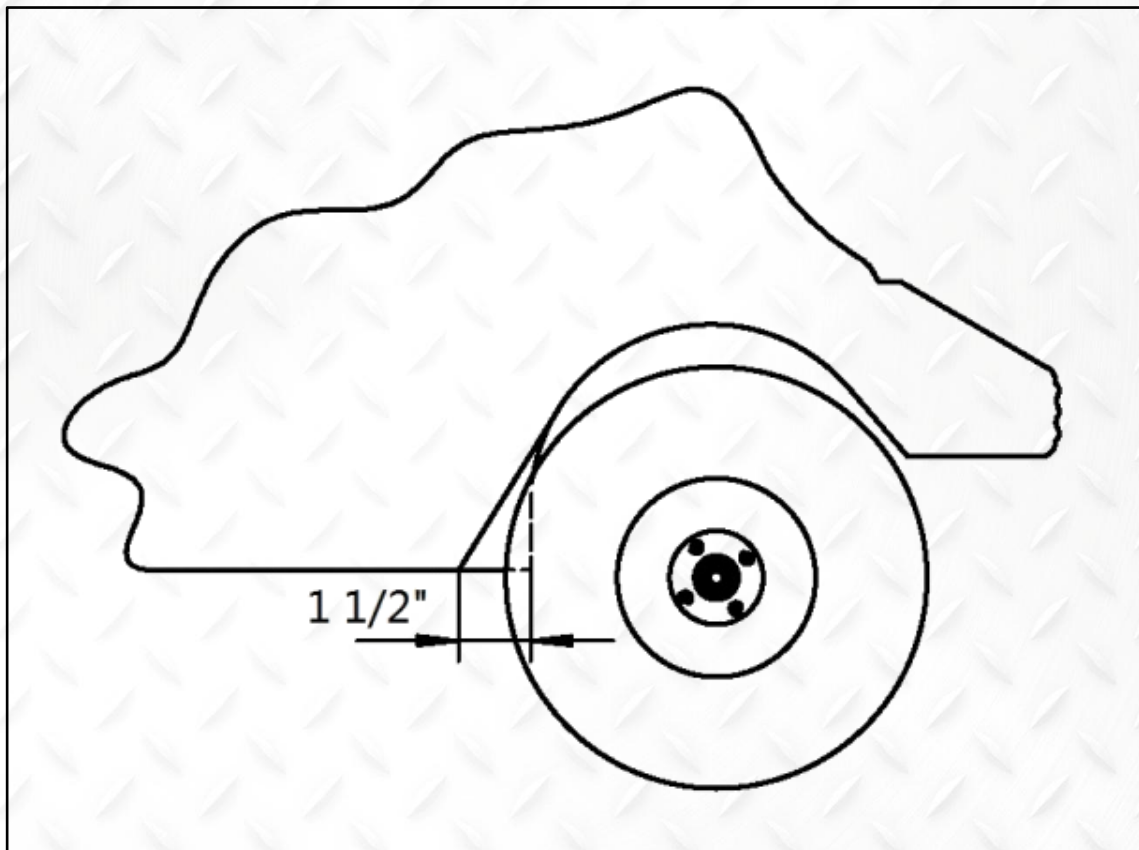

Rear Inner fenders & rockers will need heated, reformed or cut for tire clearance

