

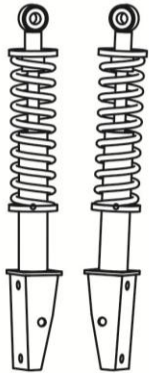

**SGC HD A-ARM
SUSPENSION WITH
SHOCKS
FITS EZGO TXT 94-01.5, ELEC**



FRONT SHOCK



BUMPER BRACKET C

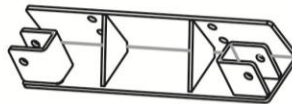

SHOCK UPPER MOUNT



BUSHINGS

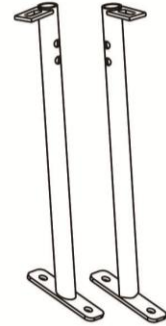

PILLARS

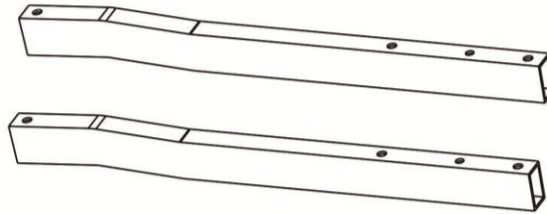

BEAMS



SPINDLES

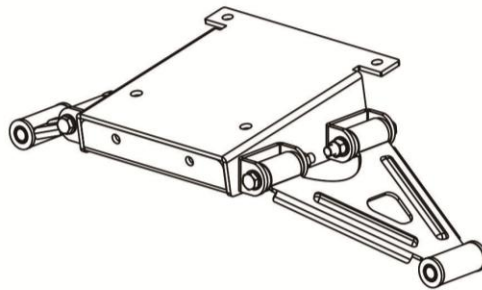

MAIN SUSPENSION ASSEMBLY



KICKOFF LINK



BUMPER BRACKET A



SGC PLATE

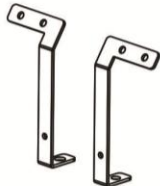

BUMPER BRACKET B

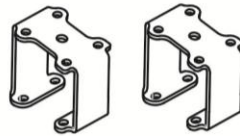

REAR RISERS



REAR SHOCK PLATE

| Bag# | Application | Hardware | Spec. | Qty. |
|------|-----------------------------------------|----------------|-----------------|------|
| 1 | FRONT SHOCKS UPPER MOUNT | Hex Bolt | 3/8-16 *2-1/2 | 2 |
| | | Lock Nut | 3/8-16 | 2 |
| | | Flat Washer | 3/8 | 4 |
| 2 | PILLARS TO CART | Hex Bolt | 3/8-16 *1-1/2 | 2 |
| | | Lock Nut | 3/8-16 | 2 |
| | | Flat Washer | 3/8 | 4 |
| | | Bushings | RUBBER BUSHING | 2 |
| 3 | PILLAR TO SHOCK UPPER MOUNT | Hex Bolt | 3/8-16 *2 | 4 |
| | | Lock Nut | 3/8-16 | 4 |
| | | Flat Washer | 3/8 | 8 |
| 4 | FRONT SHOCK LOWER MOUNT | Hex Bolt | 1/2-13 *4 | 2 |
| | | Lock Nut | 1/2-13 | 2 |
| | | Flat Washer | 1/2 | 4 |
| 5 | PILLARS TO BEAMS | Hex Bolt | M12*25 | 2 |
| | | Spring Washer | 12 | 2 |
| | | Flat Washer | 12 | 2 |
| 6 | BEAMS TO MAIN SUSPENSION ASSEMBLY | Hex Bolt | 3/8-16 * 3 | 4 |
| | | Lock Nut | 3/8-16 | 4 |
| | | Flat Washer | 3/8 | 8 |
| 7 | BEAMS TO CART | Hex Bolt | 7/16-14 * 3-1/2 | 6 |
| | | Lock Nut | 7/16-14 | 6 |
| | | Flat Washer | 7/16 | 12 |
| 8 | FRONT SHOCK COVER | Hex Bolt | 1/4-20 *1/2 | 4 |
| | | Hex Bolt | 1/4-20 *3/4 | 2 |
| | | Lock Nut | 1/4-20 | 6 |
| | | Flat Washer | 1/4 | 4 |
| | | Flat Washer | 1/4 | 8 |
| 9 | HEIM JOINTS | Heim Joint | 1/2-20*38 | 4 |
| | | Nut | 1/2-20 | 8 |
| | | Flat Washer | 1/2 | 8 |
| 10 | KICKOFF LINK | T-shape Spacer | φ8*8 | 2 |
| | | Flat Washer | φ8 | 2 |
| | | Nylon spacer | Φ9.5*φ16*3 | 2 |
| | | Pin | 2.5*18 | 2 |
| 11 | REAR RISER | Hex Bolt | 3/8-16*1-1/4 | 8 |
| | | Lock Nut | 3/8-16 | 8 |
| | | Flat Washer | 3/8 | 16 |
| 12 | SGC PLATE | Hex Bolt | 5/16-18 *3/4 | 2 |
| | | Lock Nut | 5/16-18 | 2 |
| | | Flat Washer | 5/16 | 2 |
| | | Flat Washer | 5/16 | 2 |

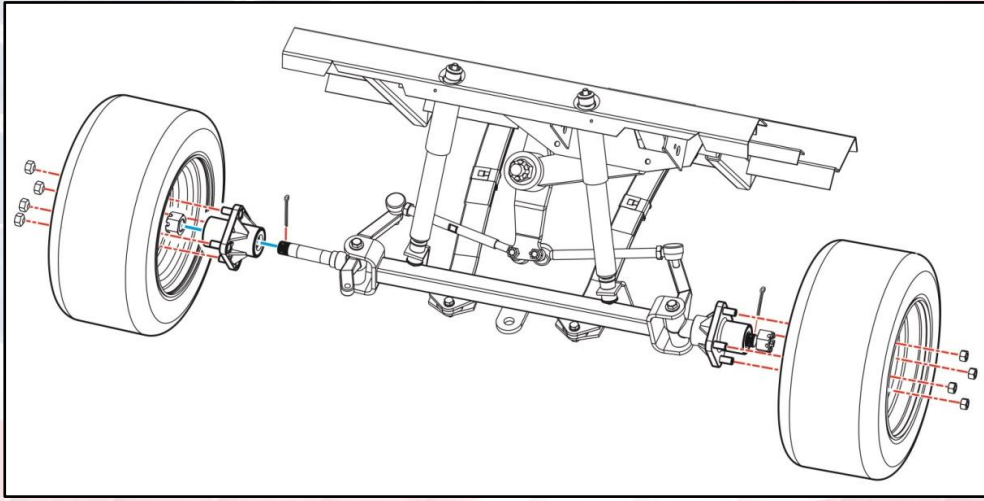

1. Remove front wheels and hubs from cart.

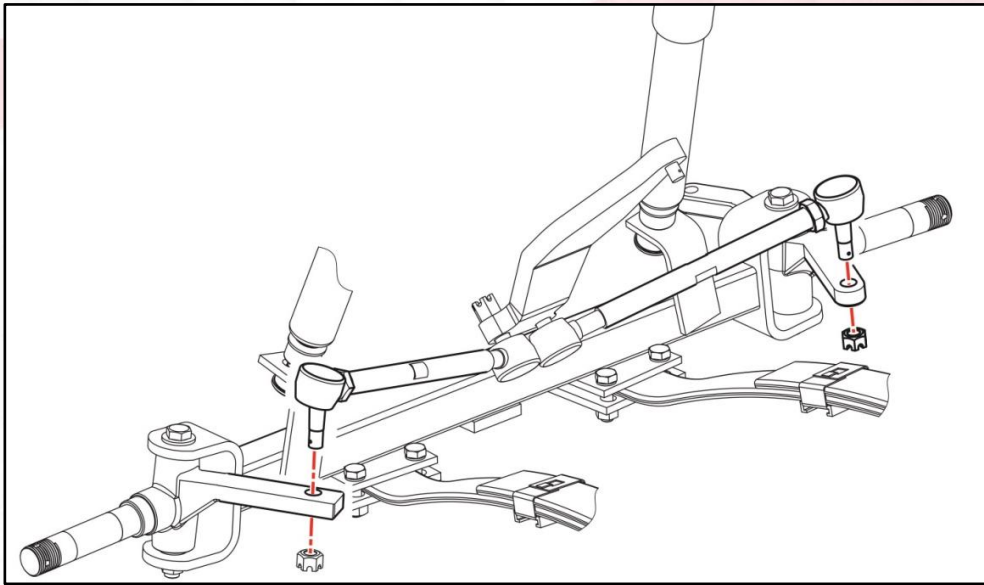

2. Remove rack and pinion from spindles.

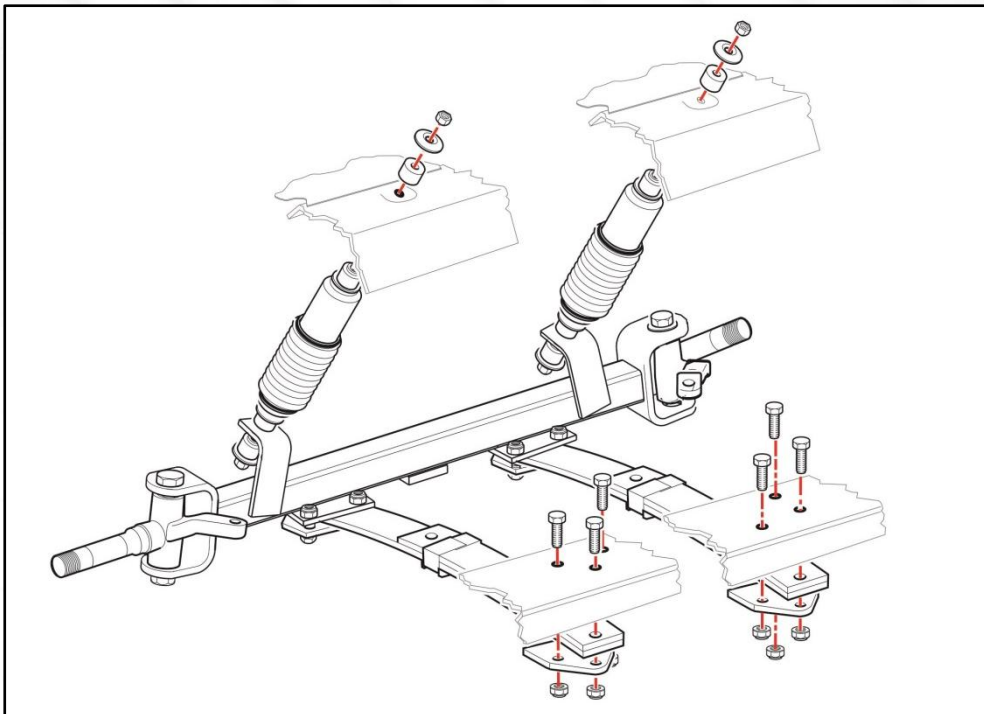

3. Remove factory leaf spring, front shock absorber, front axles.

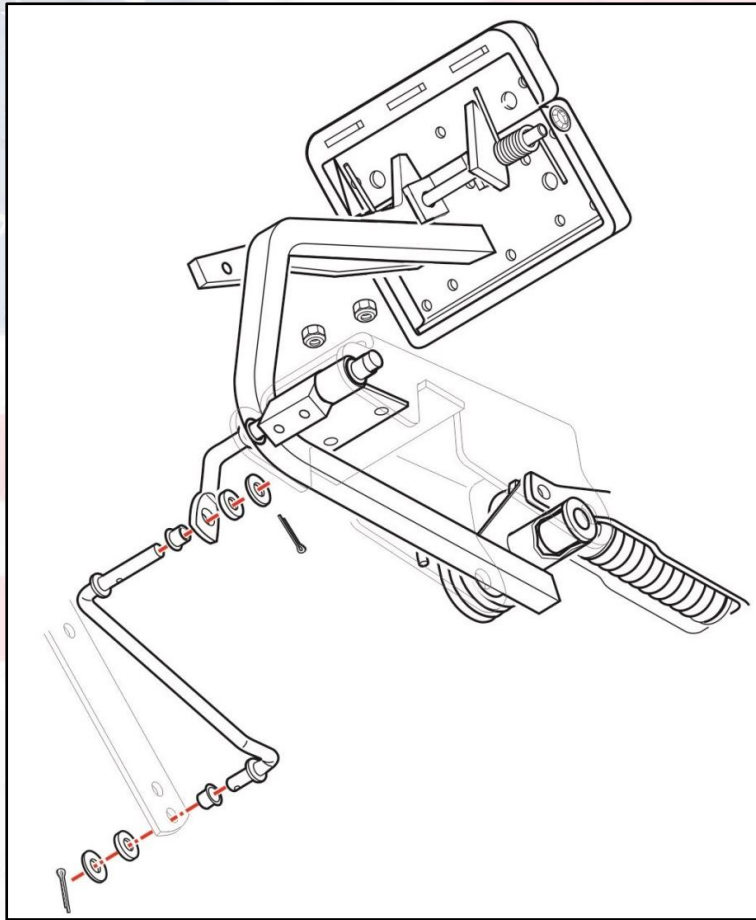

4. Take off factory kick off link.

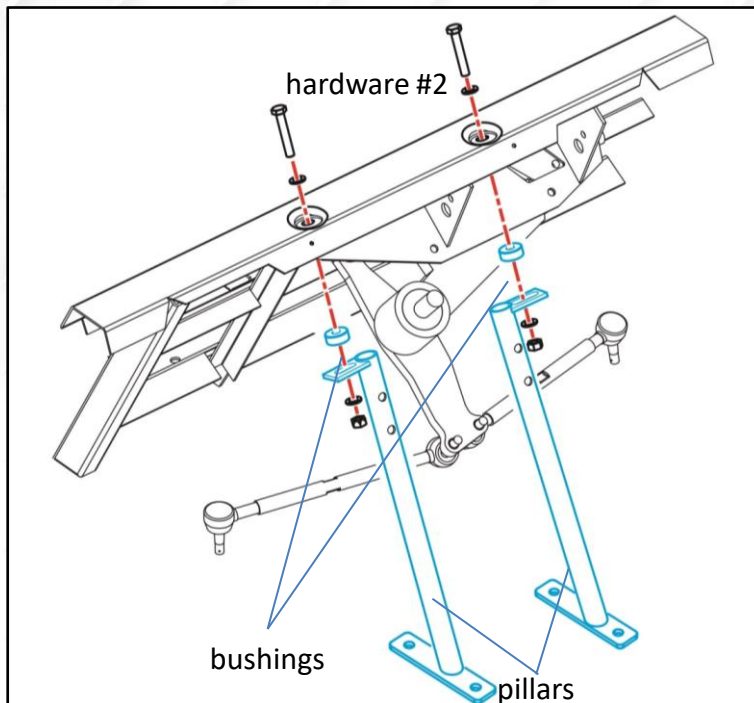

5. Once factory front suspension were removed, attach pillars to cart using hardware #2. The bushings in #2 will be used as indicated.

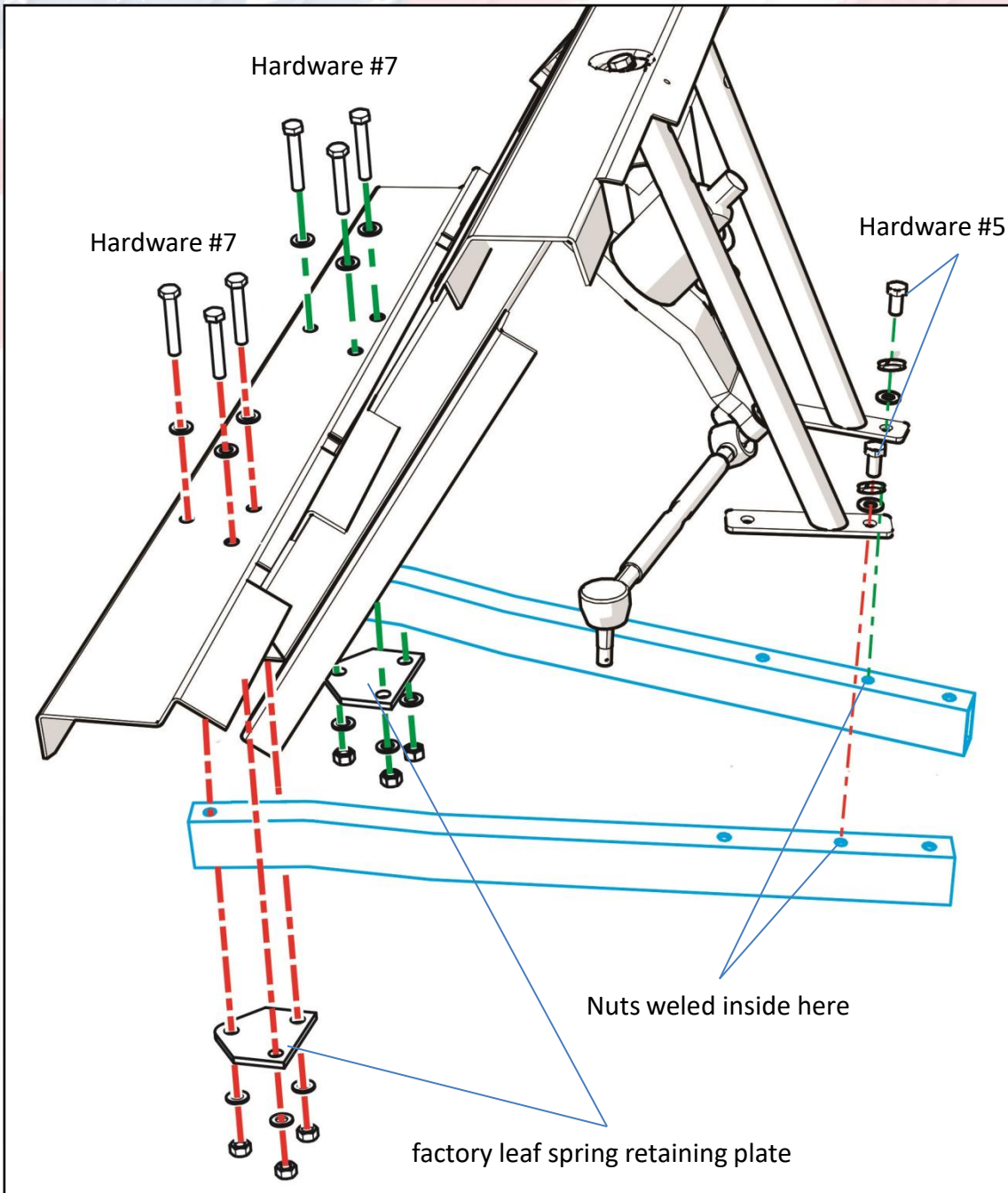

6. Attach beams to cart using factory leaf spring retaining plate and hardware #7.

Attach front portions of beams to pillars using hardware #5.

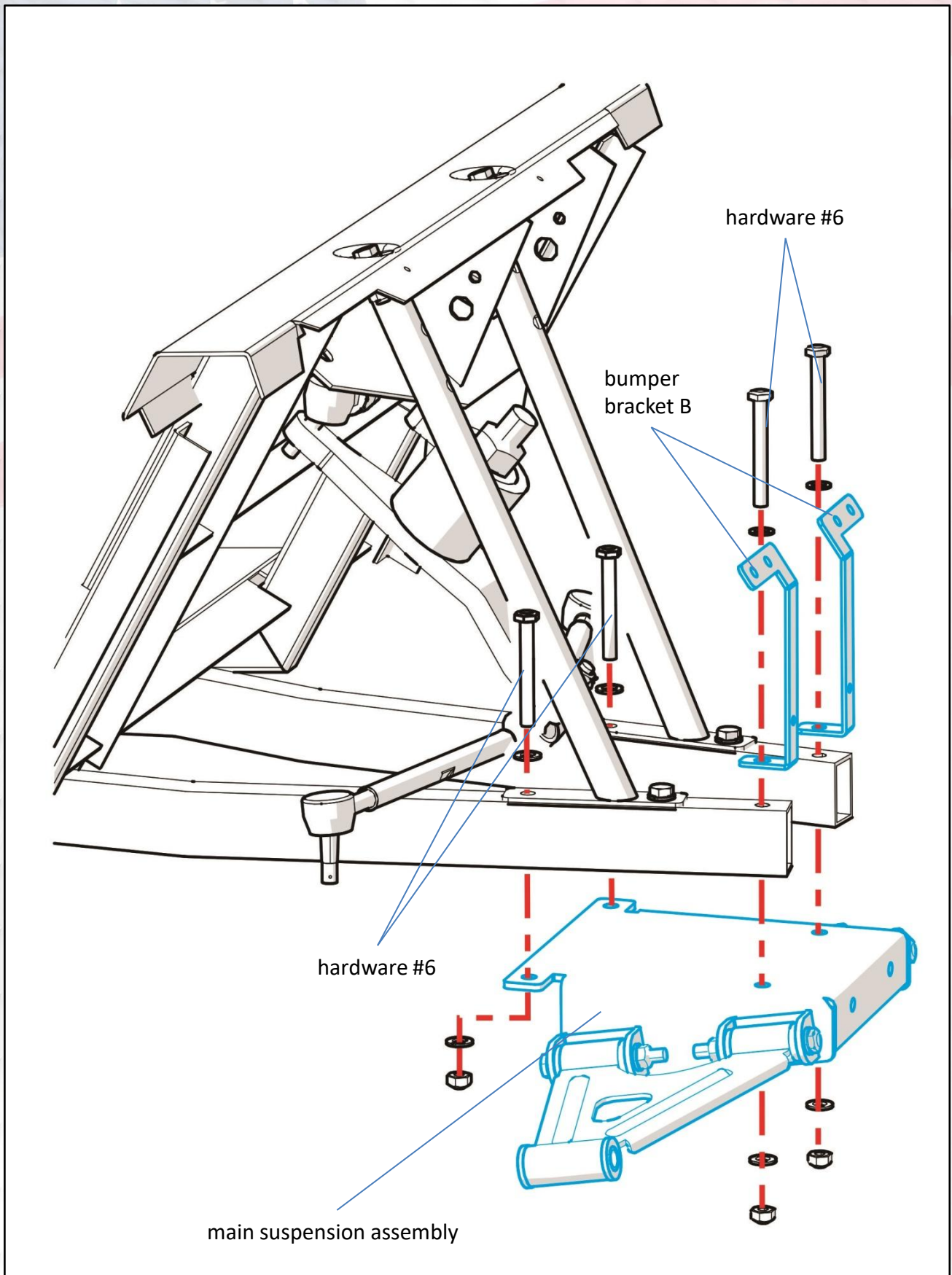

7. Attach main suspension assembly to beams using hardware #6. If you use factory plastic front shock cover, attach bumper bracket B as indicated. If you use STEELNG aluminum front shock cover, please skip this step and move to next.

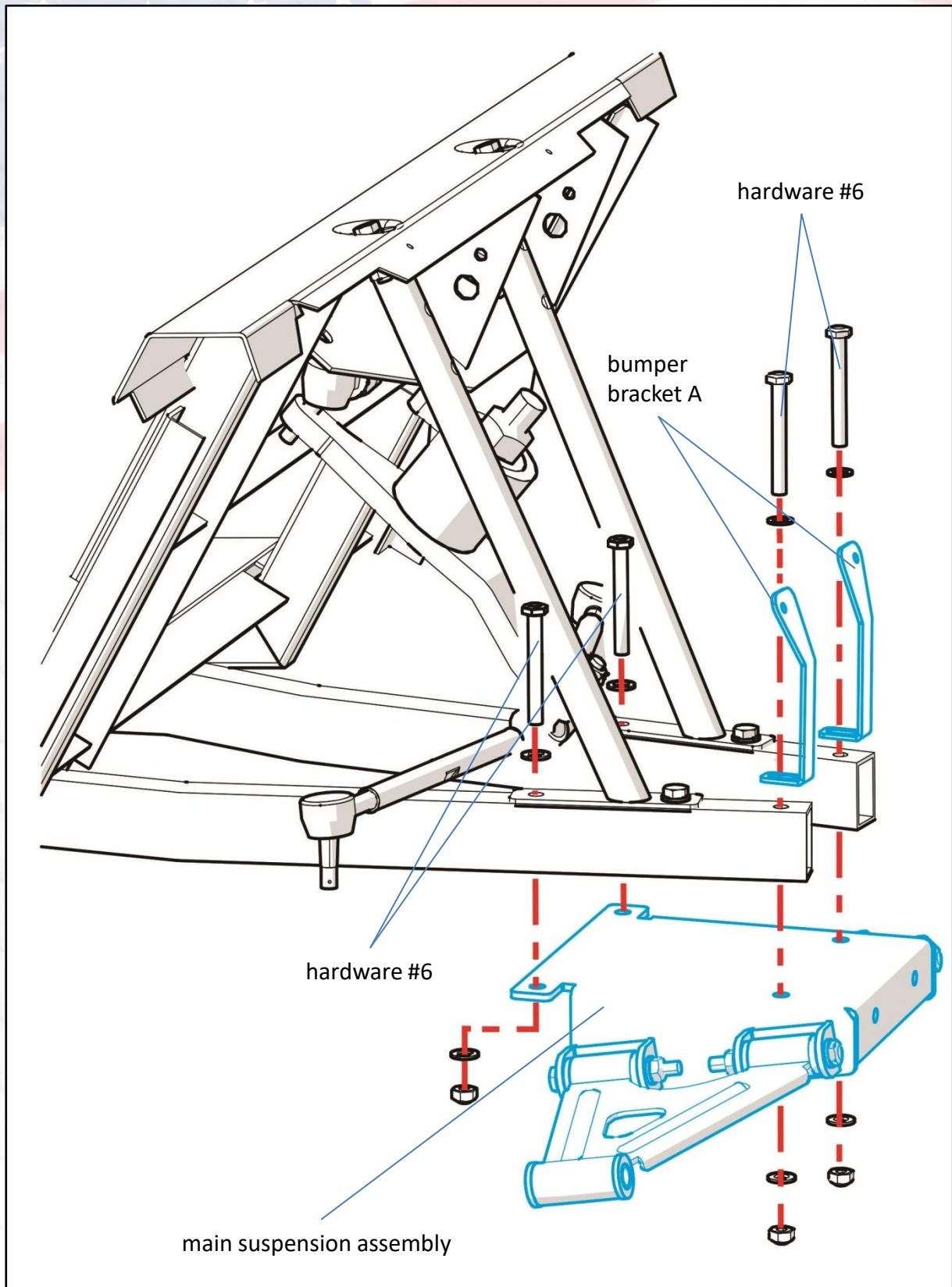

8. If you use STEELENG aluminum front shock cover, attach bumper bracket A as indicated using hardware #6. Bracket B will not be used.

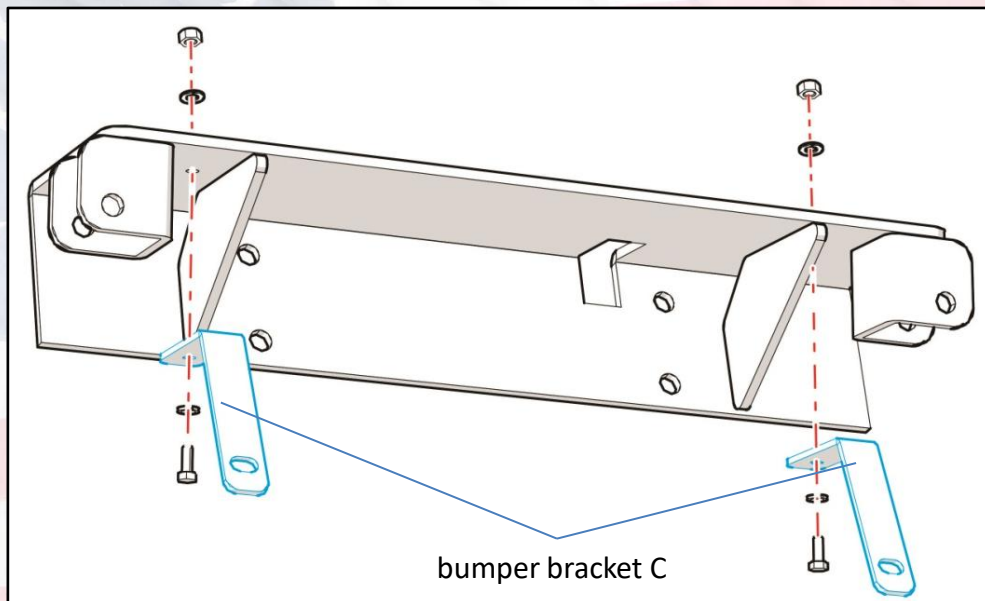

9. Attach bumper bracket C to shock upper mount using hardware #8 (two longer bolts, washers and nuts).

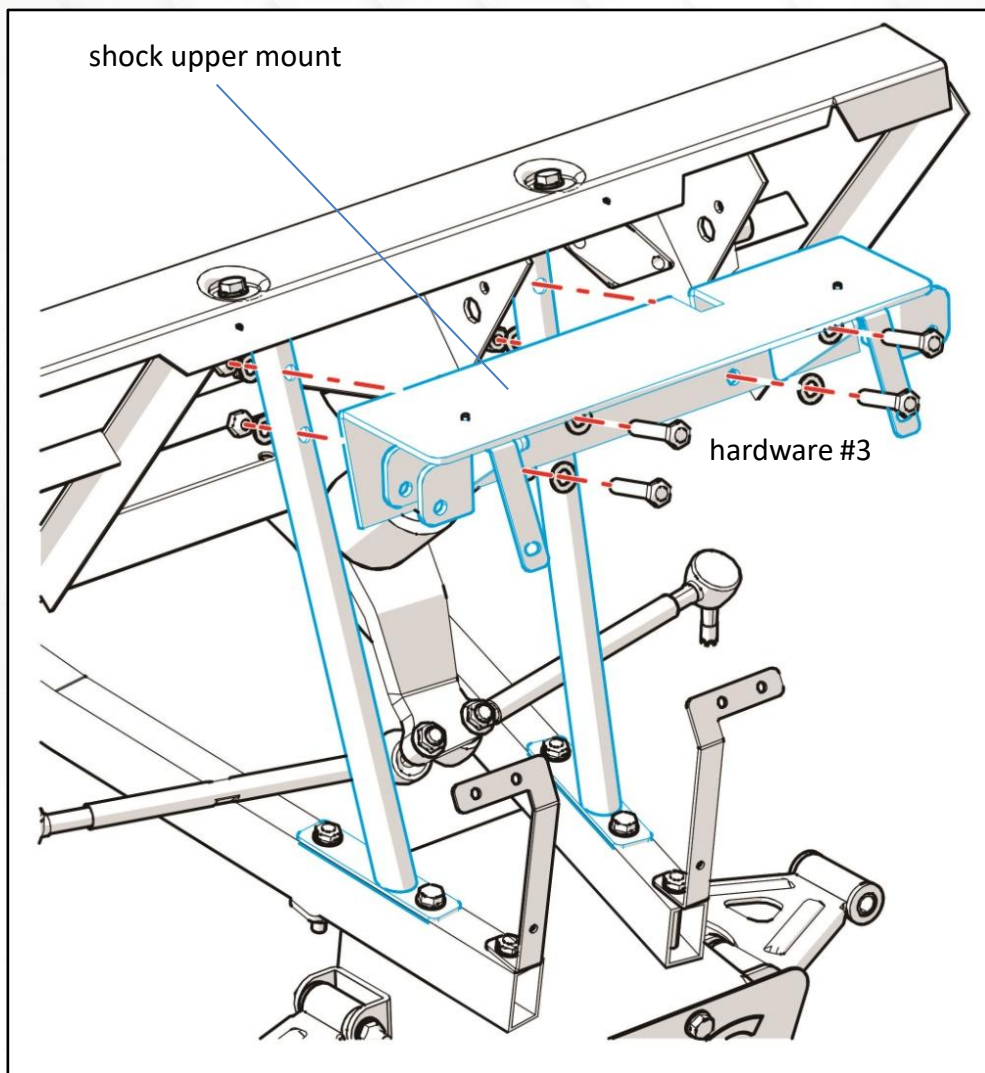

10. Attach shock upper mount to pillars using hardware #3.

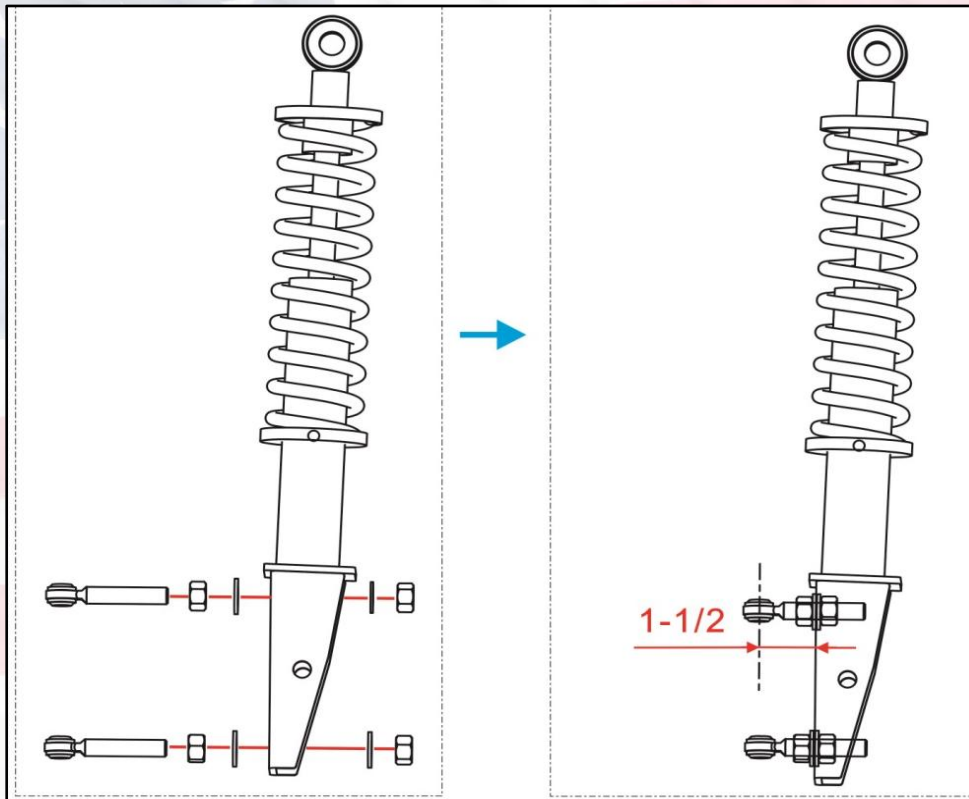

11. Attach heim joint to front shocks using hardware #9. Nuts on each side can adjust the heim joint extruding length. 1-1/2" is suggested (measured from eyelet to mounting surface).

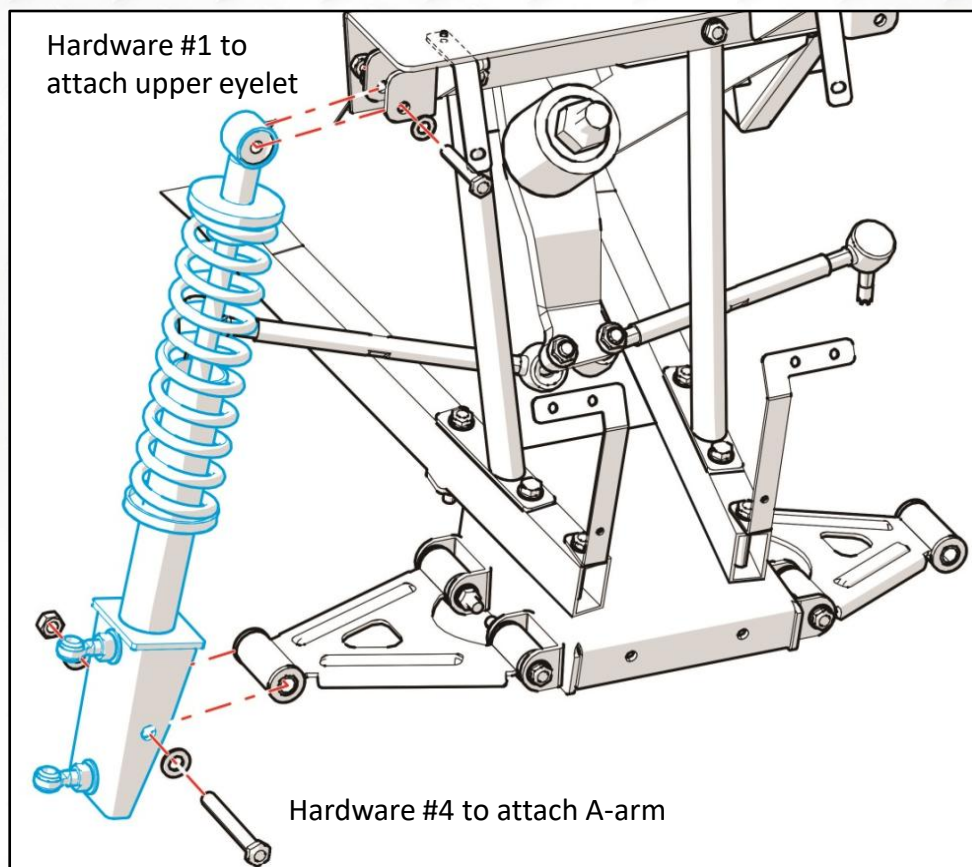

12. Attach front shocks to shock upper mount using hardware #1. Attach front shocks to A-Arm using hardware #4.

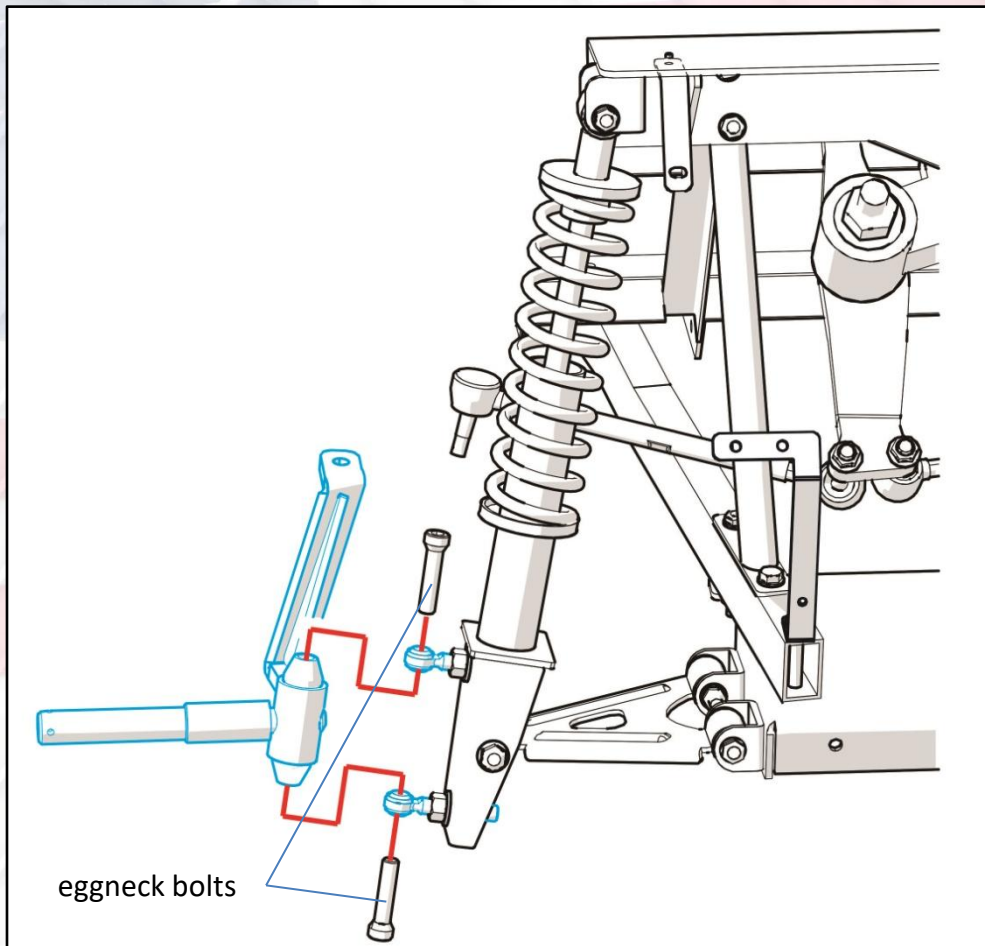

13. Attach spindles to heim joints using pre-mounted eggneck bolts.

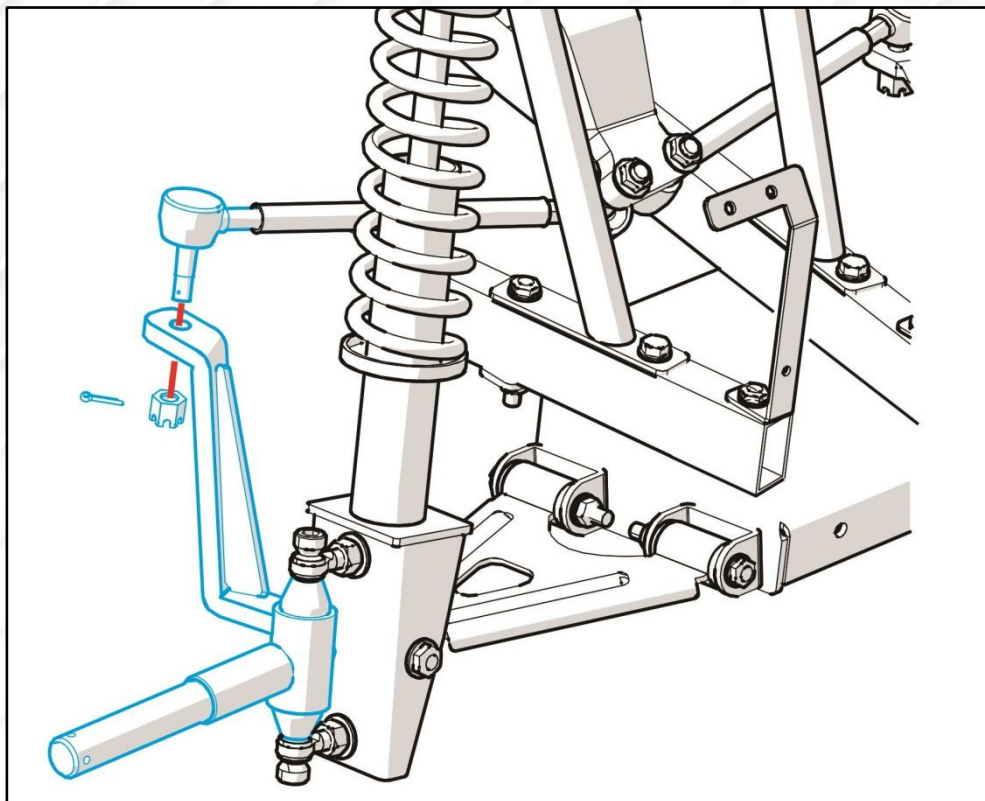

14. Reattach rack and pinion tie rod end to spindle using factory hardware.

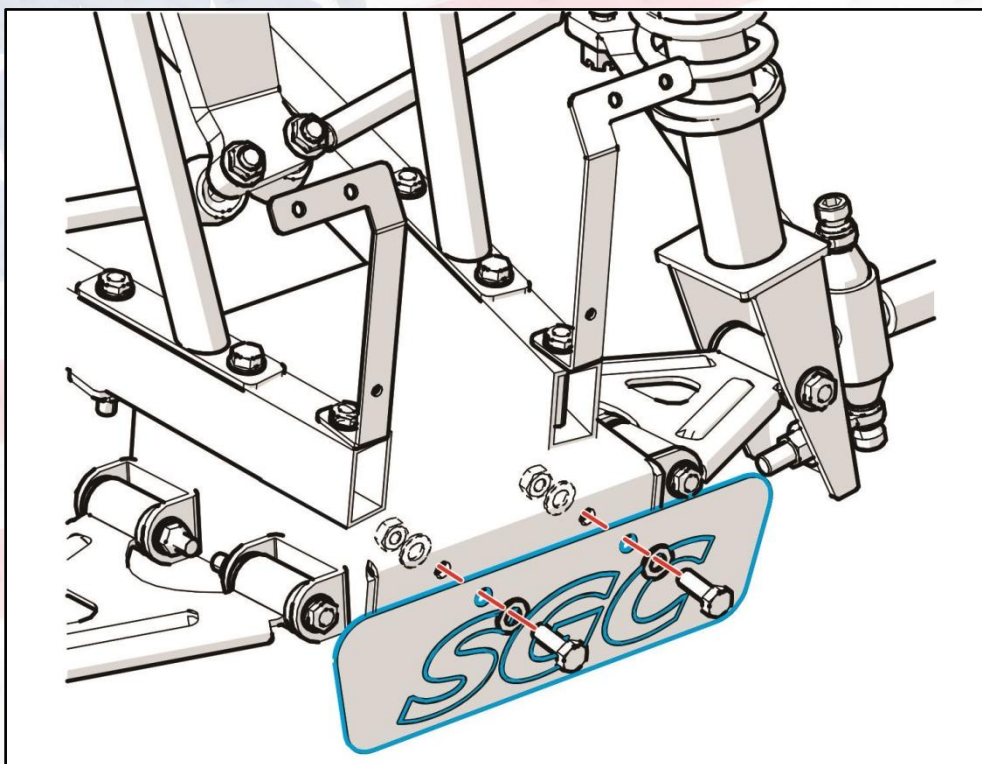

15. Attach SGC Plate to main suspension assembly using hardware #12. Black washer to be used on the front.

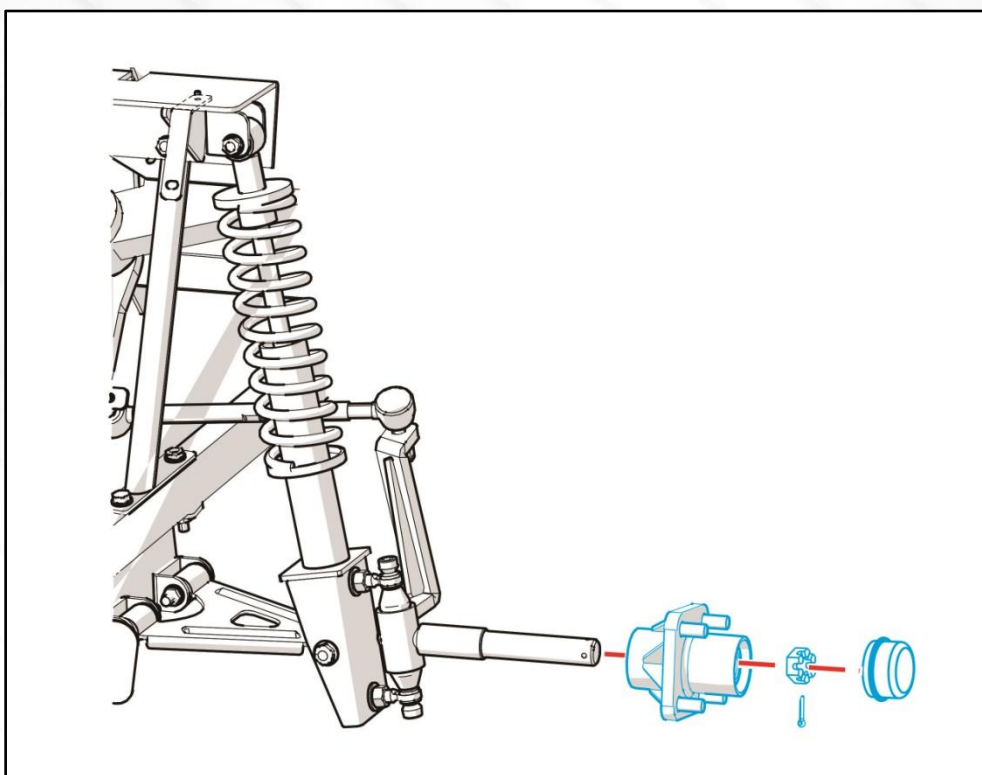

16. Reattach hubs to spindles.

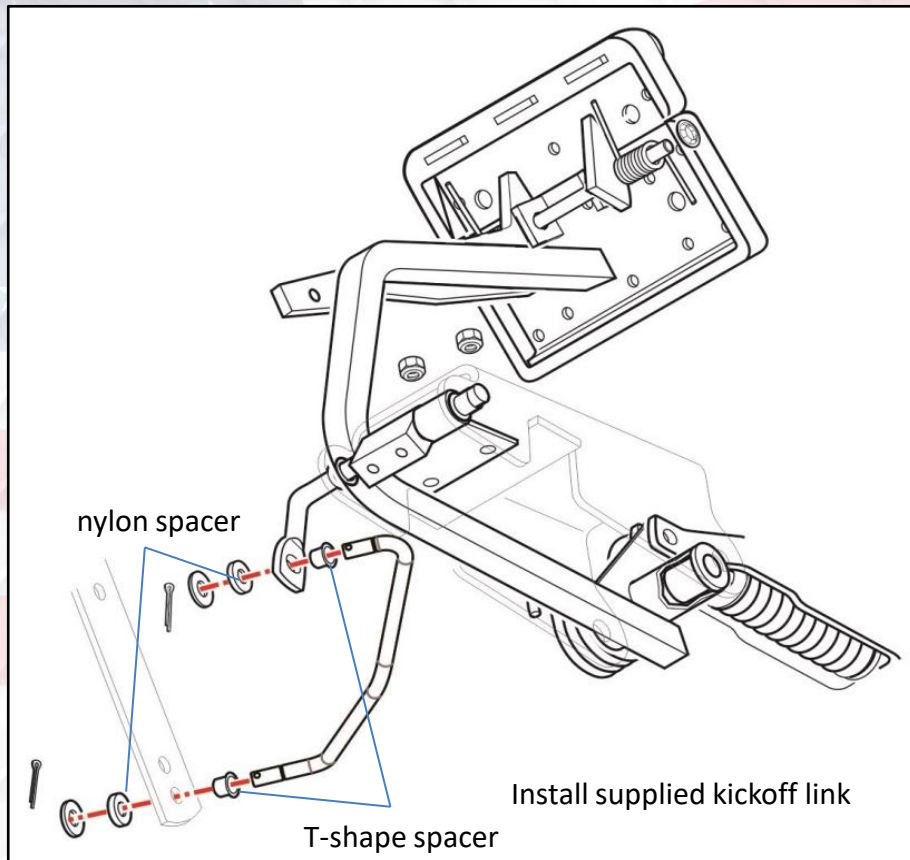

17. Go to below the brake pedal. Replace factory kickoff link with provided one using hardware #10.

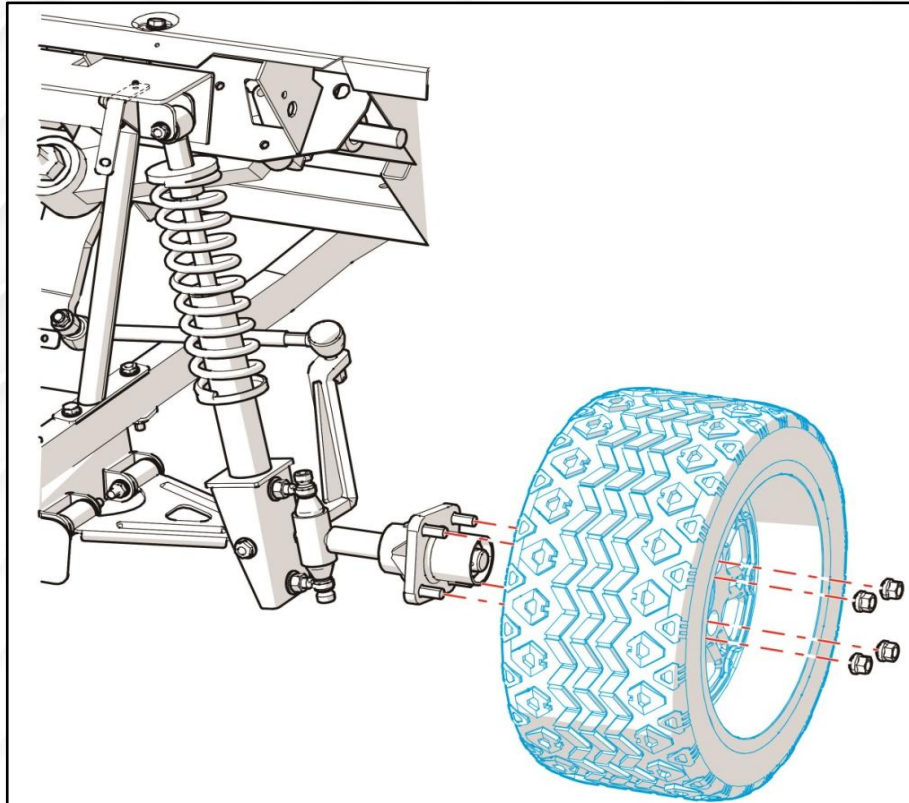

18. Attach tires and wheels to cart.

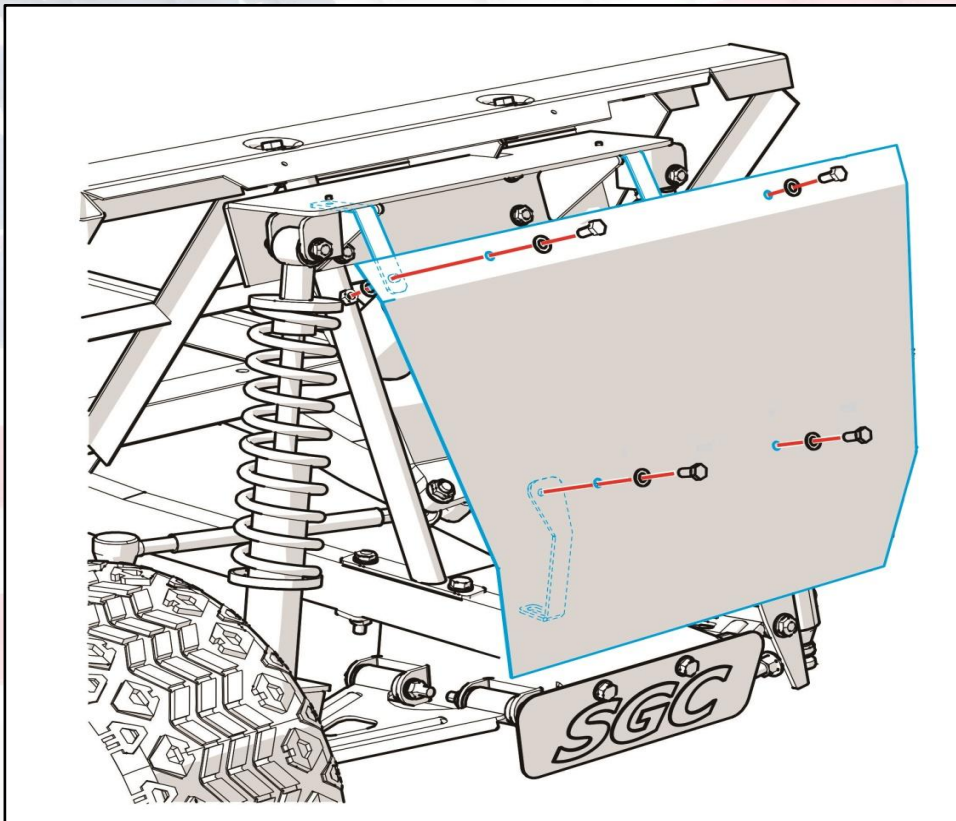

19. Attach aluminum front shock cover to bracket A and C using hardware #8 (four shorter bolts, washers and lock nuts). If you use factory plastic bumper, go to skip this step.

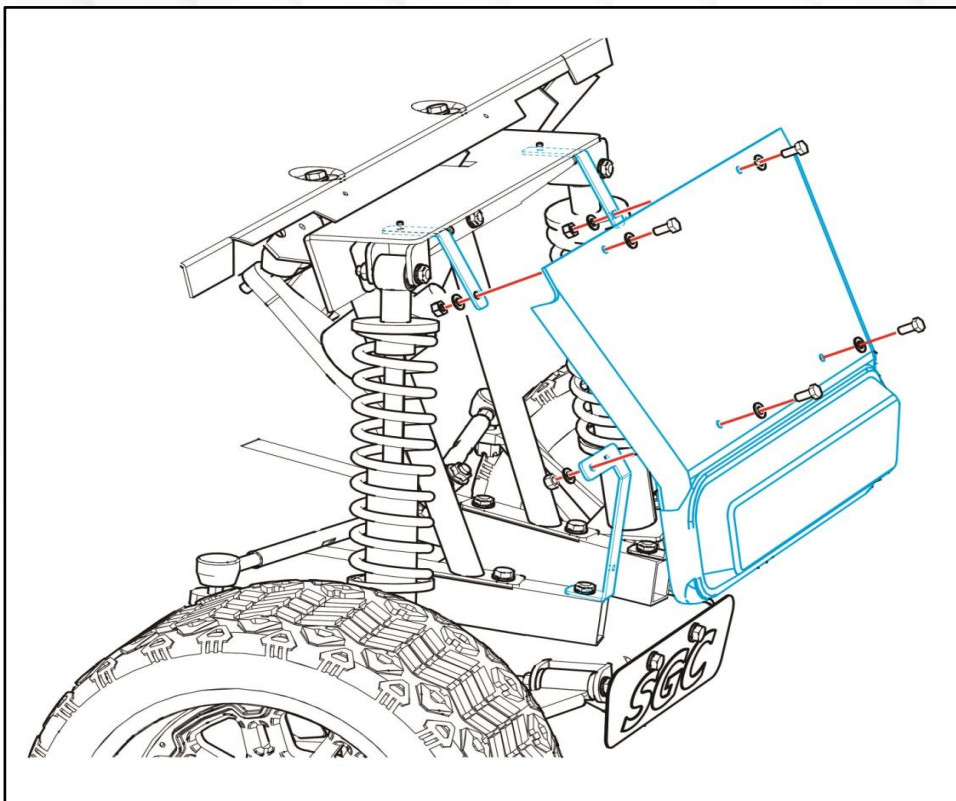

20. Attach factory front shock cover to bracket A and B using hardware #8 (four shorter bolts, washers and lock nuts).

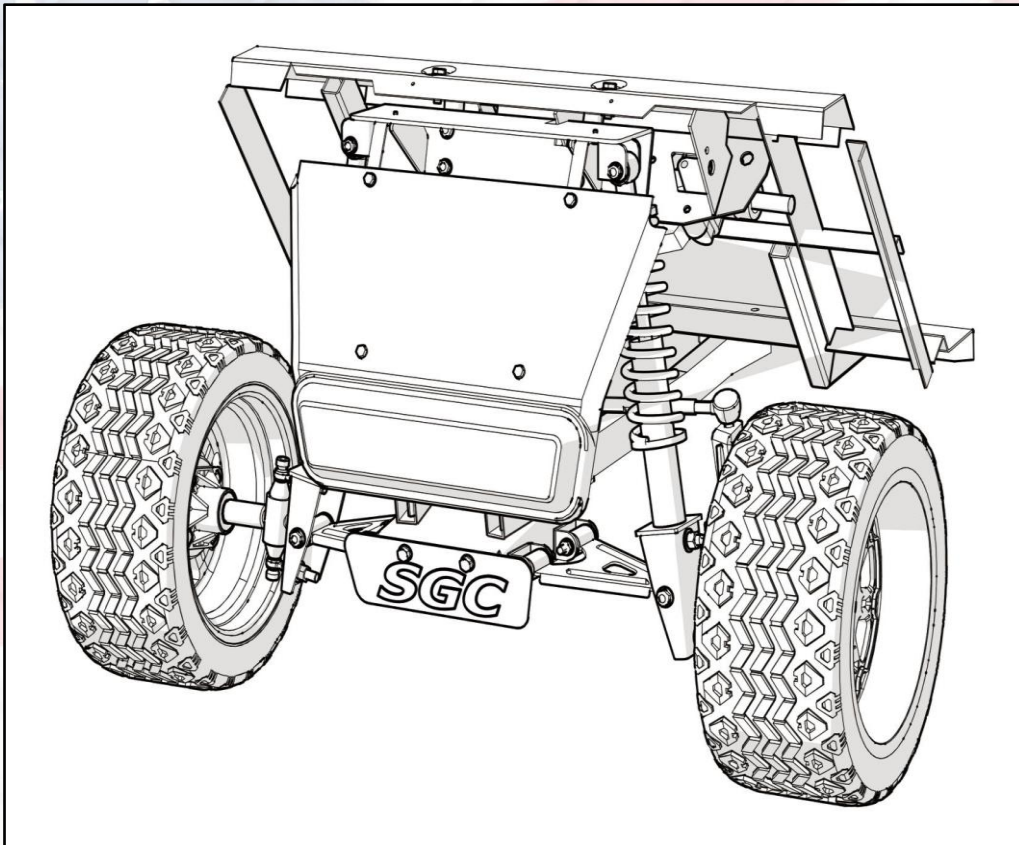

21. Finished look on front installation.

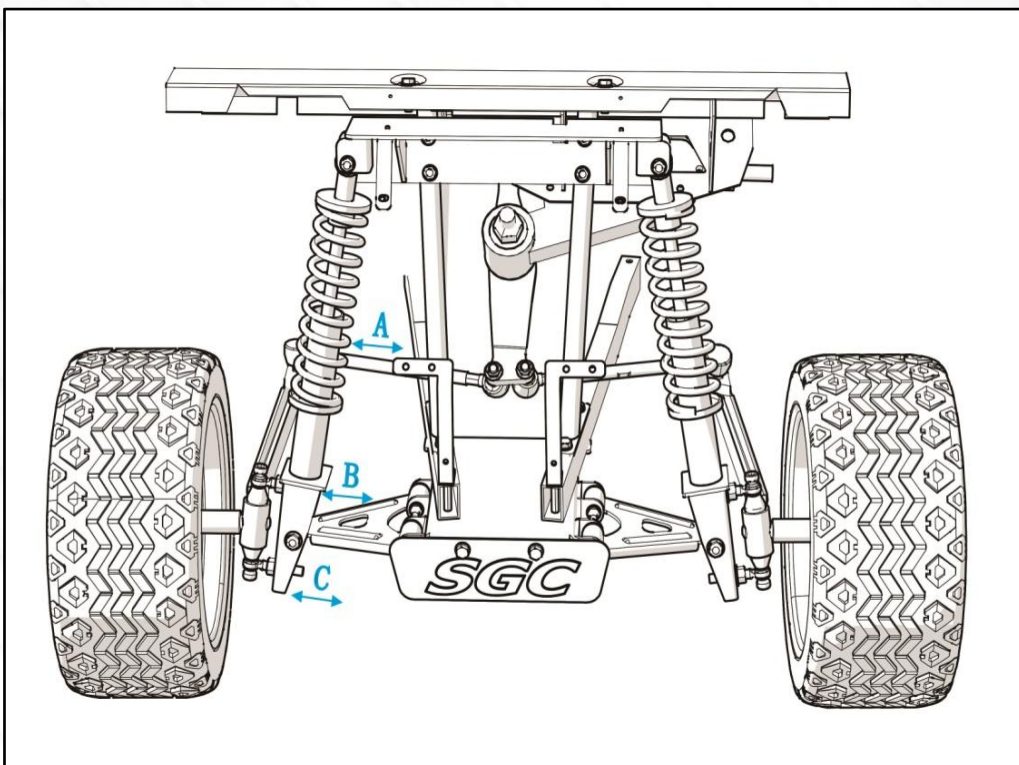

22. Adjust toe in and camber. Detailed in last page.

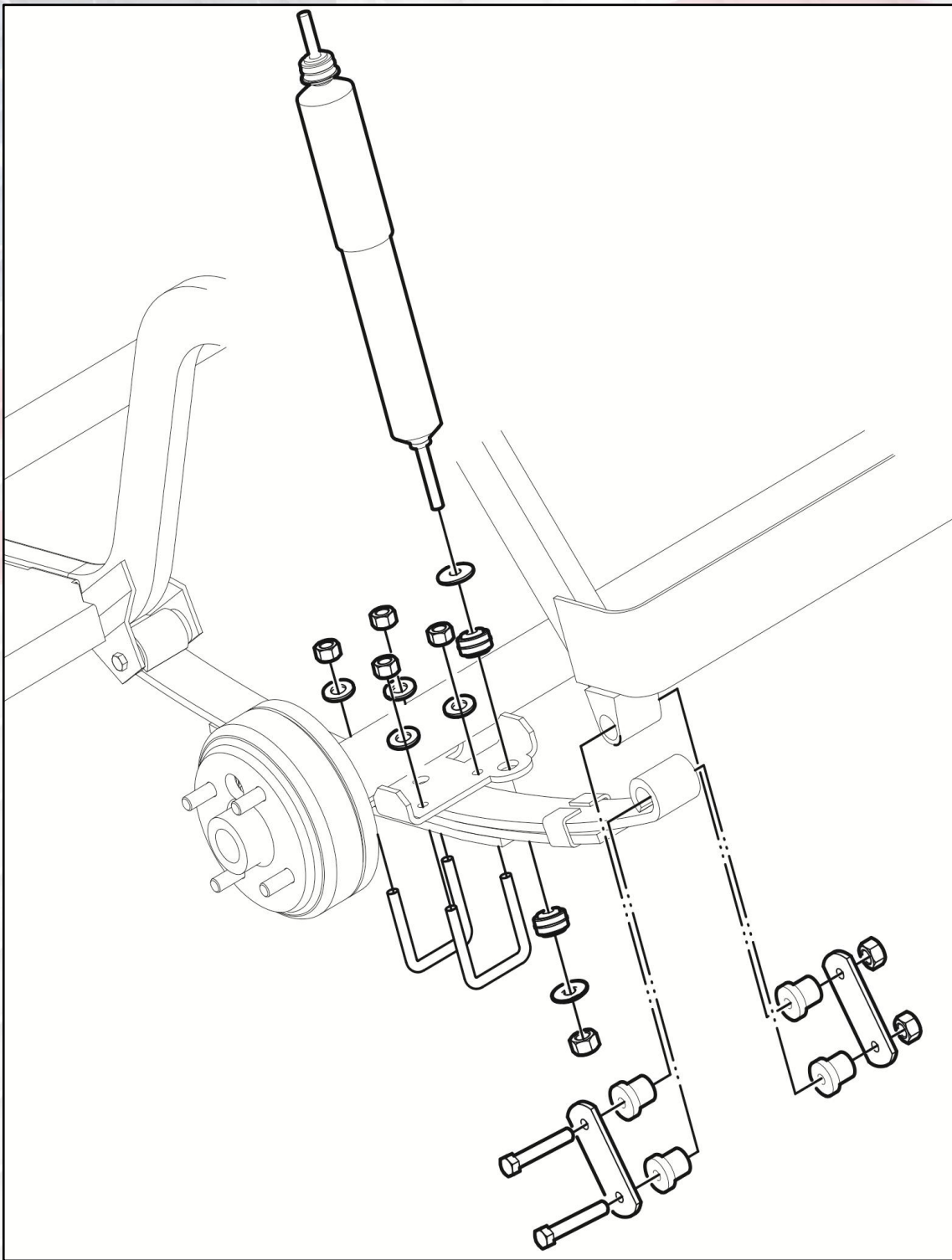

23. Jack up the rear end of the cart and place jack stands on the frame in front of the springs. Place a car jack under the rear-end housing. You will be installing larger wheels and tires so raise the cart high enough to accommodate the additional height.

24. Remove the wheels and tires. Unbolt the bottom of the shocks. Clean and lubricate bolts for later use.

25. Unbolt the rear leaf springs from under the rear end. Save the front and rear leaf spring bolts for reinstallation of the leaf springs. Using the car jack lower the rear end of the cart.

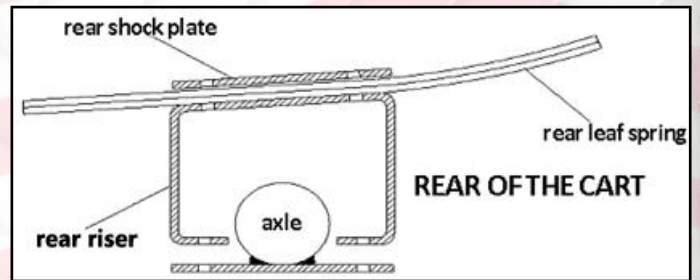
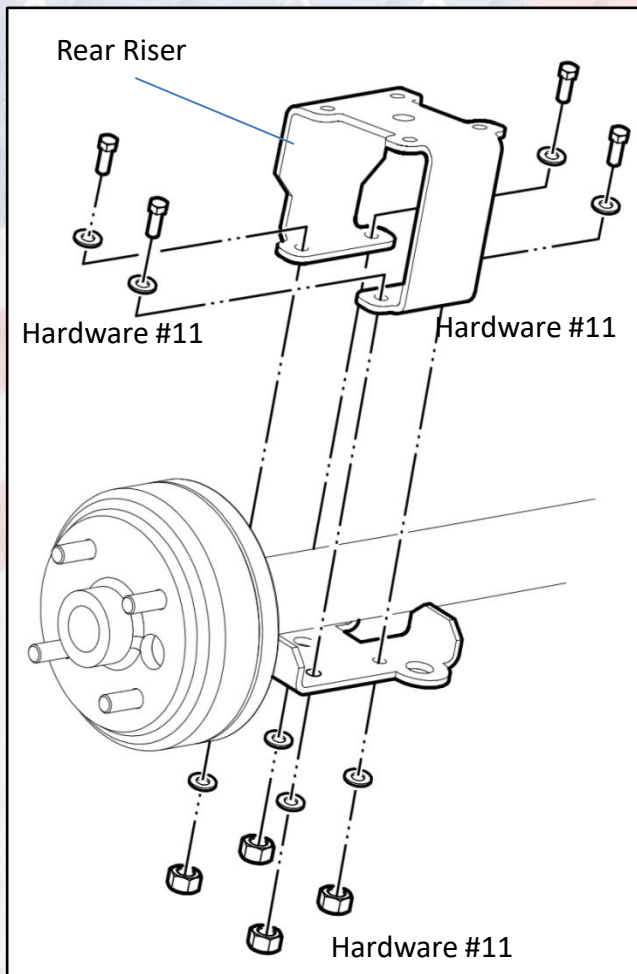

26. Sit Rear Riser on top of the rear axle as shown using hardware #11.

NOTE: Rear riser is directional.

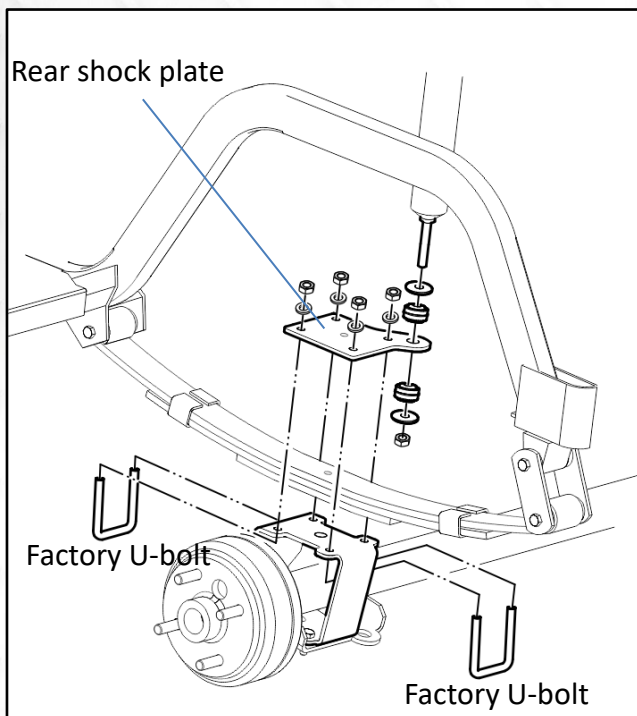

27. Place the leaf spring on top of the rear riser and loosely mount the front of the leaf springs to the stock front leaf spring mount using the stock hardware.

28. Place rear shock plate on top of the leaf spring with the shock mount holes facing the rear of the cart and towards the center.

29. Using the stock leaf spring bolts and nuts, bolt the rear leaf spring to the stock rear leaf spring mount. Attach the bottom of the shocks to rear shock plate using the stock nuts and bolts.

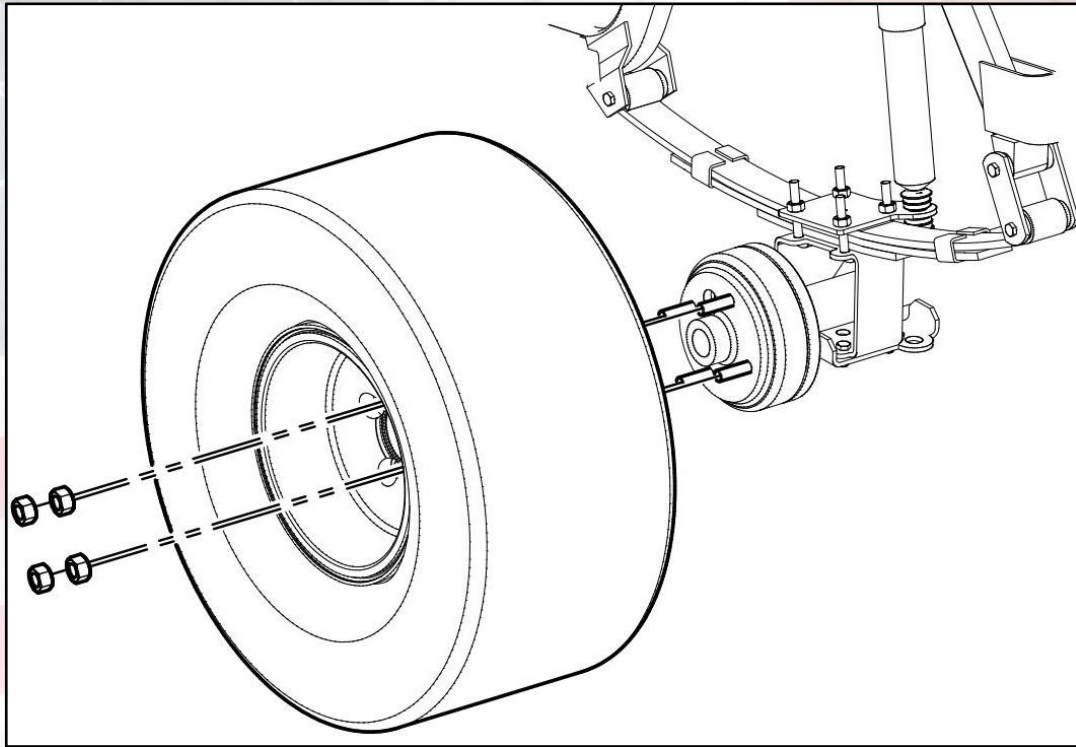

30. Use wire ties to fasten the brake cable to either the underside of the springs or the frame.

31. Securely tighten all nuts/bolts. Install recommended wheel and tire size 22 x 11 x 10 wheels and tires with a 3 x 5" offset for maximum performance. NOTE: Your stock wheels and tires will work but are **not** recommended!

ALIGNMENT INSTRUCTIONS

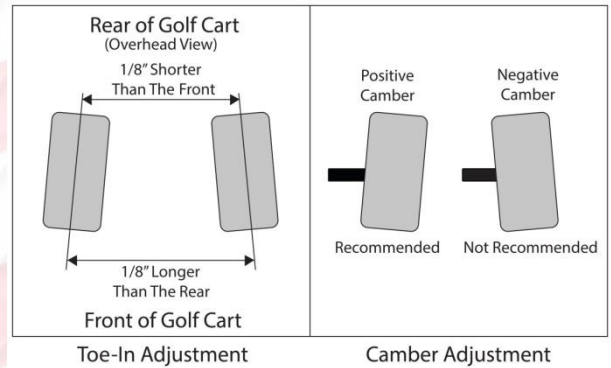
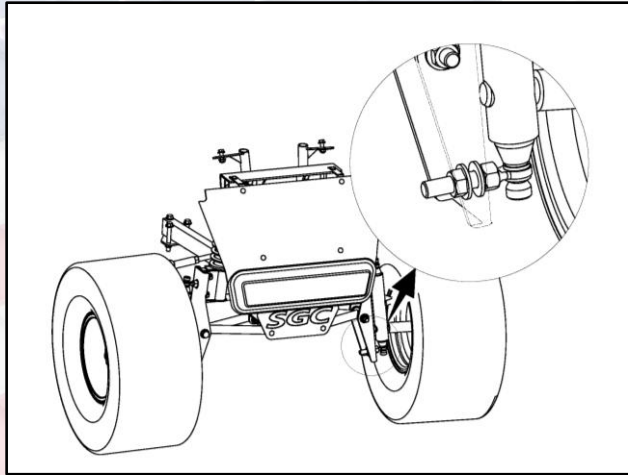

IMPORTANT: Both Camber and Toe must be adjusted on this model.

To adjust for proper camber (the vertical tilt of the wheels), use a framing square, level, or some other means of verifying that the tire is at a 90 degree angle to the ground.

Adjust camber to 90 degrees using the two nuts on the bottom heim joint.

If adjusting the camber to 90 degrees is not possible using only the adjustment on the bottom heim joint, then the top heim joint must be disconnected from the spindle, rotated, then reassembled and checked as necessary to achieve the correct camber.

IMPORTANT: Be sure to retighten all adjustment points after adjustments are made.

To adjust Toe, ensure the wheels are pointing straight forward. Find a common point to measure from on the inside front and inside rear of the front tires. Adjust until the front measurement is 1/4" to 3/8" greater than the rear measurement. Loosen nut on both tie rod ends. Adjust using a wrench to desired alignment.

If steering wheel is not properly oriented after adjusting toe-out, adjust steering box tie rod to align steering wheel if needed. Loosen tie rod lock nuts and turn steering box tie rod clockwise or counter clockwise to adjust steering wheel.

IMPORTANT: Ensure that after this adjustment, both wheels toe out from the cart's centerline equally. Once tightened, roll the cart back 15-20 feet and then forward again to check.

NOTE: Be sure to use thread locking adhesive on upper and lower heim joint spindle screws.



RETURN MERCHANDISE AUTHORIZATION

Dear Valued Customer,

Thank you for choosing Steeleng Golf Cart Accessories for your golf cart needs.

We apologize for the issues you are having with your purchase. We strive to offer the absolute best quality at the absolute best price.

To best serve you, we do need a little information to help process your return and/or exchange faster.

Please complete the following and include this entire form with your return.

Name

Shipped To Address STATE ZIP

Purchased with: eBay Direct Phone Order

This is for EXCHANGE REFUND

Please describe reason for return:-

Our Return Address:
Steeleng Golf Cart Accessories
3309 Laurens Road,
Greenville, SC 29607
Tele: 864-675-1103

For Office Use Only:

Received By: _____ Date _____
Refund Amount _____ Exchange Issued _____

**Steeleng Golf Cart Accessories reserves the right to charge a 15% restocking fee for all returned and/or exchanged items.