

# focuway®



**T5**

**Dash Cam**

**U S E R M A N U A L**

# Please follow the steps below to test your T5 cam before wiring:

- 1 Insert SD card and use the car charger that we provided in package to power on T5 on car

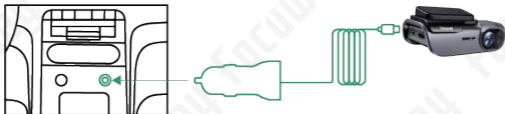

- 2 Refer to this Video Guide to connect T5 to your phone, test if T5 works for you!



**Scan the QRcode**

Or search "Focuway" on [youtube.com](https://www.youtube.com), find our channel!

Find "Okcar app using guide"

- 3 Compatible App for T5



OKCAR

**RECOMMEND**



VIIDURE

Search app name on google play or app store

# Quick Troubleshooting:

Can't find FOCUWAY-T5xx Wi-Fi?

[Page:35](#)

Connect the Wi-Fi successfully, but App does not recognize it?

[Page:37](#)

Connect the App successfully, but the App doesn't show live image, just black screen?  
Connect the Wi-Fi successfully, but the App is stuck and shows 'Buffering'?

[Page:37](#)

Can't delete the Loop Recording files?

[Page:38](#)

Automatically disconnected while use?

[Page:38](#)

Video play failed?

[Page:39](#)

How to playback the video on your PC?

[Page:39](#)

When insert a new sd card and power on the dash cam, it says 'Card full '?

[Page:40](#)

# WATCH VIDEO GUIDE



Scan the QRcode

Or search “focuway” on youtube.com

focuway



FocuWay

38 subscribers • 3 videos

Hello everyone, this is a technical support channel, where we will publish FocuWay product installation and usage tutorials. Any questions, please contact us Email: [support@focuway.com](mailto:support@focuway.com)









SUBSCRIBE

What you can get in video guide?

① Install T5 ② WiFi connect& App using

Any problem! Please Email us: [support@focuway.com](mailto:support@focuway.com)

# CATALOG

 Please Read!!! .....	01
 Package Content .....	02
 Unit Structure, Buttons And Indicator .....	03
1 Meaning of Indicator Color .....	05
2 Voice Prompts .....	05
 Installation .....	06
1 Video Guide .....	06
2 Graphic Guide .....	06
 WiFi & App Using .....	09
1 WiFi .....	10
2 App Download .....	10
3 IOS Connect to T5 .....	11
4 Android Connect to T5 .....	15
5 App Using .....	18
 T5 Settings .....	21
 Basic Functions of T5 .....	27
1 Loop Recording .....	27
2 Emergency Lock .....	28
3 Protect when Parking .....	29
4 Voice control .....	31
5 Preview / Download Recorded Video .....	32
 Trouble Shooting .....	33



## PLEASE READ!!!

We recommend you to purchase MicroSD, CLASS 10, U3 Speed Micro-SD Card, 32 GB - 256 GB.

we recommend you purchase:



TYPE
microSDXC
URS
U3
CLASS
I/10
MAX
256GB

### RECOMMENDED CARD

**SAMSUNG Class-10, U3 Speed Micro-SD card is required, up to 256GB Maximum**

Before the first record, please format SD card in app, refer to section of WiFi & App Using(page10)

- The T5 is powered by a supercapacitor, please keep it connecting to the power when using.
- The T5 is programmed automatically power on and start recording when the engine is ON. Please insert the branded & recommended Micro-SD card before you turn the engine on.
- This product is screenless, and all settings need

to be done through the mobile APP, You can judge the working status of the T5 by the status of the indicator light and the voice prompts. Learn more about this, please go to page 05.

 This is NOT an IP/4G Dash Cam - It does NOT allow you to view your recording remotely, you can use the WIFI function within 5 meters). And you need to connect the dash cam WIFI every single time you want to use the App.

 If you encounter any product issues. For example, product function problems, missing parts, product damage, etc. Please email

[support@focuway.com](mailto:support@focuway.com)

or contact the FOCUWAY support team through the Amazon order, we will give you a satisfactory solution.



## PACKAGE CONTENT



T5 Dash cam



Car Charger



Rear Camera



Electrostatic Film

## Please Note

Memory card is NOT included. We recommend you to purchase MicroSD, CLASS 10, U3 Speed Micro-SD Card, 32-256GB. Please refer to the recommended purchase on the page 1.



## UNIT STRUCTURE, BUTTONS AND INDICATOR

Stikey Mount

Rear cam Socket

Power socket



Microphone

Hard reset hole





## Power Button Functions

Press-Once to START / STOP the recording;  
Longpress to turn on/ off camera;

### Express features:

When the dash cam is recording, you can short press POWER button to stop recording first, after you hear 'Recording Stop' you can operate:

- 1) 5GHz wifi switch to 2.4GHz -- Press the POWER button 3 times continuously (If you can't find the dash cam wifi on your phone you can switch it to 2.4Ghz to try out, some old cell phone can't support 5GHz WLAN)
- 2) 2.4GHz wifi switch to 5GHz -- Press the POWER button 3 times continuously
- 3) Reset passwords -- Press the POWER button 5 times continuously

## 1 MEANING OF INDICATOR COLOR



### MEANING OF INDICATOR COCOR

- **Solid Green**  
Camera Stand by  
(Recording Stop)
- **Bilinking Green**  
Camera is Recording  
(Recording Start)

## 2 VOICE PROMPTS

- 🔊 **Starting up**  
Dash cam power on, turn on WiFi hotspot
- 🔊 **Recording start**
- 🔊 **Recording stop**
- 🔊 **Emergency recording start**  
loop recording function(page 27)
- 🔊 **Storage full**  
Please format SD card, 1.If you turn off loop recording, the memory card will fill up quickly;  
2. Locked files fill up SD card, learn more about this, please go to page 28.



## INSTALLATION

### 1 VIDEO GUIDE



YouTube

We have prepared a detailed installation and use introduction video, please refer to the video guide on the first page.

### 2 GRAPHIC GUIDE

#### 1. Understanding Power Connection Diagrams



Car Cigarette  
Lighter Socket



Car Cigarette  
Lighter Plug



Focuway T5  
Dash Cam

2. Insert SD card (SD card is not include, please refer to page 1 to purchase!)



### 3. Mounting T5 on Car Front Windshield



T5 install position



Adjust camera get the best perspective

#### PLEASE:

- 1 Make sure clean your windshield from the dust particles.
- 2 Stick the electrostatic sticker on the windshield, remove the red protective film of the 3M adhesive, and stick the 3M Sticky Mount on the electrostatic sticker.
- 3 Make sure the camera view is not obstructed by any window tint or any other object.

### 4. Wiring T5 Diagram

T5 has two cameras, front and rear, the front camera should be installed on the front windshield of the car; the rear camera should be installed on the rear windshield of the car.

Front camera wiring:



Rear camera wiring:



## CAUTION

1 Only use FOCUWAY USB car charger otherwise the camera may diswork.

2 If your vehicle has side curtain airbags please be very careful when running cables along your vehicle windows, ensure you are not running cables past any of the airbags as this can prevent the airbags from deploying.

### 4. Start Your Car Engine, Check if T5 is Powered



## WIFI & APP USING

### 1 WIFI

The WiFi of the T5 will automatically turn on when it is turned on.



**WiFi Name** : FOCUWAY-T5\*\*\*



**WiFi Password:** 12345678

2

## APP DOWNLOAD



OKCAR



Download APP "OKCAR" from Google Play.



Download APP "OKCAR" from App store



Scan the QR code to download

### 3 IOS CONNECT TO T5

This guide is designed with reference to app version 1.2.1. The app will always optimize the UI interface. The icons may be different in subsequent versions



OKCAR

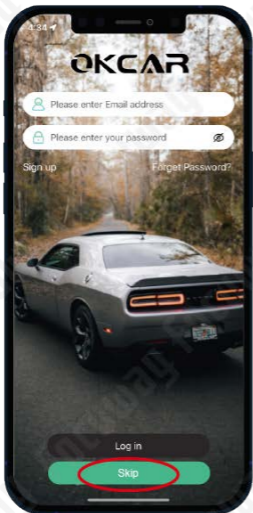

1 Skip login

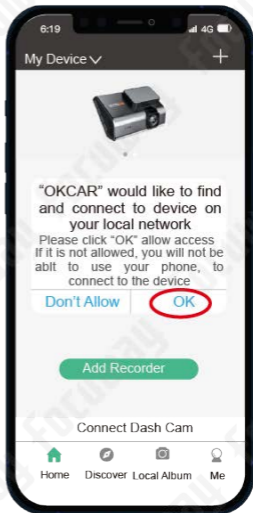

2

Please be sure to select OK, otherwise the T5 will not be able to connect to your iPhone.

Because the phone needs to be connected to the WiFi hotspot shared by T5.





OKCAR

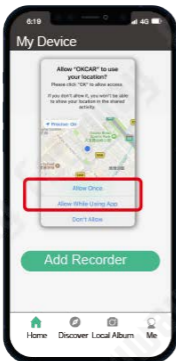

3

The system will pop up "Location Permission", please choose "Allow While Using App" or "Allow Once" (If you choose Allow Once, this message will pop up every time you connect). **If you choose don't Allow, you will not be able to connect to the T5!!!** FOCUWAY promises that the location information will only be used locally and will not be uploaded to the network, please rest assured!



Settings



4 Go settings turn on wifi



5 Connect to FOCUWAY-T5\*\*



6 Wait until FOCUWAY-T5\*\* ✓ appear



- 7 After agreeing to the location permission, click +
- 8 successfully connected
- 9 The second time you connected T5

1

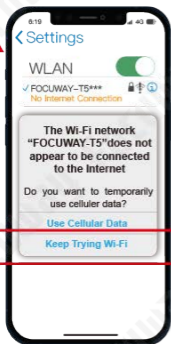

If you get this pop up for your iPhone while using WiFi feature, make sure to tap on "Keep Trying WiFi". Otherwise the camera will disconnected the WiFi and then you will have to forget the FOCUWAY-T5\*\*\* WiFi and then start to pair again for it work again.

2



If you get this pop up for your iPhone again and again even if you have connect to WiFi "FOCUWAY-T5\*\*", please check your app permission, allow the OKCAR to use your Wireless Data: Set this option to "WLAN" or "WLAN & Cellular". Also, location permission set to "While Using" Photos permission set to "All photos", OKCAR will just save videos or photos to your album, will not load irrelevant files!!!

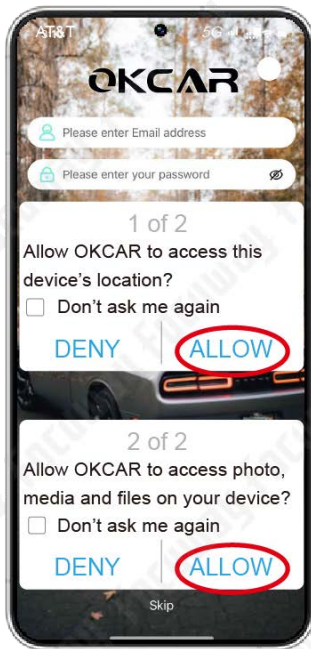

OKCAR

1

If you choose DENY, you will not be able to connect to and use the T5!!!

**FOCUWAY promises that the location information will only be used locally and will not be uploaded to the network, please rest assured!**

If you want to download T5 recorded videos or photos to your phone, or share them, you should accept "OKCAR" access photo..., otherwise the video will not be able to download to your phone.

**FOCUWAY also promises not to read any of your photos or video information, please rest assured!**

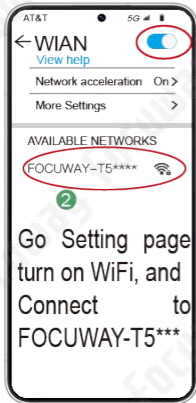

4 Wait for 1 minute, after  
pop up, click CONNECT

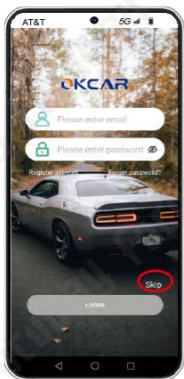

5 Skip login

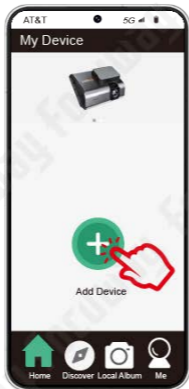

6 Add device



T5 Connect in this  
case, click icon to  
enter T5



Touch here as soon as you see this notification

Once you enter the default password for FOCUWAY WiFi and hit connect, you will see this pop-up in few seconds.

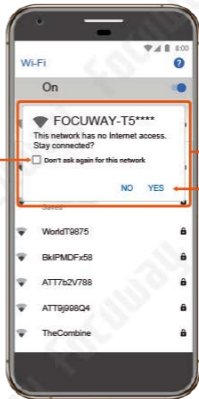

Once you tap that notification from the LEFT you will get this screen.

1.  Check this box, so your phone remembers this setting for next time.
2. Then touch **YES** to stay connected to this WiFi and save this preference.

There are extra steps you have to take when the first use. Once you connect the FOCUWAY-T5\*\*\* WiFi, your smartphone will prompt that 'No Internet'. Which is normal, wait about 10-15 seconds until you see the below pop up or notification. You just have to tap on the pop up notification that will show up in few seconds to select that you still want to stay connected even though there is No Internet. Once you select this OK, you are set to go. Please contact us if you need any help.

## 5 APP USING

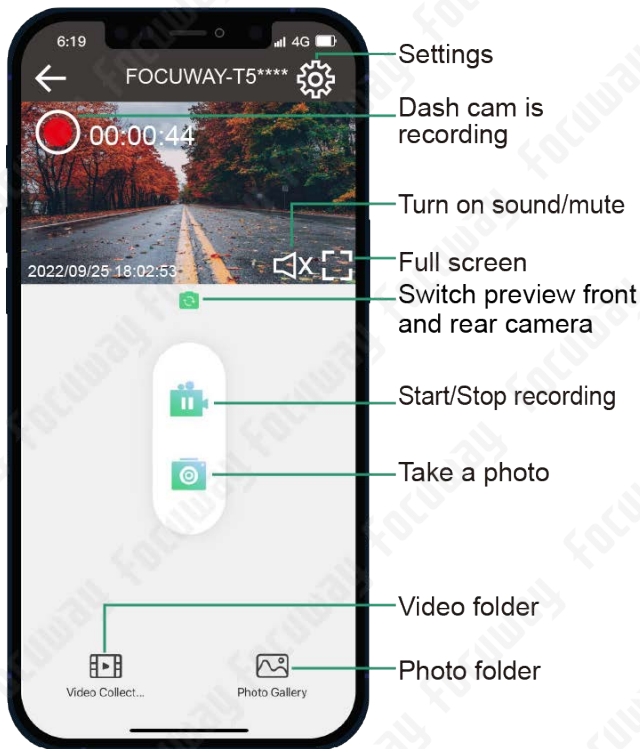

## Download videos + Trim video + Share

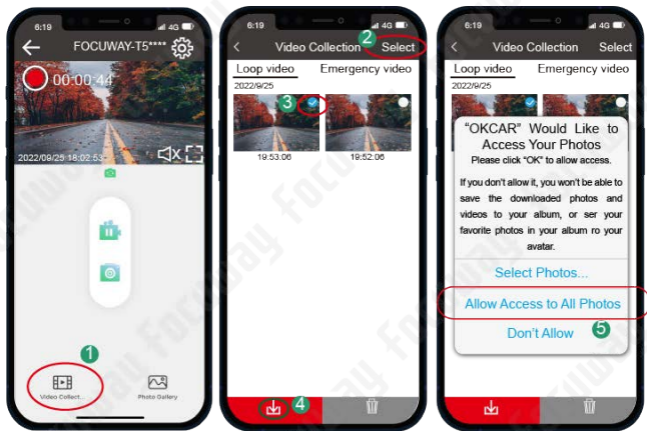

Before the video download is completed, please wait patiently, do not close the program or turn off the T5!!!

If you just want to preview videos, please click video to play by WiFi, and no need to download!



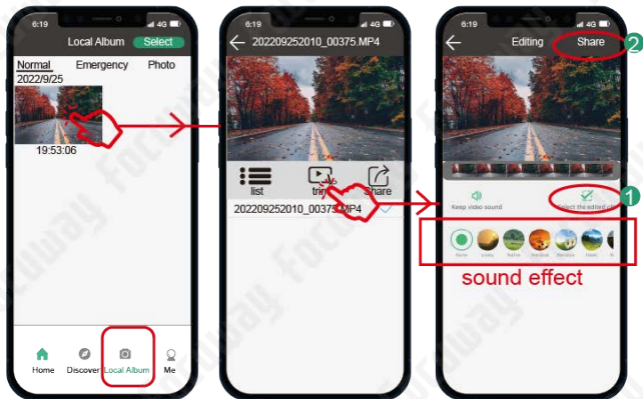

The downloaded file stored in "Local Album" Share after editing the video

On the video editing page, you can edit the duration of the video, keep or remove the original sound of the video, and add background music. When you have finished editing the video, click 'Select the edited clip' to finish the edited video and click "Share" at the top right to share the video with your friends, family or social media.

# OKCAR pages and functions

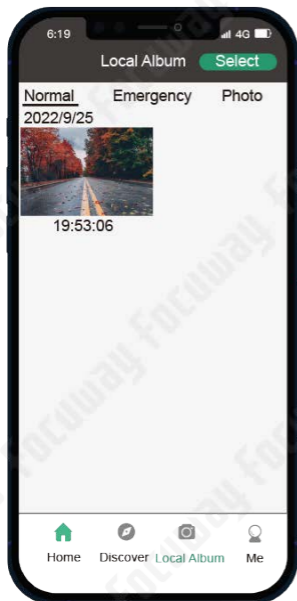

Home

Connect camera here



Discover

Get installation guide and warranty here



Local Album

Downloaded videos and photos are stored here

Emergency

Emergency videos, learn more about this, please go to page 28



Me

User account and app settings



T5 SETTINGS

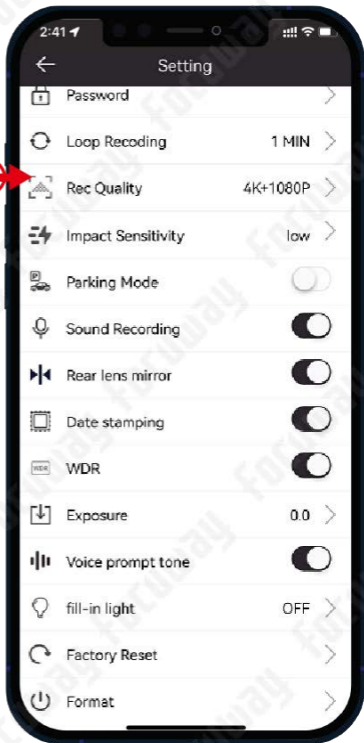

The camera comes with the default settings which allows you to start using your camera right out of the box without changing any settings.

## Password



Modify the WiFi password of the T5

## Looping Recording



This feature allows camera to continuously record loop by loop, so it can delete the oldest video files automatically when the memory card becomes full, then you don't have to manually delete them. But cannot overwrite locked videos. (When you set the loop recording to 3 minutes, each video is recorded in a loop for 3 minutes.) This feature will split each video to appropriate length based on your selection. Learn more about this, please go to page 27.

OFF  1MIN(Default)  3MIN  5MIN

## Impact Sensitivity



Impact Sensitivity is a 3-axis impact gravitational accelerometer which is designed to detect physical and gravitational forces on the camera. While Video is Being Recorded: In the event when

Impact Sensitivity is triggered due to physical or gravitational impact force on the camera, the current record video file will be locked so it will NOT be deleted by loop cycle function. Which is called **emergency lock**, learn more about this, please go to page 28.

OFF  LOW(Default)  MID  HIGH

## Parking Mode



**(This function requires a dash cam hardwire kit, please purchase it separately, learn more about using hardwire kit, please go page30 ).**

This feature is designed to work when camera is SHAKEN during Hit-&-Run event while your car is parked. When someone hits your car and shaking is detected based on your preset sensitivity, the camera Will turn ON automatically > then START recording for 30s > then lock that video file safely so it does NOT get deleted by loop cycle function & turns itself OFF automatically.

OFF(Default)  ON

Since T5 is adopted with Supercapacitor, it does not have in-built battery, the dash cam will automatically power off after the engine is off. If you want to use 24-hour parking monitoring function, please purchase the specific Type-C USB Hard Wire Kit separately.

## Sound Recording



This feature allows you to turn ON/OFF camera microphone. If you turn it off, the recorded video will have no sound. Audio is important evidence!



OFF



ON(Default)

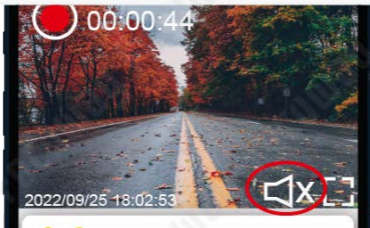

## Rear Lens Mirror



Switch the rear camera view in normal mode and mirror mode.



OFF



ON(Default)

## Date Stamp



This function can be set to add or remove the time watermark to the video/photo.



OFF



ON(Default)

## Time-lapse photography



Time-lapse photography and Parking monitoring are both solutions to protect the car while parked, so you can only choose one of these solutions to protect your car when parking. Both solutions require the purchase of FOCUWAY's voltage reduction cable to be used. Please refer to page 30 for information on how to purchase FOCUWAY's hard-wire kit.

When using the hardwire kit for power supply and enabling the "Time-lapse photography" feature, the dash cam will continue to work after the car engine is turned off. In this mode, the T5 dash cam will take photos at a rate of one frame per second and compress them into a video at 30 FPS. For example, for a 30-second parking time, it will only require 1 second of playback time in the recorded video.

**There are two benefits to this approach:**

Reducing the power consumption of T5 to prevent



draining your car battery.

Reducing the memory space occupied by 30 times for the same recording time, which helps prevent a large number of video clips from being overwritten by the loop recording function.

Voice prompt tone



This feature allows users to turn on or off the voice prompts of the T5 dash cam.



OFF



ON(Default)

Format



This function allows you to format the memory card of the T5 Dash Cam.



## BASIC FUNCTIONS OF T5

### 1 LOOP RECORDING

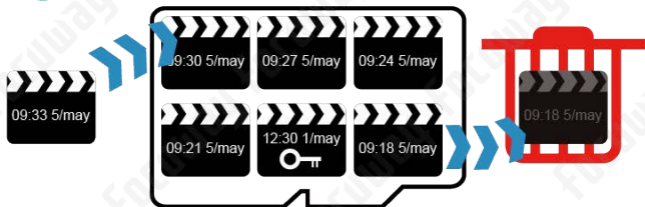



Due to the limited capacity of the SD card, when the SD card is full, the latest recorded video will replace the oldest recorded video.

But if the video file was locked , it will be kept in the SD card and can never be overwritten unless you format the SD card. **We recommend to format the Micro-SD card every month.**

T5 will help you to automatically lock the files by emergency lock. Learn more about this, please go next part!

## 2 EMERGENCY LOCK



T5 dash cam has a built-in Impact Sensitivity . When the car vibrates or suffered a crash, the built-in gravity sensor will obtain this information and automatically lock the video recorded during the crash.

When emergency lock happens, the T5 will remind you by voice :  "Emergency recording start!"



This two conditions can also cause emergency lock (we call it false lock), to reduce false locking, please set the Impact Sensitivity to "low".

! Despite this, false locks are unavoidable, so you'll need to periodically format the SD card, Otherwise, wrongly locked files will accumulate and fill up the memory card (learn more about why this happened, please go to page27 , loop recording section), resulting in failure of loop recording.

### 3 PROTECT WHEN PARKING

There are two working modes that can ensure maintains surveillance while parking: Parking monitoring and Time-lapse photography.

**However, both of these modes require the additional purchase of Focuway's hardware kit in order to function!!!**

## How it works:

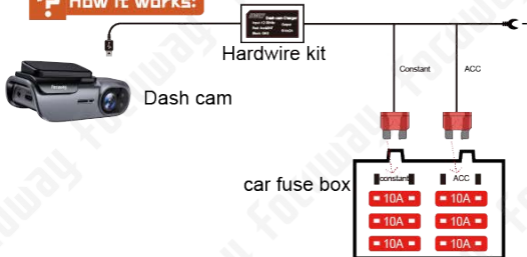

## 1. Purchase the FocuWay hardwire kit

Enter the link or scan the code with the amazon app

<https://www.amazon.com/dp/B0BG5DM5CL>



## 2. Parking monitoring



If you activate the parking monitoring, the G-sensor will remain active. If the car experiences vibrations, the T5 dash cam will automatically activate and record a 30-second

video. This video will serve as evidence and the file will be locked.

Following the 30-second emergency recording, the T5 will automatically power off and await the next vibration.

### 3. Time-lapse photography

There is a detailed introduction of this function on page 26, please check back.

## 4 VOICE CONTROL

You can use voice commands to control the functions of the T5 dash cam.

**Please note:** When using this feature, please ensure that the vehicle's interior is quiet, speak slowly and clearly when giving voice commands. Otherwise the system may not accurately capture the instructions.

Below are the key phrases for voice control:

Key phrases	Function explanations
Take photo	T5 will take a photo immediately
Lock the video	The T5 will lock the currently recorded video as crucial evidence, preventing it from being overwritten during loop recording. Unless unlocked or the memory card is formatted, that video segment will persistently remain.

## 5 PREVIEW / DOWNLOAD RECORDED VIDEO

### PLAY BACK ON APP

Please refer to page 19 , section of APP USING

### PLAY BACK ON COMPUTER

Export by card adaptor



Please disconnect the power connection of the T5 before removing the SD card.

SD card got very hot, please wait 1 minute before removing

SD Card File Hierarchy:

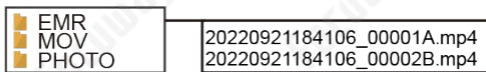

EMR: Emergency recording video

MOV: Video file      PHOTO: Photo file

\*\*\*\*A.mp4 (Front camera)

\*\*\*\*B.mp4 (Rear camera)

We recommend to use VLC player, you can get it free from:



**Download VLC Player here:**

<http://www.videolan.org/>



## TROUBLE SHOOTING

Camera keeps saying " abnormal or no storage card". Even though inserting an sd card or formatting it in the settings.

Make sure you are using the recommended, Samsung or Kinston CLASS 10, U3 Speed, 32GB-256GB, otherwise you will get notice of a malfunction or inserted improperly.

### Keep saying format SD card

All the new SD CARD requires to be formatted in OKCAR App. Please go to OKCAR APP→ Connect Recording Interface→Camera setting Settings→Format SD Card.

The app keeps pops up the prompt "kind reminder Please connect the Wi-Fi camera", I can't enter T5

Check if you have connect to WiFi "FOCU-WAY-T5\*\*\*", if not, please connect it in phone system setting.



Because T5's WiFi cannot connect to the Internet, Your phone will automatically switch to other available WiFi after a while.

## Can't view live video on the APP

The cellular data will cause the live feed not to be viewed. Please disable the "OKCAR" cellular data of your cellphone.



### Latest IOS System

- 1 Go Setting
- 2 Scroll down to find "OKCAR"
- 3 Wireless Date "WLAN"

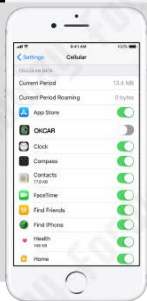

### Older IOS System Way1

- 1 Go Setting
- 2 Scroll down to find "OKCAR"
- 3 Disable "Cellular Date"

### Way2

- 1 Go Setting
- 2 Cellular Date
- 3 Scroll down to find "OKCAR", disable it

## Can't find FOCUWAY-T5xxx Wifi?

There may be several reasons why your dash cam is not working properly, such as insufficient power supply or lack of support for 5GHz network on your Android device. To troubleshoot the issue, follow these steps:

1. Check if the dash cam is powered on correctly:

1) Ensure that you are using the original car charger to power on the dash cam. If you use a USB cable to connect the dash cam to your PC or a mobile phone charger to power on the dash cam at home, the voltage may not be enough to power it on properly.

2) Listen for the voice prompt while the dash cam is turning on. You should first hear "Starting UP," and about 10-15 seconds later, "Recording Start." At the same time, the green indicator in the reset hole should be flashing. If you don't insert a TF card, you should hear "Starting UP" and "Please insert memory card," and the green indicator should be solid.

If your dash cam powers on correctly, check the



following:

### 3) Check your WLAN network agreement:

You can check your WLAN network agreement by accessing your phone settings and selecting the "About My Phone" option. Alternatively, you can also visit your mobile phone brand's official website to check the WLAN network agreement. Please note that only WLAN network agreements that support 802.11ac or 802.11a/b/g/n/ac Dual-band wireless networks can access 5GHz WiFi.

### 4) If your phone only supports 2.4GHz WiFi after verification, switch the T5 WiFi to 2.4GHz:

Press the POWER button to stop recording. Once you hear the "Recording Stop" voice, press the POWER button three times continuously. You should hear the voice prompt, "WiFi switch to 2.4GHz."

If you still cannot find the dash cam WiFi, please send an email to us at [support@focuway.com](mailto:support@focuway.com).

## Connect the WiFi successfully, but App does not recognize it?

1. Please uninstall the APP, and forget the dash cam WiFi first.
2. To ensure successful connectivity, please follow these steps in order: Download the OKCAR app >> open App, click the add button >> automatically switch to the cell phone wifi list >> connect to the wifi >> select 'Always Connect' when prompted by your phone's WLAN settings >> finally return to the app, which will automatically recognize the name of the wifi.
3. Please download the App “viidure” to try out.

## Connect the WiFi successfully, but the App is stuck and shows 'Buffering'?

### Connect the App successfully, but the App does not show live image, just black screen?

1. This issue is always caused by the fail connection between the App and dash cam wifi, please forget the dash cam wifi on the wifi list, exit the OKCAR App, restart the dash cam, then reconnect the dash cam wifi (if you have a Android phone,

please select '**Always Connect**' when prompted by your phone's WLAN settings, if you have an iPhone, please turn off the Cellular Data first)

2. Download the App “**viidure**” to try out.

3. Both Apps can't be used on your phone, this is caused by the dash cam app compatibility with your cell phone, please find the **Feedback** function on the OKCAR App and report this issue, send email to us : [support@focuway.com](mailto:support@focuway.com), we can address the compatibility issue for you immediately.

### Can't delete the Loop Recording files?

1. The emergency videos can't be deleted

2. If you failed to delete the loop record videos, please make sure the sd card you are using is from us or the recommended SAMSUNG sd card.

3. Email us to get a new memory card:

[support@focuway.com](mailto:support@focuway.com)

### Automatically disconnected while use?

1. Please confirm if there are no available WLANs that can access the internet close to your dash cam. The dash cam's WiFi has lower priority com-

pared to other WLANs that can access the internet. If there are any, please forget the available WiFi on your cellphone.

2. If you're using an iPhone, please turn off Cellular Data first as it may occupy the dash cam's WiFi data channel.

### Video play failed?

1. This issue is always caused by the sd card is too low, change a new high-speed sd card will solve this issue immediately. Or you can export the video from the sd card to your computer to check (If the sd card can't be read by your PC, you need to replace the card)

2. Email us to get a new 64GB U3 sd card, or buy the recommended SAMSUNG SD card on the Amazon.

### How to playback the video on your PC?

Your computer system player may not be compatible with the dash cam video file format, please download the VLC player or the Pot Player to playback the videos.

**Download VLC Player here:**

<http://www.videolan.org/>



When insert a new sd card and power on the dash cam, it says 'Card full'?

1. This issue is caused by the dash cam can't recognize the sd card format, so please get into the SETTINGS of the App and find the 'format' function to format the new sd card, then you can use it well.
2. Still has the problem, please email us to get a new 64GB TF card: [support@focuway.com](mailto:support@focuway.com)

## Still Need Help or Have Questions?

Please feel free to contact our world class support Email:

Scan the QR Code to Email US  
or send us: [support@focuway.com](mailto:support@focuway.com)

