

HOTEL EMPORIUM

# SNAP DISPENSER INSTALLATION GUIDE

REFILLABLE / 300ML e 10 FL OZ

SINGLE UNIT DISPENSER SIZE: 60 L x 35 W x 237.5 H (mm)

DOUBLE UNIT DISPENSER SIZE: 140 L x 35 W x 237.5 H (mm)

TRIPLE UNIT DISPENSER SIZE: 220 L x 35 W x 237.5 H (mm)

MATERIAL: PE Bottle & Bracket

INFO: Tamper-Resistant Bracket



# SNAP DISPENSER INSTALLATION GUIDE

## PARTS INCLUDED IN INSTALLATION KIT

(SHAMPOO, CONDITIONER, & BODY WASH ARE NOT INCLUDED)



WALL ANCHORS

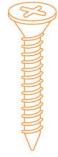

SCREWS



3M TAPE



KEY



CONNECTOR

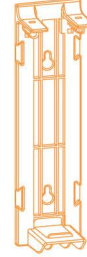

MOUNTING BACKPLATE

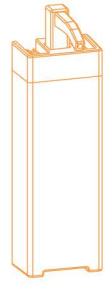

300ML DISPENSER

## RECOMMENDED PLACEMENT GUIDE

BELOW OR OPPOSITE OF THE SHOWER HEAD

(NOT TO SCALE)

To ensure optimal product performance and to maintain the quality of the liquids dispensed, we recommend installing the dispensers according to the recommended placement. This minimizes the risk of water entering the dispenser while pumping the product.

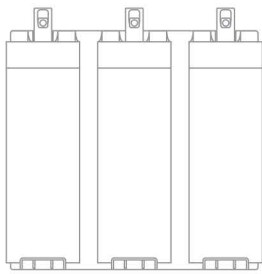

Triple Bracket Configuration

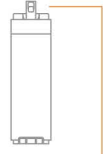

ADA COMPLIANT  
48in max  
(121.9cm)

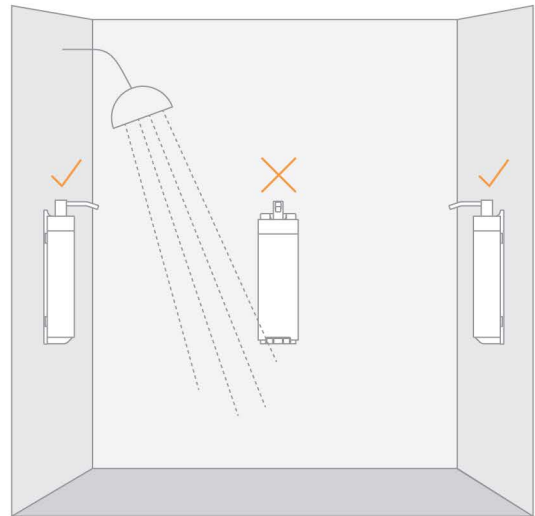

## RECOMMENDED TOOLS



ALCOHOL WIPE



LEVEL

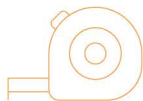

TAPE MEASURE



PENCIL



HAMMER

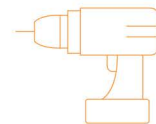

POWER DRILL



CAULK

## ADDITIONAL INFO

**Do not use a corrosive detergent.**

**Use a soft damp cloth, warm water, and mild cleaner to clean bottles and brackets.**

**To deep clean, remove dispensers and fill them with warm soapy water. Rinse and pump until water has been emptied. Air dry completely before refilling liquid and reassembling the dispenser.**

**Recommended installation is mounting bracket with both screws and tape.**

*Disclaimer: Hotel Emporium is not responsible for contamination of bacteria growth in dispensers due to infrequent and/or improper cleaning.*

# SNAP DISPENSER INSTALLATION GUIDE

1



**Clean surface thoroughly with alcohol wipe.**  
Make sure surface is fully clean and dry before installation.

2

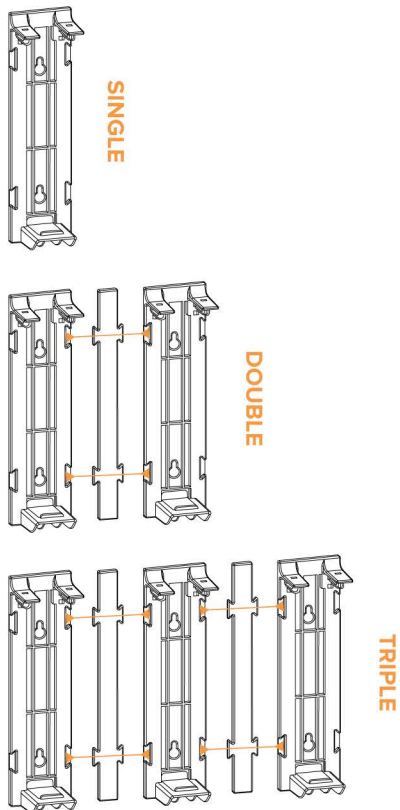

Before installation, use the connectors to combine the mounting backplates if you are using a multiple dispensers.

3

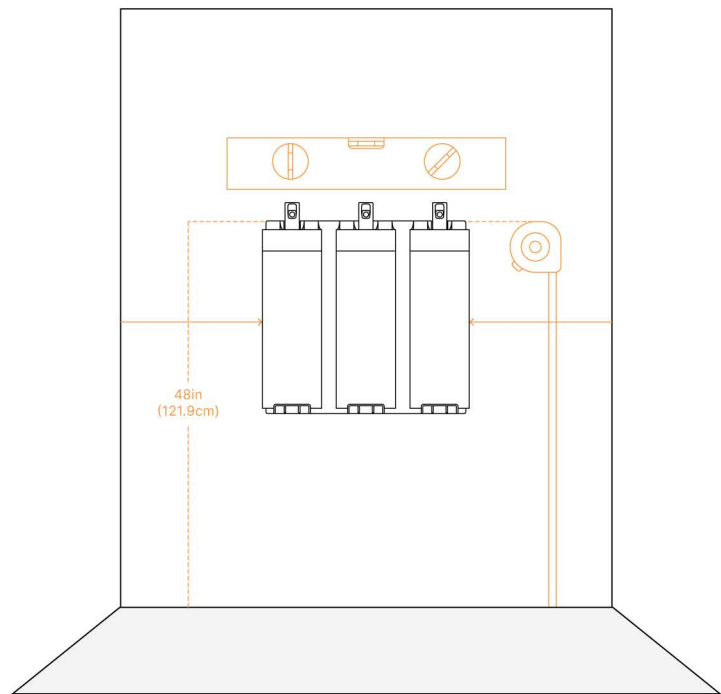

Determine the proper placement of dispenser using the backplate and make sure it is level. Recommended height is 48" from the floor to the pump of the dispensers.

4A

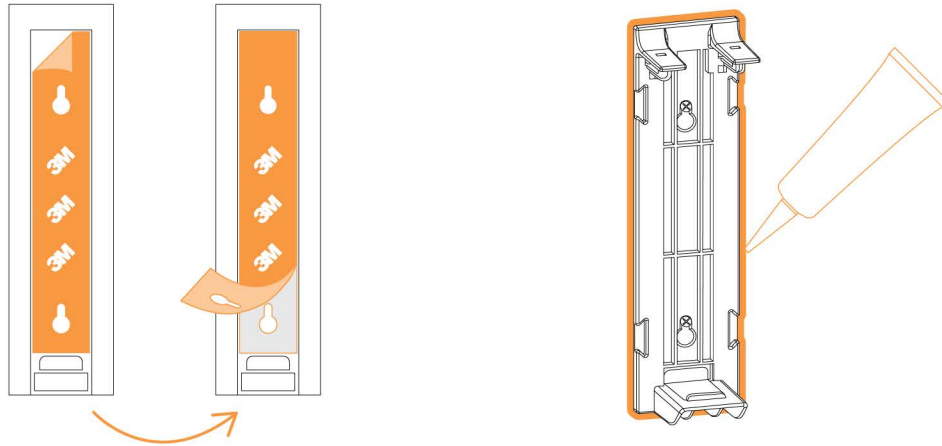

**Tape Installation**

1. For tape installation, clean back of the mounting backplate then adhere the double sided 3M mounting tape to the backplate. Peel film off.
2. Press backplate firmly onto the wall for 30 seconds until it is secured.
3. **Place a line of adhesive caulk** around the bracket to prevent water and grime from getting behind the bracket. Wipe away any excess caulk. **Wait 72 hours** before inserting the bottles to allow tape to securely set.

4B

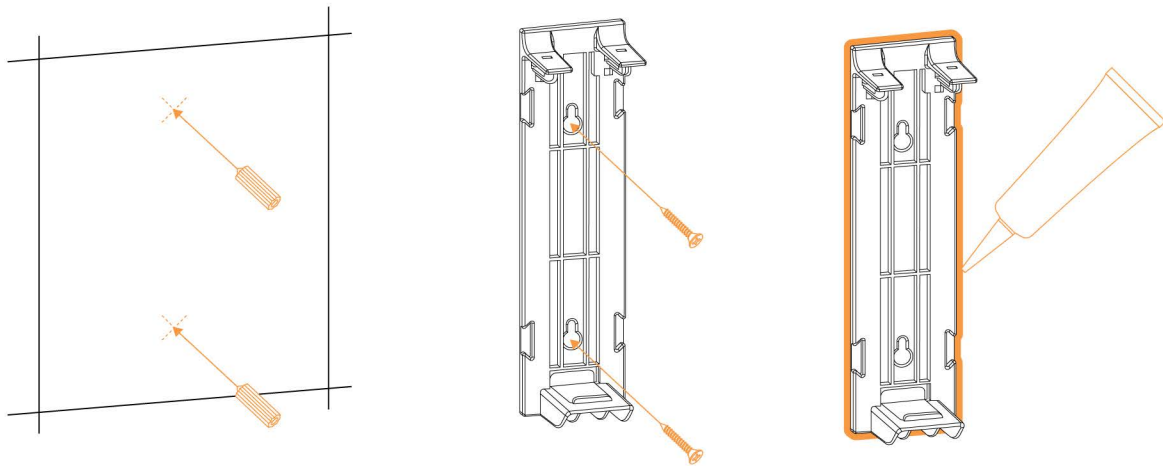

**Screw Installation**

1. For screw installation, use the mounting backplate to mark the bracket holes on the wall. Drill bracket holes into the wall.
2. Insert wall anchors with your hands, then use a hammer to tap anchors flush into the wall.
3. Insert screws partially into the anchors, then place backplate into position on the wall. Tighten screws in place.
4. **Place a line of adhesive caulk** around the bracket to prevent water and grime from getting behind the bracket. Wipe away any excess caulk. **Wait 24 hours** for caulk to dry.

5

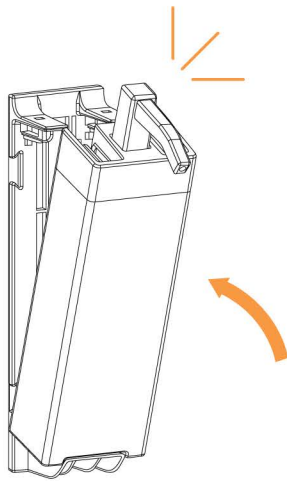

Place bottom of the dispenser on the mounting backplate and push the dispenser in until it snaps into position.

**Dispenser is now ready to use!**

6

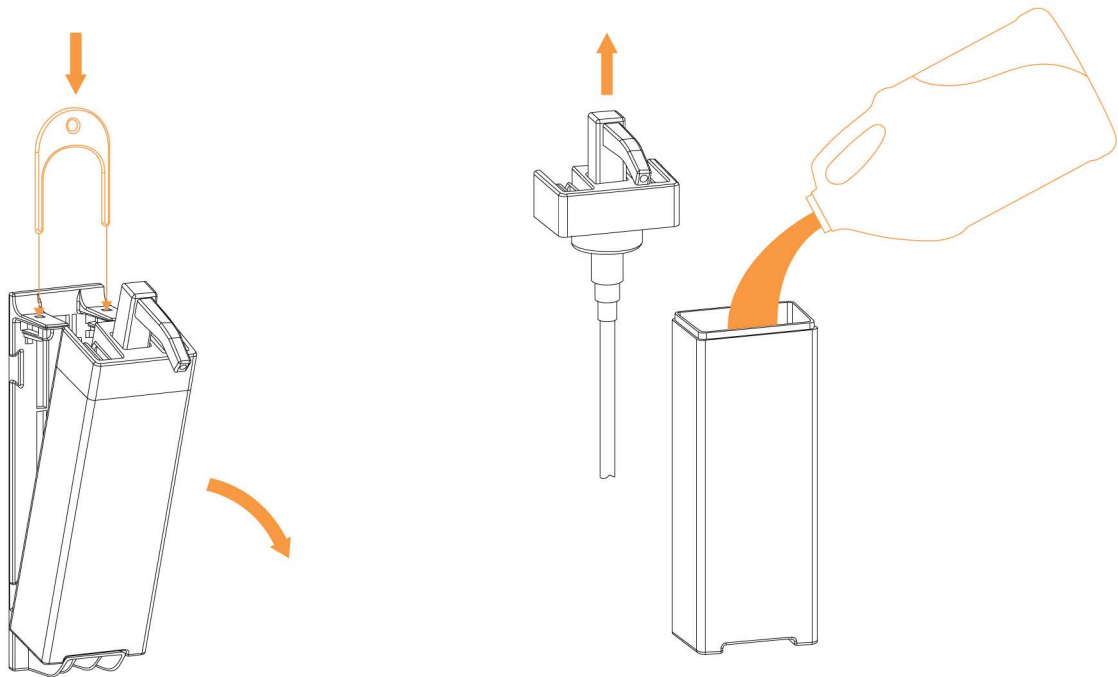

## **How To Refill Dispensers**

To refill dispensers, insert key into the keyhole at the top of the dispenser and push key to release the dispenser.

Pull dispenser out and pull pump cap off. Refill the bottle to the desired amount. Reassemble pump cap back onto the bottle, then snap the dispenser back into place.

## SNAP DISPENSER INSTALLATION SCREW GUIDE

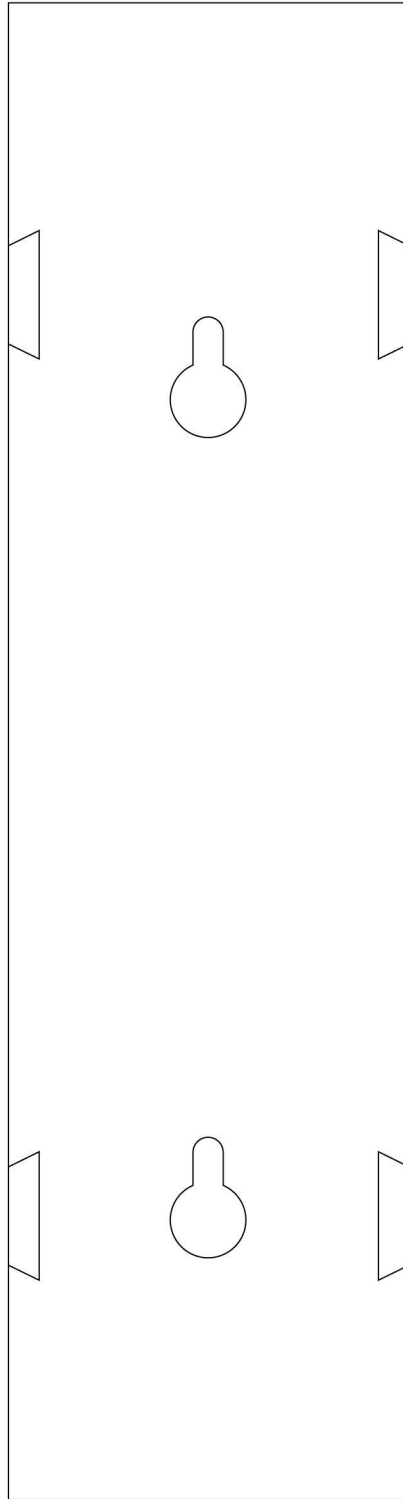

11" X 8.5" PAPER (LETTER SIZE)  
TEMPLATE IS ACTUAL SIZE  
PRINT AT 100% SCALE  
SCALE 1:1

1. Use template for dispenser placement.
2. Mark screw holes and remove template.
3. Drill holes and insert wall anchors.
4. Mount backplate with screws.



SEE VIDEO DEMO