

HOTEL EMPORIUM

# EDISON DISPENSER INSTALLATION GUIDE

NON-REFILLABLE / REFILLABLE  
500ML e 16.9 FL OZ

DISPENSER WITH BRACKET: 72 L x 67 W x 240 H (mm)

MATERIAL: PET Bottle & Stainless Steel Bracket

INFO: Tamper-Resistant Bracket



# EDISON DISPENSER INSTALLATION GUIDE

## PARTS INCLUDED IN INSTALLATION KIT

(SHAMPOO, CONDITIONER, & BODY WASH ARE NOT INCLUDED)

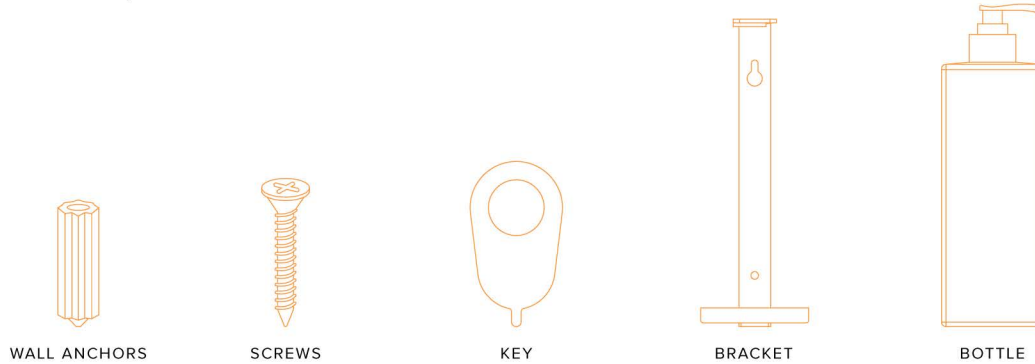

## RECOMMENDED PLACEMENT GUIDE

ON THE BACK WALL, OPPOSITE OF THE SHOWER HEAD  
(NOT TO SCALE)

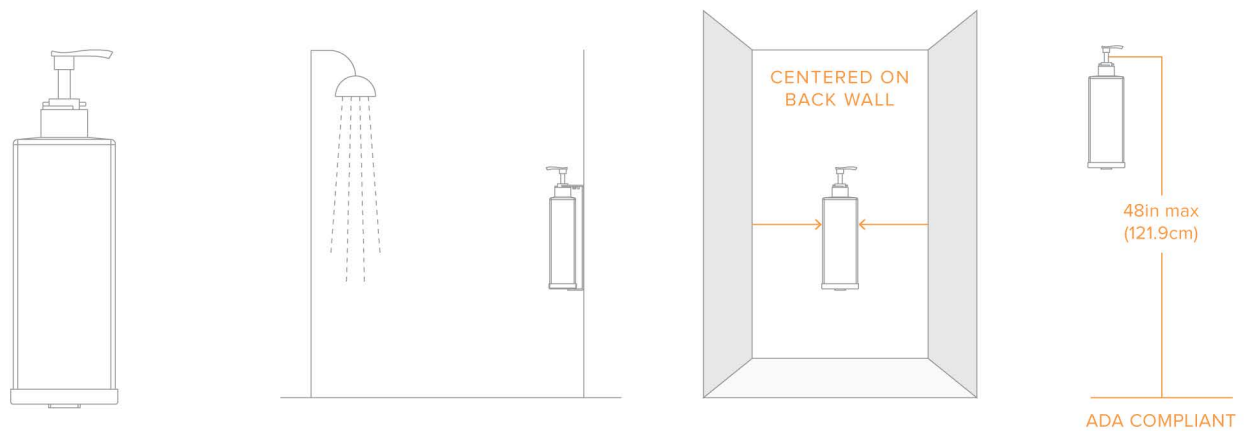

## RECOMMENDED TOOLS

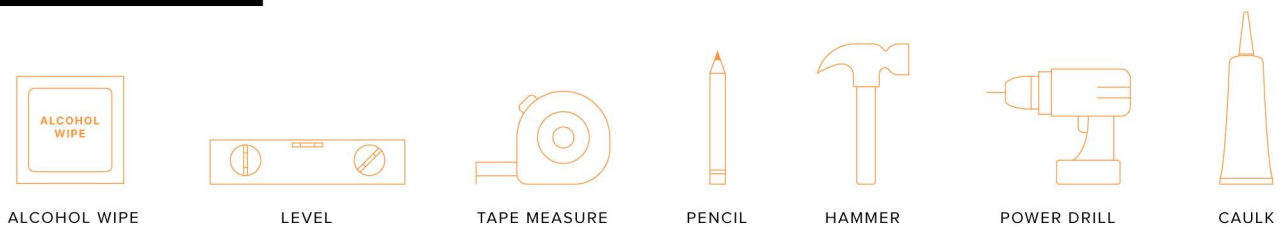

## ADDITIONAL INFO

**Do not use a corrosive detergent.**  
**Use a soft damp cloth, warm water, and mild cleaner to clean bottles and brackets.**  
**To deep clean refillable dispensers, remove bottles and fill them with warm soapy water. Rinse and pump until water has been emptied. Air dry completely before refilling liquid and reassembling the dispenser.**

*Disclaimer: Hotel Emporium is not responsible for contamination of bacteria growth in dispensers due to infrequent and/or improper cleaning.*

## EDISON DISPENSER INSTALLATION GUIDE

1



**Clean surface thoroughly with alcohol wipe.**  
Make sure surface is fully clean and dry before installation.

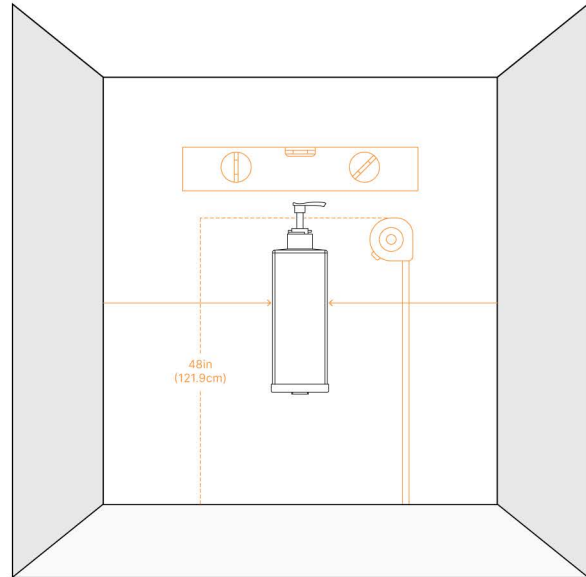

Determine the proper placement of dispenser using the bracket and make sure it is level. Recommended height is 48" from the floor to the pump of the dispensers.

2

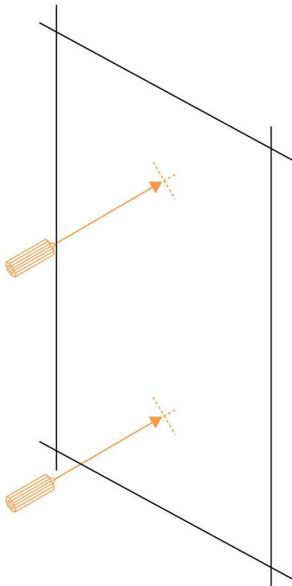

1. Use the bracket or template to mark the bracket holes on the wall. Drill the bracket holes into the wall.
2. Insert wall anchors with your hands, then use a hammer to tap anchors flush into the wall.

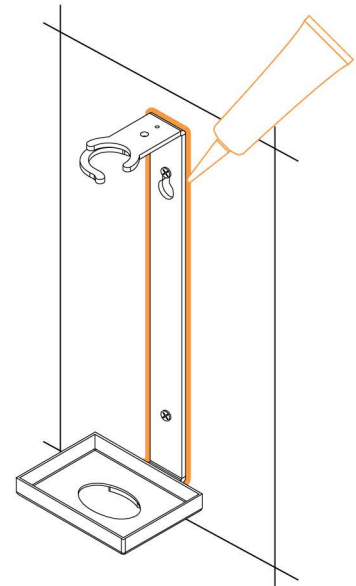
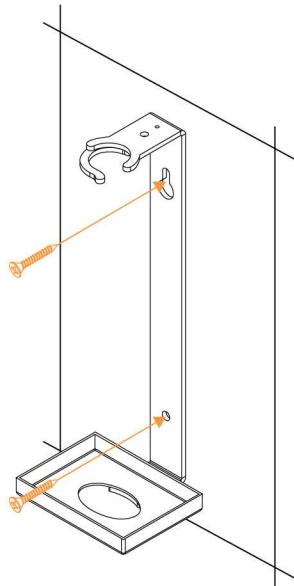

3. Insert screws partially into the anchors, then place the bracket into position on the wall. Tighten screws in place.
4. **Place a line of adhesive caulk** around the bracket to prevent water and grime from getting behind the bracket. Wipe away any excess caulk. **Wait 24 hours** for the caulk to dry.

3

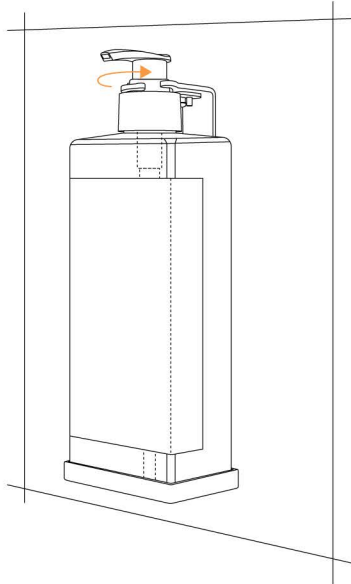

Place bottle into the open bracket.  
Close the neck hinge to lock the bottle in place.

**Dispenser is now ready to use!**

4

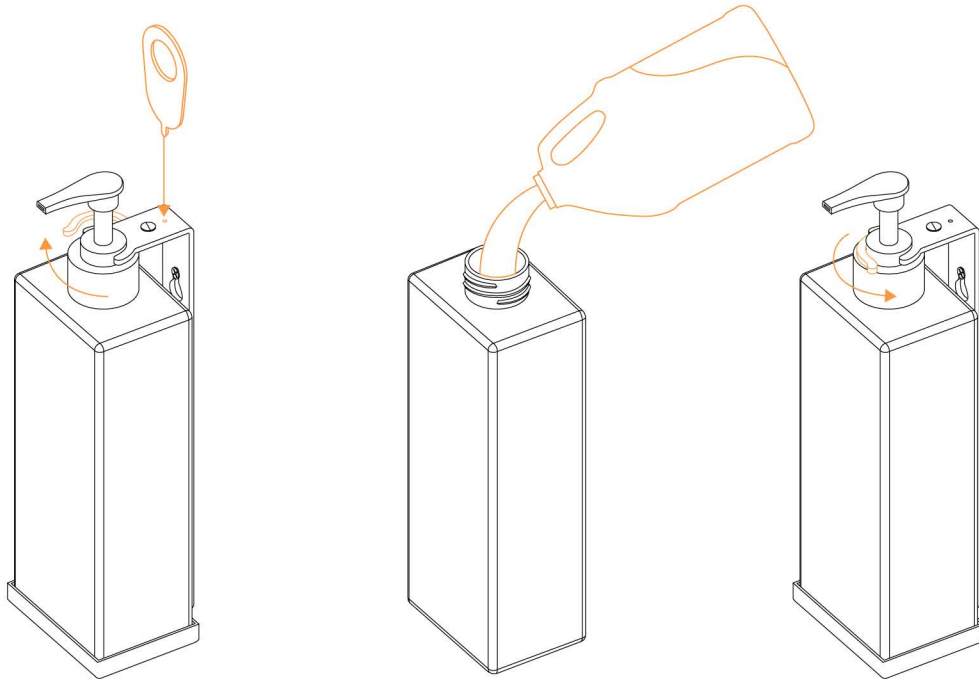

## **How To Replace or Refill Dispensers**

Unlock the bracket by inserting the key into the keyhole at the top of the bracket. Push key in to open the neck hinge to the left. Remove the empty bottle and replace with a new bottle.

-or-

Pull the bottle out and remove the pump cap. Refill the bottle to the desired amount. Reassemble pump cap back onto the bottle, then place the bottle back onto the bracket. Close the neck hinge making sure it is locked.

## EDISON DISPENSER INSTALLATION SCREW GUIDE



11" X 8.5" PAPER (LETTER SIZE)  
TEMPLATE IS ACTUAL SIZE  
PRINT AT 100% SCALE  
SCALE 1:1

1. Use template for dispenser placement.
2. Mark screw holes and remove template.
3. Drill holes and insert wall anchors.
4. Mount bracket with screws.