

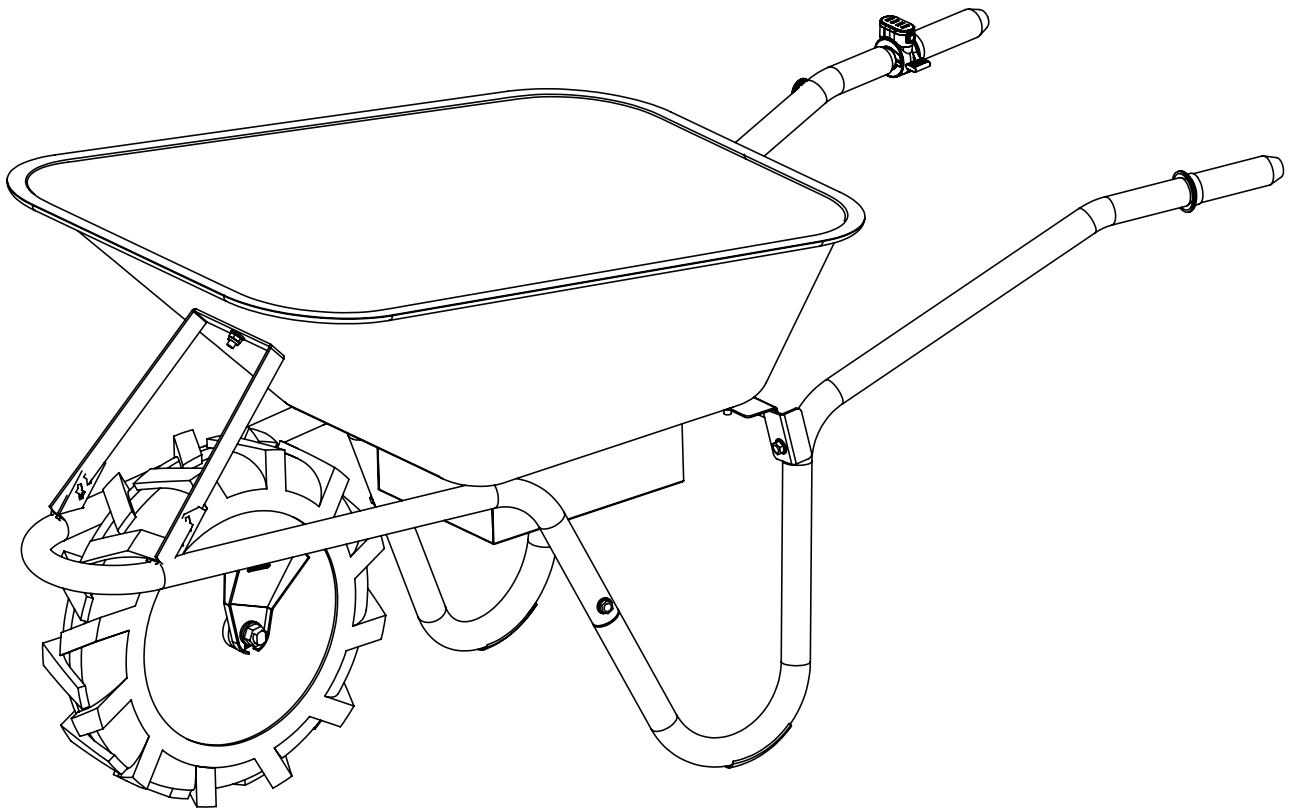

# 24V Power Barrow

## Operator's Manual

---



---

**WARNING:**

Read carefully and understand all **INSTRUCTIONS** before operating. Failure to follow the safety rules and other basic safety precautions may result in serious personal injury. Save these instructions in a safe place and on hand so that they can be read when required. Keep these instructions to assist in future servicing.

---



EC-CONFORM: This product complies with EC-directives.



Protect from rain, splashing!



READ THE MANUAL! Read the user and maintenance manual carefully and get familiar with the controls in order to use the machine correctly and to avoid injuries and machine defects.



Protective clothing!



No smoking, no naked flames, no sparks.



ATTENTION! Ignoring the safety signs and warnings applied on the machine as well as ignoring the security and operating instructions can cause serious injuries and even lead to death.



Corrosive (Battery acid).



Explosive gas.

## 1. SPECIFICATIONS

Item No.	GUO087
Rated Voltage	24V DC
Battery Capacity	12Ah
Motorpower	500W
Max Speed	4.3MPH/ 7KM/H
Wheel Diameter	16Inch/ 410mm
Max. Load Capacity	330lbs/ 150kgs
Max. Cubage	2.65 cubic feet

## 2. COMPONENTS

P. N	Descriptions
1	Frame
2	Motor Wheel
3	Battery Box
4	Handle Grip
5	Motor Control Element
5a	Battery Capacity Indicator
5b	Start-button E-support
6	Tray
7	Shut-down Button
8	Plug For Battery Charging Cable

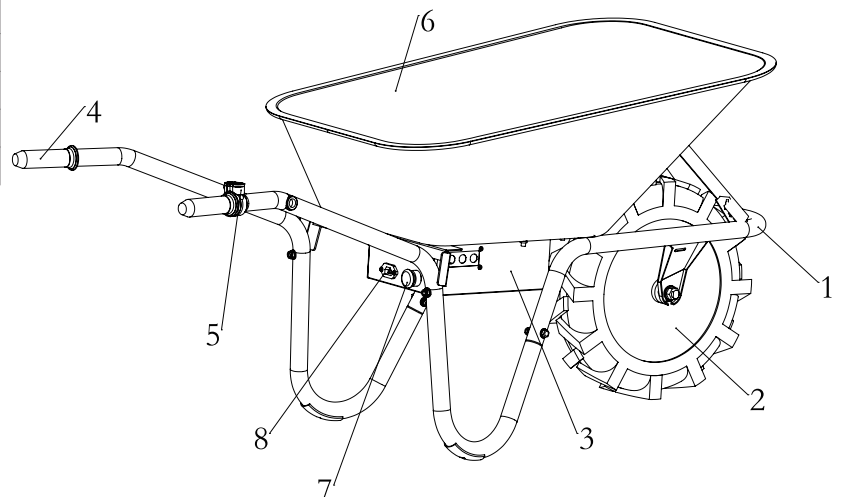
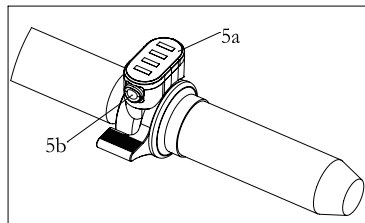

### 3. DELIVERY CONTENT

P. N	Descriptions	Q'ty
1	Motor Wheel + Line And Plugs	1
2	Frame	1
3	Left Handle	1
4	Right Handle With Motor Control Element + Line And Plug	1
5	Support	1

P. N	Descriptions	Q'ty
6	Front Support	1
7	Tray	1
8	Standard parts package	1
9	Charger	1
10	Battery Box System	1

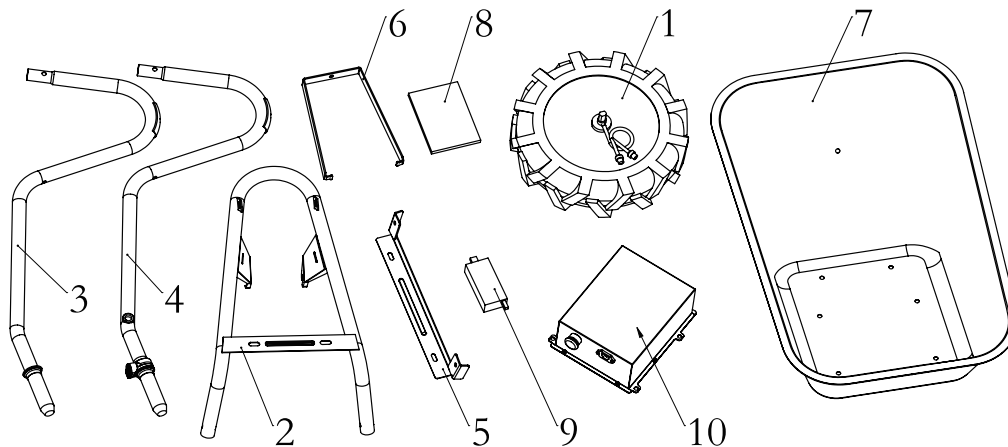

### 4. NOTICE

This manual contains important information and advice for the correct and safe use and maintenance of the electric wheelbarrow.

Following the usual commercial name of the device (see cover) is substituted in this manual with the name "machine".

The manual is part of the machine and may not be stored separately. Read it profoundly before first use of the machine and keep it for later reference. When the machine is handed to other persons always put the manual to the machine.

#### Please follow the security instructions!



Please read the entire manual, to prevent misunderstandings, machine damage or even injuries! Due to continuous development of our products illustrations, pictures might differ slightly. If you however find errors in this manual, please inform us (1-866-493-0524).

### 5. SAFETY

#### 5.1 Intended Use

The machine must only be used for its intended purpose! Any other use is deemed to be a case of misuse.

To use the machine properly you must also observe and follow all safety regulations, the assembly instructions, operating and maintenance instructions lay down in this manual.

All people who use and service the machine have to be acquainted with this manual and must be informed about the machine's potential hazards.

The machine is used for: Transportation of goods within the maximum permissible load capacity.

#### **⚠ WARNING**

The removal or modification of the safety components may result in damage to equipment and serious injury!  
**HIGHEST RISK OF INJURY!**

**Ambient conditions**

The machine may be operated:

Humidity max.70%

Temperature +5°C to +40°C (+41°F to + 104°F)

The machine, especially the battery; may not be exposed to a temperature of about 80 °C. Do not store in the blazing sun or a long time in the trunk of a car.

**Prohibited use:**

The operation of the machine outside the stated technical limits described in this manual is forbidden.

The operation of the machine without provided protective devices is prohibited.

The use of the machine not being suitable for the use of the machine and not being certified is forbidden

The use of the machine not according with the required dimensions is forbidden.

Any manipulation of the machine and parts is forbidden.

The use of the machine for any purposes other than described in this user-manual is forbidden.

It is not allowed to leave the immediate work area during the work is being performed.

**5.2 Security Instructions**

Missing or nonreadable security stickers have to be replaced immediately!

The locally applicable laws and regulations may specify the minimum age of the operator and limit the use of this machine!

To avoid malfunction, machine defects and injurie, read the following security instructions

**GENERAL:**

Use the machine only in good enough light to allow a safe operation can be guaranteed.

In tiredness, decreased concentration or under the influence of alcohol or drugs, the work on the machine is prohibited!

Caution in slippery conditions - slip hazard - risk of injury. When working, robust and non-slip footwear. Slides / stumble / traps are a major cause of serious injury or death.

The machine must be operated only by trained persons (knowledge and understanding of this manual), which have no limitations of motor skills compared with conventional workers.

Keep the machine in use with both hands.

Unauthorized persons, especially children and not trained personnel must be kept away from the running machine!

If you pass the machine to third, these instructions must be attached to the machine.

Before the start, after the failure or shock, be sure to check the device and make sure that it is in good condition

Take special care when work near swimming pools or garden ponds.

Never use the machine when it is raining or in damp, wet areas Unplug battery before all maintenance and settings!

**CHARGER:**

The charger is designed exclusively to charge the battery of this machine. Charging other battery is not permitted.

Never use the charger in a damp or wet environment

Disconnect cable connections only by pulling the plug. Pulling on the cable could damage the cable and plug and electrical safety would no longer be guaranteed.

Never use the charger if the cord, plug or the appliance itself is damaged by external influences. Attach the charger then to the next workshop.

DO not use the unit near heat sources.

Do not use extension cord to supply power to the charging station.

DO not place metal objects in the area of the charging contacts of the charger.

DO not open the charger. In case of failure, contact a specialist workshop.

Use to recharge your battery only with the original charger. Use of other charger defects may occur or fire hazard.

**BATTERY:**

Improper use or the use of damaged batteries leaking vapors. Run to fresh air and seek medical attention in case of complaints. The vapors can irritate the respiratory tract.

FIRE HAZARD! Never charge batteries near acids and flammable materials.

Charge the battery only in an ambient temperature between 0°C to +40°C. Leave to cool down after heavy load.

EXPLOSIVE! Protect the battery from heat and fire.

Use the battery only in an ambient temperature between 0°C to +45°C.

SHORT CIRCUIT! For disposal, transport or storage, the battery must (plastic bag, box) or the contacts are packed must be taped.

Never open the battery.

### 5.3 Remaining Risk Factors

Despite intended use, certain residual risks remain. Due to the design and construction of the machine, hazardous situations may occur which are identified as follows in these operating instructions:

#### **⚠ DANGER**

A safety instruction designed in this way indicates an imminently hazardous situation which, if not avoided, will result in death or serious injury.

#### **⚠ WARNING**

Such a safety instruction indicates a potentially hazardous situation which, if not avoided, may result in serious injury or even death.

#### **⚠ CAUTION**

A safety instruction designed in this way indicates a potentially hazardous situation which, if not avoided, may result in minor or moderate injury.

#### **NOTICE**

A safety note designed in this way indicates a potentially dangerous situation which, if not avoided, may result in property damage.

Irrespective of all safety regulations, your common sense and your corresponding technical suitability/training are and, will remain the most safety factor for error-free operation of the machine. Safe working depends and foremost on you.

## 6. ASSEMBLY

Please check the product contents immediately after receipt for any eventual transport damage or missing parts. Claims from transport damage or missing parts must be placed immediately after initial machine receipt and unpacking before putting the machine into operation. Please understand that later claims cannot be accepted anymore.

### 1. Frame assembly

Install the frame (A) together with the left handle (B) and the right handle (C), fix them with two bolts M8\*45 (D) and nuts (E); and then install the support (F) on the handle, fix them with two bolts M8\*50 (G) and nuts (E).  
Note: leave all nuts a little loosening, in order to easily mount other components on the frame.

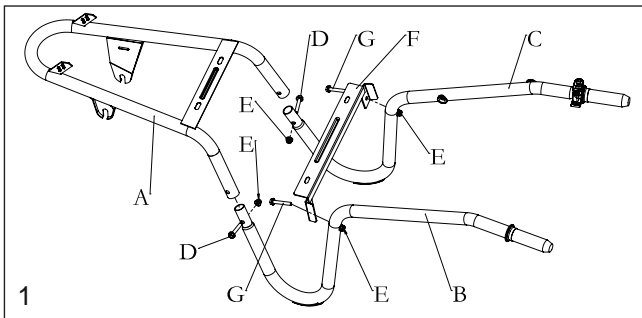

### 2. Wheel assembly

Place the motor wheel (B) as shown in the figure. Note: the line and plugs (F) are on the position same as photo. Firstly, install two washers (A) on both sides of the motor wheel (B), which are in the inner sides of the frame (C). Secondly, mount the motor wheel (B) to the frame (C). Thirdly, install two washers (D) and nuts (E) on both sides of the motor wheel (B). Install and fix the nuts (E) on the outer side of the frame (C).

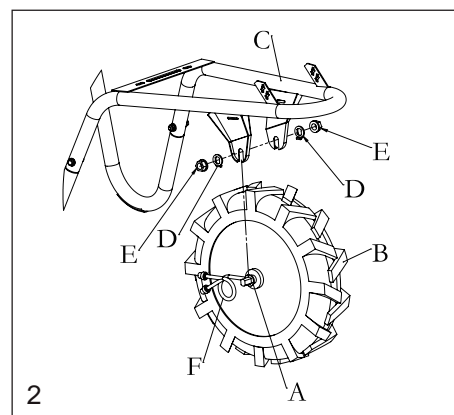

### 3. Battery box assembly

Install the battery Box System (A) onto the tray (B) and fix it with four bolts M8 \* 20 (C) and nuts (D).

### 4. Assembly tray onto frame

Install the tray (A) on the frame (B), fix it with four bolts M8 \* 20 (C) and nuts (D), then install the front support (E) on the frame (B) and tray (A), fix it with one bolt M8 \* 20 (C) and nuts (D), Finally, tighten the bolts and nuts (F) and (G).

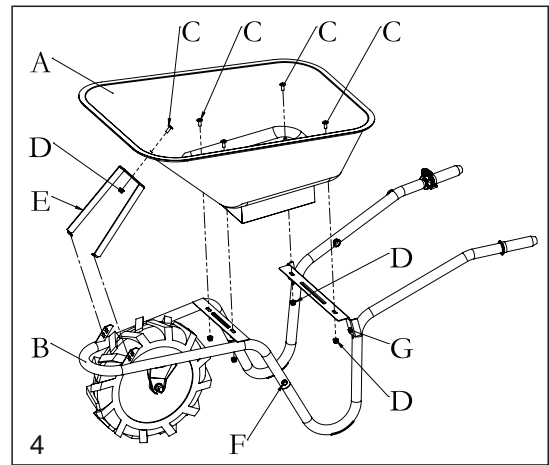
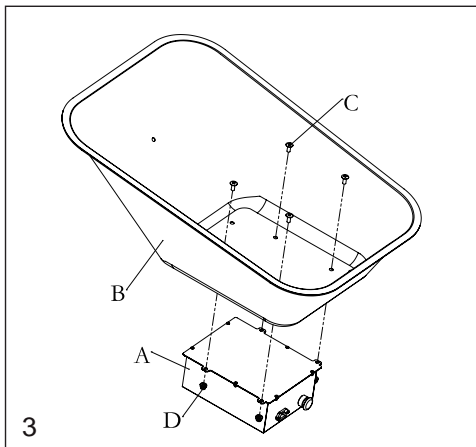

## 5. Connecting the cable

Connect the 6-pin plug @ position 1; 5-pin plug @ position 2; 3-pin plug @ position 3. The cable should be fixated with cable ties onto the frame.

## 7. OPERATION

Device to be operated in a perfect state only. Inspect the device visually every time it is to be used.

Check in particular the safety equipment, electrical controls, electric cables and screwed connection for damage and if tightened properly. Replace any damaged parts before operating the device.

### 7.1 Operation Instructions

#### **⚠ WARNING**

Unplug battery before all maintenance and settings!

#### **Notice**

Never remove the battery while the machine is running.  
In case of longer standstill, press the shut-down button.  
Use the electric motor only with sufficient battery charge.

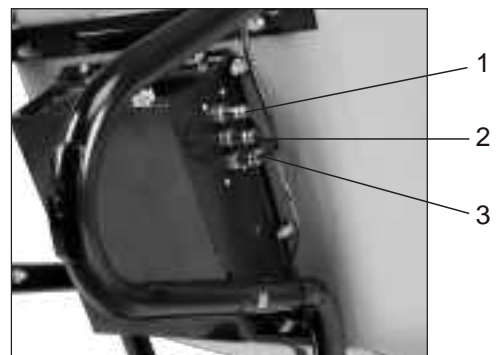

### 7.2 Operation

#### 7.2.1 Start Electrical Support

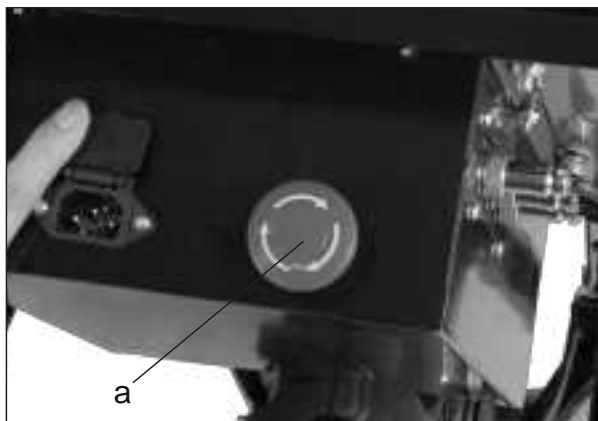

1. Unlock circuit breaker by turn the shut-down button (a).

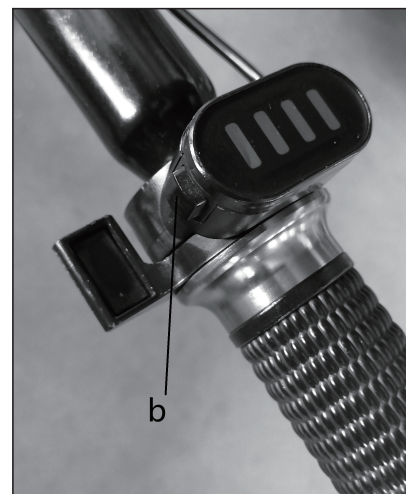

2. Press the red button (b).  
3. Turn the lever on the control element to adjust the electrical support. The further the Control lever is turned is pressed down the stronger the support.

#### **Charger**

Charger is integrated in the battery box system.

#### **Charging the battery:**

1. Connect the charger to the power supply (AC outlet) 240V/ 50 Hz and the charger plug.
2. Charge the battery.

3. Once the battery is fully charged (indication on the charger) the charger can be removed.

**LED- indication on the control element:**

All three LED light up when the red power button is pressed.

**When machine is activated by turning the lever following battery capacity is indicated:**

1. All three led light up battery capacity 100%-51%.
2. Red and orange light up battery capacity 50%-10%.
3. Only red light up please charge the battery.

## 8. MAINTENANCE

### **⚠ATTENTION**

Unplug battery before all maintenance and settings!

Serious injury due to unintentional or automatic activation of the machine!

The machine does not require extensive maintenance.

If malfunctions and defects occur, let it be Serviced by trained persons only.

#### **NOTICE**

Clean your machine regularly after every usage - it prolongs the machines lifespan and is a pre-requisite for a safe working environment.

Repair jobs shall be performed by respectively trained professionals only!

Check regularly the condition of the security stickers. Replace them if required.

Check regularly the condition of the machine.

Store the machine in a closed, dry location.

#### **8.1 Maintenance Plan.**

After each work shift: check the cables (tight fit, damage)

#### **8.2 Cleaning**

##### **NOTICE**

The usage of certain solutions containing ingredients damaging metal surfaces as well as the use of scrubbing agents will damage the machine surface!

Clean the machine surface with a wet cloth soaked in a mild solution.

Never use running water or a high-pressure cleaner to clean the machine.

Clean the outer parts with a damp sponge.

Never clean the electronic parts with water!

Check the machine and remove the deposits and / or residues with a brush.

#### **8.3 Storage**

Clean thoroughly all components before storage.

Store all components separately in a dry area at not less than -10°C.

Charge the battery fully before storing.

##### **NOTICE**

During longer standstill but at least after one month charge the battery.

#### **8.4 Disposal**

Do not dispose the machine and the battery in residual waste. Contact your local authorities for information regarding the available disposal options. When you buy at your local dealer for a replacement unit, the latter is obliged to exchange your old.

## 9. TROUBLE SHOOTING

**BEFORE YOU START WORKING FOR THE ELIMINATION OF DEFECTS, UNPLUG THE BATTERY.**

Trouble	Possible Cause	Solution
No electrical support.	Battery is not charged.	Recharge battery.
	Motor stuck.	Check motor.
	Power switch is damaged.	Check switch.
	Broker or loose cables.	Check cable.
No charging or battery.	Loosen cable.	Check cable connection.

# WARRANTY

The warranty period starts from the purchase date, and the warranty does not cover product problems caused by not operating in accordance with the specifications of this manual. Except for wearing parts, the whole machine is guaranteed for 1 year.

## 10. PARTS BREAKDOWN

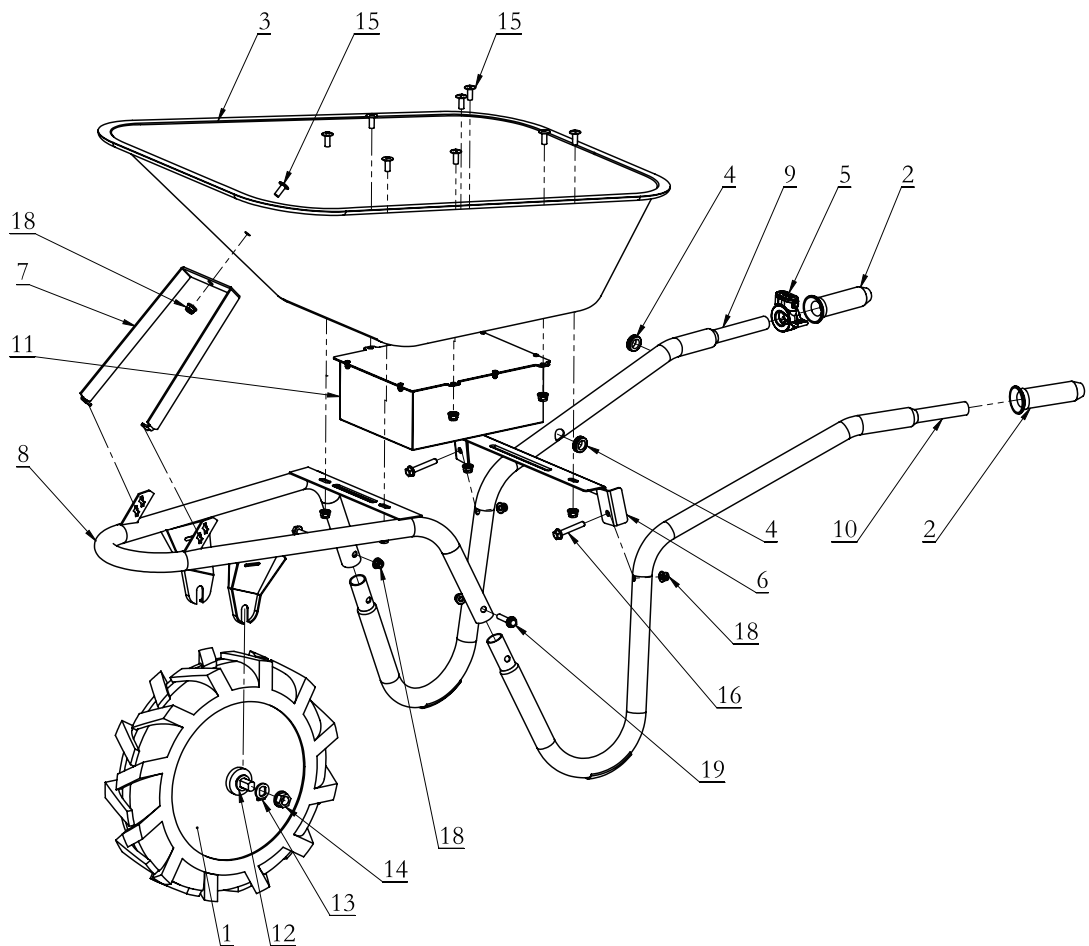

Part No.	Description	Q'ty	Part No.	Description	Q'ty
1	Motor wheel	1	10	Left handle	1
2	Handle grip	2	11	Battery box system	1
3	Tray	1	12	Motor wheel washer A	2
4	Rubber sleeve	2	13	Motor wheel washer D	2
5	Motor control element	1	14	Motor wheel nut	2
6	Support	1	15	Bolt M8X20	9
7	Front support	1	16	Bolt M8X50	2
8	Frame	1	18	Nut M8	13
9	Right handle	1	19	Bolt M8X45	2



Great Circle USA  
 Support Line: 1-866-493-0524  
 help@greatcircleus.com  
 www.greatcircleus.com