

## (9) PRESSURE EMMITTER INSTALLATION

pressure reducing emitter must be installed.

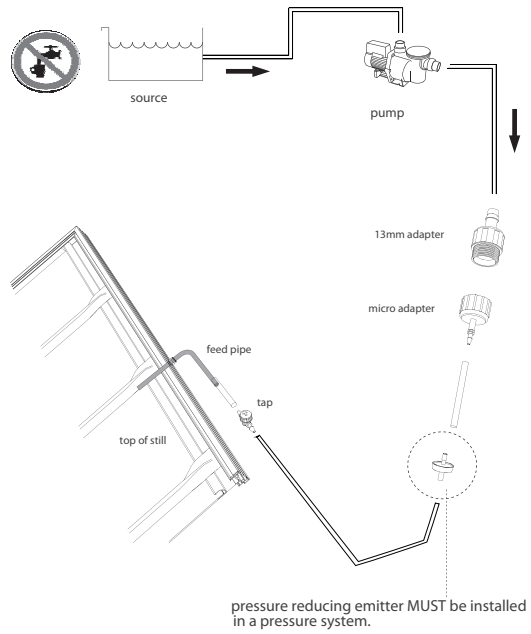

## (10) CONNECTIONS

waste and distilled water

- (1) Connect pipe to distilled water outlet.
- (2) Connect pipe to waste water outlet.

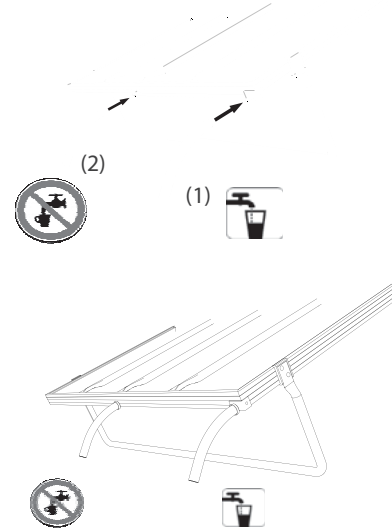

## (11) WATER

gravity water set up.

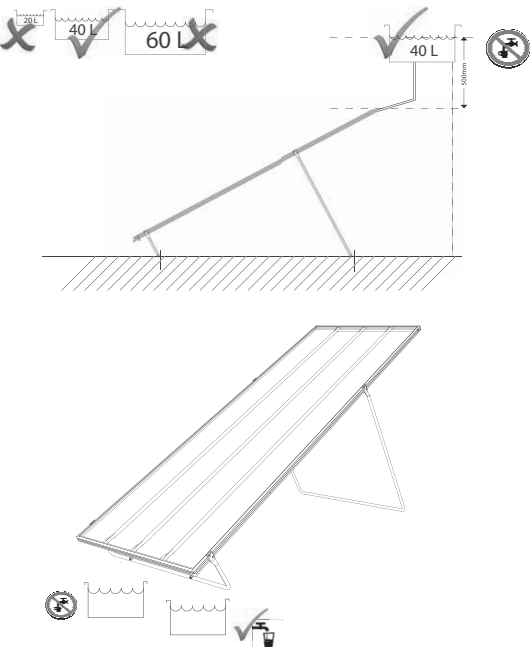

## (12) FUNCTIONING PANEL

set up

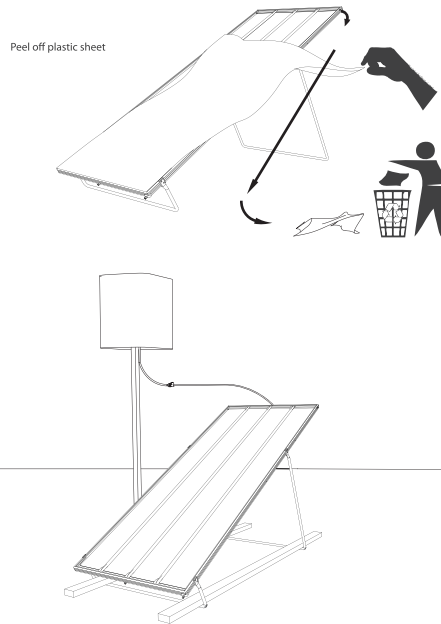

<http://www.fcubed.com.au/>

F Cubed Australia Pty Ltd  
23 Fillo Drive  
Somerton Vic 3062  
Australia.  
ph. +61 3 8339 0006  
fax. +61 3 8339 0083



Carocell  
Instructions

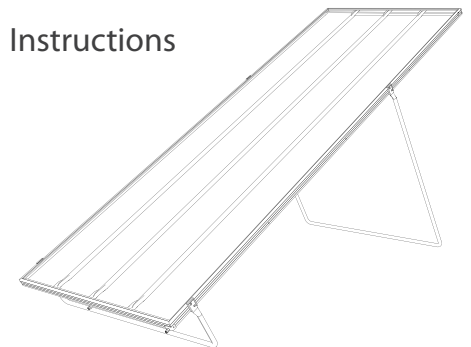

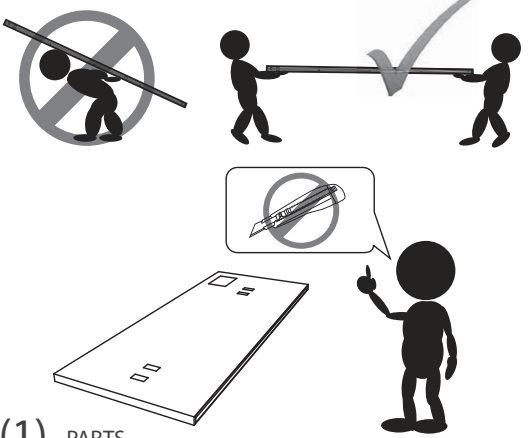

# (1) PARTS

- contents of pack.
- x 8 screws
  - x 8 steel washers
  - x 8 nylon washers
  - x 4 black mounts (2 left, 2 right)
  - x 1 larger leg
  - x 1 smaller leg
  - x 1 6L/H drip emitter
  - x 1 spirit level

# (2) MOUNTS

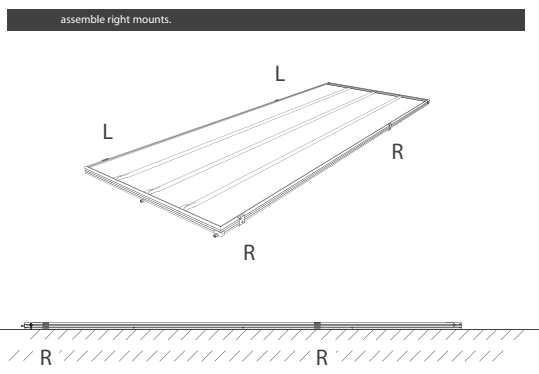

# (5) LEGS

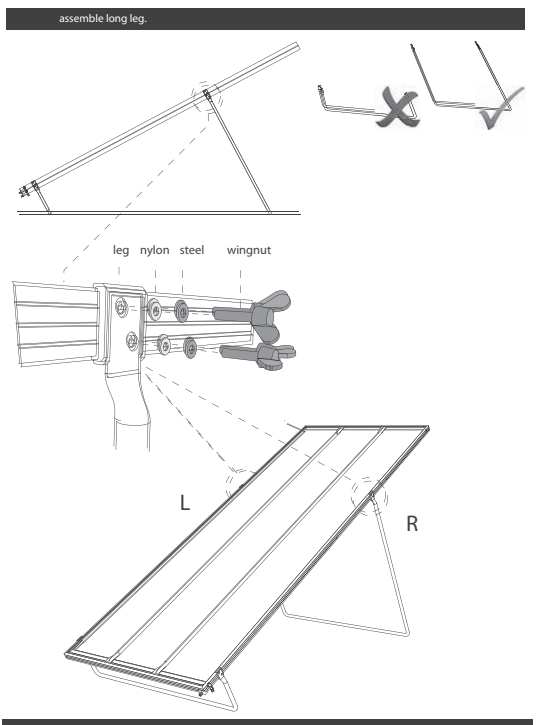

# (6) ORIENTATION

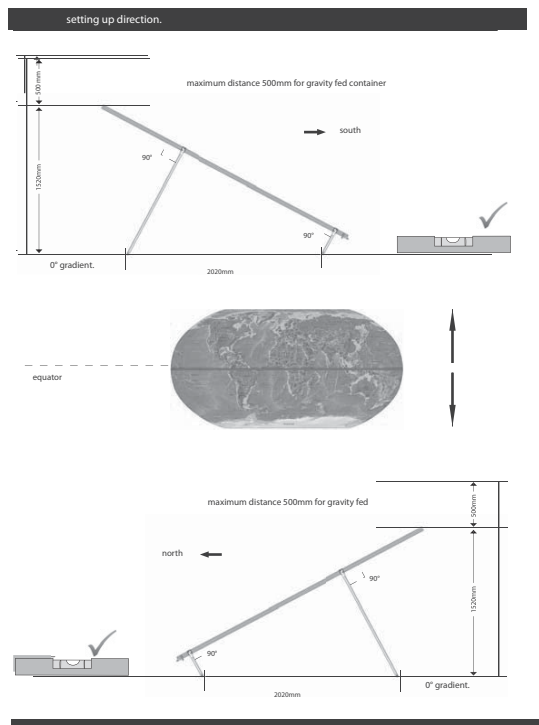

# (3) MOUNTS

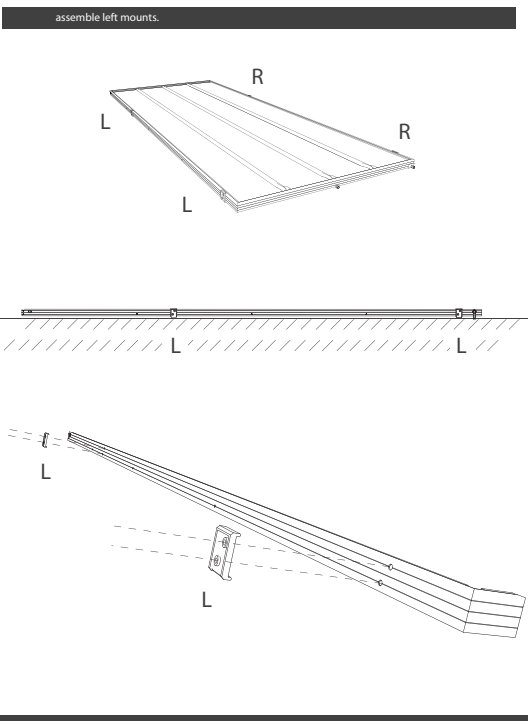

# (4) LEGS

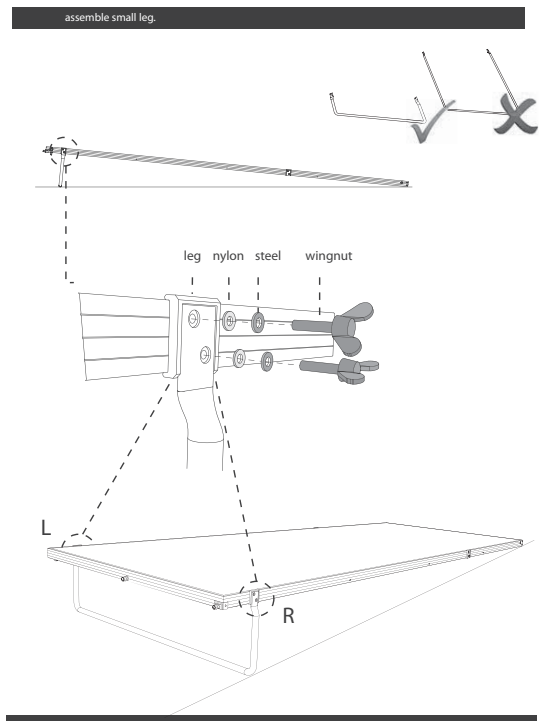

# (7) SECURE

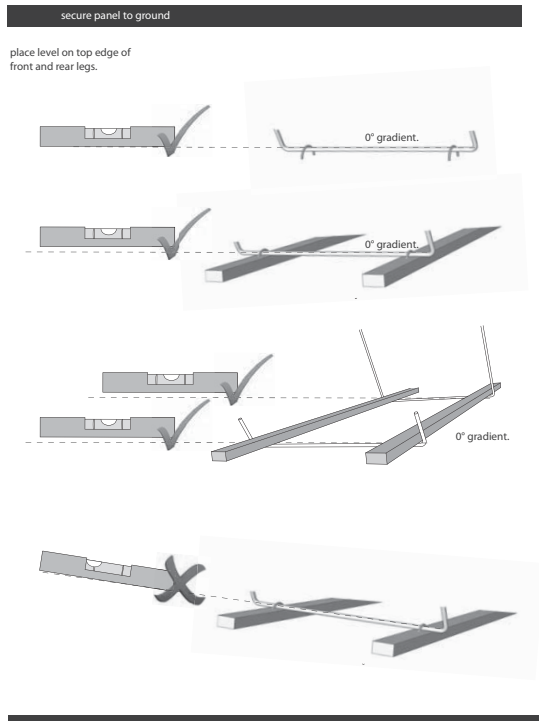

# (8) FEED PIPE ASSEMBLY AND INSTALLATION

