

DUMBBELL HOME GYM STORAGE RACK

ASSEMBLY MANUAL

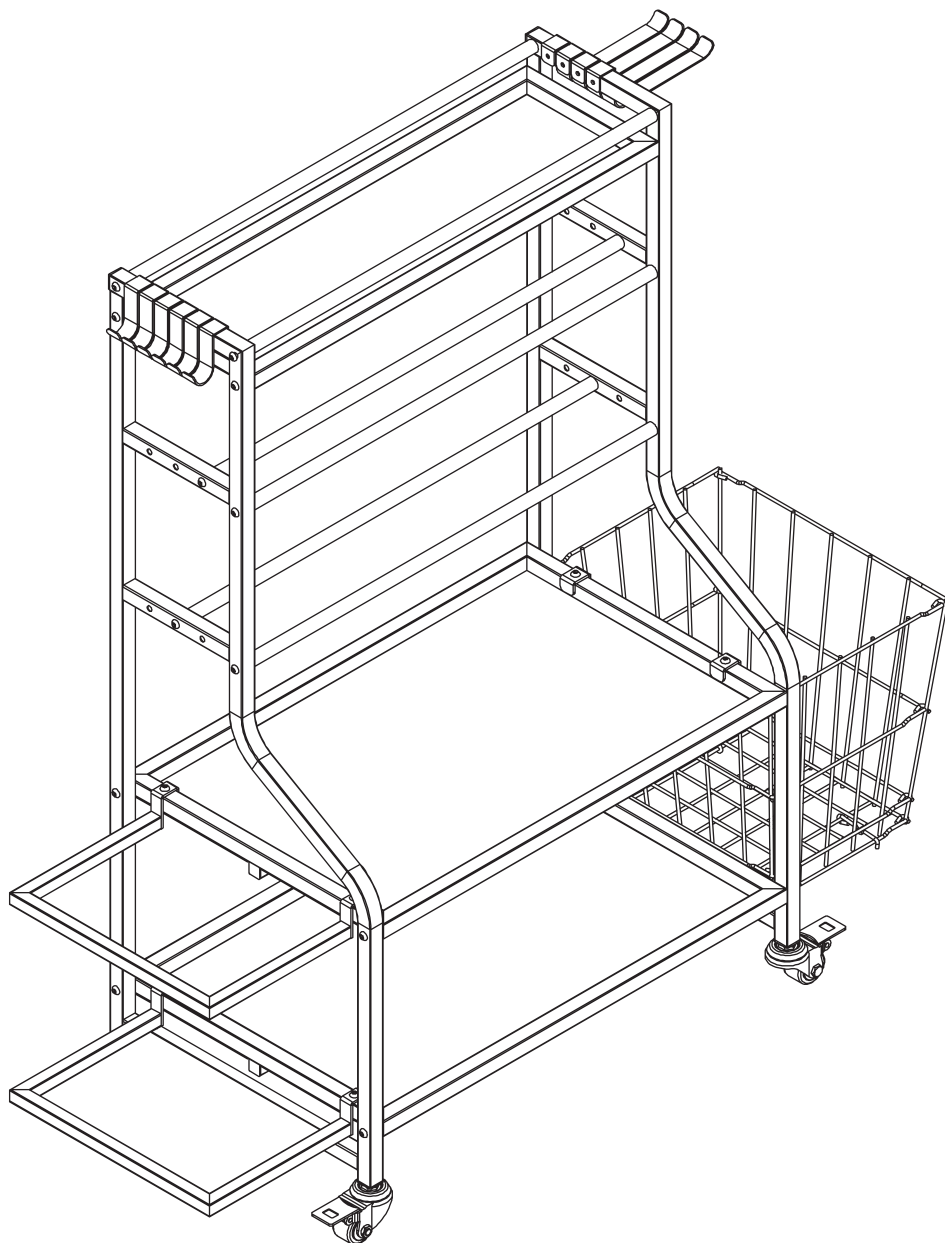

1

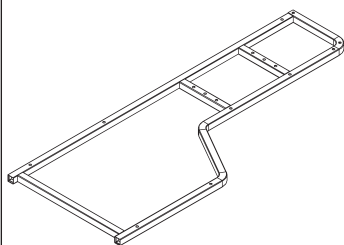

x 2 PCS

2

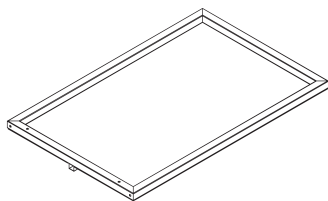

x 1 PC

3

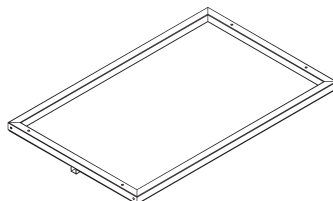

x 1 PC

4

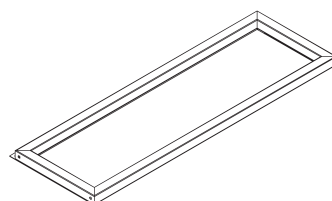

x 1 PC

5

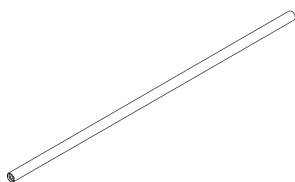

x 6 PCS

6

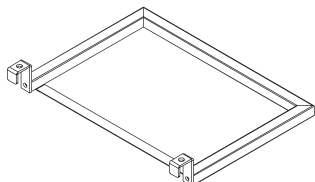

x 1 PC

7

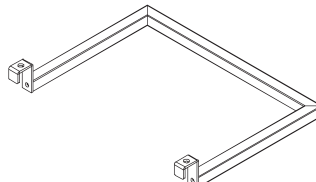

x 1 PC

8

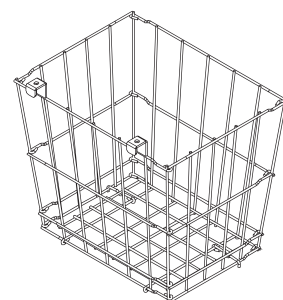

x 1 PC

9

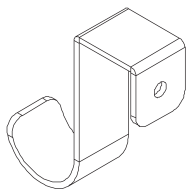

x 6 PCS

10

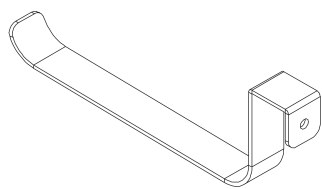

x 4 PCS

A

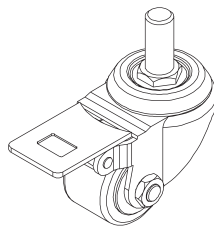

x 2 PCS

B

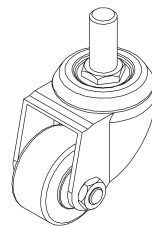

x 2 PCS

C

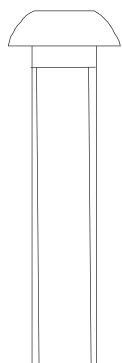

M6 x 30
24 PCS

D

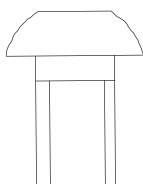

M6 x 16
6 PCS

E

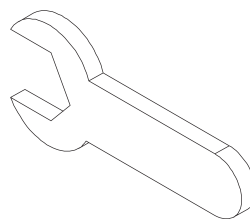

x 1 PC

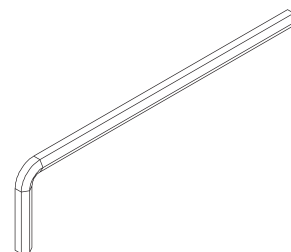

x 1 PC

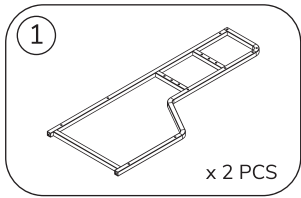

Attach ② ③ ④ to ① and tighten to 100% with **C**

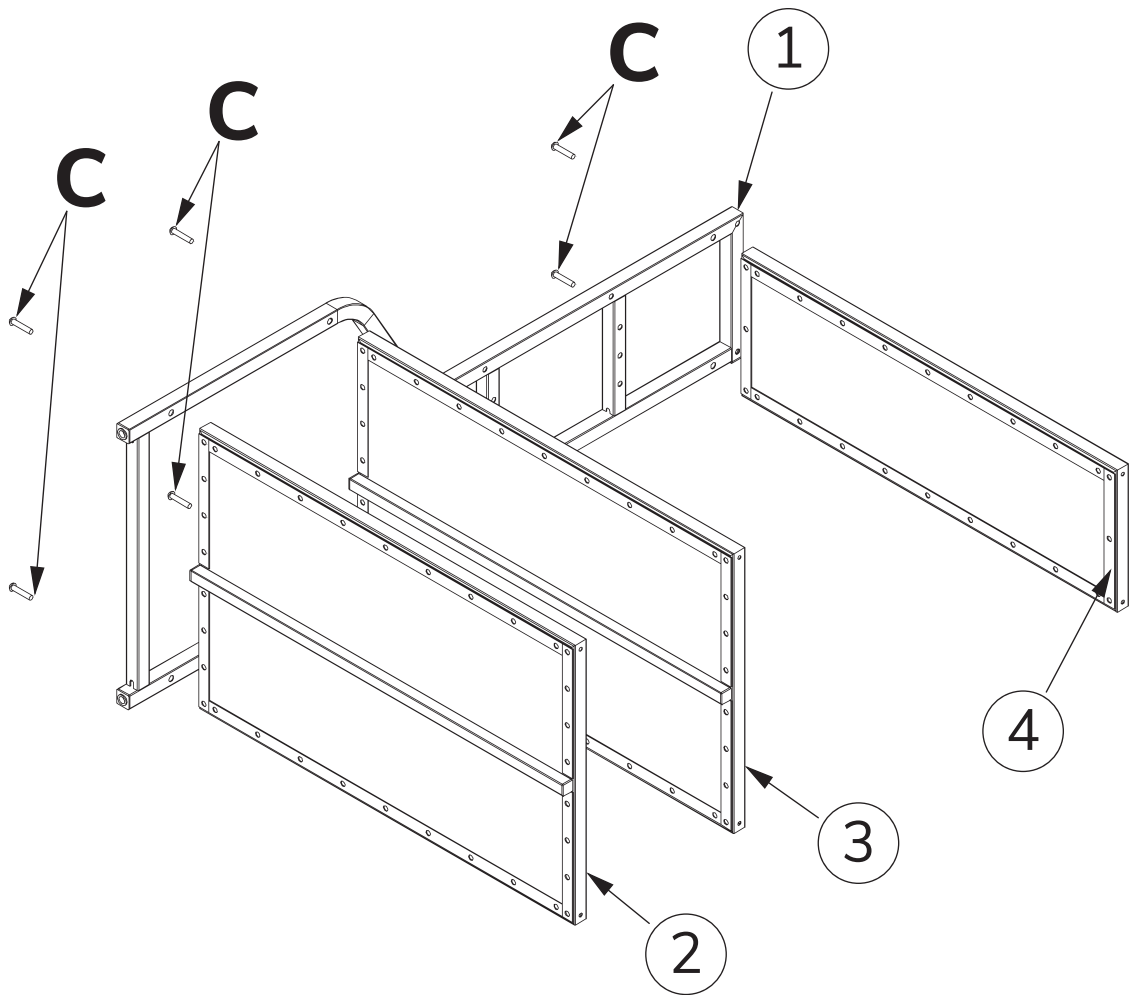
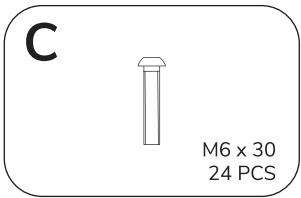
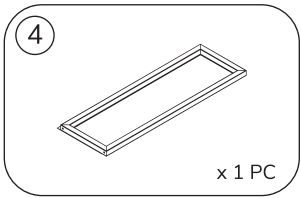
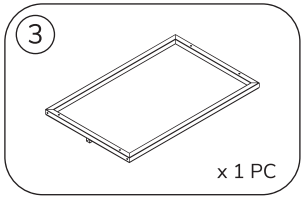
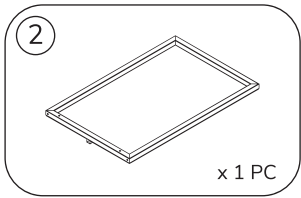

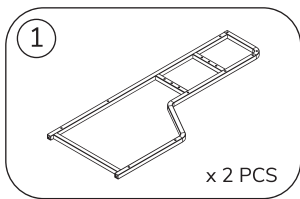

Take another 1 and attach it to the other side
and tighten to 50% with C

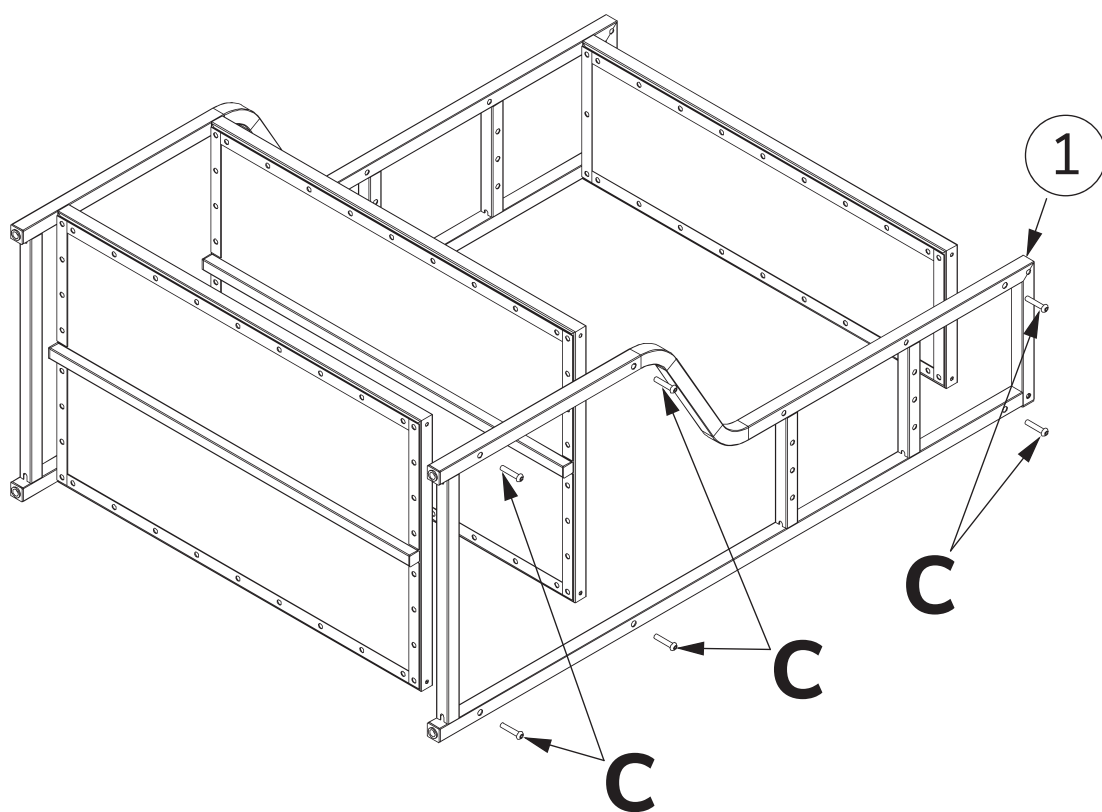
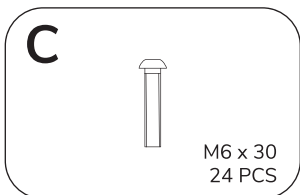

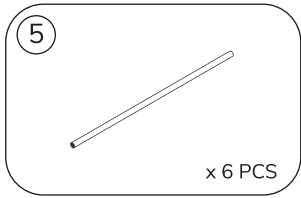

Take 6 pcs of 5 and attach them to 1 and tighten to 50% with **C**

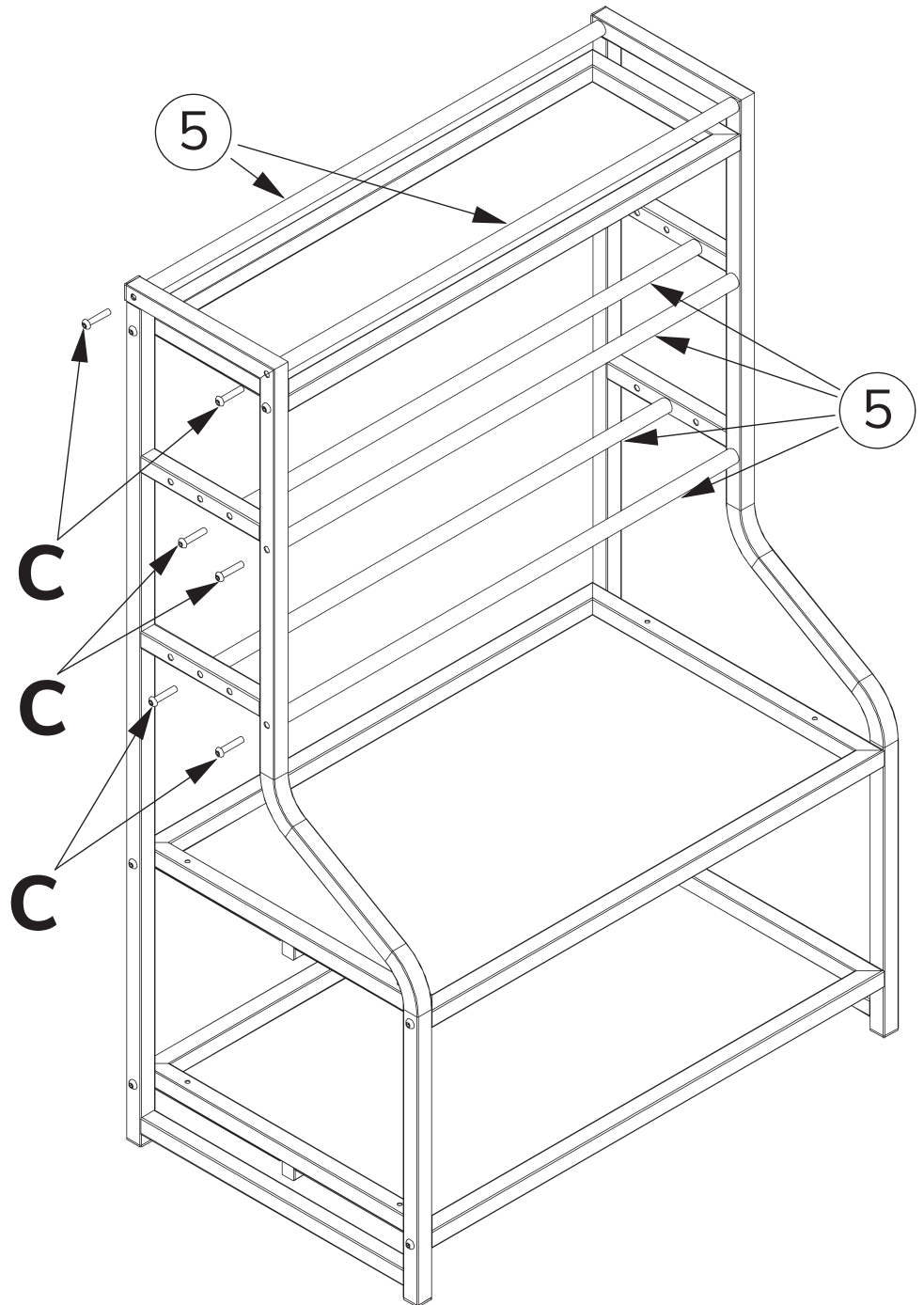
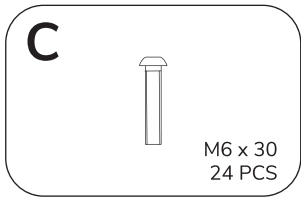

C

M6 x 30
24 PCS

Tighten the other sides of ⑤ to 100% with **C**
and tighten all loose **C** to 100%

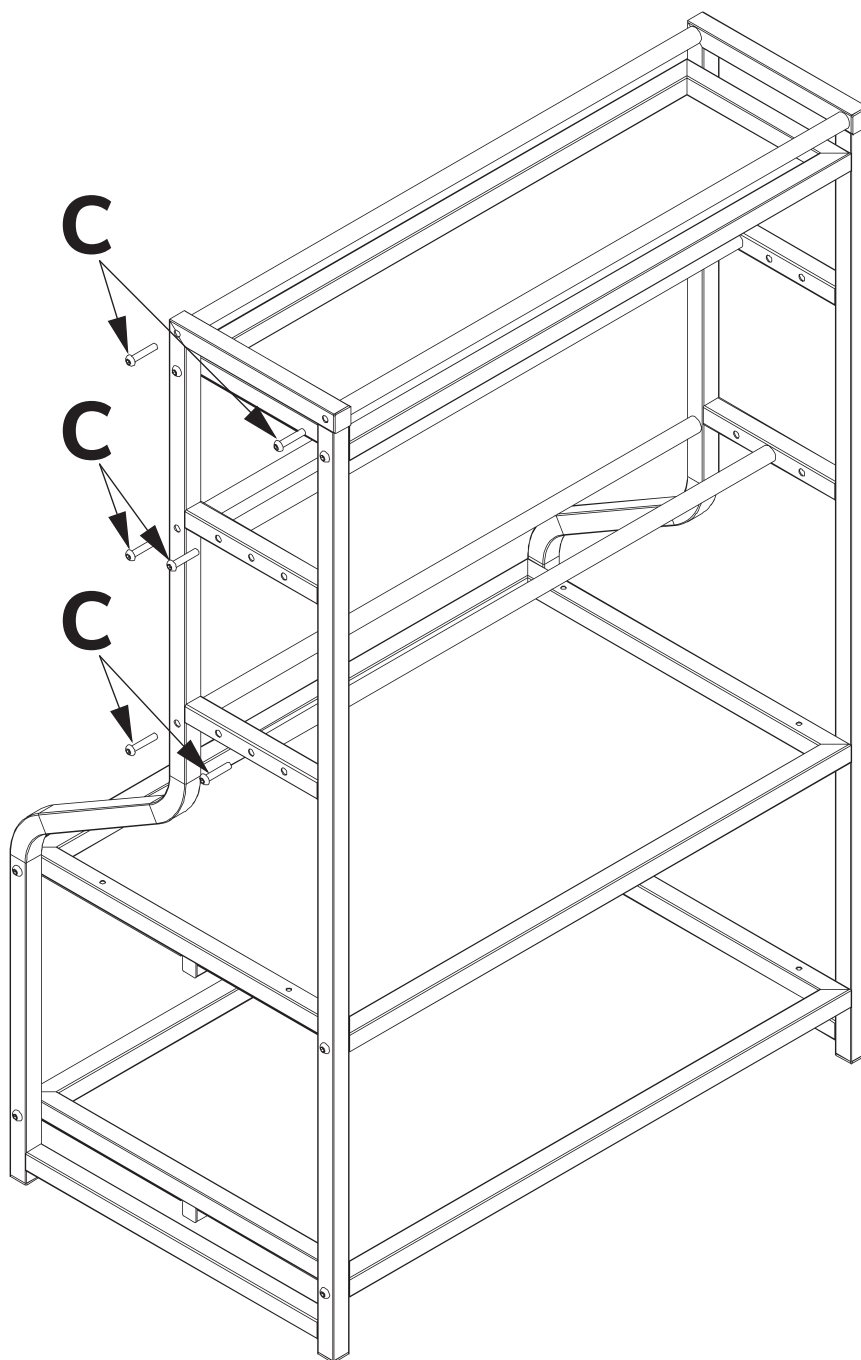

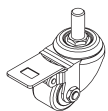
A

x 2 PCS

B

x 2 PCS

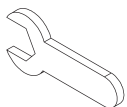
E

x 1 PC

Attach **AB** to ①, and place part **E** between the **AB** and ①

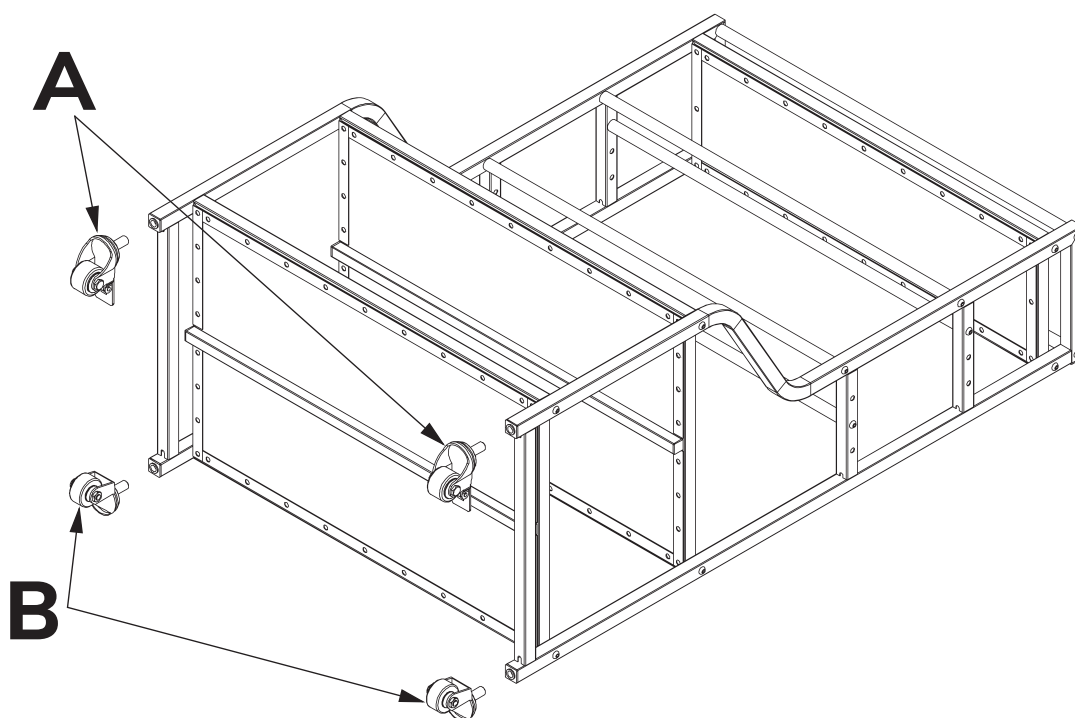

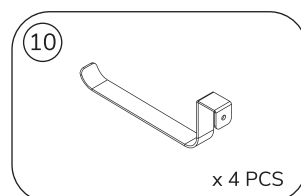
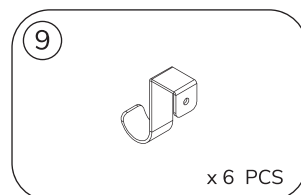
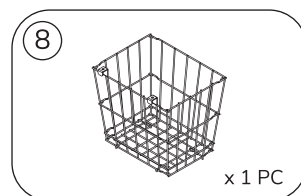
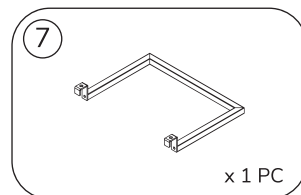
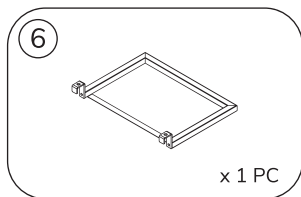

Attach ⑥⑦⑧ into part ① sides and tighten to 100%
with **D** . Hang ⑨⑩ to the sides

