



THE BEEM
User Guide

The Beem

The Beem from Mudo Labs blends acupressure principles with aromachology — the science of scents.

Developed in consultation with scientists, psychologists and researchers, it switches up your mood naturally in those moments when you need a bit of a boost.

www.mudolabs.com

How It Works

Blends scientific knowledge with age-old traditions of natural wellness.

Designed to apply acupressure to the point above your cupid's bow (GV26) for the experience of calmness and focus.

Works with interchangeable mood experience cartridges infused with all-natural essential oil formulations backed by science, and developed with aromatherapists and perfumers.

Assembly

1



Slide The Beem body out to release it from its metal cover.

2



Remove The Cartridge from its foil packaging.

3



Remove the top and bottom silicone seals.
(Pro tip: Store seals for resealing when switching between cartridges.)

4



Align the two pinholes.

5



Gently slide The Cartridge into The Beem body until it clicks.

6



Slide The Beem body back into its metal cover.
The device is now in the closed position.

User Guide

1



Before use, slide The Beem body out to release it from its metal cover.

2

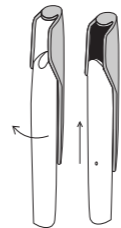

Rotate the body 180 degrees, then slide it back into the metal cover. It is now in the opened position.

3

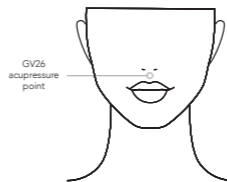

Place the exposed tip of The Cartridge on your cupid's bow (GV26) acupressure point.

4

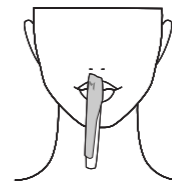

Slowly inhale through your nostrils in one continuous breath until you feel a fullness in your chest.

5



Hold the inhalation for up to 5 seconds.

6

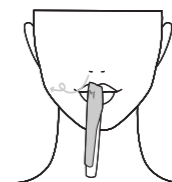

Gradually exhale.
Breathe naturally then repeat as desired.



Caution: For external use only. Do not consume. Avoid contact with eyes. Keep out of reach of children. Do not use when product is damaged.

Essential oils may cause allergic reactions. If you develop any irritation, discontinue use. If symptoms persist, consult a doctor. If you have pre-existing medical conditions, or are pregnant or nursing, consult your doctor before use. Not suitable for children.

This product is not intended to diagnose, treat, cure or prevent any disease. These statements have not been evaluated by the Food and Drug Administration.

The Beem contains magnetic components that emit electromagnetic fields that may interfere with medical devices. Consult your physician for information specific to your medical device. If you suspect that The Beem interferes with your medical device, stop using the product.

Storage Instructions

Store in a cool, dry place. Avoid direct sunlight.

Cleaning Instructions

Wipe surface with a clean cloth.

"M", "MUDO LABS" and "THE BEEM" are registered trademarks of Delightex Pte Ltd in Singapore.

Design Registration No. 30202300374X

Translated guides:

- 中文
- Bahasa Melayu
- தமிழ்

