

THANKS FOR BUYING A PROBLEM SOLVERS I-SPEC II™ SHIFTER CLAMP!

We're always looking to provide the products that allow you to configure your bike any way you want. So, if you wanted to re-use your Shimano I-Spec II shifters with non-I-Spec II brakes you've chosen the right product.

⚠ WARNING: Cycling can be dangerous. Bicycle products should be installed and serviced by a professional mechanic. Never modify your bicycle or accessories. Read and follow all product instructions and warnings including information on the manufacturer's website. Inspect your bicycle before every ride. Always wear a helmet.

For complete ASTM guidelines, and additional product safety information, please visit: www.problemsolversbike.com/safety

COMPATIBILITY & INTENDED USE

The Problem Solvers I-Spec II Shifter Clamp is compatible with Shimano I-Spec II shifters (XTR M9000, M8000).

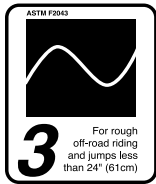

Intended for ASTM 3 conditions. This is a set of conditions for the operation of a bicycle on a regular paved surface, unpaved and gravel roads and trails with moderate grades with irregular terrain where loss of tire contact with the ground may occur. As well as rough trails and unimproved trails that require technical skills. Jumps and drops are intended to be less than 61cm (24").

TOOLS

- 3, 4 mm hex wrenches
- Torque wrench that measures in Newton meters

INCLUDED PARTS

- I-Spec Bar II Shifter Clamp (1)
- M5 x 0.8 - 12L socket head cap screw w/ washer (1)
- M5 x 0.8 - 8L button head cap screw (1)

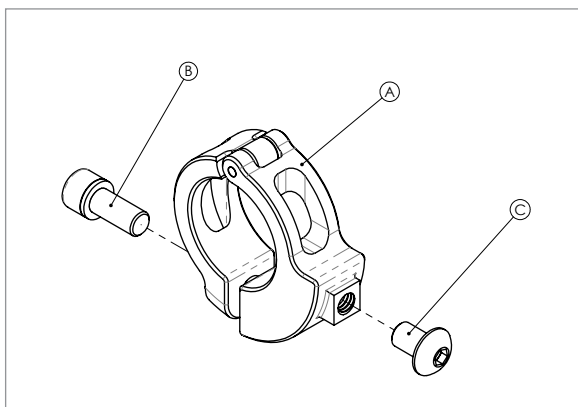

INSTALLATION

Problem Solvers I-Spec II Shifter Clamps are sold individually and can be mounted on both the right and left side of the handlebar.

- Mount your Shimano I-Spec II shifter to Problem Solvers Bar shifter clamp using the included M5 x 8mm, button head cap screw (C). (Fig. 1: shifter and clamp before mated, Fig. 2: shifter and clamp mated.)



Figure 1



Figure 2

- Remove the M5 x 12mm, Socket head cap screw (B) to open the bar clamp hinge and install the bar clamp to your desired position on the handlebar. (Figs. 3 & 4)



Figure 3



Figure 4

- Adjust the shifter and bar clamp to desired position. Tighten the M5 x 8mm button cap screw (C) to 4Nm and the M5 x 12mm socket cap screw (B) to 5Nm.

4. Check to see if your shifter is firmly secured to your handle bar by firmly grabbing the shifter and bar clamp and try rotating the bar clamp on your handlebar. If the clamp moves up or down, retighten the bar clamp but do not exceed 7Nm.
5. Assembly is complete (Fig. 5).



Figure 5

ONGOING MAINTENANCE

⚠ WARNING: Improper installation of bolts may lead to product failure, causing serious injury. Do not exceed specified torque values. Periodically inspect bolts and retighten if required. Inspect your Shifter Clamp for signs of excessive wear, cracks, or other fatigue before every ride. If you suspect that your Shifter Clamp has been damaged, return it to the shop where it was purchased to be inspected by a professional bicycle mechanic.

WARRANTY PROCESS

If you and your shop think your Problem Solvers product is worthy of a warranty inspection, please return the product to the original place of purchase, accompanied by a sales receipt.

For complete warranty information, visit problemsolversbike.com/safety