

Mount'n Mover with Pow!r Tilt

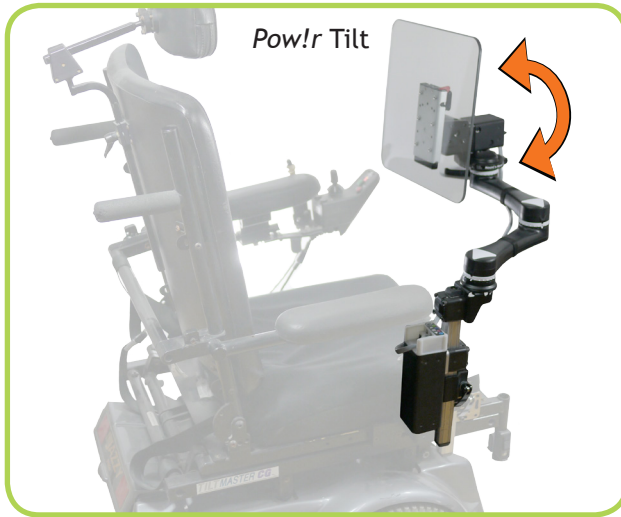

Mount'n Mover with Pow!r Shoulder



Pow!r Mount

Now Available!

You asked for it and we delivered!
Mount'n Mover with *Pow!r Tilt* and
Mount'n Mover with *Pow!r Shoulder*

A new level of independence!



"It is working great and it has been a huge help in my life"

- Scott Koch, client with Spinal Muscular Atrophy

Scott lives alone independently and enjoys playing games and socializing with friends on the computer. The Pow!r Shoulder makes it possible for him to independently suction himself. He uses a switch and the Pow!r Shoulder to move the suction tube into position and another switch to activate the suction machine. Using the Pow!r Mount has resulted in a decrease in frequency of respiratory illness, decreased anxiety and increased engagement with friends.

"I can't believe I can talk whenever I want"

- Brea

Brea accesses her speech generating device using eye gaze technology. With her Mount'n Mover with a Pow!r Shoulder she is now able to move her device into position whenever she has something to say and doesn't have to wait for someone to assist her.



Pow!r Mount

Move your Mount with the touch of a switch

- Motorized mounting systems
- Independent positioning
- *Pow!r Shoulder* or *Pow!r Tilt*
- Use from a wheelchair, bed, or table
- Wide range of control options
- Supports and moves up to 15 pounds
- Switch and App control
- Custom lock positions

Do more - with a mount that moves!



- Hybrid Mount'n Movers
- Mount'n Mover with a *Pow!r Tilt* or *Pow!r Shoulder*
- Powerfully Independent

Mount'n Mover™

by BlueSky Designs

2637 27th Ave. S., Suite 209
Minneapolis, MN 55406-1564

mountnmover.com

1-888-724-7002 (toll free) or 1-612-724-7002

Mount n Mover with
Pow!r Hybrid Systems

End Cap: Plug Hub and Controller

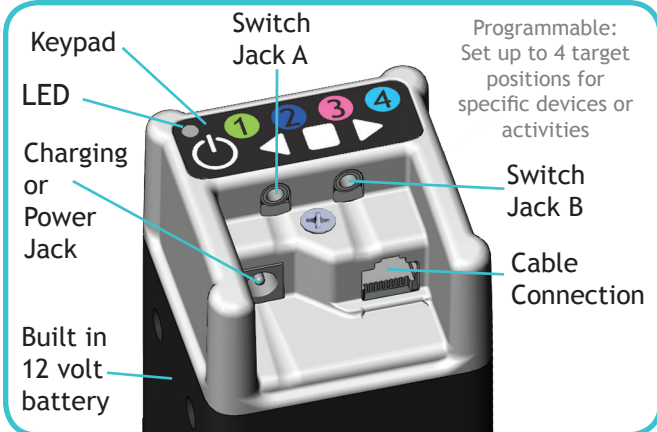

Pow!r Mount Smart Joint: Building block

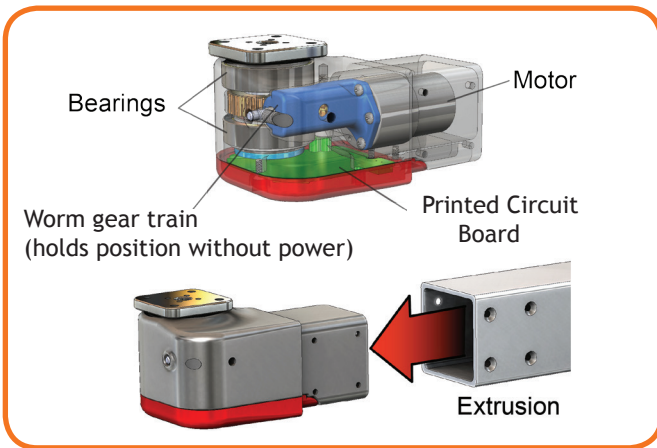

Joint Release



Switch Access For Hybrids

Single Switch A: Toggle directions

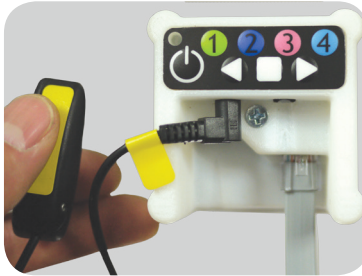

- Activate switch (or use arrow keys)
- Joint moves while held
- Let up, it stops
- Next activation, other direction

Single Switch B: Two Target positions

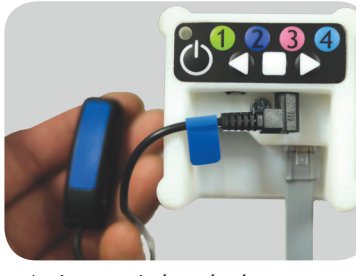

- Activate switch and release
- Moves to a target position
- Activate and release
- Joint goes to second target position
- Click switch while moving; it stops

Two Switches: Direction-specific

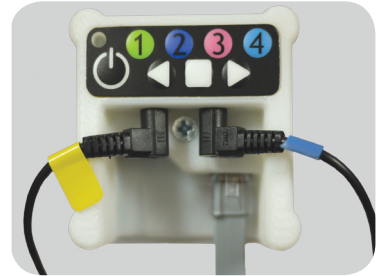

- Activate and hold Switch A
- Stops when released
- Activate Switch B to go other way

Multiple Joint Pow!r Mount System

* Under Development *



Programmable multiple joint mounting system. Program up to 30 target positions organized by groups. Groups store positions for different devices, environments, activities or people.

Controlled by Pow!r Mount App (ios and Android)



Adjust positions

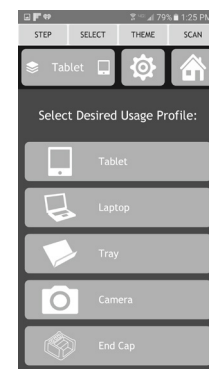

Up to five groups of targets

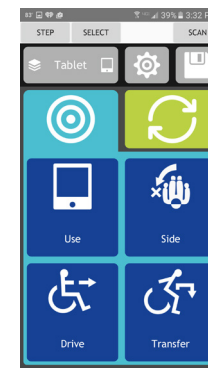

Target positions (up to 6 per group)

App Access modes include:

- Touch display (phone)
- Single switch: Timed Scan
- Single switch: Step Scan
- Dual switch: Step, Select

App Input options include:

- Switches (single, dual, wireless)
- Wheelchair controls (joystick, head array, etc)
- Switches plug into End Cap