



**POPULAS**  
furniture by AD·AS

**LARGE ROUND TABLE**  
*Hand-crank, height adjustable pedestal table*

**SPECIAL NEEDS**  
COMPUTERS  
**1-877-724-4922**

**This generous 42" diameter table comfortably accommodates four people. It provides variable height adjustment according to activity.**



**FEATURES:**

- Single surface table with 14" or 18" of verticle height adjustment capability
- Durable powder coat finish on pedestal and base
- Durable laminate provides low maintenance surface
- Easy to turn hand crank retracte out of the user's way

**TECHNICAL DATA:**

- Standard table dimensions: 42" diameter round top, 1" thick
- Vertical adjustment range 24"-38" or 27"-45," 6 cranks per inch
- Weight Capacity: 100 lbs.
- Available in six standard laminate finishes
- Base finish: Graphite Silver

MODEL	DIMENSIONS	ADJUSTMENT RANGE	START/END HEIGHT
HCP 470	42" DIAMETER	14" or 18"	24"- 38" or 27"- 45"





**POPULAS**  
*furniture by AD·AS*

**LARGE ROUND TABLE**  
*Dimensions*

HCP 470

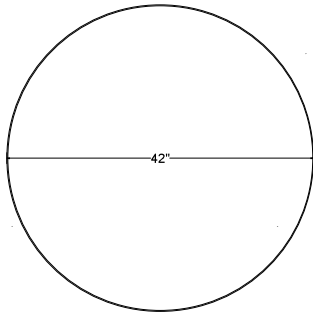

Top View

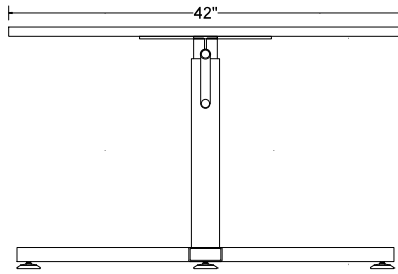

Front View

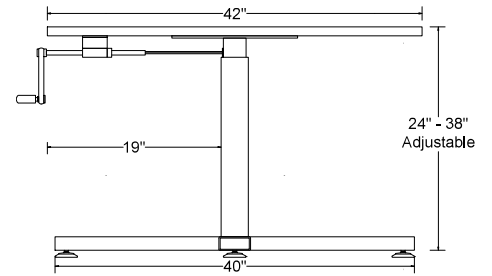

Side View