

# Swopper® Assembly

Final assembly instructions for a chair on glides.



## 1 Unpack your chair.

Remove all parts from the box & remove all wrapping. Carefully place the base ring on the floor.



## 2 Attach spring strut.

Place the small end of the spring strut (B) into the hole in the center of the base foot ring (A).

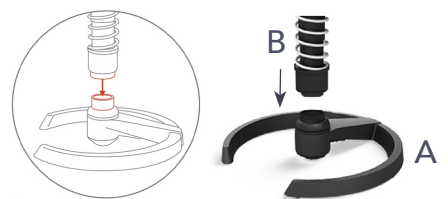

## 3 Attach seat.

Place the seat (C) onto the gas spring (B).



## 4 Sit in your chair.

Carefully return your chair to an upright position. Sit down firmly in your chair several times to fully engage the assembled chair.



We're here to help.

Call us at 877-211-5814 or email us at [customer care@ergify.com](mailto:customer care@ergify.com) for support.

**ergify**<sup>™</sup>

# Swopper® Assembly

continued

## Attaching Metal Glides.

For use on textile flooring such as carpet, use metal glides. Turn the Swopper upside down & remove the current glides carefully with pliers. Insert the metal glides into each glide spot, firmly pressing each into place.

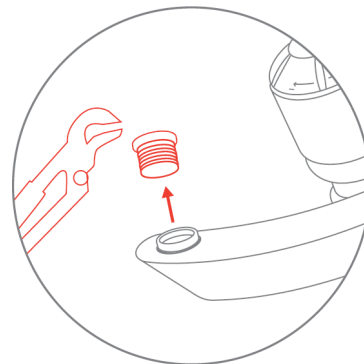

## Attaching Felt Glides.

For use on hard flooring such as wood, use felt glides. Turn the Swopper upside down & remove the current glides carefully with pliers. Insert the felt glides into each glide spot, firmly pressing each into place.

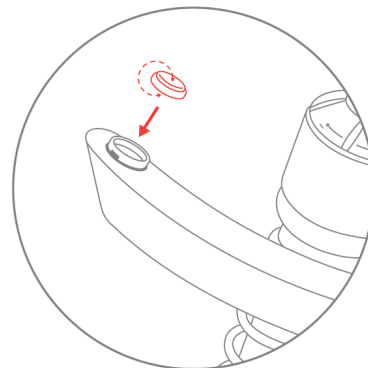

*We're here to help.*

Call us at 877-211-5814 or email us at [customer care@ergify.com](mailto:customer care@ergify.com) for support.

**SPECIAL NEEDS**  
**COMPUTERS**   
**1-877-724-4922**

**ergify**<sup>™</sup>