

Get started with myAbilia and CARY Base

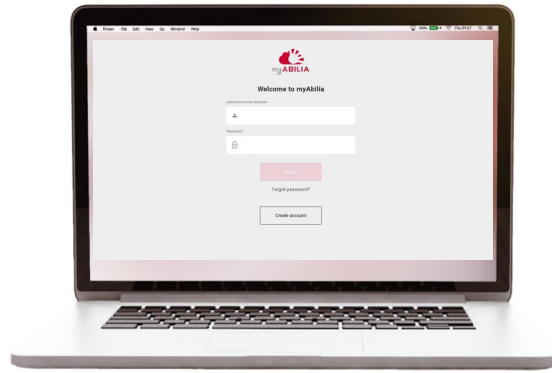

Get started with myAbilia – step by step

1. Set up myAbilia account



- a) Go to www.myabilia.com on a computer, mobile phone or tablet.
- b) Create a user account on myAbilia.
- c) Log in to myAbilia.
- d) **Select the calendar module CARY.**
- e) **Import the image library CARY.**

2. Connect CARY Base to myAbilia

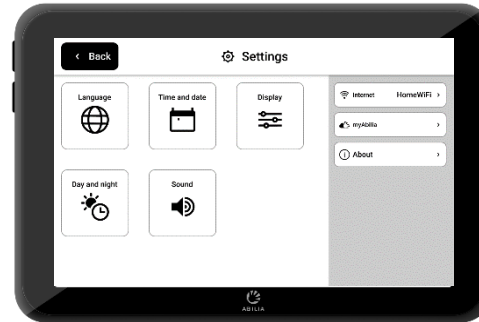

Make sure that the device is connected to Wi-Fi and log in with the user account.

3. Add activities

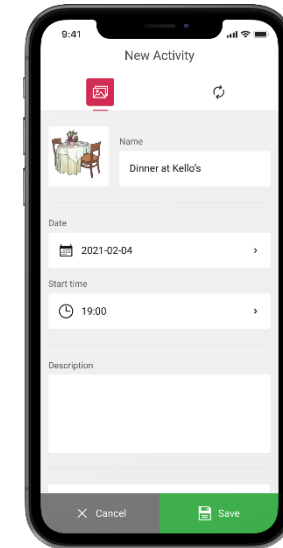

Log in to www.myabilia.com on a computer, mobile phone or tablet.

Use myAbilia to manage the calendar in CARY Base.

If you need more help, follow the instructions in this guide!

Create a user account at myAbilia



1. Open a web browser and go to www.myabilia.com.
2. Select **Create account**.
3. Select account type **User** and follow the instructions.

www.myabilia.com



Welcome to myAbilia

Username/Email address

Password

[Log in](#)

[Forgot password?](#)

[Create account](#)

Log in to myAbilia

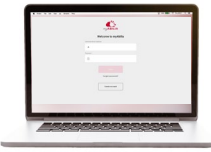

1. Open a web browser and go to www.myabilia.com.
2. Enter your username and password and select **Log in**.

The image shows the myAbilia login process. On the left is the web login page with the myABILIA logo, a 'Welcome to myAbilia' message, and a login form. The form has a 'Username/Email address' field containing 'anna@gmail.com' and a 'Password' field with masked characters. Below the form is a red 'Log in' button, a 'Forgot password?' link, and a 'Create account' button. On the right is the mobile app interface for a user named 'Anna'. It features a red header with a profile icon and a notification badge. A dark sidebar menu is open, listing options: Calendar, Basic Activities, Basic Timers, Checklist, Image Archive, Notes, and Voice Note. The main screen shows a calendar for 'Week 33' from Monday 16 to Sunday 22, with a time axis from 24h to 7pm. A red arrow points from the 'Log in' button on the web page to the mobile app's main menu.

Select the calendar module CARY



1. Select  and **My Profile** in the menu.
2. Select the tab **Modules** and select the modules intended for CARY:
 - Calendar – CARY
 - Basic Activities
 - Image Archive
3. Select **Save**.

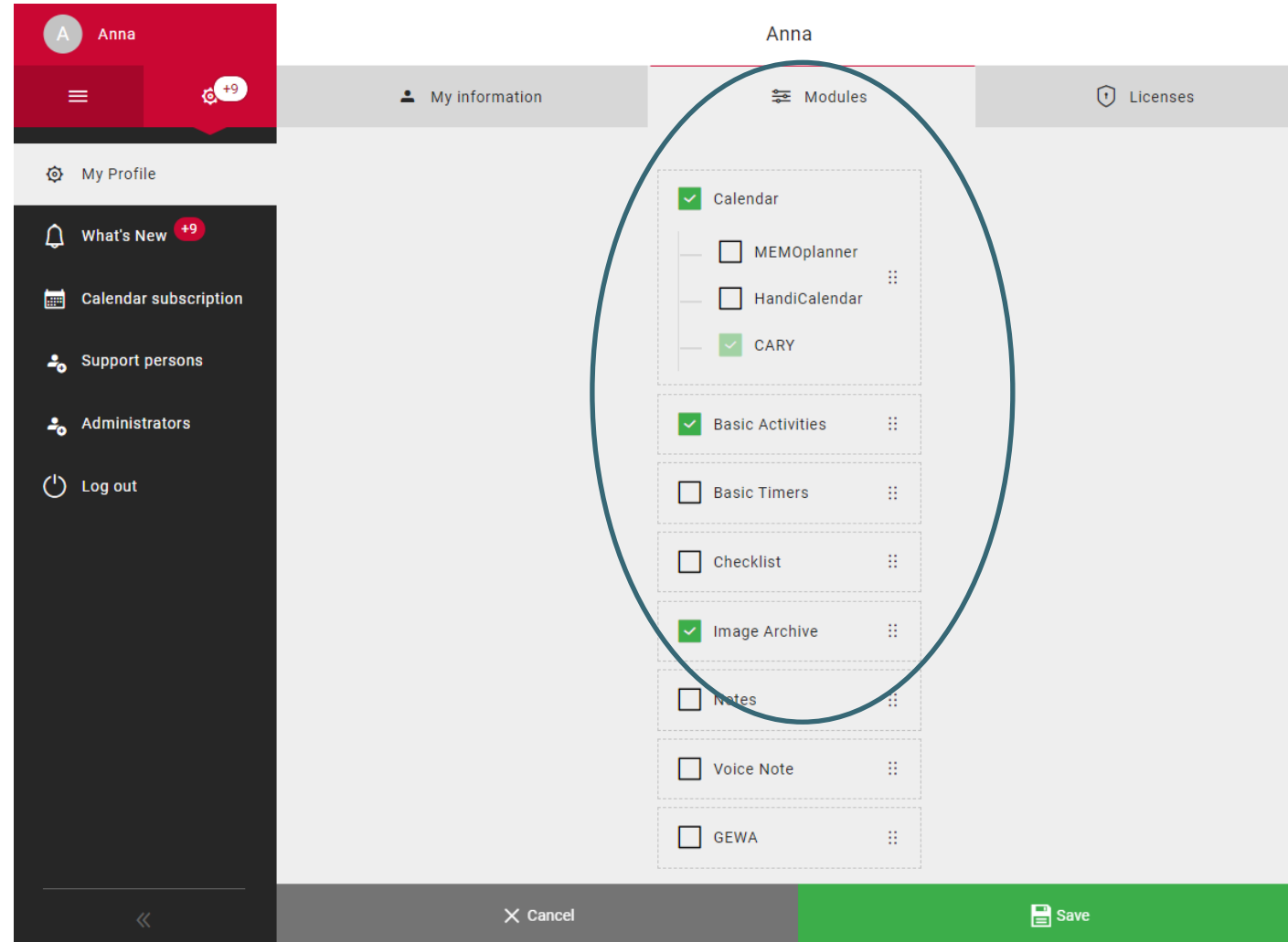

Import the image archive CARY



1. Select  and **Image Archive** in the menu.
2. Select **New** and **Import from Image Library**.
3. Select image archive **CARY** and **Add**.

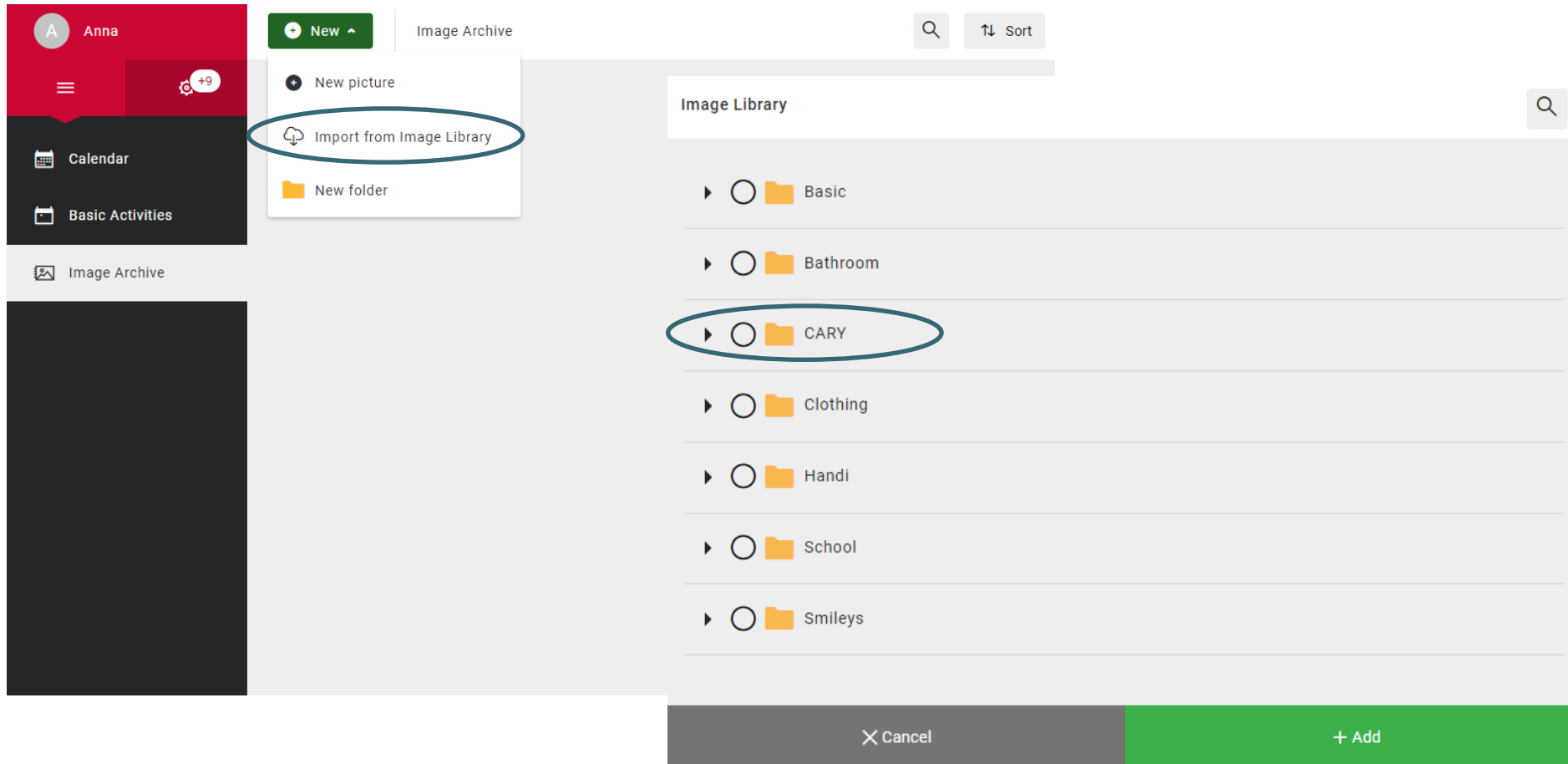

Connect CARY Base to myAbilia



1. Go to the Power menu and select **Settings**.

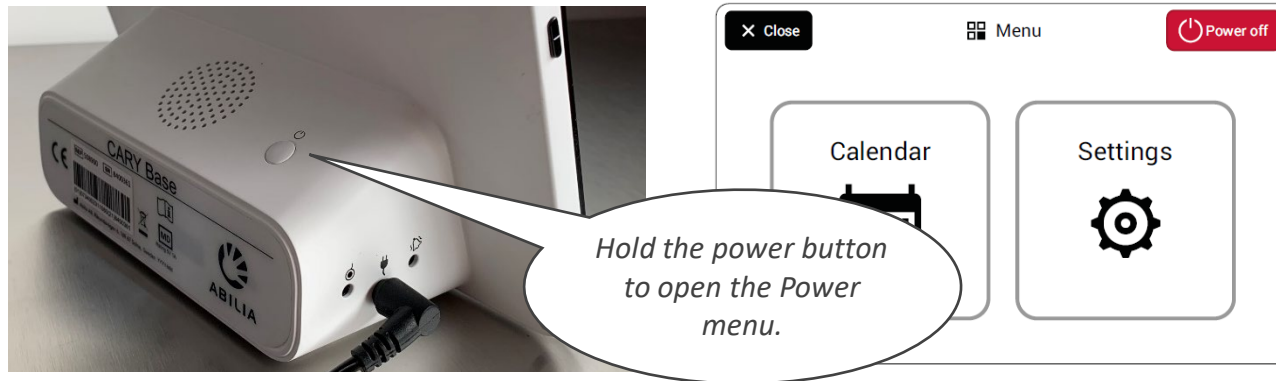

2. If the unit is not connected to the Internet, select **Internet** and select an available wireless network (Wi-Fi).
3. Select **myAbilia**.
4. Enter your username and password and select **Log in**.
5. Select **Back** and then **Close** to get back to the main view.

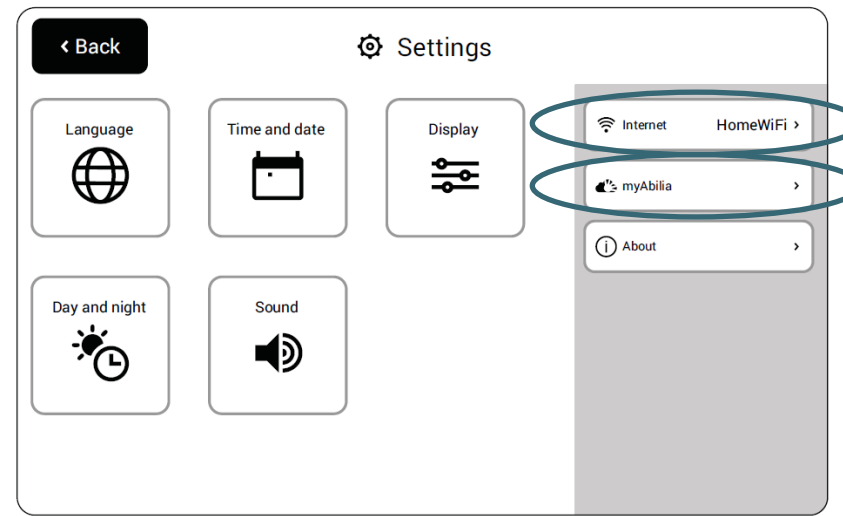

Add activities

1. Log in to www.myabilia.com with your user account.
2. Tap directly in the calendar to select **Date** and **Start time** of the activity.
3. Enter the name of the activity in the **Name** field.
4. Add a **Picture** and **Description** to the activity (optional).
5. Select to play a **message** or **text** when the reminder is shown (optional).
6. Select **Create** to save the activity.



CARY New Activity

Name & Picture **Recurrence**

Picture: 

Name: Walk the dog

Date: 2023-02-09

Description: Don't forget dog poop bags

Start time: 15:30

Record message

Extra settings: Show in dayplan Play text at alarm

Cancel Create

Message =
Recorded sound or reading of text (Name and Description)

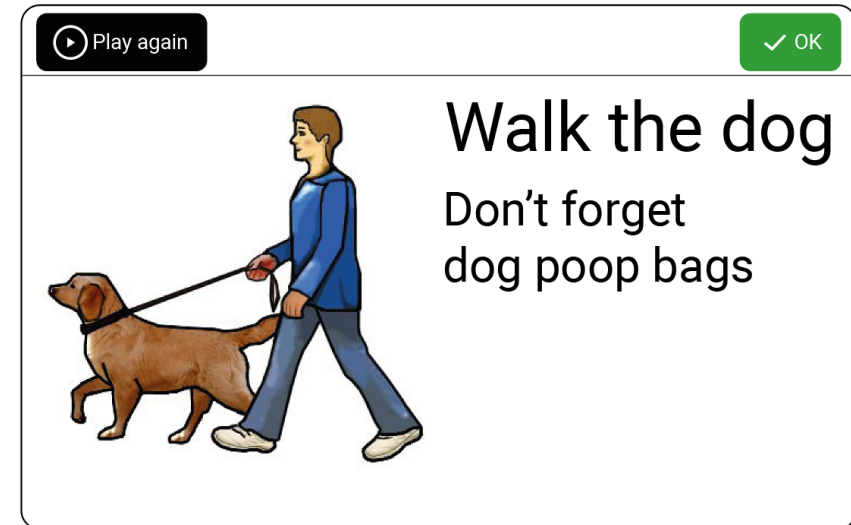

Name

Description

Picture =
Picture from the image archive or your own photo.

How myAbilia works

Add an activity in CARY Base through myAbilia

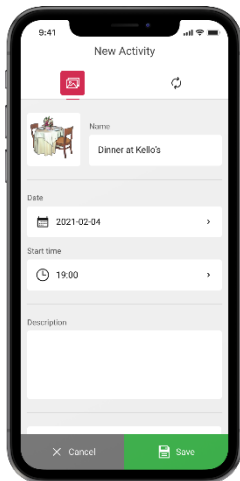

The activity shows in CARY Base



CARY Base is updated:
- Every five minutes
- When you tap Calendar