



SOLD SEPARATELY

**DRINK-MIX
 READY**
 USE ELECTROLYTES
 AND OTHER DRINKS
 IN YOUR PURENOVA!

Active Technology:

Electroadsorption, ultra-powdered activated carbon.

BPA free materials: Yes

Size: 2.3"(5.9 cm) H x 3.1" (7.9 cm) W

Weight: 3.8 oz (108 g)

Fast Flow Rate: 8 seconds per 24oz (5 liters/minute)

Lifespan: 500 presses (355L/93 gal)

Shelf Life: Stored under proper conditions, an unopened Cartridge has a shelf life of 10 years. After a cartridge has been used, it lasts at least 3 add'l years.



REMOVES

VIROSES (99.99%)

ROTAVIRUS,NOROVIRUS,HEPATITIS A

BACTERIA (99.9999%)

E.COLI,SALMONELLA,DYSENTERY

PROTOZOA (99.9%)

GIARDIA,CRYPTOSPORIDIUM,AMOEBAE

FILTERS

PARTICULATES

MICROPLASTICS,SEDIMENT,SILT

CHEMICALS

CHLORINE,BENZENE,CHLOROFORM

HEAVY METALS

LEAD,ARSENIC,CHROMIUM

TECHNOLOGY

CARTRIDGE LIFESPAN

The lifespan of a Cartridge varies with the quality of the water sources: the clearer, the better. High levels of silt or sediment will shorten the lifespan of the cartridge. Typically, when using clear water, a cartridge will be effective for ~500 cycles (355L / 93 gal). As* press time* reaches ~25 seconds (or three years have elapsed since first use)!t's time to replace your cartridge.Cartridge continues to protect, even as press time increases.



500 PRESSES
355L /93 GAL
5L /MIN

WowPress
8 SECONDS

CARTRIDGE REMOVAL

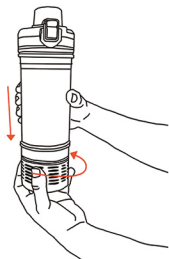

REMOVAL

Firmly grasp Inner Press. Rotate the cartridge **COUNTER-CLOCKWISE** until it separates from the Inner Press.

CARTRIDGE INSTALLATION



INSTALLATION

Firmly grasp Inner Press, then insert Cartridge into bottom of the Inner Press.

CAUTION: Proper installation of cartridge prevents cross-contamination.

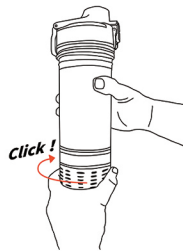

IMPORTANT: LOCK CARTRIDGE

Rotate cartridge clockwise until you feel it **CLICK** and **LOCK INTO PLACE**. If the cartridge is not locked, it can fall off during use.

PRECAUTIONS

FRESHWATER ONLY

Use freshwater only (no other liquid). NO salt or brackish water.

CROSS-CONTAMINATION

Do not expose/fill the Inner Press with untreated water, cross contamination may occur. If this does happen, disassemble and wash WowPress (not Cartridge) with soapy water and rinse thoroughly. Alternatively, thoroughly dilute potential contaminants by pressing (and agitating) water through the WOWPRESS Cartridge 5-7 times.

SOURCING THE BEST WATER

Always begin with the cleanest (least silty) water available. For instance, streams are generally better than lakes and bogs (which are often have higher levels of sediment and tannins).

CYANOBACTERIA HIGH LEAD LEVELS, MERCURY, ETC.

Cartridges are designed to remove trace levels of chemicals and heavy metals. The WowPress was NOT designed to protect against industrial disasters, coal ash spills, very high lead levels, mercury, nuclear disasters or toxic blue-green algae (cyanobacteria), etc. Find another water source in these situations.

CAUTION WITH TANNINS

Tannins are natural organic compounds that leach from decomposing vegetation and trees and can cause Cartridges to prematurely stop working. In high concentrations, tannins are easily recognizable, as they turn water tea-colored and form blackwater rivers. Do not use WowPress in water with high tannins.

NO FREEZING

Cartridges are not significantly degraded after one freeze/thaw cycle. However, don't use a cartridge after 3 or more freeze/thaw cycles. Protect your WowPress in freezing temperatures by keeping it full of water and insulate in a jacket or sleeping bag.

NO HOT (OR BOILING WATER) OR MICROWAVES.

Do not expose Cartridge to water hotter than 120°F (50°C), it will harm purifier media. Do not put the WowPress in the microwave.

CARE BETWEEN USES

DON'T USE SOAP ON CARTRIDGE.

Do not wash the Cartridge with soap or other cleaning agents. Soap will damage the purifier media. You may rinse the Cartridge with clean water as needed.

PROPER CARE & STORAGE.

For long-term storage, prepare the WOWPRESS Bottle to prevent growth of mildew and odors. Thoroughly dry Cartridge by performing one 'dry press' by pressing the wet Cartridge into an empty (no water) Outer ReFill and dump excess water. Allow Cartridge to air-dry thoroughly (depending on humidity it will take 2-4 days to completely dry). Hand wash all other parts with warm, soapy water. Reassemble unit to create air tight seal for storage. Cartridges can last up to three years after opening if cared for properly between uses.

WE HAVE YOU COVERED

WARRANTY

Every Purenova is accompanied by a one (1) year warranty covering workmanship and materials.

TESTING STANDARDS

Meets or exceeds the United States Environmental Protection Agency's Water Purifier standard for microbiological filtration.

QUESTIONS

For answers to the most common questions, live chat, and product support, please visit www.thepurenova.com/help

INTERNATIONAL MANUALS.

Manual/ Handbuch /Manuali/ Manuals /
www.thepurenova.com/manuals



SCAN WITH YOUR PHONE

LET'S GO!

Get detailed video instruction on this product

www.thepurenova.com
info@thepurenova.com