

# SDD1-20-275

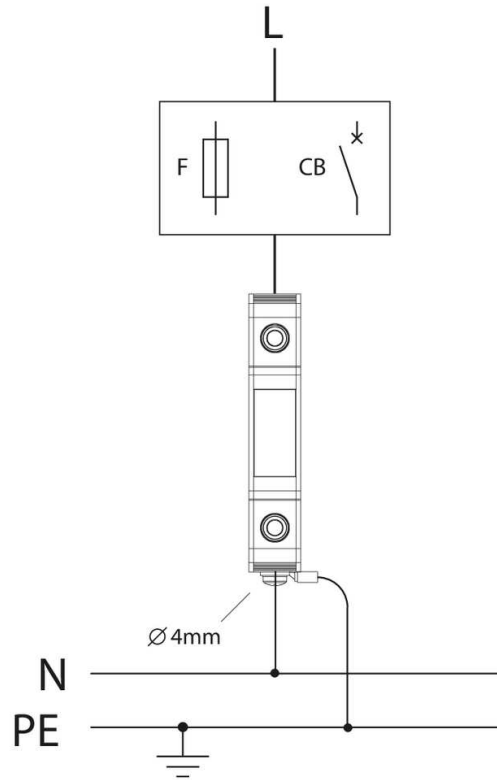

## Installation



## Terminal Information

Terminal Type	
min Capacity	2.5 mm <sup>2</sup>
max Capacity	16 mm <sup>2</sup>
Torque	2 Nm
Wire Striping Length	12mm

## Dimensional Diagram

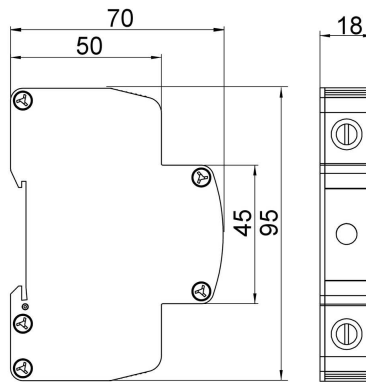

## Mounting

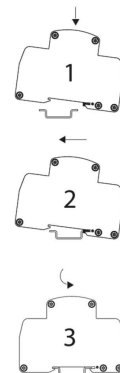

## Electrical Specifications

Connection type		Shunt
Modes of protection		L-N, L-PE, N-PE
Number of ports		1
Location		Indoor
Nominal voltage	$U_0$	230VAC
Short circuit withstand level	$I_{SSCR}$	25kA
Maximum backup fuse		16A
Recommended SCB		SCB1-3-80
Earth leakage current	$I_{PE}$	<10µA

## Indication Specifications

Display		LED power and thermal failure
---------	--	-------------------------------

## Mechanical Specifications

Minimum operating temperature		-40°C
Maximum operating temperature		70°C
Minimum operating humidity		5%
Maximum operating humidity		95%
Mounting method		TS35 DIN Rail
Environmental rating		IP20

# SDD1-50-275



## Installation

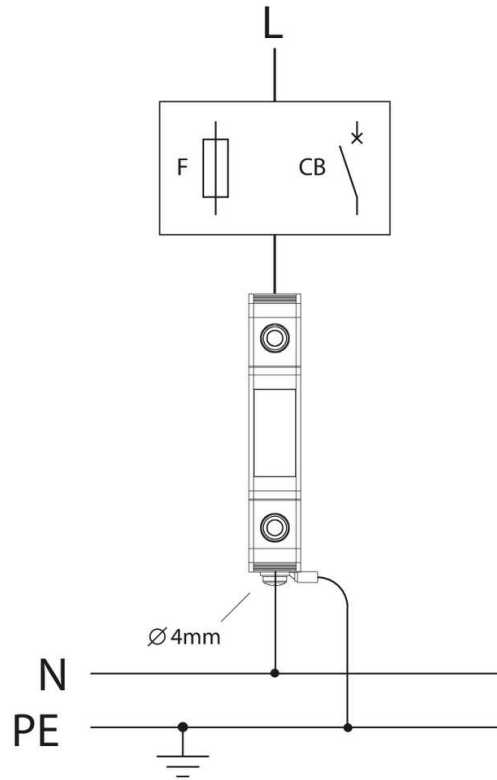

## Terminal Information

Terminal Type	
min Capacity	2.5 mm <sup>2</sup>
max Capacity	16 mm <sup>2</sup>
Torque	2 Nm
Wire Striping Length	

## Dimensional Diagram

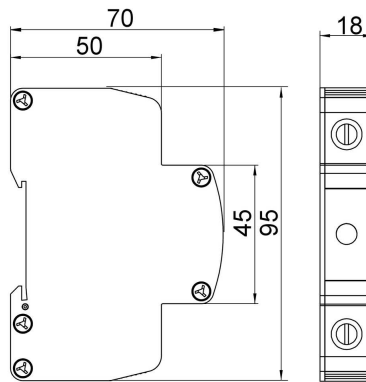

## Mounting

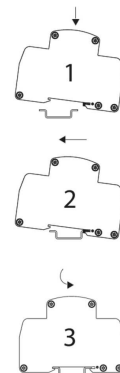

### Electrical Specifications

Connection type		Shunt
Modes of protection		L-N, L-PE, N-PE
Number of ports		1
Location		Indoor
Nominal voltage	$U_0$	230VAC
Short circuit withstand level	$I_{SSCR}$	25kA
Maximum backup fuse		32A
Recommended SCB		SCB1-3-80
Earth leakage current	$I_{PE}$	<10µA

### Indication Specifications

Display LED power and thermal failure

### Mechanical Specifications

Minimum operating temperature		-40°C
Maximum operating temperature		70°C
Minimum operating humidity		5%
Maximum operating humidity		95%
Mounting method		TS35 DIN Rail
Environmental rating		IP20

# SDD1-50-275-A



## Installation

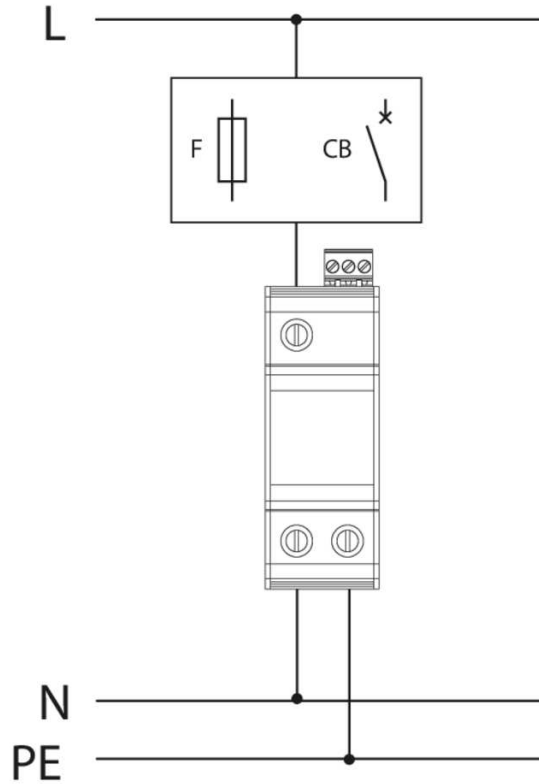

## Alarm

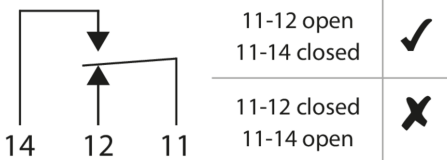

## Terminals

Terminal Type		
min Capacity	2.5 mm <sup>2</sup>	0.5 mm <sup>2</sup>
max Capacity	16 mm <sup>2</sup>	2.5 mm <sup>2</sup>
Torque	2 Nm	0.6 Nm
Wire Stripping Length		

## Mounting

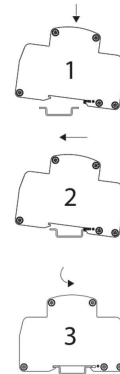

## Dimensions

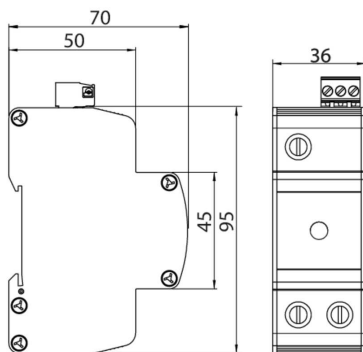

## Electrical Specifications

Connection type		Shunt
Modes of protection		L-N, L-PE, N-PE
Nominal voltage	$U_0$	230VAC
Short circuit withstand level	$I_{SSCR}$	25kA
Maximum backup fuse		32A
Recommended SCB		SCB1-3-80
Earth leakage current	$I_{PE}$	<math>< 10\mu A</math>

## Mechanical Specifications

Minimum operating temperature		-40°C
Maximum operating temperature		70°C
Minimum operating humidity		5%
Maximum operating humidity		95%
Mounting method		TS35 DIN Rail
Environmental rating		IP20

# SDD1-100-275

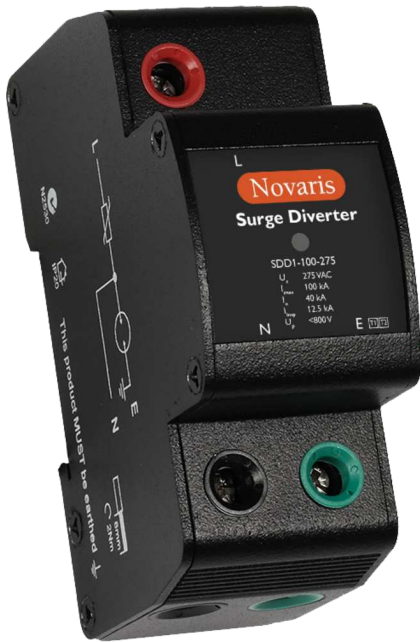

## Installation

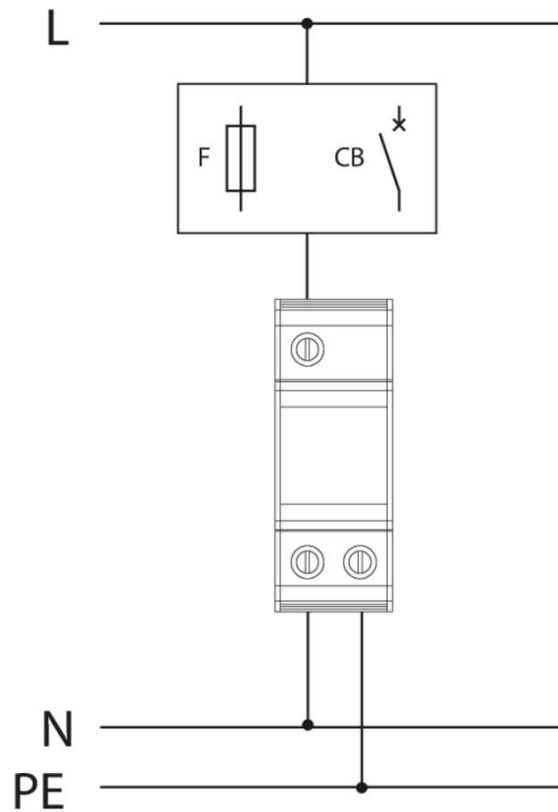

## Terminal Information

Terminal Type	
min Capacity	2.5 mm <sup>2</sup>
max Capacity	16 mm <sup>2</sup>
Torque	2 Nm
Wire Stripping Length	12mm

## Dimensional Diagram

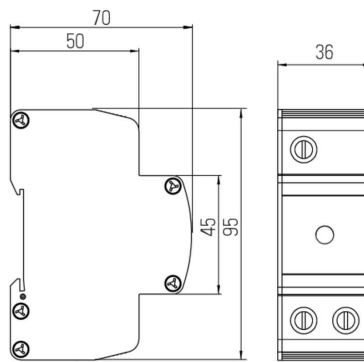

## Mounting

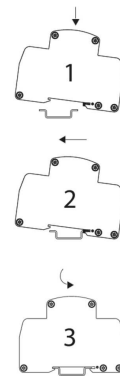

### Electrical Specifications

Connection type		Shunt
Modes of protection		L-N, L-PE, N-PE
Number of ports		1
Location		Indoor
Nominal voltage	$U_0$	230VAC
Short circuit withstand level	$I_{SSCR}$	50kA
Maximum backup fuse		63A
Recommended SCB		SCB1-3-80
Earth leakage current	$I_{PE}$	<10μA

### Indication Specifications

Display		LED power and thermal failure
---------	--	-------------------------------

### Mechanical Specifications

Minimum operating temperature		-40°C
Maximum operating temperature		70°C
Minimum operating humidity		5%
Maximum operating humidity		95%
Mounting method		TS35 DIN Rail
Environmental rating		IP20

# SDD1-100-275-A



## Installation

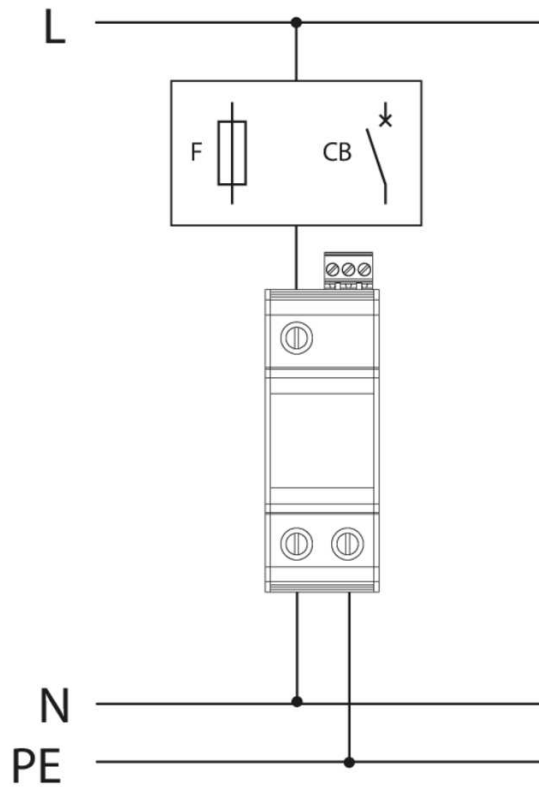



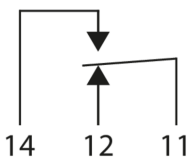

## Alarm



11-12 open	✓
11-14 closed	✓
11-12 closed	✗
11-14 open	✗

## Terminals

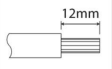
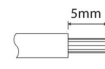
Terminal Type		
min Capacity	2.5 mm <sup>2</sup>	0.5 mm <sup>2</sup>
max Capacity	16 mm <sup>2</sup>	2.5 mm <sup>2</sup>
Torque	2 Nm 	0.6 Nm 
Wire Stripping Length		

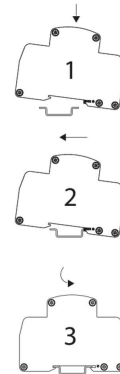

## Mounting



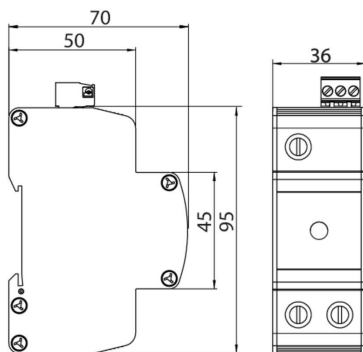





## Dimensions



## Electrical Specifications

Connection type		Shunt
Modes of protection		L-N, L-PE, N-PE
Nominal voltage	$U_0$	230VAC
Short circuit withstand level	$I_{SSCR}$	50kA
Maximum backup fuse		63A
Recommended SCB		SCB1-3-80
Earth leakage current	$I_{PE}$	<math>< 10\mu A</math>

## Mechanical Specifications

Minimum operating temperature		-40°C
Maximum operating temperature		70°C
Minimum operating humidity		5%
Maximum operating humidity		95%
Mounting method		TS35 DIN Rail
Environmental rating		IP20