

User Manual

Hard Shell Roof Top Tent

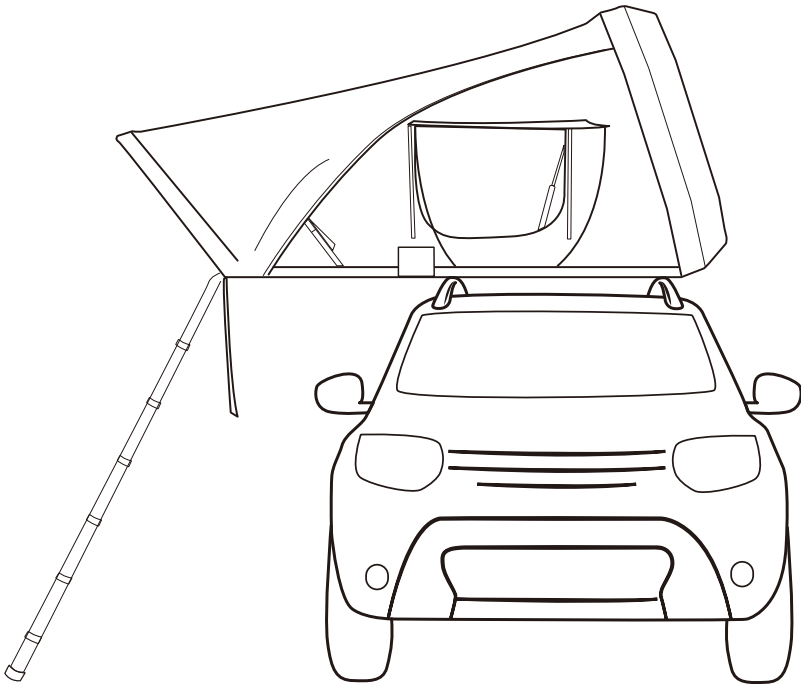

Contents

User Manual English

Precautions		02, 03
Specifications	• Introduction of Roof Tent	04
	• What is Included	05
Mounting	• Installation Guide	06, 07, 08
Use	• Opening the Tent	9, 10, 11
	• Tension poles installation	12
	• Use the Ladder	13, 14
	• Closing the Tent	15



Our products aim to make outdoor activities more convenient. Strict quality control and inspection ensure the production of safe products. However, outdoor activities always carry risks, and you should always pay attention to your own safety. Improper installation or misuse of products may result in serious personal injury or death, not just property damage or personal injury. In some cases, your safety depends on your abilities and experience. Therefore, it is important to always pay attention to the surrounding environment and weather conditions. Please carefully follow the installation manual to ensure the correct installation and safe use of the product, and use it within the capacity and durability limits of the equipment. If you have any questions about installation or use, please contact us.

Before

- Make sure you have all the components after purchase.
- Please be careful when moving the product as it is heavy.
- Be sure to wear safety gloves and protective shoes.
- If you have any health issues, do not attempt to install the product yourself.
- The roof rack of some vehicles may not be suitable for installing roof top tents.
- Please be fully familiar with the mounting method when you mount the product by yourself.

Mounting

- Please note that excessive force on the product during installation may cause damage.
- Using damaged products may lead to accidents and/or injuries. Contact us if you believe that your product is damaged.
- Please ensure the ladder locks are securely locked when using the ladder. Failure to follow this procedure can lead to physical injuries.
- The ground in which the tent is installed should be flat and firm and should be avoided under the following conditions: slippery places where the ladder is at risk of being moved, such as rocks, sand, mud, gravel, or angled surfaces.

Driving

- Please ensure that the mounting brackets are tightened and the tent is securely mounted before driving off.
- The maximum speed recommended is 70 mph (110 km/h).
- The speed of the vehicle may vary depending on the driving conditions such as type of road, condition of the road, weather (wind, rain) and speed limits.
- Be sure to slow down when driving on uneven roads or over speed bumps.
- For vehicles with weak roof racks, special care is required as the roof rack may be broken while driving.
- Do not drive the vehicle with the tent open.

Use

- Do not leave your children alone in the tent.
- Be extra careful when using the ladder the ladder steps can be slippery due to rain, mud, dirt and/or ice.
- Do not use flammable liquids or objects inside the tent.
- Do not set up the tent near a campfire or fire pit. Embers are very likely to cause holes in the fabric, which can lead to a fire.
- The composition of the fabric of the tent is a poly-cotton blend, and it can be affected by moisture on parts of the fabric depending on the amount of rain or time exposed to rain. This is not a product defect and is a natural phenomenon due to the characteristics of the cotton canvas fabric. Please be sure to dry or wipe it with a dry cloth before closing the tent.
- Please refrain from using it in bad weather conditions (hurricanes, heavy rain, storms, heavy snow, etc.).

Maintenance

- Please store the tent in a dry area.
- Long-term storage in wet and humid conditions can cause fungus, odor, and discoloration, which can shorten the lifespan of the product.
- Do not leave any contaminants or foreign substances, inside of the tent as these can damage the product.

Introduction

User Manual English

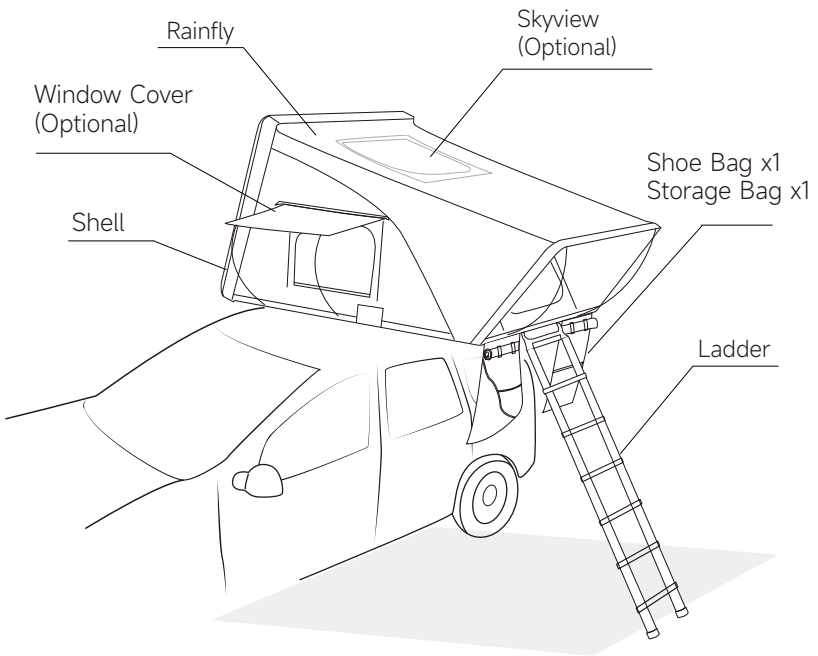

Components

(Optional Roof Rack)

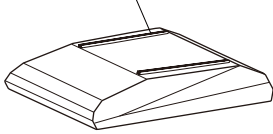

Tent x1

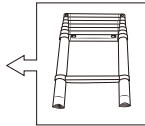

Ladder x1



Tension Pole x6 (with window cover)
Tension Pole x2 (without window cover)
Tension Pole Bag x1

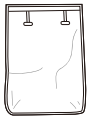

Shoe Bag x1



Storage Bag x1

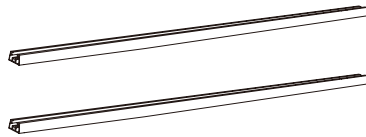

Mounting Rail x2

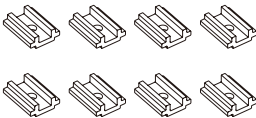

Slider x8



Wrench x1

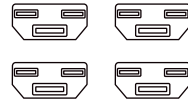

Rail Cap x1

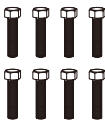

Screw x8



Nut x8

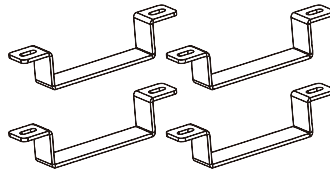

Mounting Bracket x4

Installation Guide

User Manual English

- ① It requires 4 people to lift the tent and install it from the side of the vehicle.
- ② Grasp the bottom panel of the tent and lift it up to waist level.
- ③ Lift the tent over your shoulders and then over your head.
- ④ Gently lift the tent from the back to the front on roof racks of the car.

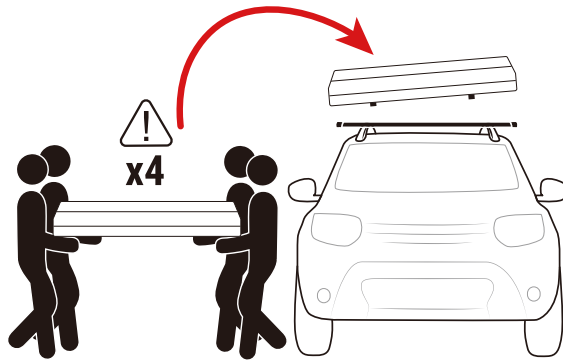

- ⑤ Make sure that the tent is almost centred top of the car, and 4 corners are at the same height. (Note the trunk opening and closing distance)

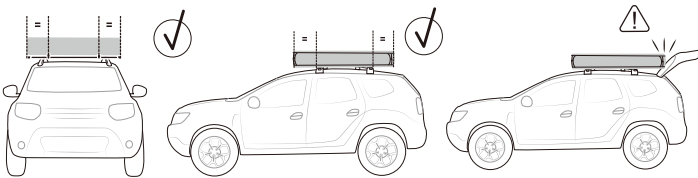

- ⑥ Insert 2pcs of sliders and screws into the mounting rails under the tent.

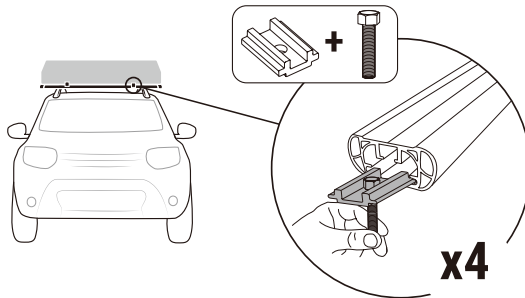

- ⑦ One person lifts the tent and the other slides the sliders over the mounting rails so that there is one on each side.
- ⑧ Attach the brackets under the mounting rails and let the sliders pass through.

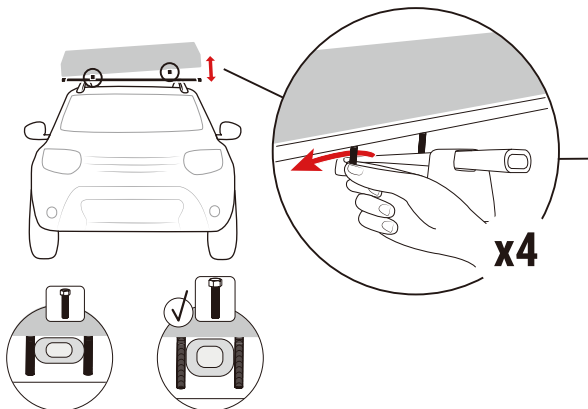

- ⑨ Place one nut on one screw and tighten with wrench, note that the two nuts should be tightened simultaneously.

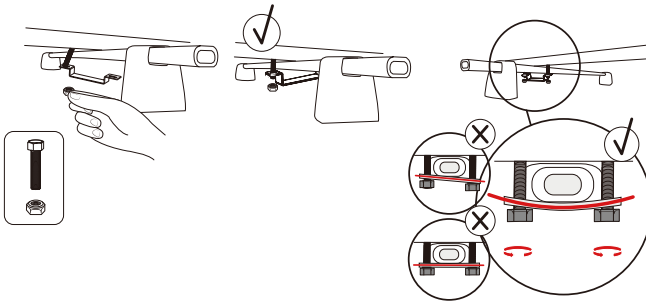

- ⑩ Repeat steps 6-10 above to complete the installation of the other three brackets.

Warning: During the installation, make sure each bracket is firmly mounted. Otherwise, it may result in tent damage, physical injuries even the risk of death.

Note: After driving a certain distance, check whether the tent is securely installed and must be checked regularly. If necessary, tighten the bracket again to ensure it is secured.

Use

User Manual English

① Open buckles / locks and velcro straps.

- Option ①
- Option ②
- Option ③

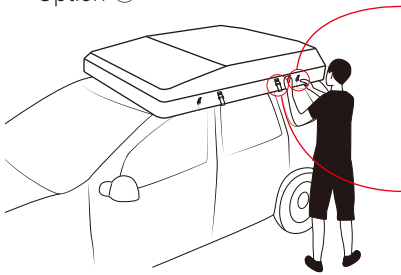

Option ①

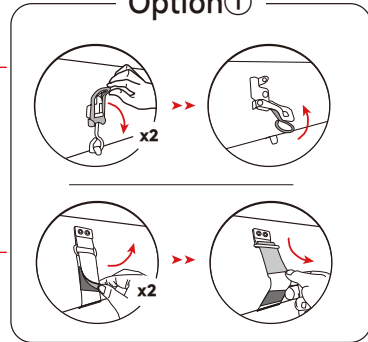

Option ②

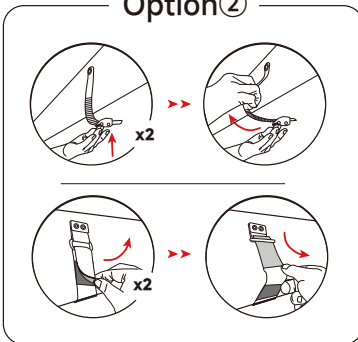

Option ③

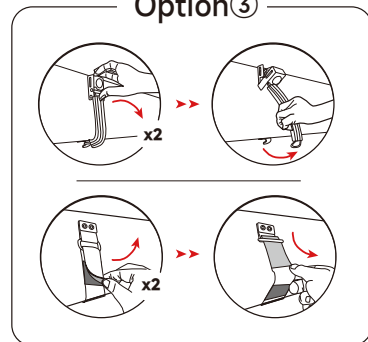

② Push the shell upwards, it will open automatically.

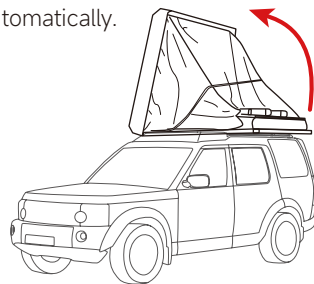
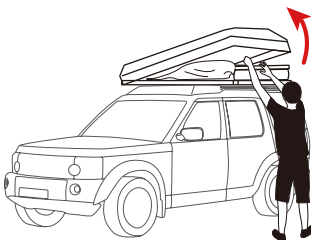

- ③ Open ladder cover cloth, unclip the ladder belt buckle and extend the ladder to the longest.

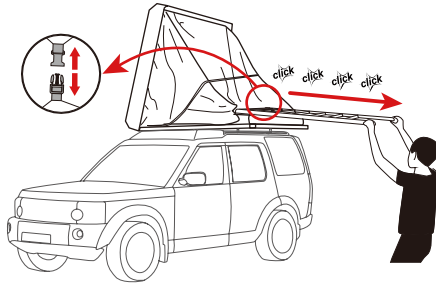

- ⑤ Grasp the bottom of the ladder with 2 hands, to flip the bottom panel.

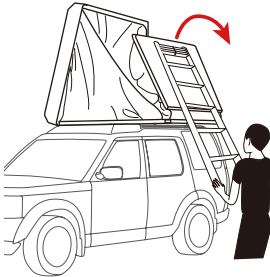

- ⑥ Ladder as the support, gently put down the bottom panel, and place ladder stably.

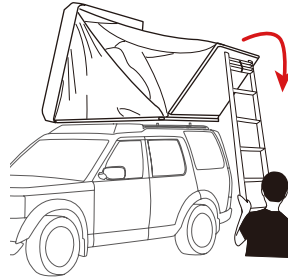

Warning: Make sure the ladder is firmly placed, and it is recommended that the ladder be approximately 70 degrees above the ground.

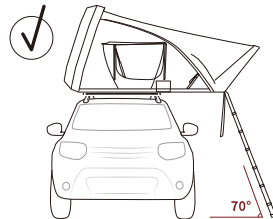
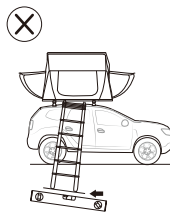
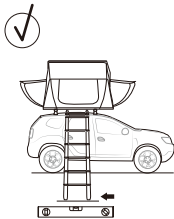

- ⑦ After the ladder is firmly installed, enter the interior of the tent.

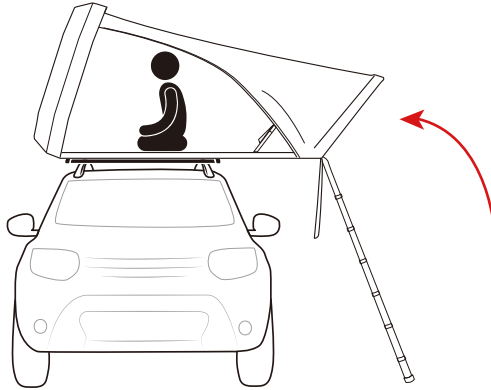

- ⑧ Install safety support on gas spring.

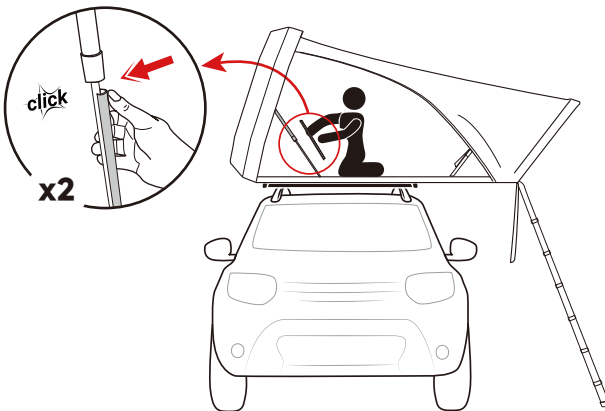

Tension poles installation

- ① Take out the tension poles from the bag.

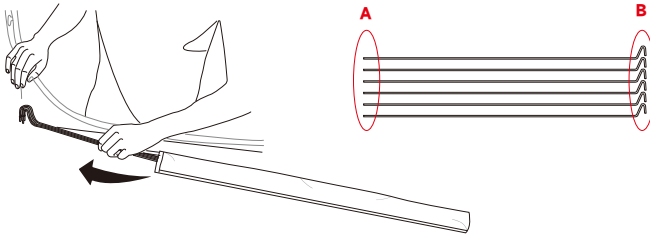

- ② Firstly, insert the **A end** into the hole reserved on the bottom panel, rotate the **B end** with the bent hook facing downward, then insert the **B end** with the bent hook into the metal hole on the rainfly. Follow this way to install the rest of tension poles.

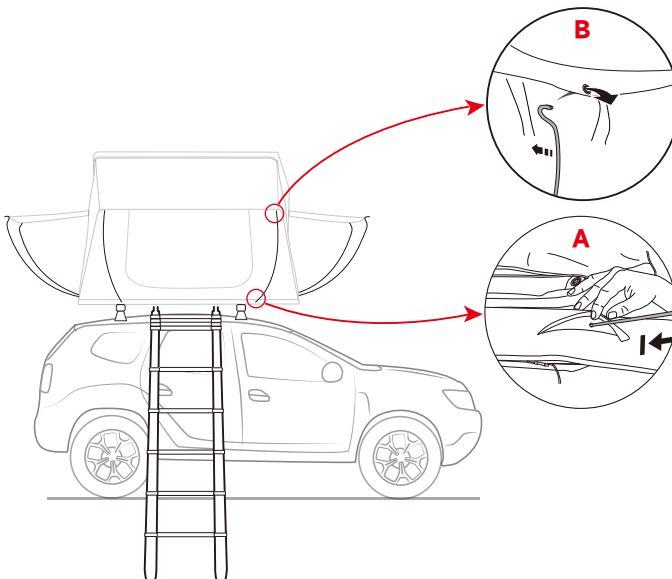

Use the ladder

- ① When using a ladder, press the unlock button with both hands to retract the entire ladder.
- ② Retract all ladder parts from bottom to top.

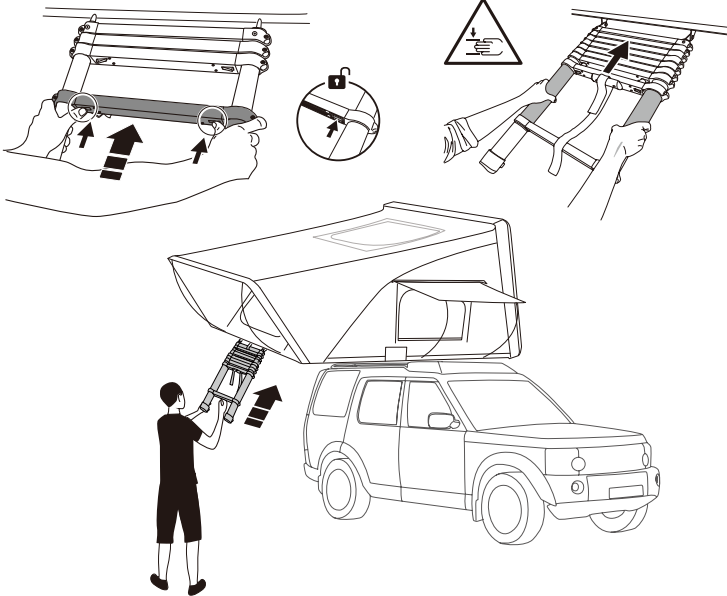

- ③ Press the unlock button with both hands simultaneously, and lower the ladder section one by one, make sure every section is securely locked.
- ④ Keep the upper ladder sections tightly attached.

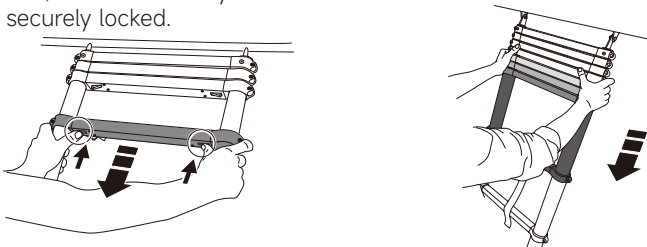

Warning: Make sure the ladder is firmly placed, and it is recommended that the ladder be approximately 70 degrees above the ground.

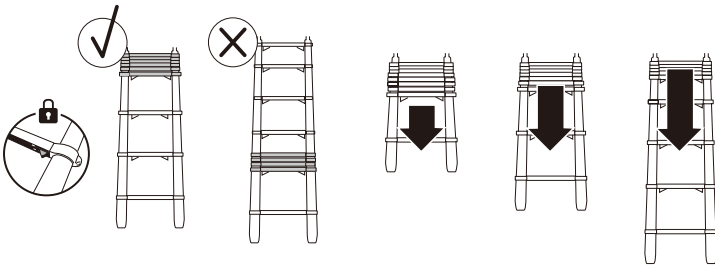

Suggestion: For your physical safety, please check if there is any damage of the ladder.

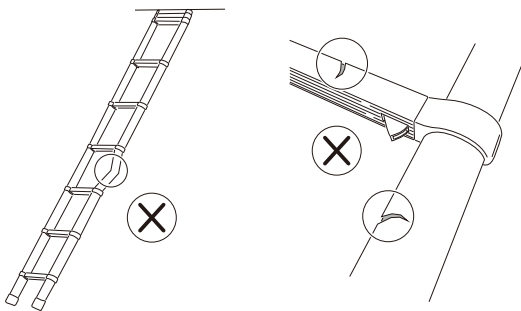

Closing the Tent

- ① Take off safety support on gas-spring, take off all tension poles.

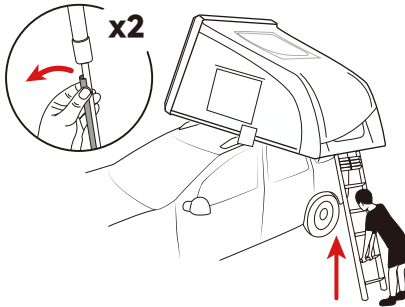

- ② Push the bottom panel into the tent by ladder.

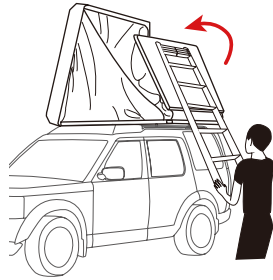

- ③ Unlock the ladder lock, retract all ladder sections from bottom to top, and then buckle the belt.

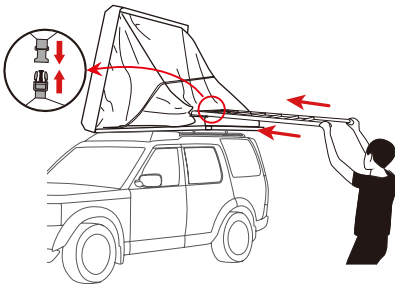

- ④ Grasp the black strap on shell and pull down to close the tent.

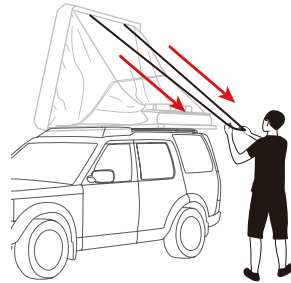

- ⑤ Put the rest parts of tent fabrics into shell.

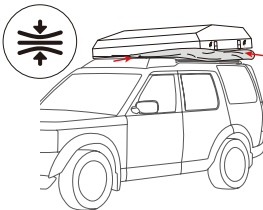

- ⑥ Locking buckles / locks and velcro straps.

