

PET DRYING BOX USER MANUAL

BASIC PARAMETER INFORMATION

Product size	45.1x43.2x46 (cm)
Folded size	45.1x43.2x20.5 (cm)
Net weight	3.9kg
Gross weight	4.7kg
Product volume	62L
Product material	PP+ABS
Product color	White
Scope of application	Cats and dogs (within 20 catties)

MAINTENANCE AND CLEANING

- Please do not use boiling water to sterilize products, plastic net can be used boiling water for sterilization.
- Please do not place the products in direct sunlight, in order to avoid accelerating the product aging.
- Please disassemble the temperature display before cleaning whole product.
- Please do not use gasoline, kerosene, polishing powder, bleach and other chemical reagents to clean the products.
- For daily maintenance, use a soft cloth rinsed with warm water to wipe the stains on the surface of products (please remove the temperature display first).
- If the product is not used for a long time, please clean it up and put the all component into the packaging box according to the original packaging sequence after drying.
- Store in a dry place for safekeeping.

PARTS LIST

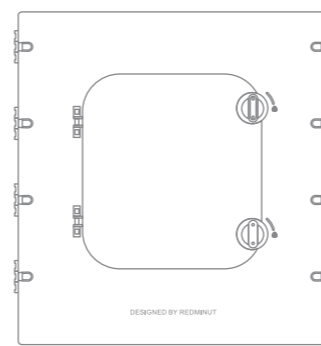

Folding case x 1



Small air duct fitting
Component x 1
42mm



Large air duct
Connector x 1
50mm

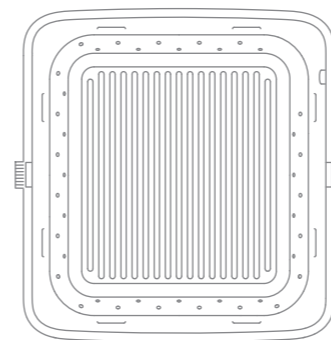

Base x 1



Plastic net x 1

PRODUCT LIST

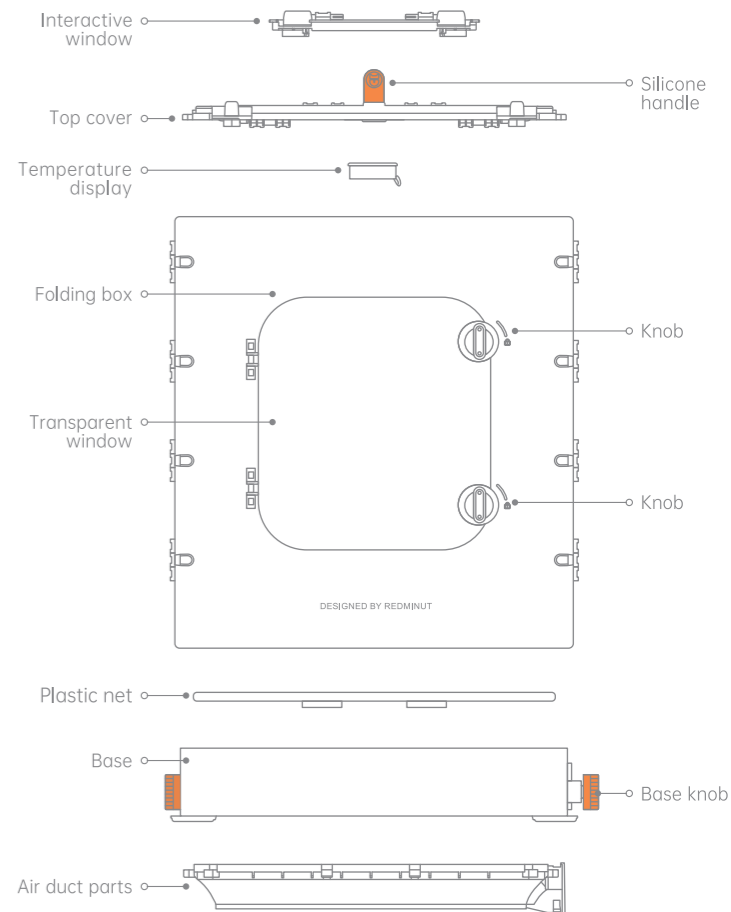

INSTRUCTIONS FOR USE

* 1. Use our smart pet blower

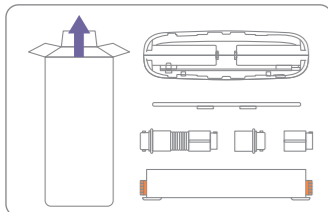

1 Unpack the box and take out the folding box, plastic net, base and all accessories in turn, and prepare the smart pets blower;

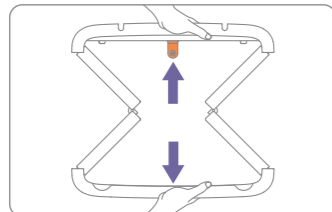

2 Choose the folding box, grab the front and rear panels with both hands, and pull them out to both sides;

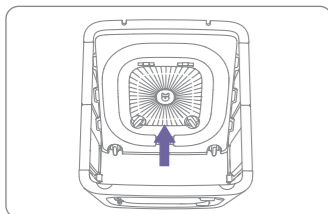

3 Grasp the handle of the top cover, lift the top cover to the top, and rotate the left and right turn buttons on the top according to the icon to fix the top cover;

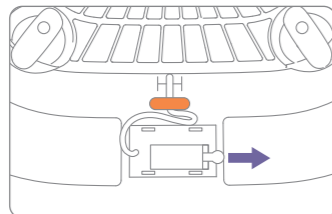

4 Take out the thermometer PVC battery insulation sheet, only for the first time using;

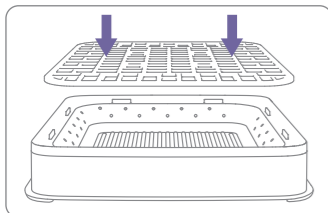

5 Put the plastic net into the base, as shown in the picture;

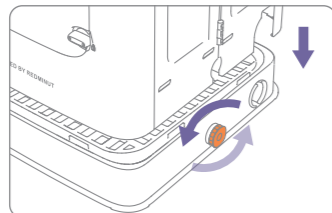

6 Rotate the bottom knob according to the unlock icon, and then lift the opened folding box with both hands, align the direction, put box on the base;

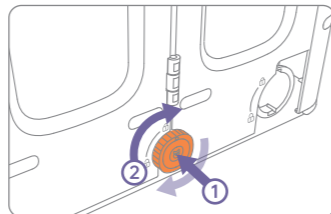

7 While pressing the knob on one side of the bottom, rotate the turnbuckle 90° in the direction indicated by the icon, and similarly on the other side, lock the base and the folding box;

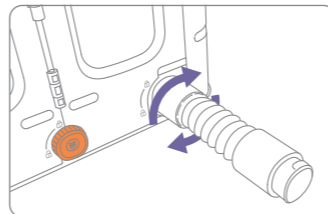

8 Connect one small air duct connector to the air inlet of the drying box;

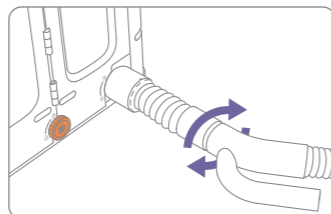

9 Connect the special connector to the smart pets blower;

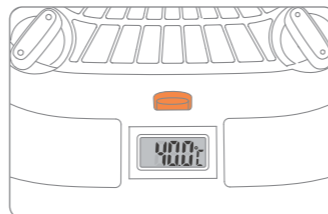

10 Turn on the smart pets blower to preheat the interior of the drying box, and it is recommended to keep the temperature between 35°C and 40°C;

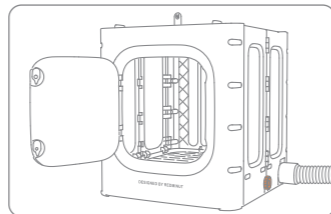

11 Rotate the transparent window knob according to the direction indicated by the icon, open the transparent window, and put the pet into the drying box;

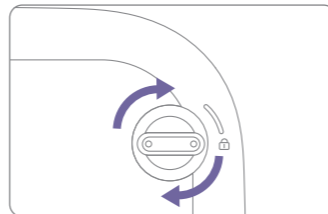

12 Close the transparent window, rotate the knob to lock the window in the direction indicated by the icon.

Special Note: The internal temperature of the drying box is recommended to be 35°C-40°C. Please do not leave it when using it to avoid accidents for pets.

Soothing: During the drying process, you can open the interactive window for comforting according to the pet's condition.

Combing: During the drying process, the pet can be released for combing according to the pet's condition, and then put back in the drying box.

* 2. Use other brand smart pet blower

Tip: Only the outer diameter of the duct is 42mm or 50mm

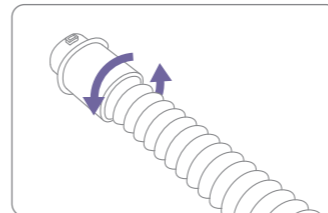

1 Connect the small air duct connector (large air duct connector) to the air pipe of the smart pets blower;

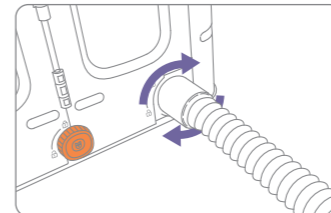

2 Fix the other end to the air inlet of the drying box.

STORAGE STEP DESCRIPTION

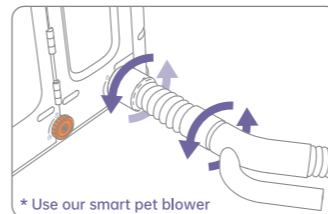

* Use our smart pet blower

*1 First unscrew the joint at one end of the fixed drying box, and then unscrew the joint at one end of the fixed air duct;

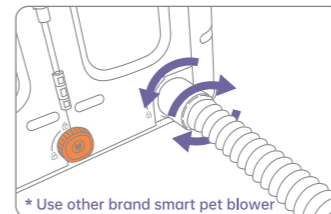

* Use other brand smart pet blower

*1 After unscrewing the end of the small (large) air duct joint that fixed the drying box, then unscrew the end of the fixed air duct;

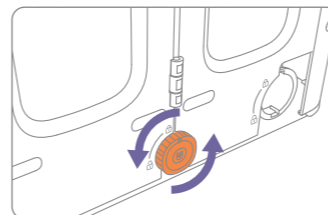

2 Directly rotate the left and right knobs at the bottom according to the direction indicated by the icon to release the fixation between the base and the folding box;

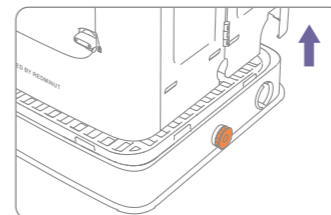

3 Lift the folding box with both hands and separate it from the base;

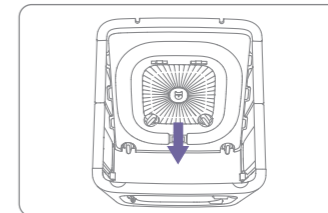

4 Grasp the handle of the top cover with one hand, rotate the left and right turn buttons on the top according to the icon instructions, lower the top cover to the bottom and release it, and then fold it;

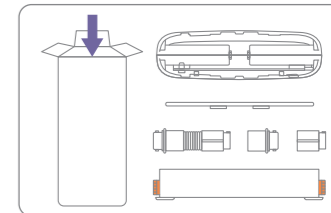

5 Put the folding box, plastic net, air duct joint and base into the storage box in turn.

CLEANING PET DRYING BOX

* 1. Folding box cleaning

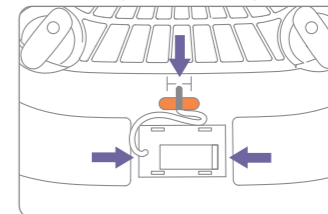

1 Pull out the temperature display probe and disassemble the temperature display;

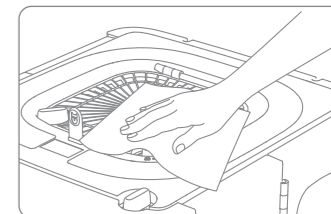

2 Wipe and clean the stains on the surface of the product with a soft rinsing cloth.

* 2. Base air duct cleaning

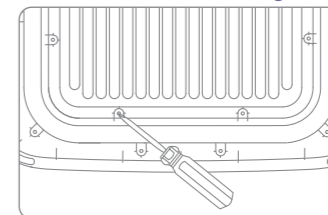

1 Turn the base over, unscrew the screw, and rinse the air duct with a tap;

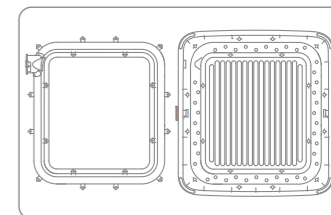

2 Dry the base and air duct, align the direction, assemble the base, and tighten the screws.