



## VESA Adapter for Samsung Monitors

32" CF397 and 24" CRG5

[www.humancentric.com/patents](http://www.humancentric.com/patents)

Model 101-1063

Full product specifications: [www.humancentric.com/101-1063](http://www.humancentric.com/101-1063)

Need help? Contact support: [support@humancentric.com](mailto:support@humancentric.com)



### WARNING



To reduce the risk of injury to persons, read all important precautions and warnings listed below. HumanCentric assumes no responsibility

for personal injury or property damage sustained by or through the use of this product:

1. Read all instructions carefully.
2. Incorrect installation may lead to damage or serious injury. Ensure the product is secured before use.
3. If using a VESA stand or VESA arm, ensure it can support the combined weight of the bracket, monitor, and any mounted devices.

### ADDITIONAL TOOLS REQUIRED

Phillips Head Screwdriver

### PARTS INCLUDED

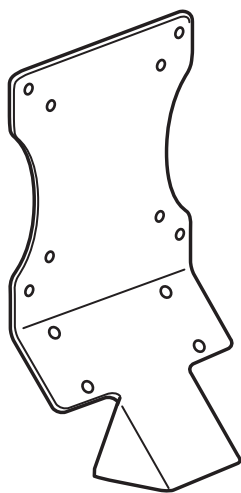

(A) VESA Adapter Bracket (x1)

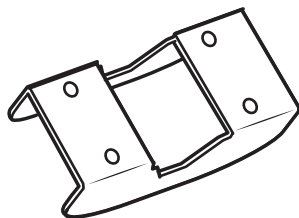

(B) Clamp Bracket (x1)



(C) M4 x 12mm Screw (x9)



(D) M4 Washer (x5)

1.

Secure the VESA Adapter Bracket (A) onto the monitor using (1) M4 x 12 mm screw(C) and (1) M4 washer(D).

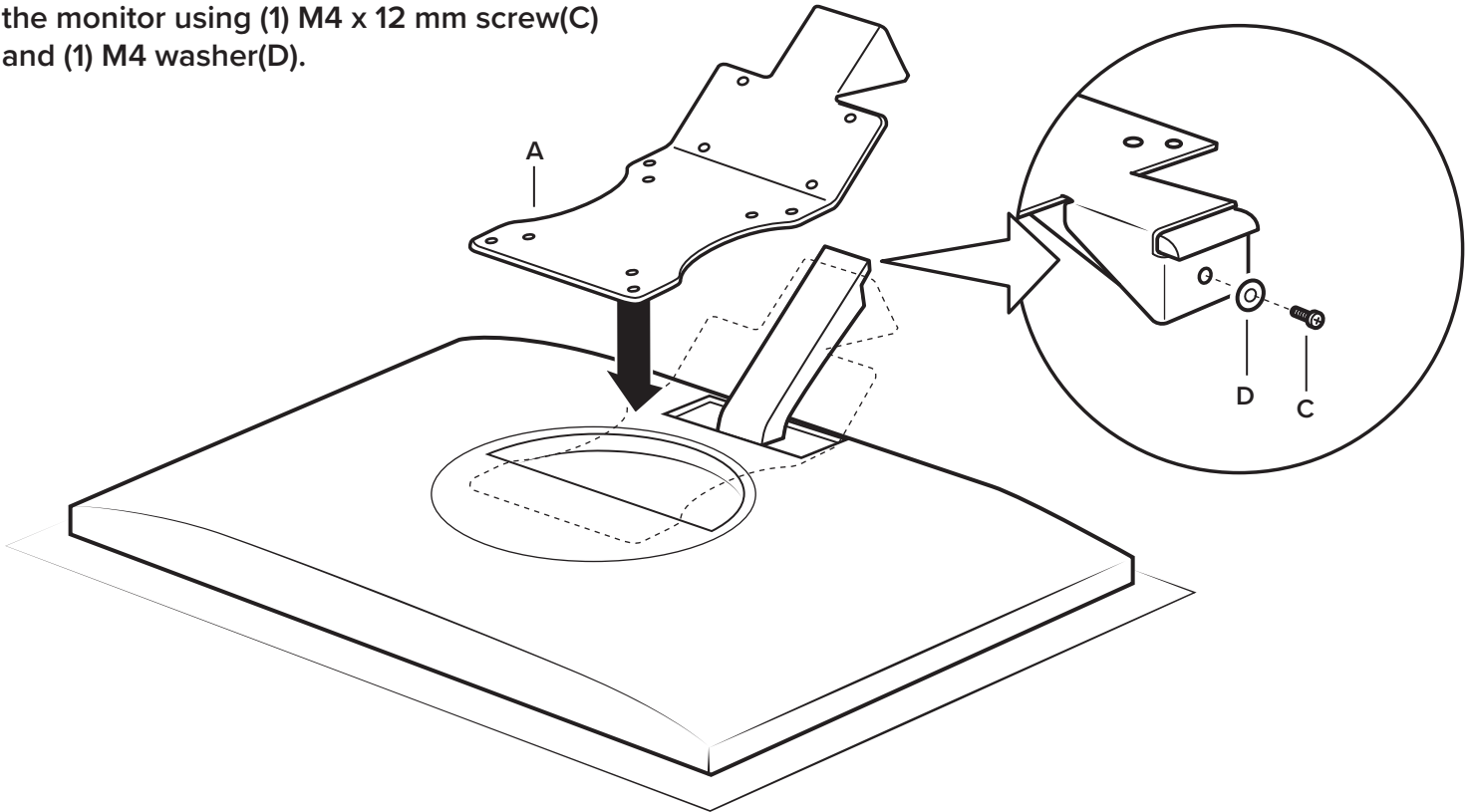

2.

Secure the Clamp Bracket (B) onto the VESA Adapter Bracket (A) using (4) M4 x 12 mm screws(C) and (4) M4 washers(D).

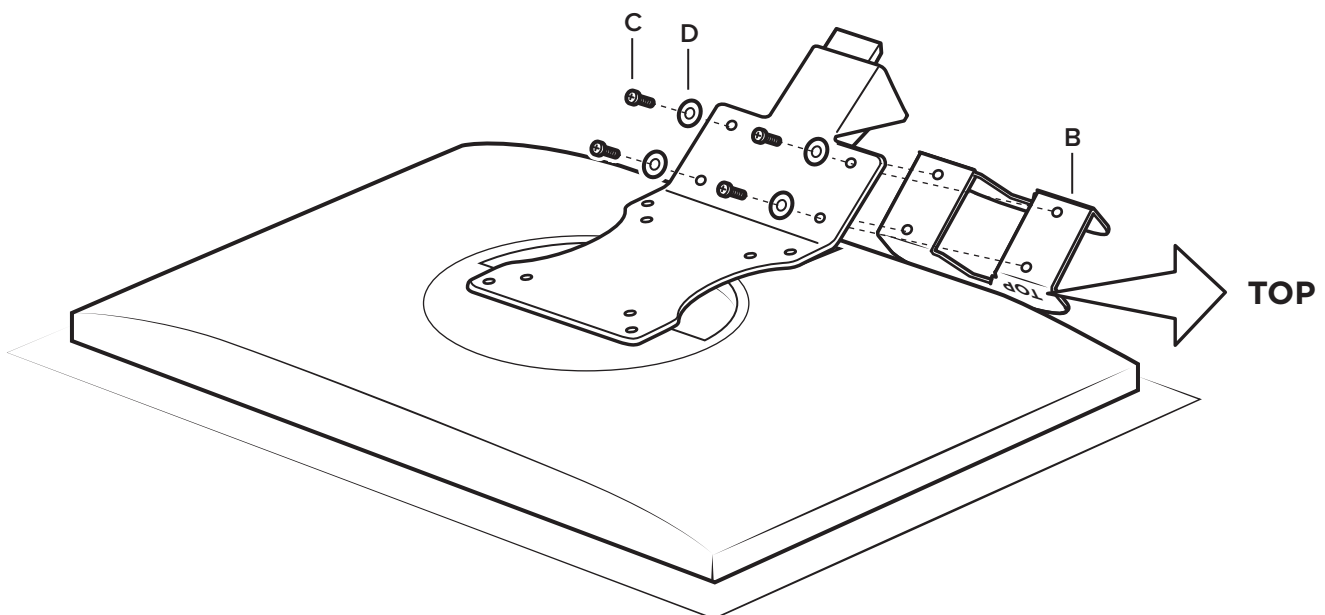

**Important:** Orientate the face labeled “TOP” on top.

3.

Mount the VESA Adapter Bracket (A) to your Monitor Arm using (4) M4 x 12mm screws(C).

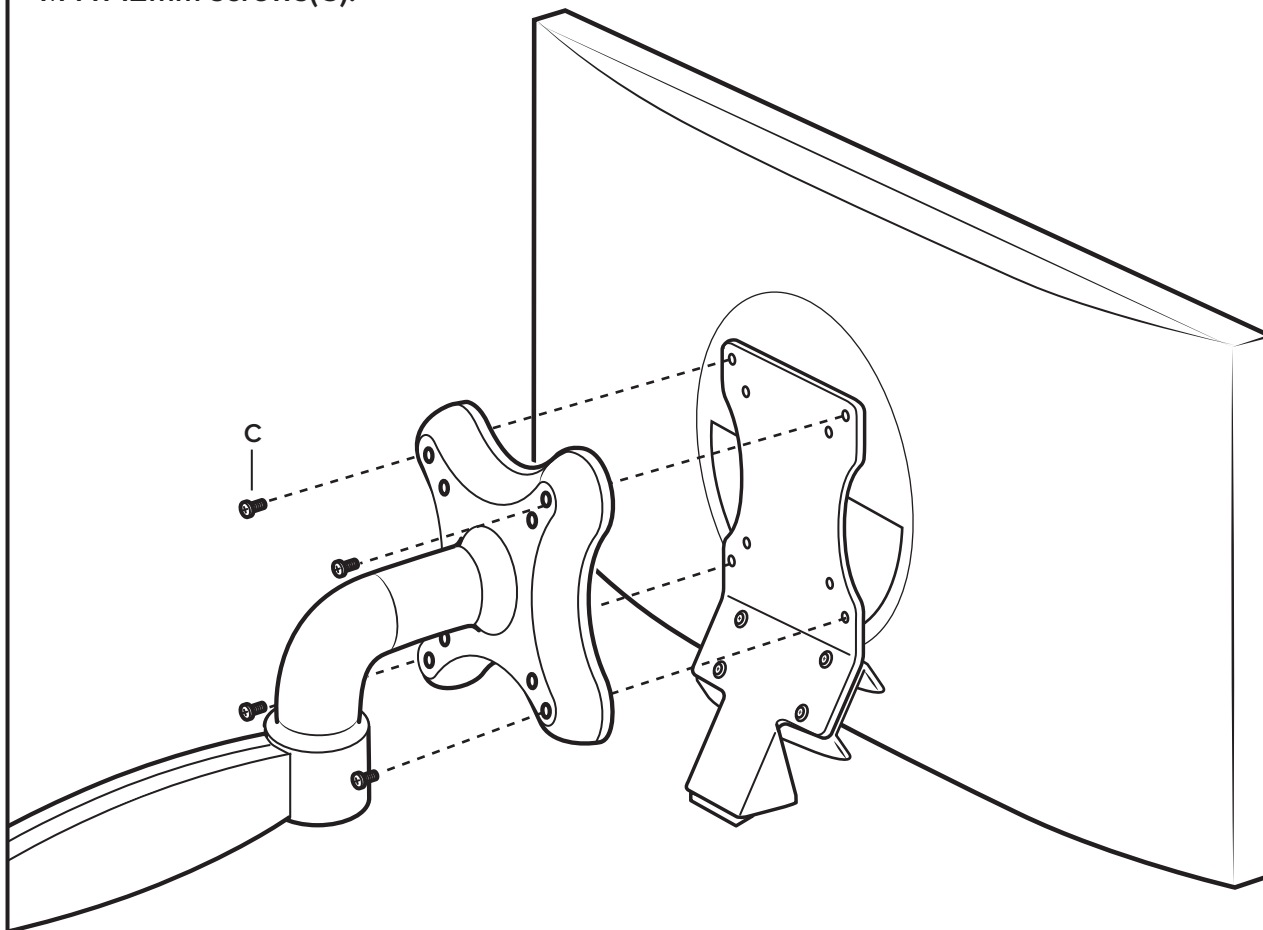

**Note:** It is best to use the screws that came with your monitor arm. If you don't have these available, we have provided VESA standard screws for your convenience.