



PHANTOM

NIGHT VISION BINOCULAR
XANB55

QUICK START GUIDE

- Charge binocular before first use, approx. 3 hours.
- Press and hold the power button to turn binocular on/off.
- Bring the screen into focus using the focus dial.
- Zoom in with the focus dial as necessary.
- This may require many turns depending on range.
- For night vision press the IR button.
- For taking photos and video, install a memory card and press the camera button.

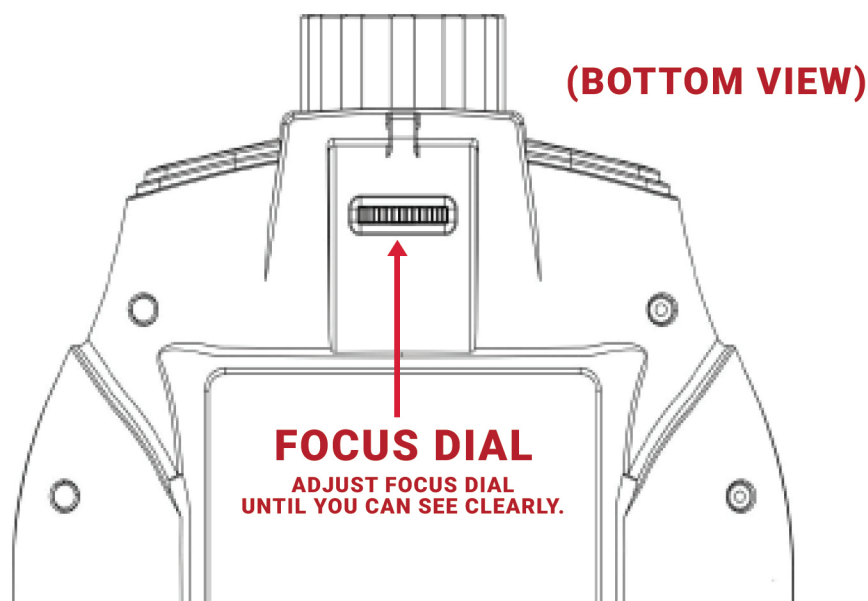

HELPFUL HINTS

- **Night vision does not work through glass. The glass will reflect the IR light signal.**
- **To see in the dark, make sure to press and release the IR button.**
- **There are multiple IR levels. (press repeatedly to adjust).**
- **The higher the IR setting, the further you will see in the dark.**
- **ALWAYS make sure to turn off your binocular when not in use.**
- **You can adjust auto shut off under the mode settings (reference manual).**
- **Always power off binoculars before removing the memory card.**

(TOP VIEW)

