

GPCA BRONCO 4DR CARGO COVER

Trunk Full of Freedom

DESIGNED IN USA. Patented

FULL COVERAGE, MUCH EASIER TO USE

Introducing the Ford Bronco flexible Cargo Cover LITE under your Bronco 2021+ hardtop. Keep your valuable possessions stored in the cargo area of your Bronco safely hidden from view with this fantastic cargo cover. The cover keeps contents of the cargo area concealed, giving you added measure of security and most importantly, peace of mind. Help hide your valuables and deter thieves, while protecting your important assets. It protects and covers while still allowing access to the rear cargo area. Specially designed to be easy to install and remove, this cargo cover is tear resistant, lightweight, water-repelling, easy to clean, adjustable and durable, need we say more!

Cheers to a trunk full of freedom!

What is included in the package

*Illustrations may be slightly different than actual product

+ Cargo Cover LITE



Mount the mid row FIRST for the best balance

+ Tie-Down D-Ring X 6



Please contact us if you have any installation questions or missing parts. HELLO@GPCA.COM
1-business day reply as always

* Optional cover/ top Quick Release Bolt set on GPCA.com

+ Explore more on **WWW.GPCA.COM**



#GPCAofficial

Join our 60K followers

GPCA

* Search "GPCA Cargo Cover installation" on Youtube or visit our FAQ page (www.GPCA.us/FAQ) for more info.

Step 1 Use Ford Bronco hardtop screws and nuts* on the tub edge to mount the 6 provided Tie-down D-rings.

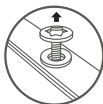

*The screws and nuts kit are not included in this package. They may or may not have come with your Bronco purchase. Visit GPCA.com to purchase the compatible **GPCA Quick Release Anchor Bolt** set if needed.



* Quick Release Thumb Screw set

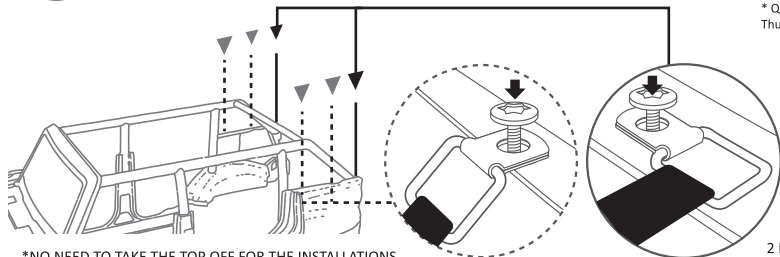

*NO NEED TO TAKE THE TOP OFF FOR THE INSTALLATIONS



2 D-Rings near the tailgate needed to be pointing to the back so the 2 straps can be mounted sideways

Step 2 Mount the cargo cover with care

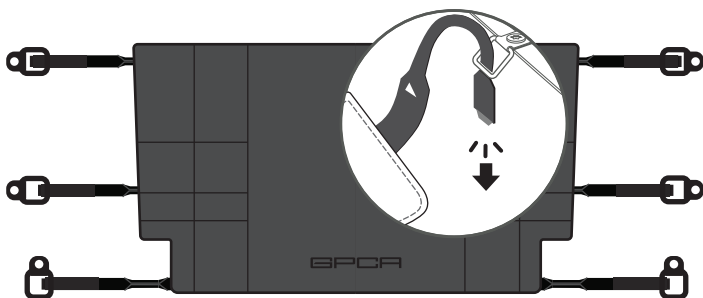

◀ **2** Mount the far edge next

◀ **1** Mount the **mid row FIRST** for the best balance

◀ **3** Mount the tailgate end the last

⚠ * These 2 D-rings point to the back

⚠ Pulling too tight can shift the whole cover and cause misalignment

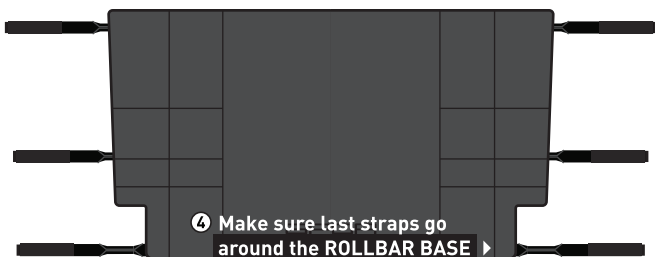

◀ **4** Make sure last straps go around the **ROLLBAR BASE**

◀ **4** Balance all the straps for the best fit if needed

Step 3 Balance all 6 straps with care

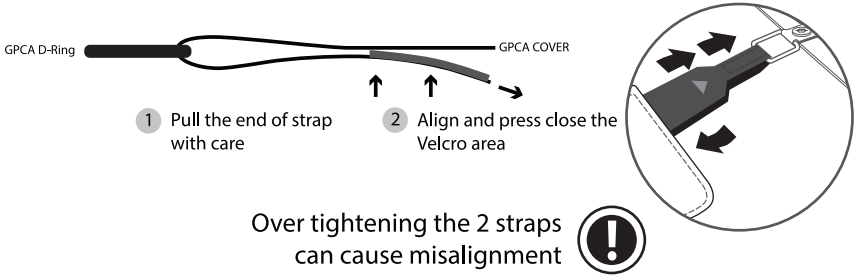

Done There are 3 configurations, now you have a trunk full of freedom on your Bronco!

A FULL COVERAGE

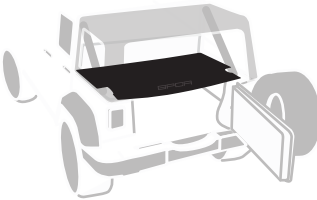

B HALF COVERAGE

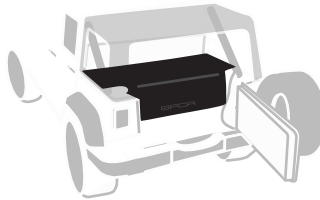

C TUCK AWAY



FAQ

Q: How to align the cover to the cargo space?

You might have tightened the 2 straps near the backseat too much and they shifted the whole cover towards to the backseat. Please demount the straps and mount the middle straps first according the the owner's manual.

Q: Is the cargo cover completely flat?

Unlike a flat hard lid, it is not 100% flat. It is a soft cover to put your valuables out-of-sight, with the flexibility to tuck away to free your cargo space when needed. Similar to comparing a soft top to hard top, people like them in different ways. If you balance the 6 straps well, the cover will be relatively flat and providing the full coverage. However, the end of the cover has a slight angle after the first 2 straps in order to cover the cargo space all the way to the tailgate due to the layout of the cargo.

Q: Will it do well outdoor and topless in the Summer?

Longtime UV exposure to the polyester material can cause de-coloring over time, our material is similar to what the factory interior fabric. Depends on how much UV exposure is, customers usually apply Aerospace 303 Marine Grade protectant to our cover and all interior fabrics on a Bronco.

Visit our FAQ page (www.GPCA.com/FAQ) for more info.