

# AURABEAT

Aurabeat 3800  
Large Capacity Sanitizing Air Purifier  
Model ASP-X1  
User Manual



**Aurabeat North America**

Distributed Exclusively by Brondell, Inc.  
PO Box 470085  
San Francisco, CA 94147-0085  
commercialsupport@brondell.com  
aurabeat-us.com

AURABEAT

# Content



1	Important Safety Information	P.1-2
2	Product	P.3
3	Getting Started	P.4-22
4	Using Your Product	P.23-26
5	Air Purifying Functions	P.26
6	Maintenance and Cleaning	P.27-30
7	Troubleshooting	P.30
8	Warranty	P.31-32
9	Specifications	P.32-33

- Thank you for purchasing this air purifier.
- Please read this manual carefully before using.
- Please keep this manual for future reference.





## 1. IMPORTANT SAFETY INFORMATION

Thank you for choosing our product.

**BEFORE USING THIS DEVICE, READ THIS MANUAL CAREFULLY. KEEP THIS MANUAL AND PRODUCT INFORMATION SAFE AND NEARBY FOR FUTURE REFERENCE.**

- We have provided many important safety messages in this manual and on your appliance. Always read and follow all safety messages.
- The manufacturer declines any liability for failure to observe these safety instructions, for inappropriate use of the appliance or incorrect setting of controls.
- All safety messages will tell you what the potential hazard is, tell you how to reduce the chance of injury, and tell you what can happen if the instructions are not followed.
- The appliance can only be used safely if it is correctly installed according to the safety instructions.
- The appliance is not intended for use outdoor or on wet surfaces.
- Do not leave the appliance unattended during operation.
-  Very young children (0-3 years) and pets should be kept away from the appliance. Young children (3-8 years) should be kept away from the appliance unless continuously supervised. Children 8 years and above and persons with reduced physical, sensory, or mental capabilities or lack of experience and knowledge can use this appliance only if they are supervised or have been given instructions on safe use and understand the hazards involved. Children must not play with the appliance. Cleaning and user maintenance must not be carried out by children without supervision.
-  Keep packaging, plastic film and small parts away from children.

### PERMITTED USE AND INSTALLATION

-  Connect and operate the appliance only in accordance with the specifications on the rating plate.
-  The appliance is not intended to be operated by means of an external switching device, such as a timer, or separate remote-controlled system.
-  When installing the appliance, check that the power cord or plug is not obstructed or damaged.
-  Do not use cord extensions, multiple socket strips nor non-approved adapters.
-  Never let the power cord encounter hot appliance parts or hot sources.

- ⚠️ Never let the power cord encounter sharp points or edges.
- ⚠️ Never kink, crush, or modify the power cord.
- Turn off and unplug the device to replace filter.
- ⚠️ Do not allow objects to enter, cover or block the air inlets and air outlets.
- When unplugging the appliance from the power supply, do not pull on the power cord, pull on the power plug.
- Do not alter the power plug in any way.
- Do not use the appliance near fire or hot surfaces.

### CLEANING AND MAINTENANCE

- ⚠️ Ensure the appliance is switched off and disconnected from the power supply before performing any maintenance operation; never use steam cleaning equipment-risk of electric shock.
- ⚠️ Repair and maintenance can only be carried out by one of our trained after-sales technicians. If the appliance is defective, unplug the appliance from the power supply and contact the after-sales service.
- ⚠️ Do not use abrasive or harsh cleaners such as window sprays, scouring cleansers, flammable fluids cleaning waxes, concentrated detergents, bleaches, or cleansers containing petroleum products on plastic parts, interior and door liners, or gaskets. Do not use paper towels, scouring pads or other harsh cleaning tools.

### DISPOSAL OF PACKAGING MATERIALS

- The packaging material is recyclable and is marked with the recycle symbol.

## 2. PRODUCT

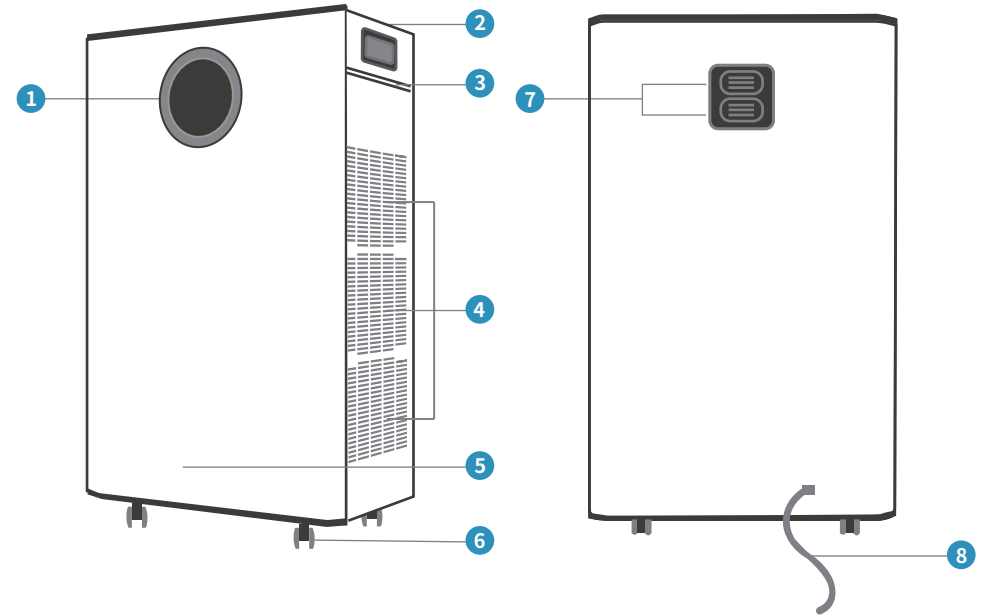

1 Touch Display

2 Upper Cover

3 Handle

4 Air Inlet

5 UVC Lamp

6 Wheels

7 Air Quality Sensor

8 Power Cord

## 3. GETTING STARTED

### WHAT'S INCLUDED

- 1 x Air Purifier
- 1 x Remote Control
- 2 x 3-Stage HEPA Filters
- 2 x Metal Pre-Filters
- 1 x Quick Start Guide

**MAKE SURE YOU REMOVE ALL PACKAGING FOR FILTERS AND PRODUCTS BEFORE USING THE APPLIANCE.**

### INSTALLATION

1. Find an ideal location to maximize the air cleaning efficiency. The location should be farthest away from the room's HVAC return vent, windows, and doorways.
2. Place the purifier on a flat, stable surface. Allow at least 4" of clearance on all sides of the purifier. Keep away from anything that would block airflow.
3. Locate the closest electrical outlet.
4. Before turning on the unit, remove the top cover by sliding the four locking tabs on the top of the unit.

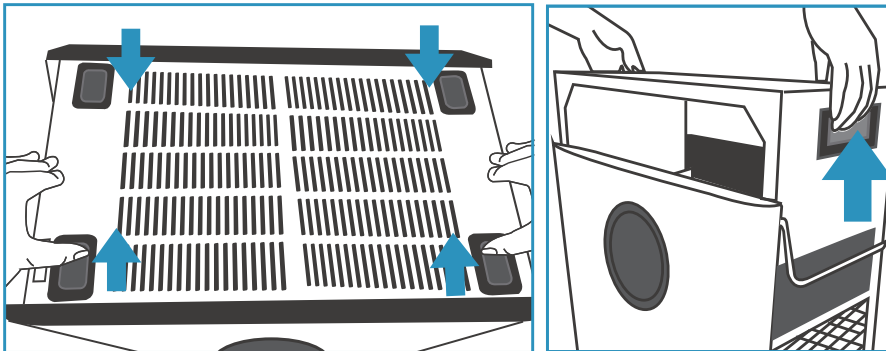

5. Remove the plastic packaging from the air filters located inside the air purifier unit before turning on or operating the unit.

6. After the plastic packaging is removed, insert both sets of filters into the unit. On each side, the Pre-Filter is inserted in the slot toward the outside of the machine, and the 3-Stage HEPA Filter is placed closest to the inside of the unit. The white HEPA portion of the 3-Stage HEPA Filter faces outward.

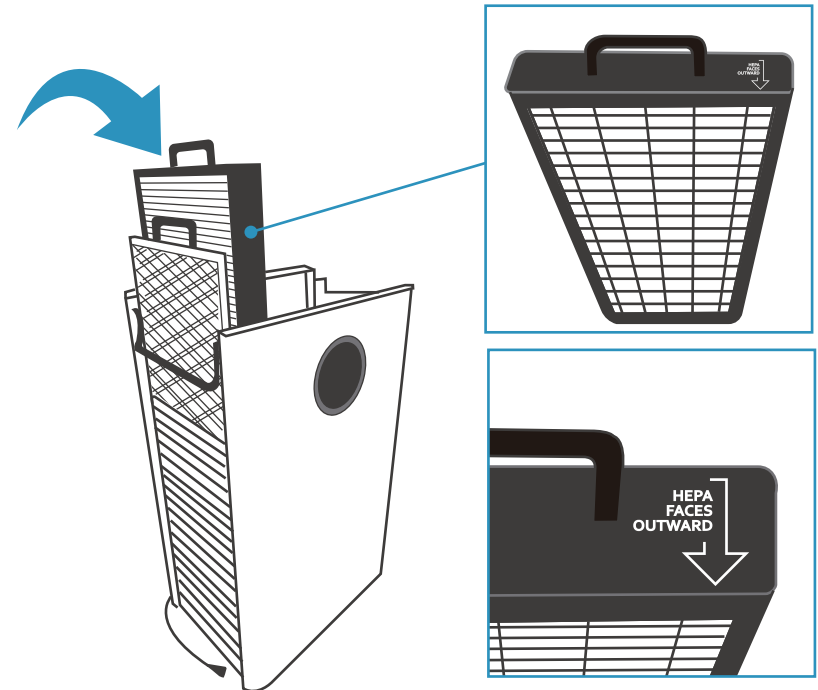

7. Plug the power cord into an electrical outlet.
8. Press the power button to turn on the unit. The unit will enter Auto Mode with Plasma and UVC Lamp on.

**YOU CAN FOLLOW STEP-BY-STEP INSTRUCTIONS BY SCANNING THE QR CODE BELOW FOR A LINK TO A DEMONSTRATION VIDEO:**



## SETTING UP THE APP

1. Scan the QR code to download the AURABEAT app from the App Store or Google Play. Once the app has been successfully installed, you can pair the unit.



2. Press “Don't Allow” if you don't want to share your location or receive notifications.

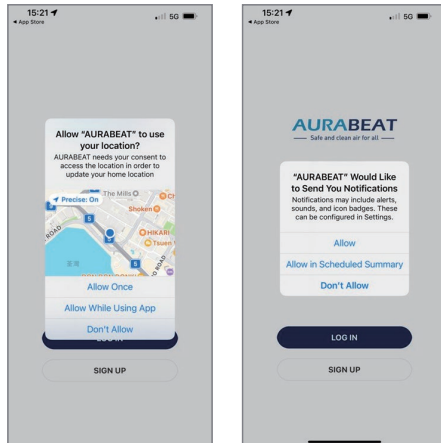

3. Press “Sign Up” to create an AURABEAT account.



4. Enter your email address and check the box. Press “Next” to create an account.

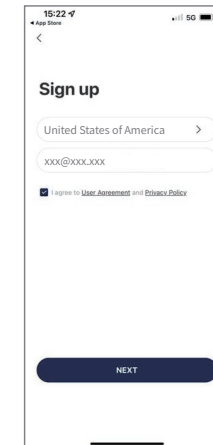

5. Enter the verification code that has been sent to your email.

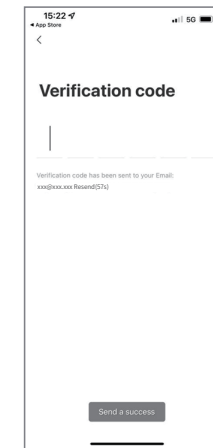

- Set a password for your account then press “Next.”

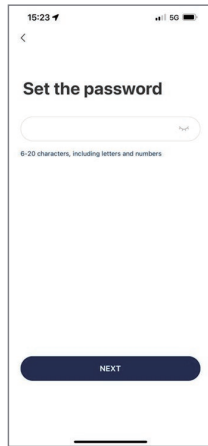

- Press “Don't Allow” if you don't want AURABEAT to access your Bluetooth.

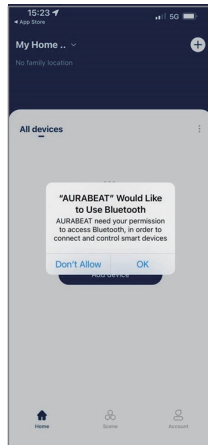

## PAIR THE DEVICE

- Press the “+” at the top right corner to add device and press “Air Purifier (Wi-Fi)” under “Add Manually.”

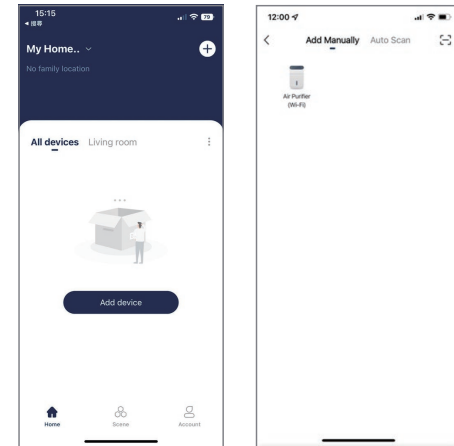

- Select a 2.4 GHz Wi-Fi network and enter the password of the Wi-Fi network. Press and hold the unit's Wi-Fi icon on the Touch Display for 5 seconds or until the icon begins blinking to activate the pairing mode.

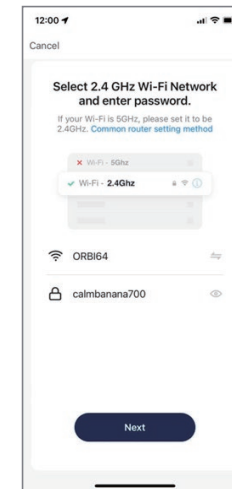

- Click "Next" to enter the network configuration page. If the app is not activated successfully within 2 minutes, please deactivate the Wi-Fi function by pressing the "Wi-Fi" icon on the unit and repeat step 2 and 3 again for the app's connection.

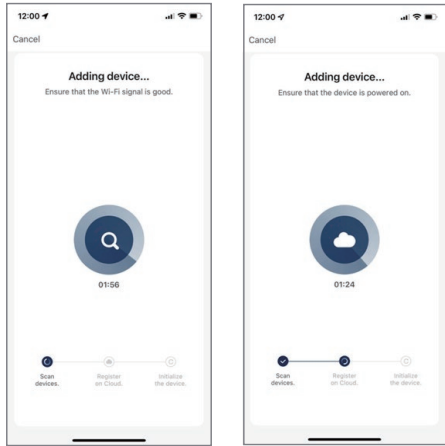

- After the network is successfully configured, click "Done" to enter the Main Page for the device operation.

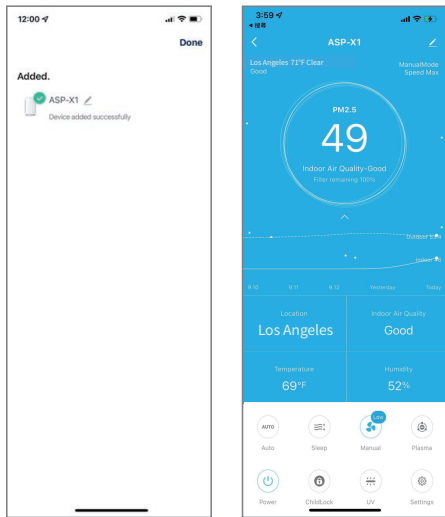

- The first account paired with the device will be the owner. The owner can add members to the account to allow other AURABEAT app users to control the device.
- To change the owner of the device, follow instructions to reset the device on P. 22.

## MAIN PAGE

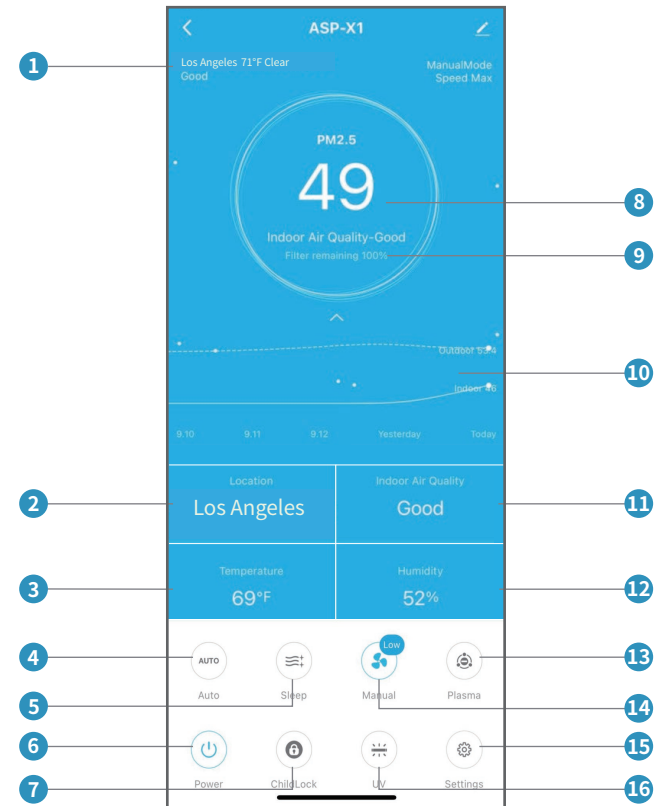

- |                                       |  |                    |
|---------------------------------------|--|--------------------|
| 1 Outdoor Temperature and Air Quality | 7 Child Lock   | 12 Indoor Humidity |
| 2 Location                            | 8 Indoor PM2.5 Level                                 | 13 Plasma          |
| 3 Indoor Temperature                  | 9 Filter Remaining Percentage                        | 14 Manual Mode     |
| 4 Auto Mode                           | 10 Last 7 Days Outdoor and Indoor Air Quality Record | 15 Settings        |
| 5 Sleep Mode                          | 11 Indoor Air Quality                                | 16 UVC Lamp        |
| 6 Power On/Off                        |  |                    |

## SCHEDULE

1. Press “Settings” and then press “Add” to add schedule in “Schedule.”

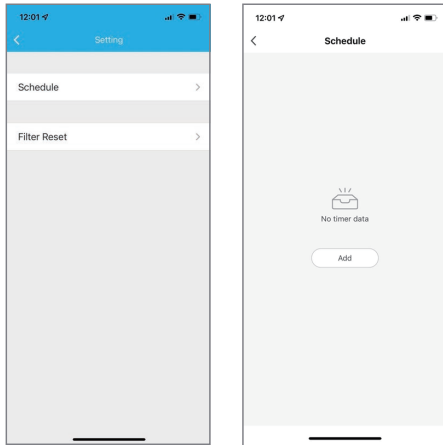

2. The schedule can be set for a maximum of 23 hours and 59 minutes and repeat by selected days of the week. The schedule “ON/OFF” function can only be set when the product is on. Press “ON/OFF” and select “ON” if you would like to schedule the device to turn on, select “OFF” if you would like to schedule the device to turn off.

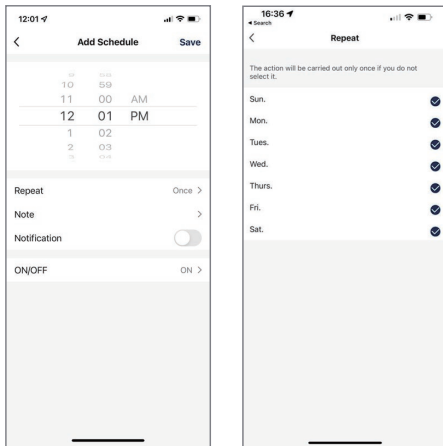

3. To remove a schedule, swipe left on the desired schedule then press “Delete.”

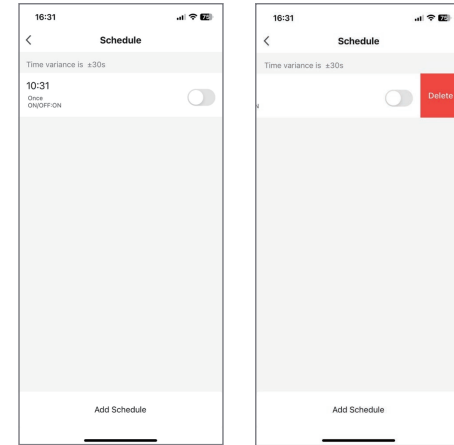

## RESET FILTER

1. Press “Settings” and then press “Filter Reset” and “Confirm” to reset the filter.

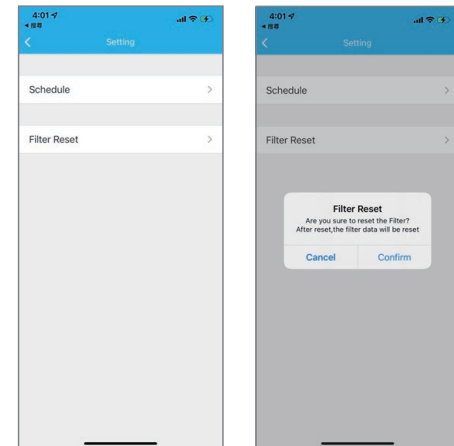



## SHARE THE DEVICE

1. Press “” on the top right hand corner and select “The Shared devices.”

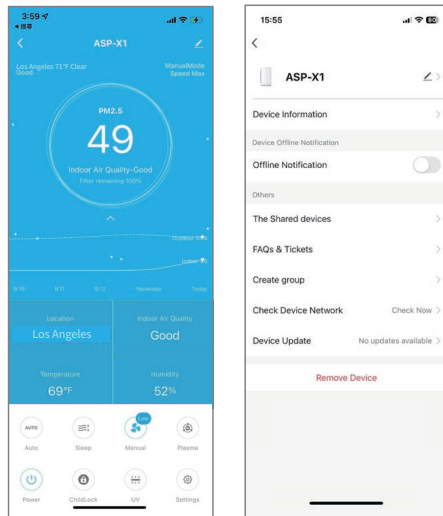

2. Press “Add Share” to share the device.

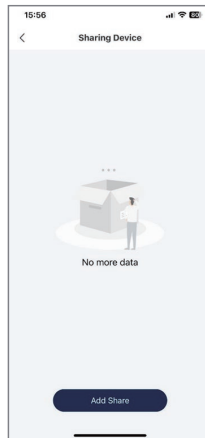

3. Tap “Country/Region” to change Country or Region and enter the account that you would like to share the device with. Press “Save” to share the device. The shared device will appear in the Home Page of the account that you have shared.

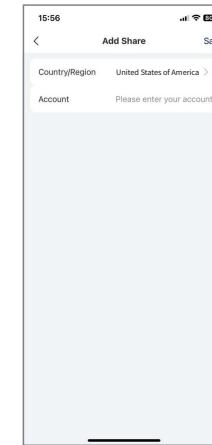

## BUILDINGS AND ROOMS

1. Press “My Building” and then select “Building Management” to change the name for your “Building.”

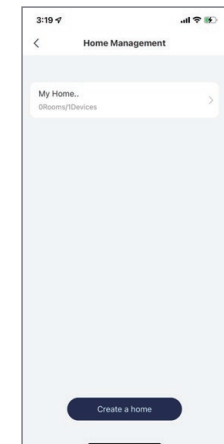
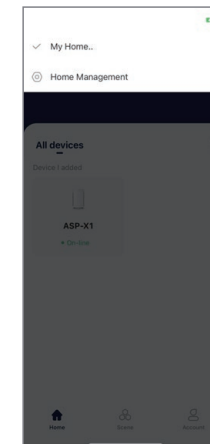
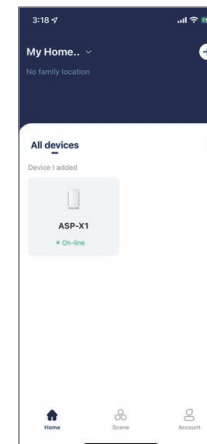

- To add a room, in “Building Setting” select “Room Management.”

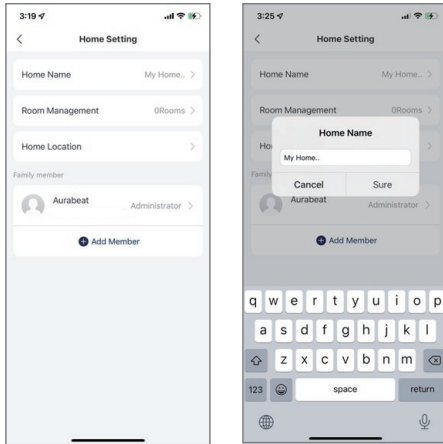

- Press “Add other room” in “Room Management” to add room. Enter the room name and press “Save.”

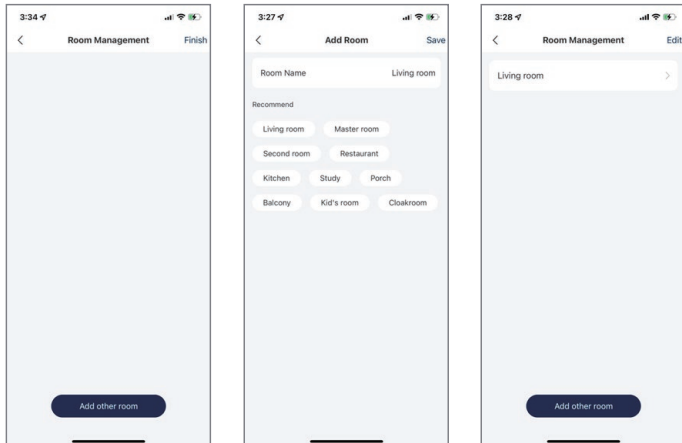

- Select added room. Press “+” and “Save” to add the device to the room.

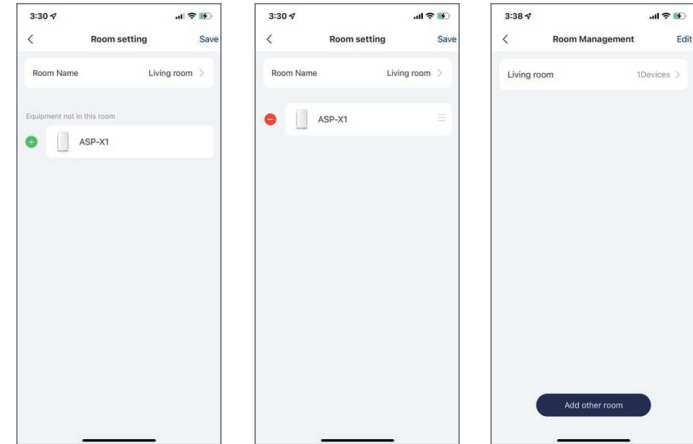

## ADD MEMBERS

- Press “My Building” and then select “Building Management.” Press “+ Add Member” to add member to control the paired device.

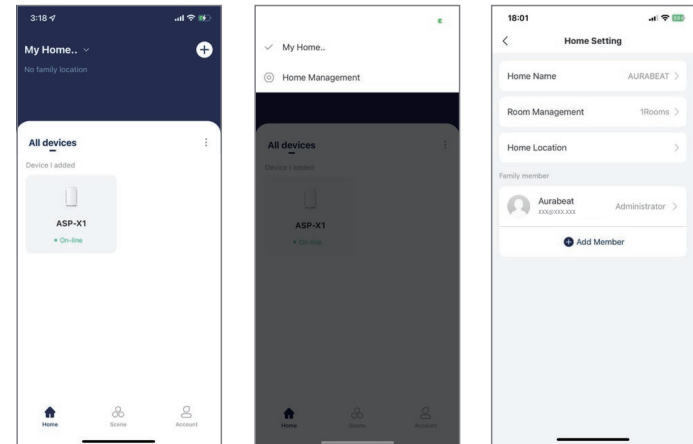

2. Enter the member's name and tap "Country/Region" to change Country or Region. Enter the member's account and press "Save."

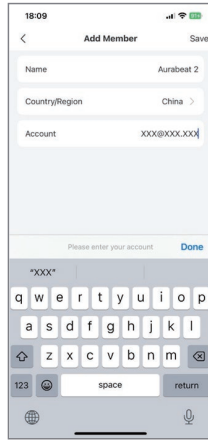

3. Press "Account" and "Building Management" in the member's app.

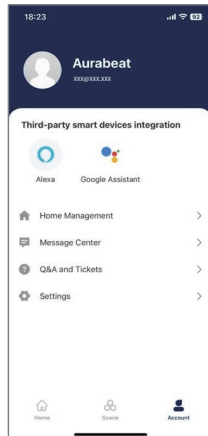

4. Select "create a Building" under "To be added" and accept the invitation.

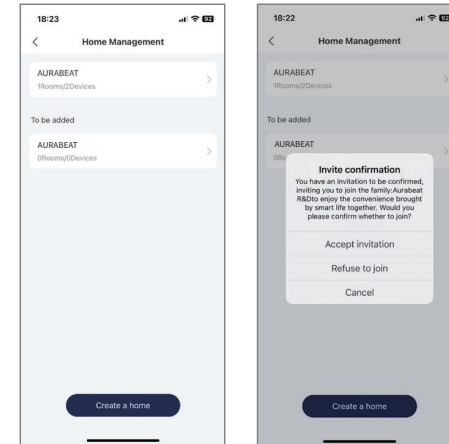

## GROUP CONTROL

1. Devices can be controlled as a group by selecting them one by one in the "Pair the device" section. Select one of the devices.

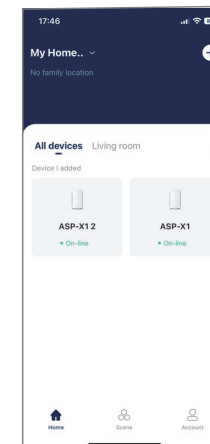

- Press “✎” on the top right hand corner and select “Create group.”

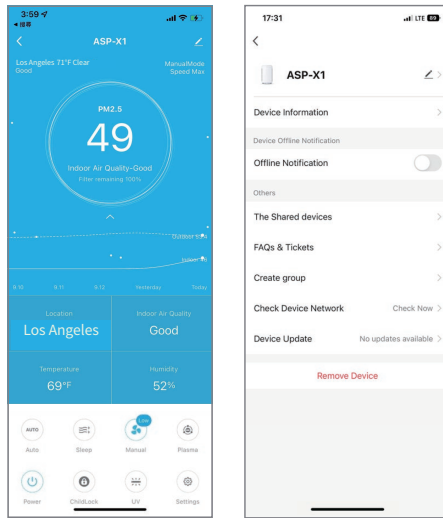

- Select the devices that you would like to group together.

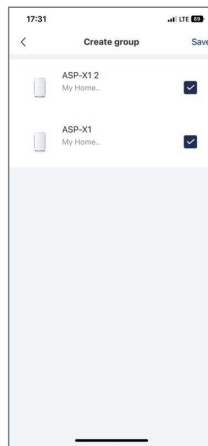

- Name the group and press “Confirm.” Press “Save” to proceed.

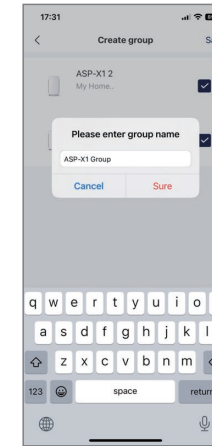

- To access control of your created group, return to the Home Page and select the group you created. You will be directed to the selected group's Main Page.

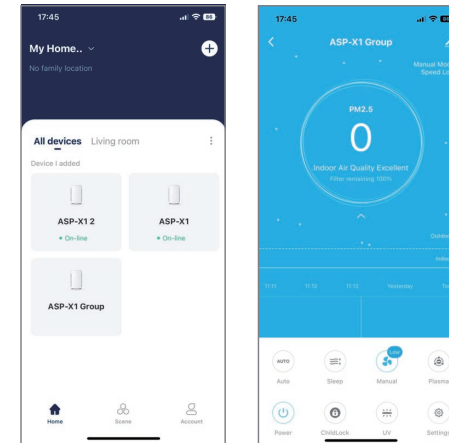

- Press “✎” on the top right hand corner. Press “Dismiss Group” and “Confirm” to ungroup the devices.

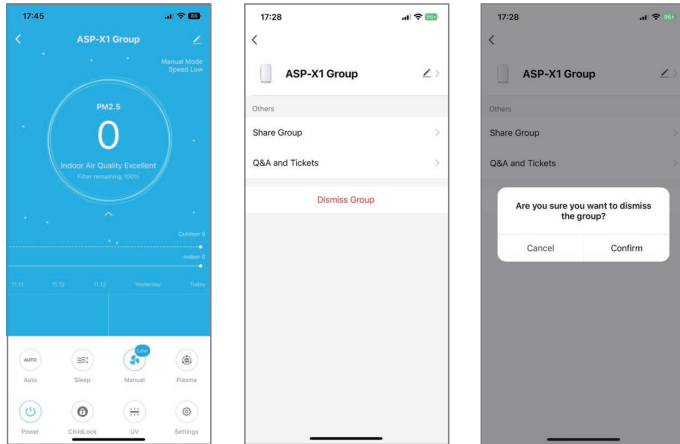

## RESET THE DEVICE

- Reset the device if you want to re-assign ownership to a different account. Press and hold the device's Wi-Fi icon on the Touch Display for 5 seconds or until the icon begins to blink.
- Login to the AURABEAT app with the new account and follow the Wi-Fi pairing instructions on P. 9.

## 4. USING YOUR PRODUCT

### TOUCH DISPLAY

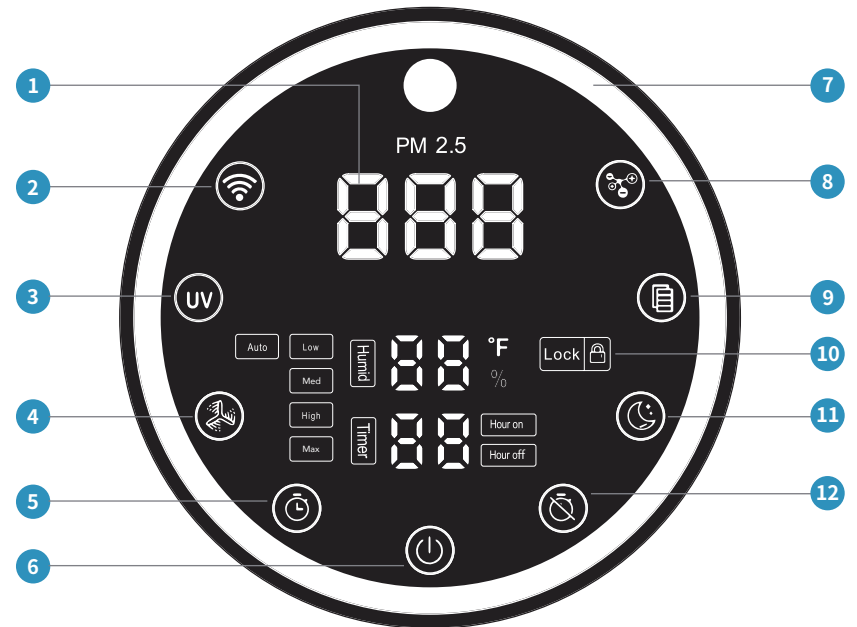

- |                   |                         |                                |
|-------------------|-------------------------|--------------------------------|
| 1 PM2.5 Indicator | 5 Timer On              | 9 Filter Replacement Indicator |
| 2 Wi-Fi           | 6 Power On/Off          | 10 Child Lock                  |
| 3 UVC Lamp        | 7 Air Quality Indicator | 11 Sleep Mode                  |
| 4 Fan Speed       | 8 Plasma                | 12 Timer Off                   |



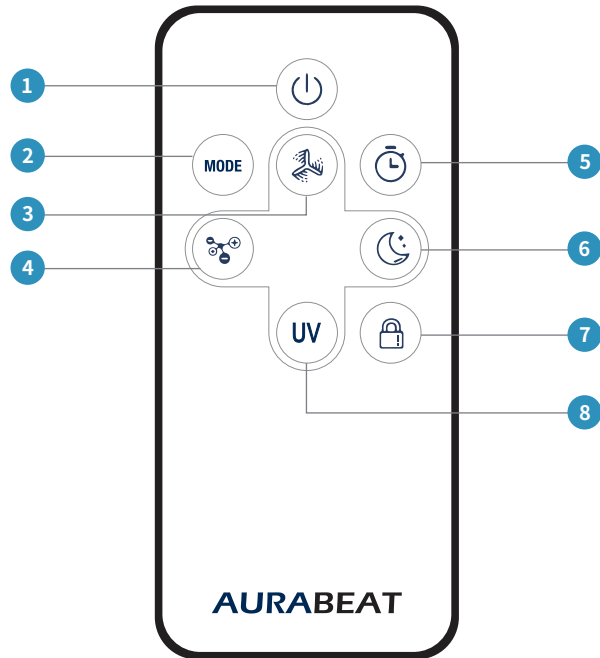

## REMOTE CONTROL



- |                           |                     |                     |
|---------------------------|---------------------|---------------------|
| <b>1</b> Power On/Off     | <b>4</b> Plasma     | <b>7</b> Child Lock |
| <b>2</b> Auto/Manual Mode | <b>5</b> Timer      | <b>8</b> UVC Lamp   |
| <b>3</b> Fan Speed        | <b>6</b> Sleep Mode |                     |

## OPERATING INSTRUCTIONS

Icon	Function	Function Details
	Power On/Off	<ul style="list-style-type: none"> <li>Press the  button to turn on/turn off the device.</li> <li>The “On/Off,” “Auto,” “PM2.5,” “Temperature,” “Humidity” icons will appear once product is turned on.</li> </ul>
	Fan Speed	<ul style="list-style-type: none"> <li>Adjust the fan speed from Auto and 1 to 4 speed levels by pressing the  button on the Touch Display or on the Remote Control.</li> <li>The fan speed indicator will be on if the fan speed function is activated.</li> </ul>
	Auto/Manual Mode (Only on Remote)	<ul style="list-style-type: none"> <li>Select “Auto/Manual Mode” by pressing the  button on the Remote Control to switch between Auto and Manual Mode. In Auto Mode, the fan speed will automatically adjust according to the air quality.</li> </ul>
	Timer On	<ul style="list-style-type: none"> <li>Press the  button on the Touch Display when the product is connected but the device is off to set the Timer On function from 1-12 hours.</li> <li>(Remote Control) Press the  button to select Timer On/Timer Off function.                             <ul style="list-style-type: none"> <li>Press the  button when the product is connected but the power is off to set the Timer On function.</li> <li>Press the  button to set Timer Off when the product is on.</li> </ul> </li> </ul>
	Timer Off	<ul style="list-style-type: none"> <li>Press the  button on the Touch Display when the device is on to set the Timer Off function from 1-12 hours.</li> </ul>
	Filter Replacement Indicator	<ul style="list-style-type: none"> <li>The  button will illuminate after the device has been operating for 4320 hours to indicate it is time for filter replacement.</li> <li>To reset the indicator, press and hold the  button on the Touch Display for 3 seconds.</li> </ul>
	Child Lock	<ul style="list-style-type: none"> <li>The  icon will appear on the Touch Display when activated. This function can only be activated/deactivated from the Remote Control and the AURABEAT app.</li> <li>(Remote Control) Press the  button to activate/deactivate Child Lock.</li> </ul>
	Plasma	<ul style="list-style-type: none"> <li>Press the  button on the Touch Display or Remote Control to activate/deactivate this function.</li> </ul>

Icon	Function	Function Details
	Sleep Mode	<ul style="list-style-type: none"> <li>Press the  button on the Touch Display or the Remote Control to activate this function. The device will operate at the lowest speed and all icons except “Sleep Mode” will be turned off. The UVC Lamp, Plasma and Timer settings will not change.</li> <li>Press the  button again to deactivate this function. The icons on the Touch Display will illuminate and the fan speed will remain at the lowest speed.</li> </ul>
	UVC Lamp	<ul style="list-style-type: none"> <li>Press the  button on the Touch Display or the Remote Control to activate/deactivate this function.</li> </ul>

PM2.5 Value	Air Quality Level	Air Quality Indicator Color
1-79	Good	Green
80-199	Fair	Blue
200-500	Bad	Red
>500	Poor	Flashing red

## 5. AIR PURIFYING FUNCTIONS

1. Pre-Filter: Captures hair, fiber, large particles, dander, etc., can be vacuumed and reused.
2. High Efficiency Air Filter: H13 HEPA Grade filter filters  $\geq 99.97\%$  of airborne particles 0.3 microns in size. It has low penetration, large capacity for holding dust, high clean air delivery rate can filter smoke and dust, especially for PM2.5, efficiently filtering particles down to  $\leq 0.01\mu\text{m}$ .
3. Activated Carbon Filter: Removes odors, VOC's, harmful gases and smoke.
4. Photocatalytic Oxidation Filter (PCO): Acting with UVC light, converts microorganisms, smoke, odors, VOC's, and chemically active compounds (CAC's) into water, carbon dioxide.
5. UVC Light: UVC lamp helps to sanitize the air, surface of the filters and the inside of the unit.

6. Plasma Purification: The positive and negative ions generated by the plasma generator neutralize in the air and produce huge energy, which results in the change of the microorganism structure around or the conversion of energy, thereby destroying the microorganisms. As the number of negative ions is greater than that of positive ions, excess negative ions are still floating in the air, which can remove smoke, dust, odors and improve air quality and health.

## 6. MAINTENANCE AND CLEANING

### NOTE

- Never immerse the device in water or any other liquid.

### EXTERIOR

- Unplug device before cleaning.
- Wipe the exterior of the air purifier with a soft, dry cloth. If necessary, wipe the housing with a damp cloth then dry immediately.
- Do not use abrasive chemicals when cleaning the air purifier.

### CLEANING AND REPLACING THE FILTERS

- For optimal performance, adhere to the recommended filter cleaning schedule.
- Always unplug the unit before opening the filter cabinet.

Filter	Method	Cleaning cycle
Metal Pre-Filters	<ul style="list-style-type: none"> <li>Clean: Vacuum or rinse filter using warm water. Allow filter to dry completely before re-inserting into unit.</li> <li>Replace: Remove the filters and place in trash bag before disposal.</li> </ul>	<ul style="list-style-type: none"> <li>Clean: every 6 months.</li> <li>Replace: every 3 years.</li> </ul>
3-Stage HEPA Filters	<ul style="list-style-type: none"> <li>Replace: Remove the filters and place in trash bag before disposal.</li> </ul>	<ul style="list-style-type: none"> <li>Replace when the red Filter Replacement Indicator light is visible on the Touch Display.</li> <li>Replace when the AURABEAT app states the filter life is at 0%.</li> </ul>

## AIR QUALITY SENSOR

Clean the PM2.5 Sensor every 2 months using the following method:

1. Open PM2.5 Sensor cover.



2. If there is dust around the sensor area, a vacuum hose attachment may be used to remove the dust.

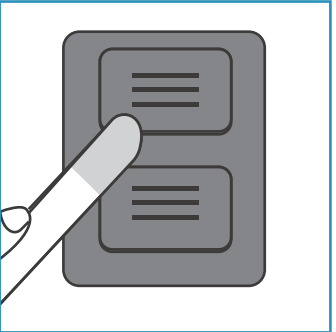

3. Wipe the lens with a dry cotton swab.

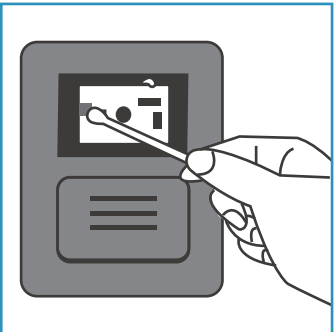

## UVC LAMP REPLACEMENT

Replace the UVC lamp when it burns out using the following method:

1. Unplug the unit and lay it on its side.

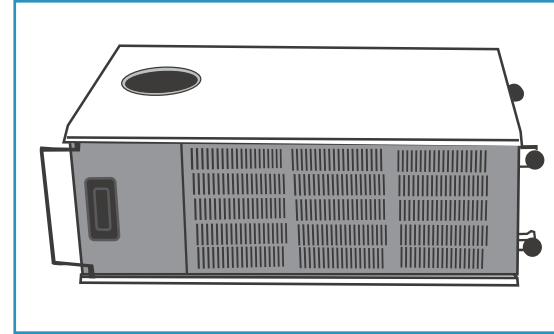

2. Remove the 8 screws from the panel located at the bottom.

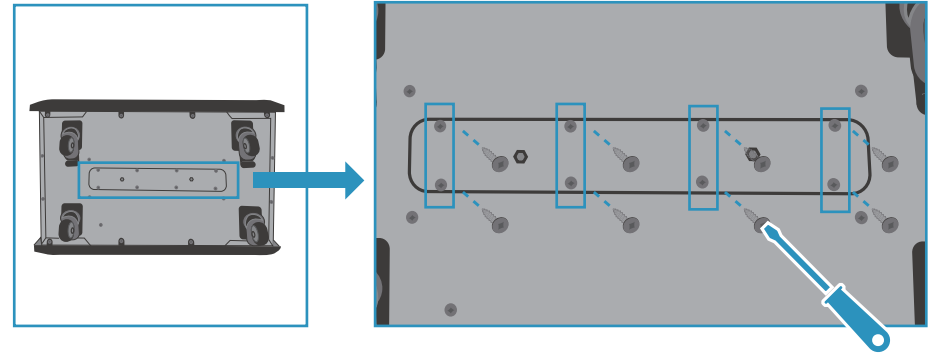

3. Remove the old lamp and replace it.

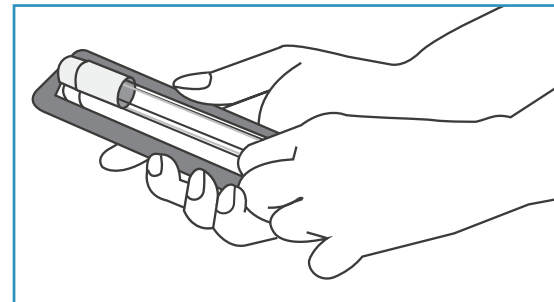



## 8. WARRANTY

### WARRANTY

Aurabeat North America products are backed by some of the most comprehensive warranties in the industry. Aurabeat North America warrants that the Aurabeat 3800 Large Capacity Sanitizing Air Purifier shall be free from defects in material and workmanship under normal use and service.

Residential & Commercial Warranty for Aurabeat 3800 Large Capacity Sanitizing Air Purifier - 3-year limited

Includes Base Model numbers: ASP-X1

100% Coverage of defects or malfunctions of all electronic parts and labor for the entire product excluding consumable filters for the first 3 years from original date of purchase.

### EXCLUSIONS AND LIMITATIONS

1. Aurabeat North America warrants its products to be free from manufacturing defects under normal use and service. This warranty is extended only to the ORIGINAL PURCHASER.
2. Aurabeat North America's obligations under this warranty are limited to repair or replacement, at Aurabeat North America's option, of products or parts found to be defective, provided that such products were properly installed and used in accordance with instructions. Aurabeat North America reserves the right to make such inspections as may be necessary in order to determine the cause of the defect. Aurabeat North America will not charge for labor or parts in connection with warranty repairs for the first 3 years from date of purchase on all products except those that may be subject to heavy commercial use limitations.
3. Aurabeat North America is not responsible for the cost of removal, return (shipping) and/or reinstallation of products. This warranty does NOT apply to:
4. This warranty gives you specific legal rights. You may have other rights which vary from state to state.

THIS WRITTEN WARRANTY IS THE ONLY WARRANTY MADE BY AURABEAT NORTH AMERICA. REPAIR OR REPLACEMENT AS PROVIDED UNDER THIS WARRANTY SHALL BE THE EXCLUSIVE REMEDY AVAILABLE TO THE PURCHASER. AURABEAT NORTH AMERICA SHALL NOT BE RESPONSIBLE FOR LOSS OF USE OF THE PRODUCT OR FOR OTHER INCIDENTAL, SPECIAL, OR CONSEQUENTIAL DAMAGES OR EXPENSES INCURRED BY THE PURCHASER OR FOR LABOR OR OTHER COSTS DUE TO INSTALLATION OR REMOVAL OR COSTS OF REPAIRS BY OTHERS, OR FOR ANY OTHER EXPENSE NOT SPECIFICALLY STATED ABOVE. EXCEPT TO THE EXTENT PROHIBITED BY APPLICABLE LAW, ANY IMPLIED WARRANTIES, INCLUDING THAT OF MERCHANTABILITY, ARE EXPRESSLY LIMITED TO THE DURATION OF THIS WARRANTY. SOME STATES DO NOT ALLOW LIMITATIONS, SO THE ABOVE LIMITATION AND EXCLUSION MAY NOT APPLY TO YOU.

4. Place the panel back on the bottom and screw it in to reattach it.

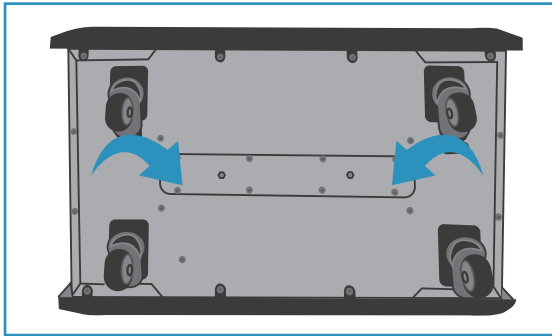

REPLACEMENT UVC CAN BE PURCHASED FROM AUTHORIZED DISTRIBUTOR.

## 7. TROUBLESHOOTING

Problem	Symptoms	Recommended Solutions
The air purifier is not working	The product is not connected.	<ul style="list-style-type: none"> <li>• Please make sure that the power cord is connected to a power supply.</li> </ul>
The air outflow is significantly weaker than before	The air inlet is covered.	<ul style="list-style-type: none"> <li>• Ensure that the air inlet is not blocked.</li> </ul>
	The surface of the filter is dirty.	<ul style="list-style-type: none"> <li>• Clean the surface of the air filter.</li> <li>• Replace the air filter if the air flow is not improved after cleaning.</li> </ul>
The air outflow is significantly stronger than before	The filter is not installed correctly.	<ul style="list-style-type: none"> <li>• Please install the filter correctly.</li> </ul>
	The filter is damaged.	<ul style="list-style-type: none"> <li>• Replace the filter.</li> </ul>
Product is very noisy during operation	The air inlet is covered.	<ul style="list-style-type: none"> <li>• Please remove the objects covering or blocking the air inlet.</li> </ul>
	There is an object inside the air outlet.	<ul style="list-style-type: none"> <li>• Please clean the air outlet.</li> </ul>

## HOW TO OBTAIN SERVICE

To obtain repair service under this warranty, you must contact an authorized Aurabeat North America or Brondell Service Center to obtain an RMA (Return Merchandise Authorization) number. Proof of purchase in the form of a copy of the original receipt must accompany the returned unit for the warranty to be valid. Take or ship the unit pre-paid to the closest Aurabeat North America or Brondell authorized service center along with the RMA number and proof of purchase. To obtain an RMA number, contact the Service Center at [commercialsupport@brondell.com](mailto:commercialsupport@brondell.com)



This device complies with part 15 of the FCC Rules. Operation is subject to the following two conditions:

1. This device may not cause harmful interference. And
2. This device must accept any interference received, including interference that may cause undesired operation.

## 9. SPECIFICATIONS

Item	Specifications
Model Number	ASP-X1
Voltage	120 V/60 Hz
Power	175W
CFM	518 CFM
Recommended Area	1300 sq ft
Product Dimension	20.9 x 13.0 x 35.4 in
Net Weight	60.6 lbs
Sensor Type	PM2.5, Temperature, Humidity
Maximum Noise	≤60 dB(A)



Meets California ozone emissions  
limit: CARB certified.

Aurabeat North America  
Distributed Exclusively by Brondell, Inc.

PO Box 470085  
San Francisco, CA  
94147-0085  
[commercialsupport@brondell.com](mailto:commercialsupport@brondell.com)

Research and Development in Hong Kong  
Made in China

**PLEASE RETAIN RECEIPT RECORDS FOR ANY WARRANTY CLAIMS.**

Replacement filter:  
APRF-100 Replacement Filter Pack  
ABRF-100PRE Pre-Filter Replacement Pack