

# SENTRY SHOWER FILTER INSTALLATION INSTRUCTIONS

## Sentry Shower Filter Contents (P/N: CP-SF):

- A) 1 Clear Housing with O-Ring & ½" Fittings
- B) 1 Catalytic Carbon Filter with CT Resin
- C) 1 Wrench (for removing housing when changing filter. NOT FOR TIGHTENING.)

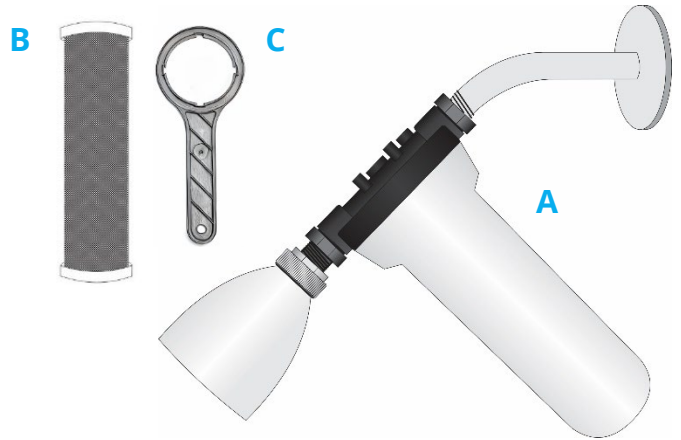

## Tools Needed (Not Included):

- 1 Pair of Pliers / Channel Locks
- Plumber's Tape

*Verify you have the necessary components listed above before starting installation.*

**STEP 1:** Choose the location for installation (i.e. Master Shower). Using a pair of pliers, remove the shower head and any remaining plumber's tape.

**STEP 2:** Prep the exposed ½" piping with 3-5 wraps of plumber's tape in the direction of the threads. Thicker tape (3.5+ mil) only requires 2-3 wraps and thinner tape (2.5 mil) requires 4-5 wraps.

**STEP 3:** Untwist the housing from the lid. With the INLET side pointing towards the incoming water, thread the lid onto the ½" pipe and hand tighten.

**STEP 4:** Unwrap the filter and place it into the housing. Then twist the housing back onto the lid and hand tighten. For optimal fit and performance, the installed housing may be positioned upright or twisted up to 60 degrees in either direction as pictured below. If necessary, shower filter may be installed in any orientation.



**STEP 5:** Reinstall the shower head by threading it onto the OUTLET fitting of the housing lid.

**STEP 6:** Turn on the water and check for leaks. Continue to run the water for 5 minutes to purge the system of excess carbon dust.

**STEP 7:** Replace the filter annually and enjoy your new shower experience with softer, cleaner water! If you have questions or concerns, please contact us at the phone number or email below.