



Infinity Tools Portable Router Table System

Part # PRTS-200

Congratulations for purchasing the most powerful and feature-rich portable router table system on the market! We're confident that it will give you many years of reliable service.

The PRTS system consists of three main parts. There is the Dust Cube base, the Table and the Fence. The Dust Cube and Fence each have their own separate instruction manuals, which are provided. Assemble each accordingly.

Table Modification

Since each compact router on the market is slightly different from the others, there is no way to predict exactly where you will need to position the included Izzy Washers on the underside of the table, so that you may rotate and lock in your compact router for its best ergonomics.

Before final attachment of the Table to the Cube, connect your router to our included 115-038 Universal Router Plate. Then position within the table and locate the best ergonomic controls position of your router.

Insert the provided 1- $\frac{1}{4}$ " bolts in the two outer holes on the clear router base plate and locate for where they'll intersect the long end of the Izzy Washers. Mark and predrill for the included attachment screws for those washers on the bottom side of the table. Then attach them to the underside of the table.

Using the provided wing nuts, tighten everything down to ensure reliable and solid positioning of your router. You may then attach your Cube to the Table, aligning the attachment flanges with the two rows of predrilled holes.

Our Fence and the T-track rails should allow you to attach your favorite routing accessories, such as hold-downs, feather boards, flip stops and guides, all offered by Infinity Cutting Tools. Most anything you can do on a full-size router table package should be possible with Infinity's Portable Router Table System!

Congratulations, your Portable Router Table System is ready for use. All that is left is to connect to your dust collection system, install your desired router bit, plug in your router, and start routing.

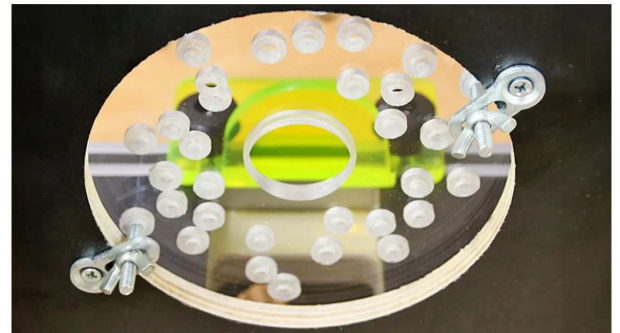

310 Mears Blvd • Oldsmar, FL 34677

P: 813-881-9090 | 1-877-872-2487 - Order Online 24/7: InfinityTools.com

Infinity Tools Portable Router Table System

Part # PRTS-200

Congratulations on purchasing your new Infinity Tools Portable Router Table System, the PRTS-200. This fence offers reliable registration on your portable router table, with integral dust collection. It is fully ambidextrous, letting you install the dust port on either end to best suit your needs.

Parts List

- A. Aluminum fence body, x1
- B. L-Bracket Attachments, x2
- C. Bolts and Track Bosses for L-Brackets, x4
- D. 3" tubular knob risers, x2
- E. 4" 1/4-20 Bolt For Star Knobs, x2
- F. Star Knobs, x2
- G. Primary exhaust port, x1
- I. End block-off plate, x1
- J. 3/8" Screws for both end plates, x8
- K. Bit Guard
- L. 1/2" Button Head Screw, Washer, & Boss x4

Required Tools

- 4MM Hex wrench
- Phillips screwdriver

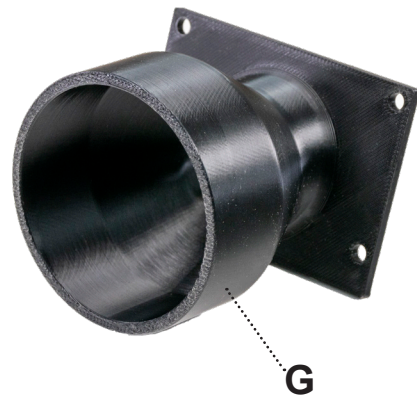
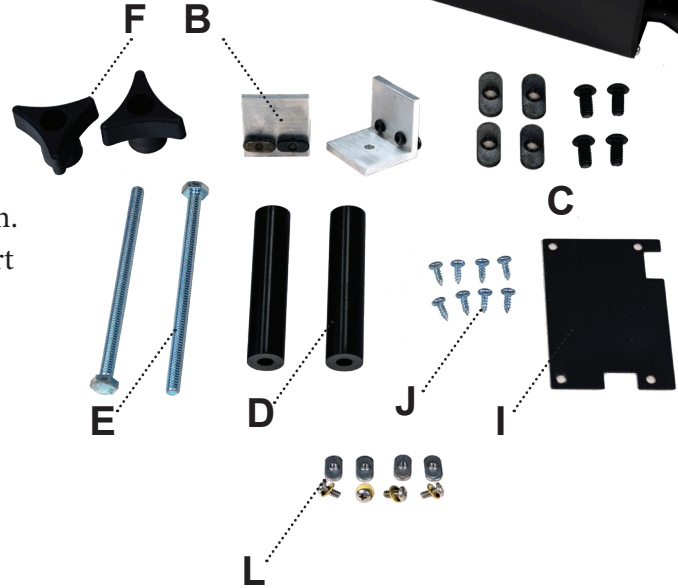
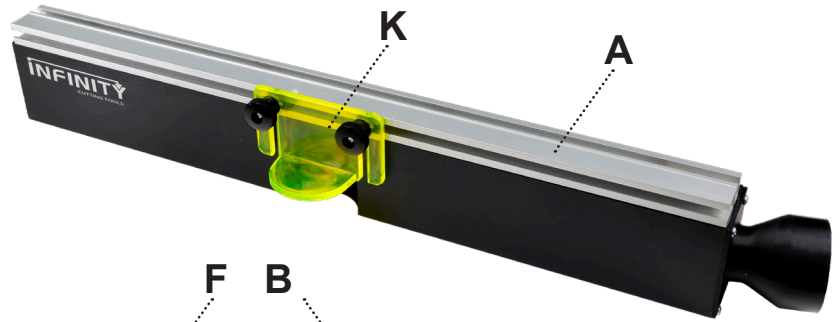



Infinity Tools Portable Router Table System

Part # PRTS-200

Congratulations on purchasing an Infinity Tools Portable Router Table System. Follow this step-by-step guide for easy assembly.



Parts List

- A. Front Panel
- B. Side Panel
- C. Back Panel
- D. Side Panel with Electrical Port
- E. Bottom Panel
- F. Baffle
- G. Hinge
- H. Door
- I. 22x #10-24 x 3/8" Button Head Screws
- J. 12x 10-24 x 5/8" Button Head Screws
- K. 34x #10-24 Nylock Nuts
- L. 10x #8-32 x 3/8" Button Head Screws
- M. 10x #8-32 Nylock Nuts
- N. 8x #6 flat head wood screws
- O. 1x Electrical Grommet
- P. 5-3/8" Block Off Plate
- Q. 2x 2-1/2" Dust Ports
- R. 1x 2-1/2" x 40" Long Dust Hose (Not Shown)
- S. 2x Hose Clamps
- T. Magnetic Strip
- U. 4x Rubber Feet

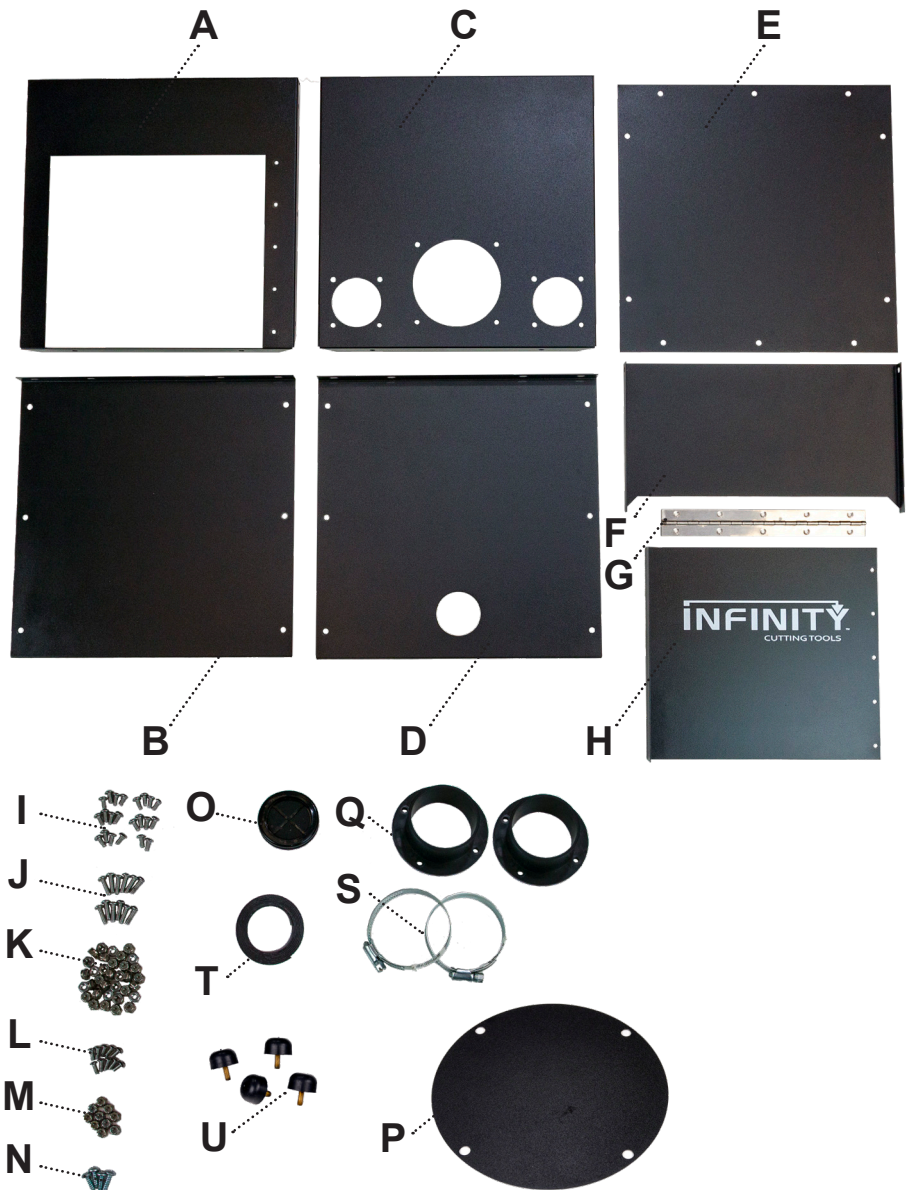

Required Tools

- 3/32" Allen Wrench
- 1/8" Allen Wrench
- 11/32" Wrench
- 3/8" Wrench
- #2 Screwdriver

310 Mears Blvd • Oldsmar, FL 34677

P: 813-881-9090 | 1-877-872-2487 - Order Online 24/7: InfinityTools.com

Assembly

Step 1.

- Assemble the front (A), Sides (B & D), and back (C) using 10x #10-24 x 3/8" button head screws (I) and #10 Nylock Nuts (K).
- Position the side panel with electrical port (D) on the side that you want your routers electrical cord to exit. This electrical port is the only difference between the two side panels.
- Leave the center two holes in the back/side panels open. The screws that go in these holes will be added later in the assembly process.

Step 2.

- Install the (Q) 2-1/2" dust ports and the (P) large center block-off plate onto the back panel (C) using 12x #10-24 x 5/8" button head screws (J) and #10-24 nylock nuts.
- This configuration is designed to allow connection of your portable shop vacuum via its 2-1/4" hose (not included) and connection of your router table fence to the Dust Cube with the included 2-1/2" hose (T) and quick connect fittings (U).
- Alternate configurations are possible and can be adjusted to suit your specific needs.

Step 3.

- Install the bottom panel (E) onto the box using the 10x #10-24 x 3/8" button head screws (I) and #10-24 Nylock nuts (K) Install the rubber feet with nylock nuts in the four corners.

Step 4.

- Install the baffle (F) into the box using 2x #10-24 button head screws (I) and #10 Nylock nuts (K) via the two open holes in the dust cube mentioned in step 1.
- This baffle controls airflow through the box sending the right amount of vacuum to the connected accessories and produces the ideal airflow to eliminate dust buildup in the box itself.

Step 5.

- Install the hinge (G) and door (H) onto the Dust Cube using 10x #8-32 x 3/8" button head screws (L) and 8-32 nylock nuts (M).
- Ensure that the hinge is installed on the outside of the Dust Cube with the barrel facing out, and the door is installed on the outside of the hinge creating a 1/16" gap.
- There should be a 1/8" gap between the bottom of the Door and bottom of the Dust Cube. This gap is intentional and allows the proper amount of airflow along the bottom of the Dust Cube to prevent buildup.

Step 6.

- Install the magnetic Strip (V) along the top and left inside edges of the door (H) trimming the magnetic strip as needed.
- Ensure that the door surface is clean and free of oil and grease before applying the adhesive backed magnetic strip.
- The magnetic strip will fill the 1/16" gap mentioned in Step 5.

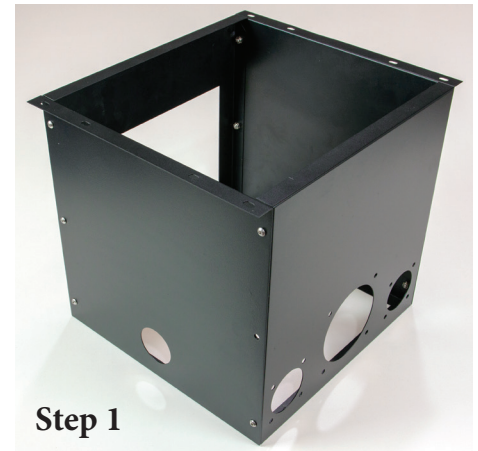

For An Overview Video Visit InfinityTools.com

310 Mears Blvd • Oldsmar, FL 34677

P: 813-881-9090 | 1-877-872-2487 - Order Online 24/7: InfinityTools.com

Step 7.

- Install the Electricidal grommet (O) into the hole on the side panel with electrical port (D). Cut a slot in the grommet large enough to allow the plug on your routers power cord to pass through.

Step 8.

- Before installing the Cube to the Table follow all assembly instructions for the table, to allow for easiest access to its underside. Once done, install the Dust Cube onto your router table using 8x #6X ½” wood screws (N) locating on the predrilled pilot holes.

Step 9.

- Install the dust collection hoses in your desired configuration and feed the routers power cord through the grommet.

Ensure that all safety guidelines are followed.

It is recommended to run your dust collection system whenever using your router table with the Dust Cube installed.

For An Overview Video Visit InfinityTools.com

310 Mears Blvd • Oldsmar, FL 34677

P: 813-881-9090 | 1-877-872-2487 - Order Online 24/7: InfinityTools.com