

## Infinity Tools Router Table Dust Cube

Part # 115-118

Congratulations on purchasing an Infinity Tools Router Table Dust Cube. Follow this step-by-step guide for easy assembly.

### Parts List

- A. Front panel
- B. Side panel
- C. Back panel
- D. Side Panel with Electrical port
- E. Bottom panel
- F. Baffle
- G. Hinge
- H. Door
- I. 22x #10-24 x 3/8" button head screws
- J. 12x #10-24 x 5/8" button head screws
- K. 34x #10-24 nylock nuts
- L. 10x #8-32 x 3/8" button head screws
- M. 10x #8-32 nylock nuts
- N. 4x #8 x 5/8" button head wood screws
- O. 1x electrical grommet
- P. 2x round block-off plates
- Q. 1x 4" dust port
- R. 1x 2-1/2" dust port
- S. 1x 2-1/2" x 40" long dust hose  
(Not Shown)
- T. 2x hose clamps
- U. 2x 2-1/2" threaded quick connect fitting
- V. Magnetic strip
- W. 4x #10-32 x 3/4" button head screws

### Required Tools

- 3/32" Allen wrench
- 1/8" Allen Wrench
- 11/32" Wrench
- 3/8" Wrench
- #2 Phillips Screwdriver

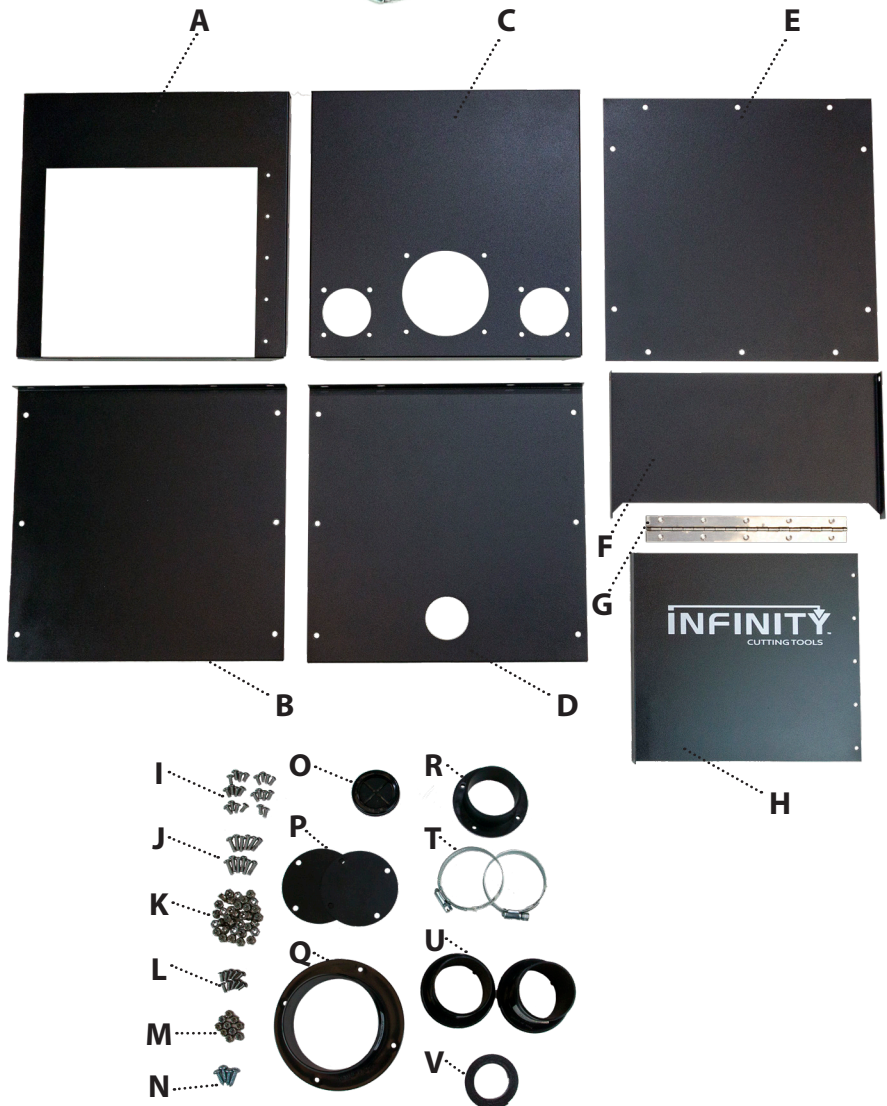

## Assembly

### Step 1.

- Assemble the front (A), Sides (B & D), and back (C) using 10x #10-24 x 3/8" button head screws (I) and #10 Nylock Nuts (K).
- Position the side panel with electrical port (D) on the side that you want your routers electrical cord to exit. This electrical port is the only difference between the two side panels.
- Leave the center two holes in the back/side panels open. The screws that go in these holes will be added later in the assembly process.

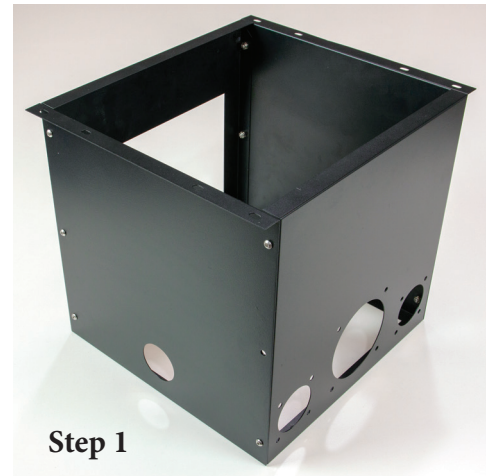

### Step 2.

- Install the 4" dust port (Q) 2-1/2" dust port (R) and one of the block-off plates (P) onto the back panel (C) using 12x #10-24 x 5/8" button head screws (J) and #10-24 nylock nuts.
- This configuration is designed to allow connection of your dust collector via a 4" hose (not included) and connection of your router table fence to the Dust Cube with the included 2-1/2" hose (T) and quick connect fittings (U).
- Alternate configurations are possible and can be adjusted to suit your specific needs.

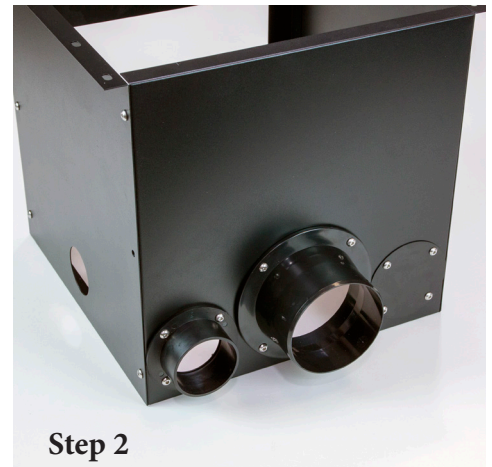

### Step 3.

- Install the bottom panel (E) onto the box using the 10x #10-24 x 3/8" button head screws (I) and #10-24 Nylock nuts (K)

### Step 4.

- Install the baffle (F) into the box using 2x #10-24 button head screws (I) and #10 Nylock nuts (K) via the two open holes in the dust cube mentioned in step 1.
- This baffle controls airflow through the box sending the right amount of vacuum to the connected accessories and produces the ideal airflow to eliminate dust buildup in the box itself.

### Step 5.

- Install the hinge (G) and door (H) onto the Dust Cube using 10x #8-32 x 3/8" button head screws (L) and 8-32 nylock nuts (M).
- Ensure that the hinge is installed on the outside of the Dust Cube with the barrel facing out, and the door is installed on the outside of the hinge creating a 1/16" gap.
- There should be a 1/8" gap between the bottom of the Door and bottom of the Dust Cube. This gap is intentional and allows the proper amount of airflow along the bottom of the Dust Cube to prevent buildup.



### Step 6.

- Install the magnetic Strip (V) along the top and left inside edges of the door (H) trimming the magnetic strip as needed.
- Ensure that the door surface is clean and free of oil and grease before applying the adhesive backed magnetic strip.
- The magnetic strip will fill the 1/16" gap mentioned in Step 5.

310 Mears Blvd • Oldsmar, FL 34677

P: 813-881-9090 | 1-877-872-2487 - Order Online 24/7: [InfinityTools.com](http://InfinityTools.com)

**Step 7.**

- Install the Electricidal grommet (O) into the hole on the side panel with electrical port (D). Cut a slot in the grommet large enough to allow the plug on your routers power cord to pass through.

**Step 8.**

- Install the Dust Cube onto your router table using 4x #8 x 5/8" button head wood screws (N).
- If installing onto an Infinity Tools Router Table Top. Pilot holes are pre drilled for easy alignment and installation using the 4 inner mounting holes on the mounting flanges.
- If installing on an Infinity Tools Cast Iron Top (RTT-006), use the 4 - #10-32 x 3/4" button head screws (W).
- If using an Infinity Heavy Duty Tool Stand the Table support braces are not needed and must be removed if previously installed.
- If installing on any other router table, position the Dust Cube in your desired location, Mark and drill 4x 1/8" diameter by 5/8" deep pilot holes. And use the #8 x 5/8" Button Head wood screws (N) to secure the Dust Cube to your router Table.

**Step 9.**

- Install the dust collection hoses in your desired configuration and feed the routers power cord through the grommet.

Ensure that all safety guidelines are followed.

It is recommended to run your dust collection system whenever using your router table with the Dust Cube installed.