

# Pantile Carthouse 2

## Instructions

Always “dry run” parts before gluing with a woodwork quality PVA.

Start with the floors and place the MDF on a flat surface.

Identify each wall and match the **asymmetric tabs** to make the assembly easier.

**\* Take care not to “mirror flip” pieces that have holes cut out for the resin inserts.**



All kits with pent (single slope roof) have the convention of lining pieces being identified as follows: G = ground floor, working counter clockwise, GA, GB and GC.

1st floor and 2<sup>nd</sup> floor have had 1 or 2 engraved on the pieces rather than G.

Should a piece be “missing” from the sequence, it is intentional as the component is not required in the kit.

Glue the jointed 3mm external walls to the 2mm base.

When dry, glue in the corresponding inner walls and check to ensure the walls are accurately lined up and you do not have “staggered” windows and doors.

Glue in the resin exposed brickwork pieces (if applicable for this kit) using general purpose / superglue or epoxy resin.

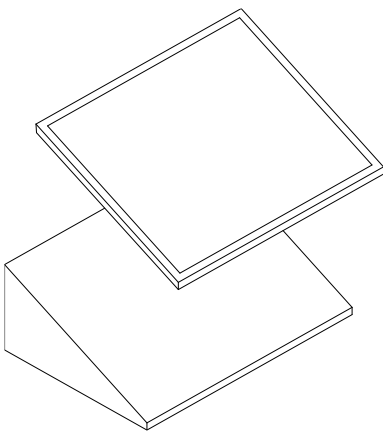

Glue the rectangular 3mm piece to the underside of the roof using a general-purpose adhesive or epoxy resin.

Align the piece with the edges of the roof while the glue is still wet. You may need to support the roof while the glue dries by wedging a book underneath to keep the MDF piece flat.

When the adhesive has “grabbed” but not fully set, offer up the roof to the top floor to check alignment.

When the glue has fully dried, cut the 4 tags and remove the positioning frame.

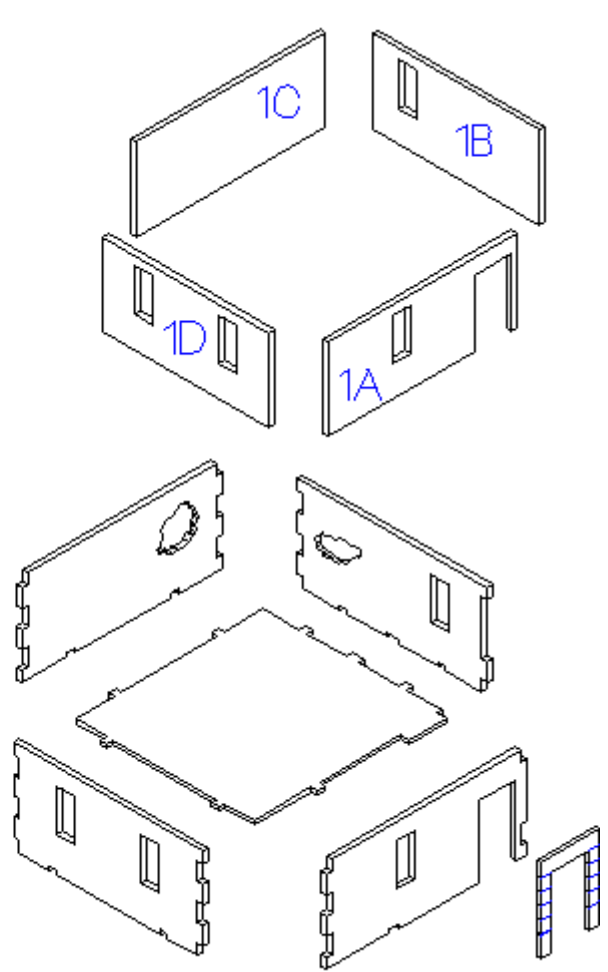
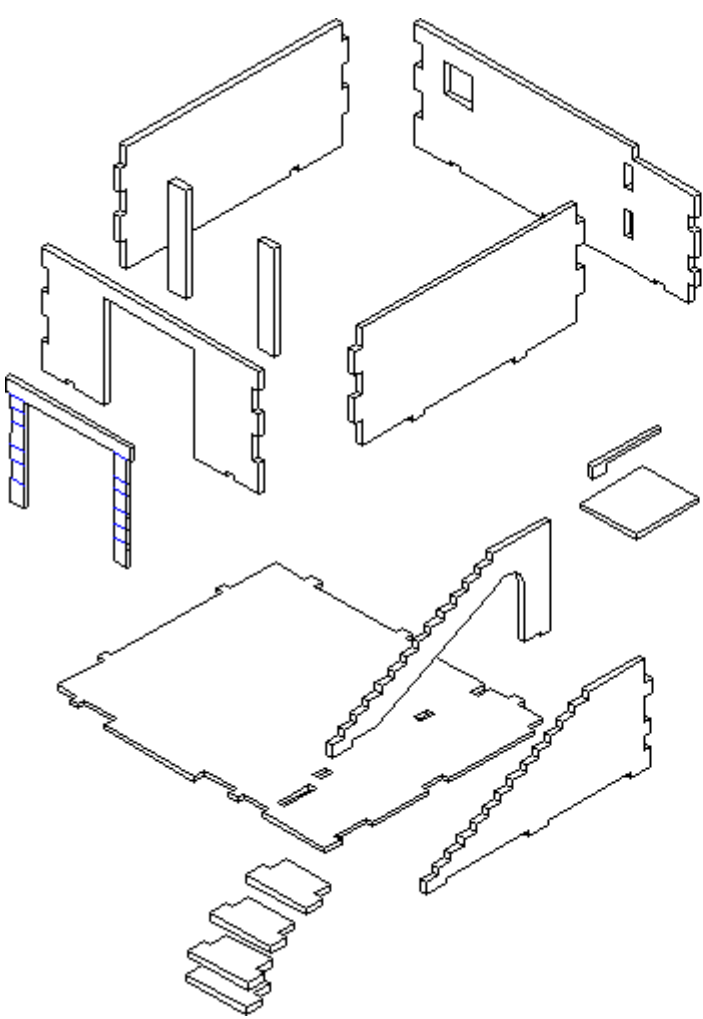

Glue the 4 walls of the ground floor to the 2mm base then glue in the hollowed out internal staircase support. Glue on the external staircase wall and fill the treads working from the bottom up. The top step should be glued on, text side down. Next, glue on the small 2mm door surround trim.

Paint and then glue in the “metal” barred window for the downstairs store area.

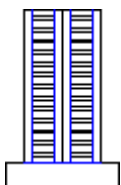

Glue the card closed shutters and sills onto the rectangular vertical roof wall using a general-purpose adhesive or superglue.

When the buildings is fully textured and painted glue on shutters for the other windows.

**TIP: Do not apply your texture too thick either side of the windows as the shutters will look better flush to the walls.**

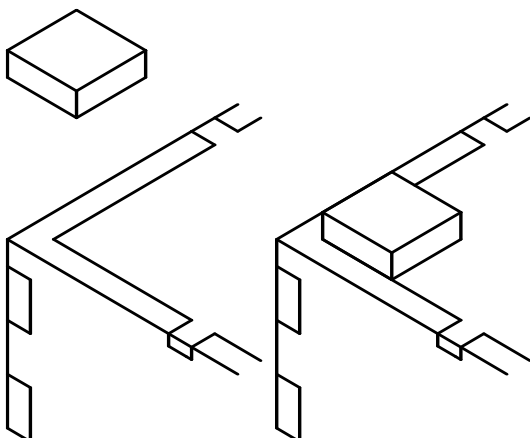

Once complete, turn over the top floors and glue locating blocks underneath taking care to only glue to the 2mm base, leaving the 3mm walls clear.