

# New World Worker's House

## Instructions

Always "dry run" parts before gluing with a woodwork quality PVA.

Start with the ground floor and place the MDF on a flat surface.

Glue in place the front wall by sliding over the floor so the entrance way sticks out.

Glue the remaining three sides to the base. Glue in the window panels (you may wish to do this at the end once the model has been painted). Follow this by fixing the window sills.

Glue the 2 x 3mm comb shapes to the top of the wall, both front and back. Set aside to dry.

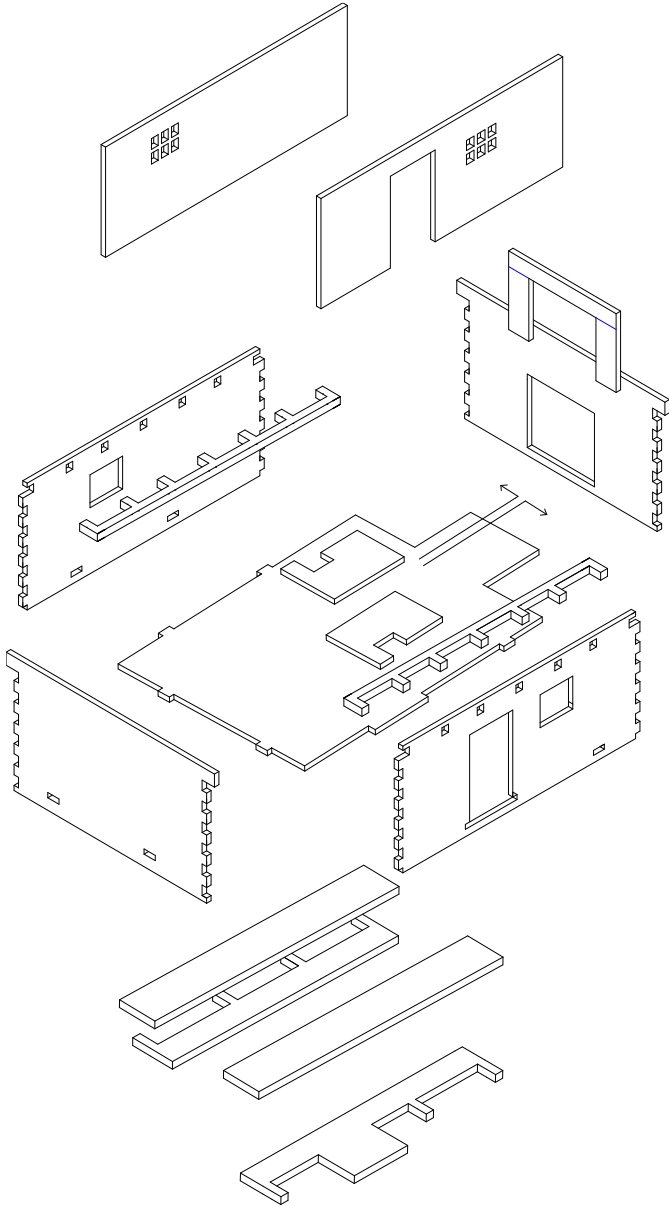

To assemble the roof, firstly glue the two gable ends to one roof section. Affix the second roof piece in place and glue in the windows panel. (You may wish to paint the windows first). Please note, the windows panel should protrude 3mm to act as a locating lug when putting the roof onto the main building.

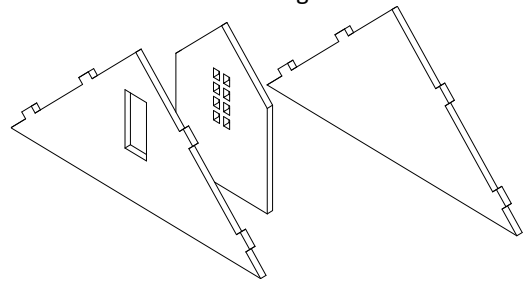

To complete the roof, starting at the lower edge, glue on the cardboard planks following the engraved lines. Coat the cardboard with a thin layer of PVA to seal into place.

Glue the two main chimney sections and two longer jointed brickwork pieces. Insert the 2mm rectangle marked "BASE" and glue in to make a rigid sub-assembly. Taking the 3mm triangular pieces, slide into place in the following order: 1 2 1. This will ensure the brick joints to the sloping chimney shoulders are correctly aligned.

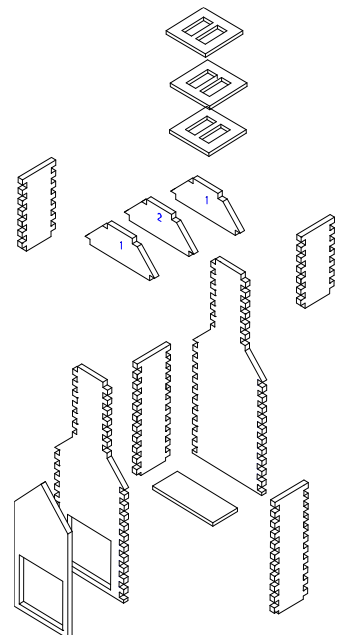

It is recommended that you spray with primer and then paint using emulsion or acrylic paint.  
Thank you for buying this model from:

**Charlie Foxtrot Models**

[www.charliefoxtrotmodels.com](http://www.charliefoxtrotmodels.com)